

NUMBER	DEGREE OF CURVE -- ARC	DEGREE OF CURVE -- CHORD	TANGENT	RADIUS	ARC LENGTH	CHORD LENGTH	EXTERNAL	MID ORDINATE
C26	95°29'35"	112°53'07"	45.7763	60.0000	78.2077	72.7876	15.4684	12.2979
C27	104°10'27"	130°45'36"	4.7111	55.0000	9.3992	9.3877	0.2014	0.2007
C28	104°10'27"	130°45'36"	5.1153	55.0000	10.2013	10.1867	0.2374	0.2363
C29	52°05'13"	54°04'17"	37.5094	110.0000	72.2986	71.0042	6.2194	5.8866
C30	104°10'27"	130°45'36"	8.7383	55.0000	17.3318	17.2602	0.6898	0.6813
C31	104°10'27"	130°45'36"	4.2461	55.0000	8.4753	8.4669	0.1637	0.1632
C32	104°10'27"	130°45'36"	4.1559	55.0000	8.2961	8.2882	0.1568	0.1563
C33	104°10'27"	130°45'36"	28.5135	55.0000	52.6108	50.6278	6.9517	6.1717

SCALES:
1" = 20' HOR
1" = 5' VER

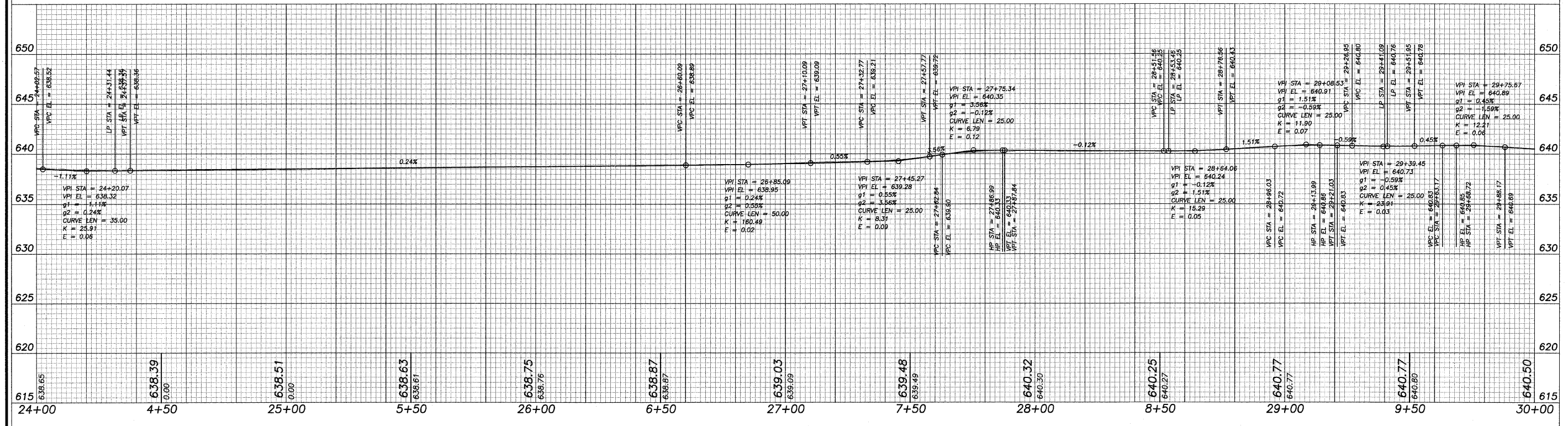
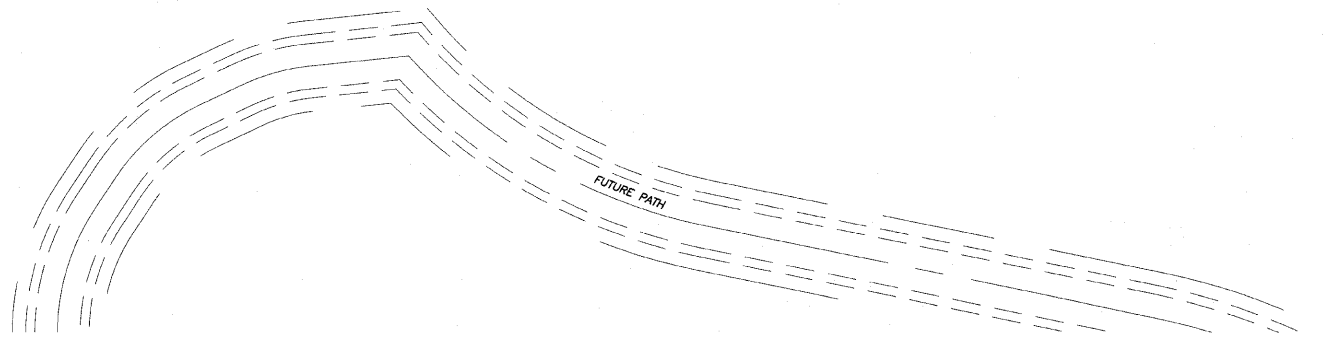

REVISIONS

REVISION	DATE	BY
	20 OCT 08	

DESIGNED BY: DAB
DRAWN BY: BGS
CHECKED BY: BGS
SURVEYED BY: BGS
BOOK NO:

wendler
GROUND-BREAKING SOLUTIONS
engineers - surveyors - scientists
www.wendlergs.com ph: 815.286.2261
Illinois Professional Design Firm No. 194-000948

PAVING PLANS
OF
SHARED MULTI-USE PATH
FOR
STERLING PARK DISTRICT

SHEET TITLE
PLAN & PROFILE

JOB NUMBER
204005

DATE
06/10/2008

SHEET NO.
8 of 15