

TYPICAL SECTION
 STATION 61+12.45 - 62+46.85
 STATION 69+68.85 - 80+21

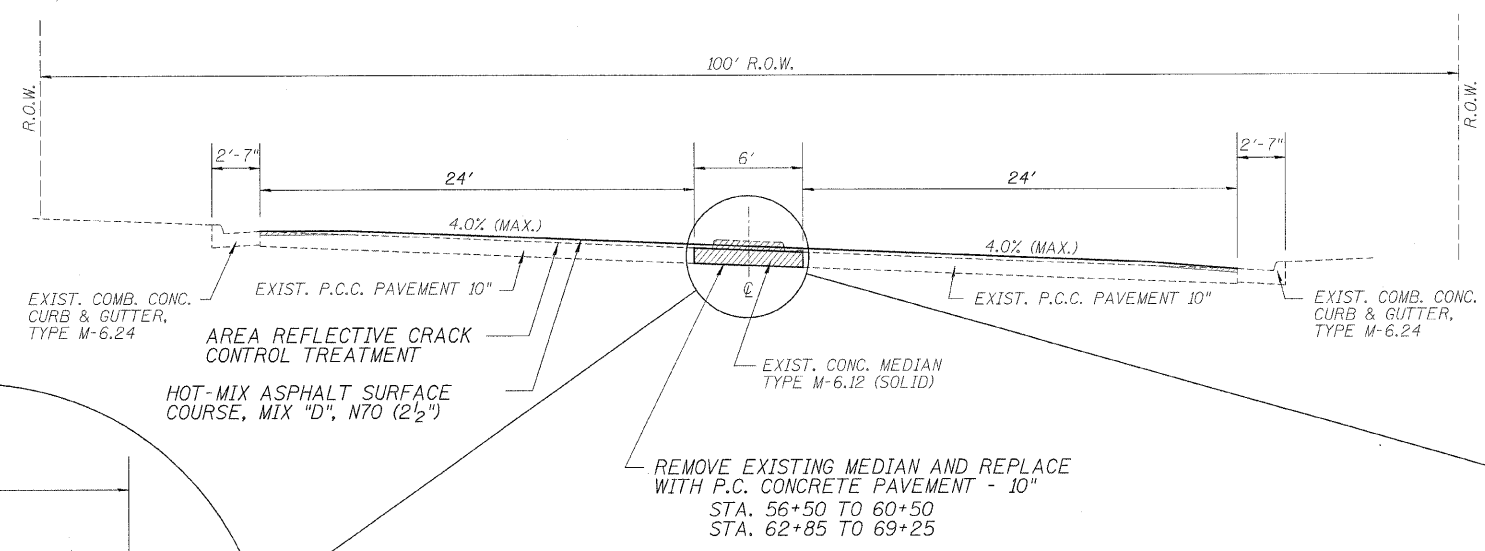

TYPICAL SECTION
 STATION 53+48.4 - 61+12.45 (REVERSED)
 STATION 62+46.85 - 69+68.85 (AS SHOWN)

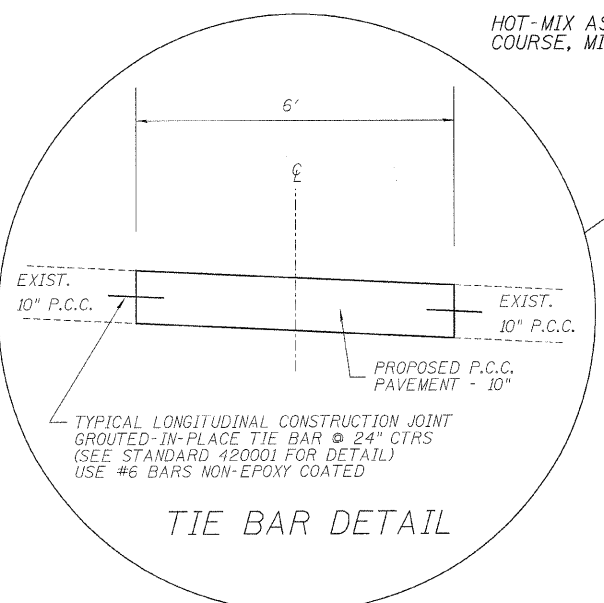

TIE BAR DETAIL

PAVEMENT MIXTURE

	CONSTRUCTION
MIXTURE USE:	SURFACE
PG:	PG 58-22
DESIGN AIR VOIDS	4.0 @ N70
MIXTURE GRADATION	IL 9.5 or 12.5
FRICTION AGGREGATE	D
MIXTURE WEIGHT:	112 LBS/ SY*IN

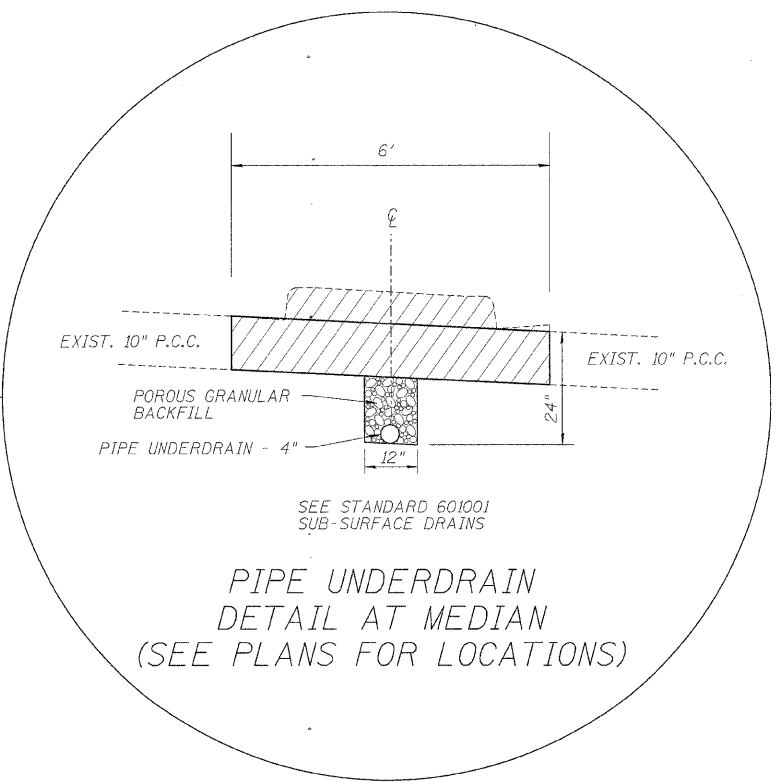

PIPE UNDERDRAIN
 DETAIL AT MEDIAN
 (SEE PLANS FOR LOCATIONS)

WILLET, HOFMANN & ASSOCIATES, INC.
 CONSULTING ENGINEERS
 809 East Second Street Dixon, IL 61021
 Phone 815.284.3381 Fax 815.284.3386
 Design Firm # 184-00918
 www.willett-hofmann.com

DESIGNED -	---	REVISED -	---
DRAWN -	---	REVISED -	---
CHECKED -	---	REVISED -	---
DATE -	---	REVISED -	---

CITY OF STERLING, ILLINOIS
LYNN BLVD. - 16TH AVE. TO FREEPORT RD.

**PROPOSED TYPICAL SECTIONS,
 TIE BAR, AND PIPE UNDERDRAIN DETAILS**

F.A. RTE.	SECTION	COUNTY	TOTAL SHEETS	SHEET NO.
	06-00141-00-RS	WHITESIDE	16	5
FED. ROAD DIST. NO. - ILLINOIS FED. AID PROJECT			CONTRACT NO. -	