

6/30/2008 1:59:17 PM

P:\0100\9000\Chicopee\_CADD\Sheets\1\1\Exc\condemnedRemovals\_PSCS.dgn

F.P. RTE.	SECTION	COUNTY	TOTAL SHEETS	SHEET NO.
• 00-00043-00-BR		FORD	51	11
FED. ROAD DIST. NO. 3		ILLINOIS	CONTRACT NO. 87198	

• HOLMES ST.  
PINE ST.  
CENTER ST.

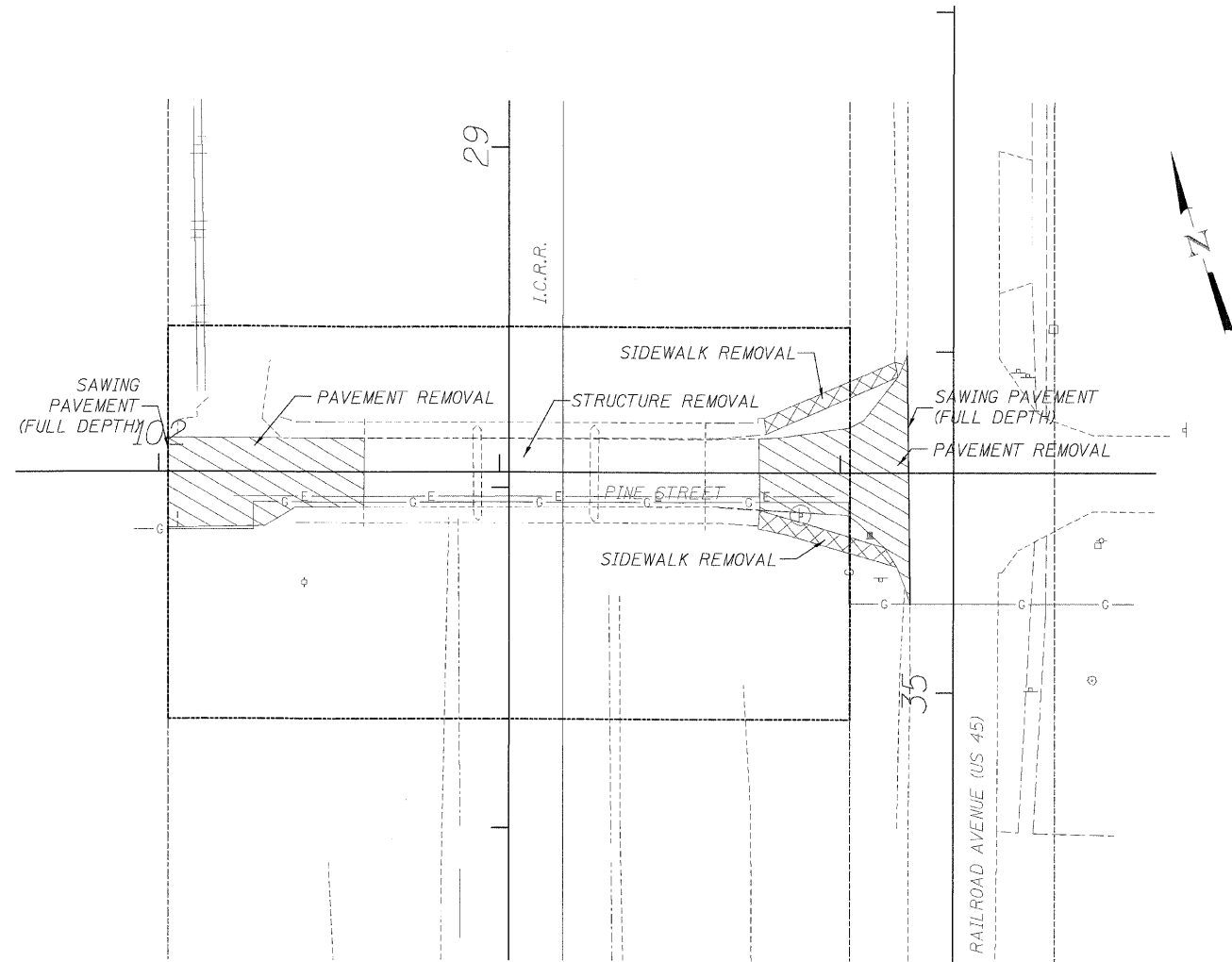

**PINE STREET SALVAGE AND REMOVAL NOTES**

SALVAGE LIGHT FIXTURES FROM 4 BRIDGE CORNERS AND DELIVER TO THE CITY OF PAXTON, STREET DEPARTMENT

CONTRACTOR TO COORDINATE UTILITY RELOCATIONS WITH UTILITY COMPANIES.

**LEGEND**

- Ⓟ SALVAGE SIGN

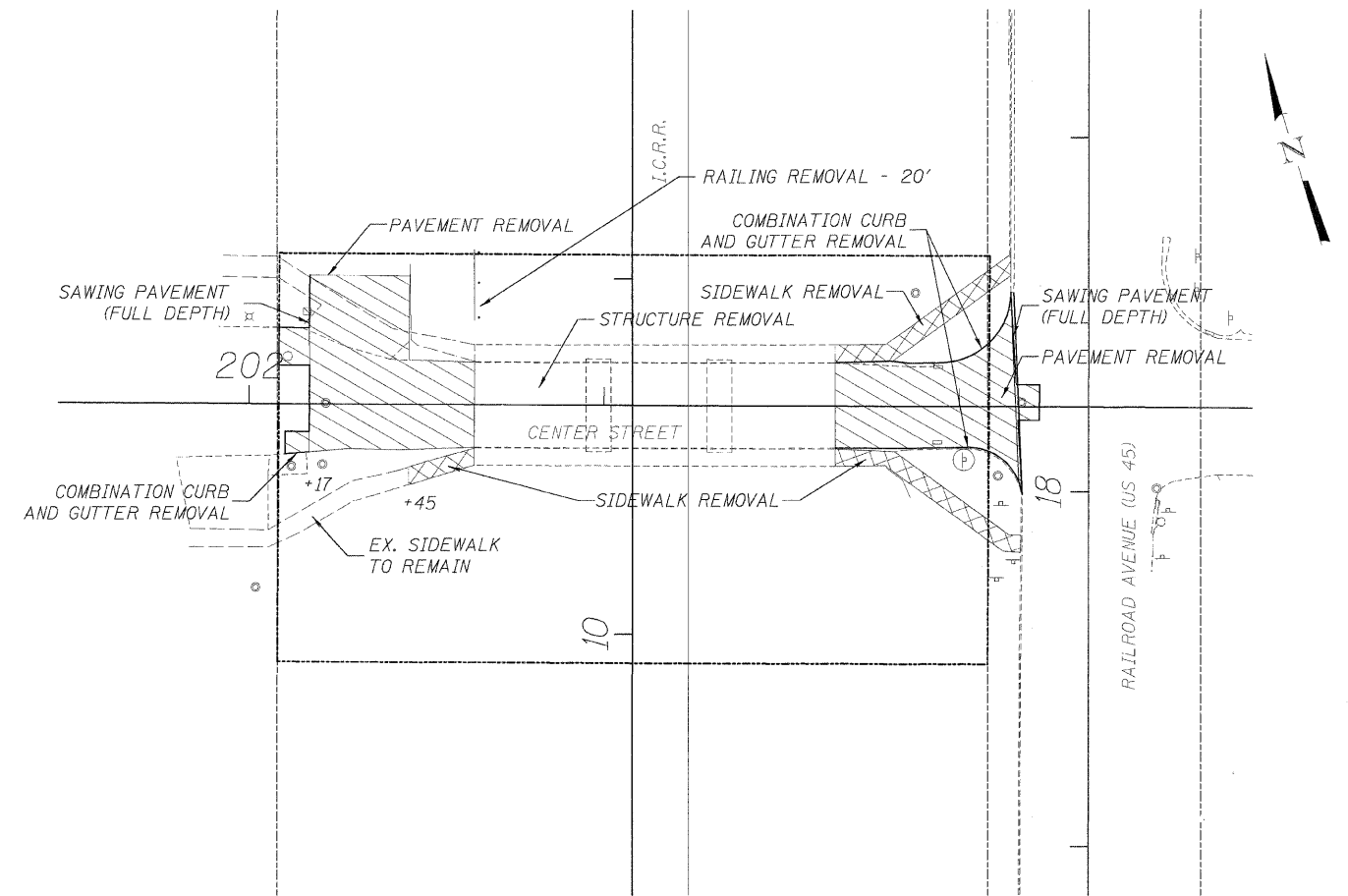

**CENTER STREET SALVAGE AND REMOVAL NOTES**

SALVAGE LIGHT FIXTURES FROM 4 BRIDGE CORNERS AND DELIVER TO THE CITY OF PAXTON, STREET DEPARTMENT

**LEGEND**

- Ⓟ SALVAGE SIGN

**EXISTING CONDITION AND REMOVALS  
PINE STREET AND CENTER STREET**

HOLMES STREET OVER  
ILLINOIS CENTRAL RAILROAD  
CITY OF PAXTON, FORD COUNTY

DESIGN BY KLA	DRAWING NO. C-11	Job# C-93-016-01
DRAWN BY DWJ	DATE 7/1/08	SCALE 1"=25'
CHECKED BY JAH		

<b>Edwards AND Kelcey</b>	DATE	REVISIONS