

6/30/2008 1:59:27 PM

F:\000000\01\chicago_CADD\Sheets\22_Pvt\Mr_Sigf_P5.dgn

F.A.P. RTE.	SECTION	COUNTY	TOTAL SHEETS	SHEET NO.
• 00-00043-00-BR		FORD	51	22
FED. ROAD DIST. NO. 3	ILLINOIS	CONTRACT NO. 87198		

• HOLMES ST.
PINE ST.
CENTER ST.

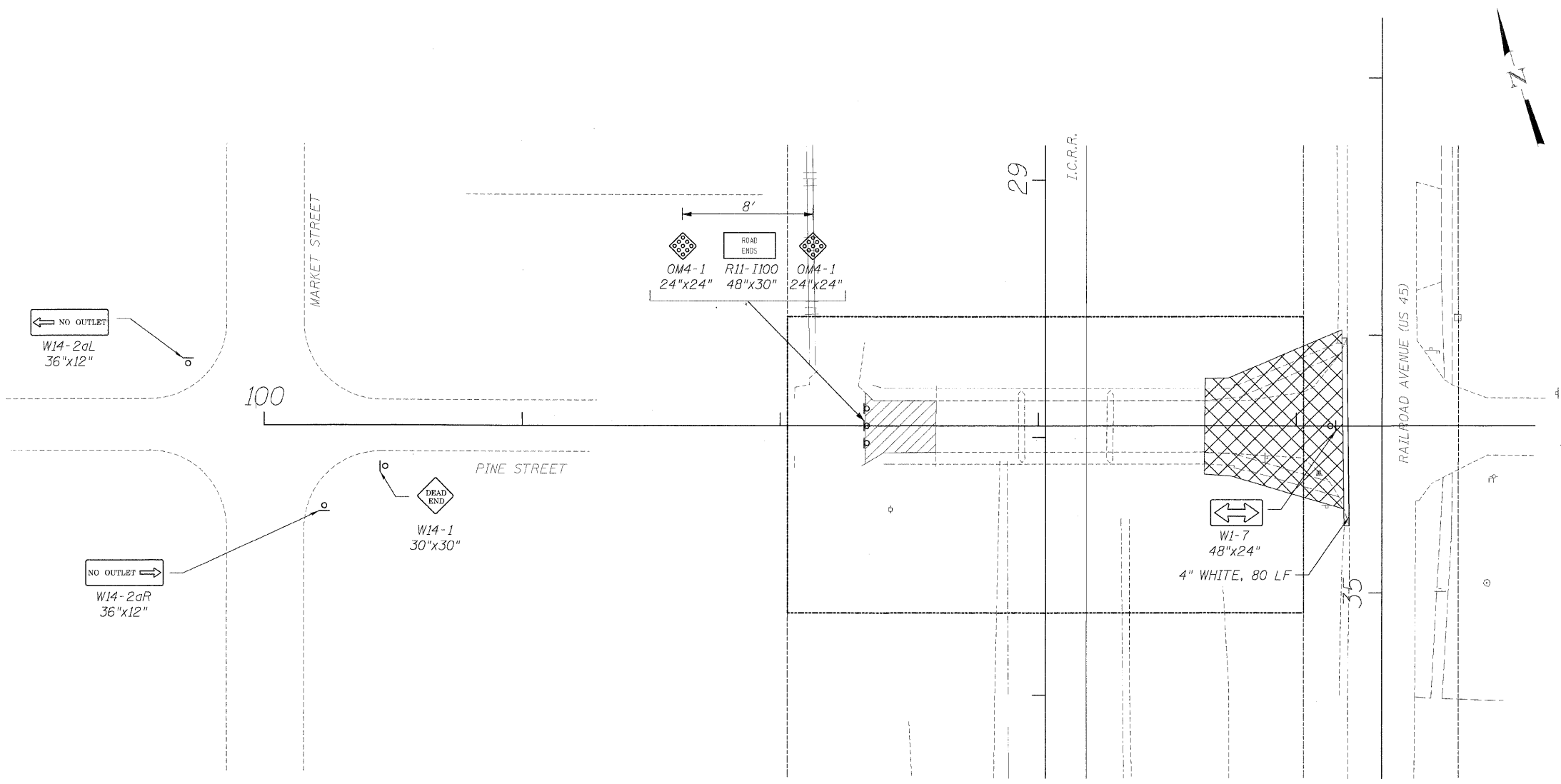

LEGEND

- SODDING, SALT TOLERANT
- SEEDING, CLASS III

NOTES

1) ALL PAVEMENT MARKINGS SHALL BE THERMOPLASTIC.

PAVEMENT MARKING, SIGNING, AND LANDSCAPING PLAN PINE STREET
HOLMES STREET OVER ILLINOIS CENTRAL RAILROAD CITY OF FAXTON, FORD COUNTY

DESIGN BY KLA	DRAWING NO. C-22	Job# C-93-016-01
DRAWN BY DWO	DATE 7/1/08	SCALE 1"=25'
CHECKED BY JAH		



DATE	REVISIONS