

6/24/2008 1:59:32 PM

PA:00000001\Chitkeda_CADD\Sheet's\16-Erosion_CentSt.dwg

F.A.P. RTE.	SECTION	COUNTY	TOTAL SHEETS	SHEET NO.
• 00-00043-00-BR		FORD	51	26
FED. ROAD DIST. NO. 3		ILLINOIS	CONTRACT NO. 87196	

• HOLMES ST.
PINE ST.
CENTER ST.

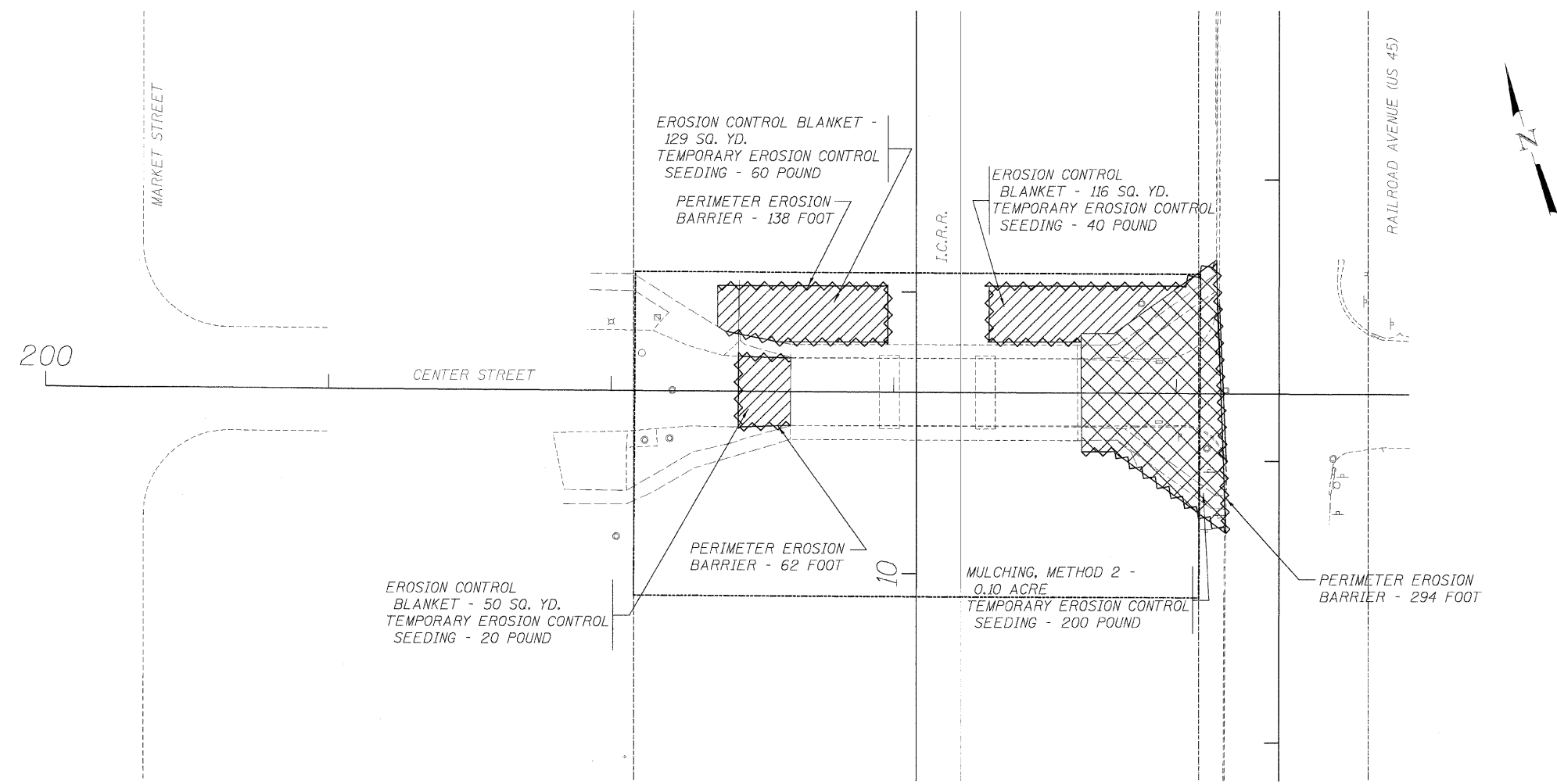

LEGEND

- MULCHING, METHOD 2 + TEMPORARY EROSION CONTROL SEEDING
- EROSION CONTROL BLANKET + TEMPORARY EROSION CONTROL SEEDING
- PERIMETER EROSION BARRIER

EROSION CONTROL PLAN CENTER STREET HOLMES STREET OVER ILLINOIS CENTRAL RAILROAD CITY OF PAXTON, FORD COUNTY		
DESIGN BY DRAWN BY CHECKED BY	MLM MLM TAI	DRAWING NO. C-26
		Job# C-93-016-01 DATE 7/1/08 SCALE 1"=25'
DATE	REVISIONS	

