

FAP. RTE.	SECTION	COUNTY	TOTAL SHEETS	SHEET NO.
• 00-00043-00-BR	FORD	51	27	
FED. ROAD DIST. NO. 3	ILLINOIS	CONTRACT NO. 87198		

• HOLMES ST.  
PINE ST.  
CENTER ST.

**NOTES:**

- (A) 1/2" PVC CONDUIT EMBEDDED IN CONCRETE SIDEWALK WITH 1 #8 (TYPE XLP 600V) 1 #8 NEUTRAL (TYPE XLP 600V) & 1 #12 GRD (TYPE XLP 600V).
- (B) 1/2" GALVANIZED STEEL CONDUIT IN TRENCH WITH 2 #8 (TYPE XLP 600V) 2 #8 NEUTRAL (TYPE XLP 600V) & 1 #12 GRD (TYPE XLP 600V).
- (C) 1/2" GALVANIZED STEEL CONDUIT IN TRENCH WITH 1 #8 (TYPE XLP 600V) 1 #8 NEUTRAL (TYPE XLP 600V) & 1 #12 GRD (TYPE XLP 600V).
- (D) REINFORCED CONCRETE LIGHT POLE (SPECIAL) (TYP.) SEE 'LIGHTING AND ELECTRICAL DETAILS' SHEET S-10
- (E) METAL HALIDE LUMINAIRE (SPECIAL) 100W/120V (TYP.)



1/2" CONDUIT, PVC, EMBEDDED IN STRUCTURE — EDGE OF CONCRETE RAILING

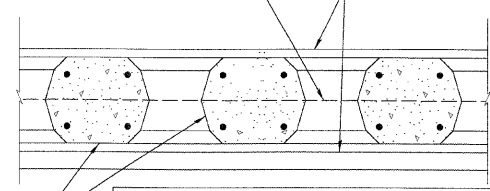

DETAIL  
N.T.S.

NOTE: FOR PLACEMENT OF EMBEDDED CONDUIT SEE "REINFORCED CONCRETE LIGHT POLES (SPECIAL)" AND "CONCRETE BRIDGE RAIL (SPECIAL)" ON DRAWINGS 'LIGHTING AND ELECTRICAL DETAILS', SHEET S-10 AND 'SUPER STRUCTURE DETAILS', SHEET S-7

**STREET LIGHTING**  
HOLMES STREET OVER  
ILLINOIS CENTRAL RAILROAD  
CITY OF PAXTON, FORD COUNTY

DESIGN BY JAH	DRAWING NO. C-27	Job# C-93-016-01
DRAWN BY DWG		DATE 7/1/08
CHECKED BY KLA		SCALE 1"=10'



DATE	REVISIONS

6/30/2008 1:58:33 PM P:\00000001\Chicago\_CADD\Sheets\2151\Rail\_Lighting.dgn