

F.A.L.I. RTE.	SECTION	COUNTY	TOTAL SHEETS	SHEET NO.
6713	05-00148-00-PV	TAZEWELL	74	13
STA. 145+50.00		TO STA. 156+60.00		
FED. ROAD DIST. NO. 4		ILLINOIS		FED. AID PROJECT

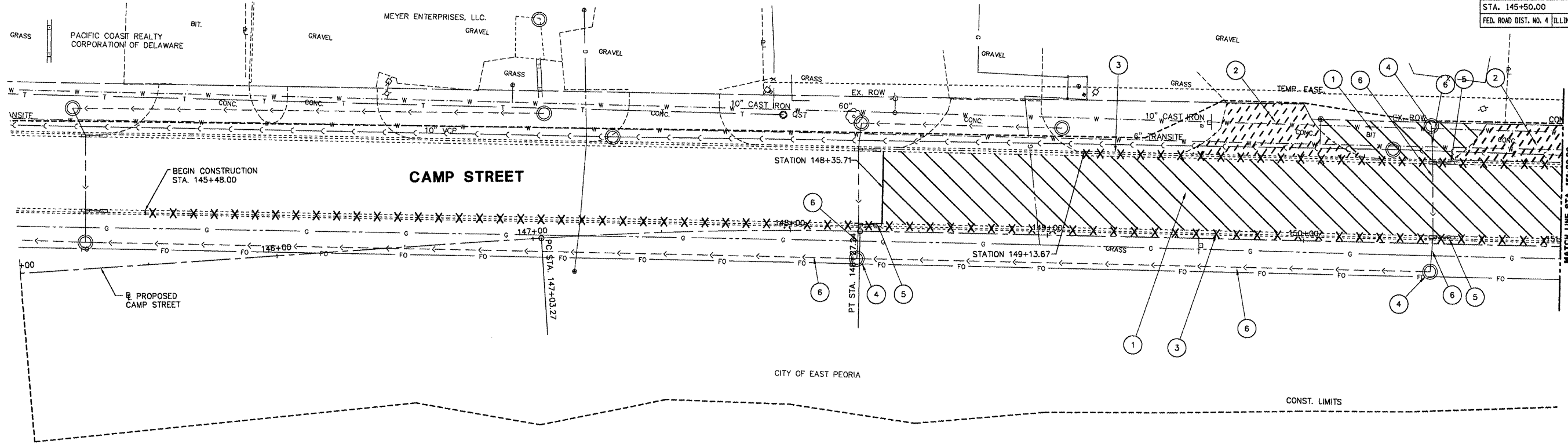
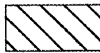
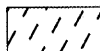
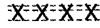

PLAN VIEW
SCALE: 1"=20'

LEGEND

- | | |
|---|-----------------------|
| ①  PAVEMENT REMOVAL | ④ REMOVING MANHOLES |
| ②  DRIVEWAY PAVEMENT REMOVAL | ⑤ REMOVING INLETS |
| ③  COMBINATION CURB AND GUTTER REMOVAL | ⑥ STORM SEWER REMOVAL |
| | ⑦ GUARDRAIL REMOVAL |

- ① PAVEMENT REMOVAL
STA. 148+35.71 TO STA. 151+00.00
- ② DRIVEWAY PAVEMENT REMOVAL
LT. STA. 149+51.16 TO STA. 150+23.58
LT. STA. 150+58.43 TO STA. 151+00.00
- ③ COMBINATION CURB AND GUTTER REMOVAL
LT. STA. 145+48.00 TO STA. 151+00.00
LT. STA. 149+13.67 TO STA. 151+00.00
- ④ REMOVING MANHOLES
STA. 148+26.20, 10.48' RT.
STA. 150+48.45, 10.46' RT.
STA. 150+48.78, 45.71' LT.
- ⑤ REMOVING INLETS
STA. 148+30.27, 2.66' LT.
STA. 150+53.18, 31.59' LT.
STA. 150+53.83, 2.65' LT.
- ⑥ STORM SEWER REMOVAL, 12"
RT. STA. 148+26.20 TO LT. STA. 148+26.63
LT. STA. 150+48.78 TO LT. STA. 150+49.64
RT. STA. 150+49.45 TO LT. STA. 150+50.30
LT. STA. 150+49.64 TO LT. STA. 150+50.30

STORM SEWER REMOVAL, 15"
RT. STA. 148+26.21 TO RT. STA. 150+49.45

STORM SEWER REMOVAL, 24"
LT. STA. 145+26.06 TO RT. STA. 148+26.21

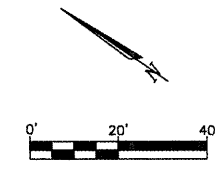

THE REMOVAL OF BOTH INLETS FOR G-1 DOUBLE AND THE PIPE IN-BETWEEN WILL BE INCLUDED AS ONE EACH REMOVAL ITEM.

REVISIONS	
NAME	DATE

ILLINOIS DEPARTMENT OF TRANSPORTATION
CAMP STREET CONNECTOR
REMOVAL PLAN
STA. 145+00 TO 151+00

SCALE: VERT. DRAWN BY JLT
HORIZ. 1" = 20'
DATE 12/22/2008 CHECKED BY CSA

L:\AS2018\UNITS\RMCP-01.dwg