

F.A.U. RTE.	SECTION	COUNTY	TOTAL SHEETS	SHEET NO.
6713	05-00148-00-PV	TAZEWELL	74	36
STA. 145+50.00		TO STA. 156+60.00		
FED. ROAD DIST. NO. 4		ILLINOIS FED. AID PROJECT		

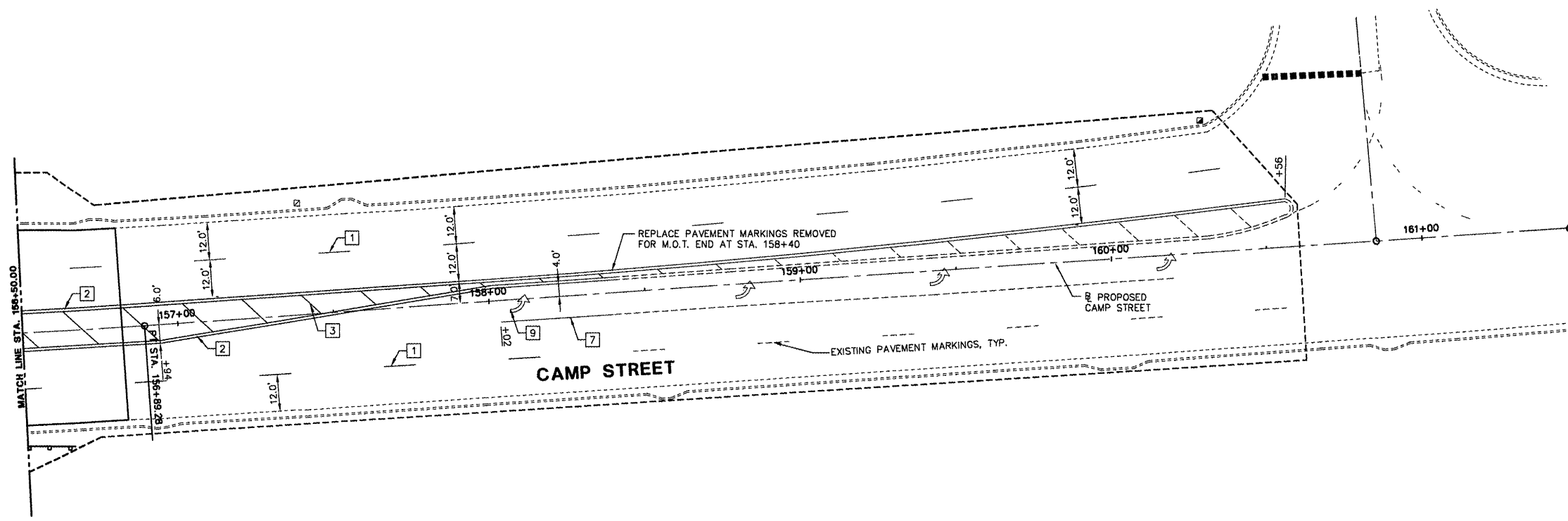

PLAN VIEW
SCALE: 1"=20'

- LEGEND**
- 1 LANE LINE SKIP DASH, WHITE 6"
 - 2 DOUBLE YELLOW, 4"
 - 3 DIAGONAL YELLOW, 12" @ 20' O.C.
 - 4 STOP LINE, WHITE 24"
 - 5 SOLID YELLOW, 4"
 - 6 SOLID WHITE, 8"
 - 7 SOLID WHITE, 4"
 - 8 LANE LINE SKIP DASH, WHITE 6"
 - 9 LETTERS AND SYMBOLS, WHITE
 - 10 LANE LINE SKIP DASH, YELLOW 4"
 - 11 DIAGONAL WHITE, 12" @ 20' O.C.
 - EXISTING PAVEMENT MARKINGS

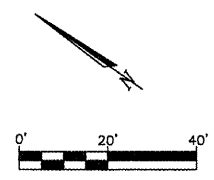

REVISIONS	
NAME	DATE

ILLINOIS DEPARTMENT OF TRANSPORTATION
CAMP STREET CONNECTOR
 PAVEMENT MARKING PLAN
 STA. 156+50 TO 161+46.96

SCALE: VERT. 1" = 20'
 HORIZ. 1" = 20'
 DATE 12/22/2008

DRAWN BY JLT
 CHECKED BY CSA

L:\30328\Drawings\PCP-03.dwg