

F.A.U. RTE.	SECTION	COUNTY	TOTAL SHEETS	SHEET NO.
6713	05-00148-00-PV	TAZEWELL	74	42
STA. 145+50.00 TO STA. 156+60.00				
FED. ROAD DIST. NO. 4 ILLINOIS FED. AID PROJECT				

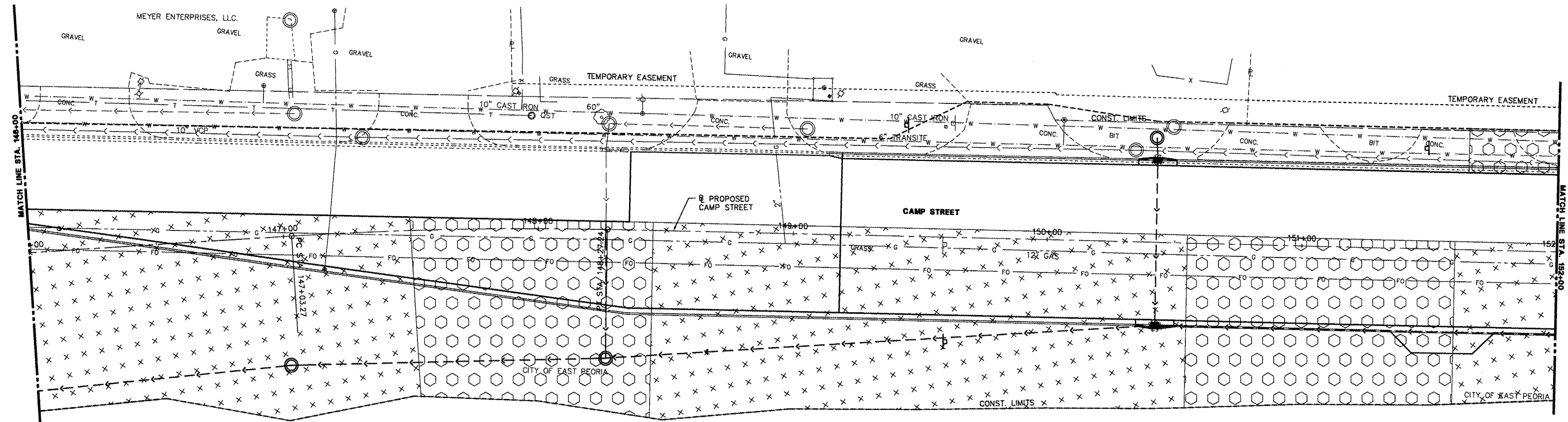
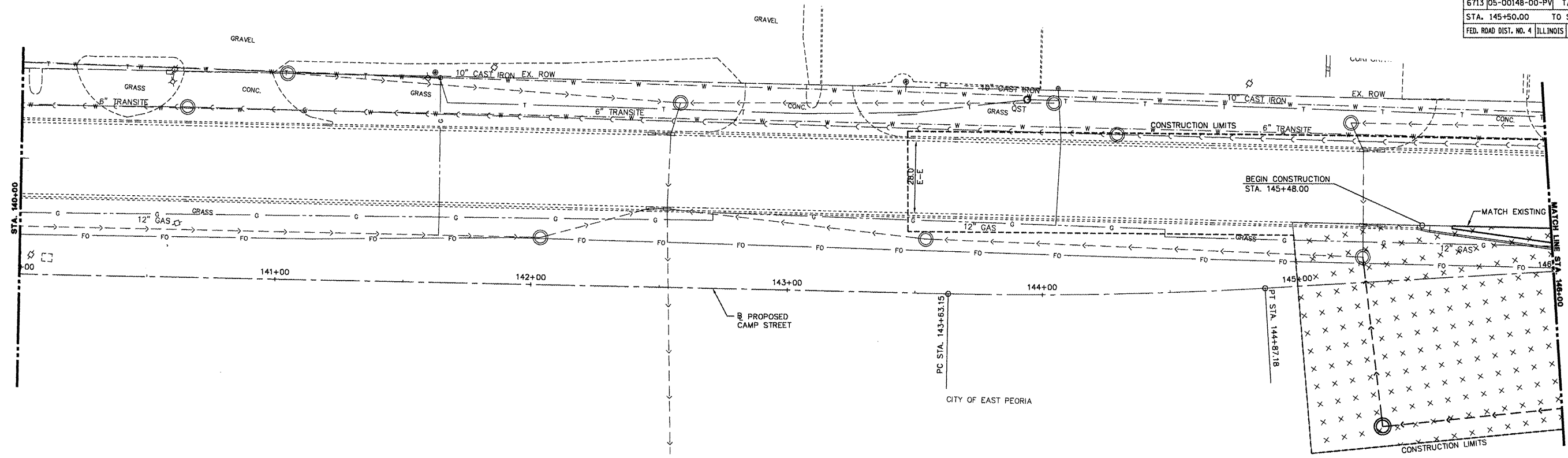
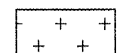
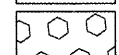

LEGEND

-  AREAS OF SPECIAL WASTE
-  AREAS OF SPECIAL WASTE AND CONSTRUCTION WORKER CAUTION

NOTE:

WHEN WORKING IN AREAS LABELED "CONSTRUCTION WORKER CAUTION", THE WEARING OF LONG PANTS, LONG SLEEVE SHIRTS, GLOVES, SAFETY GLASSES, HATS OR HARD HATS (AS APPLICABLE) IS APPROPRIATE. ADDITIONALLY, NORMAL PERSONAL HYGIENE PROCEDURES SHOULD BE FOLLOWED I.E. THROUGH CLEANUP WITH SOAP AND WATER FOLLOWING WORK ACTIVITIES.

CAMP ST. AREAS OF SPECIAL WASTE PLAN VIEW

SCALE: HORZ. 1" = 20'

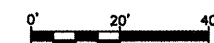

CAMP STREET - SPECIAL WASTE PLAN VIEW - STA. 140+00 TO STA. 152+00

L:\832018\DWG\WP-01.dwg