

F.A.U. RTE.	SECTION	COUNTY	TOTAL SHEETS	SHEET NO.
6713	05-00148-00-PV	TAZEWELL	74	72
STA. 145+50.00		TO STA. 156+60.00		
FED. ROAD DIST. NO. 4 ILLINOIS FED. AID PROJECT				

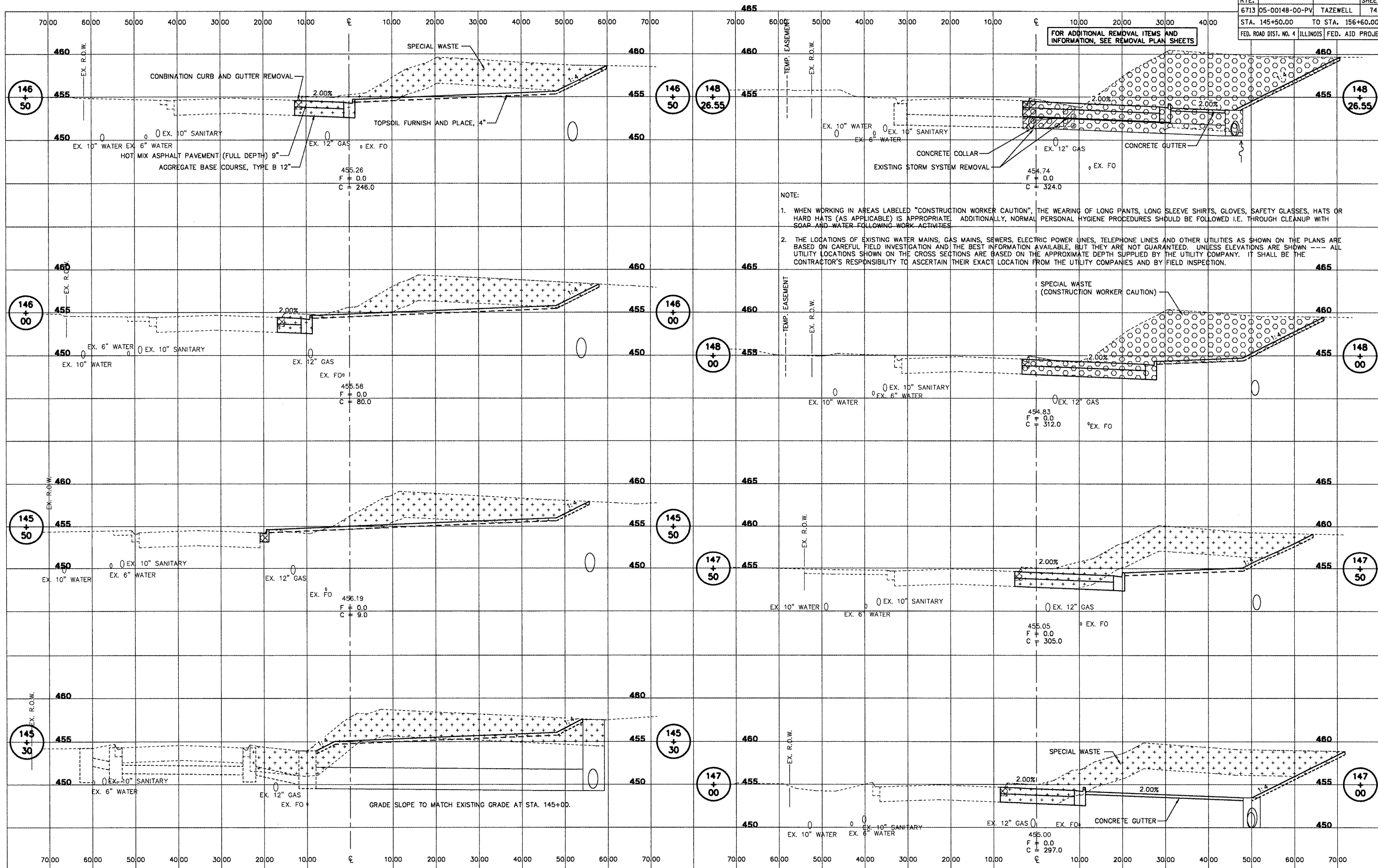

NOTE:
 1. WHEN WORKING IN AREAS LABELED "CONSTRUCTION WORKER CAUTION", THE WEARING OF LONG PANTS, LONG SLEEVE SHIRTS, GLOVES, SAFETY GLASSES, HATS OR HARD HATS (AS APPLICABLE) IS APPROPRIATE. ADDITIONALLY, NORMAL PERSONAL HYGIENE PROCEDURES SHOULD BE FOLLOWED I.E. THROUGH CLEANUP WITH SOAP AND WATER FOLLOWING WORK ACTIVITIES.
 2. THE LOCATIONS OF EXISTING WATER MAINS, GAS MAINS, SEWERS, ELECTRIC POWER LINES, TELEPHONE LINES AND OTHER UTILITIES AS SHOWN ON THE PLANS ARE BASED ON CAREFUL FIELD INVESTIGATION AND THE BEST INFORMATION AVAILABLE, BUT THEY ARE NOT GUARANTEED. UNLESS ELEVATIONS ARE SHOWN --- ALL UTILITY LOCATIONS SHOWN ON THE CROSS SECTIONS ARE BASED ON THE APPROXIMATE DEPTH SUPPLIED BY THE UTILITY COMPANY. IT SHALL BE THE CONTRACTOR'S RESPONSIBILITY TO ASCERTAIN THEIR EXACT LOCATION FROM THE UTILITY COMPANIES AND BY FIELD INSPECTION.

FOR ADDITIONAL REMOVAL ITEMS AND INFORMATION, SEE REMOVAL PLAN SHEETS

CAMP STREET - CROSS SECTIONS - STA. 140+00 TO STA. 146+00

L:\A30218\EP\PC000001.dwg