

SECTION	COUNTY	SHEETS	NO
STA. 14+00 TO STA. 15+43	MARSHALL BUREAU	14	12
ROAD DIST. ILLINOIS	SARATOGA/MILO		
*05-1016-00-BR 08-1614-00-BR	CONTRACT NO. 89398		

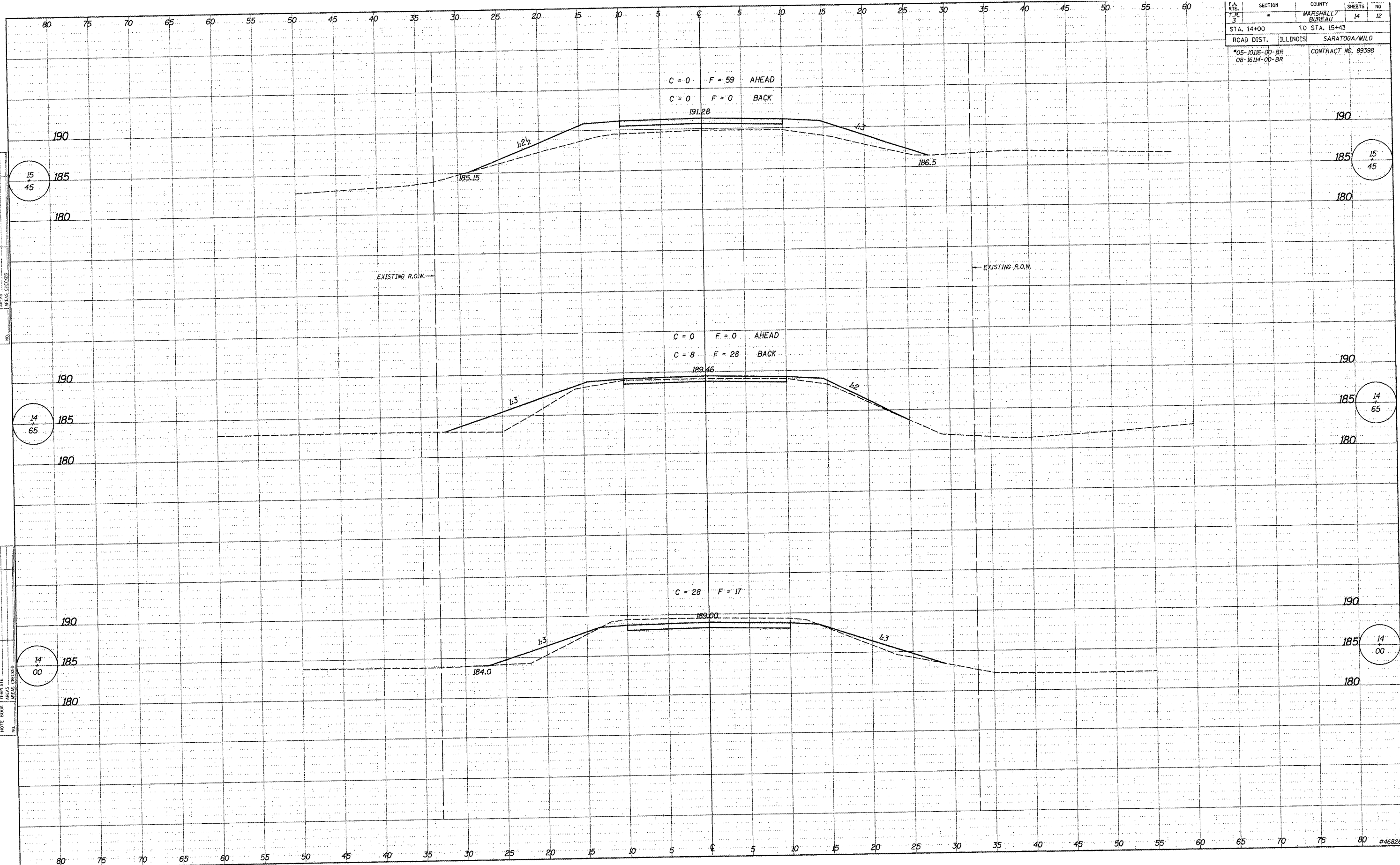

DATE: _____
 BY: _____
 CHECKED: _____
 APPROVED: _____

DATE: _____
 BY: _____
 CHECKED: _____
 APPROVED: _____