

COUNTY	ROUTE	SECTION	TOTAL SHEETS	SHEET NO.
ADAMS	FAS 432	08-00206-00-RS	11	1

STATE OF ILLINOIS
DEPARTMENT OF TRANSPORTATION
DIVISION OF HIGHWAYS
PLANS FOR PROPOSED
SURFACE TRANSPORTATION/RURAL PROGRAM
LOCAL AGENCY PAVEMENT PRESERVATION

FAS 432 (CH 14) SECTION 08-00206-00-RS ADAMS COUNTY
PROJECT NO. RS-432(122) JOB NO. C-96-222-08

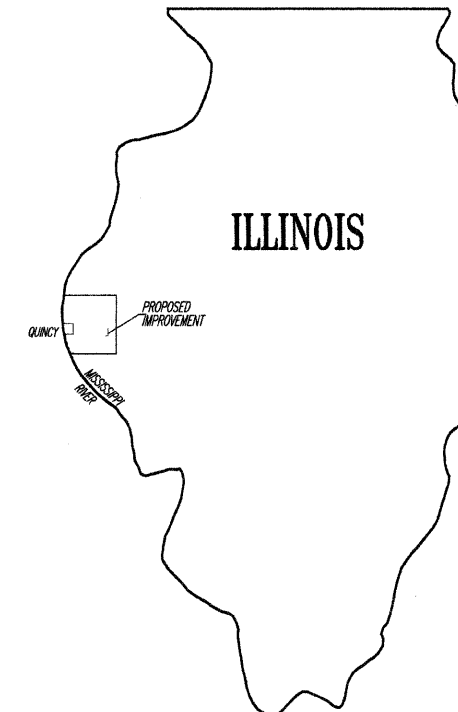

PROPOSED IMPROVEMENT MARKED THUS —

THESE PLANS WERE PREPARED BY ME OR BY A FULL-TIME MEMBER OF MY STAFF WORKING UNDER MY PERSONAL SUPERVISION.

SUBMITTED BY *Ridell C. Payne* DATE 11-18-08
COUNTY ENGINEER
LICENSE NO. 062-032961
LIC. EXPIRES 11/30/2009

INDEX OF SHEETS:

SHEET NO.	SHEET
1	TITLE SHEET
2	SUMMARY OF QUANTITIES
	GENERAL NOTES
3	TYPICAL CROSS SECTIONS
4-10	PLAN SHEETS
11	SIDE ROAD & ENTRANCE DETAILS
	BUTT JOINT DETAIL
STANDARD	701001-02
STANDARD	701006-03
STANDARD	701301-03
STANDARD	701306-02
STANDARD	701901-01
STANDARD	BLR 24-2

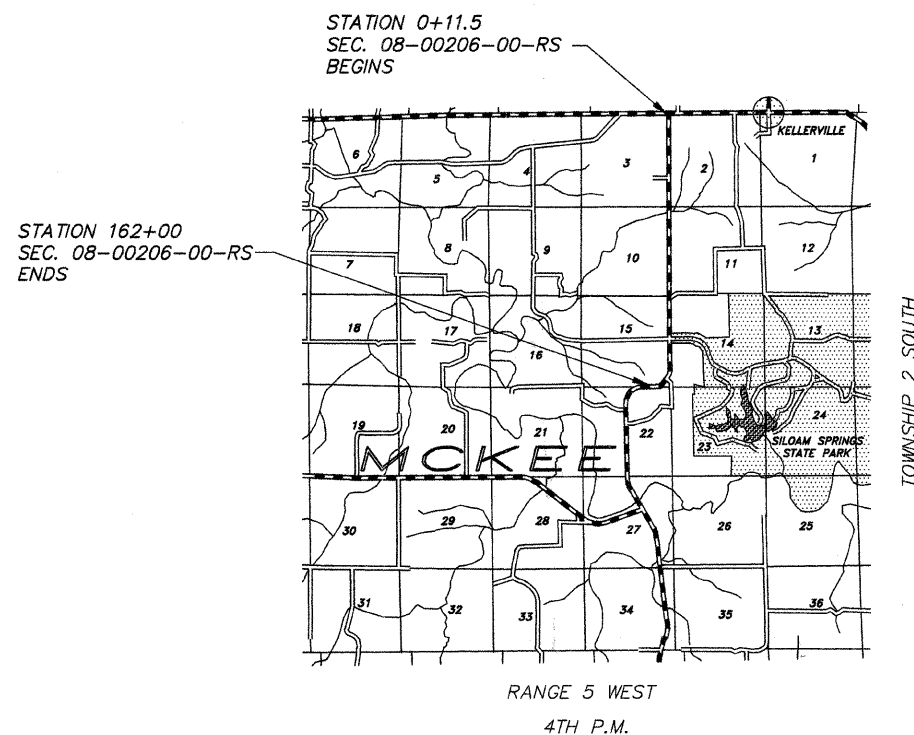

LOCATION MAP

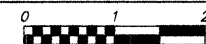

FUNCTIONAL CLASS: MAJOR COLLECTOR (NON-URBAN)
ADT=225

PROPOSED IMPROVEMENT CONSISTS OF PLACING 1 1/2" POLYMERIZED HOT-MIX ASPHALT SURFACE COURSE, MIX "C", N50 OVER 3/4" OF LEVELING BINDER (MACHINE METHOD) N50 ON THE EXISTING 22' ROADWAY WITH OTHER MISCELLANEOUS CONSTRUCTION

UTILITIES:
J.U.L.I.E. _____ 1-800-892-0123
GENERAL TELEPHONE _____ QUINCY, IL
ADAMS RURAL ELECTRICAL CO-OP _____ CAMP POINT, IL

GROSS LENGTH:
STA. 0+11.50 TO STA. 162+00.00 = 16,188.50 FT.
NET LENGTH TO BE IMPROVED: 16,188.50 FT. = 3.066 MILES

APPROVED	<u><i>Ridell C. Payne</i></u>	November 18, 2008
	COUNTY ENGINEER	
PASSED	<u><i>Ron Schamberg</i></u>	December 8, 2008
	DISTRICT ENGINEER OF CONSTRUCTION	
PASSED	<u><i>Tommy J. [Signature]</i></u>	DEC 8, 2008
	DISTRICT ENGINEER OF LOCAL ROADS AND STREETS	
RELEASING FOR BID BASED ON LIMITED REVIEW	<u><i>Roger J. [Signature]</i></u>	DEC 8, 2008
	DEPUTY DIRECTOR OF HIGHWAYS REGION FOUR ENGINEER	

**STATE OF ILLINOIS
DEPARTMENT OF TRANSPORTATION**