

WEST GUTTER LINE

Location	Station	Offset	Theoretical Grade Elevations
South End S. Appr. Pav't.	115+65.55	-16.00'	563.34
A	115+75.55	-16.00'	563.84
B	115+85.55	-16.00'	564.34
North End S. Appr. Pav't.	115+95.55	-16.00'	564.84

WEST EDGE OF PAVEMENT

Location	Station	Offset	Theoretical Grade Elevations
South End S. Appr. Pav't.	115+66.70	-12.00'	563.48
A	115+76.70	-12.00'	563.98
B	115+86.70	-12.00'	564.48
North End S. Appr. Pav't.	115+96.70	-12.00'	564.98

☉ ROADWAY & PROFILE GRADE LINE

Location	Station	Offset	Theoretical Grade Elevations
South End S. Appr. Pav't.	115+70.14	0.00'	563.83
A	115+80.14	0.00'	564.33
B	115+90.14	0.00'	564.83
North End S. Appr. Pav't.	116+00.14	0.00'	565.33

EAST EDGE OF PAVEMENT

Location	Station	Offset	Theoretical Grade Elevations
South End S. Appr. Pav't.	115+73.58	12.00'	563.82
A	115+83.58	12.00'	564.32
B	115+93.58	12.00'	564.82
North End S. Appr. Pav't.	116+03.58	12.00'	565.32

EAST GUTTER LINE

Location	Station	Offset	Theoretical Grade Elevations
South End S. Appr. Pav't.	115+74.73	16.00'	563.80
A	115+84.73	16.00'	564.30
B	115+94.73	16.00'	564.80
North End S. Appr. Pav't.	116+04.73	16.00'	565.30

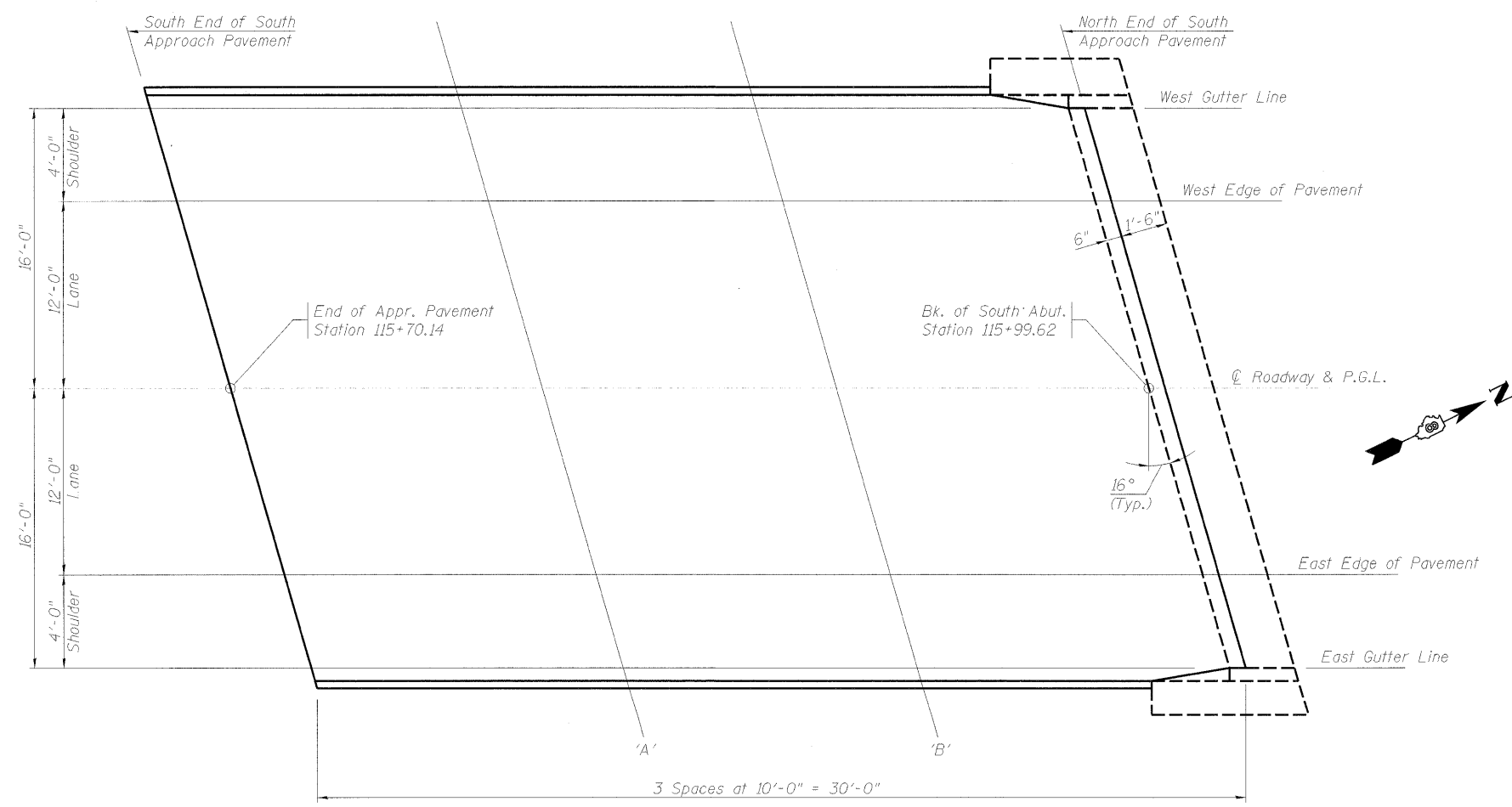

PLAN

TOP OF SOUTH APPROACH SLAB ELEVATIONS
 ANDREWS DRIVE over
 U.S. ROUTE 40 ; CSX RR and IL. WESTERN RR
 SEC. 99-00036-00-BR
 STR. NO. 003-6000
 CITY of GREENVILLE
 BOND COUNTY
 STATION 117+73.00

PROFESSIONAL DESIGN FIRM LICENSE #184-001084

© Copyright Hanson Professional Services Inc. 2008

HANSON
 Hanson Professional Services Inc.

JOB NO. 04S2012
 DATE 12/10/08

LAYOUT: MM 03/07/08
 DRAWN: DAP 03/07/08
 REVIEWED: MM 03/07/08
 12/23/2008
 A:\04\pals\0452012\CADD\Struct\Sheet\ATOS Elev S Appr.dgn