

*Order a(E) & a₁(E) bars full length.
Cut to fit skew and use remainder
of bars in opposite end.

ROUTE NO.	SECTION	COUNTY	TOTAL SHEETS	SHEET NO.
---	---	BOND	99	46
FED. ROAD DIST. NO. 7		ILLINOIS	FED. AID PROJECT	

Contract #97366 ***99-00036-00-BR

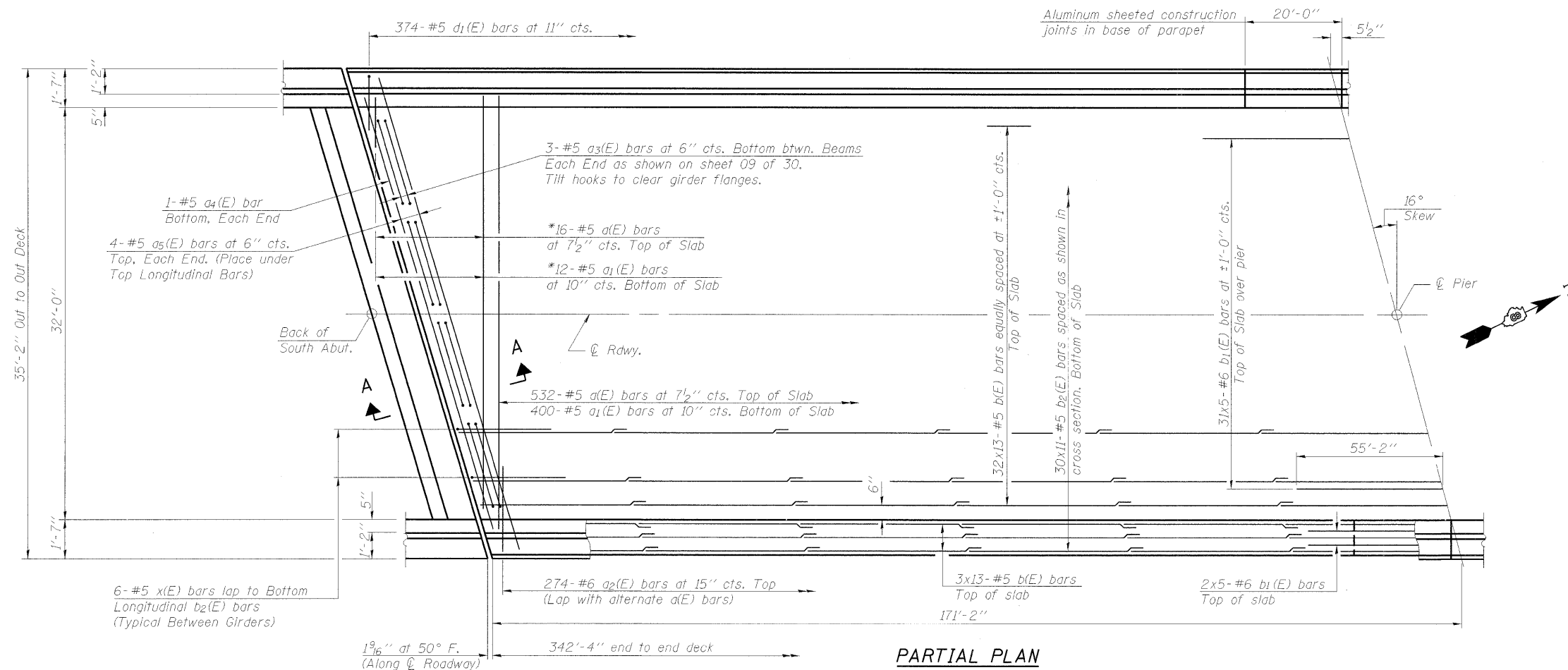

Notes:
See Sheet 09 of 30 for superstructure details and Bill of Material.
Bars indicated thus 30x11-#5 etc. indicates 30 lines of bars with 11 lengths per line.
See Sheet 09 of 30 for parapet reinforcement.
See Sheet 10 of 30 for Bridge Fence Railing Details.
Dimensions are based on a Rolled Rail Strip Seal Joint.
If the Contractor elects to use the Welded Rail Strip Seal Joint, deck dimensions may require adjustments to satisfy the details on Base Sheet EJ-SSJ.

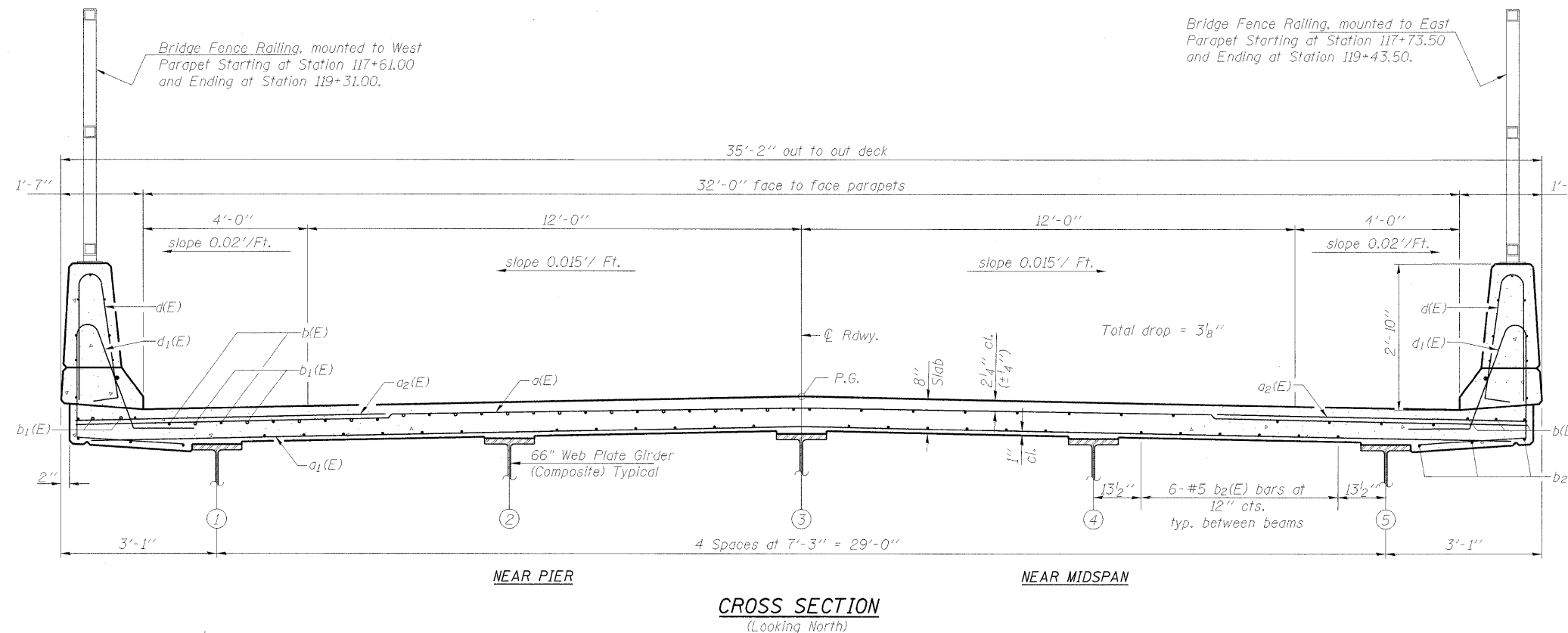

MIN. BAR LAPS
#5 Bar - 2'-2"
#6 Bar - 2'-7"

SUPERSTRUCTURE
ANDREWS DRIVE over
U.S. ROUTE 40 ; CSX RR and IL. WESTERN RR
SEC. 99-00036-00-BR
STR. NO. 003-6000
CITY of GREENVILLE
BOND COUNTY
STATION 117+73.00
PROFESSIONAL DESIGN FIRM LICENSE #184-001084
© Copyright Hanson Professional Services Inc. 2008

HANSON
Hanson Professional Services Inc.

JOB NO. 04S2012
DATE 12/10/08

LAYOUT: 03/07/08
 DRAWN: 03/07/08
 REVIEWED: 03/07/08
 MINN: 03/07/08
 12/23/2008
 I:\04 Jobs\04S2012\CADD\Struct\Sheet\Superstructure.dgn