

F.A.U. RTE.	SECTION	COUNTY	TOTAL SHEETS	SHEET NO.
8899	05-00026-01-RP	MADISON	81	35
FED. ROAD DIST. NO.	ILLINOIS	FED. AID PROJECT		
CONTRACT No. 97368				

14-2-15-36-00-000-022
N/F
LAWRENCE HRABUSTICKY
821 GLEN CROSSING RD.
(Bk 3782, Pg 1934)

14-2-15-36-00-000-021
N/F
FRANK D &
VIGINIA ANNE MCBRIDE
827 GLEN CROSSING RD.
(Bk 3664, Pg 1494)

14-1-15-36-00-000-024.018
N/F
FORREST & EVELYN BOOTH
9 PIONEER TRAIL
(Bk 4332, Pg 1337)

14-1-15-36-00-000-024.003
N/F
BILLY T DEW
832 GLEN CROSSING RD.
(Bk 3233, Pg 1546)

MATCH LINE STA. 39+80.00

MATCH LINE STA. 45+40.00

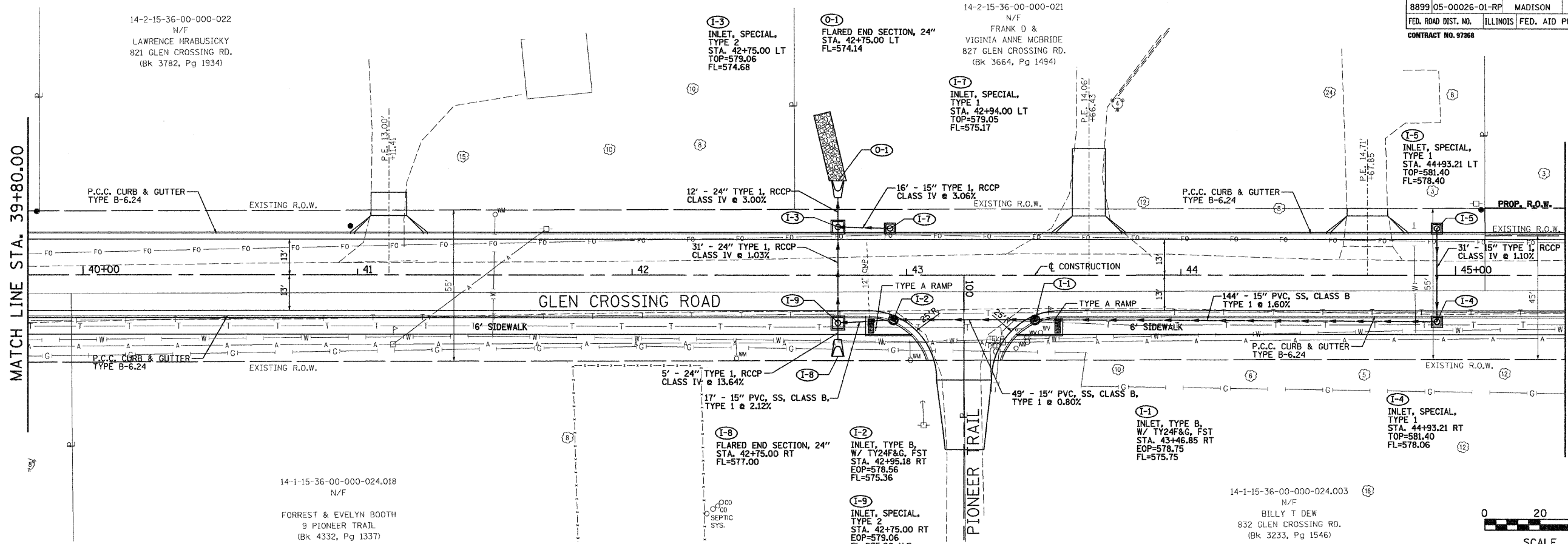

BY	DATE
SURVEYED	
PLOTTED	
NOTE BOOK	
TEMPLATE	
AREAS CHECKED	
NO.	

BY	DATE
ORIGINAL SURVEYED	
SURVEY PLOTTED	
NOTE BOOK	
TEMPLATE	

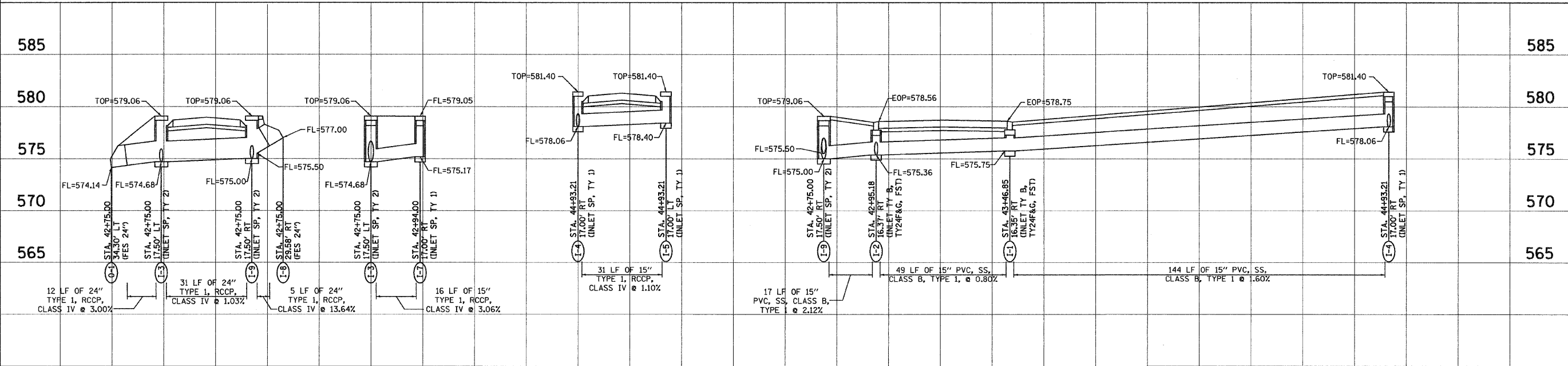

Juneau Associates, Inc. P.C.
CONSULTING ENGINEERS AND LAND SURVEYORS
2100 Stone Street, P.O. Box 1235
Springfield, Illinois 62702
Phone: (618) 837-1400 / (618) 482-0535
Fax: (618) 482-0541

DRAINAGE PLAN AND PROFILE
F.A.U. ROUTE 8899
GLEN CROSSING ROAD PHASE 2
GLEN CARBON, ILLINOIS
SECTION No. 05-00026-01-RP

REVISIONS			
NO.	DATE	BY	REMARKS

SCALE: 1 inch = 20 feet			
DSN. BY:	BFK	DATE:	4/29/08
DWN. BY:	JDH	DATE:	4/29/08
CHK'D:	BFK	DATE:	4/29/08
DWG. NO.	JOB NO. E070614B		DGN. NAME: DRAIN_02
			OF 81 SHTS