

BY	DATE
SURVEYED	
PLOTTED	
NOTE BOOK	
TEMPLATE	
AREAS CHECKED	
NO.	

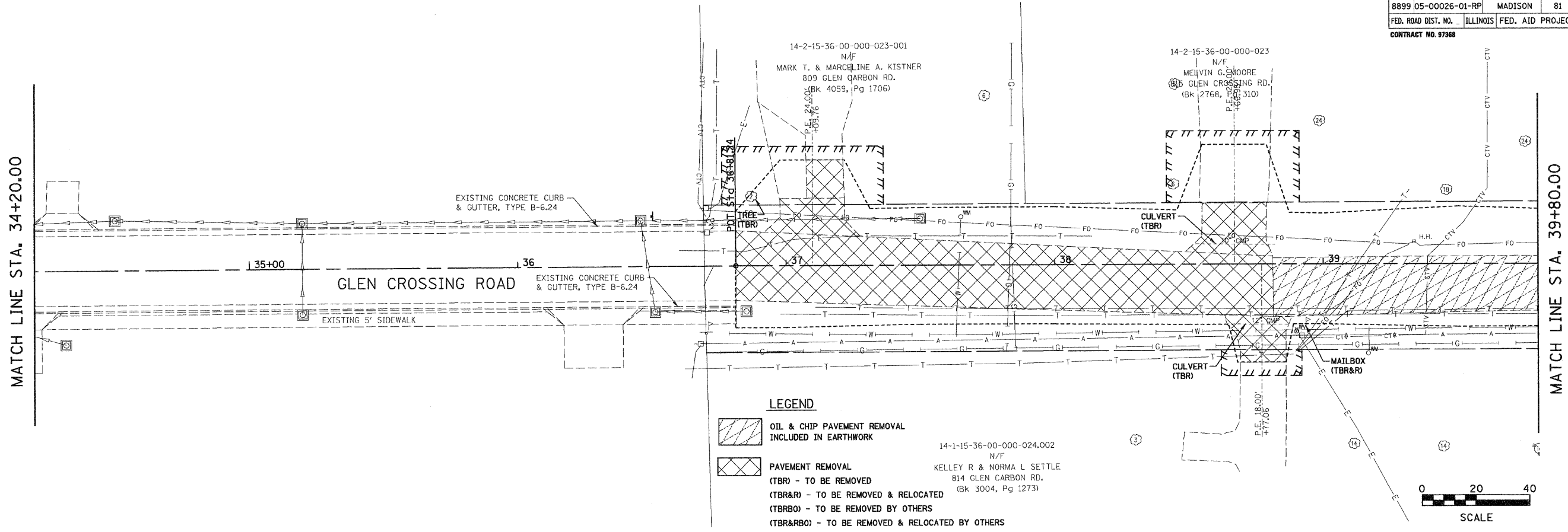

LEGEND

- OIL & CHIP PAVEMENT REMOVAL INCLUDED IN EARTHWORK
- PAVEMENT REMOVAL
- (TBR) - TO BE REMOVED
- (TBR&R) - TO BE REMOVED & RELOCATED
- (TBRBO) - TO BE REMOVED BY OTHERS
- (TBR&RBO) - TO BE REMOVED & RELOCATED BY OTHERS
- (TBA) - TO BE ADJUSTED

BY	DATE
ORIGINAL SURVEYED	
PLOTTED	
NOTE BOOK	
TEMPLATE	
AREAS CHECKED	
NO.	

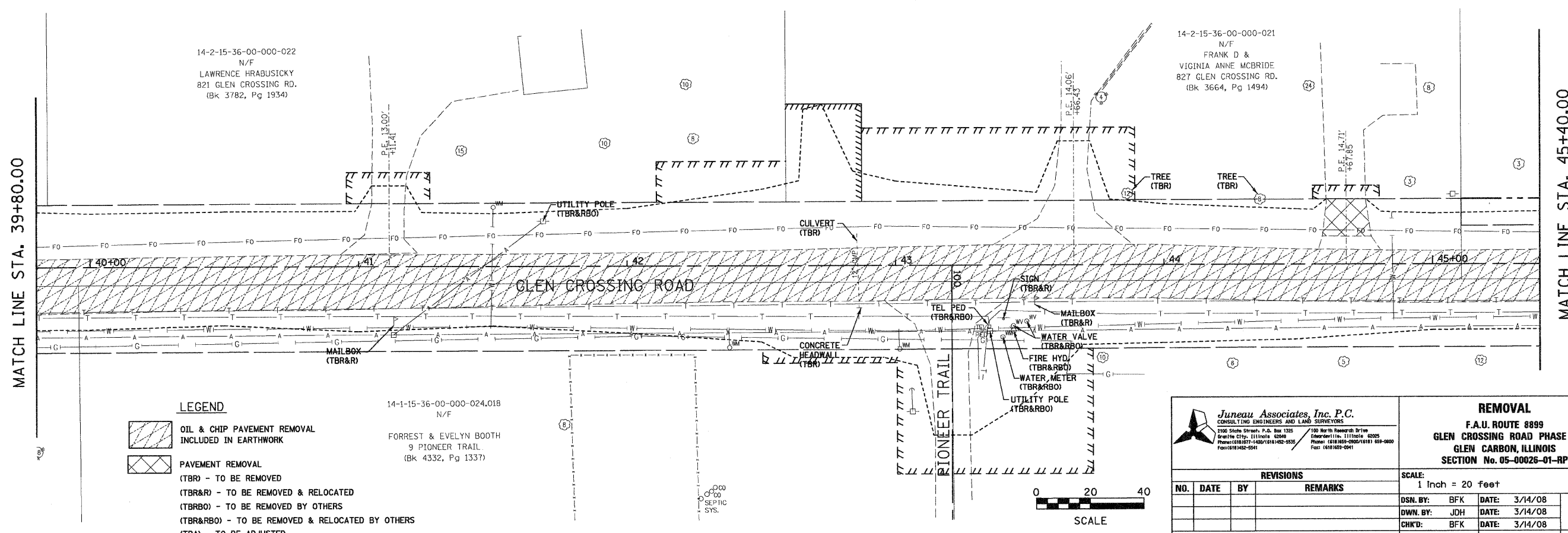

LEGEND

- OIL & CHIP PAVEMENT REMOVAL INCLUDED IN EARTHWORK
- PAVEMENT REMOVAL
- (TBR) - TO BE REMOVED
- (TBR&R) - TO BE REMOVED & RELOCATED
- (TBRBO) - TO BE REMOVED BY OTHERS
- (TBR&RBO) - TO BE REMOVED & RELOCATED BY OTHERS
- (TBA) - TO BE ADJUSTED

Juneau Associates, Inc. P.C.
CONSULTING ENGINEERS AND LAND SURVEYORS
2100 Sixth Street, P.O. Box 1325
O'Fallon, IL 62450
Phone: (618) 937-1400 / (618) 462-8528
Fax: (618) 462-8541

REMOVAL

F.A.U. ROUTE 8899
GLEN CROSSING ROAD PHASE 2
GLEN CARBON, ILLINOIS
SECTION No. 05-00026-01-RP

REVISIONS			
NO.	DATE	BY	REMARKS

SCALE: 1 Inch = 20 feet			
DSN. BY: BFK	DATE: 3/14/08	SHEET	
DWN. BY: JDH	DATE: 3/14/08	49	
CHK'D: BFK	DATE: 3/14/08		
DWG. NO.	JOB NO. E070614B	DGN. NAME: REM.01	OF 81 SHTS