

F.A.U. RTE.	SECTION	COUNTY	TOTAL SHEETS	SHEET NO.
8899 05-00026-01-RP	MADISON	ILLINOIS	81	50
FED. ROAD DIST. NO.		FED. AID PROJECT	CONTRACT NO. 97368	

BY	DATE
FINAL SURVEYED	
SURVEY PLOTTED	
NOTE BOOK TEMPLATE	
AREAS CHECKED	
NO.	

MATCH LINE STA. 45+40.00

MATCH LINE STA. 51+00.00

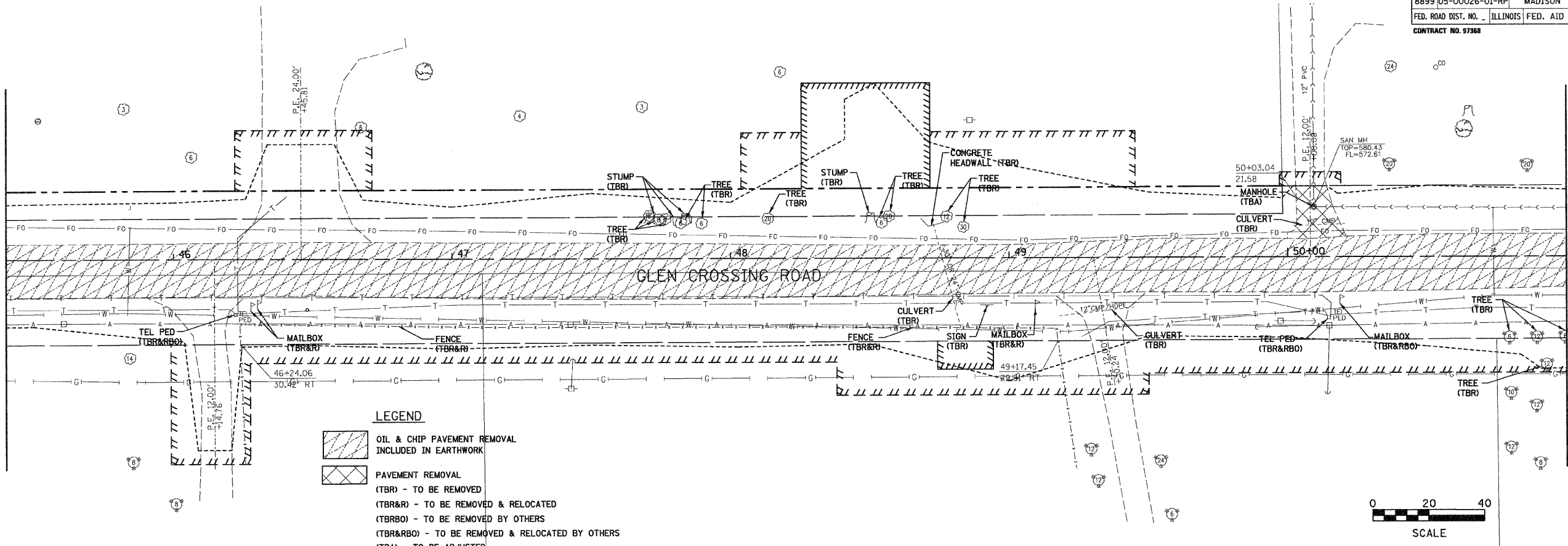

LEGEND

- OIL & CHIP PAVEMENT REMOVAL INCLUDED IN EARTHWORK
- PAVEMENT REMOVAL
- (TBR) - TO BE REMOVED
- (TBR&R) - TO BE REMOVED & RELOCATED
- (TBRBO) - TO BE REMOVED BY OTHERS
- (TBR&RBO) - TO BE REMOVED & RELOCATED BY OTHERS
- (TBA) - TO BE ADJUSTED

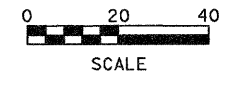

BY	DATE
ORIGINAL SURVEYED	
SURVEY PLOTTED	
NOTE BOOK TEMPLATE	
AREAS CHECKED	
NO.	

MATCH LINE STA. 51+00.00

MATCH LINE STA. 56+60.00

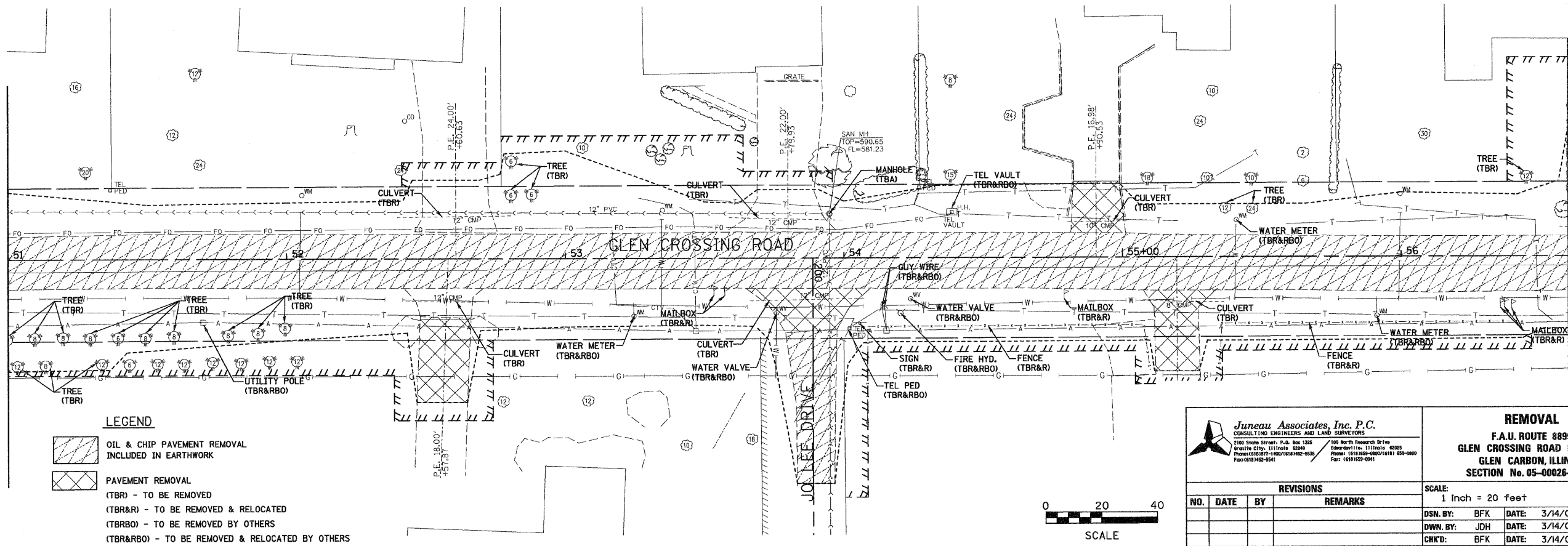

LEGEND

- OIL & CHIP PAVEMENT REMOVAL INCLUDED IN EARTHWORK
- PAVEMENT REMOVAL
- (TBR) - TO BE REMOVED
- (TBR&R) - TO BE REMOVED & RELOCATED
- (TBRBO) - TO BE REMOVED BY OTHERS
- (TBR&RBO) - TO BE REMOVED & RELOCATED BY OTHERS
- (TBA) - TO BE ADJUSTED

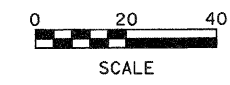

Juneau Associates, Inc. P.C.
 CONSULTING ENGINEERS AND LAND SURVEYORS
 2100 State Street, P.O. Box 1302
 Granite City, Illinois 62040
 Phone: (618) 939-4400 / (618) 939-0900
 Fax: (618) 939-0941

REMOVAL
 F.A.U. ROUTE 8899
 GLEN CROSSING ROAD PHASE 2
 GLEN CARBON, ILLINOIS
 SECTION No. 05-00026-01-RP

REVISIONS			
NO.	DATE	BY	REMARKS

SCALE: 1 Inch = 20 feet			
DSN. BY:	BFK	DATE:	3/14/08
DWN. BY:	JDH	DATE:	3/14/08
CHK'D:	BFK	DATE:	3/14/08
DWG. NO.	JOB NO. E070614B DGN. NAME: REM.02 OF 81 SHTS		