

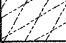

F.A.U. RTE.	SECTION	COUNTY	TOTAL SHEETS	SHEET NO.
8899	05-00026-01-RP	MADISON	81	52
FED. ROAD DIST. NO. ILLINOIS FED. AID PROJECT				
CONTRACT NO. 97388				

LEGEND

-  OIL & CHIP PAVEMENT REMOVAL INCLUDED IN EARTHWORK
-  PAVEMENT REMOVAL
- (TBR) - TO BE REMOVED
- (TBR&R) - TO BE REMOVED & RELOCATED
- (TBRBO) - TO BE REMOVED BY OTHERS
- (TBR&RBO) - TO BE REMOVED & RELOCATED BY OTHERS
- (TBA) - TO BE ADJUSTED

MATCH LINE STA. 67+80.00

MATCH LINE STA. 73+40.00

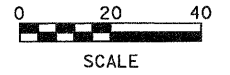
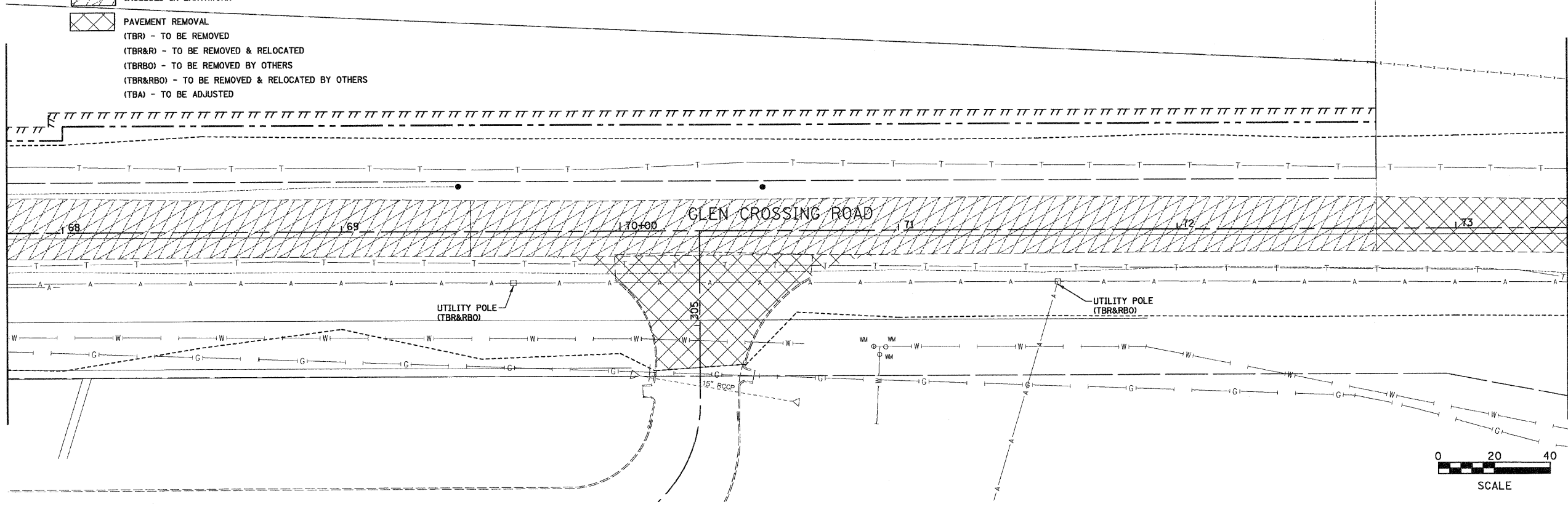

FINAL SURVEYED	BY	DATE
SURVEY PLOTTED		
NOTE BOOK TEMPLATE		
AREAS CHECKED		
NO.		

LEGEND

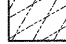
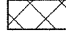
-  OIL & CHIP PAVEMENT REMOVAL INCLUDED IN EARTHWORK
-  PAVEMENT REMOVAL
- (TBR) - TO BE REMOVED
- (TBR&R) - TO BE REMOVED & RELOCATED
- (TBRBO) - TO BE REMOVED BY OTHERS
- (TBR&RBO) - TO BE REMOVED & RELOCATED BY OTHERS
- (TBA) - TO BE ADJUSTED

MATCH LINE STA. 73+40.00

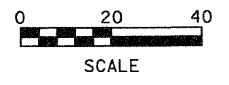
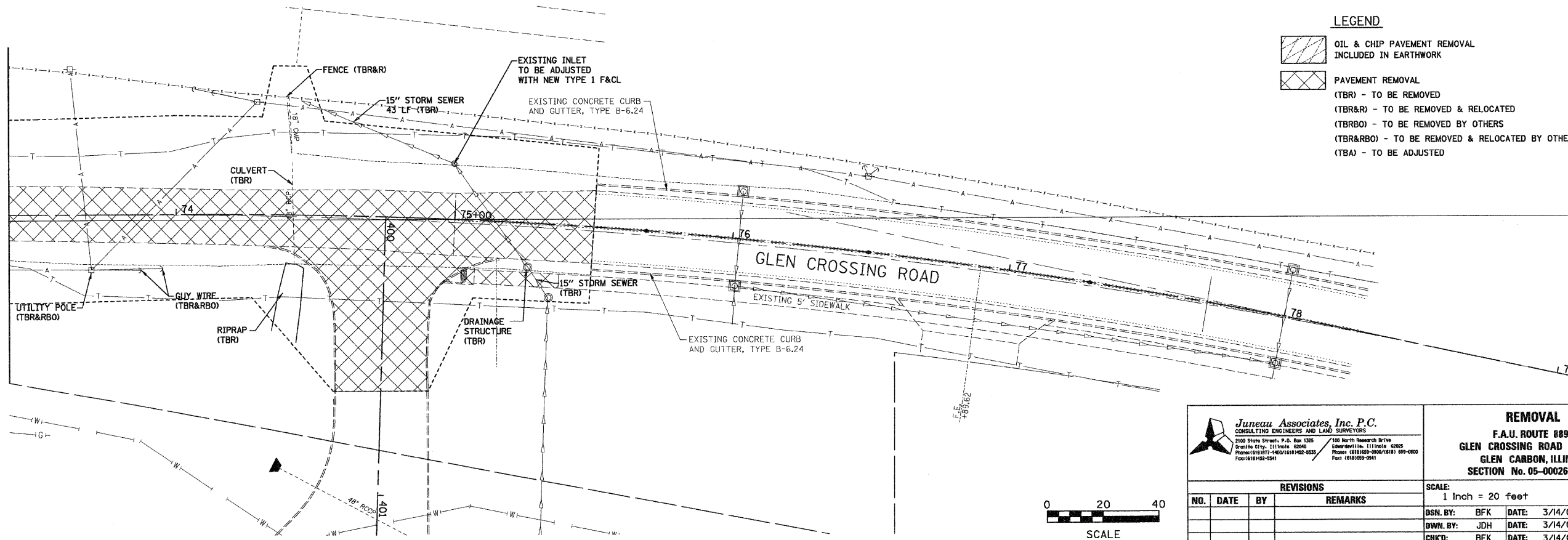

ORIGINAL SURVEYED	BY	DATE
SURVEY PLOTTED		
NOTE BOOK TEMPLATE		
AREAS CHECKED		
NO.		

Jureau Associates, Inc. P.C.
CONSULTING ENGINEERS AND LAND SURVEYORS
2105 Stone Street, P.O. Box 1325
Granite City, Illinois 62040
Phone: (618) 377-4400 / (618) 492-9535
Fax: (618) 492-2541

100 North Research Drive
Edwardsville, Illinois 62025
Phone: (618) 669-9500 / (618) 619-0800
Fax: (618) 669-0841

REMOVAL			
F.A.U. ROUTE 8899			
GLEN CROSSING ROAD PHASE 2			
GLEN CARBON, ILLINOIS			
SECTION No. 05-00026-01-RP			
SCALE:		1 Inch = 20 feet	
DSN. BY:	BFK	DATE:	3/14/08
DWN. BY:	JDH	DATE:	3/14/08
CHKD:	BFK	DATE:	3/14/08
DWG. NO.	JOB NO. E070614B		DGN. NAME: REM_04
			OF 81 SHTS

REVISIONS			
NO.	DATE	BY	REMARKS

52