

CA007

| REVISIONS | | |
|-----------|----|------|
| NUMBER | BY | DATE |
| | | |
| | | |
| | | |

0 1 2
 THIS BAR IS EQUAL TO 2"
 AT FULL SCALE (34X22).

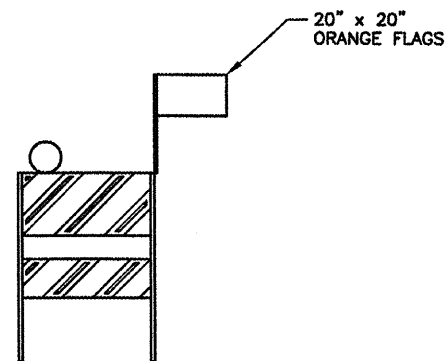

FLASHER BARRICADE DETAIL
 N.T.S.

FLASHER BARRICADE NOTES

1. FLASHERS TO BE BATTERY OPERATED. LENS TO BE RED AND BE ABLE TO ROTATE 90 DEGREES.
2. SANDBAGS TO BE PLACED ON EACH SUPPORT BRACE AS REQUIRED TO PREVENT DISPLACEMENT BY WIND, JET OR PROP BLAST.
3. NO SEPARATE PAYMENT WILL BE MADE FOR THIS ITEM. COSTS SHALL BE CONSIDERED INCIDENTAL TO THE PROJECT.
4. PLACE AT 20' INTERVALS.

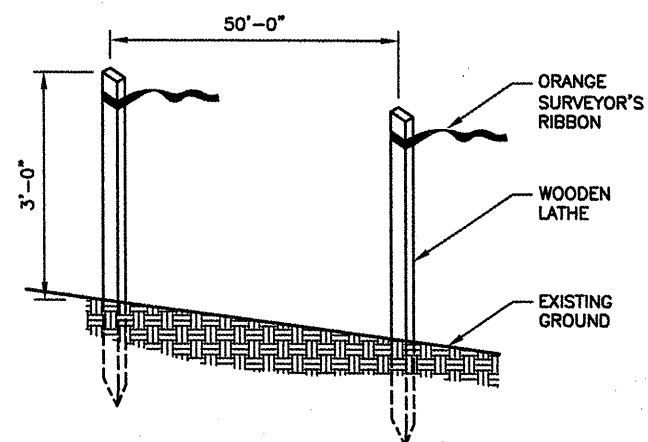

CONSTRUCTION SETBACK LINE DETAIL
 N.T.S.

CONTRACTOR ACCESS ROUTE NOTES

1. THE PROPOSED CONTRACTOR'S ACCESS ROUTE (EXISTING NORTHEAST PERIMETER ROAD) PAVEMENT STRUCTURE IS:
 - 3" BITUMINOUS SURFACE COURSE (PLACED 2005 AND 2008) - EXCELLENT CONDITION
 - 3" BITUMINOUS SURFACE COURSE (PLACED 1988)
 - 6" CRUSHED AGGREGATE BASE COURSE (PLACED 1988)
2. THE CONTRACTOR MAY USE THE EXISTING NORTHEAST PERIMETER ROAD FOR ACCESS IF HE FEELS THE PAVEMENT STRUCTURE IS SUFFICIENT TO SUPPORT HIS OPERATIONS WITHOUT DAMAGE OR DISTRESS.
3. IF THE CONTRACTOR ELECTS NOT TO USE THE EXISTING PERIMETER ROAD PAVEMENT, HE SHALL CONSTRUCT AN ACCESS ROUTE SUFFICIENT TO SUPPORT HIS OPERATIONS ON THE NORTH SIDE OF THE EXISTING PERIMETER ROAD.
4. ALL PAVEMENTS OR TURF AREAS UTILIZED BY THE CONTRACTOR FOR AN ACCESS ROUTE, STAGING, OR STORAGE SHALL BE REPAIRED AND RESTORED TO THEIR ORIGINAL CONDITION TO THE SATISFACTION OF THE AIRPORT. NO ADDITIONAL COMPENSATION TO PROTECT, REPAIR, OR RESTORE THESE AREAS SHALL BE MADE.



SPRINGFIELD AIRPORT AUTHORITY
 ABRAHAM LINCOLN CAPITAL AIRPORT
 SPRINGFIELD, ILLINOIS

WIDEN TAXIWAY G - PHASE 2

CONSTRUCTION ACTIVITY PLAN DETAILS

© Copyright CMT, Inc.

CMT
 CRANFORD, MERRY & TILLY, INC.
 CONSULTING ENGINEERS
 License No. 04-00683



DESIGN BY: CBG
 DRAWN BY: CMT
 CHECKED BY: *RW*
 APPROVED BY: *RW*
 DATE: 01/30/2009
 JOB No: 07035-09-00

IL PROJ. NO. SPI-3860
 AIP PROJ. NO. 3-17-0096-XX