

REVISIONS

NUMBER	BY	DATE

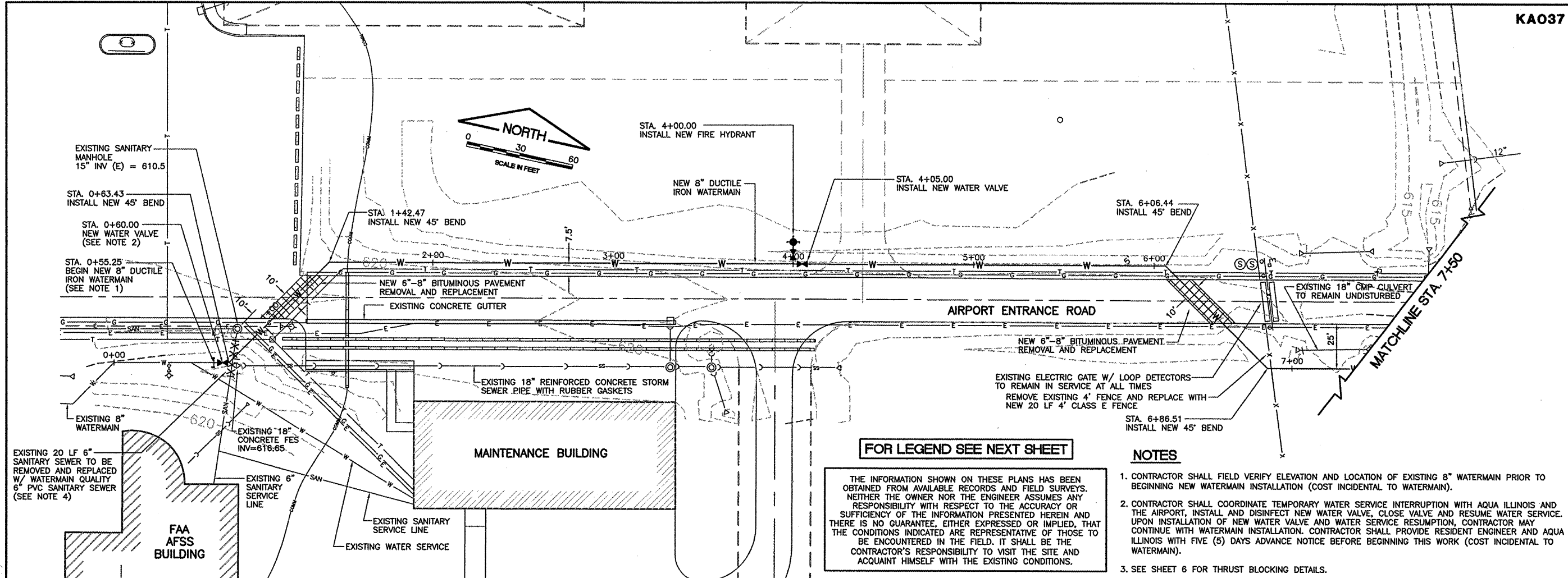
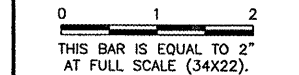

FOR LEGEND SEE NEXT SHEET

THE INFORMATION SHOWN ON THESE PLANS HAS BEEN OBTAINED FROM AVAILABLE RECORDS AND FIELD SURVEYS. NEITHER THE OWNER NOR THE ENGINEER ASSUMES ANY RESPONSIBILITY WITH RESPECT TO THE ACCURACY OR SUFFICIENCY OF THE INFORMATION PRESENTED HEREIN AND THERE IS NO GUARANTEE, EITHER EXPRESSED OR IMPLIED, THAT THE CONDITIONS INDICATED ARE REPRESENTATIVE OF THOSE TO BE ENCOUNTERED IN THE FIELD. IT SHALL BE THE CONTRACTOR'S RESPONSIBILITY TO VISIT THE SITE AND ACQUAINT HIMSELF WITH THE EXISTING CONDITIONS.

NOTES

- CONTRACTOR SHALL FIELD VERIFY ELEVATION AND LOCATION OF EXISTING 8" WATERMAIN PRIOR TO BEGINNING NEW WATERMAIN INSTALLATION (COST INCIDENTAL TO WATERMAIN).
- CONTRACTOR SHALL COORDINATE TEMPORARY WATER SERVICE INTERRUPTION WITH AQUA ILLINOIS AND THE AIRPORT, INSTALL AND DISINFECT NEW WATER VALVE, CLOSE VALVE AND RESUME WATER SERVICE. UPON INSTALLATION OF NEW WATER VALVE AND WATER SERVICE RESUMPTION, CONTRACTOR MAY CONTINUE WITH WATERMAIN INSTALLATION. CONTRACTOR SHALL PROVIDE RESIDENT ENGINEER AND AQUA ILLINOIS WITH FIVE (5) DAYS ADVANCE NOTICE BEFORE BEGINNING THIS WORK (COST INCIDENTAL TO WATERMAIN).
- SEE SHEET 6 FOR THRUST BLOCKING DETAILS.
- CONTRACTOR SHALL FIELD VERIFY LOCATION, SIZE, MATERIAL AND INVERTS OF EXISTING SANITARY SEWER (COST INCIDENTAL TO WATERMAIN). IF EXISTING SANITARY SEWER IS 18" OR GREATER BELOW NEW WATERMAIN OR IF VERTICAL BENDS AS NECESSARY WILL PROVIDE AT LEAST 18" OF VERTICAL SEPARATION BETWEEN EXISTING SANITARY SEWER AND NEW WATERMAIN, SANITARY SEWER REMOVAL AND REPLACEMENT WILL NOT BE REQUIRED.

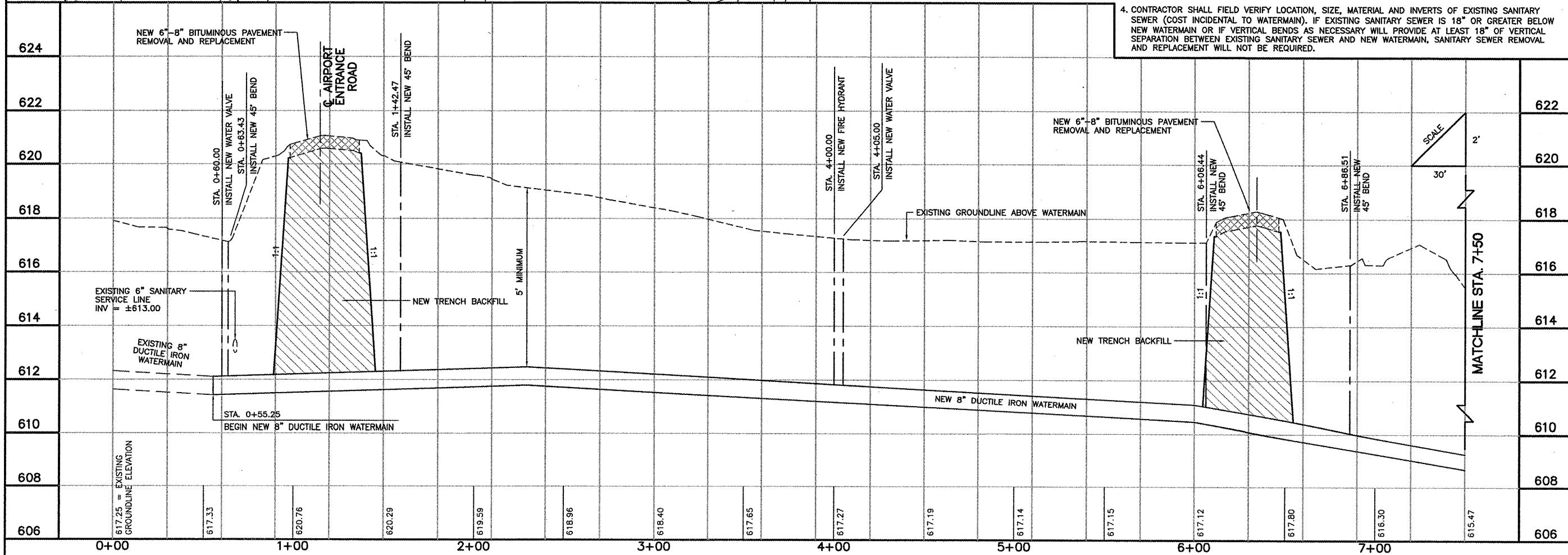

GREATER KANKAKEE AIRPORT  
 KANKAKEE, ILLINOIS  
 CONSTRUCT SOUTHEAST QUADRANT FIRE PROTECTION  
 PLAN AND PROFILE  
 STA. 0+00 TO STA. 7+50

© Copyright CMT, Inc.  
**CMT**  
 CRAWFORD, MURPHY & TILLY, INC.  
 CONSULTING ENGINEERS  
 License No. 841-000513

DESIGN BY:	CAL
DRAWN BY:	JRO
CHECKED BY:	CAL
APPROVED BY:	CAL
DATE:	01/26/07
JOB No:	06075-02
IL PROJECT: IKK-3661 A.I.P. PROJECT: 3-17-0057-813	
SHEET 4 OF 7 SHEETS	