

| REVISIONS |    |      |
|-----------|----|------|
| NUMBER    | BY | DATE |
|           |    |      |
|           |    |      |
|           |    |      |

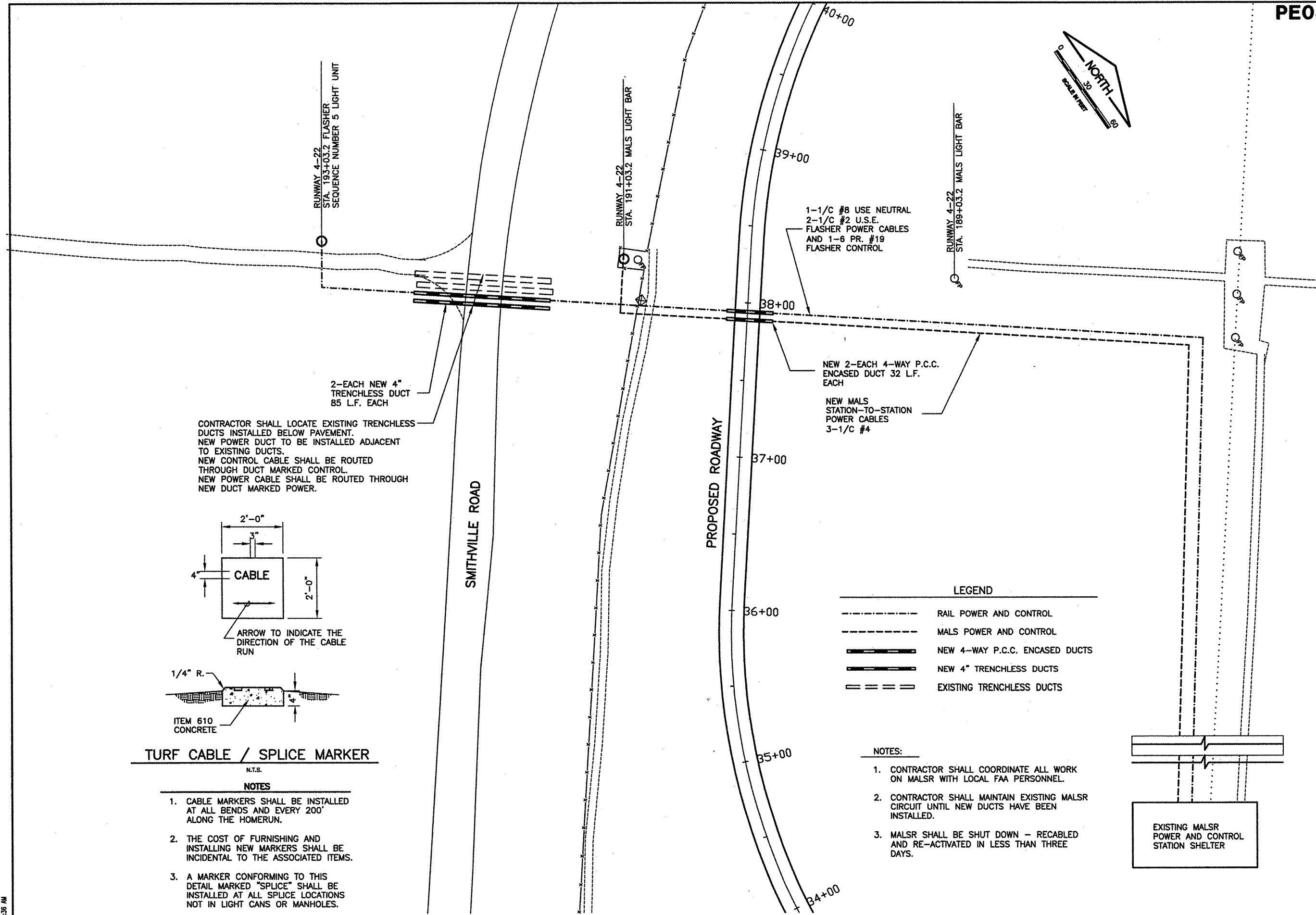

CONTRACTOR SHALL LOCATE EXISTING TRENCHLESS DUCTS INSTALLED BELOW PAVEMENT. NEW POWER DUCT TO BE INSTALLED ADJACENT TO EXISTING DUCTS. NEW CONTROL CABLE SHALL BE ROUTED THROUGH DUCT MARKED CONTROL. NEW POWER CABLE SHALL BE ROUTED THROUGH NEW DUCT MARKED POWER.

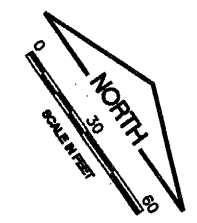
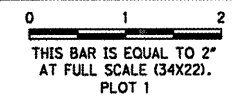
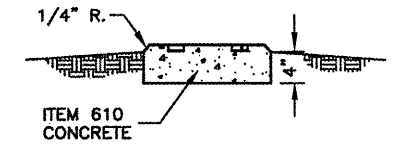
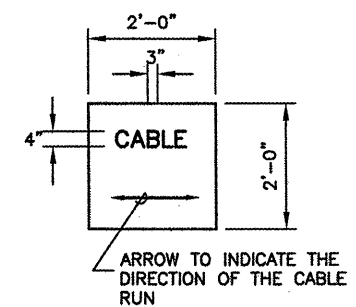

**TURF CABLE / SPLICE MARKER**  
N.T.S.

- NOTES**
1. CABLE MARKERS SHALL BE INSTALLED AT ALL BENDS AND EVERY 200' ALONG THE HOMERUN.
  2. THE COST OF FURNISHING AND INSTALLING NEW MARKERS SHALL BE INCIDENTAL TO THE ASSOCIATED ITEMS.
  3. A MARKER CONFORMING TO THIS DETAIL MARKED "SPLICE" SHALL BE INSTALLED AT ALL SPLICE LOCATIONS NOT IN LIGHT CANS OR MANHOLES.

1-1/C #8 USE NEUTRAL  
2-1/C #2 U.S.E.  
FLASHER POWER CABLES  
AND 1-6 PR. #19  
FLASHER CONTROL

NEW 2-EACH 4-WAY P.C.C.  
ENCASED DUCT 32 L.F.  
EACH

NEW MALS  
STATION-TO-STATION  
POWER CABLES  
3-1/C #4

**LEGEND**

|  |                                |
|--|--------------------------------|
|  | RAIL POWER AND CONTROL         |
|  | MALS POWER AND CONTROL         |
|  | NEW 4-WAY P.C.C. ENCASED DUCTS |
|  | NEW 4" TRENCHLESS DUCTS        |
|  | EXISTING TRENCHLESS DUCTS      |

- NOTES:**
1. CONTRACTOR SHALL COORDINATE ALL WORK ON MALS WITH LOCAL FAA PERSONNEL.
  2. CONTRACTOR SHALL MAINTAIN EXISTING MALS CIRCUIT UNTIL NEW DUCTS HAVE BEEN INSTALLED.
  3. MALS SHALL BE SHUT DOWN - RECABLED AND RE-ACTIVATED IN LESS THAN THREE DAYS.

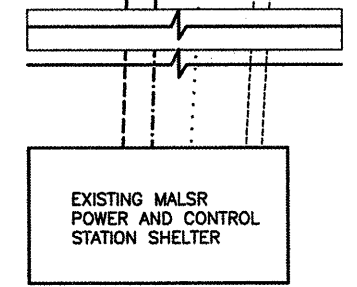

**GENERAL WAYNE A. DOWNING**  
**PEORIA INTERNATIONAL AIRPORT**  
**CONSTRUCT NEW PERIMETER ROAD AND PERIMETER FENCE - PROJECT 3**

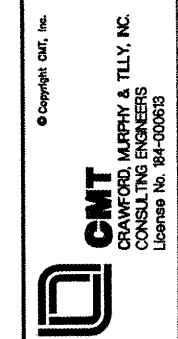

**PROJECT: PIA-3865**  
**AIP PROJ 3-17-0080-XX**

|              |              |
|--------------|--------------|
| FILE:        | MALS CABLING |
| DESIGN BY:   | TJH/SMS      |
| DRAWN BY:    | CMT          |
| CHECKED BY:  | CET          |
| APPROVED BY: | CET          |
| DATE:        | 02-13-2009   |
| JOB No:      | 07061-04-00  |

**MALS CABLING**

K:\Peoria\070610400\Draw\Sheets\1\_West\_South\_Fence\Phase 3 Sheets  
FILE: MALS CABLING.dwg  
DATE: 2/12/2009 8:36 AM