

PE089

REVISIONS

| NUMBER | BY | DATE |
|--------|----|------|
|        |    |      |
|        |    |      |
|        |    |      |

0 1 2  
 THIS BAR IS EQUAL TO 2'  
 AT FULL SCALE (34X22).  
 PLOT 1

LEGEND

- X ----- EXISTING CHAIN LINK FENCE TO BE REMOVED
- XX ----- EXISTING CHAIN LINK FENCE TO REMAIN
- XX ----- NEW 10' CHAIN LINK FENCE

NOTES:

1. WHERE NEW FENCE IS TO BE INSTALLED ALONG THE SAME LAYOUT OF EXISTING FENCE IT SHALL BE OFFSET 1' TOWARD THE LANDSIDE, UNLESS OTHERWISE NOTED.
2. WHEN CONNECTING TO EXISTING FENCE, THE CONTRACTOR MUST GUARD THE FENCE SO THAT NO UNAUTHORIZED ACCESS IS ALLOWED.

EXISTING FENCE TO BE REMOVED  
 AND REPLACED IN SAME ALIGNMENT  
 WITH NEW 10' CHAIN LINK FENCE

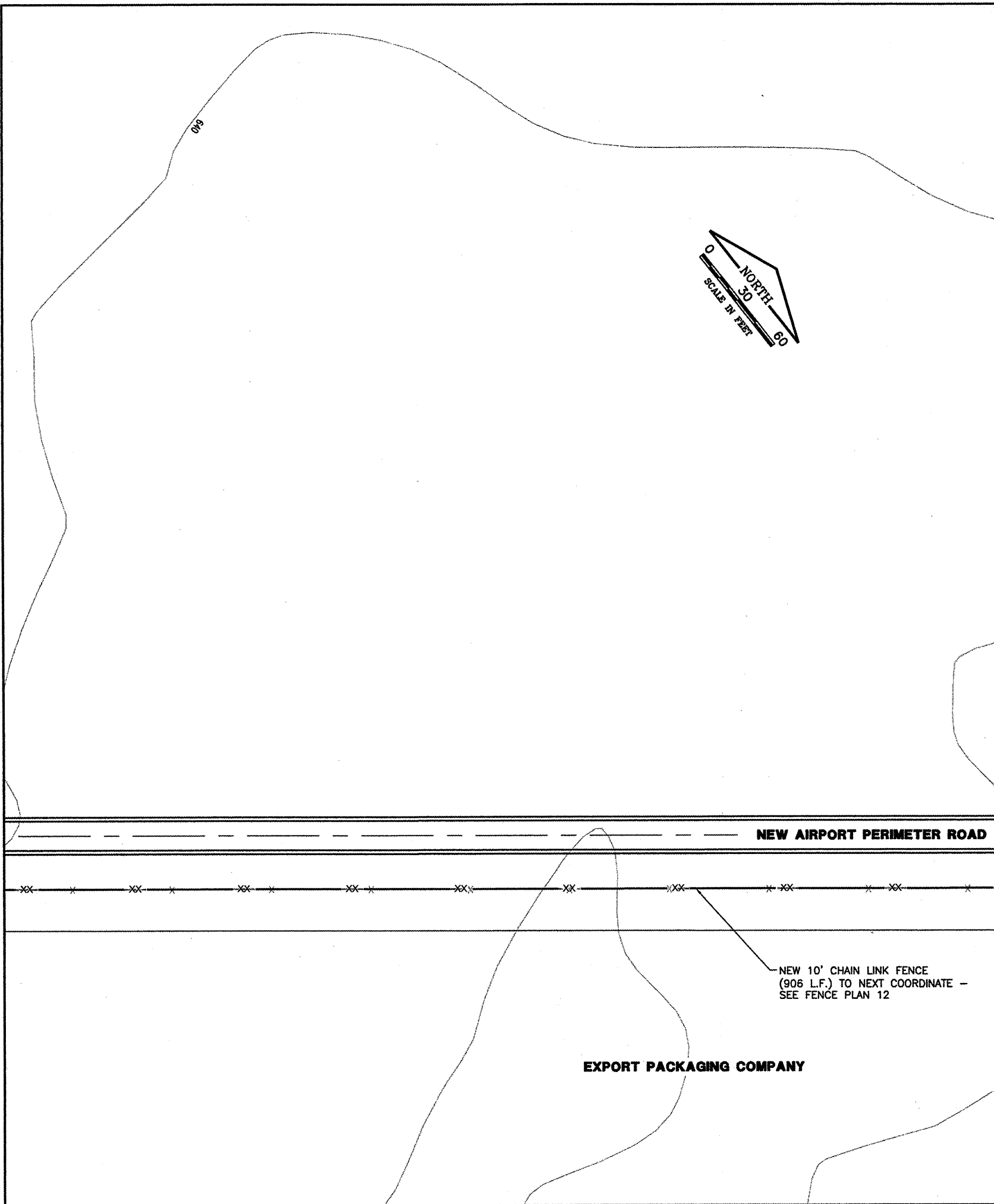
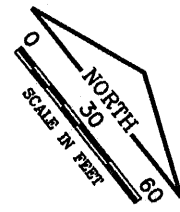

CONSTRUCT NEW PERIMETER ROAD AND  
 PERIMETER FENCE - PROJECT 3

GENERAL WAYNE A. DOWNING  
 PEORIA INTERNATIONAL AIRPORT

© Copyright CMT, Inc.  
**CMT**  
 CRAWFORD, MURPHY & TILLY, INC.  
 CONSULTING ENGINEERS  
 License No. 84-00613

**IL PROJECT: PIA-3865**  
**AIP PROJ: 3-17-0080-XX**

|              |             |
|--------------|-------------|
| FILE:        |             |
| DESIGN BY:   | TJH/SMS     |
| DRAWN BY:    | CMT         |
| CHECKED BY:  | CET         |
| APPROVED BY: | CET         |
| DATE:        | 02-13-2009  |
| JOB No:      | 07061-04-00 |

**SOUTH FENCE PLAN**  
**SHEET 5 OF 10**

K:\Peoria\070610400\Draw\Sheets\1\_West\_South\_Fence\Phase 3 Sheets  
 FILE: FENCE\_PLAN11.dwg  
 DATE: 2/12/2009 10:04 AM