

STATE OF ILLINOIS
DEPARTMENT OF TRANSPORTATION
DIVISION OF HIGHWAYS
PROPOSED
HIGHWAY PLANS
VARIOUS ROUTES
D4 CULVERT REPAIR 2015
CONTRACT MAINTENANCE
VARIOUS COUNTIES

F.A. RTE.	SECTION	COUNTY	TOTAL SHEETS	SHEET NO.
VAR	VARIOUS	VARIOUS	17	1
		ILLINOIS	CONTRACT NO. 68B91	

INDEX OF SHEETS

1. COVER SHEET
2. GENERAL NOTES, COMMITMENTS, JOB SPECIFIC NOTES
3. SUMMARY OF QUANTITIES
4. SCHEDULES OF QUANTITIES
- 5.-12. TYPICAL SECTIONS
13. I-74 LINE DIAGRAM KNOX COUNTY
14. I-155 LINE DIAGRAM TAZEWELL COUNTY
15. IL 116/US 24/US 150 LINE DIAGRAM TAZEWELL COUNTY
16. IL 251 LINE DIAGRAM WOODFORD COUNTY
17. IL 251 LINE DIAGRAM MARSHALL COUNTY

HIGHWAY STANDARDS

701001-02	701421-07
701101-04	701428
701201-04	701456-03
701400-08	701901-04
701406-09	

ADT	MU	SU
I-74 (2013) Knox Co		
17,300	30.92%	4.96%
I-155 (2013) Tazewell Co		
17,400	8.62%	4.85%
IL 116 (2009) Tazewell Co		
2,250	1.78%	3.11%
US 150 (2013) Tazewell Co		
28,900	4.15%	5.88%
US 24 (2013) Tazewell Co		
25,300	1.88%	1.68%
IL 251 (2013) Woodford Co		
1,400	8.33%	10%
IL 251 (2013) Woodford Co		
1,100	7.27%	4.33%

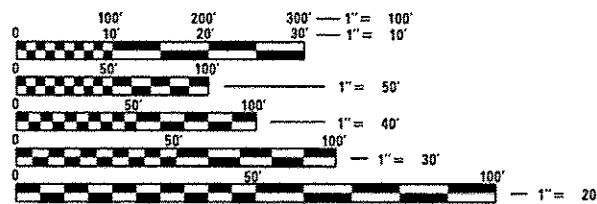

FULL SIZE PLANS HAVE BEEN PREPARED USING STANDARD ENGINEERING SCALES. REDUCED SIZED PLANS WILL NOT CONFORM TO STANDARD SCALES. IN MAKING MEASUREMENTS ON REDUCED PLANS, THE ABOVE SCALES MAY BE USED.

J.U.L.I.E.
 JOINT UTILITY LOCATION INFORMATION FOR EXCAVATION
 1-800-892-0123
 OR 811

PROJECT ENGINEER CHRISTOPHER MAUSHARD (309)671-3453
PROJECT MANAGER MIKE MOHAMED (309)671-3462
CONTRACT NO. 68B91
CATALOG NO. 035127-00D

C-94-090-14

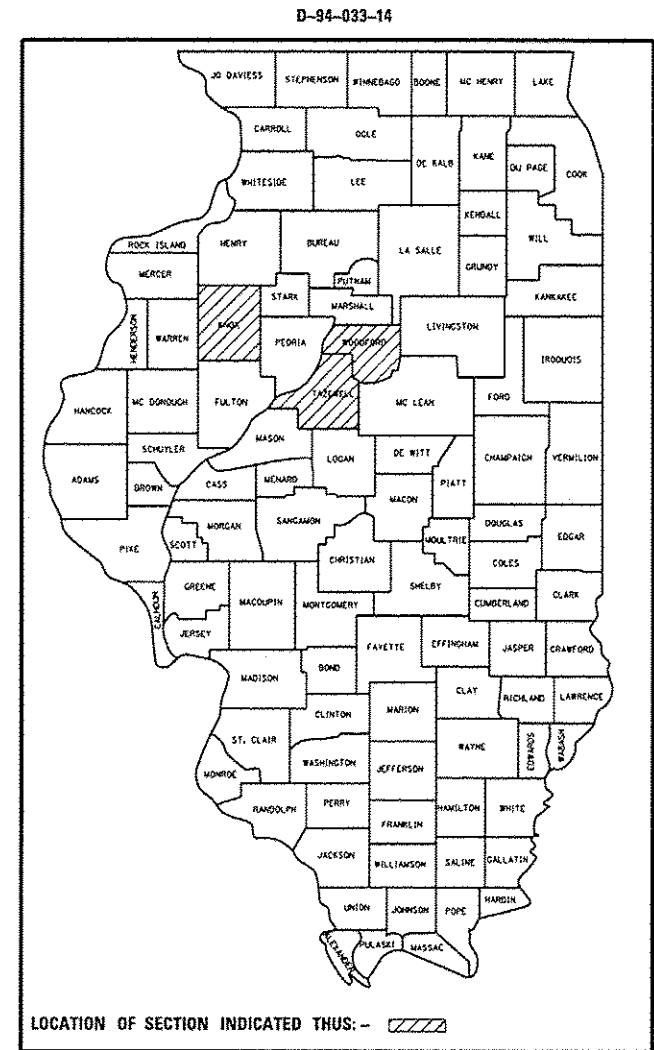
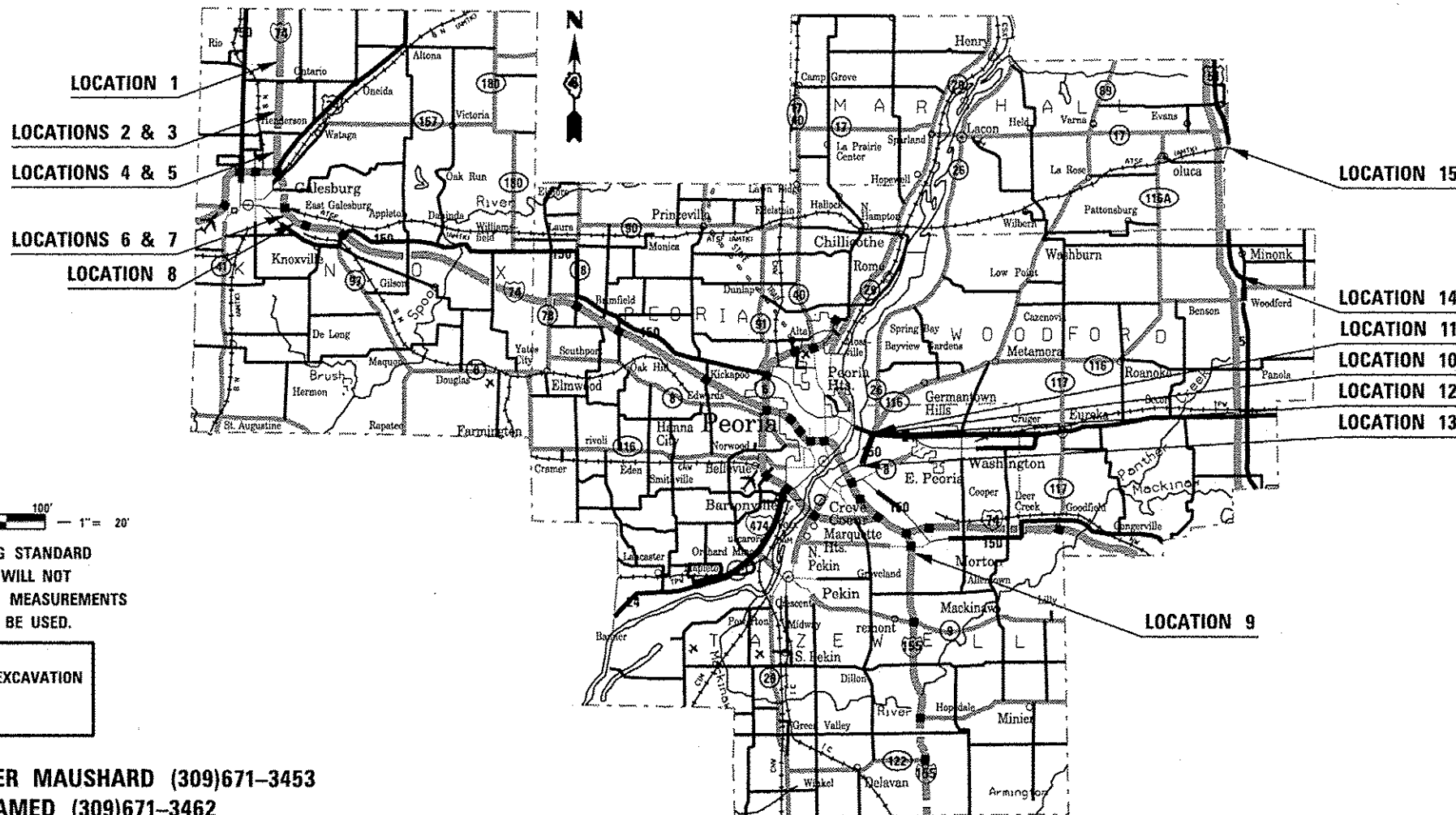

STATE OF ILLINOIS
 DEPARTMENT OF TRANSPORTATION
 DIVISION OF HIGHWAYS

SUBMITTED Oct 31 20 14
Kenil A. Grantham
 DEPUTY DIRECTOR OF HIGHWAYS, REGION ENGINEER

Jan 30 20 15
Jan J. Baranzelli PE
 ENGINEER OF DESIGN AND ENVIRONMENT

Jan 30 20 15
Omer Osman PE
 DIRECTOR OF HIGHWAYS, CHIEF ENGINEER

**PRINTED BY THE AUTHORITY
 OF THE STATE OF ILLINOIS**

GROSS LENGTH = N/A
 NET LENGTH = N/A

COMMITMENTS

COMMITMENTS ARE NOT TO BE ALTERED WITHOUT THE WRITTEN APPROVAL OF ALL PARTIES TO WHICH THE COMMITMENT WAS MADE.

NO COMMITMENTS HAVE BEEN MADE ON THIS PROJECT

GENERAL NOTES

ORDERING LENGTH CONFIRMATION – DRAINAGE ITEMS

THE CONTRACTOR SHALL CONSULT WITH THE ENGINEER IN REGARD TO THE EXACT LENGTH OF BOX/PIPE CULVERTS, STORM SEWERS, AND/OR PIPE DRAINS REQUIRED PRIOR TO ORDERING THESE ITEMS.

JOB SPECIFIC NOTES

TRAFFIC CONTROL AND PROTECTION – LANE CLOSURE RESTRICTION

LOCATION 11 (IL 116) AND LOCATION 13 (US 150 WB LANES) – ALL TRAFFIC CONTROL DEVICES MUST BE REMOVED AND ALL LANES OPEN TO TRAFFIC BY 3:30 PM.

LOCATION 13 (US 150 EB LANES) – NO WORK MUST COMMENCE PRIOR TO 8:30 AM.

FILE NAME =	USER NAME = johnsonv	DESIGNED -	REVISED -	STATE OF ILLINOIS DEPARTMENT OF TRANSPORTATION	COMMITMENTS, GENERAL NOTES, JOB SPECIFIC NOTES	F.A. RTE.	SECTION	COUNTY	TOTAL SHEETS	SHEET NO.
S:\GEN\DRAW\ST08\PLNS\SDUP09-NEW\Acti	Contracts\68891 - Pipe Culvert Liners\6889	DRAWN t Lining.dgn	REVISED -			VAR.	VARIOUS	VARIOUS	17	2
	PLDT SCALE = 100.0000' / in.	CHECKED -	REVISED -			CONTRACT NO. 68891				
Default	PLDT DATE = 10/29/2014	DATE -	REVISED -			ILLINOIS FED. AID PROJECT				
					SCALE:	SHEET 1 OF 1 SHEETS		STA.	TO STA.	

SUMMARY OF QUANTITIES

CODE NO.	PAY ITEM	UNIT	TOTAL QUANTITY	0040	0040	0040	0040
				KNOX CO 100%STATE	TAZEWELL CO 100%STATE	WOODFORD CO 100%STATE	MARSHALL CO 100%STATE
67100100	MOBILIZATION	L SUM	1	0.5	0.3	0.1	0.1
70100310	TRAFFIC CONTROL AND PROTECTION, STANDARD 701421	L SUM	1	0.6	0.4		
70100450	TRAFFIC CONTROL AND PROTECTION, STANDARD 701201	L SUM	1			1	
70100700	TRAFFIC CONTROL AND PROTECTION, STANDARD 701406	L SUM	1	1			
70100825	TRAFFIC CONTROL AND PROTECTION, STANDARD 701456	L SUM	1		1		
X0326662	CURED-IN-PLACE PIPE LINER, 24"	FOOT	650	110	480	60	
X0326663	CURED-IN-PLACE PIPE LINER, 30"	FOOT	600		600		
X0326664	CURED-IN-PLACE PIPE LINER, 36"	FOOT	895	684			211
X0327789	CURED-IN-PLACE PIPE LINER, 60"	FOOT	60		60		
X7010410	SPEED DISPLAY TRAILER	CAL MO	1	1			
Z0048665	RAILROAD PROTECTIVE LIABILITY INSURANCE	L SUM	1				1

10

TABULATION OF CURED-IN-PLACE PIPE LINER QUANTITIES								
LOCATION	LOCATION NO.	CULVERT TYPE	CULVERT SIZE	FILL HEIGHT	CURED-IN-PLACE PIPE LINER, 24"	CURED-IN-PLACE PIPE LINER, 30"	CURED-IN-PLACE PIPE LINER, 36"	CURED-IN-PLACE PIPE LINER, 60"
					FT	FT	FT	FT
I-74 KNOX COUNTY								
STA. 289+69	1	CMP	36	5.1			96	
STA. 26+45	2	CMP	36	12.5			108	
STA. 26+45	3	CMP	24	24.5	110			
STA. 132+45	4	CMP	36	5.5			87	
STA. 132+45	5	CMP	36	5.5			89	
STA. 374+60	6	CMP	36	5.5			96	
STA. 375+36	7	CMP	36	5.5			100	
STA. 426+85	8	CMP	36	7.1			108	
KNOX CO SUB-TOTAL:					110		684	
I-155 TAZEWELL COUNTY								
STA. 73+00	9	TRIPLE CMP	30	5.1		600		
IL 116 TAZEWELL COUNTY								
STA. 0+600	10	CMP	24	2.0	200			
STA. 9+199	11	CMP	60	2.5			60	
US 24 TAZEWELL COUNTY								
STA. 330+00	12	CMP	24	1.7	130			
US 150 TAZEWELL COUNTY								
STA. 84+00	13	CMP	24	13.3	150			
TAZEWELL CO SUB-TOTAL:					480	600		60
IL 251 WOODFORD COUNTY								
STA. 115+98	14	CMP	24	4.2	60			
WOODFORD CO SUB-TOTAL:					60			
IL 251 MARSHALL COUNTY								
STA. 364+09.50	15	CMP	36	6.5			211	
MARSHALL CO SUB-TOTAL:								
TOTAL					650	600	895	60

TRAFFIC CONTROL & PROTECTION STANDARDS				
LOCATION	STD. 701201	STD. 701406	STD. 701421	STD. 701456
	L SUM	L SUM	L SUM	L SUM
KNOX COUNTY		1	0.6	
TAZEWELL COUNTY			0.4	1
WOODFORD COUNTY	0.5			
MARSHALL COUNTY	0.5			
TOTAL				
	1	1	1	1

RAILROAD PROTECTIVE LIABILITY INSURANCE	
LOCATION	L SUM
MARSHALL COUNTY	1
TOTAL	
	1

MOBILIZATION	
LOCATION	L SUM
KNOX COUNTY	0.5
TAZEWELL COUNTY	0.3
WOODFORD COUNTY	0.1
MARSHALL COUNTY	0.1
TOTAL	
	1

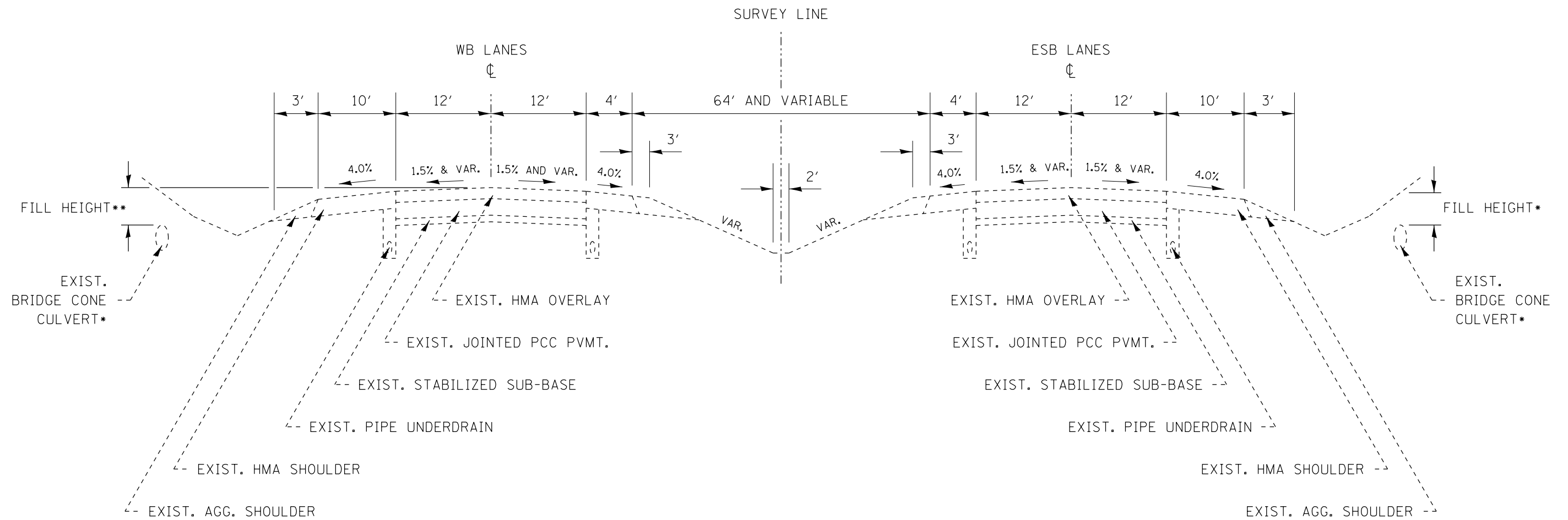

I-74 TYPICAL SECTION

LOCATIONS 1 - 8

NOTES:

*PLEASE REFER TO THE LINE DIAGRAM FOR CULVERT LOCATIONS, SIZES AND FILL HEIGHTS

**FILL HEIGHT IS MEASURED FROM CROWN OF ROAD TO TOP OF CULVERT FOR CROSS ROAD STRUCTURES; FROM TOP OF EMBANKMENT TO TOP OF CULVERT FOR BRIDGE CONE CULVERTS.

FILE NAME = 68B91 - Culvert Lining.dgn	USER NAME = aubreys	DESIGNED -	REVISED -	STATE OF ILLINOIS DEPARTMENT OF TRANSPORTATION	TYPICAL SECTIONS			F.A. RTE.	SECTION	COUNTY	TOTAL SHEETS	SHEET NO.
Default	PLOT SCALE = 100.0000' / in.	DRAWN -	REVISED -					VAR.	VARIOUS	VARIOUS	17	5
	PLOT DATE = 10/31/2014	CHECKED -	REVISED -		SCALE: SHEET 1 OF 8 SHEETS STA. TO STA.			CONTRACT NO. 68B91				
		DATE -	REVISED -		ILLINOIS FED. AID PROJECT							

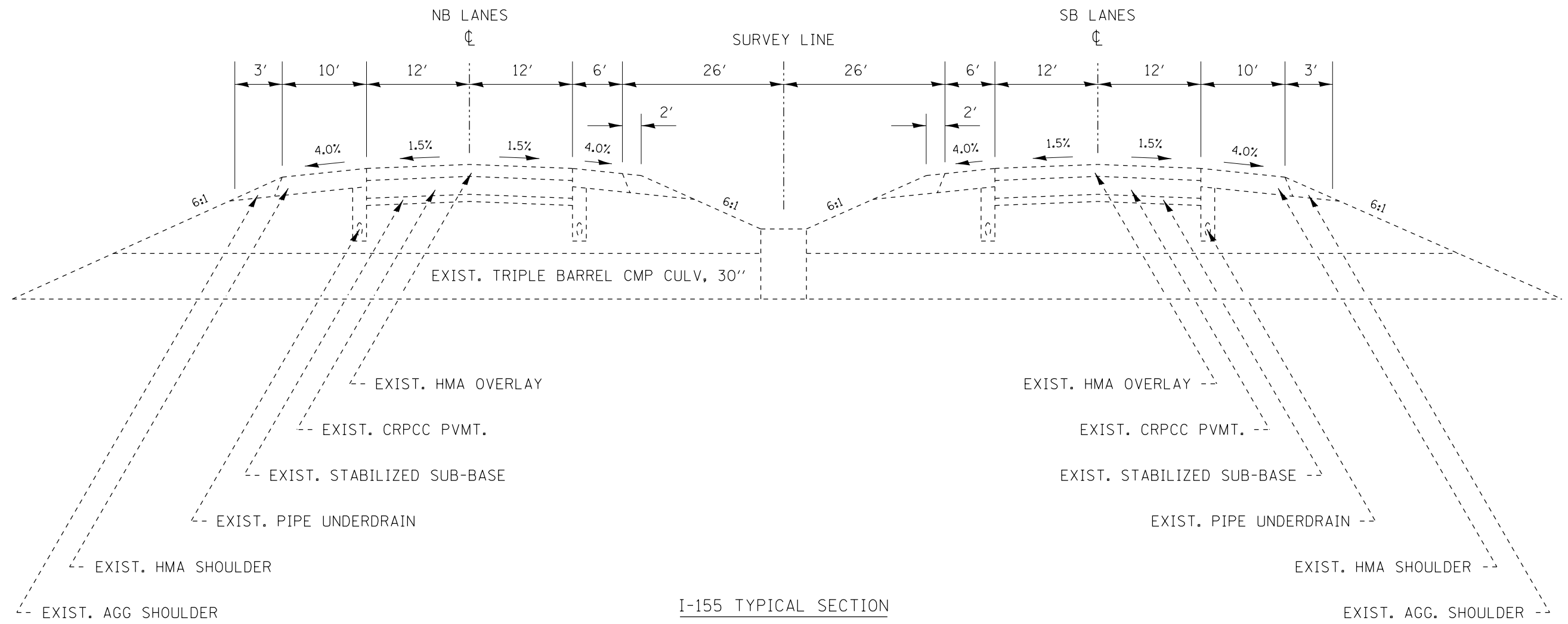

I-155 TYPICAL SECTION

LOCATION 9

FILE NAME = 68B91 - Culvert Lining.dgn	USER NAME = aubreygs	DESIGNED -	REVISED -	STATE OF ILLINOIS DEPARTMENT OF TRANSPORTATION	TYPICAL SECTIONS			F.A. RTE.	SECTION	COUNTY	TOTAL SHEETS	SHEET NO.
Default	PLOT SCALE = 100.0000' / in.	DRAWN -	REVISED -					VAR.	VARIOUS	VARIOUS	17	6
	PLOT DATE = 10/31/2014	CHECKED -	REVISED -		SCALE: SHEET 2 OF 8 SHEETS STA. TO STA.			ILLINOIS FED. AID PROJECT				
		DATE -	REVISED -		CONTRACT NO. 68B91							

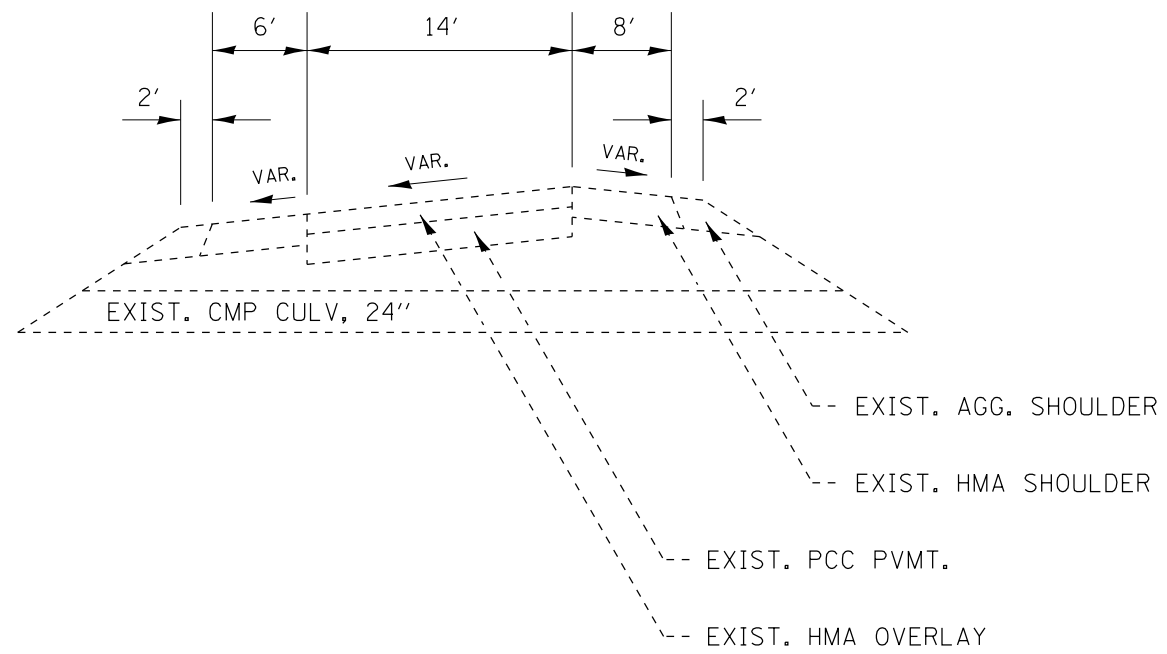

IL 116 RAMP E TYPICAL SECTION

LOCATION 10

FILE NAME = 68B91 - Culvert Lining.dgn	USER NAME = aubreygs	DESIGNED -	REVISED -	STATE OF ILLINOIS DEPARTMENT OF TRANSPORTATION	TYPICAL SECTIONS				F.A. RTE.	SECTION	COUNTY	TOTAL SHEETS	SHEET NO.	
Default	PLOT SCALE = 100.0000' / in.	DRAWN -	REVISED -		SCALE:	SHEET 3	OF 8	SHEETS	STA.	TO STA.	VAR.	VARIOUS	17	7
	PLOT DATE = 10/31/2014	CHECKED -	REVISED -								CONTRACT NO. 68B91			
		DATE -	REVISED -								ILLINOIS FED. AID PROJECT			

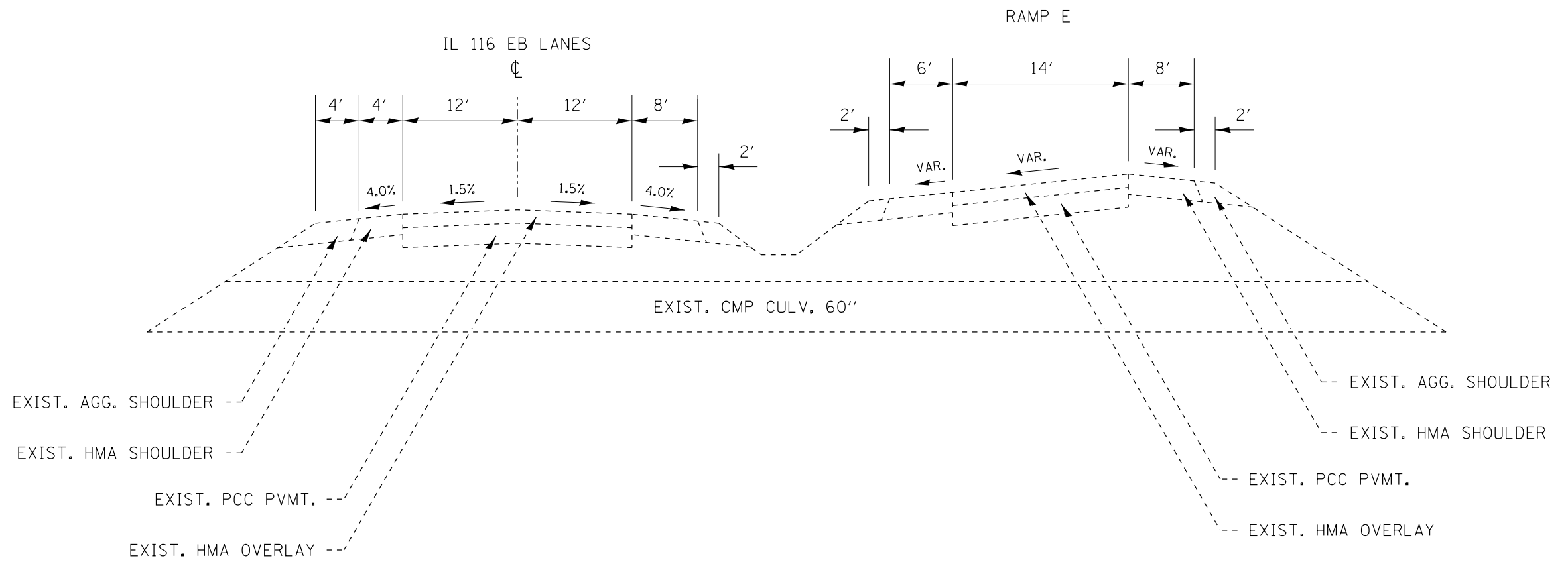

IL 116 TYPICAL SECTION

LOCATION 11

FILE NAME = 68B91 - Culvert Lining.dgn
Default

USER NAME = aubreygs
PLOT SCALE = 100.0000' / in.
PLOT DATE = 10/31/2014

DESIGNED -
DRAWN -
CHECKED -
DATE -

REVISED -
REVISED -
REVISED -
REVISED -

STATE OF ILLINOIS
DEPARTMENT OF TRANSPORTATION

TYPICAL SECTIONS

SCALE: SHEET 4 OF 8 SHEETS STA. TO STA.

F.A. RTE.	SECTION	COUNTY	TOTAL SHEETS	SHEET NO.
VAR.	VARIOUS	VARIOUS	17	8
CONTRACT NO. 68B91			ILLINOIS FED. AID PROJECT	

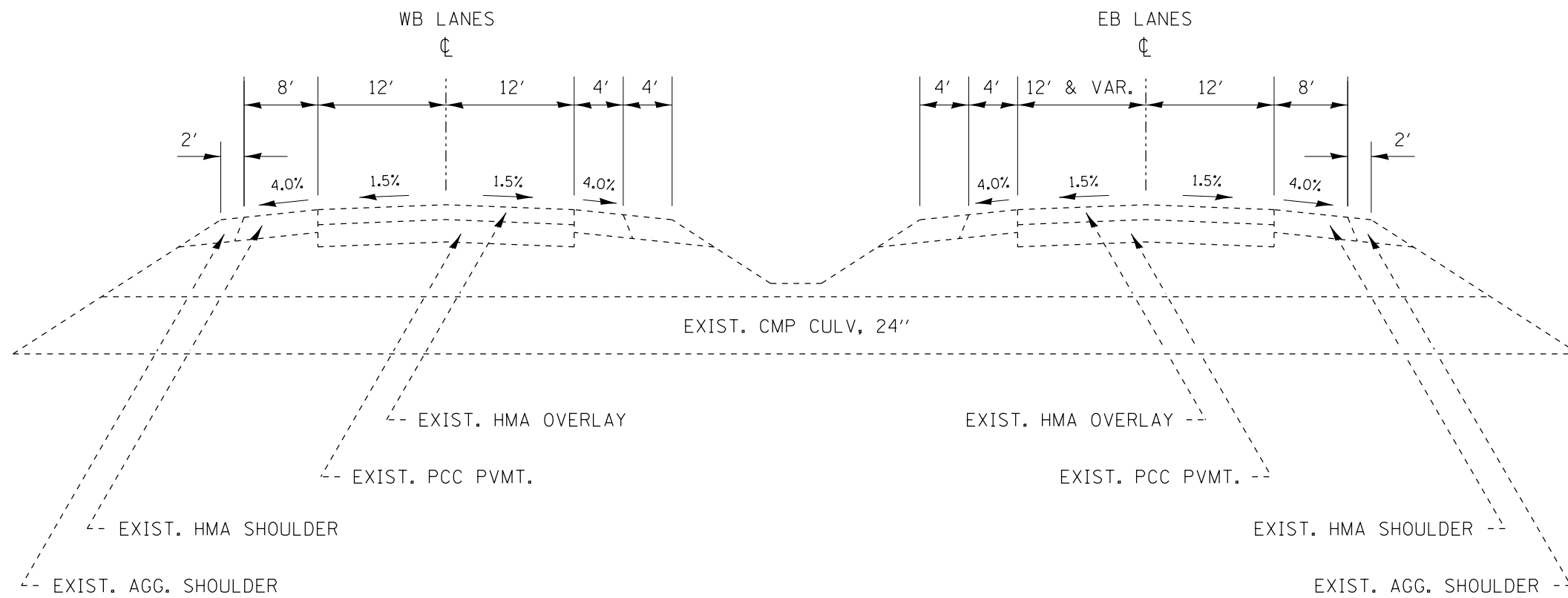

US 24 TYPICAL SECTION

LOCATION 12

FILE NAME = 68B91 - Culvert Lining.dgn	USER NAME = aubreygs	DESIGNED -	REVISED -
		DRAWN -	REVISED -
	PLOT SCALE = 100.0000' / in.	CHECKED -	REVISED -
Default	PLOT DATE = 10/31/2014	DATE -	REVISED -

STATE OF ILLINOIS
DEPARTMENT OF TRANSPORTATION

TYPICAL SECTIONS			
SCALE:	SHEET 5	OF 8 SHEETS	STA. TO STA.

F.A. RTE.	SECTION	COUNTY	TOTAL SHEETS	SHEET NO.
VAR.	VARIOUS	VARIOUS	17	9
				CONTRACT NO. 68B91
ILLINOIS FED. AID PROJECT				

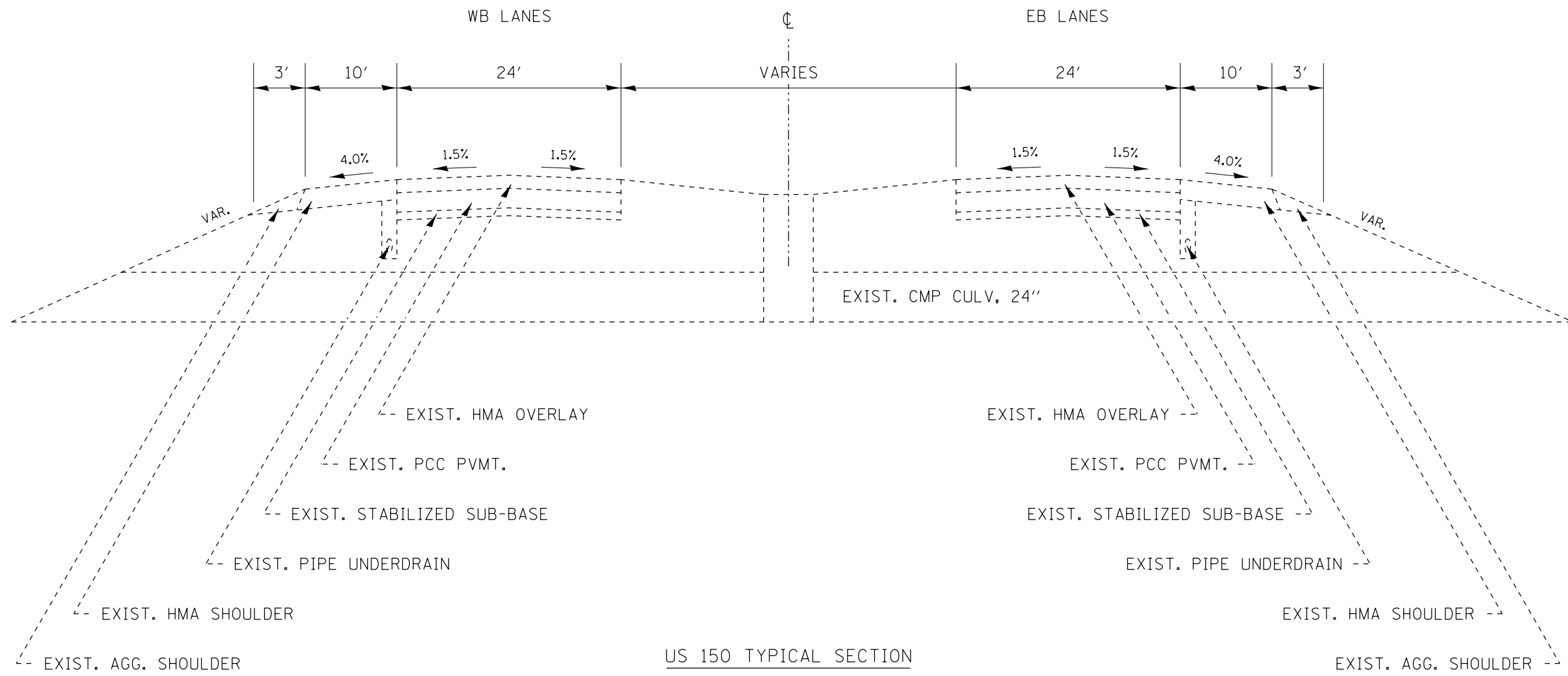

US 150 TYPICAL SECTION
LOCATION 13

FILE NAME = 68B91 - Culvert Lining.dgn	USER NAME = aubreygs	DESIGNED -	REVISED -	STATE OF ILLINOIS DEPARTMENT OF TRANSPORTATION	TYPICAL SECTIONS			F.A. RTE.	SECTION	COUNTY	TOTAL SHEETS	SHEET NO.
	PLOT SCALE = 100.0000' / in.	CHECKED -	REVISED -					VAR.	VARIOUS	VARIOUS	17	10
Default	PLOT DATE = 10/31/2014	DATE -	REVISED -	SCALE: SHEET 6 OF 8 SHEETS STA. TO STA.			ILLINOIS FED. AID PROJECT CONTRACT NO. 68B91					

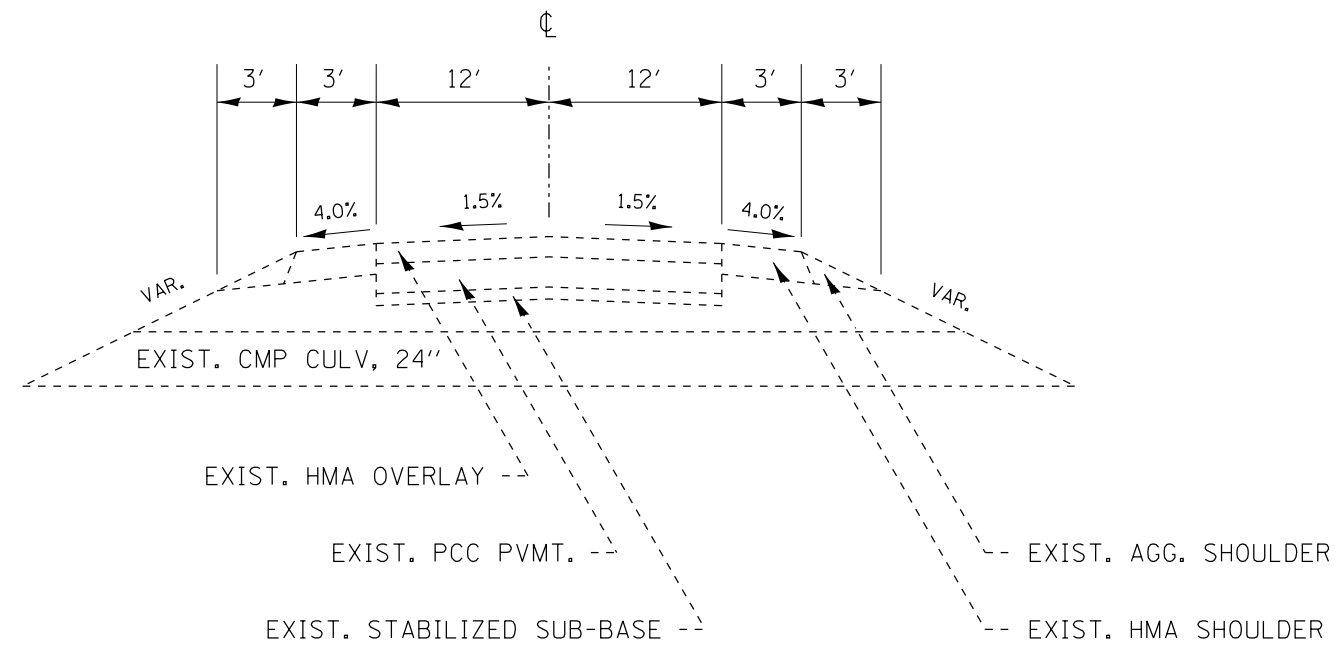

IL 251 TYPICAL SECTION

LOCATION 14

FILE NAME = 68B91 - Culvert Lining.dgn	USER NAME = aubreygs	DESIGNED -	REVISED -
		DRAWN -	REVISED -
	PLOT SCALE = 100.0000' / in.	CHECKED -	REVISED -
Default	PLOT DATE = 10/31/2014	DATE -	REVISED -

STATE OF ILLINOIS
DEPARTMENT OF TRANSPORTATION

TYPICAL SECTIONS

SCALE: SHEET 7 OF 8 SHEETS STA. TO STA.

F.A. RTE.	SECTION	COUNTY	TOTAL SHEETS	SHEET NO.
VAR.	VARIOUS	VARIOUS	17	11
			CONTRACT NO. 68B91	
ILLINOIS FED. AID PROJECT				

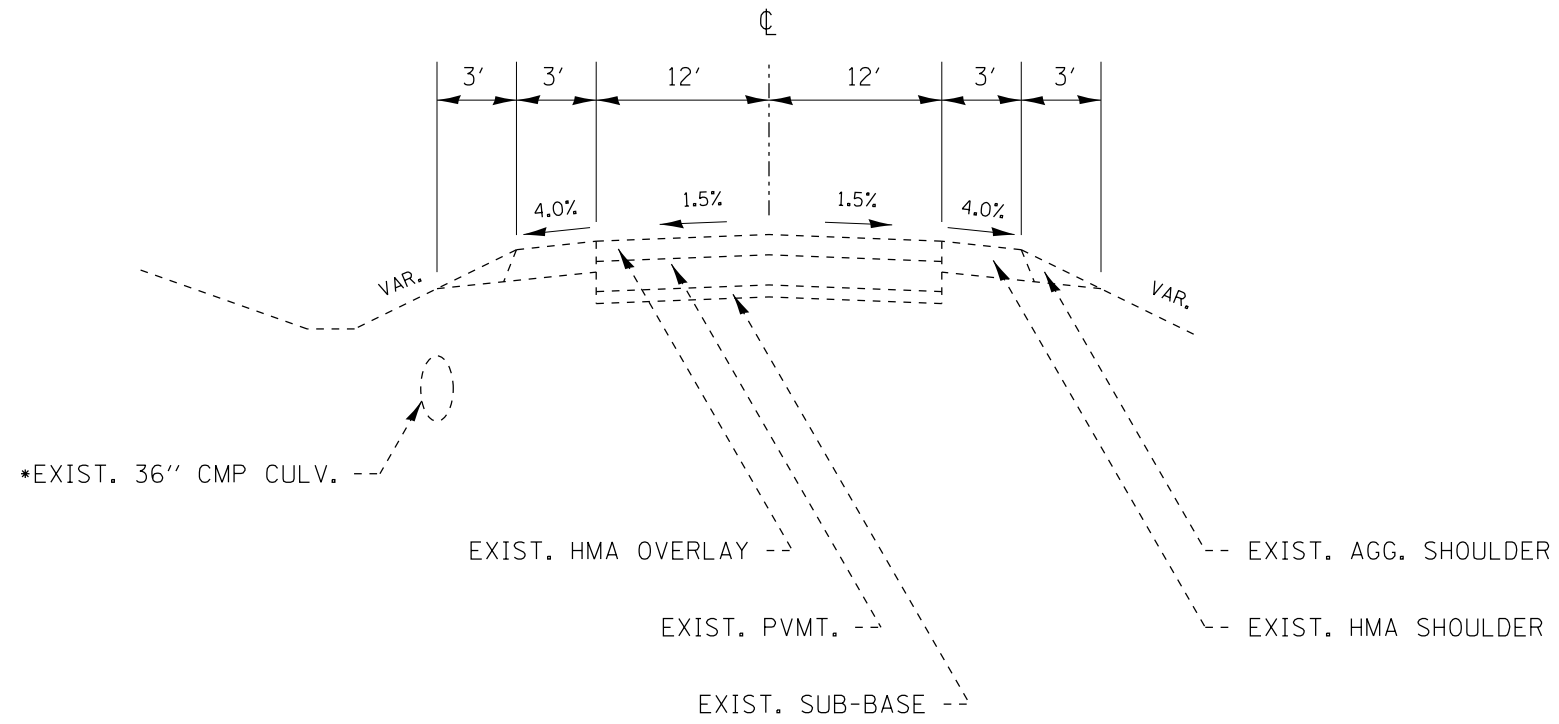

IL 251 TYPICAL SECTION

LOCATION 15

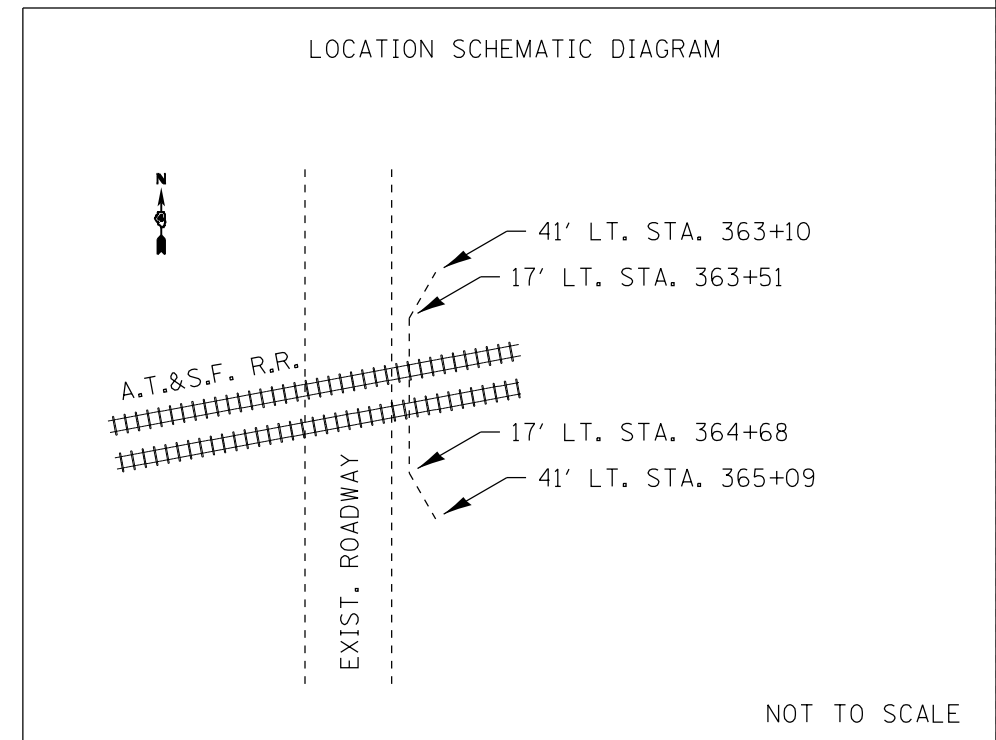

NOT TO SCALE

FILE NAME = 68B91 - Culvert Lining.dgn	USER NAME = aubreygs	DESIGNED -	REVISED -
Default	PLOT SCALE = 100.0000' / in.	DRAWN -	REVISED -
	PLOT DATE = 10/31/2014	CHECKED -	REVISED -
		DATE -	REVISED -

STATE OF ILLINOIS
DEPARTMENT OF TRANSPORTATION

TYPICAL SECTIONS

SCALE: SHEET 8 OF 8 SHEETS STA. TO STA.

F.A. RTE.	SECTION	COUNTY	TOTAL SHEETS	SHEET NO.
VAR.	VARIOUS	VARIOUS	17	12
CONTRACT NO. 68B91				
ILLINOIS FED. AID PROJECT				

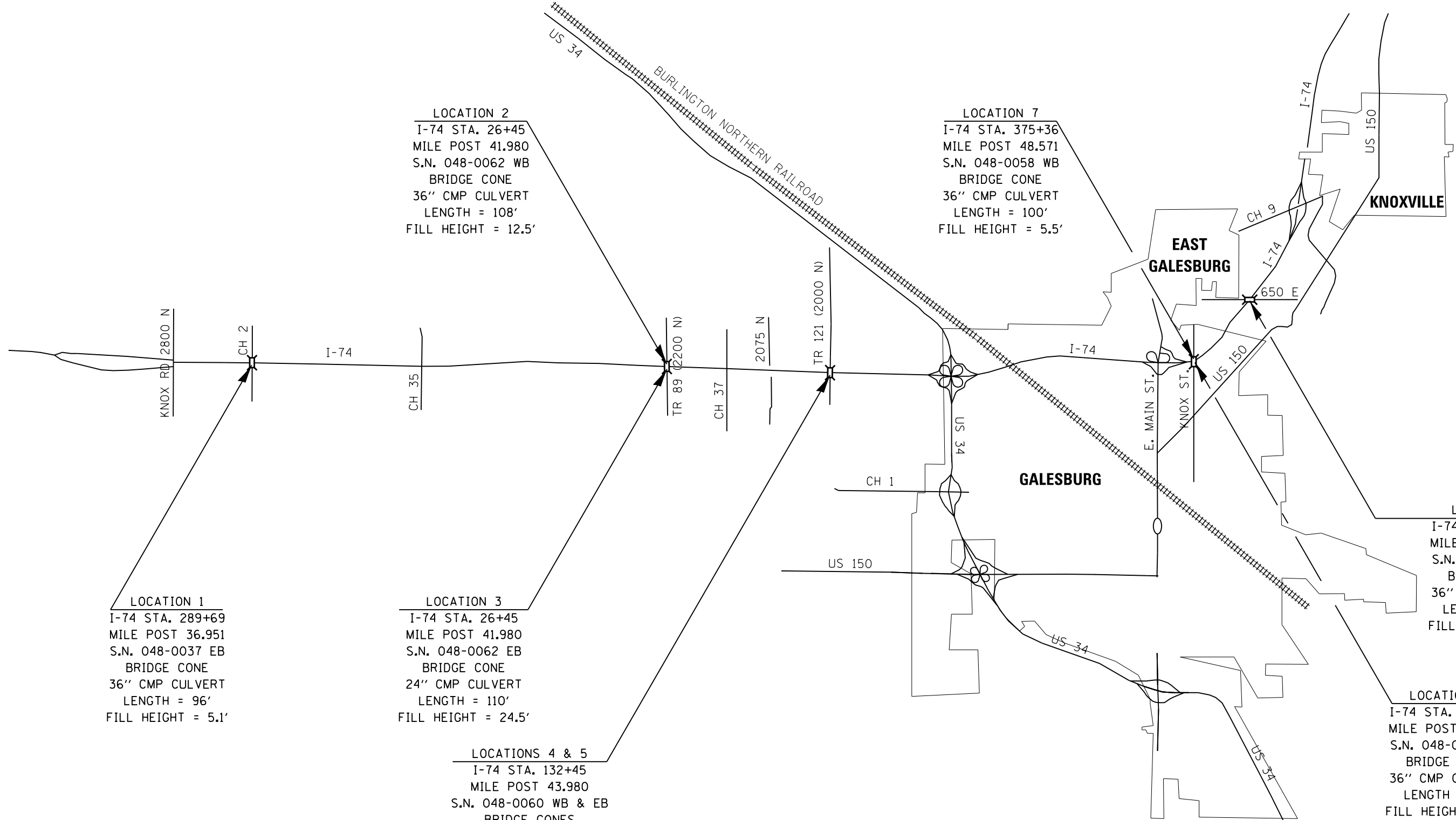

LOCATION 2
 I-74 STA. 26+45
 MILE POST 41.980
 S.N. 048-0062 WB
 BRIDGE CONE
 36" CMP CULVERT
 LENGTH = 108'
 FILL HEIGHT = 12.5'

LOCATION 7
 I-74 STA. 375+36
 MILE POST 48.571
 S.N. 048-0058 WB
 BRIDGE CONE
 36" CMP CULVERT
 LENGTH = 100'
 FILL HEIGHT = 5.5'

LOCATION 1
 I-74 STA. 289+69
 MILE POST 36.951
 S.N. 048-0037 EB
 BRIDGE CONE
 36" CMP CULVERT
 LENGTH = 96'
 FILL HEIGHT = 5.1'

LOCATION 3
 I-74 STA. 26+45
 MILE POST 41.980
 S.N. 048-0062 EB
 BRIDGE CONE
 24" CMP CULVERT
 LENGTH = 110'
 FILL HEIGHT = 24.5'

LOCATIONS 4 & 5
 I-74 STA. 132+45
 MILE POST 43.980
 S.N. 048-0060 WB & EB
 BRIDGE CONES
 36" CMP CULVERT
 LENGTH = 88'
 FILL HEIGHT = 5.5'

LOCATION 8
 I-74 STA. 426+85
 MILE POST 49.560
 S.N. 048-0048 EB
 BRIDGE CONE
 36" CMP CULVERT
 LENGTH = 108'
 FILL HEIGHT = 7.1'

LOCATION 6
 I-74 STA. 374+60
 MILE POST 48.569
 S.N. 048-0058 EB
 BRIDGE CONE
 36" CMP CULVERT
 LENGTH = 96'
 FILL HEIGHT = 5.5'

FILE NAME = 68B91 - Culvert Lining.dgn	USER NAME = aubreys	DESIGNED - DRAWN -	REVISED - REVISED -
	PLOT SCALE = 100.0000' / in.	CHECKED -	REVISED -
	PLOT DATE = 10/31/2014	DATE -	REVISED -

**STATE OF ILLINOIS
 DEPARTMENT OF TRANSPORTATION**

I-74 LINE DIAGRAM KNOX COUNTY		
NOT TO SCALE	SHEET 1 OF 1 SHEETS	STA. TO STA.

F.A. RTE.	SECTION	COUNTY	TOTAL SHEETS	SHEET NO.
VAR.	VARIOUS	VARIOUS	17	13
CONTRACT NO. 68B91				
ILLINOIS FED. AID PROJECT				

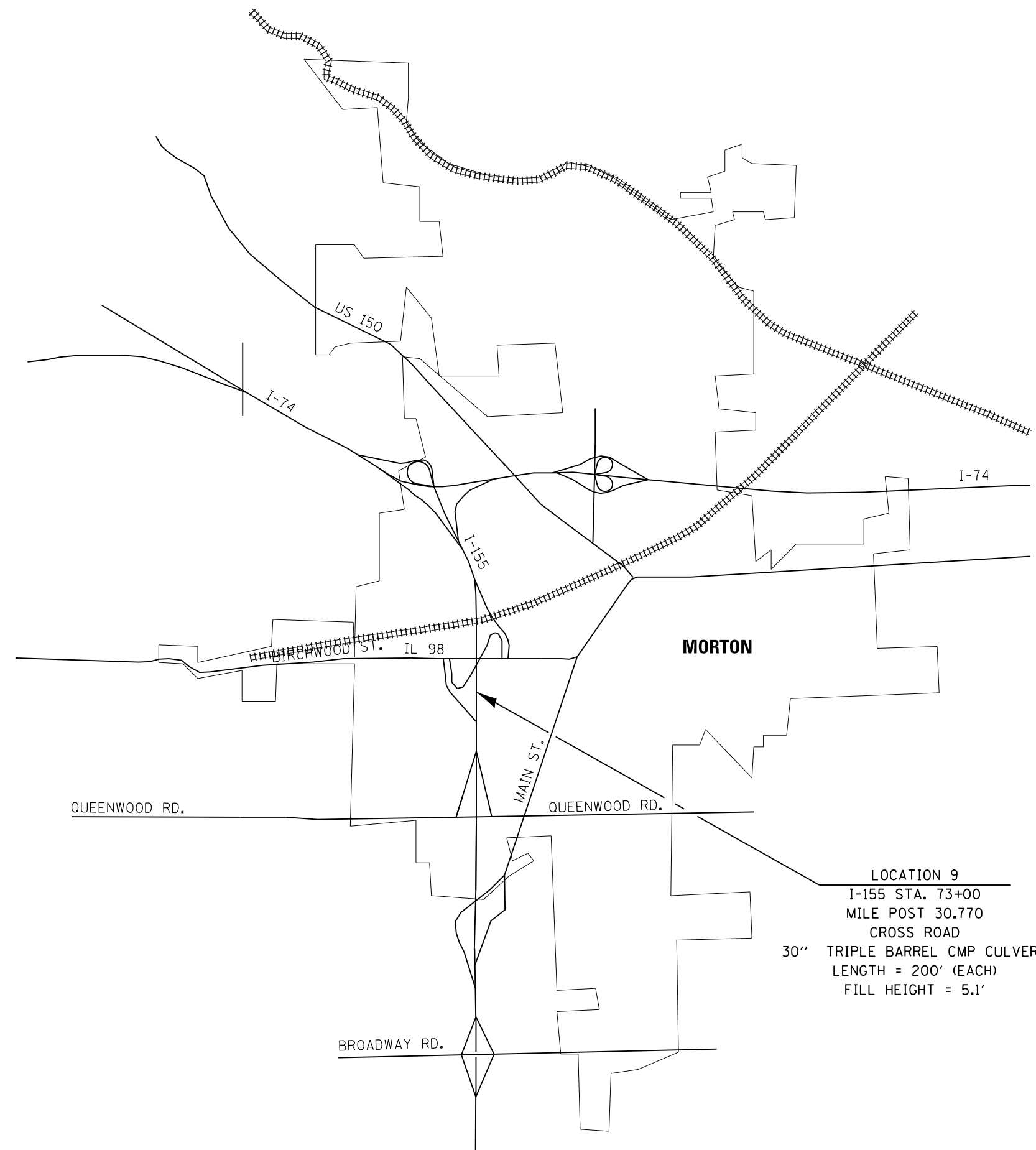

LOCATION 9
 I-155 STA. 73+00
 MILE POST 30.770
 CROSS ROAD
 30" TRIPLE BARREL CMP CULVERT
 LENGTH = 200' (EACH)
 FILL HEIGHT = 5.1'

FILE NAME = 68B91 - Culvert Lining.dgn	USER NAME = aubreygs	DESIGNED -	REVISED -	STATE OF ILLINOIS DEPARTMENT OF TRANSPORTATION	I-155 LINE DIAGRAM TAZEWELL COUNTY			F.A. RTÉ.	SECTION	COUNTY	TOTAL SHEETS	SHEET NO.	
		DRAWN -	REVISED -		NOT TO SCALE	SHEET 1 OF 1 SHEETS	STA.	TO STA.	VAR.	VARIOUS	VARIOUS	17	14
		PLOT SCALE = 100.0000' / in.	CHECKED -		REVISED -				CONTRACT NO. 68B91				
		PLOT DATE = 10/31/2014	DATE -		REVISED -	ILLINOIS FED. AID PROJECT							



LOCATION 11
 IL 116 STA. 9+199
 MILE POST 6.229
 CROSS ROAD
 60" CMP CULVERT
 LENGTH = 60'
 FILL HEIGHT = 2.5'

LOCATION 10
 IL 116 STA. 0+600
 MILE POST 6.200
 CROSS ROAD
 24" CMP CULVERT
 LENGTH = 200'
 FILL HEIGHT = 2'

LOCATION 12
 US 24 STA. 330+00
 MILE POST 2.020
 CROSS ROAD
 24" CMP CULVERT
 LENGTH = 130'
 FILL HEIGHT = 1.7'

LOCATION 13
 US 150 STA. 84+00
 MILE POST 3.70
 CROSS ROAD
 24" CMP CULVERT
 LENGTH = 150'
 FILL HEIGHT = 13.3'

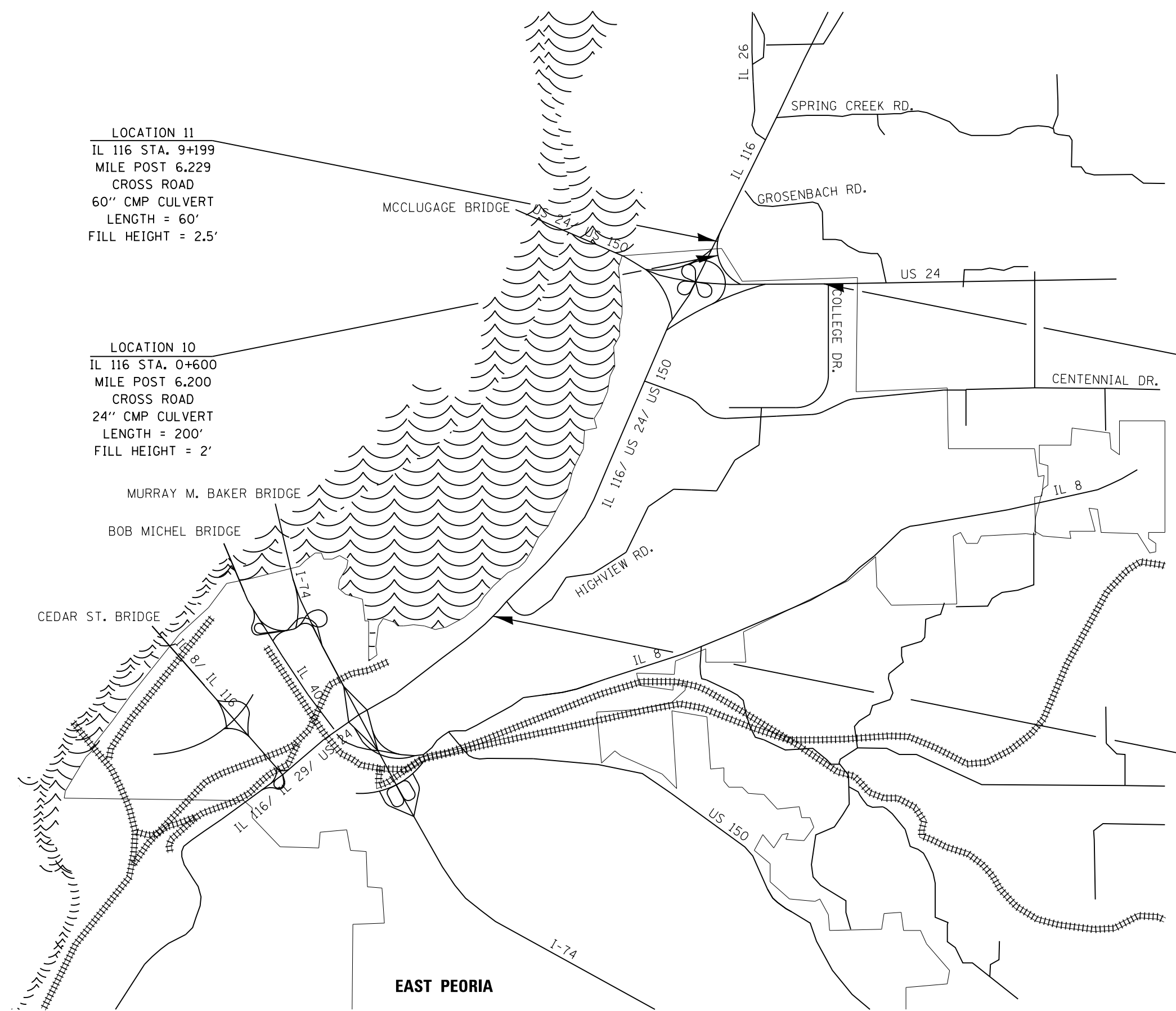

EAST PEORIA

FILE NAME = 68B91 - Culvert Lining.dgn	USER NAME = aubreys	DESIGNED -	REVISED -	STATE OF ILLINOIS DEPARTMENT OF TRANSPORTATION	IL 116/US 24/US 150 LINE DIAGRAM TAZEWELL COUNTY			F.A. RTÉ.	SECTION	COUNTY	TOTAL SHEETS	SHEET NO.	
		DRAWN -	REVISED -		NOT TO SCALE	SHEET 1 OF 1 SHEETS	STA.	TO STA.	VAR.	VARIOUS	VARIOUS	17	15
		PLOT SCALE = 100.0000' / in.	REVISED -		CONTRACT NO. 68B91								
		PLOT DATE = 10/31/2014	REVISED -		ILLINOIS FED. AID PROJECT								

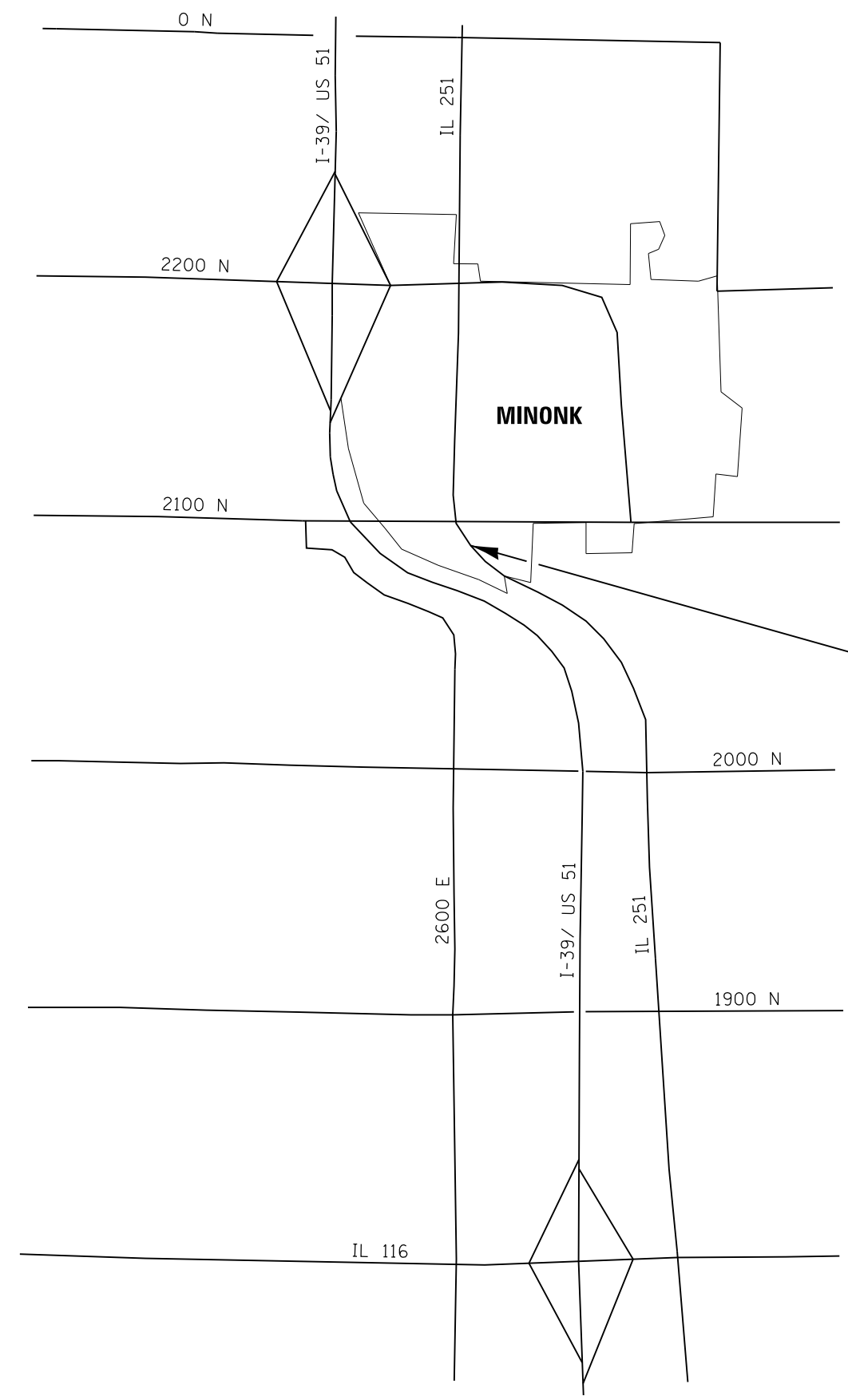

LOCATION 14
 IL 251 STA. 115+98
 MILE POST 17.130
 CROSS ROAD
 24" CMP CULVERT
 LENGTH = 60'
 FILL HEIGHT = 4.2'

FILE NAME = 68B91 - Culvert Lining.dgn	USER NAME = aubreygs	DESIGNED -	REVISED -
		DRAWN -	REVISED -
	PLOT SCALE = 100.0000' / in.	CHECKED -	REVISED -
	PLOT DATE = 10/31/2014	DATE -	REVISED -

STATE OF ILLINOIS
DEPARTMENT OF TRANSPORTATION

IL 251 LINE DIAGRAM
WOODFORD COUNTY

NOT TO SCALE SHEET 1 OF 1 SHEETS STA. TO STA.

F.A. RTE.	SECTION	COUNTY	TOTAL SHEETS	SHEET NO.
VAR.	VARIOUS	VARIOUS	17	16
CONTRACT NO. 68B91				
ILLINOIS FED. AID PROJECT				

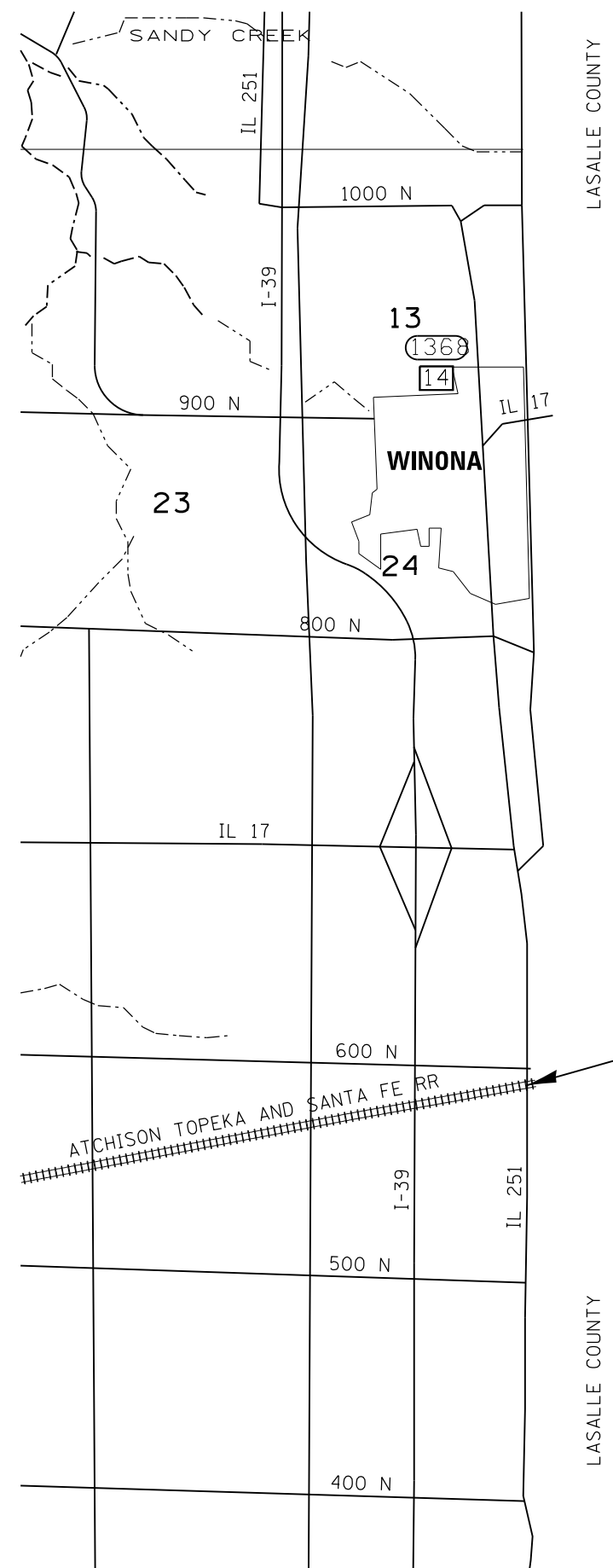

LOCATION 15
 IL 251
 41' LT. STA. 363+10 TO
 17' LT. STA. 363+51 TO
 17' LT. STA. 364+68 TO
 41' LT. STA. 365+09
 36" CMP CULVERT
 LENGTH = 211'
 FILL HEIGHT = 6.5'

NOTES:
 *THE CULVERT IS LOCATED ON THE EAST SIDE OF THE ROADWAY AND RUNS PARALLEL TO THE ROADWAY.
 **THE CULVERT HAS TWO 30° ELBOWS.
 SEE LOCATION SCHEMATIC DIAGRAM SHEET 12

FILE NAME = 68B91 - Culvert Lining.dgn	USER NAME = aubreygs	DESIGNED -	REVISED -
		DRAWN -	REVISED -
	PLOT SCALE = 100.0000' / in.	CHECKED -	REVISED -
	PLOT DATE = 10/31/2014	DATE -	REVISED -

STATE OF ILLINOIS
DEPARTMENT OF TRANSPORTATION

IL 251 LINE DIAGRAM
MARSHALL COUNTY

NOT TO SCALE SHEET 1 OF 1 SHEETS STA. TO STA.

F.A. RTE.	SECTION	COUNTY	TOTAL SHEETS	SHEET NO.
VAR.	VARIOUS	VARIOUS	17	17
CONTRACT NO. 68B91				
ILLINOIS FED. AID PROJECT				