

STATE OF ILLINOIS
DEPARTMENT OF TRANSPORTATION
DIVISION OF HIGHWAYS
PROPOSED
HIGHWAY PLANS

FAP ROUTE 781 & 332 (IL 33 & IL 1)
SECTION D7 HMA RESURF 2015-5

RESURFACING INTERMITTENT
CRAWFORD COUNTY

F.A.P. RTE.	SECTION	COUNTY	TOTAL SHEETS	SHEET NO.
781 & 332	D7 HMA RESURF 2015-5	CRAWFORD	11	1
ILLINOIS			CONTRACT NO. 74680	

FOR INDEX OF SHEETS, SEE SHEET NO. 2

ADT = 5300, IL 33 (2013)
 3450, IL 1 (2013)

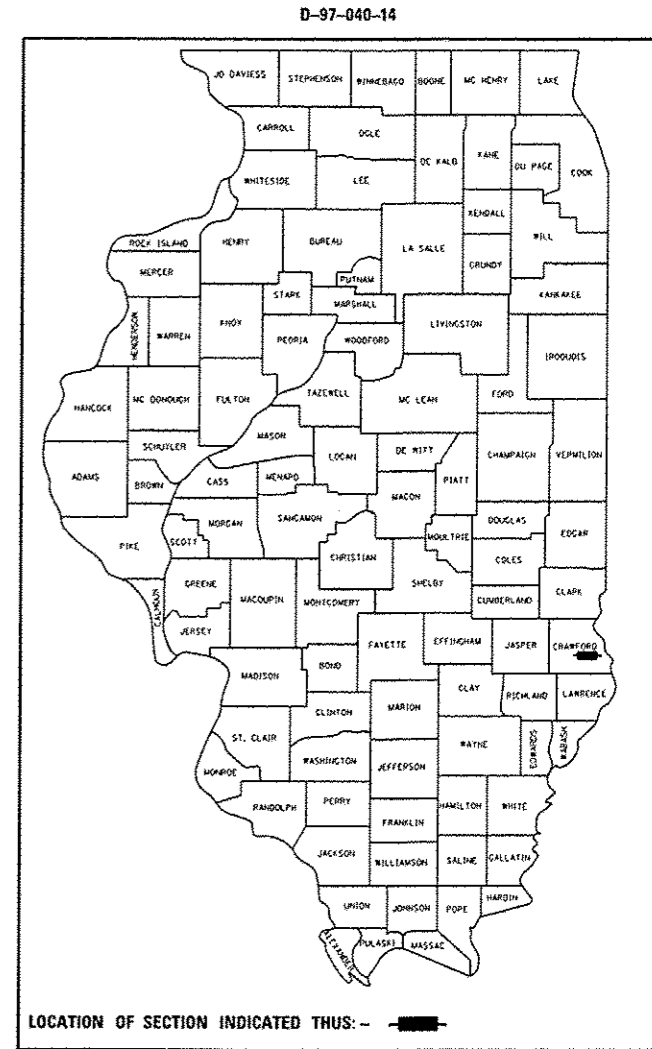

SEE SHEET NO. 4
 FOR DETAILED MAP

C-97-086-14

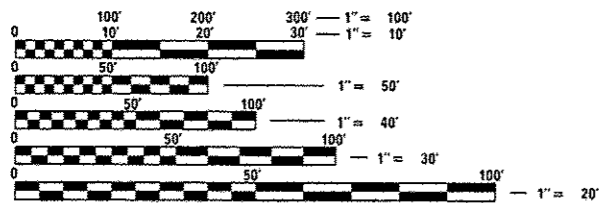
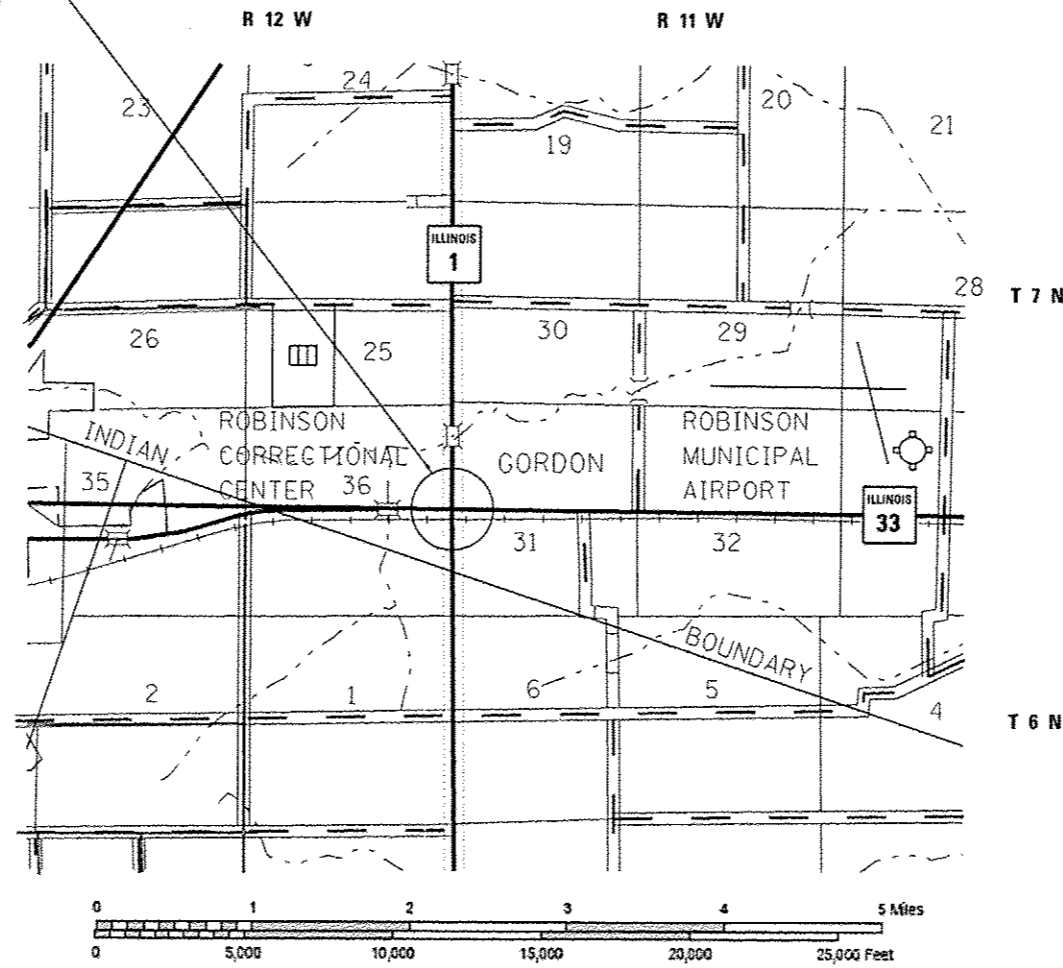

FULL SIZE PLANS HAVE BEEN PREPARED USING STANDARD ENGINEERING SCALES. REDUCED SIZED PLANS WILL NOT CONFORM TO STANDARD SCALES. IN MAKING MEASUREMENTS ON REDUCED PLANS, THE ABOVE SCALES MAY BE USED.

J.U.L.I.E.
 JOINT UTILITY LOCATION INFORMATION FOR EXCAVATION
 1-800-892-0123
 OR 811

PROJECT ENGINEER: MARK DAUGHERTY
 PROJECT MANAGER: MATT BOWER

CONTRACT NO. 74680

IL 33	IL 1
GROSS LENGTH = 901.00 FT. = 0.171 MILE	GROSS LENGTH = 1635.00 FT. = 0.310 MILE
NET LENGTH = 901.00 FT. = 0.171 MILE	NET LENGTH = 1627.00 FT. = 0.308 MILE

STATE OF ILLINOIS
 DEPARTMENT OF TRANSPORTATION
 DIVISION OF HIGHWAYS

SUBMITTED *October 29, 2014*
Roger L. Driskul, P.E.
 DEPUTY DIRECTOR OF HIGHWAYS, REGION ENGINEER

Jan 30, 2015
John D. Baranzelli, P.E.
 ENGINEER OF DESIGN AND ENVIRONMENT

Jan 30, 2015
Omer Osman, P.E.
 DIRECTOR OF HIGHWAYS, CHIEF ENGINEER

PRINTED BY THE AUTHORITY
OF THE STATE OF ILLINOIS

GENERAL NOTES

THIS SECTION SHALL BE CONSTRUCTED IN ACCORDANCE WITH THE PLANS, THE "STANDARD SPECIFICATIONS FOR ROAD AND BRIDGE CONSTRUCTION", ADOPTED JANUARY 1, 2012; THE "SUPPLEMENTAL SPECIFICATIONS AND RECURRING SPECIAL PROVISIONS" INDICATED ON THE CHECK SHEET, AND THE SPECIAL PROVISIONS INCLUDED IN THE PROPOSAL.

THE WORK INCLUDED IN THIS SECTION CONSISTS OF PATCHING, HOT-MIX ASPHALT SURFACE REMOVAL, HOT-MIX ASPHALT RESURFACING, PAVEMENT MARKING, AND ANY OTHER WORK NECESSARY TO COMPLETE THE SECTION.

SPECIAL ATTENTION SHALL BE MADE TO ARTICLE 701.07 OF THE STANDARD SPECIFICATIONS CONCERNING DROP-OFFS. IN CURB & CUTTER AREAS, THE MAXIMUM ALLOWABLE DIFFERENTIAL IN ELEVATION AT THE EDGE OF PAVEMENT/EDGE OF GUTTER SHALL BE 1 1/2" AT THE END OF THE WORK DAY.

THE CONTRACTOR SHALL MILL THROUGH THE CLASS D PATCHES AFTER THE PATCHING IS COMPLETED. THIS WORK SHALL BE PAID FOR AS HMA SURFACE REMOVAL OF THE THICKNESS SPECIFIED.

THE RESIDENT ENGINEER SHALL BE THE SOLE JUDGE CONCERNING THE CURING TIME FOR THE VARIOUS HOT-MIX ASPHALT LIFTS.

THE ACTUAL LOCATIONS OF PAVEMENT PATCHING SHALL BE DETERMINED BY THE ENGINEER IN THE FIELD.

PAVEMENT MARKING SHALL BE APPLIED IN ACCORDANCE WITH SECTION 780 OF THE STANDARD SPECIFICATIONS. SHORT TERM PAVEMENT MARKING SHALL BE APPLIED TO THE MILLED SURFACE. BITUMINOUS MATERIALS (PRIME COAT), AND HOT-MIX ASPHALT SURFACE COURSE AS SPECIFIED IN SECTION 703 OF THE STANDARD SPECIFICATIONS. TEMPORARY TAPE SHALL BE USED ON THE SURFACE COURSE. PAINT SHALL BE USED ON MILLED SURFACES.

THE CONTRACTOR SHALL PROVIDE INTERNET ACCESS TO THE BITUMINOUS PLANT QUALITY CONTROL LAB SO THAT BITUMINOUS PLANT REPORTS CAN BE E-MAILED TO THE DISTRICT HEADQUARTERS. THIS WORK WILL NOT BE PAID FOR SEPARATELY BUT SHALL BE INCLUDED IN THE UNIT PRICES FOR OTHER ITEMS IN THE CONTRACT.

MATERIAL FOR AGGREGATE WEDGE SHOULDER, TYPE B SHALL BE CRUSHED STONE, CRUSHED CONCRETE, OR RAP.

THE FOLLOWING MIXTURE REQUIREMENTS ARE APPLICABLE FOR THIS PROJECT:

APPLICATION	AC/PG	DESIGN AIR VOIDS	MIXTURE COMPOSITION	FRICTION AGGREGATE
LEVELING BINDER HMA LEVELING BINDER IL-9.5, N90	PG 64-22	4.0% @ N=90	IL - 9.5	N/A
HMA SURFACE COURSE POLYMERIZED HMA SURFACE COURSE, MIX "D" N90	SBS PG 70-22	4.0% @ N=90	IL - 9.5	MIX D
CLASS D PATCHING HMA ASPHALT BINDER COURSE, IL-19.0 N70	PG 64-22	4.0% @ N=70	IL - 19.0	N/A

THE FOLLOWING RATES OF APPLICATION HAVE BEEN USED IN THE CALCULATING PLAN QUANTITIES:

BITUMINOUS MATERIALS (PRIME COAT)	0.05 LBS/SQ FT
BITUMINOUS MATERIALS (PRIME COAT)-FOG COAT	0.025 LBS/SQ FT
SURFACE AND BINDER	112 LBS/SQ YD/INCH

INDEX OF SHEETS

SHEET NO. DESCRIPTION

- 1 COVER SHEET
- 2 INDEX OF SHEETS, HIGHWAY STANDARDS AND GENERAL NOTES
- 3 SUMMARY OF QUANTITIES
- 4 LOCATION MAP
- 5-6 TYPICAL CROSS SECTION
- 7 SCHEDULE OF QUANTITIES
- 8-11 PAVEMENT MARKINGS AND RAISED REFLECTIVE PAVEMENT MARKERS

HIGHWAY STANDARDS

STANDARD NO. DESCRIPTION

- 000001-06 STANDARD SYMBOLS, ABBREVIATIONS, AND PATTERNS
- 001006 DECIMAL OF AN INCH AND OF A FOOT
- 442201-03 CLASS C AND D PATCHES
- 701006-05 OFF-ROAD OPERATIONS, 2L, 2W, 15' TO 24" FROM PAVEMENT EDGE
- 701201-04 LANE CLOSURE, 2L, 2W, DAY ONLY FOR SPEEDS => 45 MPH
- 701301-04 LANE CLOSURE, 2L, 2W SHORT TIME OPERATIONS
- 701306-03 LANE CLOSURE, 2L, 2W, SLOW MOVING OPERATIONS DAY ONLY, FOR SPEEDS => 45 MPH
- 701311-03 LANE CLOSURE, 2L, 2W, MOVING OPERATIONS - DAY ONLY
- 701901-04 TRAFFIC CONTROL DEVICES
- 780001-05 TYPICAL PAVEMENT MARKINGS
- 781001-03 TYPICAL APPLICATIONS RAISED REFLECTIVE PAVEMENT MARKERS

FILE NAME =	USER NAME = steffanek	DESIGNED -	REVISED -	STATE OF ILLINOIS DEPARTMENT OF TRANSPORTATION	GENERAL NOTES & INDEX OF SHEETS	F.A.P. RTE.	SECTION	COUNTY	TOTAL SHEETS	SHEET NO.
et:\pwork\puidoc\stefanek\08396986\074688-akt-gennote.dgn		DRAWN -	REVISED -			* DT HMA RESURF 2015-5	CRAWFORD	11	2	
PLOT SCALE = 1/8"=1'-0"		CHECKED -	REVISED -			* 781 & 332	CONTRACT NO. 74680			
Default		DATE -	REVISED -			ILLINOIS FED. AID PROJECT				
						SCALE:	SHEET	OF	SHEETS	STA. TO STA.

100% STATE

100% STATE

SUMMARY OF QUANTITIES			TOTAL QUANTITIES	CONSTRUCTION TYPE CODE	
CODE NO	ITEM	UNIT		0005 FAP 781 (IL 33)	0005 FAP 332 (IL 1)
40600275	BITUMINOUS MATERIALS (PRIME COAT)	POUND	5048	1928	3120
40600645	LEVELING BINDER (MACHINE METHOD), N90	TON	314	120	194
40600990	TEMPORARY RAMP	SQ YD	128	43	85
40603545	POLYMERIZED HOT-MIX ASPHALT SURFACE COURSE, MIX "D", N90	TON	628	240	388
44000158	HOT-MIX ASPHALT SURFACE REMOVAL, 2 1/4"	SQ YD	7478	2855	4623
44201827	CLASS D PATCHES, TYPE II, 15 INCH	SQ YD	10	5	5
44201831	CLASS D PATCHES, TYPE III, 15 INCH	SQ YD	20	10	10
44201833	CLASS D PATCHES, TYPE IV, 15 INCH	SQ YD	30	15	15
48102100	AGGREGATE WEDGE SHOULDER, TYPE B	TON	51	27	24
67100100	MOBILIZATION	L SUM	1	0.5	0.5
70100450	TRAFFIC CONTROL AND PROTECTION, STANDARD	L SUM	1	0.5	0.5
	701201				
70100460	TRAFFIC CONTROL AND PROTECTION, STANDARD	L SUM	1	0.5	0.5
	701306				
X7015005	CHANGEABLE MESSAGE SIGN	CAL DA	14	7	7

SUMMARY OF QUANTITIES			TOTAL QUANTITIES	CONSTRUCTION TYPE CODE	
CODE NO	ITEM	UNIT		0005 FAP 781 (IL 33)	0005 FAP 332 (IL 1)
70300100	SHORT TERM PAVEMENT MARKING	FOOT	1369	486	883
70300210	TEMPORARY PAVEMENT MARKING LETTERS AND SYMBOLS	SQ FT	62		62
70300220	TEMPORARY PAVEMENT MARKING - LINE 4"	FOOT	6626	2027	4599
70300280	TEMPORARY PAVEMENT MARKING - LINE 24"	FOOT	96	26	70
70301000	WORK ZONE PAVEMENT MARKING REMOVAL	SQ FT	152	54	98
* 78001110	PAINT PAVEMENT MARKING - LINE 4"	FOOT	6626	2027	4599
* 78004200	PREFORMED PLASTIC PAVEMENT MARKING, TYPE B - INLAID - LETTERS AND SYMBOLS	SQ FT	62		62
* 78004280	PREFORMED PLASTIC PAVEMENT MARKING, TYPE B - INLAID - LINE 24"	FOOT	96	26	70
* 78100100	RAISED REFLECTIVE PAVEMENT MARKER	EACH	31	11	20
X4060995	TEMPORARY RAMP, SPECIAL	SQ YD	144	38	106
Z0048665	RAILROAD PROTECTIVE LIABILITY INSURANCE	L SUM	1		1

13

* SPECIALTY ITEM

FILE NAME :	USER NAME : xstffannk	DESIGNED -	REVISED -	STATE OF ILLINOIS DEPARTMENT OF TRANSPORTATION	SUMMARY OF QUANTITIES	F.A.P. RATE:	SECTION	COUNTY	TOTAL SHEETS	SHEET NO.
...	...	DRAWN -	REVISED -			* 07 HMA RESURF 2015-5	CRAWFORD	11	3	
...	...	CHECKED -	REVISED -			* 781 & 332	CONTRACT NO. 74680			
...	...	DATE -	REVISED -			ILLINOIS FED. AID PROJECT				

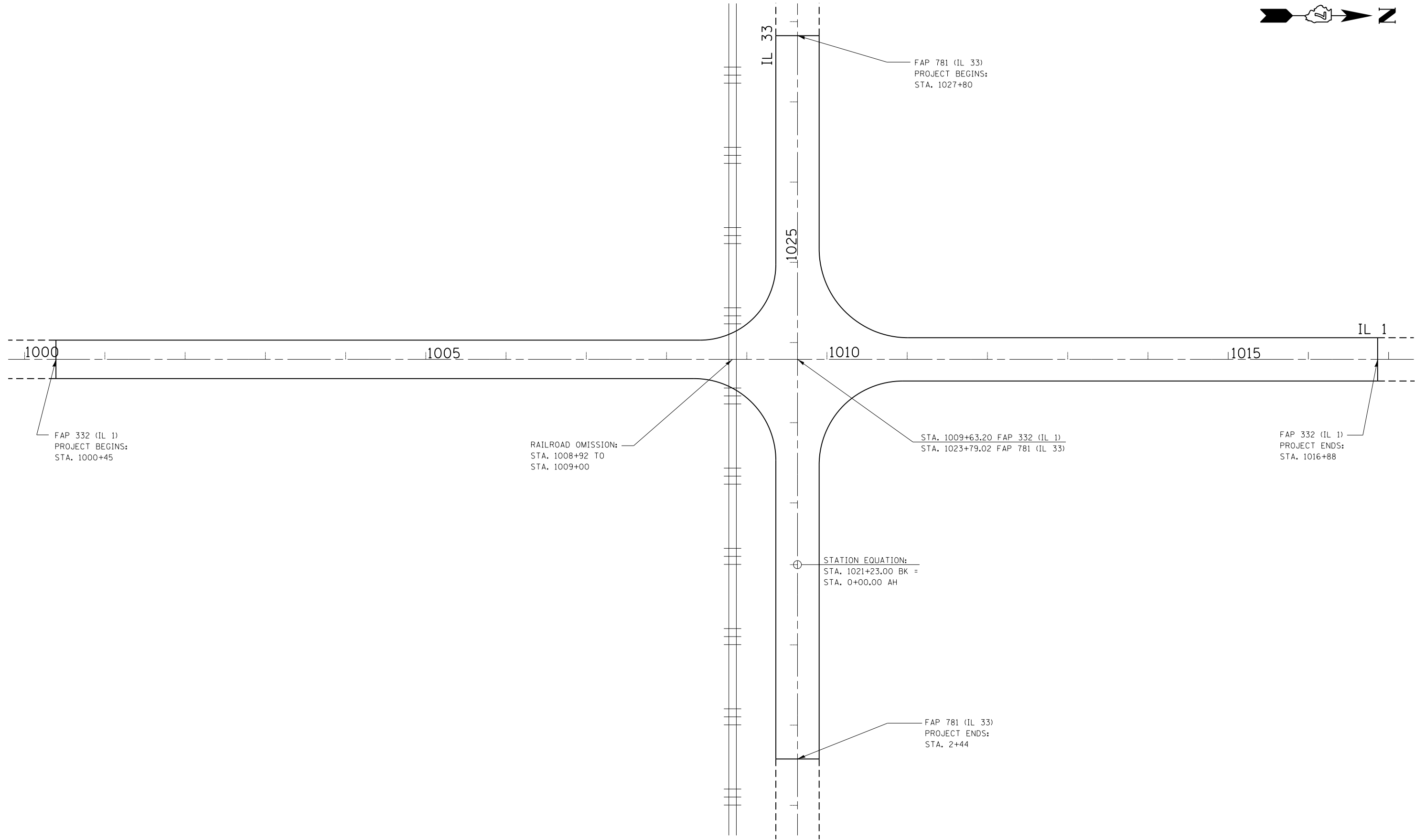

DRAWING NOT TO SCALE

FILE NAME =	USER NAME = steffenmk	DESIGNED -	REVISED -
ct:\pw\work\p\idot\steffenmk\d0396986\074680-sht-cover.dgn		DRAWN -	REVISED -
Default	PLOT SCALE = 100.0000' / in.	CHECKED -	REVISED -
	PLOT DATE = 10/30/2014	DATE -	REVISED -

**STATE OF ILLINOIS
DEPARTMENT OF TRANSPORTATION**

LOCATION MAP			
SCALE:	SHEET	OF	SHEETS
	STA.	TO	STA.

F.A.P. RTE.	SECTION	COUNTY	TOTAL SHEETS	SHEET NO.
•	D7 HMA RESURF 2015-5	CRAWFORD	11	4
•	781 & 332	CONTRACT NO. 74680		
ILLINOIS FED. AID PROJECT				

TYPICAL CROSS SECTION

IL RTE 1

STATION TO STATION
1000 + 45 1008 + 92 (RAILROAD OMISSION: 1008 + 92 TO 1009 + 00)

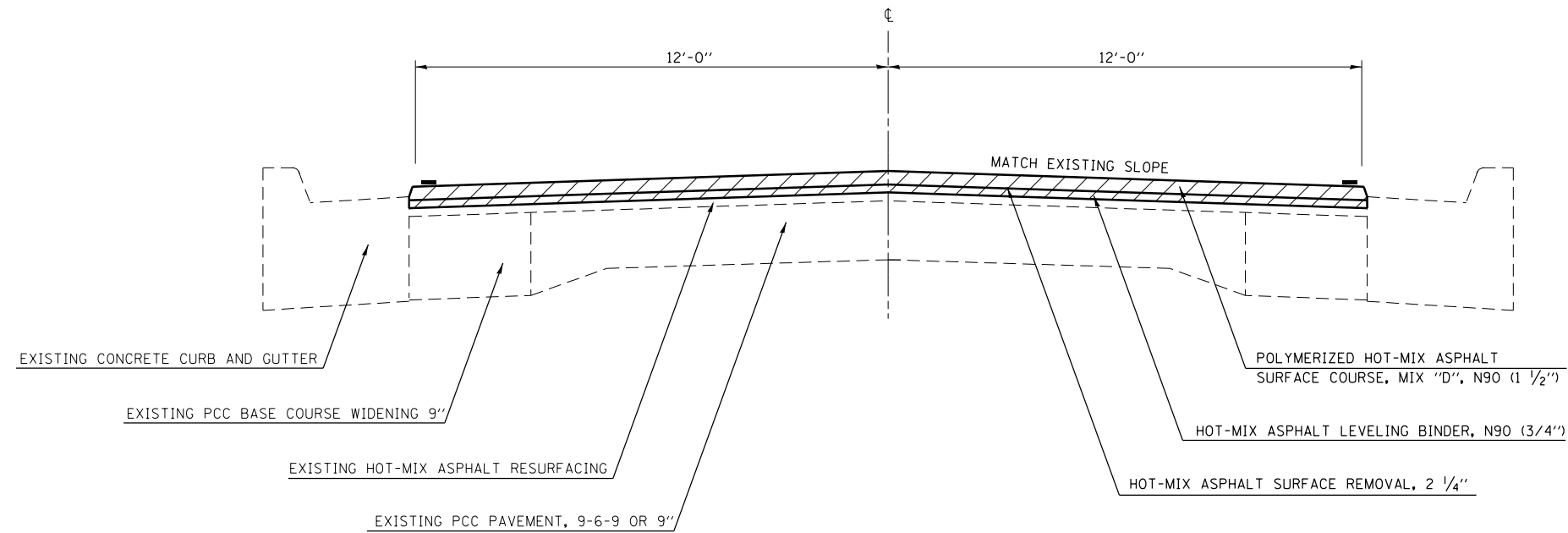

TYPICAL CROSS SECTION

IL RTE 1

STATION TO STATION
1009 + 00 1016 + 88

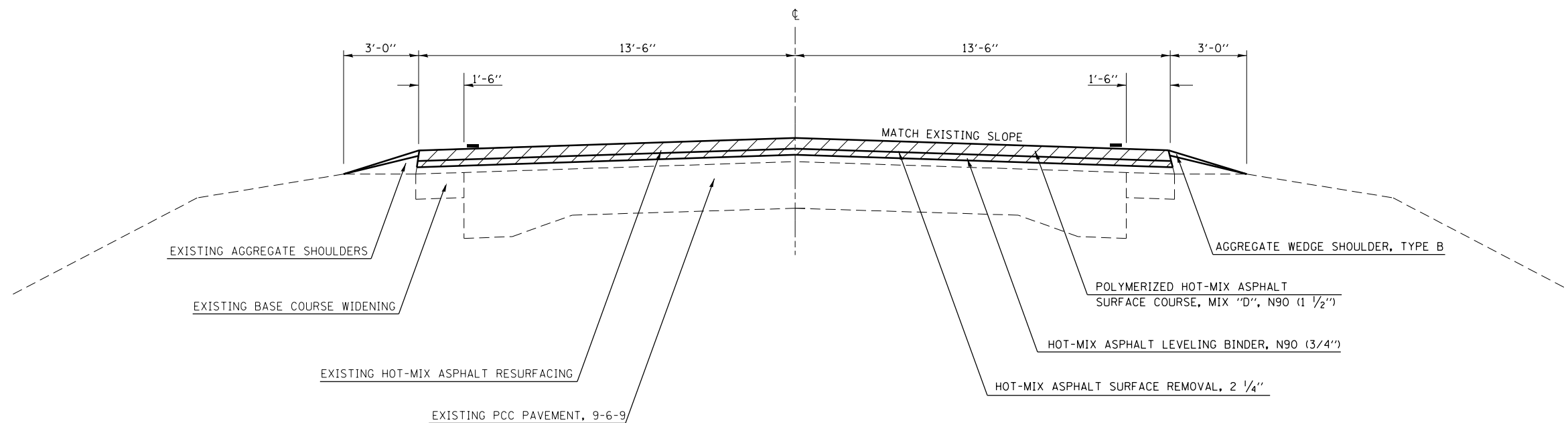

FILE NAME =	USER NAME = steffenmk	DESIGNED -	REVISED -
ct:\pw\work\p\dot\steffenmk\d0396986\074680-sht-typcros.dgn		DRAWN -	REVISED -
Default	PLOT SCALE = 100.0000' / in.	CHECKED -	REVISED -
	PLOT DATE = 10/30/2014	DATE -	REVISED -

**STATE OF ILLINOIS
DEPARTMENT OF TRANSPORTATION**

TYPICAL CROSS SECTIONS

SCALE: SHEET OF SHEETS STA. TO STA.

F.A.P. RTE.	SECTION	COUNTY	TOTAL SHEETS	SHEET NO.
•	D7 HMA RESURF 2015-5	CRAWFORD	11	5
•	781 & 332	CONTRACT NO. 74680		

ILLINOIS FED. AID PROJECT

TYPICAL CROSS SECTION

IL RTE 33

STATION TO STATION
 1027 + 80 0 + 00 1021 + 23 2 + 44 (STA EQ 1021 + 23 BK = 0 + 00 AH)

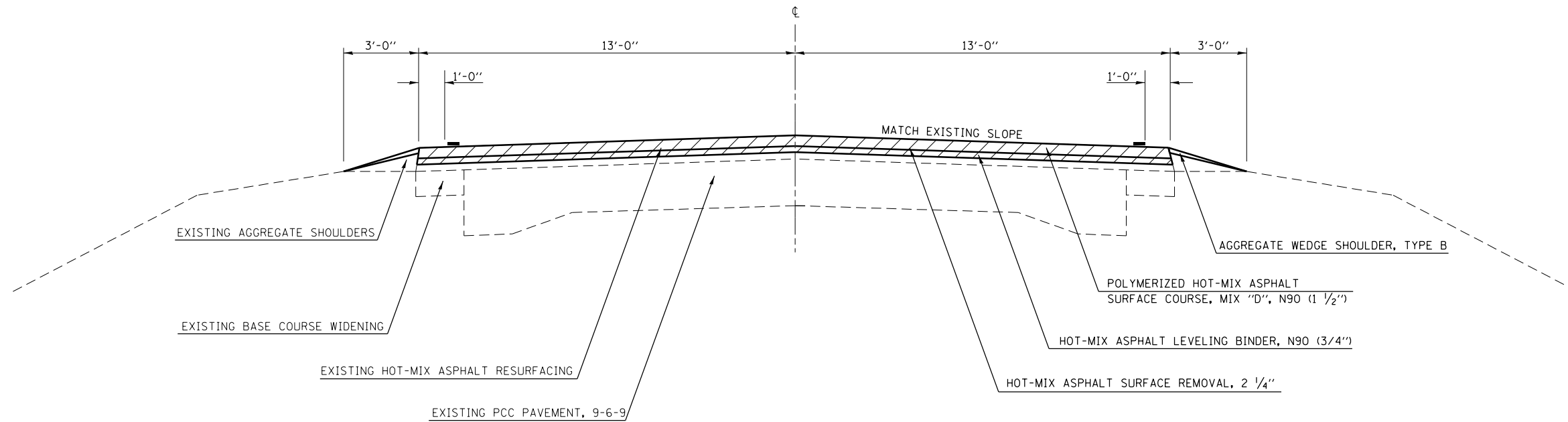

FILE NAME =	USER NAME = steffenmk	DESIGNED -	REVISED -
ci:\pw\work\p\idot\steffenmk\d0396986\074680\sh-t\typcals.dgn	74680-sh-t\typcals.dgn	DRAWN -	REVISED -
Default	PLOT SCALE = 100.0000' / in.	CHECKED -	REVISED -
	PLOT DATE = 10/30/2014	DATE -	REVISED -

STATE OF ILLINOIS
 DEPARTMENT OF TRANSPORTATION

TYPICAL CROSS SECTIONS

SCALE: SHEET OF SHEETS STA. TO STA.

F.A.P. RTE.	SECTION	COUNTY	TOTAL SHEETS	SHEET NO.
•	D7 HMA RESURF 2015-5	CRAWFORD	11	6
•	781 & 332	CONTRACT NO. 74680		
ILLINOIS FED. AID PROJECT				

PAVING SCHEDULE

	LOCATION		LENGTH (FOOT)	QUANTITY (POUND)	QUANTITY (SQ YD)	QUANTITY (TON)	QUANTITY (TON)	QUANTITY SQ YD	QUANTITY (TON)	
	STATION TO STATION									
	1027+80.00	1021+23.00								
IL 33	STA EQ = 1021+23 BK = 0+00 AH									
	00+00.00	2+44.00	244.00	475.8	21.7	29.61	59.21	704.90	7.30	
	NE QUAD OF INTERSECTION=			43.9			2.73	5.46	65.00	
	NW QUAD OF INTERSECTION=			49.3			3.07	6.14	73.10	
	SE QUAD OF INTERSECTION=			41.7			2.60	5.19	61.80	
	SW QUAD OF INTERSECTION=			35.7			2.22	4.44	52.90	
	TOTAL FOR IL 33=			1927.6	43.4	120.0	239.9	2855.7	27.0	
	IL 1	1000+45.00	1008+92.00	847.00	1524.60	40	94.86	189.73	2258.70	23.6
RAILROAD OMISSION: 1008+92 TO 1009+00										
1009+00.00		1016+88.00	788.00	1595.70	45	99.29	198.58	2364.00		
TOTAL FOR IL 1=			3120.3	85.0	194.2	388.3	4622.7	23.6		
GRAND TOTAL=				5048	128	314	628	7478	51	

PAVEMENT MARKING SCHEDULE

	LOCATION		LENGTH (FT)	70300100 SHORT TERM PAVEMENT MARKING			70300220 TEMPORARY PAVEMENT MARKING - LINE 4"			70300280 TEMPORARY PAVEMENT MARKING LINE, 24"	70300210 TEMPORARY PAVEMENT MARKING LINES, LETTERS AND SYMBOLS	70301000 WORK ZONE PAVEMENT MARKING REMOVAL		78001110 PAINT PAVEMENT MARKING - LINE 4"			78004280 PREFORMED PLASTIC PAVEMENT MARKING, TYPE B - INLAID - LINE 24"	78004200 PREFORMED PLASTIC PAVEMENT MARKING, TYPE B - INLAID - LETTERS AND SYMBOLS
	STATION TO STATION			YELLOW CENTERLINE (FT)	WHITE EDGELINE (FT)	YELLOW CENTERLINE (FT)	YELLOW NO PASSING ZONE (FT)	WHITE EDGELINE (FT)	WHITE STOP BARS (FT)	WHITE RAILROAD (SO FT)	YELLOW CENTERLINE (FT)	WHITE EDGELINE (FT)	YELLOW CENTERLINE (FT)	YELLOW NO PASSING ZONE (FT)	WHITE EDGELINE (FT)	WHITE STOP BARS (FT)	WHITE RAILROAD (SO FT)	
	1027+80.00	1021+23.00		197.1	157.7	164.25		1314.00	26.0		21.90	17.50	164.25		1314.0	26.0		
IL 33	STA EQ = 1021+23 BK = 0+00 AH																	
	00+00.00	2+44.00	244.00	73.2	58.6	61		488.00		8.10	6.50	61.00		488.00				
	TOTAL FOR IL 33=			270.3	216.2	225.3	0.0	1802.0	26.0	30.0	24.0	225.3	0.0	1802.0	26.0			
	IL 1	1000+45.00	1008+92.00	847.00	254.1	203.3	211.75		1694.00	12.0	28.20	22.60	211.75		1694.00	12.0		
RAILROAD OMISSION: 1008+92 TO 1009+00																		
1009+00.00		1016+88.00	788.00	236.4	189.1	197		1576.00	34.0	26.30	21.00	197.00		1576.00	34.0			
1005+06.00		1009+06.00	400.00				400.00		62.0			400.00			62.0			
1010+32.00		1015+52.00	520.00				520.00		24.0			520.00			24.0			
TOTAL FOR IL 1=			490.5	392.4	408.8	920.0	3270.0	70.0	54.5	43.6	408.8	920.0	3270.0	70.0				
TOTAL FOR IL 33 & IL 1=			761	609	634	920	5072	96	85	68	634	920	5072	96				
GRAND TOTAL=			1369			6626		96	62	152		6626		96	62			

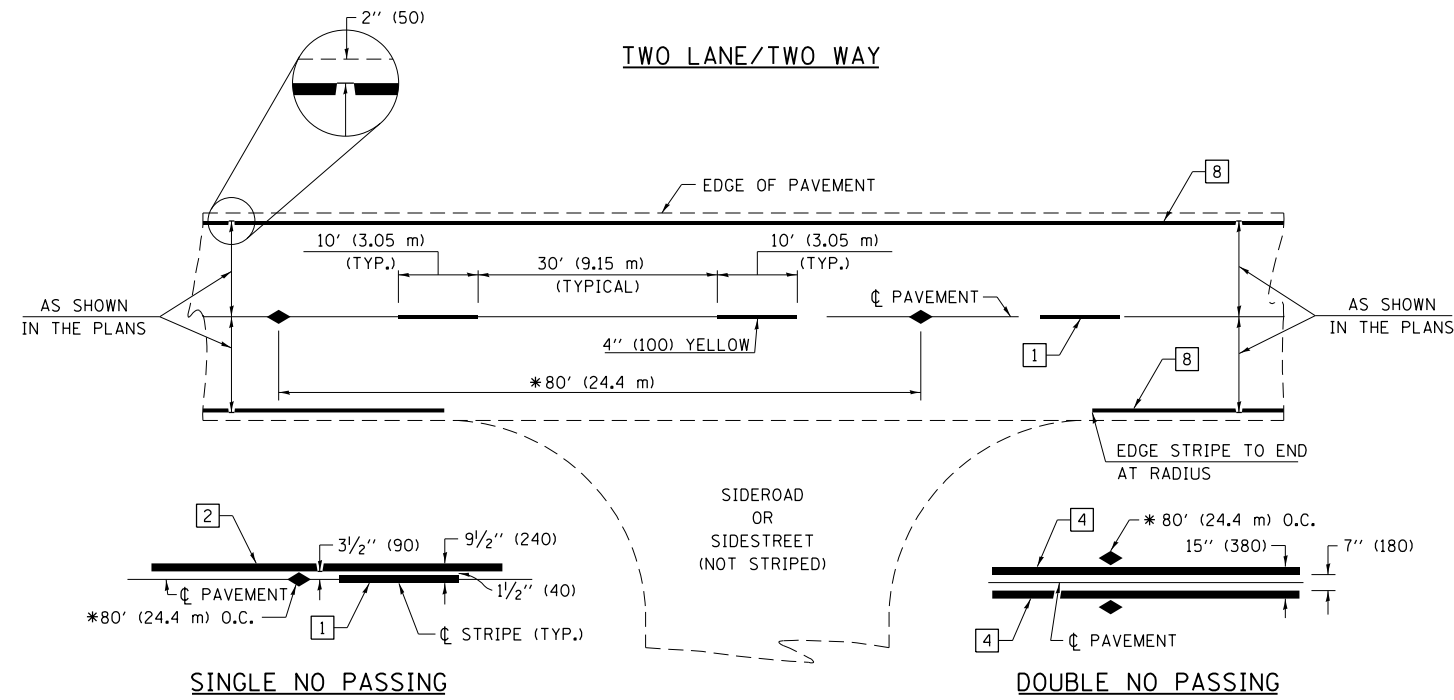

* REDUCE TO 40' (12.2 m) O.C. ON CURVES WITH POSTED OR ADVISORY SPEEDS OF 45 mph (70 km/h) OR LESS.

PAVEMENT MARKING LEGEND

- 1 4" (100) SKIP-DASH (YELLOW)
 - 2 4" (100) SOLID (YELLOW)
 - 3 12" (300) DIAGONAL (YELLOW)
 - 4 4" (100) DOUBLE YELLOW (NARROW)
 - 5 12" (300) SOLID WHITE
 - 6 RESERVED
 - 7 6" (150) SKIP-DASH (WHITE)
 - 8 4" (100) SOLID (WHITE)
 - 9 12" (300) DIAGONAL (WHITE)
 - 10 6" (150) SOLID (WHITE)
 - 11 24" (600) STOP BAR (WHITE)
 - 12 8" (200) SOLID (WHITE)
 - 13 4" (100) PARKING WHITE
-

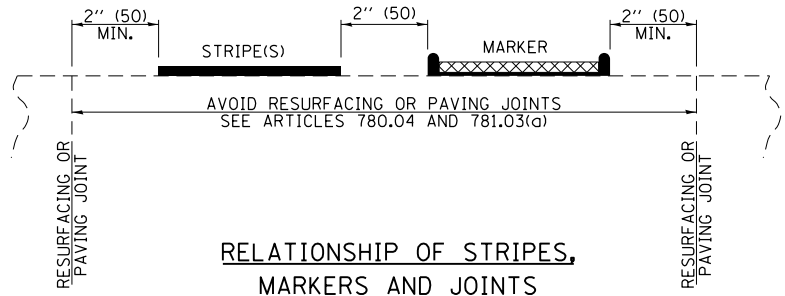

TYPICAL PAVEMENT MARKERS LEGEND

- ◆ TWO-WAY AMBER MARKER
- ▶ ONE-WAY AMBER MARKER
- ▷ ONE-WAY CRYSTAL MARKER

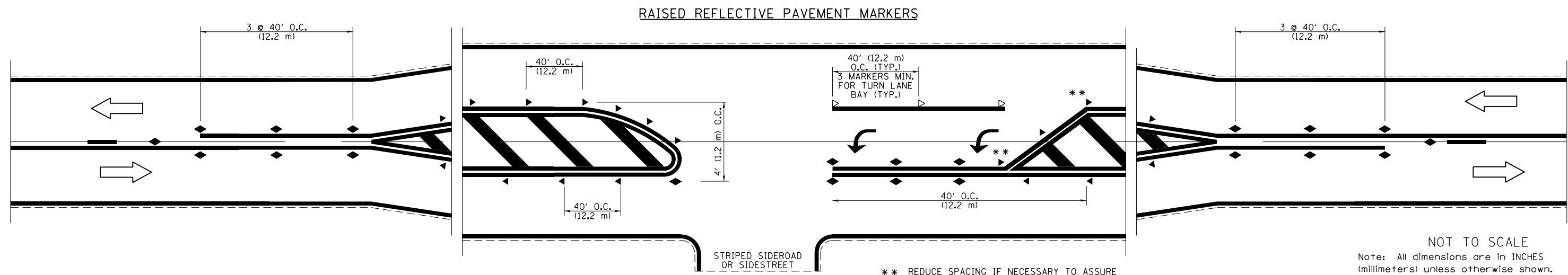

NOT TO SCALE
 Note: All dimensions are in INCHES (millimeters) unless otherwise shown.

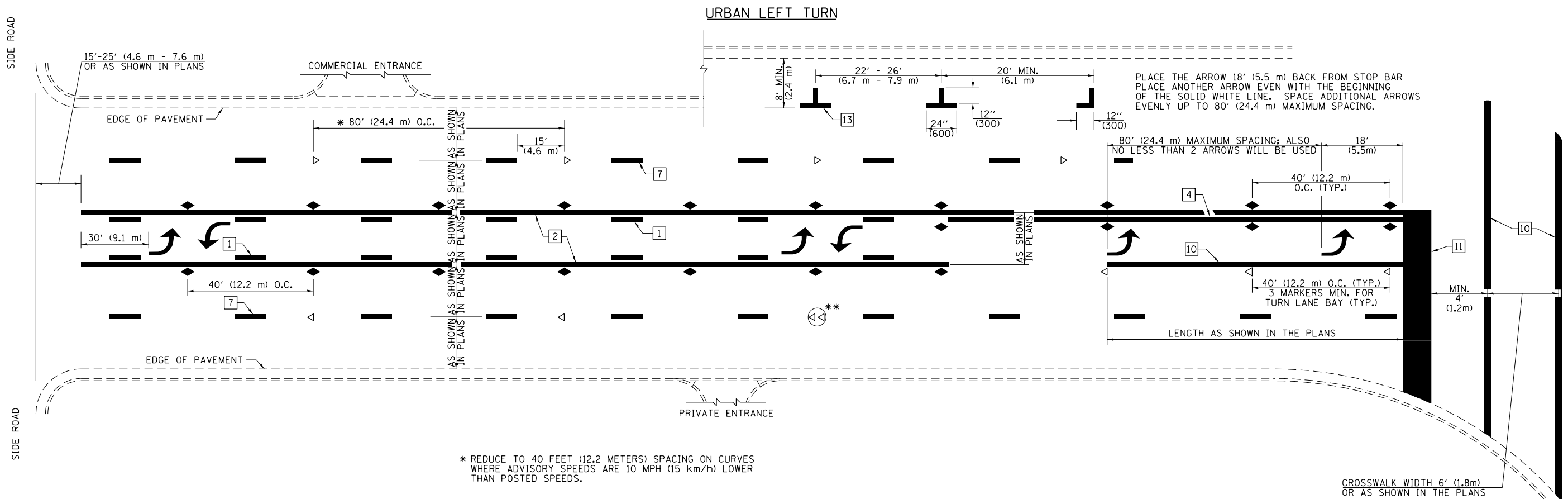

PLACE THE ARROW 18' (5.5 m) BACK FROM STOP BAR
 PLACE ANOTHER ARROW EVEN WITH THE BEGINNING
 OF THE SOLID WHITE LINE. SPACE ADDITIONAL ARROWS
 EVENLY UP TO 80' (24.4 m) MAXIMUM SPACING.

* REDUCE TO 40 FEET (12.2 METERS) SPACING ON CURVES
 WHERE ADVISORY SPEEDS ARE 10 MPH (15 km/h) LOWER
 THAN POSTED SPEEDS.

** DOUBLE LANE LINE MARKERS SHALL BE SPECIFIED
 AND SPACED AS SHOWN IN HIGHWAY STANDARD
 781001 FOR MULTI-LANE DIVIDED AND UNDIVIDED
 HIGHWAYS.

PAVEMENT MARKING LEGEND

- 1 4" (100) SKIP-DASH (YELLOW)
- 2 4" (100) SOLID (YELLOW)
- 3 12" (300) DIAGONAL (YELLOW)
- 4 4" (100) DOUBLE YELLOW (NARROW)
- 5 12" (300) SOLID WHITE
- 6 RESERVED
- 7 6" (150) SKIP-DASH (WHITE)
- 8 4" (100) SOLID (WHITE)
- 9 12" (300) DIAGONAL (WHITE)
- 10 6" (150) SOLID (WHITE)
- 11 24" (600) STOP BAR (WHITE)
- 12 8" (200) SOLID (WHITE)
- 13 4" (100) PARKING WHITE

GENERAL NOTES

1. TURN ARROW PAIRS SHALL BE PLACED AT 250' (75 m) INTERVALS AND SHALL BE EVENLY SPACED BETWEEN BOTH ENDS OF THE BIDIRECTIONAL LEFT TURN LANE. USE A MINIMUM OF TWO PAIRS PER BLOCK.
2. THE SOLID YELLOW PAVEMENT MARKINGS [2] SHOULD GENERALLY START OR END NEAR THE RADIUS POINT OF EACH STREET RETURN EXCEPT WHERE ONE OR BOTH ENDS WOULD INCLUDE STOP BARS.
3. THE SKIP-DASH PAVEMENT MARKINGS [1] OR [7] SHOULD BE CENTERED BETWEEN BOTH ENDS OF EACH CITY BLOCK AND SHALL BE PLACED SO THEY LINE UP ACROSS FROM EACH OTHER.
4. USE LARGE ARROW SIZE FOR BOTH RURAL AND URBAN LOCATIONS. (SEE LAST PAGE OF SECTION 780x FOR SYMBOLS TABLE)
5. LANE LINE EXTENSIONS SHALL BE THE SAME COLOR AND WIDTH AS THE LANE LINE BEING EXTENDED.

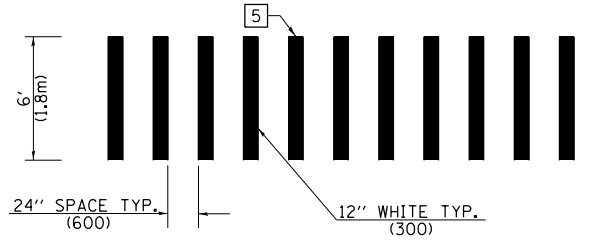

**CROSSWALK DETAIL
 (DECATUR CITY LIMITS ONLY)**

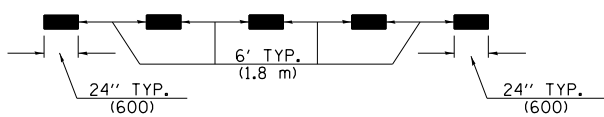

LANE LINE EXTENSIONS

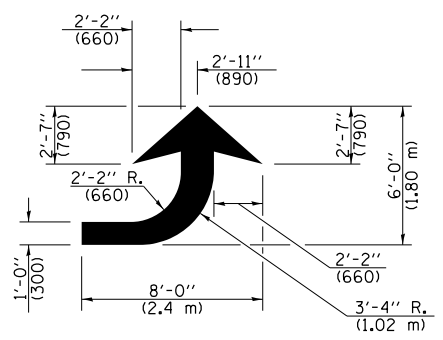

LEFT ARROW
 REVERSE FOR RIGHT ARROW
 AREA = 15.6 SQ. FT. (1.47 m²)
 (WHITE)

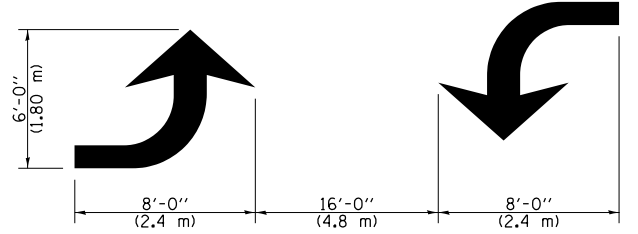

**TYPICAL DOUBLE
 TURN ARROWS (WHITE)**

NOT TO SCALE

Note: All dimensions are in INCHES
 (millimeters) unless otherwise shown.

DISTRICT 7 DETAIL NO. 78000001

FILE NAME =	USER NAME = steffenmk	DESIGNED -	REVISED -	STATE OF ILLINOIS DEPARTMENT OF TRANSPORTATION	PAVEMENT MARKING AND RAISED REFLECTIVE PAVEMENT MARKERS (RURAL & URBAN APPLICATIONS)	F.A.P. RTE.	SECTION	COUNTY	TOTAL SHEETS	SHEET NO.	
ei:\pw\work\p\idot\stevfemk\d0396986\074680-sht-details.dgn	PLOT SCALE = 2.0000' / in.	DRAWN -	REVISED -			• D7 HMA RESURF 2015-5	CRAWFORD	11	9		
	PLOT DATE = 10/30/2014	CHECKED -	REVISED -			• 781 & 332	CONTRACT NO. 74680	ILLINOIS FED. AID PROJECT			
		DATE -	REVISED -			SCALE:	SHEET NO. 2 OF 4 SHEETS	STA.	TO STA.		

ISLAND

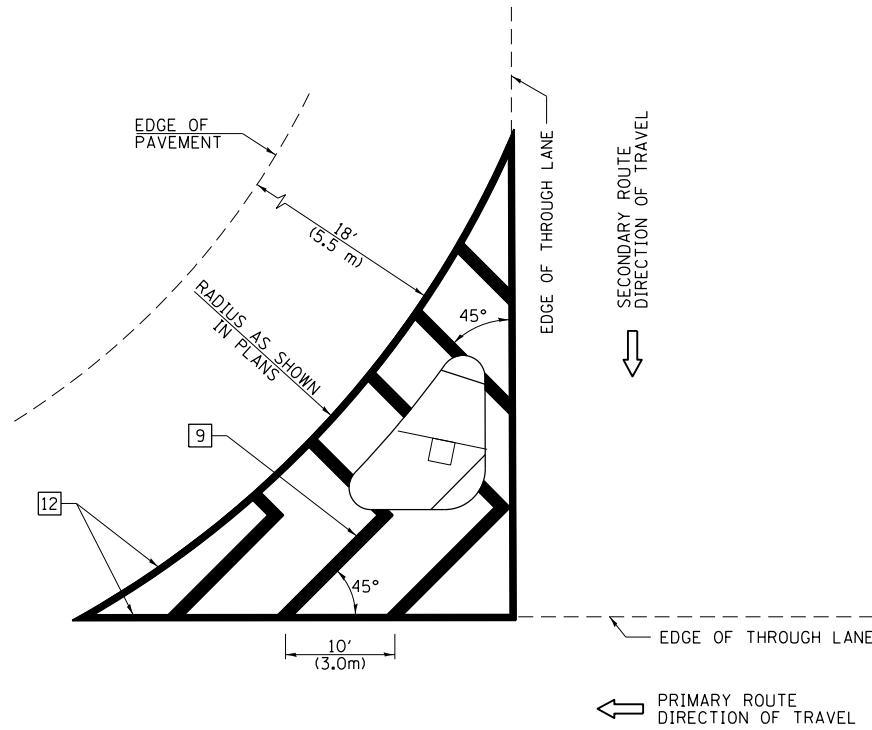

GENERAL NOTES

1. RAISED AND CORRUGATED MEDIANS SHALL BE OUTLINED WITH [2] IF PRESENT.
2. SOME OF THE INFORMATION INCLUDED WITH THIS DETAIL MAY NOT BE APPLICABLE TO THIS IMPROVEMENT.
3. PAVEMENT MARKINGS ARE TO BE EXTENDED THROUGH OMISSIONS WHEN APPLICABLE.
4. FINAL PAVEMENT MARKINGS SHALL BE IN PLACE PRIOR TO PLACING ANY RAISED REFLECTIVE PAVEMENT MARKERS.
5. THE FOLLOWING CRITERIA SHALL BE USED FOR SELECTING THE DIAGONAL PAVEMENT MARKING SPACING:

< 30 MPH (< 50 km/h)	15' (4.5 m)
30-45 MPH (50-75 km/h)	20' (6.0 m)
> 45 MPH (> 75 km/h)	30' (9.0 m)

PAVEMENT MARKING LEGEND

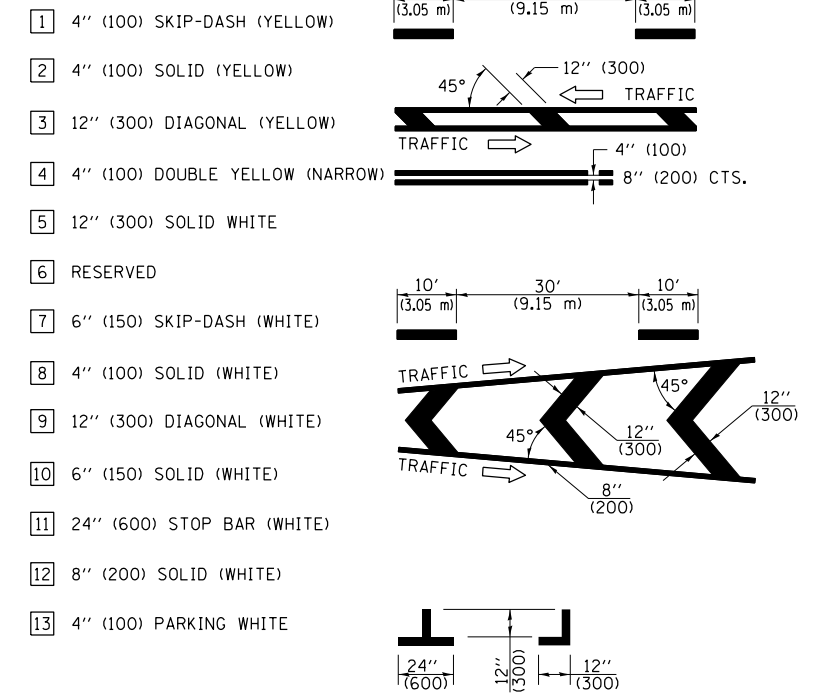

RURAL LEFT TURN STRIPING

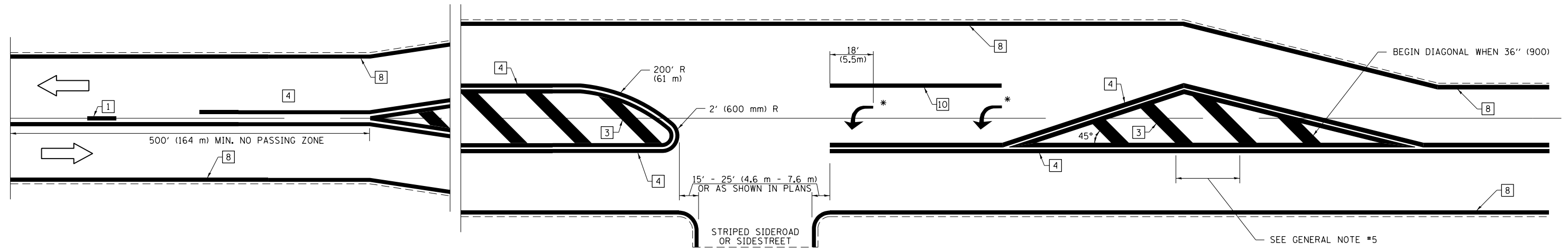

* PLACE AN ARROW 18' (5.5 m) BACK FROM STOP BAR. PLACE ANOTHER ARROW EVEN WITH THE BEGINNING OF THE SOLID WHITE LINE. SPACE ADDITIONAL ARROWS EVENLY UP TO 80' (24.4 m) MAXIMUM SPACING. USE MINIMUM OF 2 ARROWS.

NOT TO SCALE

Note: All dimensions are in INCHES (millimeters) unless otherwise shown.

DISTRICT 7 DETAIL NO. 7800001

FILE NAME =	USER NAME = steffenmk	DESIGNED -	REVISED -
ei:\pwork\pwork\stevfenmk\d0396986\074680-sht-details.dgn		DRAWN -	REVISED -
	PLOT SCALE = 2.0000' / in.	CHECKED -	REVISED -
	PLOT DATE = 10/30/2014	DATE -	REVISED -

**STATE OF ILLINOIS
DEPARTMENT OF TRANSPORTATION**

**PAVEMENT MARKING AND RAISED REFLECTIVE PAVEMENT MARKERS
(RURAL & URBAN APPLICATIONS)**

SCALE: SHEET NO. 3 OF 4 SHEETS STA. TO STA.

F.A.P. RTE.	SECTION	COUNTY	TOTAL SHEETS	SHEET NO.
• 781 & 332	D7 HMA RESURF 2015-5	CRAWFORD	11	10
CONTRACT NO. 74680			ILLINOIS FED. AID PROJECT	

PAVEMENT MARKINGS AT RAILROAD-HIGHWAY GRADE CROSSING

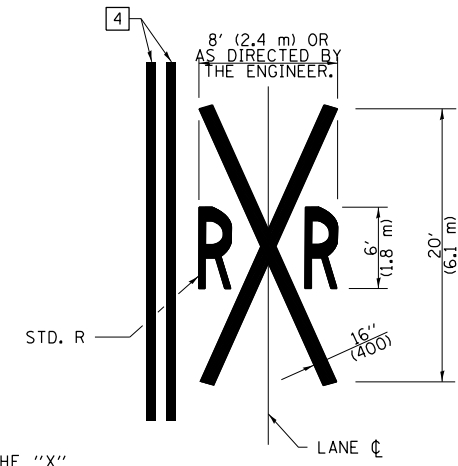
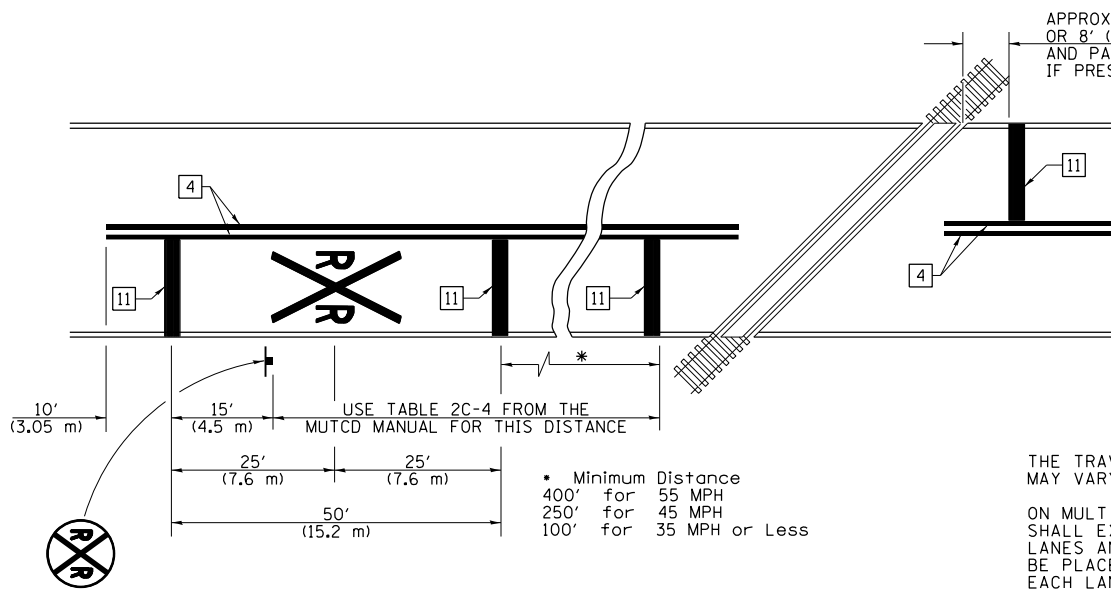

NOTES

THE TRAVERSE SPREAD OF THE "X" MAY VARY ACCORDING TO LANE WIDTH.

ON MULTI-LANE ROADS, THE STOP LINES SHALL EXTEND ACROSS ALL APPROACH LANES AND SEPARATE RXR SYMBOLS SHALL BE PLACED ADJACENT TO EACH OTHER IN EACH LANE.

WHEN THE PAVEMENT MARKING SYMBOL IS USED, A PORTION OF THE SYMBOL SHOULD BE LOCATED DIRECTLY ADJACENT TO THE ADVANCE WARNING SIGN (W10-1) AS PLACED BY TABLE II-1, CONDITION B OF THE MUTCD.

PAVEMENT MARKING LEGEND

- 1 4" (100) SKIP-DASH (YELLOW)
 - 2 4" (100) SOLID (YELLOW)
 - 3 12" (300) DIAGONAL (YELLOW)
 - 4 4" (100) DOUBLE YELLOW (NARROW)
 - 5 12" (300) SOLID WHITE
 - 6 RESERVED
 - 7 6" (150) SKIP-DASH (WHITE)
 - 8 4" (100) SOLID (WHITE)
 - 9 12" (300) DIAGONAL (WHITE)
 - 10 6" (150) SOLID (WHITE)
 - 11 24" (600) STOP BAR (WHITE)
 - 12 8" (200) SOLID (WHITE)
 - 13 4" (100) PARKING WHITE
-

RAILROAD CROSSING WITH INTERCONNECT ONLY

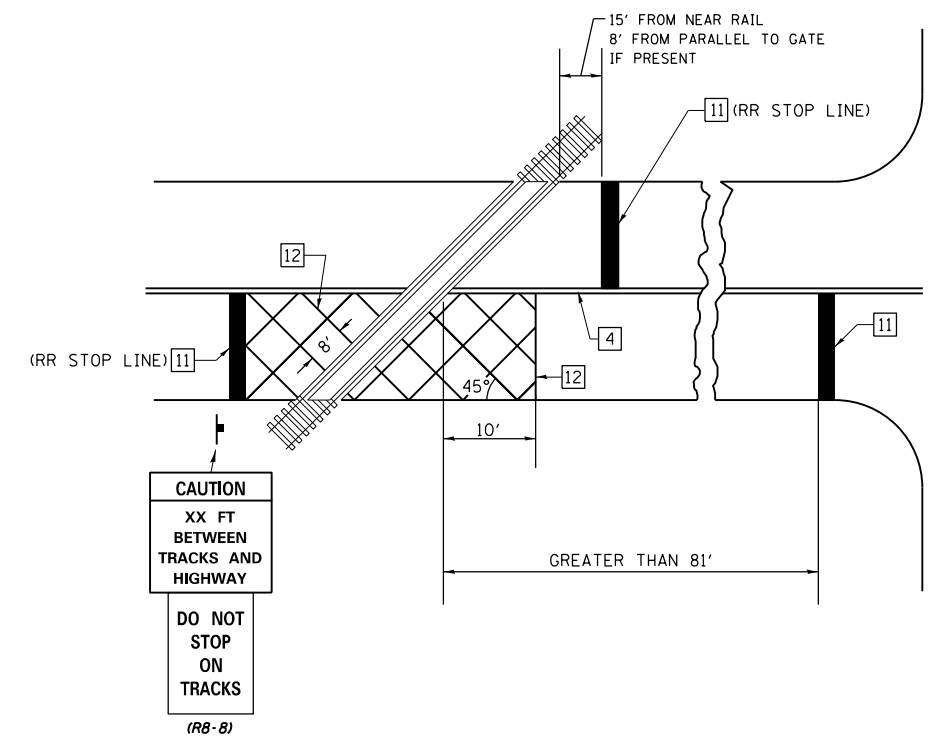

RAILROAD CROSSING WITH INTERCONNECT AND PRE-SIGNALS

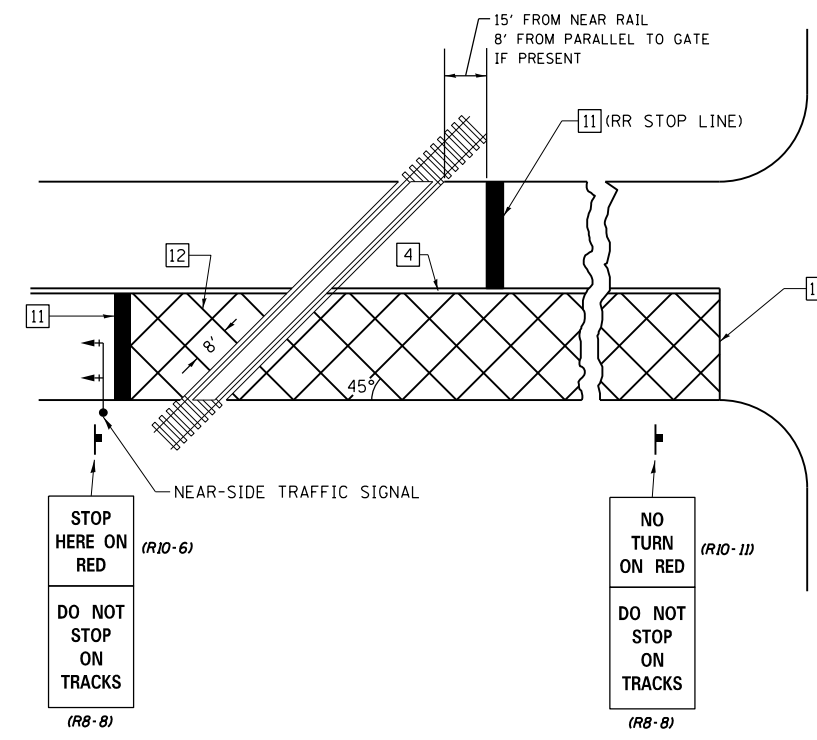

SUPPLEMENTAL PAVEMENT MARKING TREATMENT FOR RAILROAD-HIGHWAY GRADE CROSSING

GENERAL NOTES

- SUPPLEMENTAL PAVEMENT MARKINGS TO BE INSTALLED ONLY ON APPROACHES TO INTERSECTIONS CONTROLLED BY TRAFFIC SIGNALS WHICH ARE INTERCONNECTED WITH THE RAILROAD WARNING SIGNALS.
- EXTEND PAVEMENT MARKINGS TO THE INTERSECTION ONLY WHERE NEAR-SIDE TRAFFIC SIGNALS ARE USED.

NOT TO SCALE

Note: All dimensions are in INCHES (millimeters) unless otherwise shown.

DISTRICT 7 DETAIL NO. 7800001

FILE NAME =	USER NAME = steffenmk	DESIGNED -	REVISED -	STATE OF ILLINOIS DEPARTMENT OF TRANSPORTATION	PAVEMENT MARKING AND RAISED REFLECTIVE PAVEMENT MARKERS (RURAL & URBAN APPLICATIONS)	F.A.P. RTE.	SECTION	COUNTY	TOTAL SHEETS	SHEET NO.
c:\pwork\pwork\stevfenmk\d0396986\074680-sht-details.dgn		DRAWN -	REVISED -			• D7 HMA RESURF 2015-5	CRAWFORD	11	11	
PLOT SCALE = 2.0000' / in.		CHECKED -	REVISED -			• 781 & 332	CONTRACT NO. 74680			
PLOT DATE = 10/30/2014		DATE -	REVISED -			ILLINOIS FED. AID PROJECT				