

STATE OF ILLINOIS
DEPARTMENT OF TRANSPORTATION
DIVISION OF HIGHWAYS

F.A. RTE.	SECTION	COUNTY	TOTAL SHEETS	SHEET NO.
	12-00107-00-SP	COOK	17	1
		ILLINOIS	CONTRACT NO. 61B02	

FOR INDEX OF SHEETS, SEE SHEET NO. 2

DESIGN DESIGNATION:
LAKE ST = LOCAL ROAD
POSTED SPEED LIMIT:
25 MPH

TRAFFIC = 2000 ADT (2014)

PLANS FOR PROPOSED
FEDERAL AID HIGHWAY
LAKE STREET
PARKVIEW SCHOOL TO AUSTIN AVENUE
SIDEWALKS, PAVEMENT MARKING, AND SIGNING
SECTION 12-00107-00-SP
PROJECT SRTS-4009(290)
VILLAGE OF MORTON GROVE
COOK COUNTY



CHRIS R. TOMICH, VILLAGE ENGINEER
VILLAGE OF MORTON GROVE

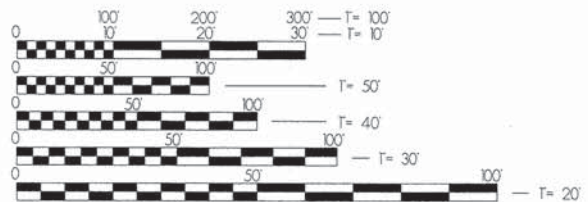

FULL SIZE PLANS HAVE BEEN PREPARED USING STANDARD ENGINEERING SCALES. REDUCED SIZED PLANS WILL NOT CONFORM TO STANDARD SCALES. IN MAKING MEASUREMENTS ON REDUCED PLANS, THE ABOVE SCALES MAY BE USED.

JULIE
JOINT UTILITY LOCATION INFORMATION FOR EXCAVATION
1-800-892-0123
OR 811

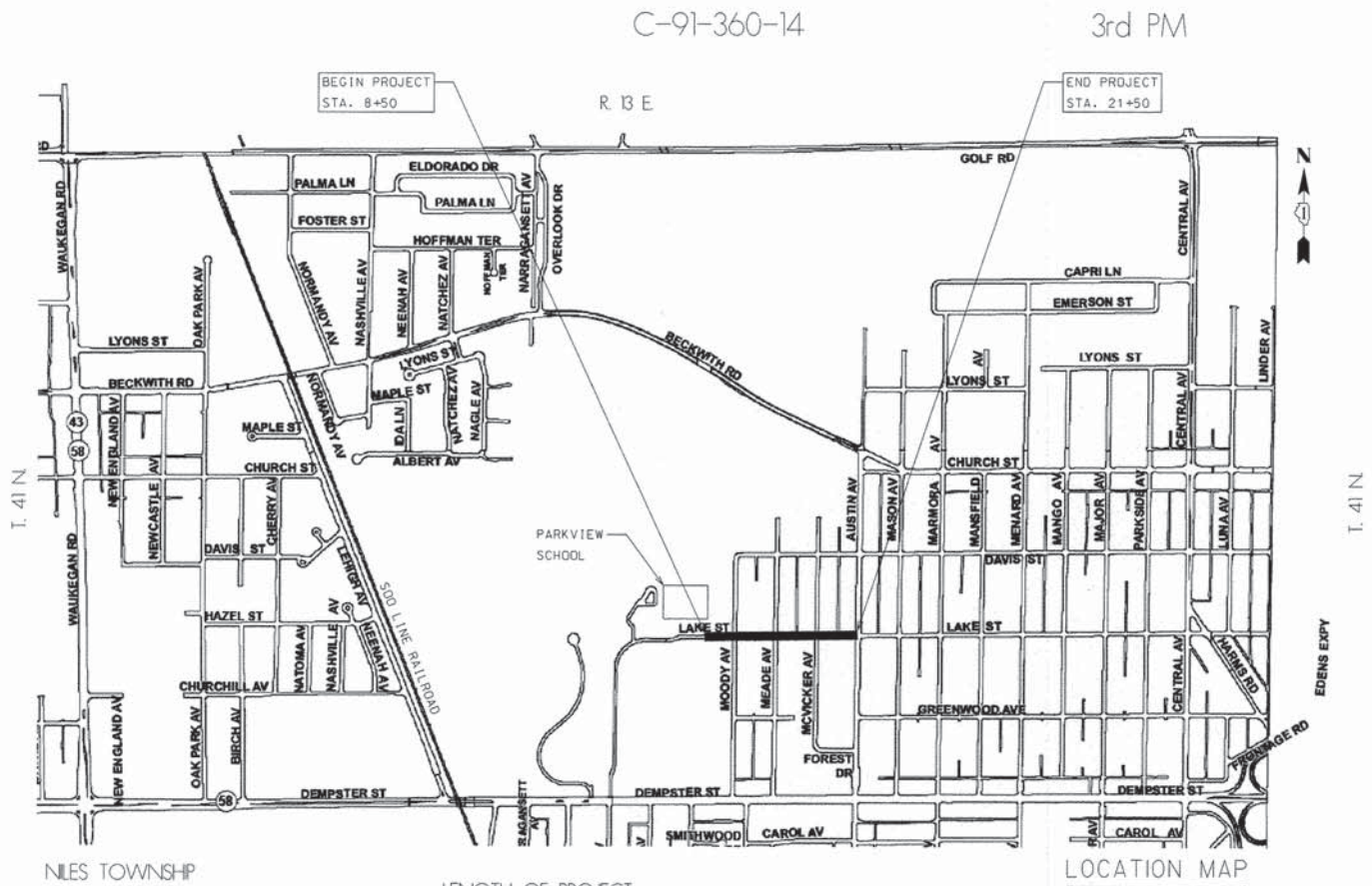

LENGTH OF PROJECT
LAKE ST - GROSS LENGTH = 1300.00 FT. = 0.246 MILE
LAKE ST - NET LENGTH = 1300.00 FT. = 0.246 MILE

LOCATION MAP
N.T.S.

STATE OF ILLINOIS
DEPARTMENT OF TRANSPORTATION
DIVISION OF HIGHWAYS

Approved: December 15, 2014
Chris R. Tomich
VILLAGE OF MORTON GROVE VILLAGE ENGINEER

Passed: December 22, 2014
Christopher Holt
DISTRICT 1 ENGINEER OF LOCAL ROADS & STREETS

Releasing for Bid: December 22, 2014
Based on Limited Review: *John F. ...*
DEPUTY DIRECTOR OF HIGHWAYS, REGION 1 ENGINEER

PRINTED BY THE AUTHORITY
OF THE STATE OF ILLINOIS

FEDERAL AID PROGRAM ENGINEER: FAWAD AGUEL, P.E. 847-705-4021 SCHALMBURG, IL

INDEX OF SHEETS

1. COVER SHEET
2. INDEX OF SHEETS / IDOT STANDARDS / GENERAL NOTES
3. SUMMARY OF QUANTITIES
4. TYPICAL SECTIONS
5. PLANS - LAKE ST-PARKVIEW SCHOOL TO MCVICKER AVE
6. PLANS - LAKE ST - MCVICKER AVE TO AUSTIN AVE
7. CURB RAMP DETAILS - MOODY AVE AT LAKE ST
8. CURB RAMP DETAILS - MEADE AVE AT LAKE ST
9. CURB RAMP DETAILS - MCVICKER AVE AT LAKE ST
10. SPECIAL DETAILS - SHEET 1
11. SPECIAL DETAILS - SHEET 2
12. CONSTRUCTION DETAILS
13. CURB OR CURB AND GUTTER REMOVAL AND REPLACEMENT (BD-24)
14. TRAFFIC CONTROL AND PROTECTION FOR SIDE ROADS, INTERSECTIONS, AND DRIVEWAYS (TC-10)
15. DISTRICT ONE TYPICAL PAVEMENT MARKINGS (TC-13)
16. ARTERIAL ROAD INFORMATION SIGN (TC-22)
17. MISC. ELECTRICAL DETAILS - SHEET A (BE-702)

IDOT STATE HIGHWAY STANDARDS

000001-06	STANDARD SYMBOLS, ABBREVIATIONS, AND PATTERNS
424001-08	PERPENDICULAR CURB RAMPS FOR SIDEWALKS
424006-02	DIAGONAL CURB RAMPS
424011-02	CORNER PARALLEL CURB RAMPS
424016-02	MID-BLOCK CURB RAMPS FOR SIDEWALKS
424021-03	DEPRESSED CORNER FOR SIDEWALKS
424026-01	ENTRANCE/ALLEY PEDESTRIAN CROSSINGS
424031-01	MEDIAN PEDESTRIAN CROSSINGS
442201-03	CLASS C & D PATCHES
604001-04	FRAME AND LIDS, TYPE I
606001-06	CONCRETE CURB AND COMBINATION CONCRETE CURB AND GUTTER
701006-05	OFF ROAD OPERATIONS, 2L, 2W, 15' TO 24' TO PAVEMENT EDGE
701301-04	LANE CLOSURE, 2L, 2W, SHORT TIME OPERATIONS
701311-03	LANE CLOSURE, 2L, 2W, MOVING OPERATIONS - DAY ONLY
701501-06	URBAN LANE CLOSURE, 2L, 2W UNDIVIDED
701801-05	SIDEWALK, CORNER, OR CROSSWALK CLOSURE
701901-04	TRAFFIC CONTROL DEVICES
780001-05	TYPICAL PAVEMENT MARKINGS
821101-01	LUMINAIRE WIRING DIAGRAM
836001-02	LIGHT POLE FOUNDATION

A. GENERAL

1. **EARTHWORK AND PAVING SPECIFICATIONS**
THE ILLINOIS DEPARTMENT OF TRANSPORTATION "STANDARD SPECIFICATIONS FOR ROAD AND BRIDGE CONSTRUCTION," ADOPTED JANUARY 1, 2012, AND ALL ADDENDA THERETO, SHALL GOVERN THE PAVING WORK UNDER THIS CONTRACT, EXCEPT AS MODIFIED BY THESE SPECIFICATIONS.
2. **UNDERGROUND SPECIFICATIONS**
THE "STANDARD SPECIFICATIONS FOR WATER AND SEWER MAIN CONSTRUCTION IN ILLINOIS," LATEST EDITION, SHALL GOVERN THE UNDERGROUND WORK UNDER THIS CONTRACT, EXCEPT AS MODIFIED BY THESE SPECIFICATIONS.
3. **WORK**
WORK SHALL MEAN THE FURNISHING OF ALL LABOR, MATERIAL, EQUIPMENT AND OTHER INCIDENTALS NECESSARY OR CONVENIENT TO THE SUCCESSFUL COMPLETION OF THE IMPROVEMENTS DESIGNED BY THE ENGINEER AND SHOWN ON THIS SET OF PLANS. WORK SHALL ALSO INCLUDE CARRYING OUT OF ALL THE DUTIES AND OBLIGATIONS IMPOSED BY THE AGREEMENT BETWEEN THE OWNER AND THE CONTRACTOR FOR THE PROPER INSTALLATION AND ACCEPTANCE OF THE IMPROVEMENTS DESIGNED BY THE ENGINEER AND SHOWN ON THIS SET OF PLANS.
4. **COMPLIANCE WITH LOCAL ORDINANCES**
ALL WORK PERFORMED UNDER THIS CONTRACT SHALL BE IN ACCORDANCE WITH THE VILLAGE OF MORTON GROVE'S ORDINANCES AND STANDARDS.
5. **EXISTING UTILITIES**
WHEN THE PLANS OR SPECIAL PROVISIONS INCLUDE INFORMATION PERTAINING TO THE LOCATION AND ELEVATIONS OF UTILITY FACILITIES, SUCH INFORMATION REPRESENTS ONLY THE OPINION OF THE ENGINEER AS TO LOCATION AND ELEVATION OF SUCH UTILITIES AND IS ONLY INCLUDED FOR THE CONVENIENCE OF THE BIDDERS. THE ENGINEER AND OWNER ASSUME NO RESPONSIBILITY WHATEVER IN RESPECT TO THE SUFFICIENCY OR ACCURACY OF THE INFORMATION SHOWN ON THE PLANS RELATIVE TO THE LOCATION AND ELEVATION OF UTILITY FACILITIES, NOR THE MANNER IN WHICH THEY ARE TO BE REMOVED OR ADJUSTED. IT IS EACH CONTRACTOR'S AND SUBCONTRACTOR'S RESPONSIBILITY TO VISIT THE SITE AND DETERMINE THE ACTUAL LOCATION AND ELEVATION OF ALL UTILITIES. EACH CONTRACTOR AND SUBCONTRACTOR SHALL OBTAIN FROM THE RESPECTIVE UTILITY COMPANIES DETAILED INFORMATION RELATIVE TO THE LOCATION AND ELEVATION OF THEIR FACILITIES AND THE WORKING SCHEDULES OF THE UTILITY COMPANIES FOR REMOVING OR ADJUSTING THEM.

EACH CONTRACTOR AND SUBCONTRACTOR PERFORMING UNDERGROUND WORK SHALL CONTACT J.U.L.I.E. AT 1-800-892-0123 OR 811 AT LEAST 48 HOURS PRIOR TO START OF WORK.
6. **SAFETY OF WORK**
EACH CONTRACTOR AND SUBCONTRACTOR SHALL BE RESPONSIBLE FOR INITIATING, MAINTAINING AND SUPERVISING ALL SAFETY PRECAUTIONS AND PROGRAMS IN CONNECTION WITH THE WORK. EACH CONTRACTOR AND SUBCONTRACTOR SHALL TAKE ALL NECESSARY PRECAUTIONS FOR THE SAFETY OF, AND SHALL PROVIDE THE NECESSARY PROTECTION TO PREVENT DAMAGE, INJURY, OR LOSS TO:

A) ALL EMPLOYEES ON THE WORK AND OTHER PERSONS AND ORGANIZATIONS WHO MAY BE AFFECTED THEREBY.

B) ALL THE WORK AND MATERIALS AND EQUIPMENT TO BE INCORPORATED THEREIN, WHETHER IN STORAGE ON OR OFF THE SITE; AND

C) OTHER PROPERTY AT THE SITE OR ADJACENT THERETO, INCLUDING TREES, SHRUBS, LAWNS, WALKS, PAVEMENTS, ROADWAY STRUCTURES, UTILITIES, AND UNDERGROUND FACILITIES NOT DESIGNATED FOR REMOVAL, RELOCATIONS, OR REPLACEMENT IN THE COURSE OF CONSTRUCTION.

D) EACH CONTRACTOR AND SUBCONTRACTOR SHALL DESIGNATE A RESPONSIBLE REPRESENTATIVE AT THE SITE WHOSE DUTY SHALL BE THE PREVENTION OF ACCIDENTS. THIS PERSON SHALL BE THE CONTRACTOR'S SUPERINTENDENT UNLESS OTHERWISE DESIGNATED IN WRITING BY THE CONTRACTOR TO OWNER.
7. **EXISTING ELEVATIONS AND LOCATIONS**
EVERY CONTRACTOR AND SUBCONTRACTOR SHALL VERIFY THE ELEVATIONS AND LOCATIONS OF ALL EXISTING INFORMATION AS SHOWN ON THE PLANS AND NOTIFY THE ENGINEER OF ALL DISCREPANCIES PRIOR TO THE COMMENCEMENT OF THE WORK. EXISTING UNDERGROUND UTILITIES SHALL BE EXPOSED BY THE CONTRACTORS AND SUBCONTRACTORS PRIOR TO THE START OF CONSTRUCTION TO DETERMINE IF A PROBLEM OR CONFLICT EXISTS WITH THE PROPOSED IMPROVEMENTS AND TO AVOID DELAYS IN THE PROGRESS OF THE WORK ONCE THE WORK COMMENCES.

8. NOTIFICATION

THE VILLAGE OF MORTON GROVE AND THE ENGINEER SHALL BE NOTIFIED BY THE CONTRACTOR AT LEAST TWO (2) WORKING DAYS PRIOR TO COMMENCEMENT OF CONSTRUCTION.

9. COMPLIANCE WITH LAWS AND REGULATIONS

EVERY CONTRACTOR SHALL COMPLY WITH ALL LOCAL AND STATE SAFETY LAWS, REGULATIONS AND ORDINANCES, AND FEDERAL SAFETY REGULATIONS AS OUTLINED IN THE LATEST REVISIONS OF THE FEDERAL CONSTRUCTION SAFETY STANDARDS AND WITH ALL PROVISIONS AND REGULATIONS OF THE OCCUPATIONAL SAFETY AND HEALTH ADMINISTRATION (OSHA) STANDARDS. EACH CONTRACTOR IS RESPONSIBLE FOR PROVIDING A SAFE WORKING PLACE FOR HIS EMPLOYEES. EACH CONTRACTOR AND SUBCONTRACTOR IS RESPONSIBLE FOR THE SUPERVISION, DIRECTION, AND CONDUCT OF THEIR EMPLOYEES, AGENTS, MATERIAL SUPPLIERS, AND VENDORS.

10. PAVEMENT DISTURBED DURING CONSTRUCTION

EXISTING ROADWAY PAVEMENT OR SHOULDER DISTURBED DURING CONSTRUCTION SHALL BE RESTORED IN ACCORDANCE WITH IDOT AND VILLAGE OF MORTON GROVE STANDARDS.

11. ITEMS NOT SPECIFICALLY SHOWN

ALL ITEMS THAT ARE NOT SPECIFICALLY SHOWN ON THE PLANS OR IN THE SUMMARY OF QUANTITIES BUT CAN REASONABLY BE INTERPRETED TO BE INCLUDED IN THE WORK DESCRIBED SHALL BE INCLUDED IN THE COST OF THE CONTRACT.

12. RECORD DRAWINGS

EACH CONTRACTOR AND SUBCONTRACTOR SHALL MAINTAIN AND KEEP UP TO DATE A SET OF "RECORD DRAWINGS" SHOWING ALL CHANGES FROM THE ORIGINAL PLANS. ALL CONTRACTORS AND SUBCONTRACTORS SHALL DELIVER THE "RECORD DRAWINGS" TO THE ENGINEER AT THE CONCLUSION OF THE PROJECT. THE ENGINEER WILL TRANSFER THE INFORMATION TO THE ORIGINAL PLANS.

13. CONTRACTOR(S)

FOR THE PURPOSES OF THESE SPECIFICATIONS, THE TERMS CONTRACTOR AND SUBCONTRACTOR SHALL MEAN ANY PERSON OR ENTITY THAT PROVIDES WORK FOR THE IMPROVEMENTS AS SHOWN ON THESE PLANS. THE ENGINEER, OWNER, AND THE ARCHITECT ARE NOT CONSIDERED CONTRACTORS OR SUB CONTRACTORS.

14. ANY SIGN LOCATED IN THE PUBLIC RIGHT-OF-WAY WHICH INTERFERES WITH CONSTRUCTION OF THE PROPOSED ROADWAY OR LIGHTING SYSTEM THAT IS INTENDED TO BE MAINTAINED SHALL BE RELOCATED IN ACCORDANCE WITH ARTICLE 107.25. THIS WORK IS INCLUDED IN THE COST OF THIS PROJECT. ALL WORK INVOLVING SIGN REMOVAL SHALL BE GOVERNED BY THE FOLLOWING REQUIREMENTS.

EVERY SIGN RELOCATED MUST BE RE-ERECTED AT A TEMPORARY LOCATION AND BE VISIBLE TO TRAFFIC FOR WHICH IT WAS INTENDED. ALL SUCH SIGNS MUST BE MAINTAINED STRAIGHT AND CLEAN FOR THE DURATION OF THE TEMPORARY SETTING. THIS WORK INCLUDES PROVIDING A SIGN POST FOR THE TEMPORARY LOCATION, SHOULD SUCH A POST BE NECESSARY.

ALL SIGNS SHALL BE RE-ERECTED IN THE ORIGINAL LOCATION AS THE IMPROVEMENTS ARE COMPLETED.

THE CONTRACTOR SHALL BE RESPONSIBLE FOR ANY SIGNS DAMAGED BY HIS/HER CONSTRUCTION ACTIVITIES AND WILL REPLACE THEM AT NO ADDITIONAL COST. THIS WORK SHALL BE INCLUDED IN THE COST OF THE CONTRACT.

15. DRIVEWAY APRON REPAIRS

PROPOSED DRIVEWAY APRON REPAIRS ADJACENT TO PROPOSED CURB AND GUTTER SHALL BE THREE FEET MEASURED PERPENDICULAR TO THE BACK-OF-CURB UNLESS INDICATED OTHERWISE ON THE PLANS OR BY THE ENGINEER IN THE FIELD.

IT IS THE CONTRACTOR'S RESPONSIBILITY TO PROTECT EXISTING PCC DRIVEWAY APRONS DURING CURB AND GUTTER REMOVAL AND INSTALLATION. THE CONTRACTOR SHALL BE FULLY RESPONSIBLE FOR ANY DAMAGE TO EXISTING DRIVEWAY APRONS NOT CALLED OUT FOR REPAIR. ALL APRONS NOT CALLED OUT FOR REPAIR BUT WHICH ARE DAMAGED BY THE CONTRACTOR SHALL BE REPLACED BY THE CONTRACTOR AT NO ADDITIONAL COST WITH THE SAME EXISTING MATERIALS INCLUDING, BUT NOT LIMITED TO STAMPED OR COLORED CONCRETE.

B. PAVING

1. THE PAVING CONTRACTOR IS RESPONSIBLE FOR MAINTAINING PROPER DRAINAGE ON THE PROPOSED PAVEMENT. WHERE THE CONTRACTOR IS IN DOUBT ABOUT THE PROPER DIRECTION OF DRAINAGE, HE SHALL REQUEST ASSISTANCE FROM THE ENGINEER.
2. FULL DEPTH SAW CUTS SHALL BE USED TO REMOVE EXISTING PAVEMENT, CURB AND GUTTER, SIDEWALK, DRIVEWAYS, BUTT JOINTS, AND APPURTENANCES FROM MATERIAL TO REMAIN, IN ACCORDANCE WITH SECTION 440 OF THE "STANDARD SPECIFICATIONS." THE COST OF THE SAWING SHALL BE INCLUDED IN THE COST OF THE ITEM REMOVED.
3. BASE COURSE SHALL NOT BE PLACED ADJACENT TO CURB AND GUTTER UNTIL THE CURB AND GUTTER HAS BEEN PROPERLY BACKFILLED TO THE SATISFACTION OF THE ENGINEER.
4. PRIOR TO PLACING HOT-MIX ASPHALT ADJACENT TO EXISTING PAVEMENT TO REMAIN, THE EXPOSED EDGE SHALL BE CLEANED OF LOOSE MATERIAL TO THE SATISFACTION OF THE ENGINEER. THIS WORK SHALL BE CONSIDERED INCLUDED IN THE COST OF THE HOT-MIX ASPHALT BEING PLACED.
5. THE CONTRACTOR SHALL NOT CROSS COMPLETED BASE COURSE OR EXISTING PAVEMENT NOT SCHEDULED TO BE REMOVED WITH TRACK EQUIPMENT.
6. **PRIME COAT**
PRIME COAT MUST BE INSTALLED NO EARLIER THAN TWENTY-FOUR (24) HOURS PRIOR TO PLACEMENT OF HOT-MIX ASPHALT.
7. **BUTT JOINTS**
BUTT JOINT WILL BE INSTALLED AT THE ENDS OF ALL RESURFACING (WHERE RESURFACING MEETS EXISTING PAVEMENT) IN ACCORDANCE WITH THE "BUTT JOINT AND BITUMINOUS TAPER DETAILS" SHEET INCLUDED IN THE PLANS, UNLESS OTHERWISE SPECIFIED.
8. THE LOCATION OF PAVEMENT PATCHING AND COMBINATION CONCRETE CURB AND GUTTER REPAIR ARE AS SHOWN ON THE PLANS OR AS DETERMINED BY THE ENGINEER. THESE SHALL NOT EXCEED THE QUANTITIES LISTED IN THE SUMMARY OF QUANTITIES.

C. RESTORATION AND TREE PRESERVATION

1. ALL DISTURBED LAWN AREAS WITHIN THE PUBLIC RIGHT-OF-WAY/EASEMENTS WILL BE RESTORED WITH 4-10 INCHES OF TOPSOIL AND SALT TOLERANT SOD.
2. ALL PARKWAY TREES SHALL BE PRESERVED. THE CONTRACTOR SHALL BE FULLY RESPONSIBLE FOR ANY DAMAGE TO SUCH TREES.

D. SEWER AND WATER STRUCTURES

1. **FINAL FRAME ADJUSTMENTS**
THE PAVING CONTRACTOR SHALL MAKE ALL NECESSARY FINAL ADJUSTMENTS TO EXISTING AND PROPOSED FRAMES, GRATES, LIDS, AND STRUCTURES TO MEET FINAL FINISHED GRADES.
2. INLETS ARE INCLUDED IN CATCH BASIN PAY ITEMS AND VALVE VAULTS ARE INCLUDED IN MANHOLE PAY ITEMS FOR GENERAL STRUCTURE IMPROVEMENTS INCLUDING ADJUSTMENTS OR RECONSTRUCTION, UNLESS OTHERWISE NOTED.
3. ONLY PRECAST ADJUSTMENT RINGS WILL BE ALLOWED FOR THE ADJUSTMENTS OF CATCH BASINS, MANHOLES, VALVE VAULTS, AND INLETS. NO MORE THAN TWO (2) RINGS FOR TOTAL ADJUSTMENT OF EIGHT (8) INCHES WILL BE ALLOWED.
4. ALL FRAMES AND GRATES DAMAGED BY THE CONTRACTOR DURING CONSTRUCTION WILL BE REPLACED BY THE CONTRACTOR AT HIS EXPENSE.
5. ALL FRAMES WITH CLOSED LIDS FURNISHED AS PART OF THIS CONTRACT FOR CONSTRUCTION, ADJUSTMENT, OR RECONSTRUCTION OF ANY MANHOLE, CATCH BASIN, VALVE VAULT, OR METER VAULT SHALL HAVE CAST INTO THE LID ONE OF THE FOLLOWING WORDS: ALL LIDS USED ON THE STORM SEWER STRUCTURES SHALL BEAR THE WORD "STORM"; ALL LIDS USED ON SANITARY SEWER STRUCTURES SHALL BEAR THE WORD "SANITARY"; ALL LIDS USED ON WATER SYSTEM STRUCTURES SHALL BEAR THE WORD "WATER." THIS SHALL BE INCLUDED IN THE UNIT COST OF THE FRAME AND LID SPECIFIED.

FILE NAME #	USER NAME # USER#	DESIGNED - JFG	REVISED - 12/15/2014	STATE OF ILLINOIS DEPARTMENT OF TRANSPORTATION	INDEX OF SHEETS / IDOT STANDARDS / GENERAL NOTES		F.A. RTE.	SECTION	COUNTY	TOTAL SHEETS	SHEET NO.		
#FILE#		DRAWN - JFG	REVISED -		SCALE: _____	SHEET _____	OF _____	SHEETS	STA. _____	TO STA. _____	ILLINOIS	FED. AID PROJECT	
#MODELNAME#		CHECKED - CRT	REVISED -								COOK	17	2
		DATE - 10/17/2014	REVISED -								CONTRACT NO. 61B02		

SUMMARY OF QUANTITIES			
CODE NO.	ITEM	UNIT	CONSTRUCTION TYPE CODE 0021 TOTAL QUANTITY
20101100	TREE TRUNK PROTECTION	EACH	20
20200100	EARTH EXCAVATION	CU YD	16
40201000	AGGREGATE FOR TEMPORARY ACCESS	TON	20
42300200	PORTLAND CEMENT CONCRETE DRIVEWAY PAVEMENT, 6 INCH	SQ YD	42
42300400	PORTLAND CEMENT CONCRETE DRIVEWAY PAVEMENT, 8 INCH	SQ YD	17
42400200	PORTLAND CEMENT CONCRETE SIDEWALK 5 INCH	SQ FT	6538
42400800	DETECTABLE WARNINGS	SQ FT	170
44000200	DRIVEWAY PAVEMENT REMOVAL	SQ YD	141
44000500	COMBINATION CURB AND GUTTER REMOVAL	FOOT	57
44000600	SIDEWALK REMOVAL	SQ FT	6015
44201753	CLASS D PATCHES, TYPE II, 9 INCH	SQ YD	103
60300305	FRAMES AND LIDS TO BE ADJUSTED	EACH	2
60406000	FRAMES AND LIDS, TYPE 1, OPEN LID	EACH	1
67100100	MOBILIZATION	L SUM	1
70102620	TRAFFIC CONTROL AND PROTECTION, STANDARD 701501	L SUM	1
70102640	TRAFFIC CONTROL AND PROTECTION, STANDARD 701801	L SUM	1
* 78000100	THERMOPLASTIC PAVEMENT MARKING - LETTERS AND SYMBOLS	SQ FT	55
* 78000400	THERMOPLASTIC PAVEMENT MARKING - LINE 6"	FOOT	249
* 78000600	THERMOPLASTIC PAVEMENT MARKING - LINE 12"	FOOT	318
* 78000650	THERMOPLASTIC PAVEMENT MARKING - LINE 24"	FOOT	59
* 78300100	PAVEMENT MARKING REMOVAL	SQ FT	32
83600200	LIGHT POLE FOUNDATION, 24" DIAMETER	FOOT	10
84200804	REMOVAL OF POLE FOUNDATION	EACH	1
84400105	RELOCATE EXISTING LIGHTING UNIT	EACH	1
X2520700	SODDING, SPECIAL	SQ YD	370
Z0004510	HOT-MIX ASPHALT DRIVEWAY PAVEMENT, 3"	SQ YD	62
Z0004562	COMBINATION CONCRETE CURB & GUTTER REMOVAL & REPLACEMENT	FOOT	463
Z0030850	TEMPORARY INFORMATION SIGNING	SQ FT	52

THE EXACT LOCATION AND LIMITS OF SOME CURB AND GUTTER REPAIRS, DRIVEWAY REPAIRS, SIDEWALK REPAIRS, AND PAVEMENT REPAIRS HAVE NOT BEEN DETERMINED. THESE ITEMS WILL BE VERIFIED AND LOCATED BY THE ENGINEER IN THE FIELD AT THE TIME OF CONSTRUCTION.

* - DENOTES SPECIALTY ITEM

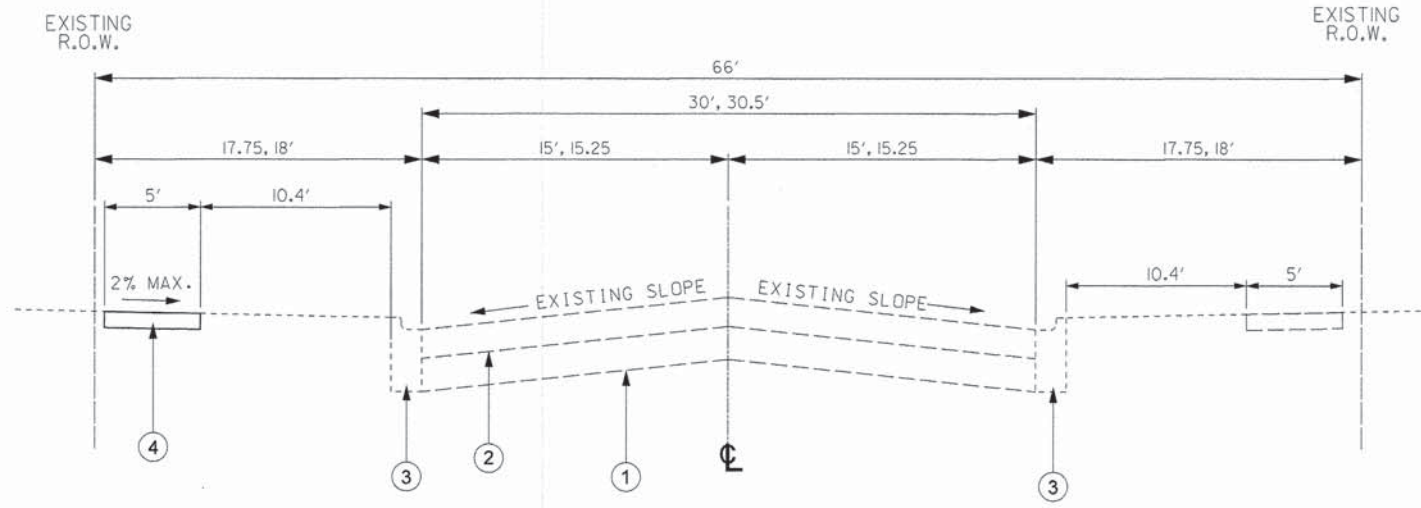

EXISTING & PROPOSED TYPICAL SECTION
 LAKE ST - PARKVIEW SCHOOL TO AUSTIN AVE
 STA. 8+50 TO STA. 21+50
 LENGTH = 1300 FT

- LEGEND**
- ① EXISTING AGGREGATE BASE COURSE (5-1/2" MIN.)
 - ② EXISTING HMA PAVEMENT (2-1/2" MIN.)
 - ③ EXISTING COMBINATION CONCRETE CURB & GUTTER, TYPE B-6.12 & VARIES. PROPOSED INTERMITTENT COMB. CONC. C&G REM. & REPL.
 - ④ EXISTING CONCRETE SIDEWALK (5" AND VARIES). PROPOSED INTERMITTENT SIDEWALK REM. & REPL.

HMA MIXTURE REQUIREMENTS	
MIXTURE TYPE	AIR VOIDS
PATCHING	
CLASS D PATCH (HMA BINDER IL-19 mm)	4% @ 70 GYR
DRIVEWAY	
HMA SURFACE COURSE, MIX "D", N50 (IL 9.5 mm)	4% @ 50 GYR

THE UNIT WEIGHT USED TO CALCULATE ALL HOT-MIX ASPHALT SURFACE MIXTURE IS 112 LBS/SQ YD/IN

* THE "AC TYPE" FOR NON-POLYMERIZED HMA SHALL BE "PG-64-22" UNLESS MODIFIED BY D-1 SPECIAL PROVISION. FOR USE OF RECYCLED MATERIALS, SEE SPECIAL PROVISIONS.

NOTE: DRIVEWAY AND APRON REPAIRS
 PROPOSED DRIVEWAY APRON REPAIRS ADJACENT TO PROPOSED CURB & GUTTER SHALL BE THREE FEET FROM BACK OF CURB UNLESS INDICATED OTHERWISE ON THE PLANS OR BY THE ENGINEER IN THE FIELD.

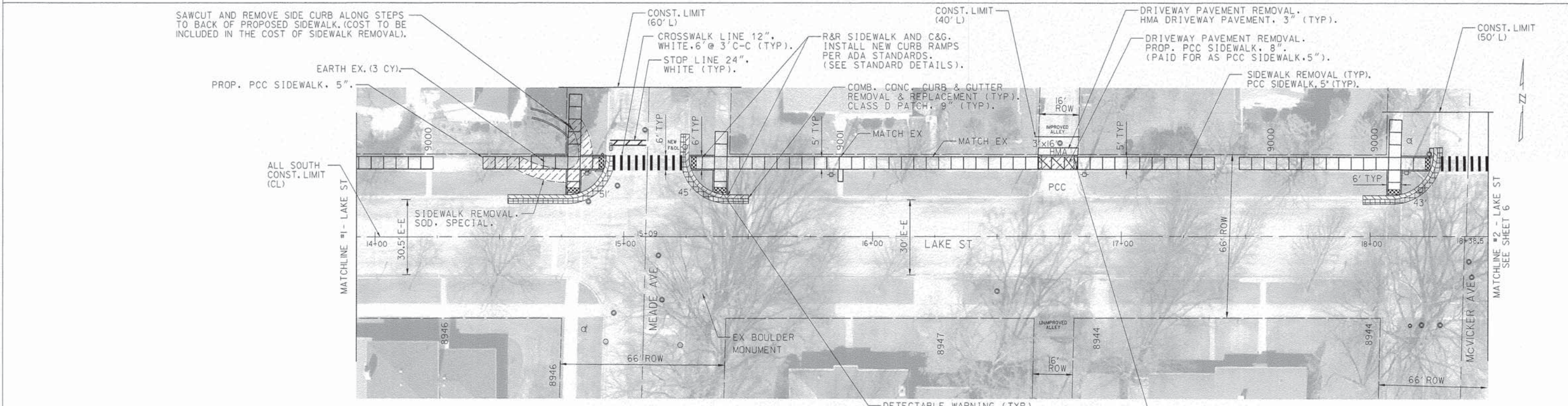
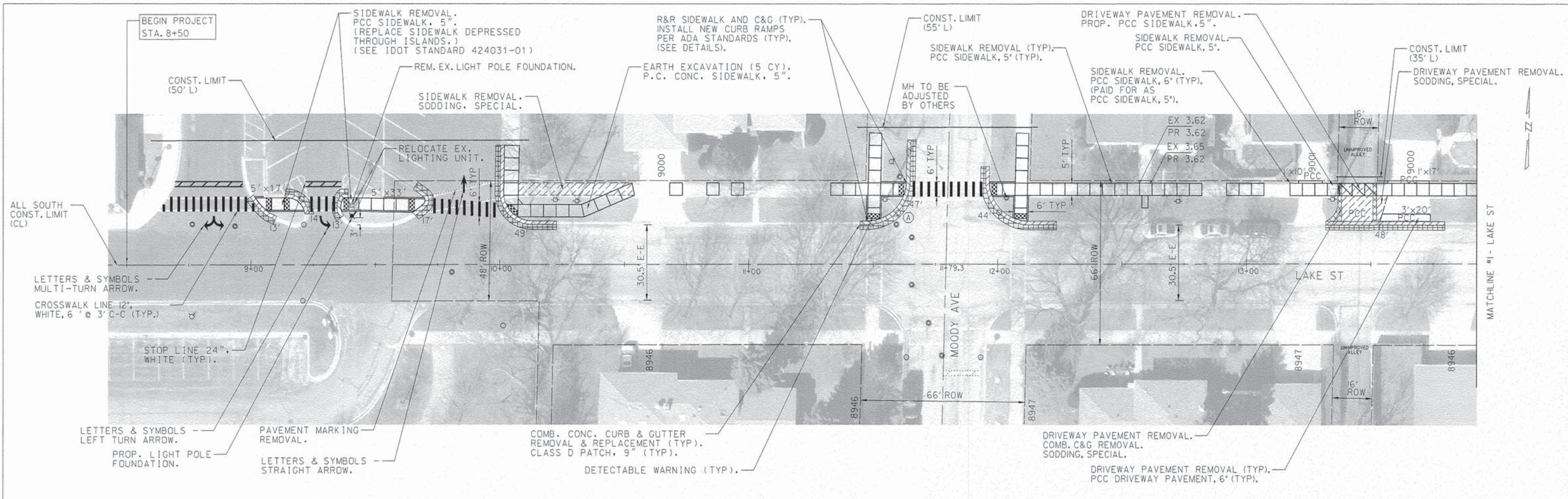

- NOTES:
1. SIDEWALK REMOVAL AND REPLACEMENT WILL BE MARKED BY THE ENGINEER IN THE FIELD.
 2. CURB & GUTTER REMOVAL AND REPLACEMENT WILL BE MARKED BY THE ENGINEER IN THE FIELD.
 3. CLASS D PATCHES ADJACENT TO C&G R&R SHALL BE 2 FT. WIDE UNLESS INDICATED OTHERWISE ON THE PLANS OR DIRECTED BY THE ENGINEER IN THE FIELD.
 4. DRIVEWAY PAVEMENT REMOVAL AND REPLACEMENT WILL BE MARKED BY THE ENGINEER IN THE FIELD.
 5. PAVEMENT MARKING WILL BE MARKED BY THE ENGINEER IN THE FIELD.

FILE NAME =	USER NAME = #USER#	DESIGNED - JFG	REVISED - 12/15/2014	STATE OF ILLINOIS DEPARTMENT OF TRANSPORTATION	LAKE STREET - Parkview School to McVicker Ave		F.A. RTE.	SECTION	COUNTY	TOTAL SHEETS	SHEET NO.
#FILE#		DRAWN - JFG	REVISED -					12-00107-00-SP	COOK	17	5
	PLOT SCALE = #SCALE#	CHECKED - CRT	REVISED -							CONTRACT NO. 61B02	
#MODELNAME#	PLOT DATE = #DATE#	DATE - 10/17/2014	REVISED -				SCALE: 1"=20'	SHEET ___ OF ___ SHEETS	STA. _____ TO STA. _____	ILLINOIS FED. AID PROJECT	

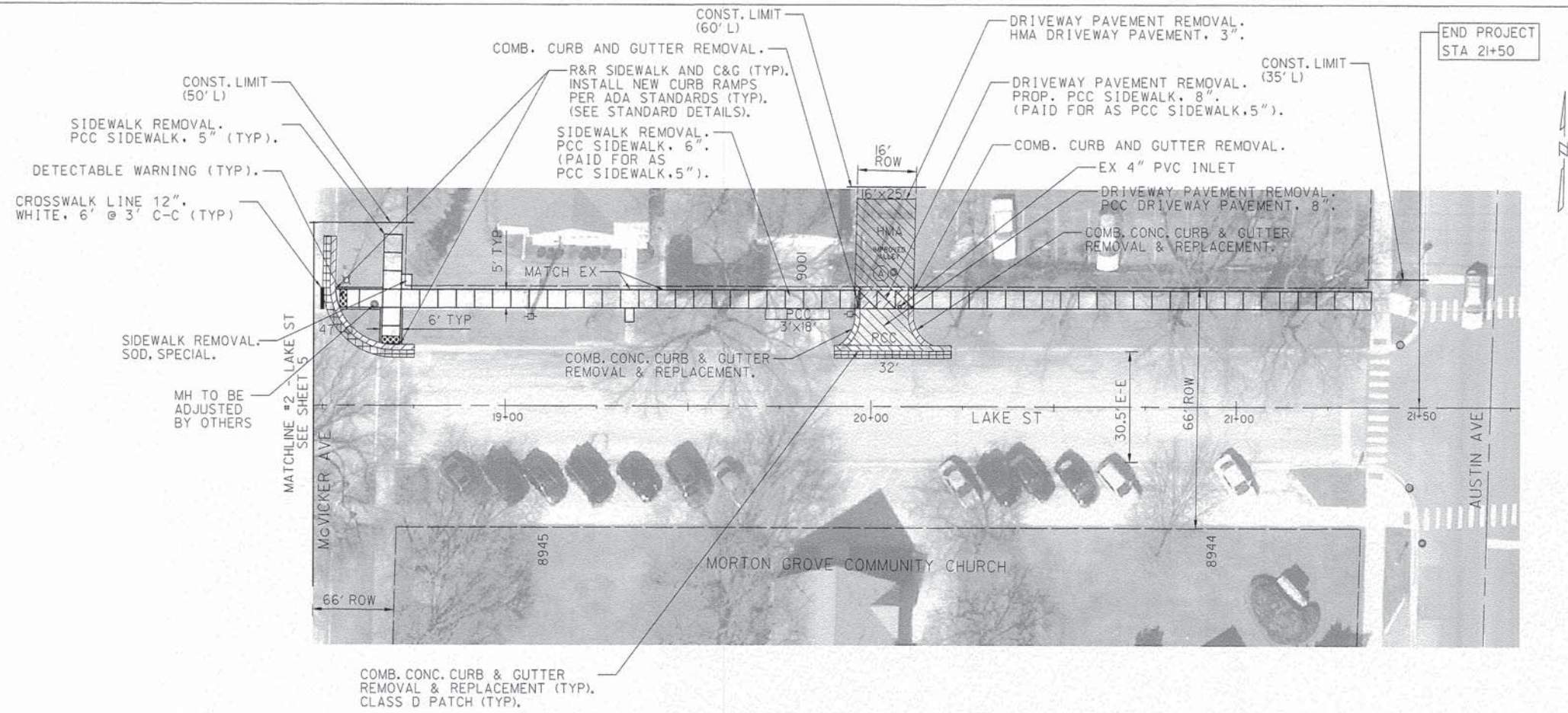

- NOTES:
1. SIDEWALK REMOVAL AND REPLACEMENT WILL BE MARKED BY THE ENGINEER IN THE FIELD.
 2. CURB & GUTTER REMOVAL AND REPLACEMENT WILL BE MARKED BY THE ENGINEER IN THE FIELD.
 3. CLASS D PATCHES ADJACENT TO C&G R&R SHALL BE 2 FT. WIDE UNLESS INDICATED OTHERWISE ON THE PLANS OR DIRECTED BY THE ENGINEER IN THE FIELD.
 4. DRIVEWAY PAVEMENT REMOVAL AND REPLACEMENT WILL BE MARKED BY THE ENGINEER IN THE FIELD.
 5. PAVEMENT MARKING WILL BE MARKED BY THE ENGINEER IN THE FIELD.

FILE NAME =	USER NAME = #USER#	DESIGNED - JFG	REVISED - 12/15/2014	STATE OF ILLINOIS DEPARTMENT OF TRANSPORTATION	LAKE ST - McVicker Ave to Austin Ave	F.A. RTE.	SECTION	COUNTY	TOTAL SHEETS	SHEET NO.
#FILE#		DRAWN - JFG	REVISED - _____			12-00107-00-SP	COOK	17	6	
#MODELNAME#		CHECKED - CRT	REVISED - _____			CONTRACT NO. 61B02				
		DATE - 10/17/2014	REVISED - _____			ILLINOIS FED. AID PROJECT				
SCALE: 1"=20'						SHEET ___ OF ___ SHEETS		STA. _____ TO STA. _____		

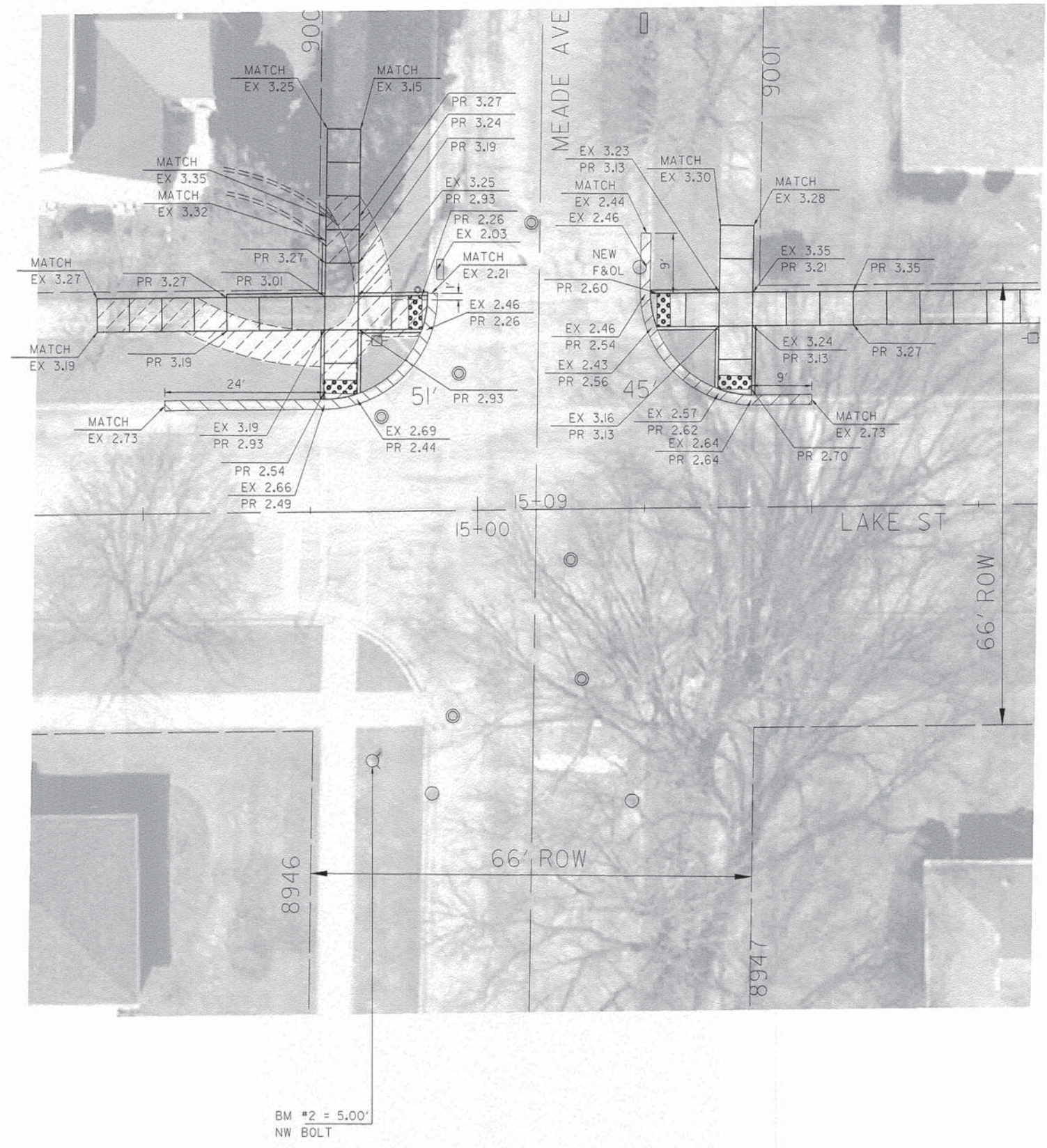

FILE NAME = #FILE#	USER NAME = #USER#	DESIGNED - JFG	REVISED - 12/15/2014	STATE OF ILLINOIS DEPARTMENT OF TRANSPORTATION	MEADE AVE AT LAKE ST Curb Ramp Details		F.A. RTE.	SECTION	COUNTY	TOTAL SHEETS	SHEET NO.
		DRAWN - JFG	REVISED -					12-00107-00-SP	COOK	17	8
		CHECKED - RCG	REVISED -				CONTRACT NO. 61B02				
#MODELNAME#		DATE - 10/17/2014	REVISED -		SCALE: 1"=10'		SHEET	OF	SHEETS	STA.	TO
ILLINOIS FED. AID PROJECT											

BM #3 = 5.00'
SE BONNET BOLT



FILE NAME =	USER NAME = #USER#	DESIGNED - JFG	REVISED - 12/15/2014	STATE OF ILLINOIS DEPARTMENT OF TRANSPORTATION	McVICKER AVE AT LAKE ST Curb Ramp Details		F.A. RTE.	SECTION	COUNTY	TOTAL SHEETS	SHEET NO.
#FILEL#		DRAWN - JFG	REVISED -					12-00107-00-SP	COOK	17	9
	PLOT SCALE = #SCALE#	CHECKED - CRT	REVISED -						CONTRACT NO. 61B02		
#MODELNAME#	PLOT DATE = #DATE#	DATE - 10/17/2014	REVISED -		SCALE: 1"=10'		SHEET ___ OF ___ SHEETS	STA. _____ TO STA. _____		ILLINOIS FED. AID PROJECT	

NOTE:
 1. ELEVATIONS ARE BASED ON BENCHMARK #1 (FIRE HYD. AT NW CORNER OF MOODY AT LAKE; SW BONNET BOLT = 5.00').

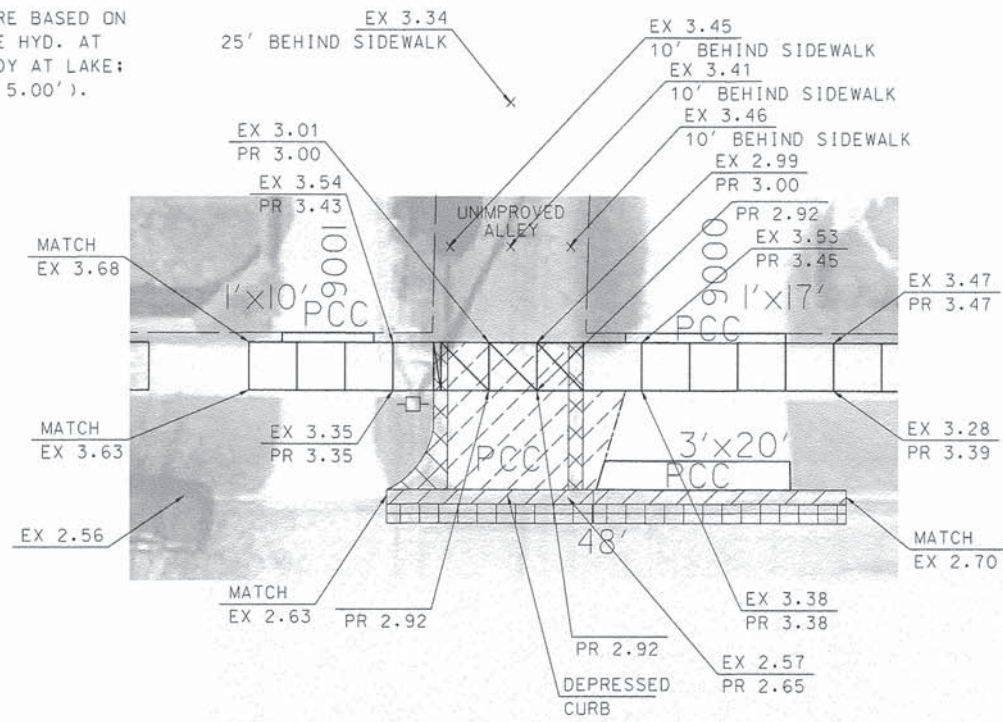

NORTH ALLEY BETWEEN MOODY AVE AND MEADE AVE

NOTE:
 1. ELEVATIONS ARE BASED ON BENCHMARK #2 (FIRE HYD. AT SW CORNER OF MEADE AT LAKE; NW BONNET BOLT = 5.00').

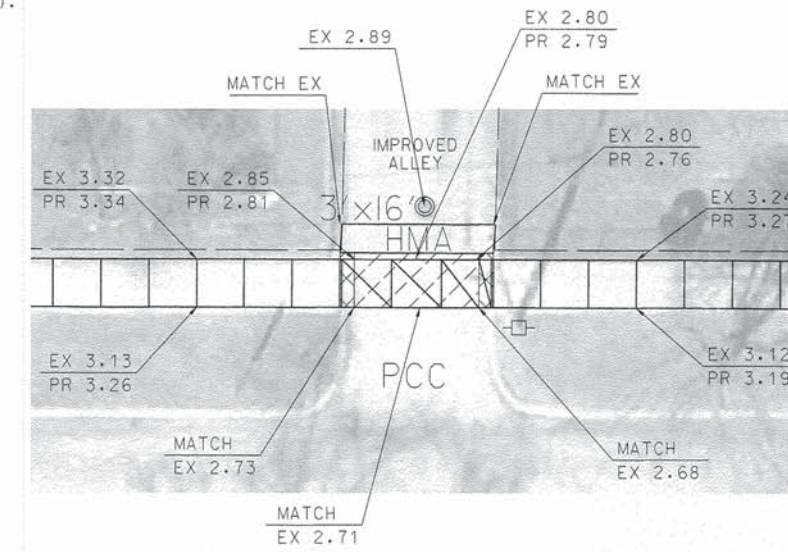

NORTH ALLEY BETWEEN MEADE AVE AND McVICKER AVE

FILE NAME *	USER NAME = #USER*	DESIGNED - JFG	REVISED - 12/15/2014
#FILE#		DRAWN - JFG	REVISED -
	PLOT SCALE = #SCALE*	CHECKED - CRT	REVISED -
#MODELNAME*	PLOT DATE = #DATE*	DATE - 10/17/2014	REVISED -

STATE OF ILLINOIS
 DEPARTMENT OF TRANSPORTATION

SPECIAL DETAILS - Sheet 1

SCALE: 1"=10' SHEET ___ OF ___ SHEETS STA. _____ TO STA. _____

F.A. RTE.	SECTION	COUNTY	TOTAL SHEETS	SHEET NO.
	12-00107-00-SP	COOK	17	10
			CONTRACT NO. 61B02	
ILLINOIS FED. AID PROJECT				

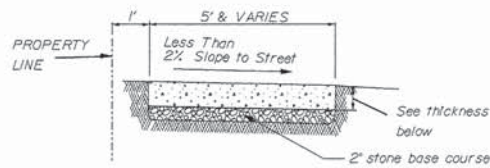
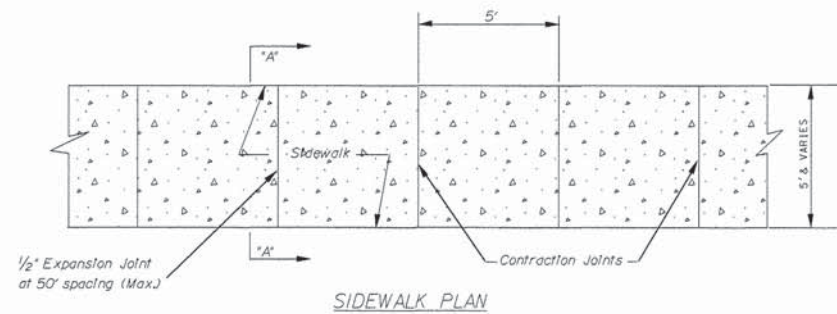

SIDEWALK CONSTRUCTION

Notes:

1. All material and workmanship shall conform to the Standard Specifications for Road and Bridge Construction, latest edition.
2. All pours must be separate. No monolithic pours with curb and gutter, driveway approaches, and sidewalks.
3. All sawcuts are to be full depth.
4. The Contractor shall notify the Village 48 hours prior to commencing work.
5. Curing agent shall be installed on all concrete work.
6. Install contraction joints 1/8" wide every five (5) lineal feet.
7. Install 1/2" expansion material every fifty (50) lineal feet.
8. Install 1/2" expansion material between the sidewalks and all structures such as light standards, traffic signal standards, poles, columns, or any structure which extends through the sidewalk.
9. Sidewalk Thickness: 5" - Everywhere, except where driveways cross sidewalks.
6" - Where residential driveways cross sidewalks.
8" - Where commercial driveways cross sidewalks.

SECTION A-A

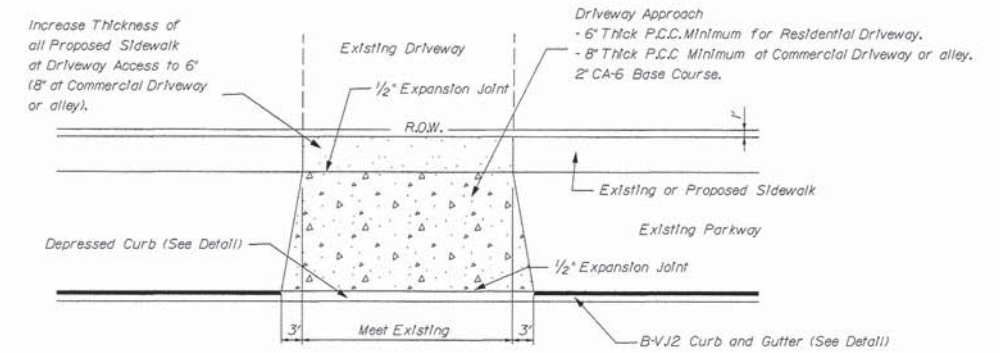

In no case shall any driveway approach be smaller than the existing driveway on property. Actual size to be approved by the Village.

Notes:

1. All material and workmanship shall conform to the Standard Specifications for Road and Bridge Construction, latest edition.
2. All pours must be separate. No monolithic pours with curb and gutter, driveway approaches, and sidewalk.
3. All sawcuts are to be full depth.
4. The contractor shall notify the Village 48 hours prior to commencing work.
5. Protective coating shall be installed on all concrete work.

RESIDENTIAL DRIVEWAY CONSTRUCTION

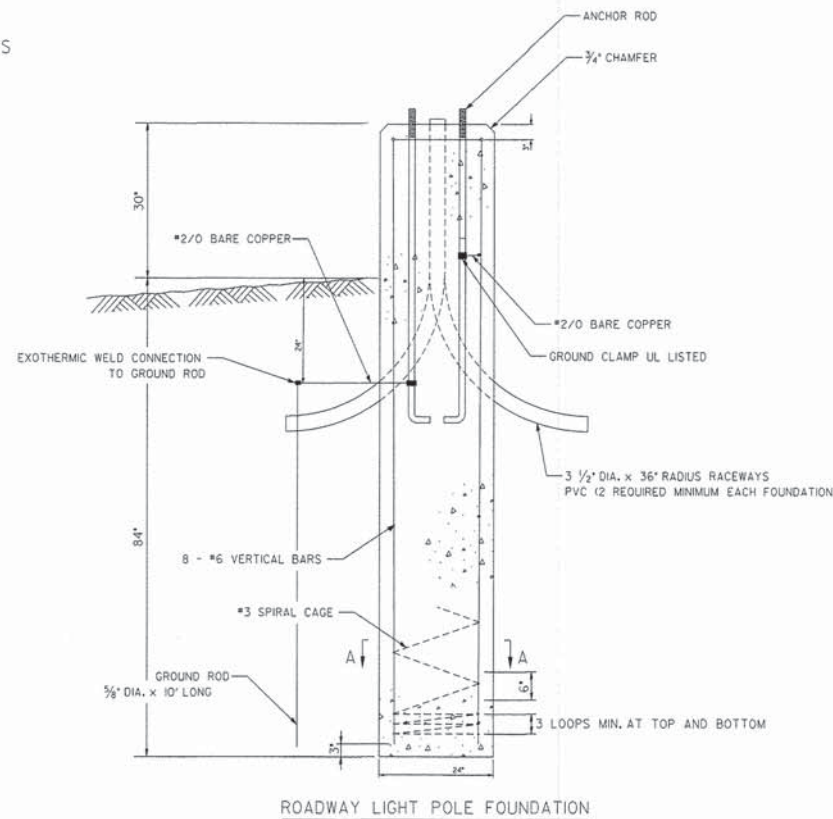
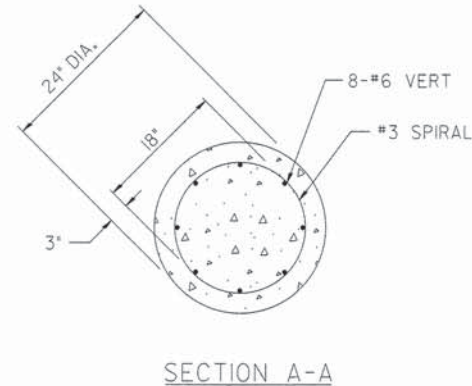
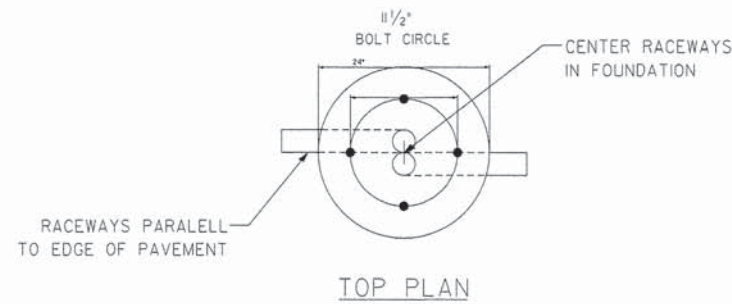
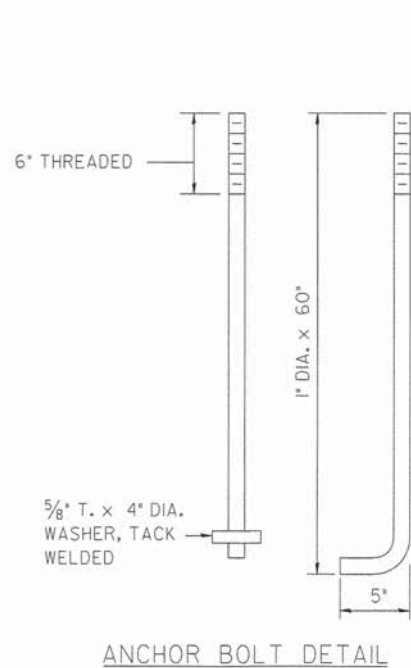

NOTES:

1. ALL DIMENSIONS ARE SHOWN IN INCHES, UNLESS NOTED OTHERWISE.
2. THE ANCHOR RODS AND RACEWAYS SHALL BE SECURED IN THE PROPER LOCATION BEFORE PLACEMENT OF THE CONCRETE.
3. THE HOLE FOR THE FOUNDATION SHALL BE MADE BY DRILLING WITH AN AUGER OF THE SAME DIAMETER OF THE FOUNDATION. IF SOIL CONDITIONS REQUIRE THE USE OF A LINER TO FORM THE HOLE, THE LINER SHALL BE WITHDRAWN AS THE CONCRETE IS DEPOSITED.
4. THE TOP OF THE FOUNDATION SHALL BE CONSTRUCTED LEVEL. A LINER OR FORM SHALL BE USED TO PRODUCE A UNIFORM SMOOTH SIDE TO THE TOP OF THE FOUNDATION. FOUNDATION TOP SHALL BE CHAMFERED 3/4 INCH.
5. THE CONCRETE SHALL BE CLASS SI. CONCRETE SHALL CURE ACCORDING TO ARTICLE 1020J3 BEFORE LIGHT POLES ARE INSTALLED.
6. THE ANCHOR ROD SHALL BE A HOOK ROD TYPE. COLD BENDING OF THE ANCHOR ROD WILL NOT BE ALLOWED. THE RADIUS OF THE HOOK BEND SHALL NOT BE LESS THAN FOUR TIMES THE NOMINAL DIAMETER OF THE ANCHOR ROD. A TACK WELDED ANCHOR ROD MAY BE SUBSTITUTED WITH THE APPROVAL OF THE ENGINEER.
7. THE ANCHOR RODS SHALL BE ACCORDING TO ASTM F 1554 GRADE 105. NUTS SHALL BE HEXAGON NUTS ACCORDING TO ASTM A 194 2H OR ASTM A 563 DH, AND WASHERS SHALL BE ACCORDING TO ASTM F 436.
8. ANCHOR RODS, NUTS, AND WASHERS SHALL BE COMPLETELY GALVANIZED BY EITHER HOT-DIPPED PROCESS CONFORMING TO AASHTO M 232, THE MECHANICAL PLATING METHOD CONFORMING TO AASHTO M 298, CLASS 50 WITH A MAXIMUM COATING THICKNESS OF 6 MILS. OR THE ELECTROLYTIC PROCESS ACCORDING TO AASHTO F 1136.
9. THE ANCHOR RODS SHALL BE THREADED A MINIMUM OF 6 INCHES WITH A MINIMUM OF 3 INCHES OF THREADED ANCHOR ROD EMBEDDED IN THE FOUNDATION.
10. ANCHOR RODS SHALL PROJECT 2 3/4 ABOVE THE TOP OF THE FOUNDATION. IF BREAKAWAY COUPLINGS ARE SPECIFIED, THE CONTRACTOR SHALL CAREFULLY COORDINATE THE ANCHOR ROD PROJECTION WITH THE INSTALLATION REQUIREMENTS OF THE BREAKAWAY COUPLINGS.
11. THE CONTRACTOR SHALL USE A #3 SPIRAL AT 6" PITCH OR MAY SUBSTITUTE #3 TIES AT 12" ON CENTER WITH APPROVAL OF THE ENGINEER.
12. THE CABLE TRENCHES AND FOUNDATIONS SHALL BE BACKFILLED AND COMPACTED AS SPECIFIED BEFORE THE LIGHT POLE IS ERECTED.
13. THE RACEWAYS SHALL PROJECT 1' ABOVE THE TOP OF THE FOUNDATION.

LIGHT POLE FOUNDATION DETAIL

FILE NAME =	USER NAME = #USER#	DESIGNED - JFG	REVISED - 12/15/2014
#FILEL#		DRAWN - JFG	REVISED -
#MODELNAME#		CHECKED - CRT	REVISED -
	PLOT DATE = #DATE#	DATE - 10/17/2014	REVISED -

STATE OF ILLINOIS
DEPARTMENT OF TRANSPORTATION

CONSTRUCTION DETAILS

SCALE: N.T.S. SHEET ___ OF ___ SHEETS STA. _____ TO STA. _____

F.A. RTE.	SECTION	COUNTY	TOTAL SHEETS	SHEET NO.
	12-00107-00-SP	COOK	17	12
CONTRACT NO. 61B02				
ILLINOIS FED. AID PROJECT				

VARIABLE - TO MEET EXISTING DIMENSIONS AND FIELD CONDITIONS (SEE NOTE ②)

PROP. CONC. CURB OR CURB AND GUTTER REPLACEMENT IN ACCORDANCE WITH STATE STANDARD 606001. (SEE NOTE ②)

SAW CUT FULL DEPTH - INCLUDED IN THE COST OF SIDEWALK, DRIVEWAY OR MEDIAN SURFACE REMOVAL PAY ITEM.

SEE STATE STANDARD 606001
EXISTING OR PROPOSED HMA SURFACE (IF APPLICABLE)

18" (450) MAX.

1/4" (5) **

EXISTING SIDEWALK, DRIVEWAY, MEDIAN SURFACE, SOD OR GROUND.

PROPOSED SIDEWALK, DRIVEWAY PAVEMENT, MEDIAN SURFACE OR SODDING SALT TOLERANT WITH TOP SOIL, 4" (100) SOD RESTORATION (SEE NOTE ①).

EXISTING CONCRETE PAVEMENT, CONCRETE BASE COURSE OR FLEXIBLE PAVEMENT

3" (75) MIN.

SUITABLE BACKFILL MATERIAL (INCLUDED IN THE COST OF CURB OR CURB AND GUTTER REMOVAL AND REPLACEMENT)

PROPOSED 3/4" (20) PREFORMED EXPANSION JOINT AT CONCRETE SIDEWALKS, DRIVEWAYS, AND MEDIANS. (INCLUDED IN THE COST OF CURB OR CURB AND GUTTER REMOVAL AND REPLACEMENT.)

* 3" (75) MINIMUM FROM TOP AND BOTTOM OF THE CONCRETE PAVEMENT OR BASE COURSE.

** IF THE FINAL SURFACE OF THE PAVEMENT IS CONCRETE, THE GUTTER IS TO BE FLUSH WITH THE PAVEMENT.

UNSUITABLE SUB-BASE MATERIAL TO BE REMOVED, IF DIRECTED BY THE ENGINEER, SHALL BE REPLACED WITH EITHER SUB-BASE GRANULAR MATERIAL, TYPE B OR ADDITIONAL THICKNESS OF CONCRETE.

REMOVAL AND REPLACEMENT 4" (100) OR LESS IS INCLUDED IN THE COST OF CURB OR CURB AND GUTTER REMOVAL AND REPLACEMENT.

REMOVAL AND REPLACEMENT IN EXCESS OF 4" (100) WILL BE PAID FOR IN ACCORDANCE WITH ARTICLE 109.04 OF THE STANDARD SPECIFICATIONS.

NOTE: ① SIDEWALK, DRIVEWAY PAVEMENT OR MEDIAN SURFACE SHALL BE SIMILAR TO THE MATERIAL BEING REMOVED AND WILL BE PAID FOR SEPARATELY.
SODDING, SALT TOLERANT AND TOP SOIL, FURNISH AND PLACE 4" WILL BE PAID FOR SEPARATELY.

② FERTILIZER FOR THE PLACEMENT OF THE SOD IS NOT REQUIRED

③ CURB OR CURB AND GUTTER REPLACEMENT SHALL MATCH THE SHAPE OF THE EXISTING CURB OR CURB AND GUTTER UNLESS OTHERWISE SPECIFIED.

④ FOR CURB OR CURB AND GUTTER REMOVAL AND REPLACEMENT ADJACENT TO FLEXIBLE PAVEMENT DELETE EPOXY COATED TIE BARS.

⑤ LONGITUDINAL BARS, IF ENCOUNTERED IN THE EXISTING CURB OR CURB AND GUTTER, ARE NOT TO BE REPLACED. CUTTING AND REMOVING LONGITUDINAL BARS SHALL BE INCLUDED IN THE COST OF CURB OR CURB AND GUTTER REMOVAL AND REPLACEMENT.

⑥ THE COST OF HMA SURFACE REMOVAL IN THE EXISTING GUTTER FLAG SHALL BE INCLUDED IN THE COST OF THE CURB AND GUTTER REMOVAL AND REPLACEMENT.

⑦ THE REMOVAL AND REPLACEMENT OF THE EXISTING CURB OR CURB AND GUTTER SHALL BE DONE IN ACCORDANCE WITH THE APPLICABLE PORTIONS OF SECTION 440 AND 606 OF THE STANDARD SPECIFICATIONS.

⑧ THE LOCATIONS OF REMOVAL AND REPLACEMENT OF EXISTING CURB OR CURB AND GUTTER SHALL BE DETERMINED BY THE RESIDENT ENGINEER AT THE TIME OF CONSTRUCTION.

PROPOSED #6 (20) EPOXY COATED TIE BARS 24" (600) LONG AT 24" (600) CENTERS WILL NOT BE PAID FOR SEPARATELY. DELETE EPOXY COATED TIE BARS IF EXISTING TIE BARS ARE USUABLE AS DETERMINED BY THE ENGINEER. (SEE NOTE ③).

BASIS OF PAYMENT:
THIS WORK WILL BE PAID FOR AT THE CONTRACT UNIT PRICE PER FOOT (METER) FOR "CURB REMOVAL AND REPLACEMENT" OR "COMBINATION CONCRETE CURB AND GUTTER REMOVAL AND REPLACEMENT".

CURB OR CURB AND GUTTER REMOVAL AND REPLACEMENT

ALL DIMENSIONS ARE IN INCHES (MILLIMETERS) UNLESS OTHERWISE SHOWN.

FILE NAME =	USER NAME = drivakosgn	DESIGNED - A. HOUSEH	REVISED - R. SHAH 10-03-96
et:\p\work\p\dot\drivakosgn\d0108315\bd24.dgn		DRAWN -	REVISED - A. ABBAS 03-21-97
	PLOT SCALE = 50,000' / IN.	CHECKED -	REVISED - M. GOMEZ 01-22-01
	PLOT DATE = 12/15/2009	DATE - 03-11-94	REVISED - R. BORO 12-15-09

**STATE OF ILLINOIS
DEPARTMENT OF TRANSPORTATION**

CURB OR CURB AND GUTTER REMOVAL AND REPLACEMENT	
SCALE: NONE	SHEET NO. 1 OF 1 SHEETS
STA.	TO STA.

F.A. RTE.	SECTION	COUNTY	TOTAL SHEETS	SHEET NO.
	12-00107-00-SP	COOK	17	13
BD600-06 (BD-24)		CONTRACT NO. 61B02		
FED. ROAD DIST. NO. 1 ILLINOIS FED. AID PROJECT				

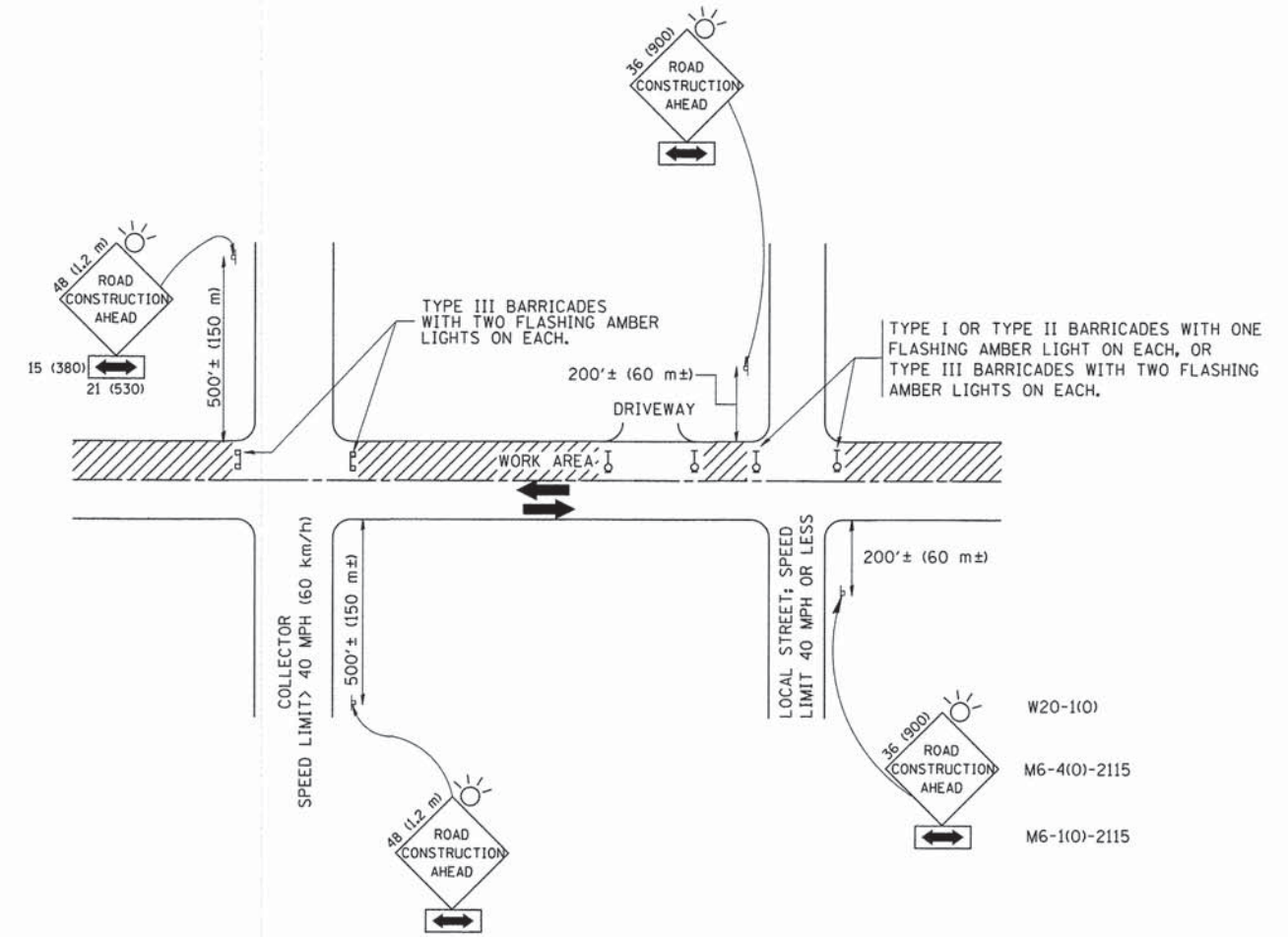

TRAFFIC CONTROL AND PROTECTION FOR SIDE ROADS, INTERSECTIONS, AND DRIVEWAYS

NOTES:

A. FOR NO LANE RESTRICTION ON THE SIDE ROAD OR DRIVEWAYS

1. SIDE ROAD WITH A SPEED LIMIT OF 40 MPH (60 km/h) OR LESS AS SHOWN ON THE DRAWING AND AS DIRECTED BY THE ENGINEER:
 - a) ONE ROAD CONSTRUCTION AHEAD SIGN 36 x 36 (900x900) WITH A FLASHER AND FLAG MOUNTED ON IT APPROXIMATELY 200' (60 m) IN ADVANCE OF THE MAIN ROUTE.
 - b) THE CLOSED PORTION OF THE MAIN ROUTE SHALL BE PROTECTED BY BLOCKING WITH TYPE I, TYPE II OR TYPE III BARRICADES, 1/3 OF THE CROSS SECTION OF THE CLOSED PORTION.
2. SIDE ROAD WITH A SPEED LIMIT GREATER THAN 40 MPH (60 km/h) AS SHOWN ON THE DRAWING AND AS DIRECTED BY THE ENGINEER:
 - a) ONE ROAD CONSTRUCTION AHEAD SIGN 48 x 48 (1.2 m x 1.2 m) WITH A FLASHER MOUNTED ON IT APPROXIMATELY 500' (150 m) IN ADVANCE OF THE MAIN ROUTE.
 - b) THE CLOSED PORTION OF THE MAIN ROUTE SHALL BE PROTECTED BY BLOCKING WITH TYPE III BARRICADES, 1/2 OF THE CROSS SECTION OF THE CLOSED PORTION.
3. WHEN THE SIDE ROAD LIES BETWEEN THE BEGINNING OF THE MAINLINE SIGNING AND THE WORK ZONE, A SINGLE HEADED ARROW (M6-1) SHALL BE USED IN LIEU OF THE DOUBLE HEADED ARROW (M6-4).

B. FOR A LANE CLOSURE ON A SIDE ROAD OR DRIVEWAY:

USE APPLICABLE PORTIONS OF THE TYPICAL APPLICATION OF TRAFFIC CONTROL DEVICES (STD. 701501, STD. 701606 OR THE APPROPRIATE STANDARD). THE SPACING OF SIGNS AND BARRICADES SHALL BE ADJUSTED FOR FIELD CONDITIONS AS DIRECTED BY THE ENGINEER. THE DIRECTIONAL ARROW SHALL BE COVERED OR REMOVED WHEN NO LONGER CONSISTENT WITH THE SIDE ROAD LANE CLOSURE.

C. ADVANCE WARNING SIGNS ARE TO BE OMITTED ON DRIVEWAY UNLESS OTHERWISE NOTED.

D. THE TRAFFIC CONTROL AND PROTECTION FOR SIDE ROADS, INTERSECTIONS, AND DRIVEWAYS SHALL BE INCIDENTAL TO THE COST OF SPECIFIED TRAFFIC CONTROL STANDARDS OR ITEMS.

All dimensions are in millimeters (Inches) unless otherwise shown.

FILE NAME = W:\diststd\22x34\tcl0.dgn	USER NAME = geglionobt	DESIGNED - LHA	REVISED - J. OBERLE 10-18-95
		DRAWN -	REVISED - A. HOUSEH 03-06-96
	PLOT SCALE = 50,000' / IN.	CHECKED -	REVISED - A. HOUSEH 10-15-96
	PLOT DATE = 1/4/2008	DATE - 06-89	REVISED - T. RAMMACHER 01-06-00

STATE OF ILLINOIS
DEPARTMENT OF TRANSPORTATION

TRAFFIC CONTROL AND PROTECTION FOR
SIDE ROADS, INTERSECTIONS, AND DRIVEWAYS

SCALE: NONE SHEET NO. 1 OF 1 SHEETS STA. TO STA.

F.A. RTE.	SECTION	COUNTY	TOTAL SHEETS	SHEET NO.
	12-00107-00-SP	COOK	17	14
	TC-10		CONTRACT NO. 61B02	
FED. ROAD DIST. NO. 1 [ILLINOIS] FED. AID PROJECT				

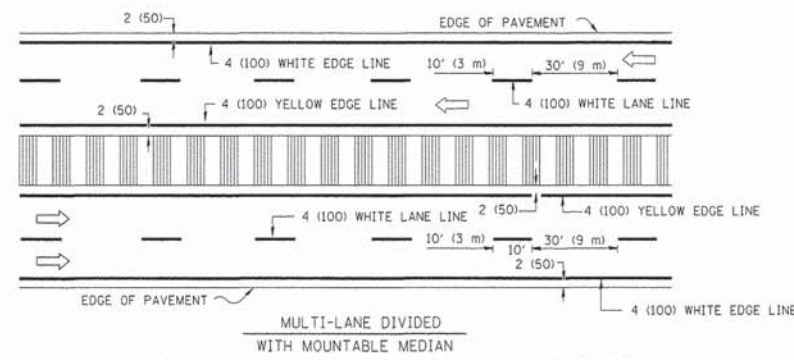
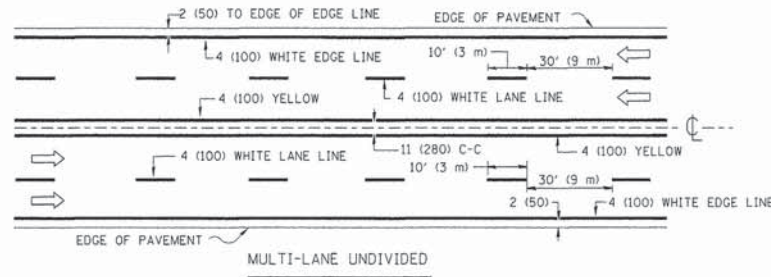
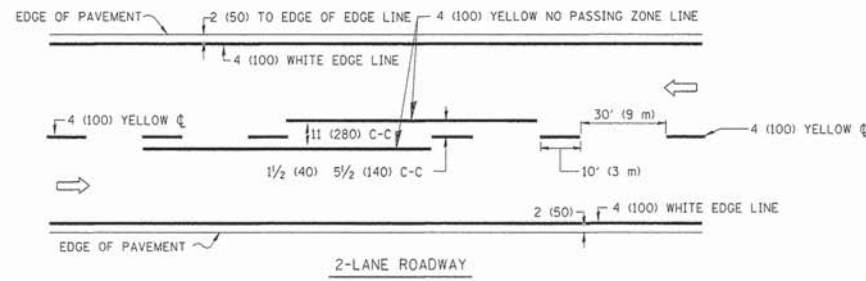

NOTE: MEDIANS WITH BARRIER CURB DO NOT REQUIRE AN EDGE LINE

TYPICAL LANE AND EDGE LINE MARKING

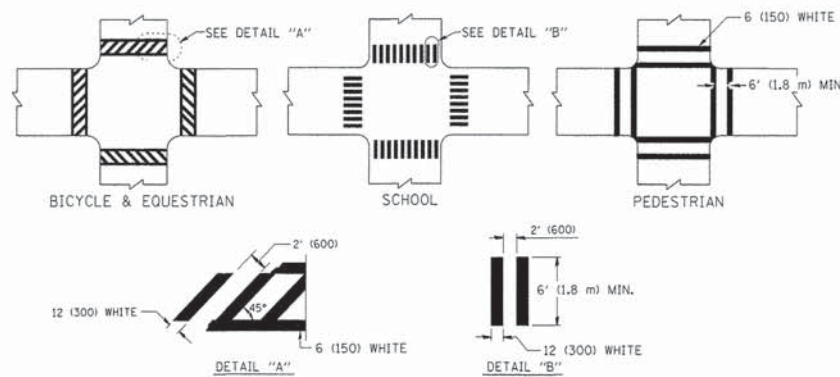

TYPICAL CROSSWALK MARKING

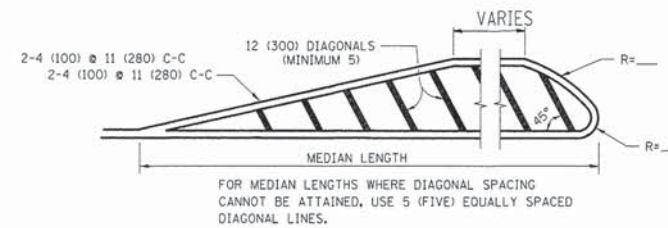
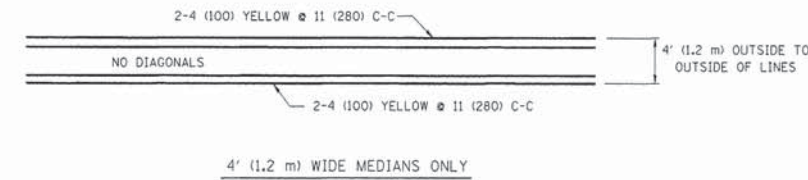

FOR MEDIAN LENGTHS WHERE DIAGONAL SPACING CANNOT BE ATTAINED, USE 5 (FIVE) EQUALLY SPACED DIAGONAL LINES.
DIAGONAL LINE SPACING: 50' (15 m) C-C (LESS THAN 30MPH (50 km/h))
75' (25 m) C-C 30MPH (50 km/h) TO 45MPH (70 km/h)
150' (45 m) C-C (MORE THAN 45MPH (70 km/h))

MEDIANS OVER 4' (1.2 m) WIDE

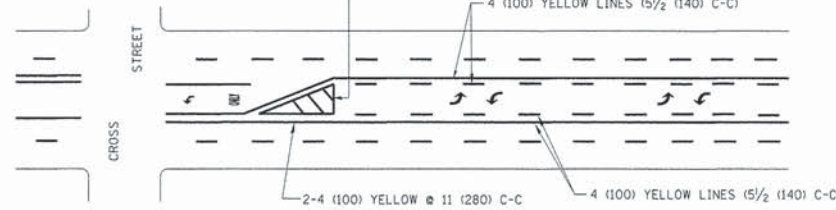

A MINIMUM OF TWO PAIRS OF TURN ARROWS SHALL BE USED, WHITE IN COLOR. ADDITIONAL PAIRS SHALL BE PLACED AT 200' (60 m) TO 300' (90 m) INTERVALS.

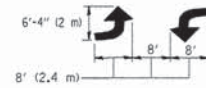

MEDIAN WITH TWO-WAY LEFT TURN LANE

TYPICAL PAINTED MEDIAN MARKING

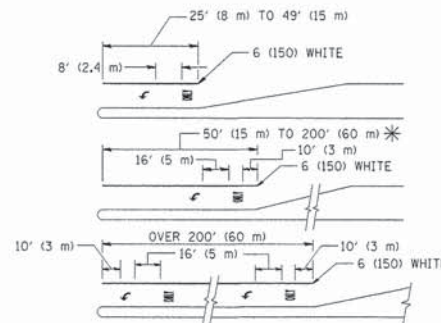

FULL SIZE LETTERS 8' (2.4 m) AND ARROWS SHALL BE USED.
AREA = 15.6 SQ. FT. (1.5 m²) ONLY AREA = 20.8 SQ. FT. (1.9 m²)

* TURN LANES IN EXCESS OF 400' (120 m) IN LENGTH MAY HAVE AN ADDITIONAL SET OF ARROW - "ONLY" INSTALLED MIDWAY BETWEEN THE OTHER TWO SETS OF ARROW - "ONLY".

TYPICAL LEFT (OR RIGHT) TURN LANE

TYPICAL TURN LANE MARKING

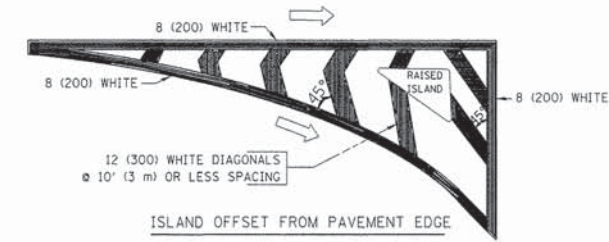

ISLAND OFFSET FROM PAVEMENT EDGE

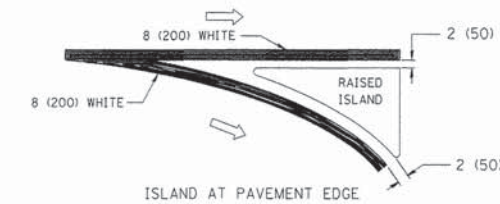

ISLAND AT PAVEMENT EDGE

TYPICAL ISLAND MARKING

TYPE OF MARKING	WIDTH OF LINE	PATTERN	COLOR	SPACING / REMARKS
CENTERLINE ON 2 LANE PAVEMENT	4 (100)	SKIP-DASH	YELLOW	10' (3 m) LINE WITH 30' (9 m) SPACE
CENTERLINE ON MULTI-LANE UNDIVIDED PAVEMENT	2 @ 4 (100)	SOLID	YELLOW	11 (280) C-C
NO PASSING ZONE LINES: FOR ONE DIRECTION FOR BOTH DIRECTIONS	4 (100) 2 @ 4 (100)	SOLID SOLID	YELLOW YELLOW	5/2 (140) C-C FROM SKIP-DASH CENTERLINE 11 (280) C-C OMIT SKIP-DASH CENTERLINE BETWEEN
LANE LINES	4 (100) 5 (125) ON FREEWAYS	SKIP-DASH SKIP-DASH	WHITE WHITE	10' (3 m) LINE WITH 30' (9 m) SPACE
DOTTED LINES (EXTENSIONS OF CENTER, LANE OR TURN LANE MARKINGS)	SAME AS LINE BEING EXTENDED	SKIP-DASH	SAME AS LINE BEING EXTENDED	2' (600) LINE WITH 6' (1.8 m) SPACE
EDGE LINES	4 (100)	SOLID	YELLOW-LEFT WHITE-RIGHT	OUTLINE MOUNTABLE MEDIANS IN YELLOW; EDGE LINES ARE NOT USED NEXT TO BARRIER CURB
TURN LANE MARKINGS	6 (150) LINE; FULL SIZE LETTERS & SYMBOLS (8' (2.4m))	SOLID	WHITE	SEE TYPICAL TURN LANE MARKING DETAIL
TWO WAY LEFT TURN MARKING	2 @ 4 (100) EACH DIRECTION 8' (2.4m) LEFT ARROW	SKIP-DASH AND SOLID IN PAIRS	YELLOW WHITE	10' (3 m) LINE WITH 30' (9 m) SPACE FOR SKIP-DASH; 5/2 (140) C-C BETWEEN SOLID LINE AND SKIP-DASH LINE SEE TYPICAL TWO-WAY LEFT TURN MARKING DETAIL
CROSSWALK LINES (PEDESTRIAN) A. DIAGONALS (BIKE & EQUESTRIAN) B. LONGITUDINAL BARS (SCHOOL)	2 @ 6 (150) 12 (300) @ 45° 12 (300) @ 90°	SOLID SOLID SOLID	WHITE WHITE WHITE	NOT LESS THAN 6' (1.8 m) APART 2' (600) APART 2' (600) APART SEE TYPICAL CROSSWALK MARKING DETAILS.
STOP LINES	24 (600)	SOLID	WHITE	PLACE 4' (1.2 m) IN ADVANCE OF AND PARALLEL TO CROSSWALK, IF PRESENT. OTHERWISE, PLACE AT DESIRED STOPPING POINT. PARALLEL TO CROSSROAD CENTERLINE, WHERE POSSIBLE
PAINTED MEDIANS	2 @ 4 (100) WITH 12 (300) DIAGONALS @ 45° NO DIAGONALS USED FOR 4' (1.2 m) WIDE MEDIANS	SOLID	YELLOW: TWO WAY TRAFFIC WHITE: ONE WAY TRAFFIC	11 (280) C-C FOR THE DOUBLE LINE SEE TYPICAL PAINTED MEDIAN MARKING.
GORE MARKING AND CHANNELIZING LINES	8 (200) WITH 12 (300) DIAGONALS @ 45°	SOLID	WHITE	DIAGONALS: 15' (4.5 m) C-C (LESS THAN 30MPH (50 km/h)) 20' (6 m) C-C 30MPH (50 km/h) TO 45MPH (70 km/h) 30' (9 m) C-C (OVER 45MPH (70 km/h))
RAILROAD CROSSING	24 (600) TRANSVERSE LINES; "RR" 15 6' (1.8 m) LETTERS; 16 (400) LINE FOR "X"	SOLID	WHITE	SEE STATE STANDARD 780001 AREA OF: "R"=3.6 SQ. FT. (0.33 m ²) EACH "X"=54.0 SQ. FT. (5.0 m ²)
SHOULDER DIAGONALS	12 (300) @ 45°	SOLID	WHITE - RIGHT YELLOW - LEFT	50' (15 m) C-C (LESS THAN 30MPH (50 km/h)) 75' (25 m) C-C (30 MPH (50 km/h) TO 45MPH (70 km/h)) 150' (45 m) C-C (OVER 45MPH (70 km/h))

FOR FURTHER DETAILS ON PAVEMENT MARKING REFER TO STANDARD SPECIFICATIONS FOR ROAD AND BRIDGE CONSTRUCTION AND STATE STANDARD 780001.

All dimensions are in inches (millimeters) unless otherwise shown.

FILE NAME =	USER NAME = drivakosgn	DESIGNED - EVERS	REVISED -T. RAMMACHER 10-27-94
ei:\pw\work\p\dot\drivakosgn\d0108315\td	3.dgn	DRAWN -	REVISED -C. JUCIUS 09-09-09
	PLOT SCALE = 50,000 ' / IN.	CHECKED -	REVISED -
	PLOT DATE = 9/9/2009	DATE = 03-19-90	REVISED -

STATE OF ILLINOIS
DEPARTMENT OF TRANSPORTATION

DISTRICT ONE		F.A. RTE.	SECTION	COUNTY	TOTAL SHEETS	SHEET NO.
TYPICAL PAVEMENT MARKINGS			12-00107-00-SP	COOK	17	15
SCALE: NONE		SHEET NO. 1 OF 1 SHEETS		STA. TO STA.	FED. ROAD DIST. NO. 1 ILLINOIS FED. AID PROJECT	
		TC-13		CONTRACT NO. 61B02		

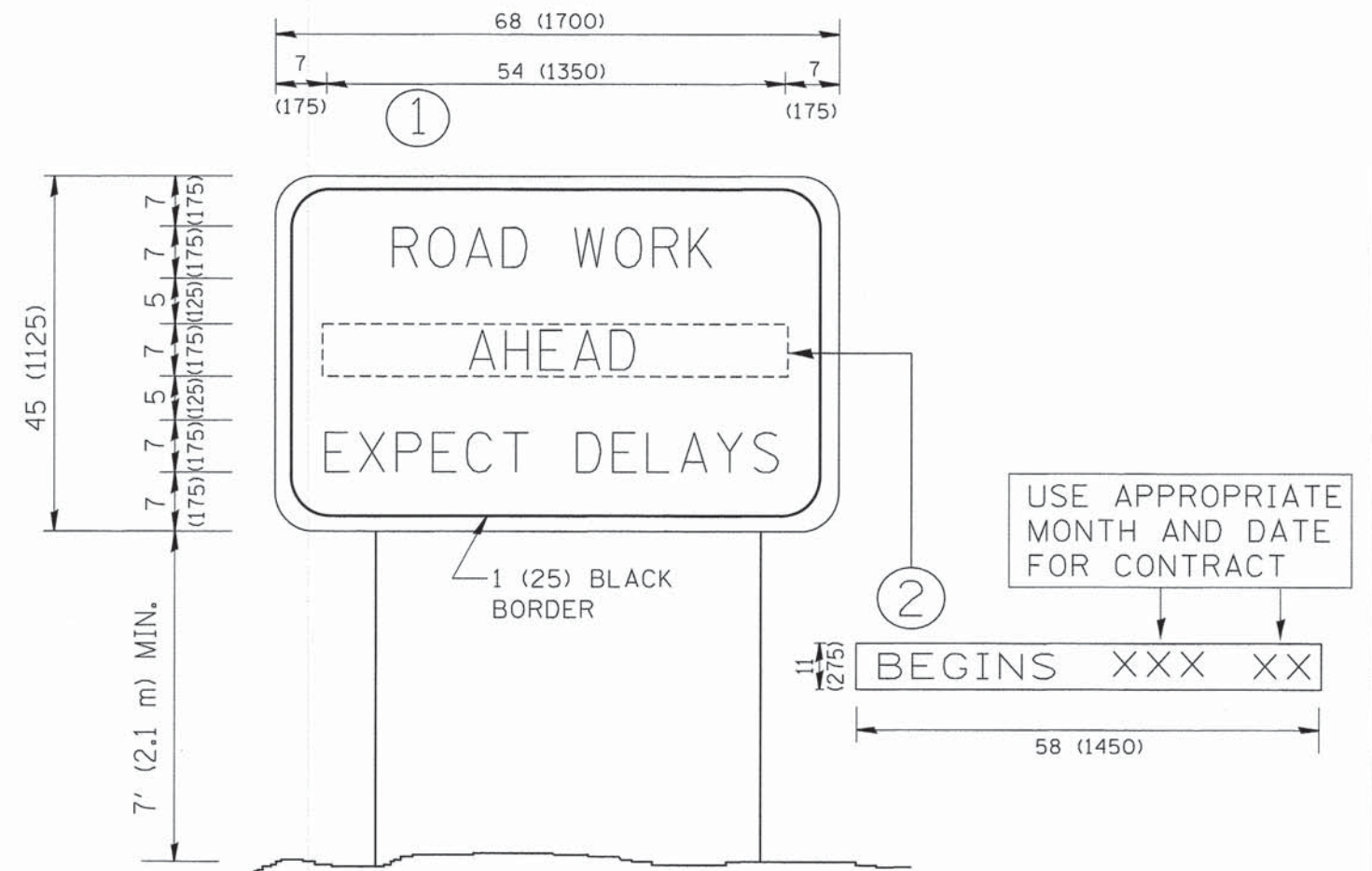

NOTES:

1. USE BLACK LETTERING ON ORANGE BACKGROUND.
2. ERECT SIGNS IN ADVANCE OF THE LOCATION FOR THE "ROAD CONSTRUCTION AHEAD" SIGN AT LOCATIONS AS DIRECTED BY THE ENGINEER.
3. ERECT SIGN ① WITH INSTALLED PANEL ② ONE WEEK PRIOR TO THE START OF CONSTRUCTION.
4. REMOVE PANEL ② SOON AFTER THE START OF CONSTRUCTION.
5. SEE SPECIAL PROVISION FOR "TEMPORARY INFORMATION SIGNING" FOR ADDITIONAL INFORMATION.
6. ONE SIGN ASSEMBLY EQUALS 25.70 SQ. FT. (2.3 SQ. M.)
7. SHALL BE PAID FOR AS TEMPORARY INFORMATION SIGNING.

ALL DIMENSIONS ARE IN INCHES (MILLIMETERS) UNLESS OTHERWISE SHOWN.

FILE NAME = W:\dststd\22x34\to22.dgn	USER NAME = goglianobt	DESIGNED -	REVISED - R. MIRS 09-15-97
		DRAWN -	REVISED - R. MIRS 12-11-97
	PLOT SCALE = 50.000' / IN.	CHECKED -	REVISED - T. RAMMACHER 02-02-99
	PLOT DATE = 1/4/2008	DATE -	REVISED - C. JUCIUS 01-31-07

STATE OF ILLINOIS
DEPARTMENT OF TRANSPORTATION

ARTERIAL ROAD
INFORMATION SIGN
SCALE: NONE SHEET NO. 1 OF 1 SHEETS STA. TO STA.

F.A. RTE.	SECTION	COUNTY	TOTAL SHEETS	SHEET NO.
	12-00107-00-SP	COOK	17	16
TC-22		CONTRACT NO. 61B02		
FED. ROAD DIST. NO. 1 ILLINOIS FED. AID PROJECT				

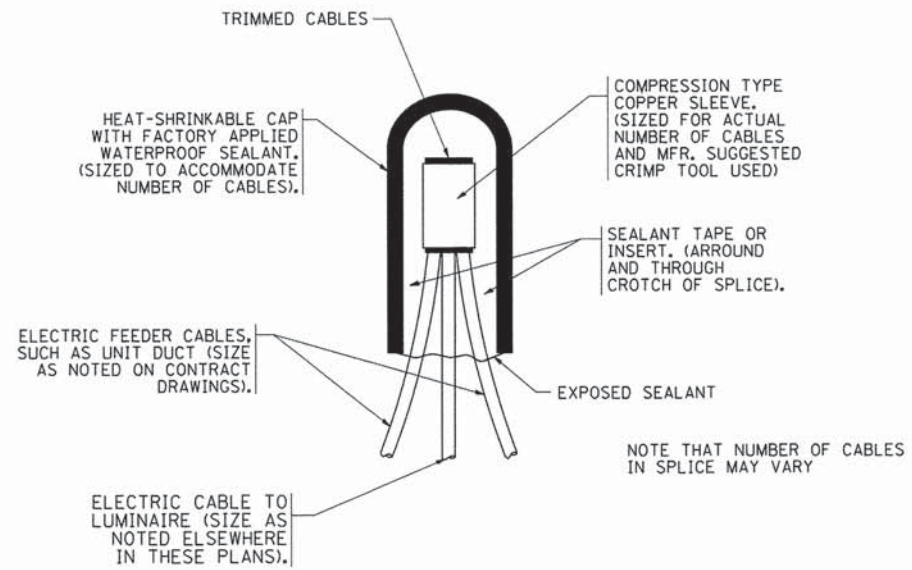

TYPICAL SPLICE DETAIL

N.T.S.

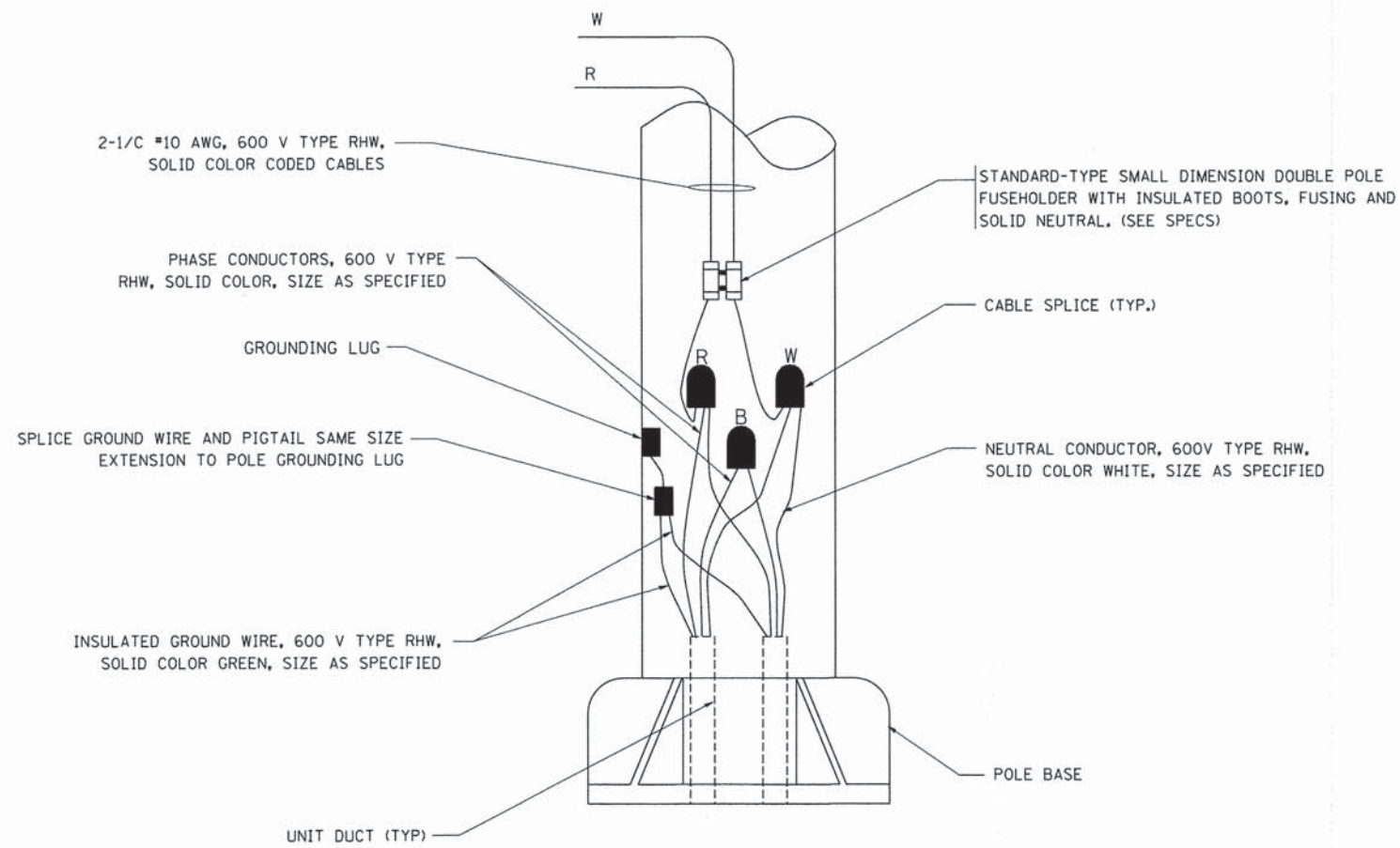

POLE WIRING DETAIL

N.T.S.

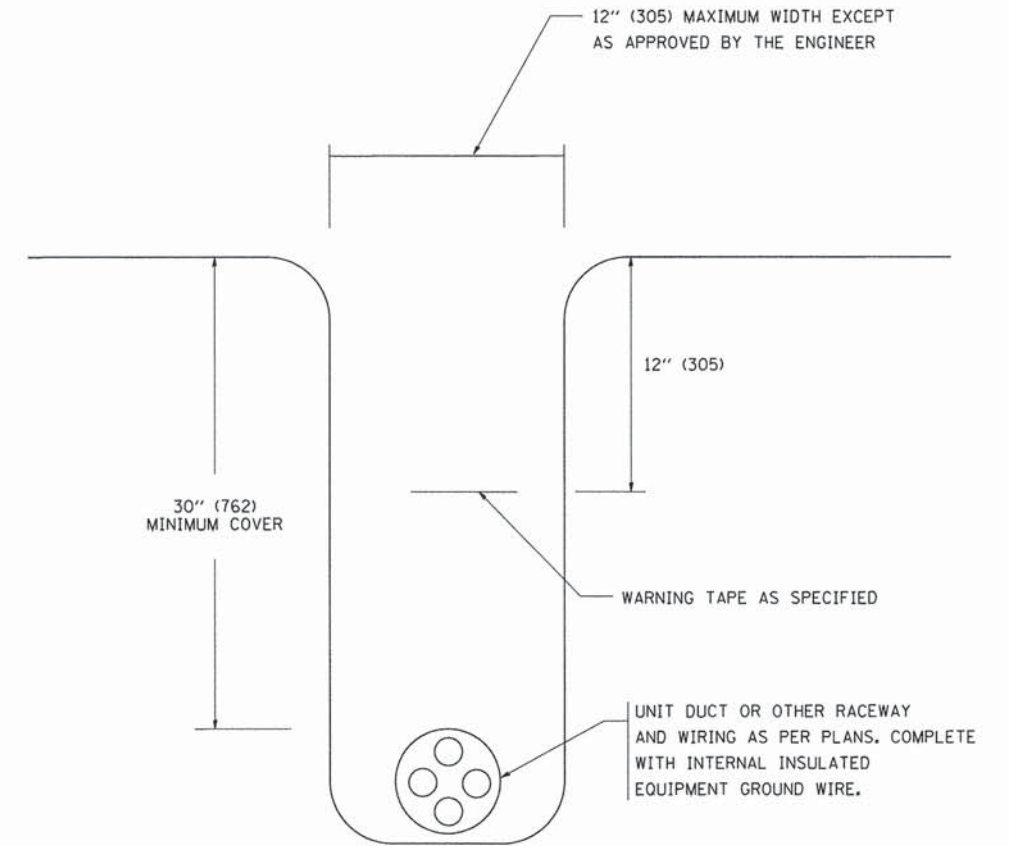

TYPICAL WIRING IN TRENCH DETAIL

N.T.S.

FILE NAME = W:\diststd\22x34\be702.dgn	USER NAME = geglennobt	DESIGNED -	REVISED - 08-08-03	STATE OF ILLINOIS DEPARTMENT OF TRANSPORTATION	MISC. ELECTRICAL DETAILS SHEET A			F.A. RTE. *	SECTION	COUNTY	TOTAL SHEETS	SHEET NO.
	PLOT SCALE = 50,000' / IN.	DRAWN -	REVISED -					12-00107-00-SP	COOK	17	17	
	PLOT DATE = 1/4/2008	CHECKED -	REVISED -		BE-702		CONTRACT NO. 61B02					
		DATE -	REVISED -		SCALE: NONE	SHEET NO. 1 OF 1 SHEETS	STA. TO STA.	FED. ROAD DIST. NO. 1 ILLINOIS FED. AID PROJECT				