

INDEX OF SHEETS

- 1 COVER SHEET
- 2 GENERAL NOTES, COMMITMENTS, & HIGHWAY STANDARDS
- 3, 4 SUMMARY OF QUANTITIES
- 5 SCHEDULE OF QUANTITIES
- 6 TYPICAL CROSS SECTIONS
- 7-9 STAGE CONSTRUCTION DETAILS
- 10-22 PLAN SHEETS
- 23-28 MISCELLANEOUS DETAILS

HIGHWAY STANDARDS

000001-06	701106-02
001006	701401-09
442001-04	701400-08
442101-07	701406-09
635001-01	701901-04
642001-02	780001-05
701101-04	781001-03

HIGHWAY CLASSIFICATION

FAI 72 (I-72)
 FUNCTIONAL CLASS - INTERSTATE
 ADT (2014) - 14,000
 ADT (2034) - 16,500
 PV - 78.93%
 SU - 6.43%
 MU - 14.64%

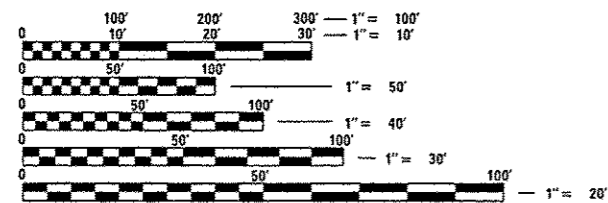

FULL SIZE PLANS HAVE BEEN PREPARED USING STANDARD ENGINEERING SCALES. REDUCED SIZED PLANS WILL NOT CONFORM TO STANDARD SCALES. IN MAKING MEASUREMENTS ON REDUCED PLANS, THE ABOVE SCALES MAY BE USED.

J.U.L.I.E.
 JOINT UTILITY LOCATION INFORMATION FOR EXCAVATION
 1-800-892-0123
 OR 811

PROJECT ENGINEER: VINCENT J. MADONIA (217) 785-9046
 PROJECT MANAGER: VICTOR T. YOUNG (217) 524-0472
 CONTRACT NO. 72G92

STATE OF ILLINOIS
DEPARTMENT OF TRANSPORTATION
DIVISION OF HIGHWAYS
PROPOSED
HIGHWAY PLANS

FAI ROUTE 72 (I-72)
 SECTION (84-10-2)RS-5
 PROJECT ACNHPP-0072 (403)
CONCRETE OVERLAY
SANGAMON COUNTY
C-96-063-14

BEGIN IMPROVEMENT
STATION EQUATION:
 STA. 295 + 70.43 (BK) =
 STA. 0 + 00.00 (AH)

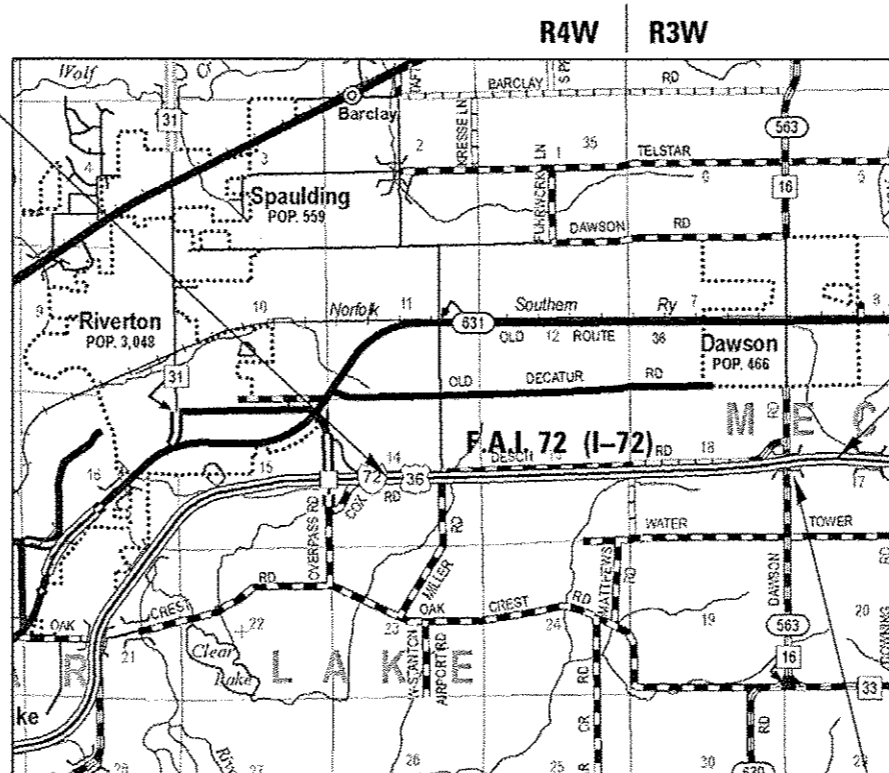

LOCATION MAP

GROSS LENGTH = 17,109.00 FT. = 3.240 MILE
 NET LENGTH = 17,109.00 FT. = 3.240 MILE

SN 084-0155
 CH 16 OVER I-72
 STA. 134 + 13.03
 (NO WORK)

END IMPROVEMENT
 STA. 171 + 09.00

F.A.I. RTE.	SECTION	COUNTY	TOTAL SHEETS	SHEET NO.
72	(84-10-2)RS-5	SANGAMON	28	1
ILLINOIS			CONTRACT NO. 72G92	

D-96-063-14

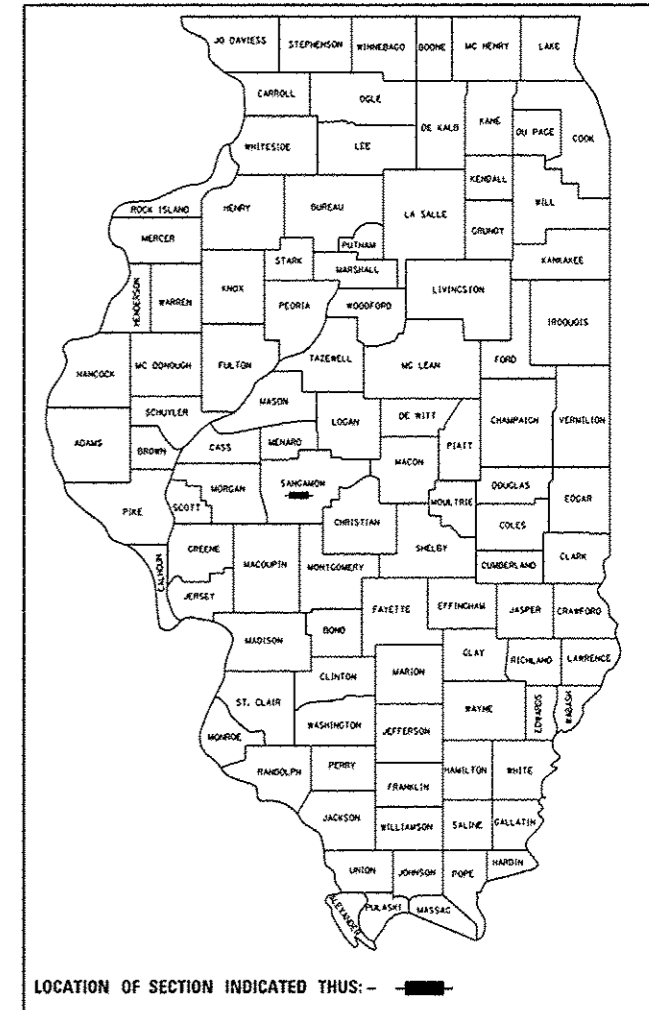

LOCATION OF SECTION INDICATED THUS: - [thick black line] -

STATE OF ILLINOIS
 DEPARTMENT OF TRANSPORTATION
 DIVISION OF HIGHWAYS

SUBMITTED January 13 2015
Roger L. Quirk, Jr.
 DEPUTY DIRECTOR OF HIGHWAYS, REGION ENGINEER

Jan 30 2015
John D. Baranzelli, P.E.
 ENGINEER OF DESIGN AND ENVIRONMENT

Jan 30 2015
Omec Osman, P.E.
 DIRECTOR OF HIGHWAYS, CHIEF ENGINEER

PRINTED BY THE AUTHORITY
OF THE STATE OF ILLINOIS

GENERAL NOTES

1. THE STANDARDS INCLUDED IN THE BACK OF THESE PLANS SHALL APPLY TO THIS PROJECT.
2. THESE PLANS HAVE BEEN PREPARED USING STANDARD SYMBOLS AS INDICATED IN THESE PLANS, AND THEY SHALL TAKE PRECEDENCE OVER THOSE SHOWN ON STANDARD 000001-06 IF THERE IS A CONFLICT.
3. EXISTING RAISED REFLECTIVE PAVEMENT MARKERS SHALL BE REMOVED PRIOR TO RESURFACING.
4. THE CONTRACTOR SHALL VERIFY ALL DIMENSIONS AND CONDITIONS IN THE FIELD PRIOR TO CONSTRUCTION AND ORDERING OF MATERIALS.
5. THE CONTRACTOR SHALL PROTECT UTILITY PROPERTY FROM CONSTRUCTION OPERATIONS AS OUTLINED IN ARTICLE 107.31 OF THE STANDARD SPECIFICATIONS. AGENCIES KNOWN TO HAVE FACILITIES WITHIN THE PROJECT AREA ARE AS FOLLOWS:

J.U.L.I.E. 1-800-892-0123

ILLINOIS STATE LAW REQUIRES A 48-HOUR NOTICE BE GIVEN TO ALL UTILITIES BEFORE DIGGING. FIELD MARKING OF FACILITIES MAY BE OBTAINED BY CONTACTING J.U.L.I.E. OR FOR NON-MEMBERS, BY CONTACTING THE UTILITY COMPANY DIRECTLY.

IT IS UNDERSTOOD AND AGREED THAT THE CONTRACTOR HAS TAKEN THE FOREGOING INTO CONSIDERATION IN SUBMITTING HIS BID, AND NO ADDITIONAL COMPENSATION WILL BE ALLOWED FOR ANY DELAYS OR INCONVENIENCES CAUSED BY THE SAME.

THE INFORMATION AND DATA SHOWN OR INDICATED ON THESE IMPROVEMENT PLANS WITH RESPECT TO EXISTING UNDERGROUND FACILITIES AND UTILITIES AT OR CONTIGUOUS TO THE SITE IS BASED ON INFORMATION AND DATA FURNISHED BY THE OWNERS OF SUCH UNDERGROUND FACILITIES AND UTILITIES OR BY OTHERS. FIELD MARKINGS OF FACILITIES IN CRITICAL AREAS MAY BE OBTAINED BY PROVIDING A MINIMUM OF 96 HOURS ADVANCE NOTICE TO THE RESIDENT ENGINEER SO THAT UTILITIES CAN BE GIVEN NOTICE. NO GUARANTEE IS IMPLIED AS TO THE ACCURACY OR COMPLETENESS OF ANY SUCH INFORMATION OR DATA; AND CONTRACTOR SHALL HAVE FULL RESPONSIBILITY FOR (i) REVIEWING AND CHECKING ALL SUCH INFORMATION AND DATA, (ii) VERIFYING IF ANY CONFLICTS EXIST WITH THE PROPOSED WORK AND UNDERGROUND FACILITIES AND UTILITIES SHOWN OR INDICATED ON THE IMPROVEMENT PLANS; (iii) COORDINATION OF THE WORK WITH THE OWNERS OF SUCH UNDERGROUND FACILITIES AND UTILITIES DURING CONSTRUCTION, AND (iv) THE SAFETY AND PROTECTION OF ALL SUCH UNDERGROUND FACILITIES AND UTILITIES AND REPAIR ANY DAMAGE THERETO RESULTING FROM THE WORK AT HIS EXPENSE.

6. FULL DEPTH SAW CUTTING ON ALL EDGES FOR REMOVAL ITEMS SHALL BE INCLUDED IN THE COST OF THE REMOVAL ITEM AS INDICATED AND IN ACCORDANCE WITH SECTION 440 OF THE STANDARD SPECIFICATIONS.
7. FOR STABILIZATION, ALL TYPE III BARRICADES SHALL REQUIRE A MINIMUM OF FOUR SANDBAGS PER BARRICADE.
8. ALL AREAS DISTURBED BEYOND THE CONSTRUCTION LIMITS FOR ANY REASON SHALL BE SEEDED WITH CLASS 2 SEEDING, AS DIRECTED BY THE ENGINEER. NUTRIENTS SHALL CONFORM TO ARTICLE 250.04. FINAL SEEDING SHALL BE PERFORMED AS SOON AS POSSIBLE. THESE AREAS WILL NOT BE MEASURED FOR PAYMENT.
9. WHERE SECTION OR SUBSECTION MONUMENTS ARE ENCOUNTERED, THE ENGINEER SHALL BE NOTIFIED BEFORE SUCH MONUMENTS ARE REMOVED. THE CONTRACTOR SHALL PROTECT AND CAREFULLY PRESERVE ALL MONUMENTS UNTIL AN AUTHORIZED SURVEYOR OR AGENT HAS WITNESSED OR OTHERWISE REFERENCED THEIR LOCATION. THE CONTRACTOR SHALL BE RESPONSIBLE FOR HAVING AN AUTHORIZED SURVEYOR REESTABLISH ANY SECTION OR SUBSECTION MONUMENTS DESTROYED BY HIS/HER OPERATIONS.
10. The Contractor shall re-establish proper drainage and all irregularities shall be shaped, trimmed and finish to match into existing grade lines.

11. THE FOLLOWING RATES OF APPLICATION HAVE BEEN USED TO CALCULATE THE PLAN QUANTITIES:

BITUMINOUS MATERIALS (PRIME COAT)	0.00038 TON/SQ. YD. (ON PAVEMENT)
BITUMINOUS MATERIALS (PRIME COAT)	0.001425 TON/SQ. YD. (ON AGG.)
AGGREGATE PRIME COAT	0.002 TON/SQ. YD.
BITUMINOUS CONCRETE SURFACE / BINDER	0.056 TON/SQ. YD. PER 1"
AGGREGATE MATERIAL	2.05 TON/CU. YD.

MIXTURE TABLES

Location(s):	I-72
MIXTURE USE(S):	LEVELING BINDER (Interlayer)
PG:	PG 64-22
DESIGN AIR VOIDS:	4.0% @ N50
Mixture Composition:	IL 9.5
FRICTION AGGREGATE:	N/A
Quality Management:	QCP (Note 1)
Mixture Sublot Size:	1,000 Tons

Location(s):	I-72 Shoulders
MIXTURE USE(S):	HMA Base Course
PG:	PG 64-22
DESIGN AIR VOIDS:	4.0% @ N50
Mixture Composition:	IL 19.0 or IL 19.0CB
FRICTION AGGREGATE:	N/A
Quality Management:	QC/QA
Mixture Sublot Size:	N/A

Note 1: The density pay factor will be equal to 100% for sublots with all interval test result within acceptable limits.

COMMITMENTS

1. THE RESIDENT ENGINEER SHALL CONTACT STUDIES & PLANS CONCERNING ANY MAJOR PLAN CHANGES.

DISTRICT SIX	
EXAMINED	December 29th 20 14
<i>John C. Nguyen</i>	
OPERATIONS ENGINEER	
EXAMINED	December 19 20 14
<i>Ron Chamberlain</i>	
PROJECT IMPLEMENTATION ENGINEER	
EXAMINED	December 19 20 14
<i>Jeffrey P. Myer</i>	
PROGRAM DEVELOPMENT ENGINEER	

90/10 FED/STATE

CONSTR. CODE
6-00745-0000

CODE NO.	ITEM	UNIT	TOTAL QUANTITY	ROADWAY	
				0005	RURAL
35501300	HOT-MIX ASPHALT BASE COURSE, 4"	SO YD	8516.5	8516.5	
35501328	HOT-MIX ASPHALT BASE COURSE, 11"	SO YD	22812	22812	
40600275	BITUMINOUS MATERIALS (PRIME COAT)	POUND	34218	34218	
40600625	LEVELING BINDER (MACHINE METHOD), N50	TON	5322.8	5322.8	
40600982	HOT-MIX ASPHALT SURFACE REMOVAL - BUTT JOINT	SO YD	1778	1778	
44000162	HOT-MIX ASPHALT SURFACE REMOVAL, 3 1/4"	SO YD	114060	114060	
44000178	HOT-MIX ASPHALT SURFACE REMOVAL, 7 1/4"	SO YD	38020	38020	
44004250	PAVED SHOULDER REMOVAL	SO YD	22812	22812	
44200529	CLASS A PATCHES, TYPE II, 8 INCH	SO YD	110.9	110.9	
44200533	CLASS A PATCHES, TYPE III, 8 INCH	SO YD	116.6	116.6	
44200535	CLASS A PATCHES, TYPE IV, 8 INCH	SO YD	208.4	208.4	
44213000	PATCHING REINFORCEMENT	SO YD	457.2	457.2	
44213200	SAW CUTS	FOOT	1892.5	1892.5	
44213206	TIE BARS 5/8"	EACH	462.5	462.5	

90/10 FED/STATE

CONSTR. CODE
6-00745-0000

CODE NO.	ITEM	UNIT	TOTAL QUANTITY	ROADWAY	
				0005	RURAL
48102100	AGGREGATE WEDGE SHOULDER, TYPE B	TON	5196	5196	
63500105	DELINEATORS	EACH	86	86	
64200116	SHOULDER RUMBLE STRIPS, 16 INCH	FOOT	68436	68436	
67000400	ENGINEER'S FIELD OFFICE, TYPE A	CAL MD	12	12	
67100100	MOBILIZATION	L SUM	1	1	
70100700	TRAFFIC CONTROL AND PROTECTION, STANDARD 701406	L SUM	1	1	
70100800	TRAFFIC CONTROL AND PROTECTION, STANDARD 701401	L SUM	1	1	
70103815	TRAFFIC CONTROL SURVEILLANCE	CAL DA	60	60	
70106800	CHANGEABLE MESSAGE SIGN	CAL MD	12	12	
70300100	SHORT TERM PAVEMENT MARKING	FOOT	10265.4	10265.4	
70300230	TEMPORARY PAVEMENT MARKING - LINE 5"	FOOT	76992	76992	
* 78005120	EPOXY PAVEMENT MARKING - LINE 5"	FOOT	76992	76992	
* 78100100	RAISED REFLECTIVE PAVEMENT MARKER	EACH	430	430	
78300100	PAVEMENT MARKING REMOVAL	SO FT	4277	4277	

* SPECIALTY ITEM

FILE NAME : c:\pwork\pvidot\sparkg\0360559\067	USER NAME : sparkg 092-shs-500.dgn	DESIGNED - DRAWN -	REVISED - REVISED -	STATE OF ILLINOIS DEPARTMENT OF TRANSPORTATION	SUMMARY OF QUANTITIES				F.A.I. RTE. 72	SECTION (84-10-2)RS-5	COUNTY SANGAMON	TOTAL SHEETS 28	SHEET NO. 3
Default	PLOT SCALE = 100.0000' / 1" =	CHECKED - DATE -	REVISED - REVISED -		SCALE:	SHEET	OF	SHEETS	STA.	TO STA.	CONTRACT NO. 72092		
	PLOT DATE = Jan-13-2015 01:49:24PM				ILLINOIS FED. AID PROJECT								

90/10 FED/STATE

CONSTR. CODE

6-00745-0000

CODE NO.	ITEM	UNIT	TOTAL QUANTITY	ROADWAY	
				0005	RURAL
78300200	RAISED REFLECTIVE PAVEMENT MARKER REMOVAL	EACH	430	430	
<input type="checkbox"/> X0320157	CLEANING UNDERDRAIN OUTLETS	EACH	132	132	
X0322279	OUTLET MARKER	EACH	132	132	
<input type="checkbox"/> X2503000	MAINTENANCE MOWING	ACRE	84	84	
X4200760	PORTLAND CEMENT CONCRETE OVERLAY, 6"	SQ YD	152080	152080	
X7010410	SPEED DISPLAY TRAILER	CAL MD	16	16	
X7200201	WIDTH RESTRICTION SIGNING	L SUM	1	1	
* X7830072	GROOVING FOR RECESSED PAVEMENT MARKING 6"	FOOT	76992	76992	
∅ Z0076600	TRAINEES	Hour	2000	2000	
X9900002	GEOTEXTILE FABRIC INTERLAYER	SQ YD	83937.3	83937.3	
∅ Z0076604	TRAINEES TRAINING PROGRAM GRADUATE	Hour	2000	2000	

Non - PART. (100% STATE)

* SPECIALTY ITEM

∅ 0042

FILE NAME =	USER NAME = sparkgs	DESIGNED -	REVISED -	STATE OF ILLINOIS DEPARTMENT OF TRANSPORTATION	SUMMARY OF QUANTITIES				F.A.I. RTE.	SECTION	COUNTY	TOTAL SHEETS	SHEET NO.
c:\pwwork\pwwork\sparkgs\d0360559\0572092-rlt-500.dgn		DRAWN -	REVISED -		72	(84-10-2)RS-5	SANGAMON	28	4				
PLOT SCALE = 100.0000 ' / in.		CHECKED -	REVISED -		CONTRACT NO. 72092								
Default	PLOT DATE = Jan-13-2015 01:49:24PM	DATE -	REVISED -		SCALE:	SHEET	OF	SHEETS	STA.	TO STA.	ILLINOIS FED. AID PROJECT		

LOCATION (EB, WB, STATION)	LENGTH	HMA SURFACE REMOVAL, 3.25"	HMA SURFACE REMOVAL, 7.25"	HMA BASE COURSE, 4"	GEOTEXTILE FABRIC INTERLAYER	HMA LEVEL BINDER, 1.25"	P. C. C. OVERLAY, 6"	PRIME COAT
	(FOOT)	(SQ YD)	(SQ YD)	(TON)	(SQ YD)	(TON)	(SQ YD)	(POUND)
WB, 0+00 TO 171+00	17109	57030	19010.0	4258.2	83644.0		76040.0	
EB, 0+00 TO 171+00	17109	57030	19010.0	4258.2		5322.8	76040.0	34218
EB, 0+00 TO 30+00	30				146.7			
EB, 170+79 TO 171+09	30				146.7			
TOTALS =		114060.0	38020.0	8516.5	83937.3	5322.8	152080.0	34218.00

ESTIMATED PATCHING QUANTITY						
	CLASS A, 8 INCH			SAW CUTS	REINFORCEMENT	TIE BARS 5/8"
	TY II	TY III	TY IV			
	SY	SY	SY	FT	SY	EACH
TOTALS	22.2	23.3	41.7	378.5	87.2	92.5

Pavement Marking Schedule						
Location	Length	EPOXY		RRPM	Remove RRPM	Grooving for recessed markings
		Edge Line 5"	Skip Dash 5"			
Sta 0+00 to 171+09 WB	17109	34218	4278	215	215	38496
Sta 0+00 to 171+09 EB	17109	34218	4278	215	215	38496
Totals		68436	8556	430	430	76992

PAVEMENT PATCHING SCHEDULE					CLASS A, 8 INCH			SAW CUTS	PATCHING REINF.	TIE BARS 5/8"
					TY II	TY III	TY IV			
STATION	LANE	LENGTH	WIDTH	AREA	44200577	44200581	44200583	44213200	44213000	44213206
		(FT)	(FT)	(S. Y.)	(S. Y.)	(S. Y.)	(S. Y.)	(FT)	(S. Y.)	(EA.)
9+20	WBDL	25	6	16.7	--	16.7	--	74.0	16.7	23.0
11+60	WBDL	15	6	10.0	10.0	--	--	54.0	10.0	--
14+00	WBDL	120	6	80.0	--	--	80.0	264.0	80.0	118.0
21+25	WBDL	6	12	8.0	8.0	--	--	60.0	8.0	--
33+20	WBDL	20	6	13.3	13.3	--	--	64.0	13.3	18.0
46+40	WBDL	20	6	13.3	13.3	--	--	64.0	13.3	18.0
143+30	WBDL	15	12	20.0	--	20.0	--	78.0	20.0	--
146+90	WBDL	20	6	13.3	13.3	--	--	64.0	13.3	18.0
148+90	WBDL	30	6	20.0	--	20.0	--	84.0	20.0	28.0
157+25	WBDL	6	12	8.0	8.0	--	--	60.0	8.0	--
165+00	WBDL	25	6	16.7	--	16.7	--	74.0	16.7	23.0
167+75	WBDL	10	6	6.7	6.7	--	--	44.0	6.7	--
168+00	WBDL	15	12	20.0	--	20.0	--	78.0	20.0	--
156+30	EBDL	40	6	26.7	--	--	26.7	104.0	26.7	38.0
155+90	EBDL	6	12	8.0	8.0	--	--	60.0	8.0	--
155+84	EBDL	40	6	26.7	--	--	26.7	104.0	26.7	38.0
153+50	EBDL	6	12	8.0	8.0	--	--	60.0	8.0	--
135+40	EBDL	50	6	33.3	--	--	33.3	124.0	33.3	48.0
TOTALS:					88.7	93.3	166.7	1514.0	348.7	370.0

Patching Total: 348.7

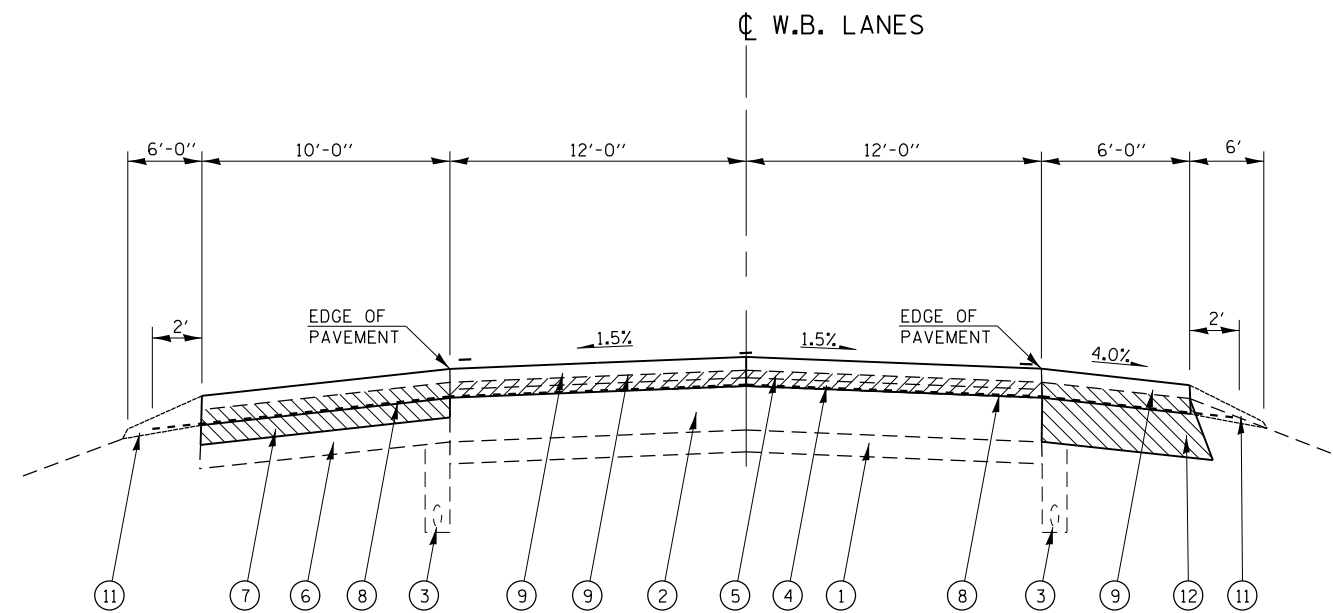

WESTBOUND LANES

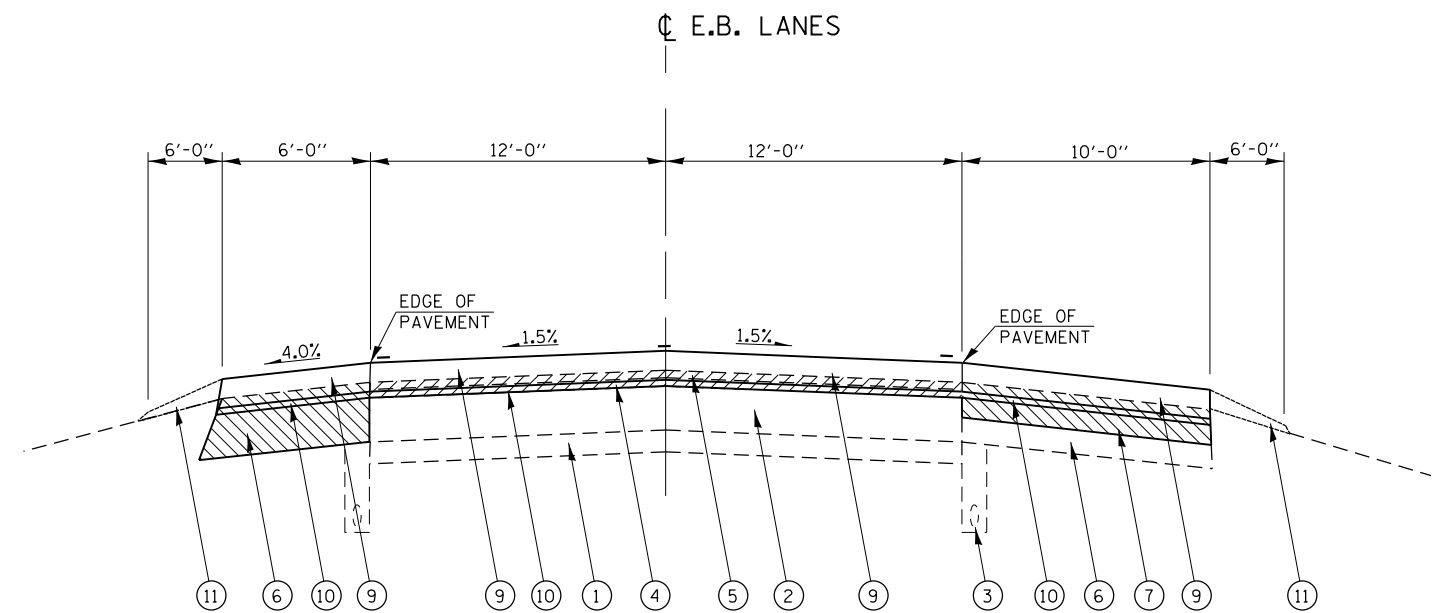

EASTBOUND LANES

F.A.I. RTE. 72
STA. 0 + 00.00 – STA. 171 + 09.00

LEGEND

- ① EXIST. STABILIZED SUB-BASE, 4"
 - ② EXIST. CONTINUOUS REINFORCED P.C.C. PAVEMENT, 8"
 - ③ EXIST. PIPE UNDERDRAINS
 - ④ EXIST. HMA BINDER COURSE, MIX B, TY 1, 1.75"
 - ⑤ EXIST. HMA SURFACE COURSE, MIX D, CL. 1, TY 1, 1.5"
 - ⑥ EXIST. HMA SHOULDER (WITH RUMBLE STRIPS), 11.25"
 - ⑦ PROPOSED HMA BASE COURSE, 4"
 - ⑧ PROPOSED GEOFABRIC INTERLAYER
 - ⑨ PROPOSED CONCRETE OVERLAY, 6"
 - ⑩ PROPOSED LEVELING BINDER, 1.25"
 - ⑪ PROPOSED WEDGE AGGREGATE SHOULDER, TYPE B
 - ⑫ PROPOSED HMA BASE COURSE 11"
- PROPOSED HMA SURFACE REMOVAL, 3.25"
 (REMOVAL TO BARE P.C.C.)
- PROPOSED HMA SURFACE REMOVAL, 7.25"
 (REMOVAL DEPTH FOR HMA SHOULDER)

FILE NAME =	USER NAME = sparksgw	DESIGNED - VTY	REVISED -
c:\pwork\pwork\sparksgw\0360559\0672092-sht-typicals-modified.dgn		DRAWN - RTS	REVISED -
Default	PLOT SCALE = 20.0000' / in.	CHECKED - VTY	REVISED -
	PLOT DATE = Jan-13-2015 01:51:05PM	DATE - 10-15-2014	REVISED -

STATE OF ILLINOIS
DEPARTMENT OF TRANSPORTATION

TYPICAL SECTIONS

SCALE: SHEET 2 OF 2 SHEETS STA. TO STA.

F.A.I. RTE.	SECTION	COUNTY	TOTAL SHEETS	SHEET NO.
72	(84-10-2)RS-5	SANGAMON	28	6
CONTRACT NO. 72G92			ILLINOIS FED. AID PROJECT	

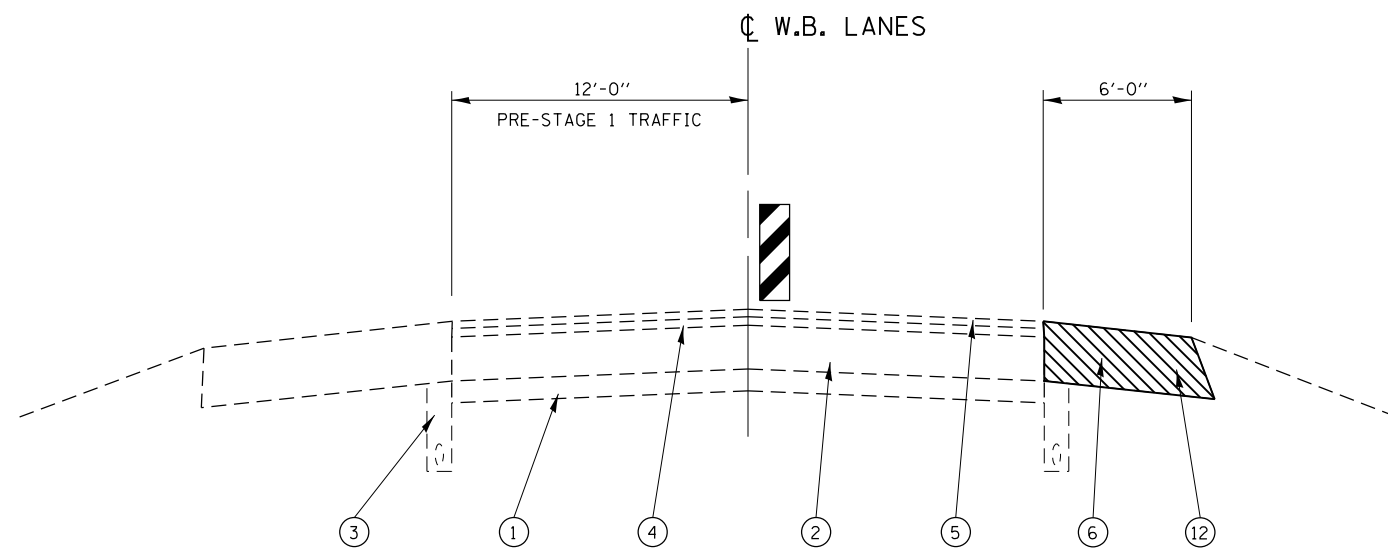

PRE-STAGE 1 TRAFFIC /CONSTRUCTION
WESTBOUND LANES

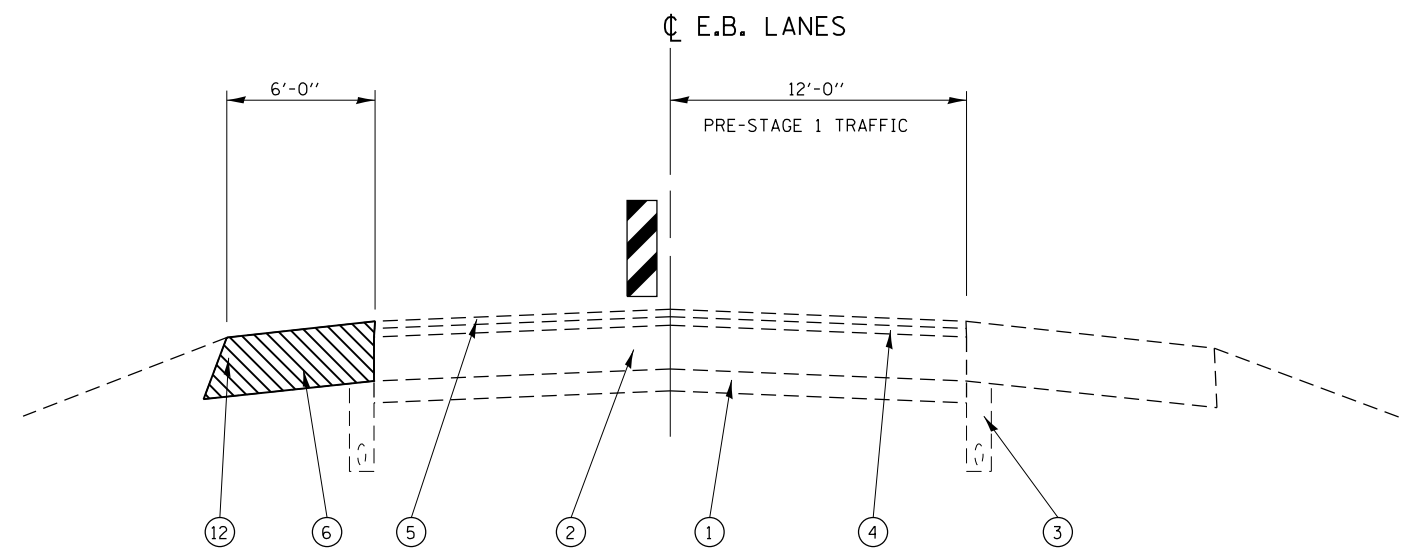

PRE-STAGE 1 TRAFFIC /CONSTRUCTION
EASTBOUND LANES

F.A.I. RTE. 72
STA. 0 + 00.00 – STA. 171 + 09.00

PRE-STAGE 1

SUGGESTED SEQUENCE OF CONSTRUCTION
PRE-STAGE 1, WESTBOUND TRAFFIC

1. REMOVE AND RECONSTRUCT EXISTING 11" MEDIAN SHOULDER.

LEGEND

- ① EXIST. STABILIZED SUB-BASE, 4"
- ② EXIST. CONTINUOUS REINFORCED P.C.C. PAVEMENT, 8"
- ③ EXIST. PIPE UNDERDRAINS
- ④ EXIST. HMA BINDER COURSE, MIX B, TY 1, 1.75"
- ⑤ EXIST. HMA SURFACE COURSE, MIX D, CL. 1, TY 1, 1.5"
- ⑥ EXIST. HMA SHOULDER (WITH RUMBLE STRIPS), 11.25"
- ⑦ PROPOSED HMA BASE COURSE, 4"
- ⑧ PROPOSED GEOFABRIC INTERLAYER
- ⑨ PROPOSED CONCRETE OVERLAY, 6"
- ⑩ PROPOSED LEVELING BINDER, 1.25"
- ⑪ PROPOSED WEDGE AGGREGATE SHOULDER, TYPE B
- ⑫ PROPOSED HMA BASE COURSE 11"

SUGGESTED SEQUENCE OF CONSTRUCTION
PRE-STAGE 1, EASTBOUND TRAFFIC

1. REMOVE AND RECONSTRUCT EXISTING 11" MEDIAN SHOULDER.

FILE NAME =	USER NAME = sparksgw	DESIGNED - VTY	REVISED -
et:\pw\work\p\idot\sparksgw\0360559\0672092-sh-typical-modified.dgn		DRAWN - RTS	REVISED -
Default	PLOT SCALE = 20.0000' / in.	CHECKED - VTY	REVISED -
	PLOT DATE = Jan-13-2015 01:51:06PM	DATE - 10-23-2014	REVISED -

STATE OF ILLINOIS
DEPARTMENT OF TRANSPORTATION

TYPICAL SECTIONS
PRE-STAGE 1 CONSTRUCTION

SCALE: SHEET 1 OF 1 SHEETS STA. TO STA.

F.A.I. RTE.	SECTION	COUNTY	TOTAL SHEETS	SHEET NO.
72	(84-10-2)RS-5	SANGAMON	28	7
CONTRACT NO. 72G92			ILLINOIS FED. AID PROJECT	

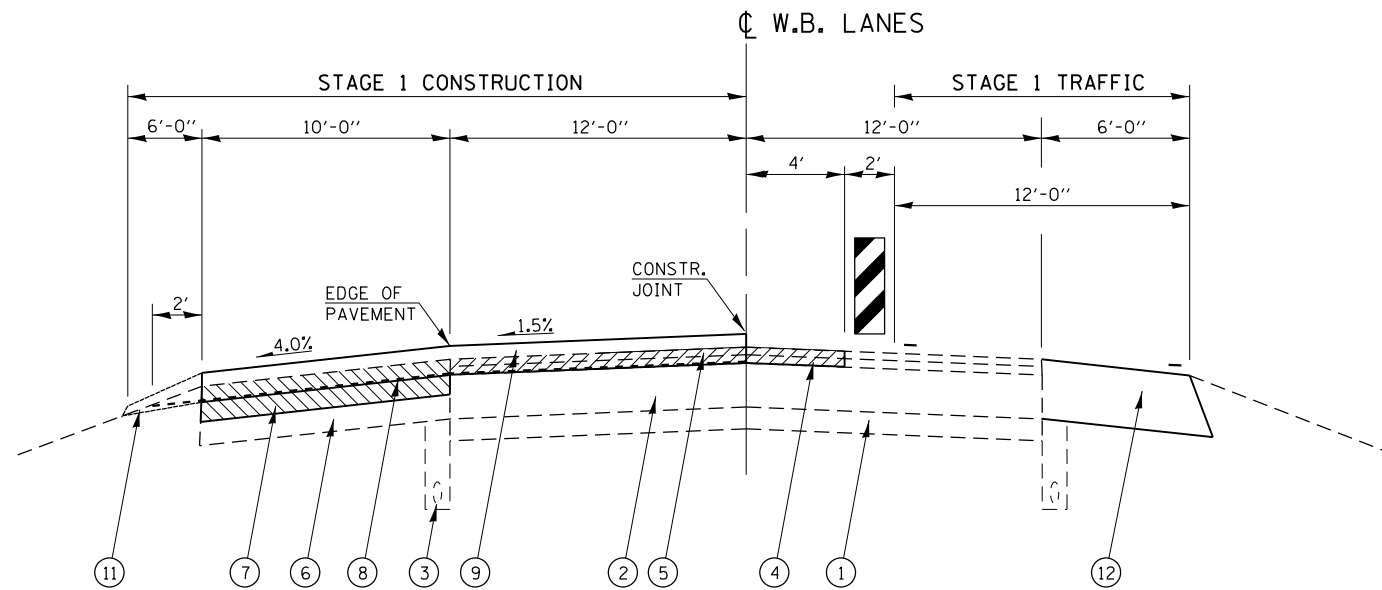

STAGE 1 TRAFFIC /CONSTRUCTION
WESTBOUND LANES

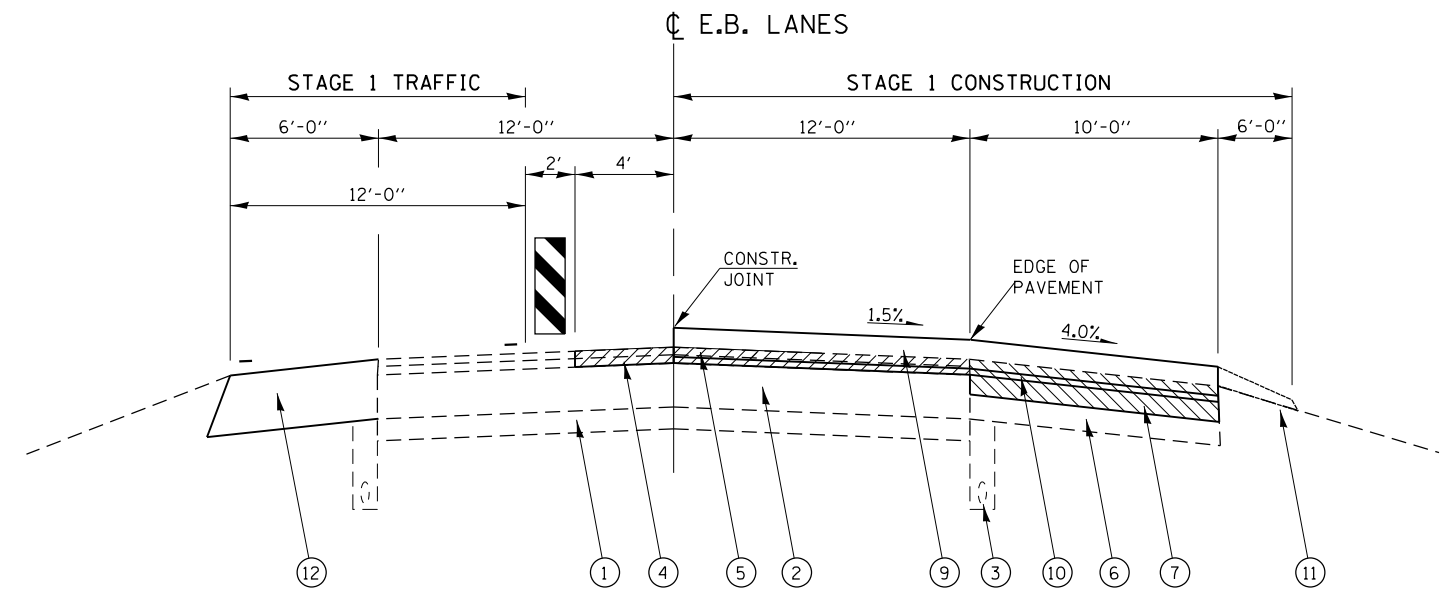

STAGE 1 TRAFFIC /CONSTRUCTION
EASTBOUND LANES

F.A.I. RTE. 72
STA. 0 + 00.00 – STA. 171 + 09.00

SUGGESTED SEQUENCE OF CONSTRUCTION
STAGE 1, WESTBOUND TRAFFIC

1. MILL MAINLINE PAVEMENT 3.25" (TO BARE P.C.C.)
2. MILL OUTSIDE HMA SHOULDER 7.25"
3. RESURFACE OUTSIDE HMA SHOULDER WITH HMA BINDER COURSE, 4".
4. PLACE GEOFABRIC INTERLAYER 2' FROM OUTSIDE EDGE OF HMA SHOULDER TO EDGE OF MILLED MAINLINE SURFACE (WIDTH = 21').
5. PLACE CONCRETE OVERLAY, 6" ON HMA SHOULDER AND MAINLINE PAVEMENT.
6. PLACE AGGREGATE SHOULDERS.

LEGEND

- ① EXIST. STABILIZED SUB-BASE, 4"
 - ② EXIST. CONTINUOUS REINFORCED P.C.C. PAVEMENT, 8"
 - ③ EXIST. PIPE UNDERDRAINS
 - ④ EXIST. HMA BINDER COURSE, MIX B, TY 1, 1.75"
 - ⑤ EXIST. HMA SURFACE COURSE, MIX D, CL. 1, TY 1, 1.5"
 - ⑥ EXIST. HMA SHOULDER (WITH RUMBLE STRIPS), 11.25"
 - ⑦ PROPOSED HMA BASE COURSE, 4"
 - ⑧ PROPOSED GEOFABRIC INTERLAYER
 - ⑨ PROPOSED CONCRETE OVERLAY, 6"
 - ⑩ PROPOSED LEVELING BINDER, 1.25"
 - ⑪ PROPOSED WEDGE AGGREGATE SHOULDER, TYPE B
 - ⑫ PROPOSED HMA BASE COURSE 11"
- PROPOSED HMA SURFACE REMOVAL, 3.25" (REMOVAL TO BARE P.C.C.)
 PROPOSED HMA SURFACE REMOVAL, 7.25" (REMOVAL DEPTH FOR HMA SHOULDER)

SUGGESTED SEQUENCE OF CONSTRUCTION
STAGE 1, EASTBOUND TRAFFIC

1. MILL MAINLINE PAVEMENT 3.25" (TO BARE P.C.C.)
2. MILL OUTSIDE HMA SHOULDER 7.25"
3. RESURFACE OUTSIDE HMA SHOULDER WITH HMA BINDER COURSE, 4".
4. PLACE HMA LEVEL BINDER, 1.25" FROM OUTSIDE EDGE OF HMA SHOULDER TO EDGE OF MILLED SURFACE.
5. PLACE CONCRETE OVERLAY, 6" ON HMA SHOULDER AND MAINLINE PAVEMENT.
6. PLACE AGGREGATE SHOULDERS.

FILE NAME =	USER NAME = sparksgw	DESIGNED - VTY	REVISED -
ct:\pw\work\p\id\sparksgw\0360559\0672092-sh1-typicals-modified.dgn		DRAWN - RTS	REVISED -
Default	PLOT SCALE = 20.0000' / in.	CHECKED - VTY	REVISED -
	PLOT DATE = Jan-13-2015 01:51:06PM	DATE - 10-15-2014	REVISED -

STATE OF ILLINOIS
DEPARTMENT OF TRANSPORTATION

TYPICAL SECTIONS			
STAGE 1 CONSTRUCTION			
SCALE:	SHEET 1	OF 2 SHEETS	STA. TO STA.

F.A.I. RTE.	SECTION	COUNTY	TOTAL SHEETS	SHEET NO.
72	(84-10-2)RS-5	SANGAMON	28	8
CONTRACT NO.			72G92	
ILLINOIS FED. AID PROJECT				

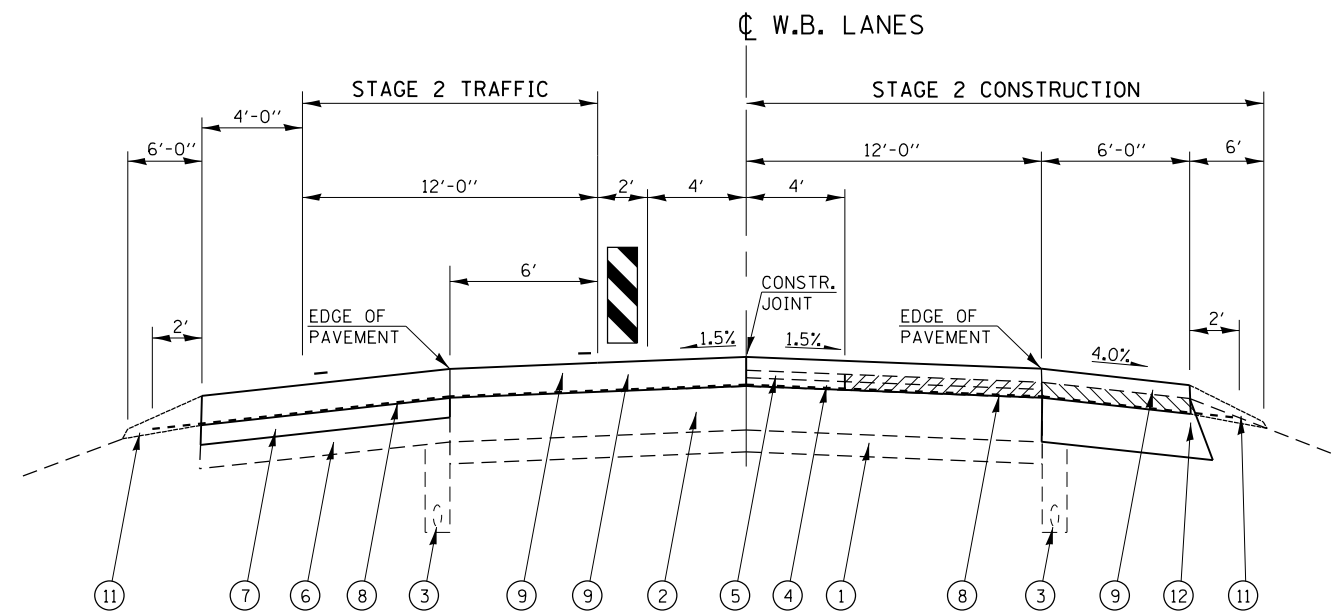

STAGE 2 TRAFFIC /CONSTRUCTION

WESTBOUND LANES

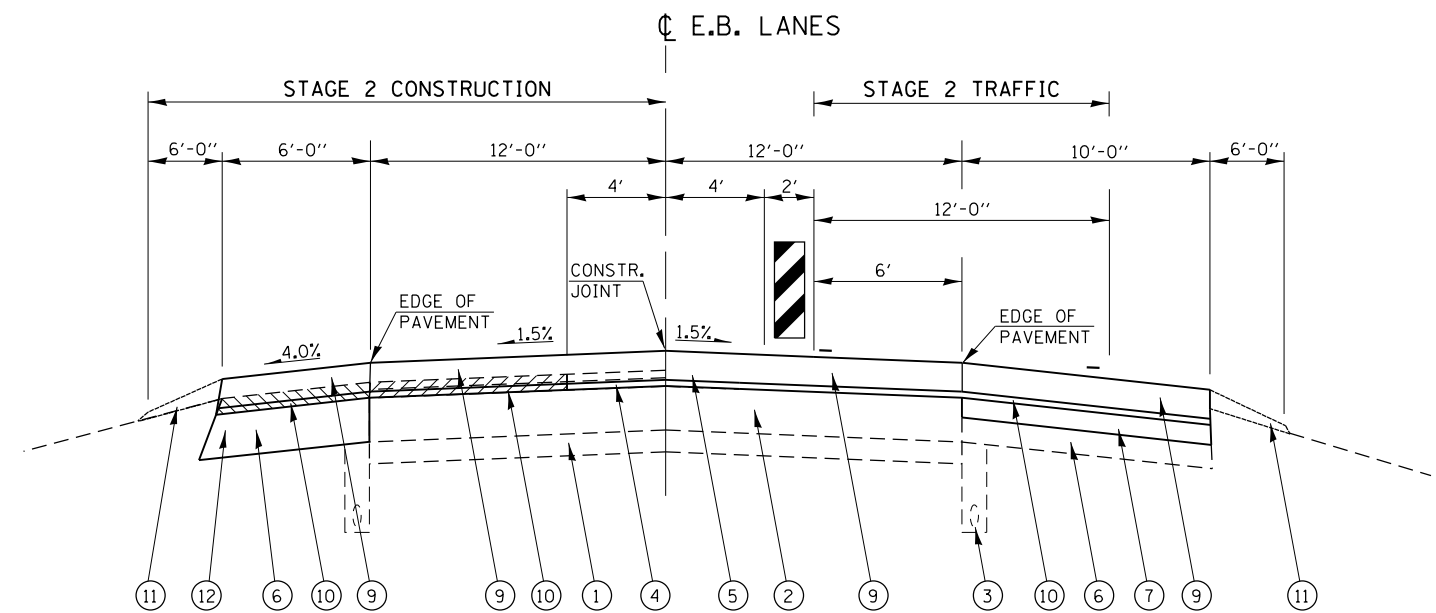

STAGE 2 TRAFFIC /CONSTRUCTION

EASTBOUND LANES

F.A.I. RTE. 72 STA. 0 + 00.00 – STA. 171 + 09.00

SUGGESTED SEQUENCE OF CONSTRUCTION

STAGE 2, WESTBOUND TRAFFIC

1. MILL MAINLINE PAVEMENT 3.25" (TO BARE P.C.C.)
2. MILL OUTSIDE HMA SHOULDER 3.25"
3. PLACE GEOFABRIC INTERLAYER 2' FROM OUTSIDE EDGE OF HMA SHOULDER TO EDGE OF MILLED MAINLINE SURFACE (WIDTH = 23').
4. PLACE CONCRETE OVERLAY, 6" ON HMA SHOULDER AND MAINLINE PAVEMENT.
5. PLACE AGGREGATE SHOULDERS.

LEGEND

- ① EXIST. STABILIZED SUB-BASE, 4"
- ② EXIST. CONTINUOUS REINFORCED P.C.C. PAVEMENT, 8"
- ③ EXIST. PIPE UNDERDRAINS
- ④ EXIST. HMA BINDER COURSE, MIX B, TY 1, 1.75"
- ⑤ EXIST. HMA SURFACE COURSE, MIX D, CL. 1, TY 1, 1.5"
- ⑥ EXIST. HMA SHOULDER (WITH RUMBLE STRIPS), 11.25"
- ⑦ PROPOSED HMA BASE COURSE, 4"
- ⑧ PROPOSED GEOFABRIC INTERLAYER
- ⑨ PROPOSED CONCRETE OVERLAY, 6"
- ⑩ PROPOSED LEVELING BINDER, 1.25"
- ⑪ PROPOSED WEDGE AGGREGATE SHOULDER, TYPE B
- ⑫ PROPOSED HMA BASE COURSE 11"

PROPOSED HMA SURFACE REMOVAL, 3.25" (REMOVAL TO BARE P.C.C.)

PROPOSED HMA SURFACE REMOVAL, 7.25" (REMOVAL DEPTH FOR HMA SHOULDER)

SUGGESTED SEQUENCE OF CONSTRUCTION

STAGE 2, EASTBOUND TRAFFIC

1. MILL MAINLINE PAVEMENT 3.25" (TO BARE P.C.C.)
2. MILL OUTSIDE HMA SHOULDER 3.25"
3. RESURFACE OUTSIDE HMA SHOULDER WITH HMA BINDER COURSE, 4".
4. PLACE HMA LEVEL BINDER, 1.25" FROM OUTSIDE EDGE OF HMA SHOULDER TO EDGE OF MILLED SURFACE.
5. PLACE CONCRETE OVERLAY, 6" ON HMA SHOULDER AND MAINLINE PAVEMENT.
6. PLACE AGGREGATE SHOULDERS.

FILE NAME =	USER NAME = sparksgw	DESIGNED - VTY	REVISED -
Default	Plot Scale = 20.0000' / in.	DRAWN - RTS	REVISED -
	PLOT DATE = Jan-13-2015 01:51:06PM	CHECKED - VTY	REVISED -
		DATE - 10-15-2014	REVISED -

**STATE OF ILLINOIS
DEPARTMENT OF TRANSPORTATION**

TYPICAL SECTIONS STAGE 2 CONSTRUCTION			
SCALE:	SHEET 2	OF 2 SHEETS	STA. TO STA.

F.A.I. RTE.	SECTION	COUNTY	TOTAL SHEETS	SHEET NO.
72	(84-10-2)RS-5	SANGAMON	28	9
CONTRACT NO. 72G92			ILLINOIS FED. AID PROJECT	

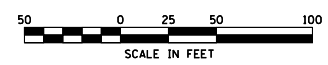

STA. 0+00.00 BEGIN
SECTION (84-10-1RS-3, 84-102RS-4) IMPROVEMENTS

ELEVATION EQUATION:
STATION 0+00.00 (BK) =
STATION 0+00.00 (AH)

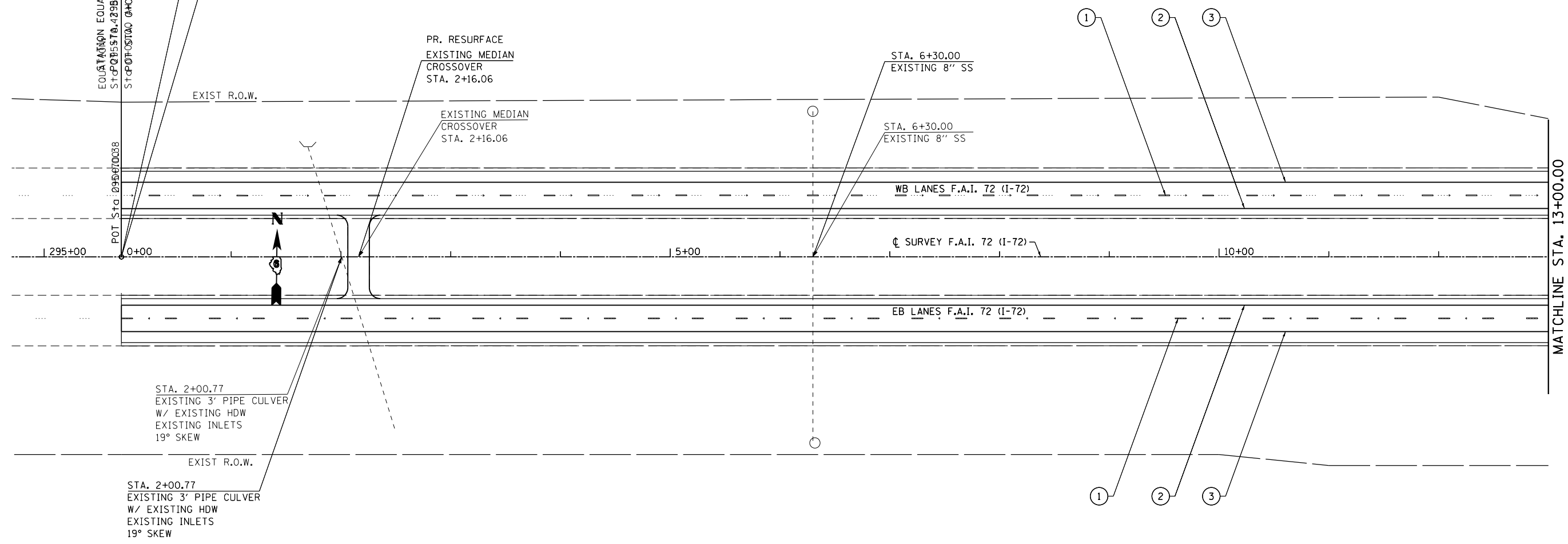

MATCHLINE STA. 13+00.00

PAVEMENT MARKING LEGEND

- ① EPOXY PAVEMENT MARKING - LINE, 5" (30' SKIP, 10' DASH, WHITE)
- ② EPOXY PAVEMENT MARKING - LINE, 5" (SOLID YELLOW)
- ③ EPOXY PAVEMENT MARKING - LINE, 5" (SOLID WHITE)

FILE NAME =	USER NAME = sparksgw	DESIGNED -	REVISED -
Default	2092-sht-plan-50-021.dgn	DRAWN -	REVISED -
	PLOT SCALE = 100.0000' / in.	CHECKED -	REVISED -
	PLOT DATE = Jan-13-2015 01:51:18PM	DATE -	REVISED -

**STATE OF ILLINOIS
DEPARTMENT OF TRANSPORTATION**

PLAN SHEET - F.A.I. 72 (I-72)

SCALE: SHEET 1 OF 13 SHEETS STA. TO STA.

F.A.I. RTE.	SECTION	COUNTY	TOTAL SHEETS	SHEET NO.
72	(84-10-2)RS-5	SANGAMON	28	10
CONTRACT NO. 72G92				
ILLINOIS FED. AID PROJECT				

EXIST. CURVE 8039
 PI STA. = 25+49.29
 Δ = 1° 14' 44" (LT)
 D = 0° 08' 04"
 R = 42,630.10'
 T = 463.36'
 L = 926.68'
 E = 2.52'
 e = NORMAL CROWN
 T.R. = -----
 S.E. RUN = -----
 P.C. STA. = 20+85.93
 P.T. STA. = 30+12.61

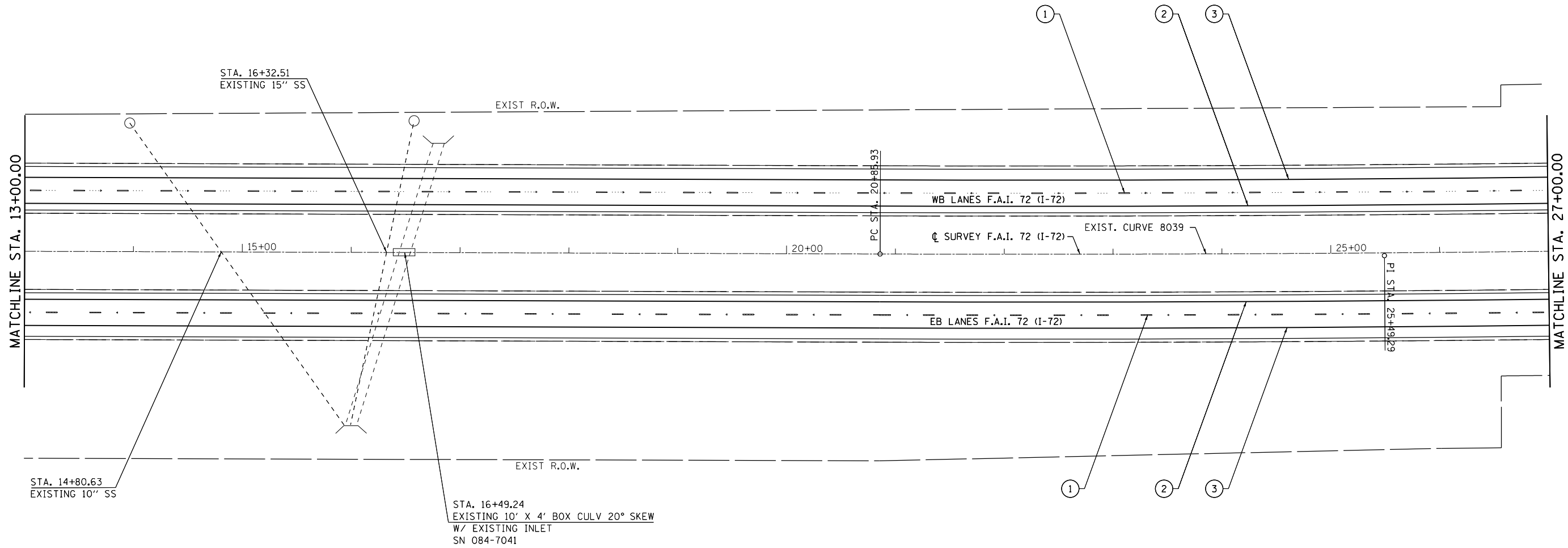
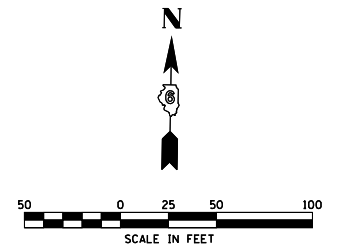

PAVEMENT MARKING LEGEND

- ① EPOXY PAVEMENT MARKING - LINE, 5" (30' SKIP, 10' DASH, WHITE)
- ② EPOXY PAVEMENT MARKING - LINE, 5" (SOLID YELLOW)
- ③ EPOXY PAVEMENT MARKING - LINE, 5" (SOLID WHITE)

FILE NAME =	USER NAME = sparksgw	DESIGNED -	REVISED -
Default	2092-sht-plan-50-021.dgn	DRAWN -	REVISED -
	PLOT SCALE = 100.0000' / in.	CHECKED -	REVISED -
	PLOT DATE = Jan-13-2015 01:51:55PM	DATE -	REVISED -

**STATE OF ILLINOIS
 DEPARTMENT OF TRANSPORTATION**

PLAN SHEET - F.A.I. 72 (I-72)

SCALE: SHEET 2 OF 13 SHEETS STA. TO STA.

F.A.I. RTE.	SECTION	COUNTY	TOTAL SHEETS	SHEET NO.
72	(84-10-2)RS-5	SANGAMON	28	11
ILLINOIS FED. AID PROJECT			CONTRACT NO. 72G92	

EXIST. CURVE 8039
 PI STA. = 25+49.29
 $\Delta = 1^\circ 14' 44''$ (LT)
 D = 0° 08' 04"
 R = 42,630.10'
 T = 463.36'
 L = 926.68'
 E = 2.52'
 e = NORMAL CROWN
 T.R. = -----
 S.E. RUN = -----
 P.C. STA. = 20+85.93
 P.T. STA. = 30+12.61

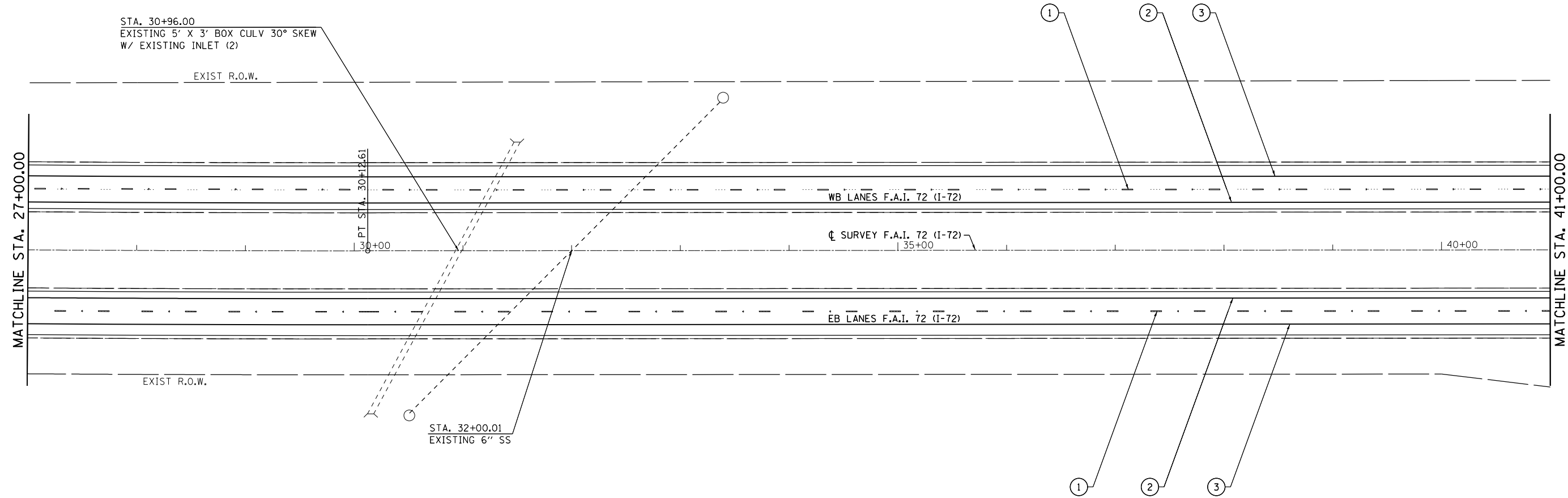
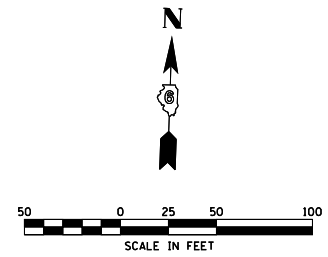

PAVEMENT MARKING LEGEND

- ① EPOXY PAVEMENT MARKING - LINE, 5" (30' SKIP, 10' DASH, WHITE)
- ② EPOXY PAVEMENT MARKING - LINE, 5" (SOLID YELLOW)
- ③ EPOXY PAVEMENT MARKING - LINE, 5" (SOLID WHITE)

FILE NAME =	USER NAME = sparksgw	DESIGNED -	REVISED -
et:\pw\work\p\idot\sparksgw\10360559\0672092-sht-plan-50-021.dgn		DRAWN -	REVISED -
Default	PLOT SCALE = 100.0000' / in.	CHECKED -	REVISED -
	PLOT DATE = Jan-13-2015 01:51:16PM	DATE -	REVISED -

**STATE OF ILLINOIS
 DEPARTMENT OF TRANSPORTATION**

PLAN SHEET - F.A.I. 72 (I-72)

SCALE: SHEET 3 OF 13 SHEETS STA. TO STA.

F.A.I. RTE.	SECTION	COUNTY	TOTAL SHEETS	SHEET NO.
72	(84-10-2)RS-5	SANGAMON	28	12
CONTRACT NO. 72G92			ILLINOIS FED. AID PROJECT	

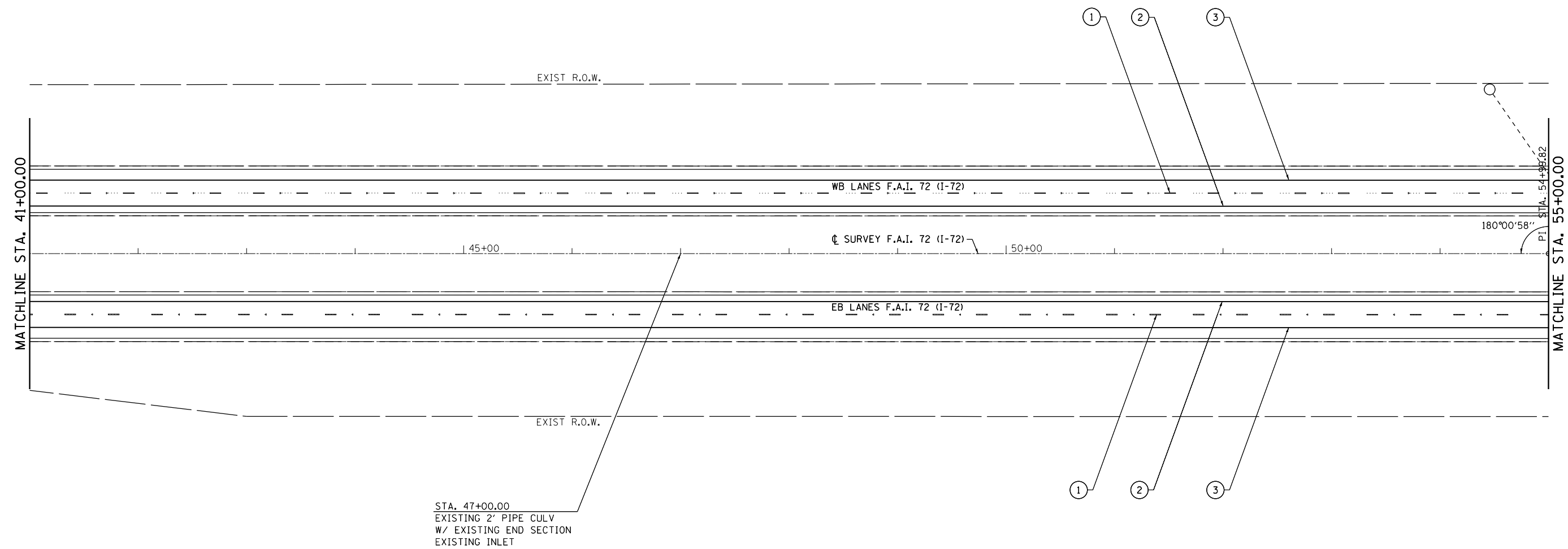
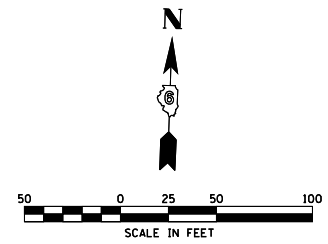

PAVEMENT MARKING LEGEND

- ① EPOXY PAVEMENT MARKING - LINE, 5" (30' SKIP, 10' DASH, WHITE)
- ② EPOXY PAVEMENT MARKING - LINE, 5" (SOLID YELLOW)
- ③ EPOXY PAVEMENT MARKING - LINE, 5" (SOLID WHITE)

FILE NAME =	USER NAME = sparksgw	DESIGNED -	REVISED -
et:\pw\work\p\idot\sparksgw\0360559\0672092-sht-plan-50-021.dgn		DRAWN -	REVISED -
Default	PLOT SCALE = 100.0000' / in.	CHECKED -	REVISED -
	PLOT DATE = Jan-13-2015 01:51:7PM	DATE -	REVISED -

**STATE OF ILLINOIS
DEPARTMENT OF TRANSPORTATION**

PLAN SHEET - F.A.I. 72 (I-72)

SCALE: SHEET 4 OF 13 SHEETS STA. TO STA.

F.A.I. RTE.	SECTION	COUNTY	TOTAL SHEETS	SHEET NO.
72	(84-10-2)RS-5	SANGAMON	28	13
ILLINOIS FED. AID PROJECT			CONTRACT NO. 72G92	

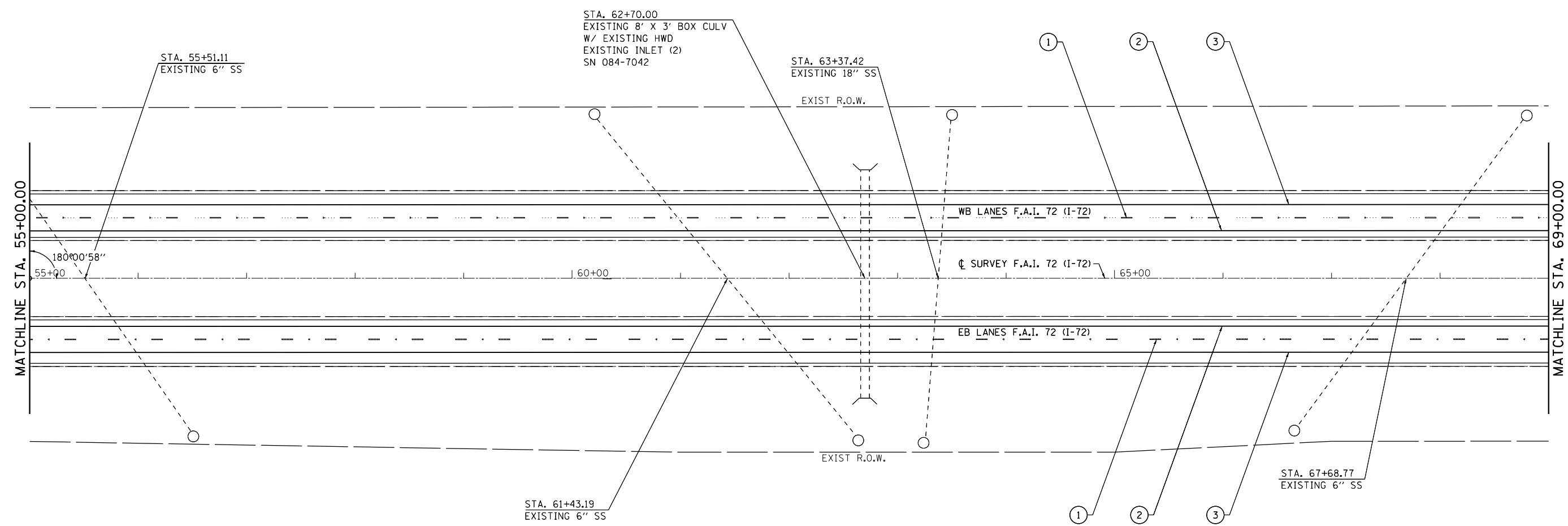
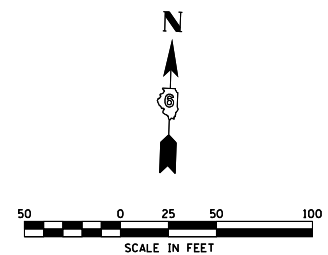

PAVEMENT MARKING LEGEND

- ① EPOXY PAVEMENT MARKING - LINE, 5" (30' SKIP, 10' DASH, WHITE)
- ② EPOXY PAVEMENT MARKING - LINE, 5" (SOLID YELLOW)
- ③ EPOXY PAVEMENT MARKING - LINE, 5" (SOLID WHITE)

FILE NAME =	USER NAME = sparksgw	DESIGNED -	REVISED -
c:\pwork\pwork\sparksgw\0360559\0672092-sht-plan-50-021.dgn		DRAWN -	REVISED -
Default	PLOT SCALE = 100.0000' / in.	CHECKED -	REVISED -
	PLOT DATE = Jan-13-2015 01:51:08PM	DATE -	REVISED -

**STATE OF ILLINOIS
DEPARTMENT OF TRANSPORTATION**

PLAN SHEET - F.A.I. 72 (I-72)

SCALE: SHEET 5 OF 13 SHEETS STA. TO STA.

F.A.I. RTE.	SECTION	COUNTY	TOTAL SHEETS	SHEET NO.
72	(84-10-2)RS-5	SANGAMON	28	14
CONTRACT NO. 72G92			ILLINOIS FED. AID PROJECT	

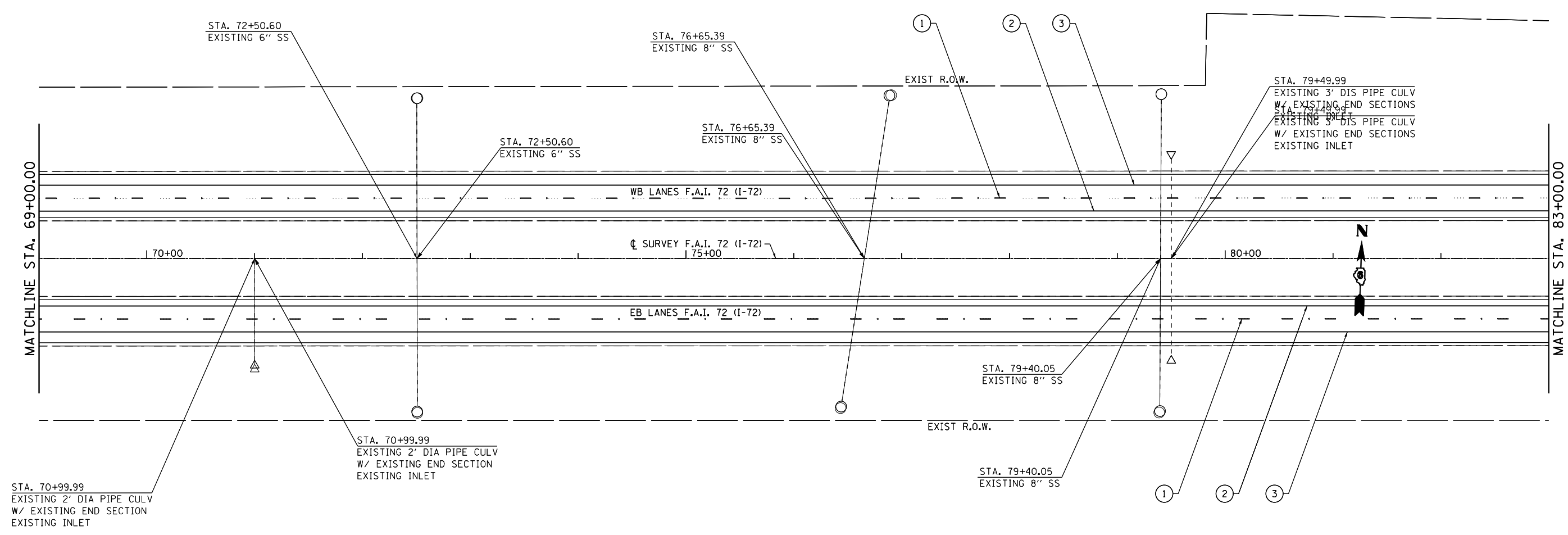
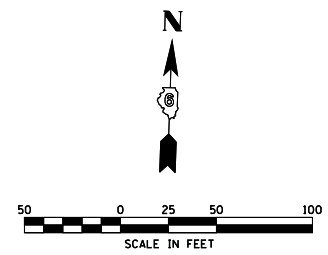

PAVEMENT MARKING LEGEND

- ① EPOXY PAVEMENT MARKING - LINE, 5" (30' SKIP, 10' DASH, WHITE)
- ② EPOXY PAVEMENT MARKING - LINE, 5" (SOLID YELLOW)
- ③ EPOXY PAVEMENT MARKING - LINE, 5" (SOLID WHITE)

FILE NAME =	USER NAME = sparksgw	DESIGNED -	REVISED -
et:\pw\work\p\dot\sparksgw\0360559\0672092-sht-plan-50-021.dgn		DRAWN -	REVISED -
Default	PLOT SCALE = 100.0000' / in.	CHECKED -	REVISED -
	PLOT DATE = Jan-13-2015 01:51:08PM	DATE -	REVISED -

**STATE OF ILLINOIS
DEPARTMENT OF TRANSPORTATION**

PLAN SHEET - F.A.I. 72 (I-72)

SCALE: SHEET 6 OF 13 SHEETS STA. TO STA.

F.A.I. RTE.	SECTION	COUNTY	TOTAL SHEETS	SHEET NO.
72	(84-10-2)RS-5	SANGAMON	28	15
CONTRACT NO. 72G92			ILLINOIS FED. AID PROJECT	

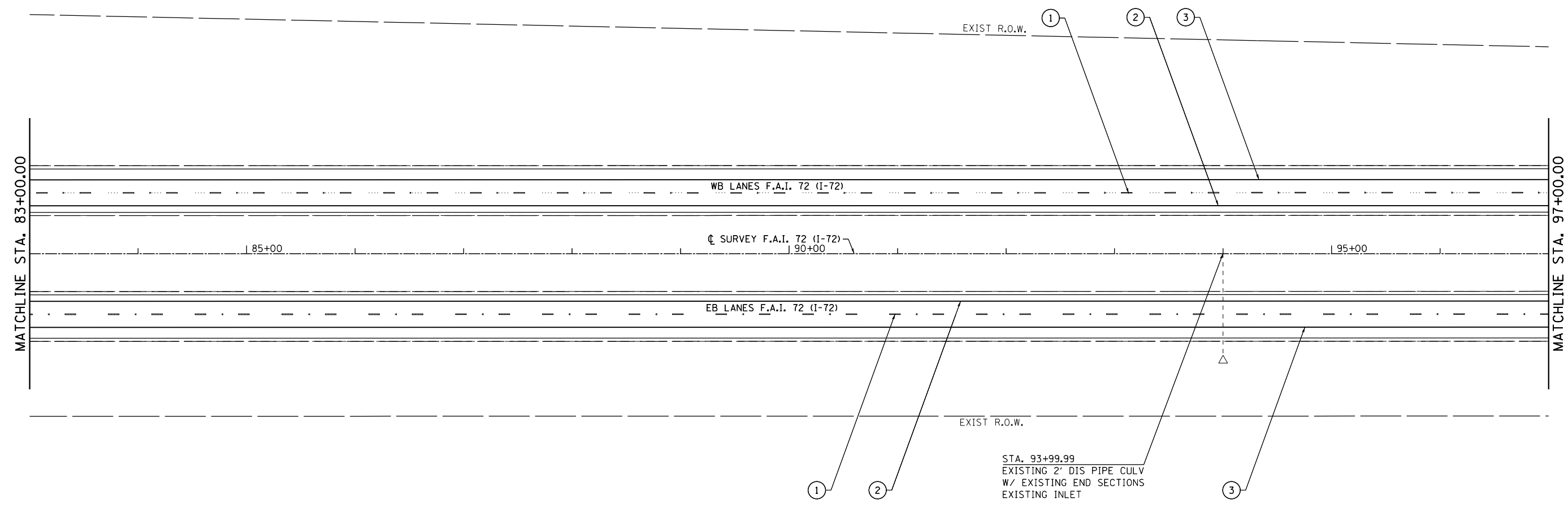
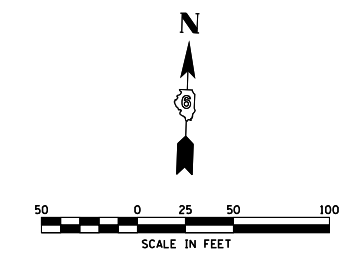

PAVEMENT MARKING LEGEND

- ① EPOXY PAVEMENT MARKING - LINE, 5" (30' SKIP, 10' DASH, WHITE)
- ② EPOXY PAVEMENT MARKING - LINE, 5" (SOLID YELLOW)
- ③ EPOXY PAVEMENT MARKING - LINE, 5" (SOLID WHITE)

FILE NAME =	USER NAME = sparksgw	DESIGNED -	REVISED -
c:\pwork\work\pwork\sparksgw\0360559\0672092-sht-plan-50-021.dgn		DRAWN -	REVISED -
Default	PLOT SCALE = 100.0000' / in.	CHECKED -	REVISED -
	PLOT DATE = Jan-13-2015 01:51:19PM	DATE -	REVISED -

**STATE OF ILLINOIS
DEPARTMENT OF TRANSPORTATION**

PLAN SHEET - F.A.I. 72 (I-72)

SCALE: SHEET 7 OF 13 SHEETS STA. TO STA.

F.A.I. RTE.	SECTION	COUNTY	TOTAL SHEETS	SHEET NO.
72	(84-10-2)RS-5	SANGAMON	28	16
ILLINOIS FED. AID PROJECT			CONTRACT NO. 72G92	

EXIST. CURVE 8038
 PI STA. = 118+90.37
 $\Delta = 6^\circ 21' 12''$ (LT)
 D = $0^\circ 15' 04''$
 R = 22,806.28'
 T = 1,265.75'
 L = 2,528.91'
 E = 35.10'
 e = NORMAL CROWN
 T.R. = -----
 S.E. RUN = -----
 P.C. STA. = 106+24.62
 P.T. STA. = 131+53.52

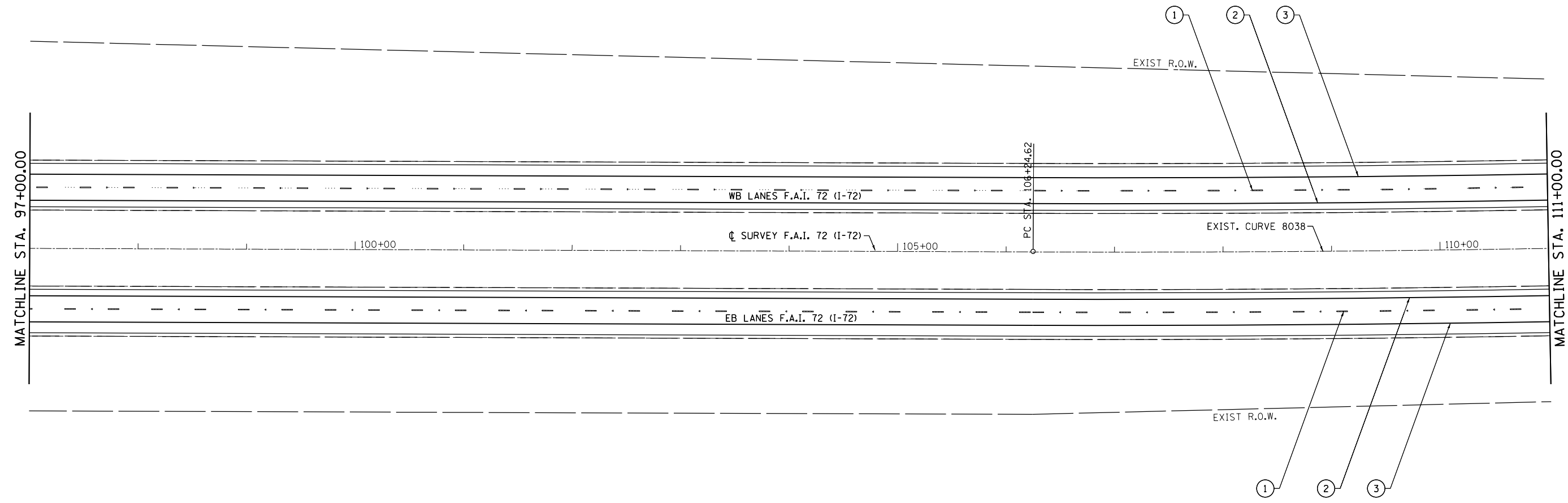
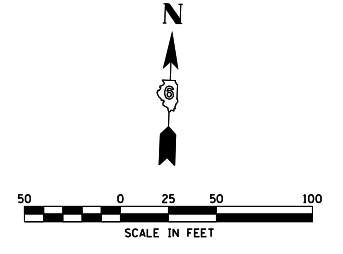

PAVEMENT MARKING LEGEND

- ① EPOXY PAVEMENT MARKING - LINE, 5" (30' SKIP, 10' DASH, WHITE)
- ② EPOXY PAVEMENT MARKING - LINE, 5" (SOLID YELLOW)
- ③ EPOXY PAVEMENT MARKING - LINE, 5" (SOLID WHITE)

FILE NAME =	USER NAME = sparksgw	DESIGNED -	REVISED -
c:\pwork\pwork\sparksgw\0360559\0672092-sht-plan-50-021.dgn		DRAWN -	REVISED -
Default	PLOT SCALE = 100.0000' / in.	CHECKED -	REVISED -
	PLOT DATE = Jan-13-2015 01:51:20PM	DATE -	REVISED -

**STATE OF ILLINOIS
 DEPARTMENT OF TRANSPORTATION**

PLAN SHEET - F.A.I. 72 (I-72)

SCALE: SHEET 8 OF 13 SHEETS STA. TO STA.

F.A.I. RTE.	SECTION	COUNTY	TOTAL SHEETS	SHEET NO.
72	(84-10-2)RS-5	SANGAMON	28	17
CONTRACT NO. 72G92			ILLINOIS FED. AID PROJECT	

EXIST. CURVE 8038
 P.I. STA. = 118+90.37
 $\Delta = 6^\circ 21' 12''$ (LT)
 $D = 0^\circ 15' 04''$
 $R = 22,806.28'$
 $T = 1,265.75'$
 $L = 2,528.91'$
 $E = 35.10'$
 $e = \text{NORMAL CROWN}$
 $T.R. = \text{-----}$
 $S.E. \text{ RUN} = \text{-----}$
 $P.C. \text{ STA.} = 106+24.62$
 $P.T. \text{ STA.} = 131+53.52$

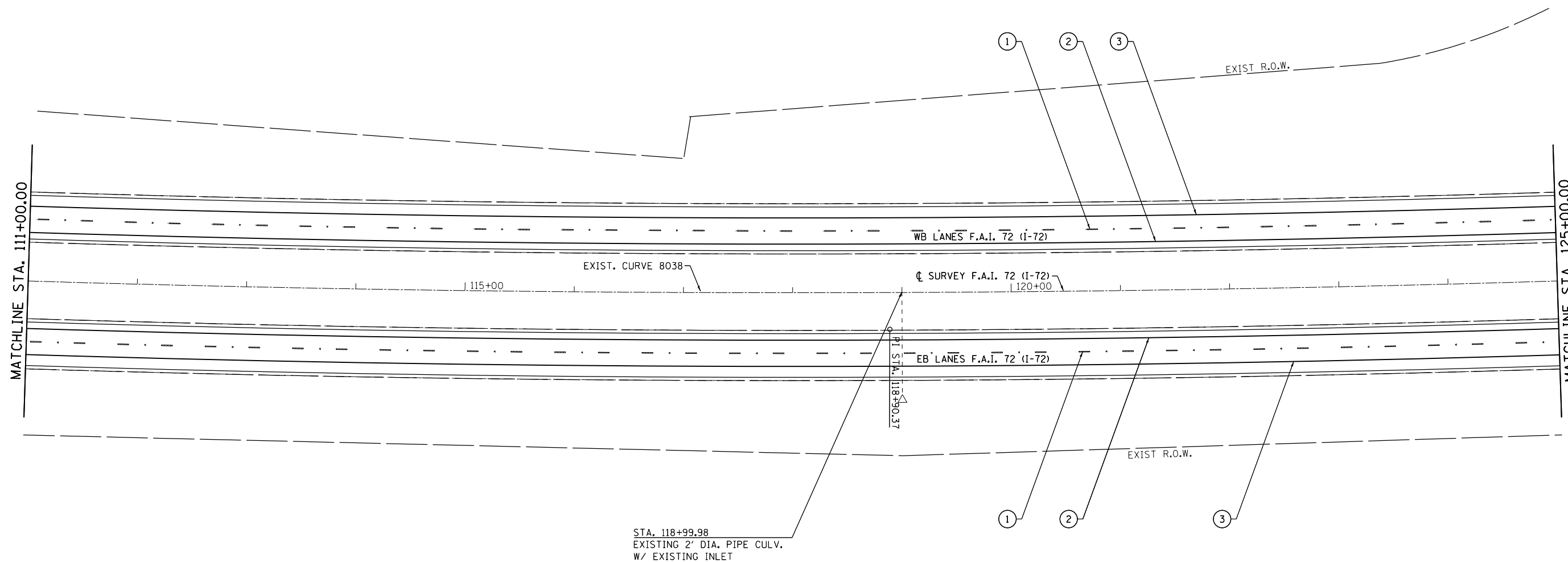
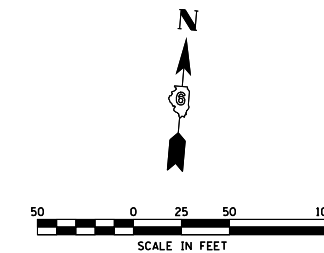

PAVEMENT MARKING LEGEND

- ① EPOXY PAVEMENT MARKING - LINE, 5" (30' SKIP, 10' DASH, WHITE)
- ② EPOXY PAVEMENT MARKING - LINE, 5" (SOLID YELLOW)
- ③ EPOXY PAVEMENT MARKING - LINE, 5" (SOLID WHITE)

FILE NAME =	USER NAME = sparksgw	DESIGNED -	REVISED -
c:\pwork\work\pwork\sparksgw\0360559\0672092-sht-plan-50-021.dgn		DRAWN -	REVISED -
Default	PLOT SCALE = 100.0000' / in.	CHECKED -	REVISED -
	PLOT DATE = Jan-13-2015 01:51:21PM	DATE -	REVISED -

STATE OF ILLINOIS
DEPARTMENT OF TRANSPORTATION

PLAN SHEET - F.A.I. 72 (I-72)

SCALE: SHEET 9 OF 13 SHEETS STA. TO STA.

F.A.I. RTE.	SECTION	COUNTY	TOTAL SHEETS	SHEET NO.
72	(84-10-2)RS-5	SANGAMON	28	18
			CONTRACT NO. 72G92	
ILLINOIS FED. AID PROJECT				

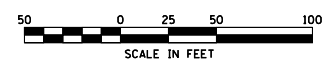

EXIST. CURVE 8038
 PI STA. = 118+90.37
 Δ = 6° 21' 12" (LT)
 D = 0° 15' 04"
 R = 22,806.28'
 T = 1,265.75'
 L = 2,528.91'
 E = 35.10'
 e = NORMAL CROWN
 T.R. = -----
 S.E. RUN = -----
 P.C. STA. = 106+24.62
 P.T. STA. = 131+53.52

STA. 130+00.00
 EXISTING 2' DIA. PIPE CULV.
 W/ EXISTING END SECTIONS
 EXISTING INLET

STA. 139+24.00
 EXISTING 12" SS

WB LANES F.A.I. 72 (I-72)

EB LANES F.A.I. 72 (I-72)

STA. 1650+00.00 CH 16 (DAWSON RD.) =
 STA. 134+13.03 I-72 (SN 084-0155)

EXIST. CURVE 8037
 PI STA. = 146+16.62
 Δ = 12° 34' 23" (RT)
 D = 0° 30' 04"
 R = 11,432.95'
 T = 1,259.48'
 L = 2,508.84'
 E = 69.16'
 e = 1.5 %
 T.R. = 67.50'
 S.E. RUN = 90.00'
 P.C. STA. = 133+57.14
 P.T. STA. = 158+65.98

PAVEMENT MARKING LEGEND

- ① EPOXY PAVEMENT MARKING - LINE, 5" (30' SKIP, 10' DASH, WHITE)
- ② EPOXY PAVEMENT MARKING - LINE, 5" (SOLID YELLOW)
- ③ EPOXY PAVEMENT MARKING - LINE, 5" (SOLID WHITE)

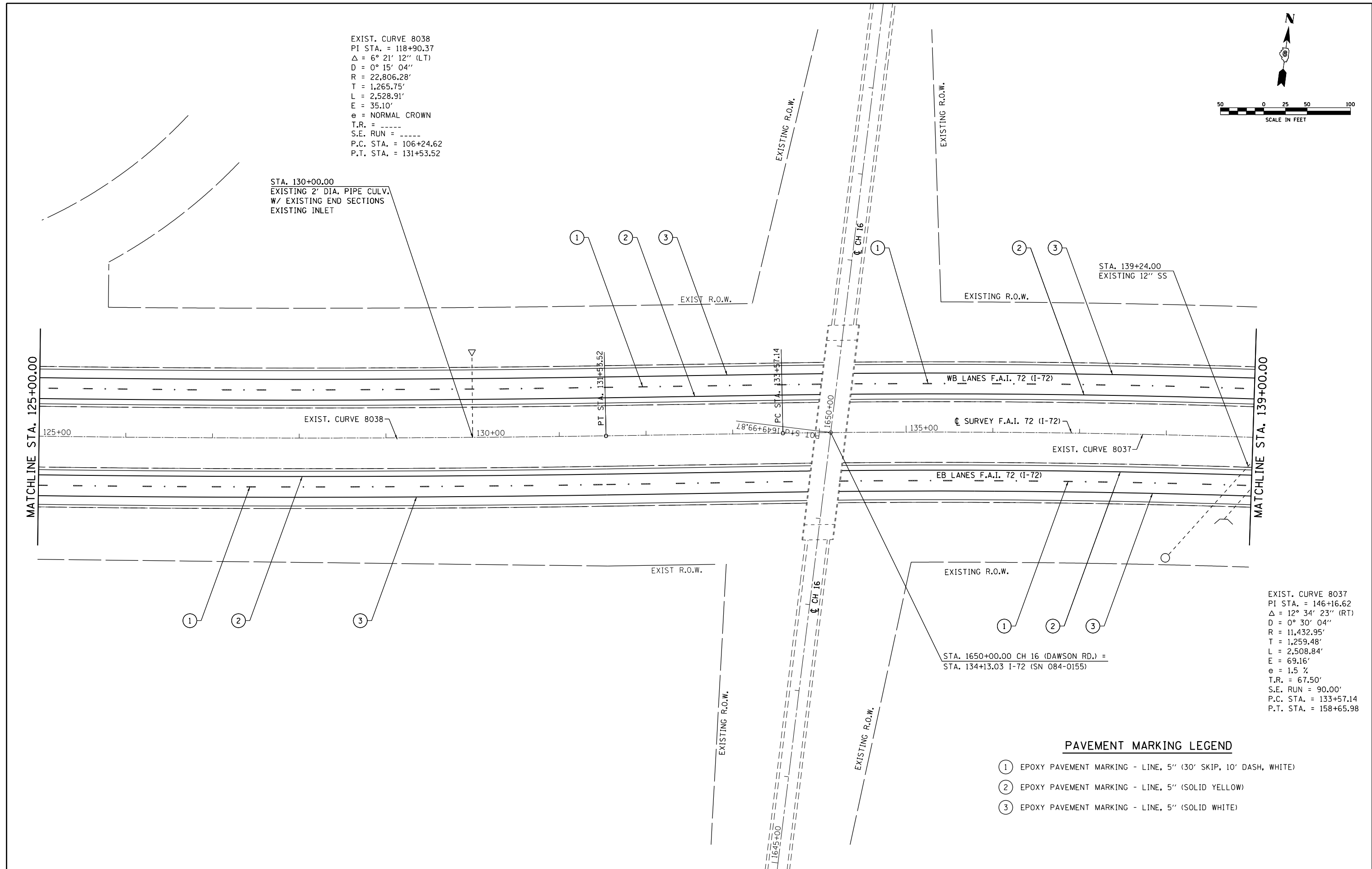

FILE NAME =	USER NAME = sparksgw	DESIGNED -	REVISED -
c:\pwwork\pwwork\sparksgw\0360559\0672092-sht-plan-50-021.dgn		DRAWN -	REVISED -
Default	PLOT SCALE = 100.0000' / in.	CHECKED -	REVISED -
	PLOT DATE = Jan-13-2015 01:51:21PM	DATE -	REVISED -

**STATE OF ILLINOIS
 DEPARTMENT OF TRANSPORTATION**

PLAN SHEET - F.A.I. 72 (I-72)

SCALE: SHEET 10 OF 13 SHEETS STA. TO STA.

F.A.I. RTE.	SECTION	COUNTY	TOTAL SHEETS	SHEET NO.
72	(84-10-2)RS-5	SANGAMON	28	19
CONTRACT NO. 72G92				
ILLINOIS FED. AID PROJECT				

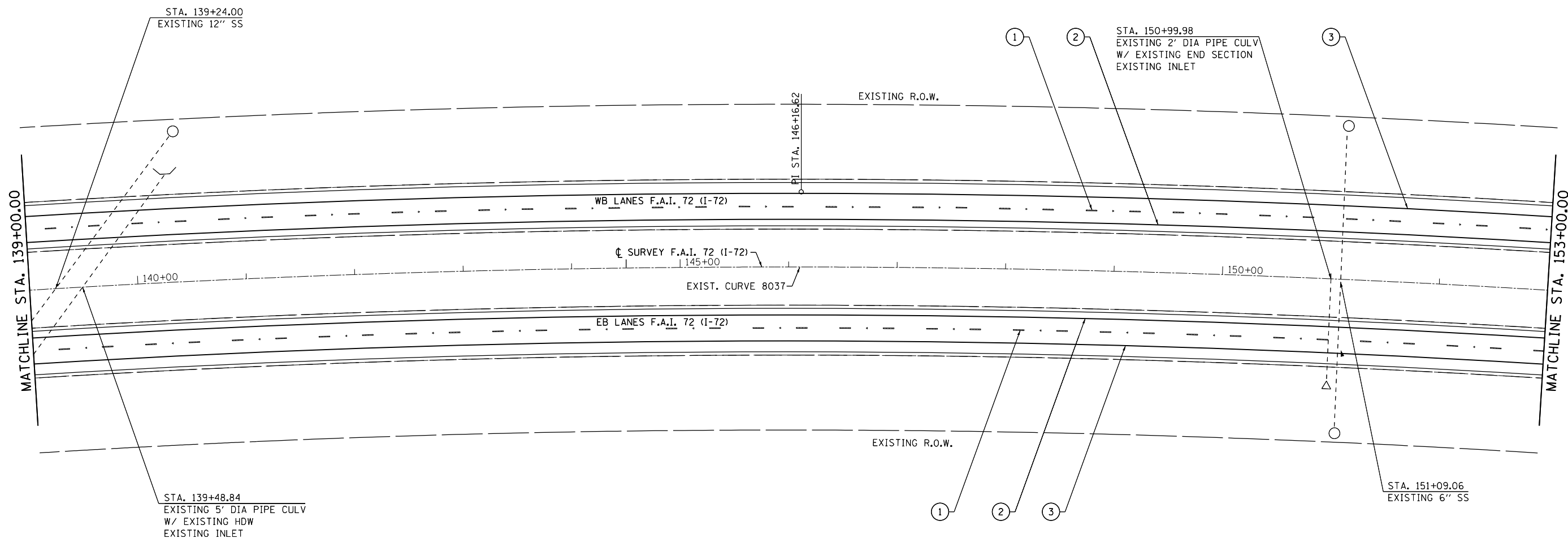
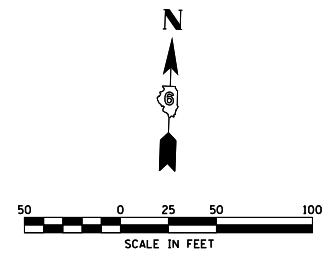

EXIST. CURVE 8037
 PI STA. = 146+16.62
 $\Delta = 12^\circ 34' 23''$ (RT)
 $D = 0^\circ 30' 04''$
 $R = 11,432.95'$
 $T = 1,259.48'$
 $L = 2,508.84'$
 $E = 69.16'$
 $e = 1.5\%$
 $T.R. = 67.50'$
 $S.E. RUN = 90.00'$
 $P.C. STA. = 133+57.14$
 $P.T. STA. = 158+65.98$

PAVEMENT MARKING LEGEND

- ① EPOXY PAVEMENT MARKING - LINE, 5" (30' SKIP, 10' DASH, WHITE)
- ② EPOXY PAVEMENT MARKING - LINE, 5" (SOLID YELLOW)
- ③ EPOXY PAVEMENT MARKING - LINE, 5" (SOLID WHITE)

FILE NAME =	USER NAME = sparksgw	DESIGNED -	REVISED -
et:\pwork\pwork\sparksgw\0360559\0672092-sht-plan-50-021.dgn		DRAWN -	REVISED -
Default	PLOT SCALE = 100.0000' / in.	CHECKED -	REVISED -
	PLOT DATE = Jan-13-2015 01:51:22PM	DATE -	REVISED -

**STATE OF ILLINOIS
 DEPARTMENT OF TRANSPORTATION**

PLAN SHEET - F.A.I. 72 (I-72)

SCALE: SHEET 11 OF 13 SHEETS STA. TO STA.

F.A.I. RTE.	SECTION	COUNTY	TOTAL SHEETS	SHEET NO.
72	(84-10-2)RS-5	SANGAMON	28	20
ILLINOIS FED. AID PROJECT			CONTRACT NO. 72G92	

EXIST. CURVE 8036
 PI STA. = 170+58.76
 Δ = 4° 22' 13" (LT)
 D = 0° 15' 01"
 R = 22,887.92'
 T = 873.31'
 L = 1,745.77'
 E = 16.65'
 e = NORMAL CROWN
 T.R. = -----
 S.E. RUN = -----
 P.C. STA. = 161+85.45
 P.T. STA. = 179+31.23

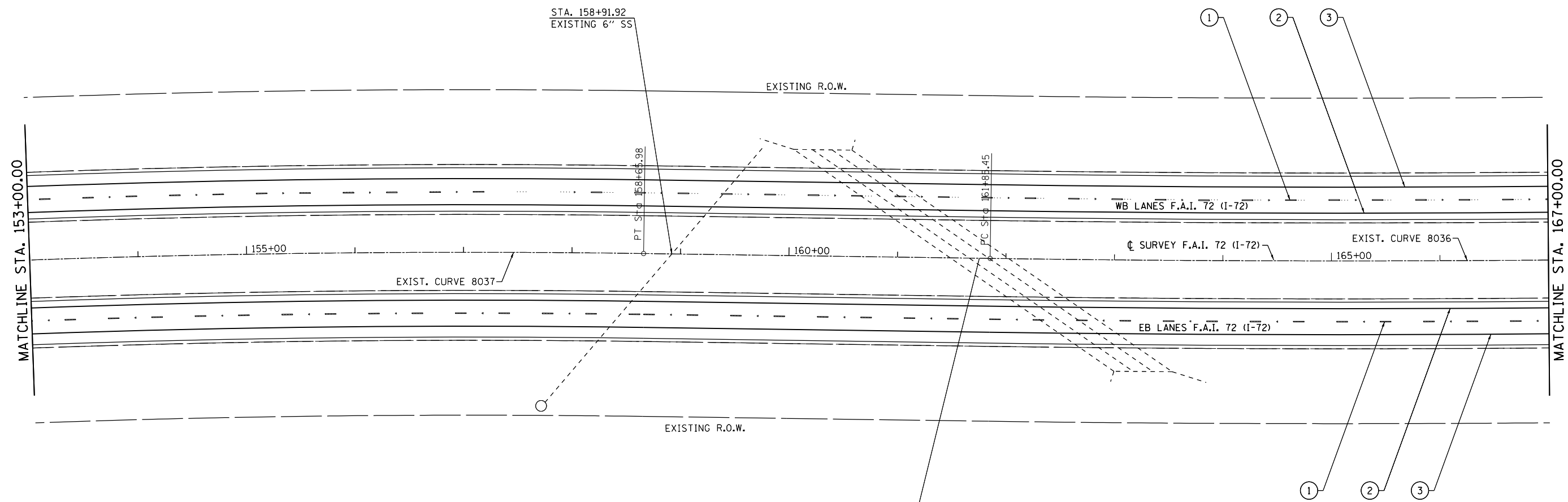
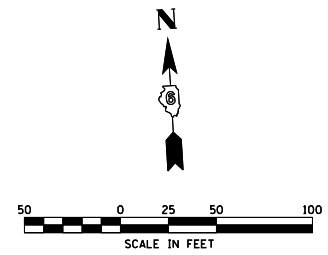

EXIST. CURVE 8037
 PI STA. = 146+16.62
 Δ = 12° 34' 23" (RT)
 D = 0° 30' 04"
 R = 11,432.95'
 T = 1,259.48'
 L = 2,508.84'
 E = 69.16'
 e = 1.5%
 T.R. = 67.50'
 S.E. RUN = 90.00'
 P.C. STA. = 133+57.14
 P.T. STA. = 158+65.98

STA. 161+75.39
 EXISTING TRIPLE 9' X 9' BOX CULV SKEW 56°
 W/ EXISTING INLET (2)
 SN 084-2010

PAVEMENT MARKING LEGEND

- ① EPOXY PAVEMENT MARKING - LINE, 5" (30' SKIP, 10' DASH, WHITE)
- ② EPOXY PAVEMENT MARKING - LINE, 5" (SOLID YELLOW)
- ③ EPOXY PAVEMENT MARKING - LINE, 5" (SOLID WHITE)

FILE NAME =	USER NAME = sparksgw	DESIGNED -	REVISED -
Default	2092-sht-plan-50-021.dgn	DRAWN -	REVISED -
	PLOT SCALE = 100.0000' / in.	CHECKED -	REVISED -
	PLOT DATE = Jan-13-2015 01:51:23PM	DATE -	REVISED -

**STATE OF ILLINOIS
 DEPARTMENT OF TRANSPORTATION**

PLAN SHEET - F.A.I. 72 (I-72)

SCALE: SHEET 12 OF 13 SHEETS STA. TO STA.

F.A.I. RTE.	SECTION	COUNTY	TOTAL SHEETS	SHEET NO.
72	(84-10-2)RS-5	SANGAMON	28	21
ILLINOIS FED. AID PROJECT			CONTRACT NO. 72G92	

EXIST. CURVE 8036
 PI STA. = 170+58.76
 $\Delta = 4^\circ 22' 13''$ (LT)
 $D = 0^\circ 15' 01''$
 $R = 22,887.92'$
 $T = 873.31'$
 $L = 1,745.77'$
 $E = 16.65'$
 $e = \text{NORMAL CROWN}$
 $T.R. = \text{-----}$
 $S.E. \text{ RUN} = \text{-----}$
 $P.C. \text{ STA.} = 161+85.45$
 $P.T. \text{ STA.} = 179+31.23$

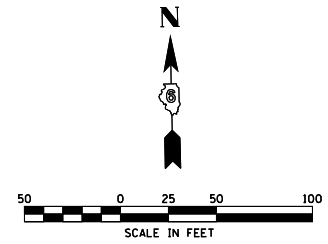

STA. 171+09.00 END
 SECTION (84-10-1RS-3, 84-102RS-4) IMPROVEMENTS

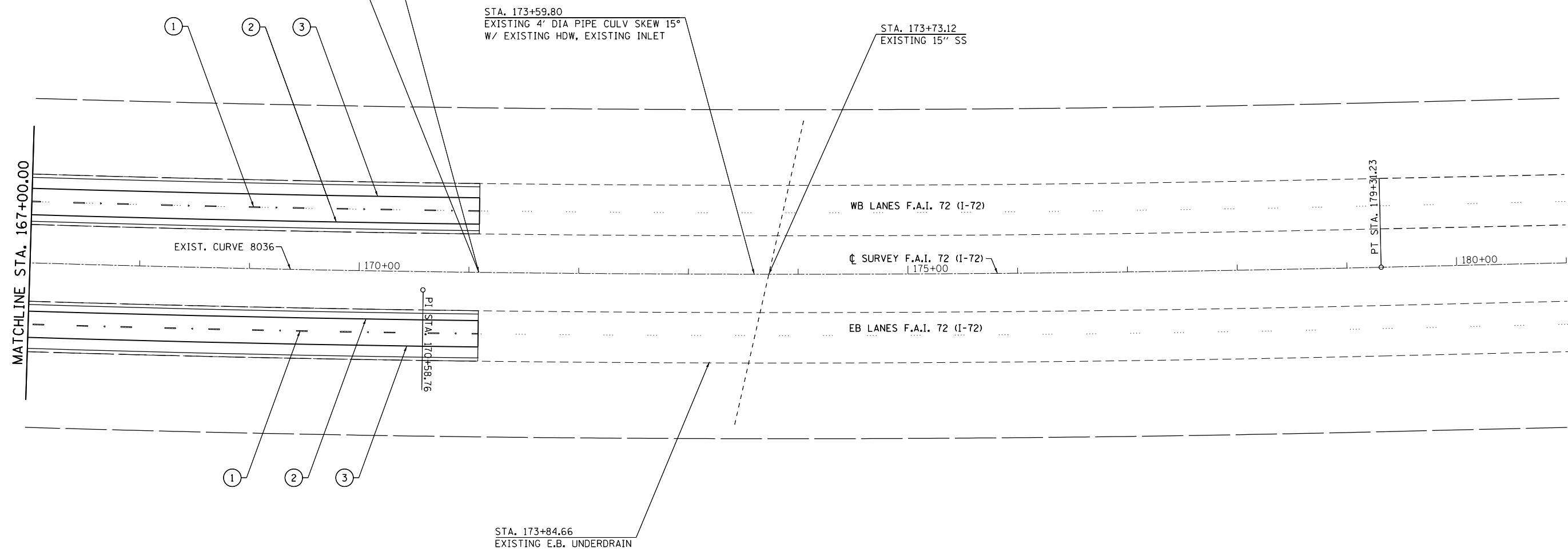

PAVEMENT MARKING LEGEND

- ① EPOXY PAVEMENT MARKING - LINE, 5" (30' SKIP, 10' DASH, WHITE)
- ② EPOXY PAVEMENT MARKING - LINE, 5" (SOLID YELLOW)
- ③ EPOXY PAVEMENT MARKING - LINE, 5" (SOLID WHITE)

FILE NAME =	USER NAME = sparksgw	DESIGNED -	REVISED -
Default	2092-sht-plan-50-021.dgn	DRAWN -	REVISED -
	PLOT SCALE = 100.0000' / 1in.	CHECKED -	REVISED -
	PLOT DATE = Jan-13-2015 01:51:24PM	DATE -	REVISED -

**STATE OF ILLINOIS
 DEPARTMENT OF TRANSPORTATION**

PLAN SHEET - F.A.I. 72 (I-72)

SCALE: SHEET 13 OF 13 SHEETS STA. TO STA.

F.A.I. RTE.	SECTION	COUNTY	TOTAL SHEETS	SHEET NO.
72	(84-10-2)RS-5	SANGAMON	28	22
CONTRACT NO. 72G92				
ILLINOIS FED. AID PROJECT				

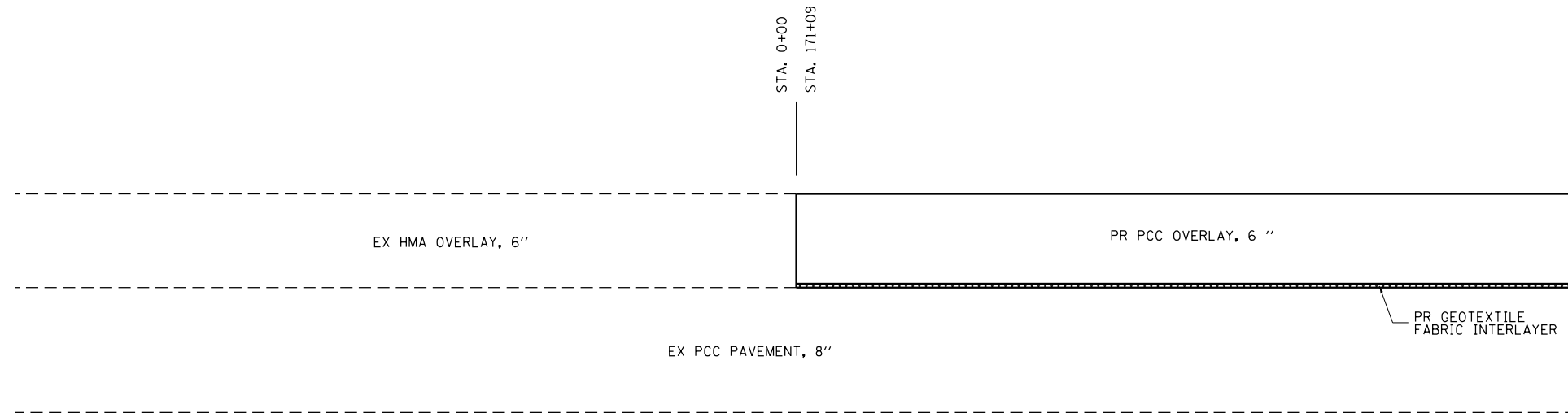

WB TRANSITION.

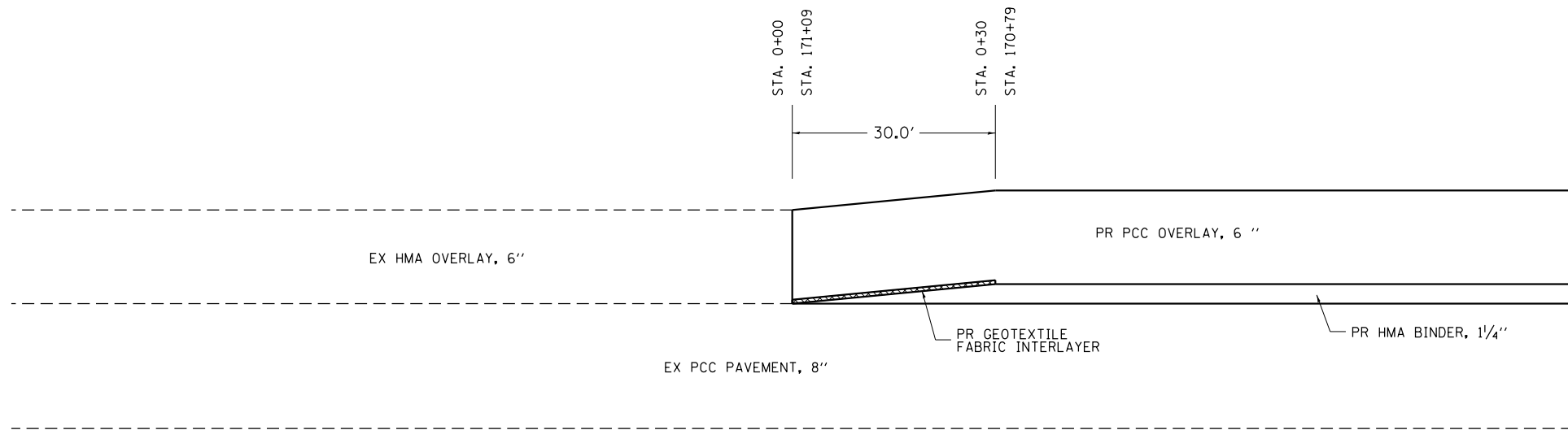

EB TRANSITION.

FILE NAME =	USER NAME = sparksgw	DESIGNED -	REVISED -
c:\pwork\pwork\sparksgw\0360559\0672092-sht-details.dgn		DRAWN -	REVISED -
Default	PLOT SCALE = 100.0000' / in.	CHECKED -	REVISED -
	PLOT DATE = Jan-13-2015 01:51:38PM	DATE -	REVISED -

**STATE OF ILLINOIS
DEPARTMENT OF TRANSPORTATION**

BUTT JOINT DETAIL

SCALE: SHEET OF SHEETS STA. TO STA.

F.A.I. RTE.	SECTION	COUNTY	TOTAL SHEETS	SHEET NO.
72	(84-10-2) RS-5	SANGAMON	28	23
CONTRACT NO. 72G92			ILLINOIS FED. AID PROJECT	

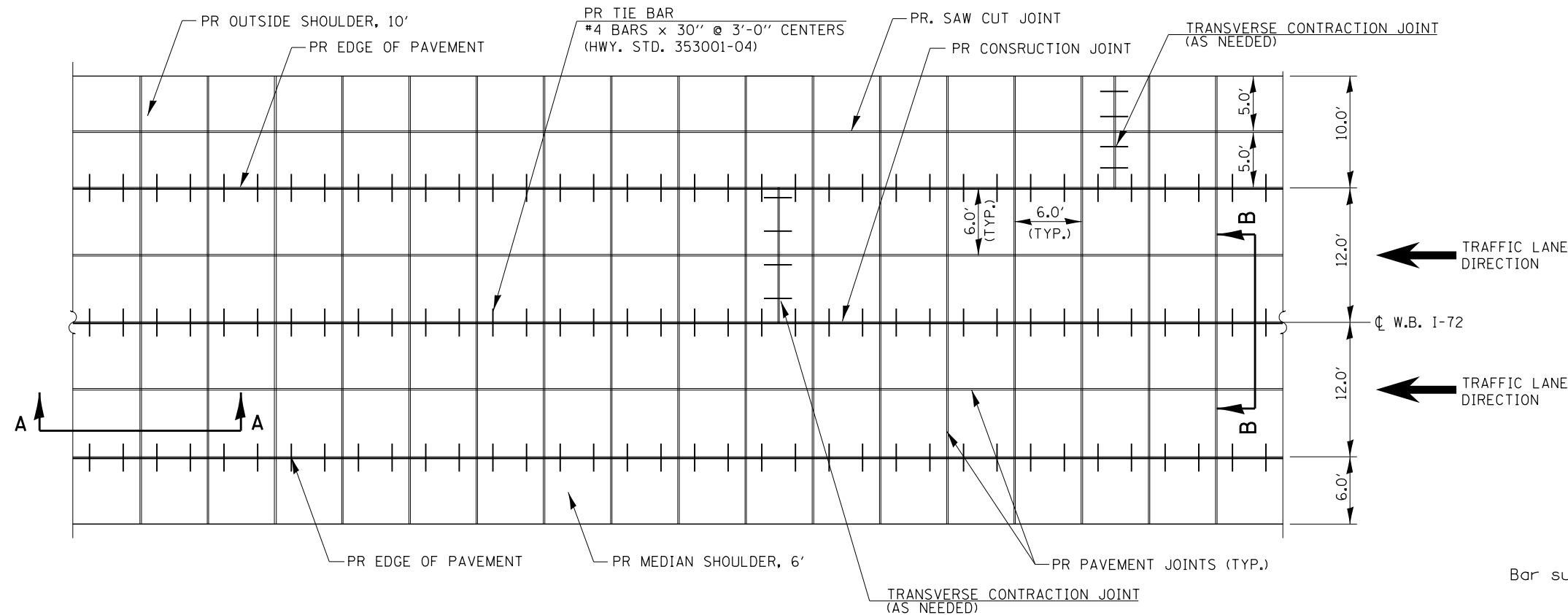

PLAN VIEW
WESTBOUND I-72
STA. 0+00.00 TO STA. 171+09.00

- NOTE:**
1. ALL PAVEMENT SAWCUTS, LABOR, EQUIPMENT, AND MATERIALS NECESSARY FOR THE CONSTRUCTION OF 'PORTLAND CEMENT CONCRETE OVERLAY, 6"' SHALL BE INCLUDED IN THE CONTRACT UNIT PRICE PER SQUARE YARD FOR SAID PAY ITEM HEREIN.
 2. TIE BARS ARE REQUIRED AT CONSTRUCTION JOINTS.
 3. TIE BARS AT SHOULDERS ARE NOT REQUIRED IF PAVEMENT IS POURED MONOLITHICALLY.

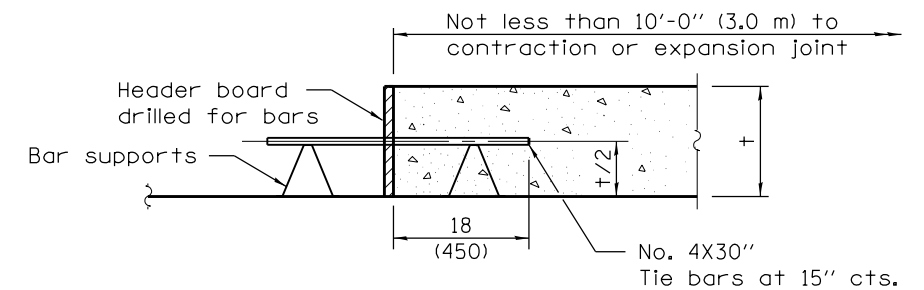

TRANSVERSE CONSTRUCTION JOINT

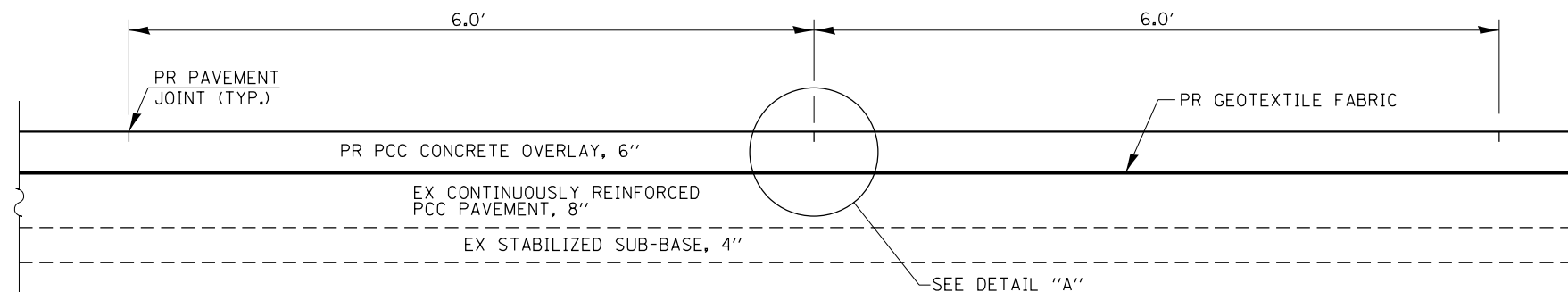

SECTION A-A

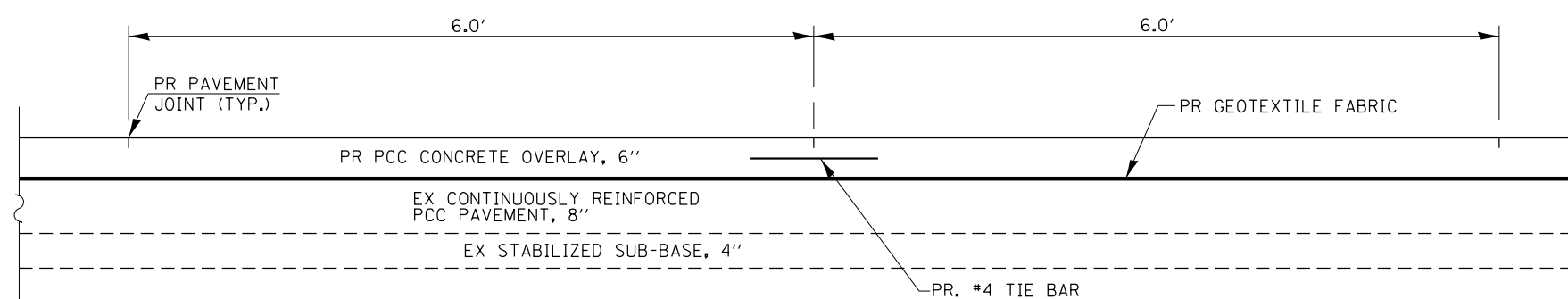

SECTION B-B

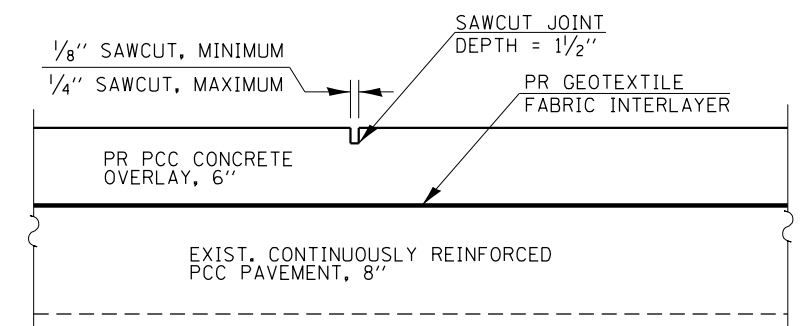

DETAIL "A"

FILE NAME =	USER NAME = sparksgw	DESIGNED - VTY	REVISED -	STATE OF ILLINOIS DEPARTMENT OF TRANSPORTATION	PAVEMENT CONSTRUCTION DETAILS (WESTBOUND LANES)				F.A.I. R.T.E.	SECTION	COUNTY	TOTAL SHEETS	SHEET NO.
Default	2092-sht-details.dgn	DRAWN - RTS	REVISED -						72	(84-10-2) RS-5	SANGAMON	28	24
	PLOT SCALE = 100.0000' / 1in.	CHECKED - VTY	REVISED -		CONTRACT NO. 72G92				ILLINOIS FED. AID PROJECT				
	PLOT DATE = Jan-13-2015 01:51:38PM	DATE - 10-17-14	REVISED -		SCALE:	SHEET	OF	SHEETS	STA.	TO	STA.		

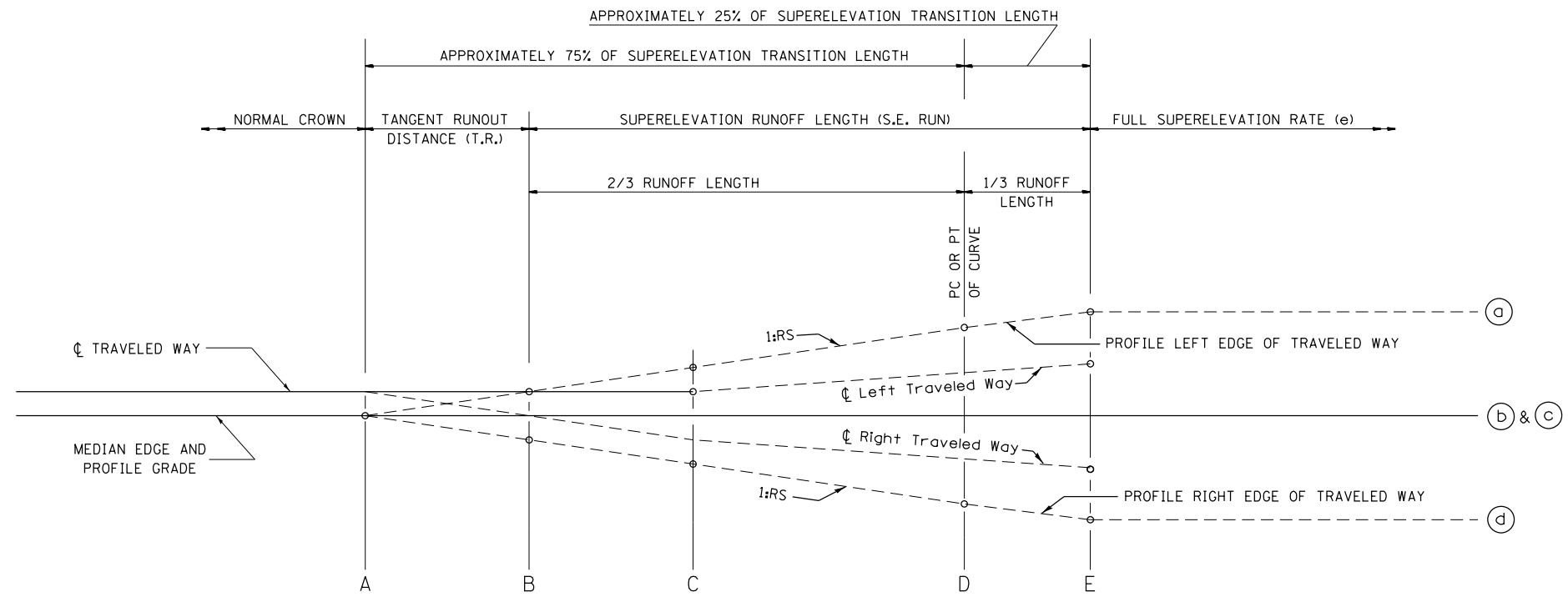

TYPICAL PROFILE - S.E. TRANSITION

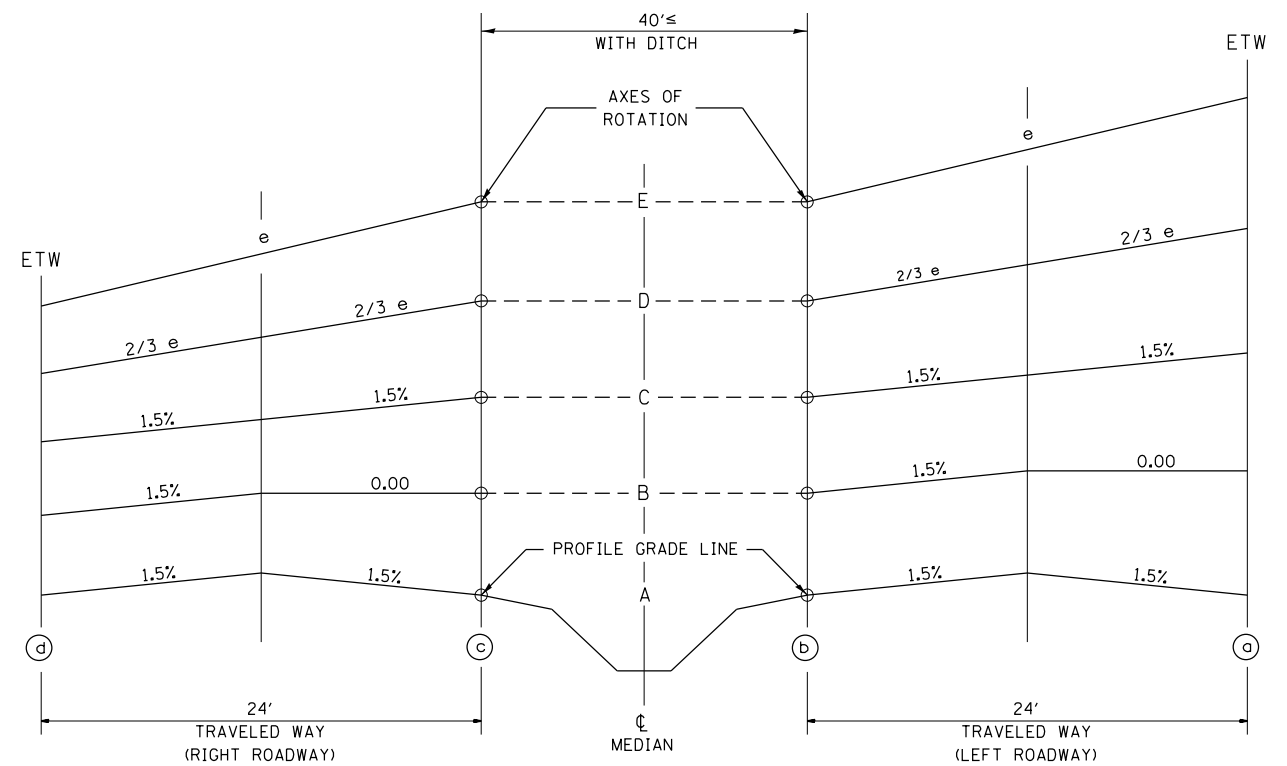
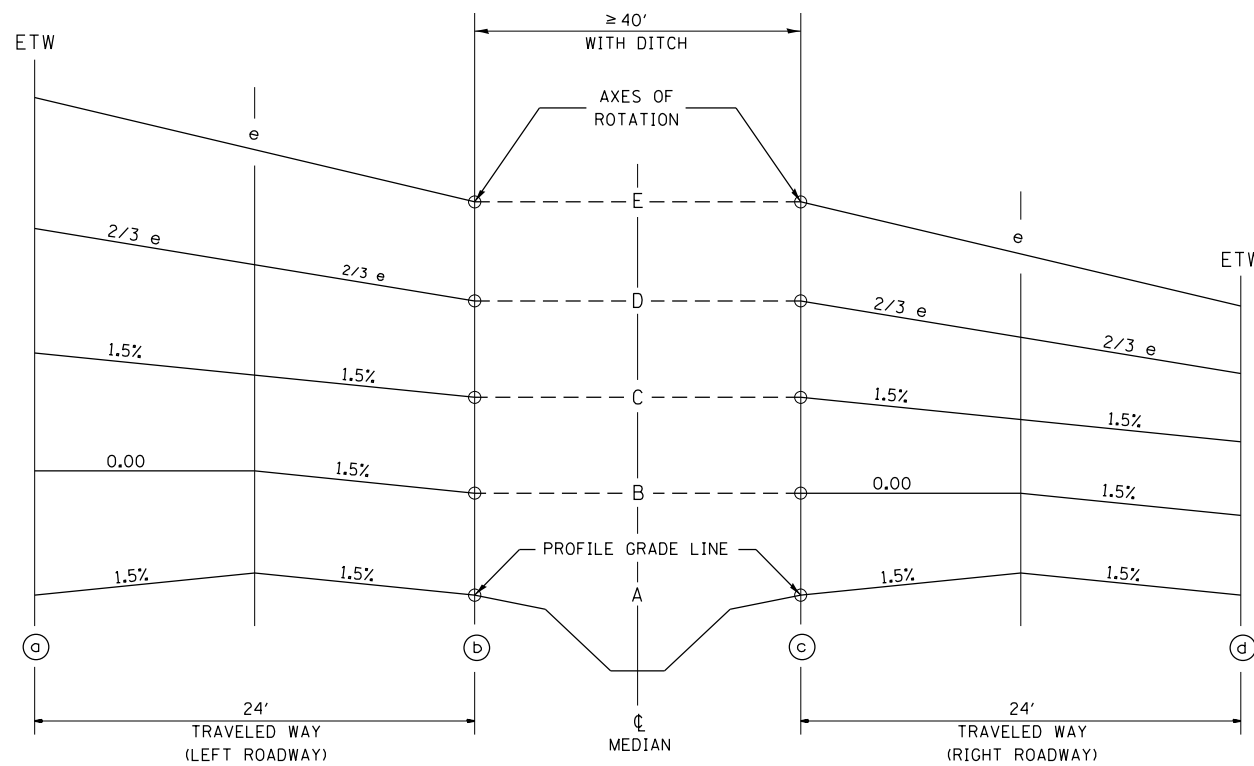

FILE NAME =	USER NAME = sparksgw	DESIGNED - VTY	REVISED -
ct:\pw\work\p\dot\sparksgw\10360559\0672092-sht-details.dgn		DRAWN - RTS	REVISED -
Default	PLOT SCALE = 100.0000' / 1in.	CHECKED - VTY	REVISED -
	PLOT DATE = Jan-13-2015 01:51:38PM	DATE - 11-20-14	REVISED -

STATE OF ILLINOIS
DEPARTMENT OF TRANSPORTATION

SUPERELEVATION TRANSITION
DETAIL, 4 LANE DIVIDED HIGHWAY

SCALE: SHEET 1 OF 2 SHEETS STA. TO STA.

F.A.I. RTE.	SECTION	COUNTY	TOTAL SHEETS	SHEET NO.
72	(84-10-2) RS-5	SANGAMON	28	26
CONTRACT NO. 72G92				
ILLINOIS FED. AID PROJECT				

I-72

EXIST. CURVE 8037
 PI STA. = 146+16.62
 Δ = 12° 34' 23" (RT)
 D = 0° 30' 04"
 R = 11,432.95'
 T = 1,259.48'
 L = 2,508.84'
 E = 69.16'
 e = 1.5%
 T.R. = 67.50'
 S.E. RUN = 90.00'
 P.C. STA. = 133+57.14
 P.T. STA. = 158+65.98

TABLE OF SUPERELEVATION BREAK POINT LOCATIONS

CURVE NO.	e	A	B	C	D	E	TRANSITION
8037	1.67%	132+29.34	132+96.84	133+64.34	133+57.14	133+86.84	TRANS. IN
		159+93.78	159+26.28	158+58.78	158+65.98	158+36.28	TRANS. OUT

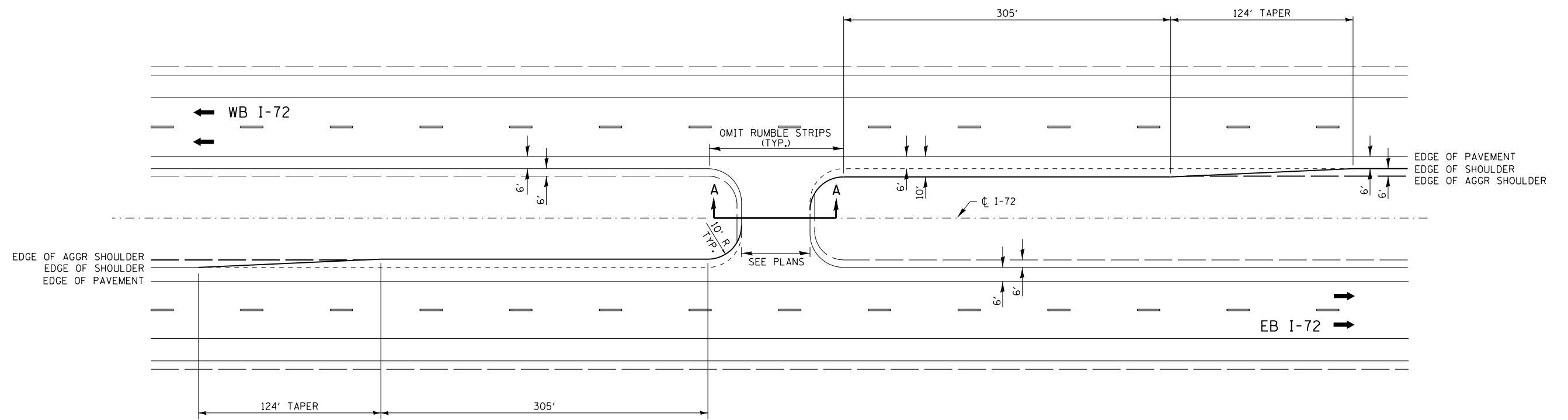

PLAN VIEW
STA. 2+16.06

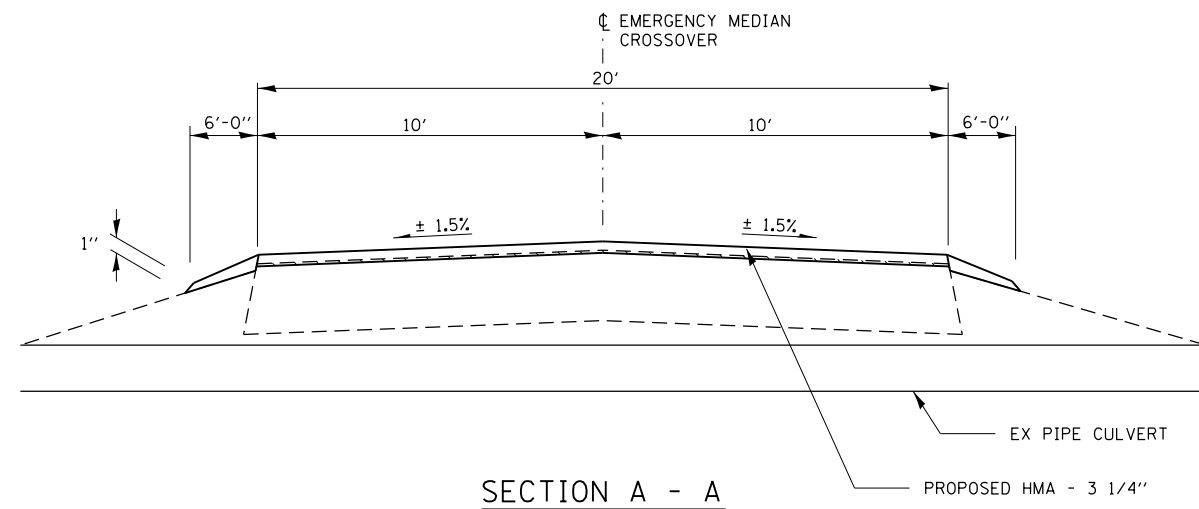

SECTION A - A

FILE NAME =	USER NAME = sparksgw	DESIGNED - VTY	REVISED -
c:\pwork\work\pwork\sparksgw\0360559\0672092-sht-details.dgn		DRAWN - RTS	REVISED -
Default	PLOT SCALE = 100.0000' / 1in.	CHECKED - VTY	REVISED -
	PLOT DATE = Jan-13-2015 01:51:39PM	DATE - 11-20-14	REVISED -

STATE OF ILLINOIS
DEPARTMENT OF TRANSPORTATION

EMERGENCY MEDIAN CROSSOVER DETAIL

SCALE: SHEET 1 OF 1 SHEETS STA. TO STA.

F.A.I. RTE.	SECTION	COUNTY	TOTAL SHEETS	SHEET NO.
72	(84-10-2) RS-5	SANGAMON	28	28
CONTRACT NO. 72G92				
ILLINOIS FED. AID PROJECT				