

ROUTE	SECTION	CITY	TOTAL SHEETS	SHEET NO.
SAFE ROUTES TO SCHOOL	12-00081-00-SW	OLNEY	21	1
CONTRACT NO. 95733		ILLINOIS	PROJECT SRTS-4009(281)	

STATE OF ILLINOIS
DEPARTMENT OF TRANSPORTATION
DIVISION OF HIGHWAYS
**PLANS FOR PROPOSED
SAFE ROUTES TO SCHOOL PROJECT**
SECTION 12-00081-00-SW CITY OF OLNEY
PROJECT SRTS-4009(281)
JOB NO. C-97-030-14

INDEX OF SHEETS

SHEET	ITEM
1	COVER SHEET
2	SUMMARY OF QUANTITIES
3	MISCELLANEOUS DETAILS
4-12	SIDEWALK PLAN
13	ENTRANCE DETAIL - E.R.M.S. ENTRANCES
14	INTERSECTION DETAIL 1 - VAN ST. AND JONATHAN DR.
15	INTERSECTION DETAIL 2 - VAN ST. AND JONATHAN DR.
16	INTERSECTION DETAIL - VAN AND HALL ST.
17	INTERSECTION DETAIL - HALL ST. AND IMPERIAL DR.
18	INTERSECTION DETAIL - HALL ST. BRADLEY DR.
19	INTERSECTION DETAIL - HALL ST. AND E.R.E.S. NORTH ENTRANCE
20	SIDEWALK DETAIL - HALL ST. TO E.R.E.S. SOUTH ENTRANCE
21	ENTRANCE DETAIL - E.R.E.S. EAST ENTRANCE

STANDARD DRAWINGS

- STANDARD 000001-06
- STANDARD 424001-08
- STANDARD 424016-02
- STANDARD 424026-01
- STANDARD 604086-03
- STANDARD 606001-06
- STANDARD 701001-02
- STANDARD 701006-05
- STANDARD 701201-04
- STANDARD 701301-04
- STANDARD 701501-06
- STANDARD 701801-05
- STANDARD 701901-04
- STANDARD 720006-04
- STANDARD BLR 10-6
- STANDARD BLR 14-11

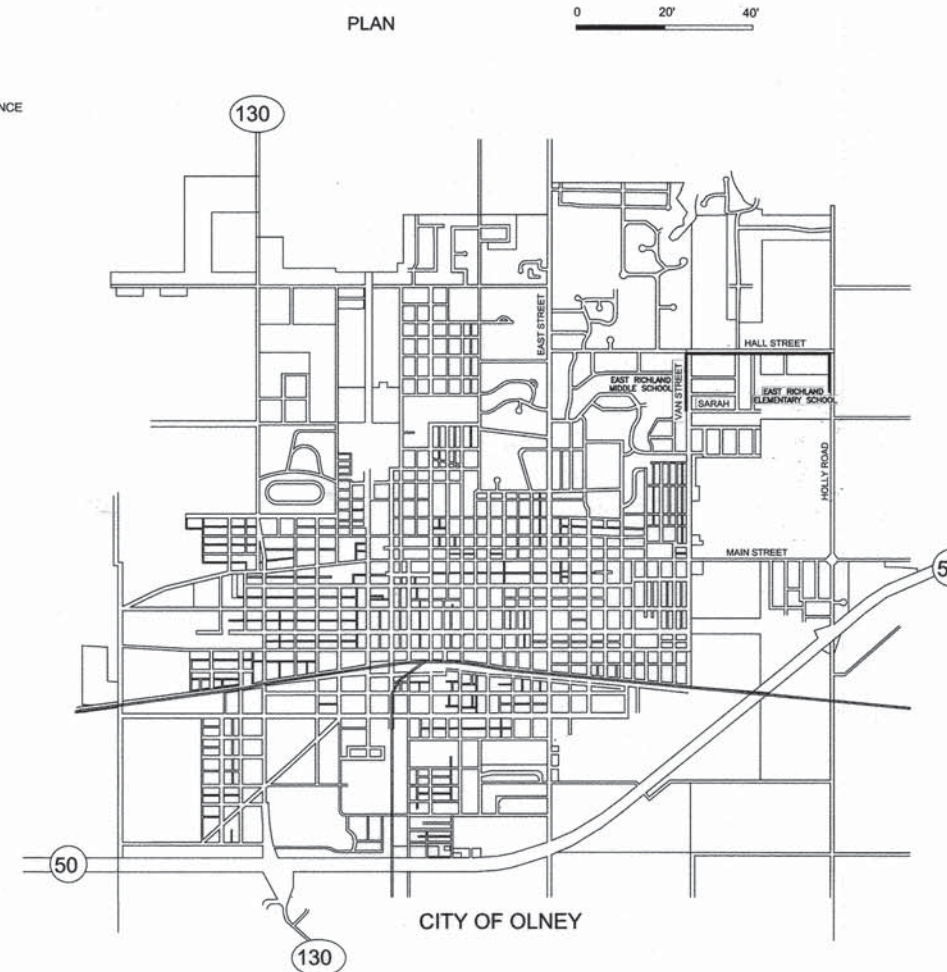

VAN STREET - STA. 34+09.77 TO 46+80.59 = 1270.82 Ft.
HALL STREET - STA. 46+80.59 TO 72+84.78 = 2604.19 Ft.
HOLLY ROAD - STA. 72+84.78 TO 82+07.00 = 922.22 Ft.
NET LENGTH SECTION 12-00081-00-SW = 4797.23 Ft. = 0.909 Mi.

CONTRACT NO. 95733

Joint Utility Locating Information for Excavators

JULIE 1-800-892-0123

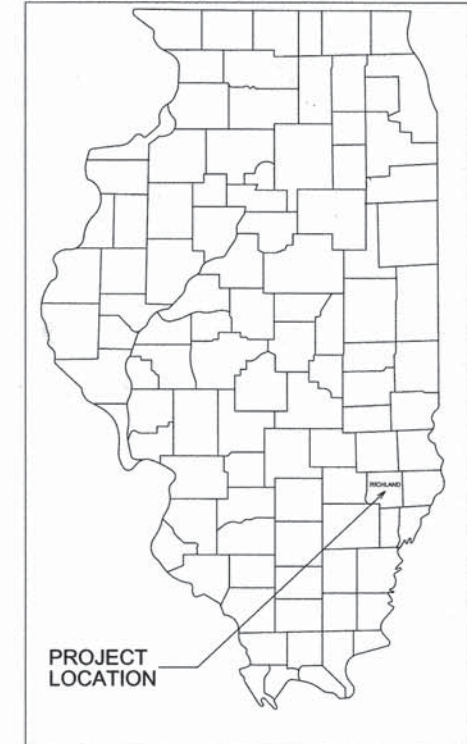

ROBERT A. CHARLESTON
REGISTERED PROFESSIONAL ENGINEER
OF ILLINOIS
12/11/14
Lic. Expires 11/30/15

CHARLESTON ENGINEERING, INC.
CONSULTING ENGINEERS
105 NORTH KITCHELL
P.O. BOX 397
OLNEY, ILLINOIS 62450
(618) 392-0736
ILLINOIS DEPARTMENT OF PROFESSIONAL REGULATION REGISTRATION #184.003513

APPROVED December 11 2014
Ray W. Jones
MAYOR - CITY OF OLNEY

STATE OF ILLINOIS
DEPARTMENT OF TRANSPORTATION
PASSED 1-2-2015
Margaret East
DISTRICT SEVEN ENGINEER OF
LOCAL ROADS AND STREETS

Releasing For
Bid Based on
Limited Review
1-2-2015
Paul L. Dushnell
DEPUTY DIRECTOR OF HIGHWAYS
REGION FOUR ENGINEER

ROUTE	SECTION	CITY	TOTAL SHEETS	SHEET NO.
SAFE ROUTES TO SCHOOL	12-00081-00-SW	OLNEY	21	2
CONTRACT NO. 95733		ILLINOIS	PROJECT SRTS-4009(281)	

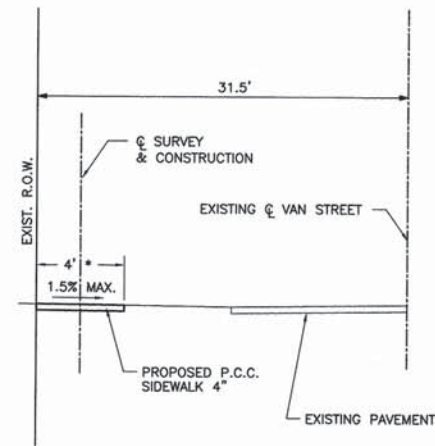

PROPOSED TYPICAL SECTION

STA. 42+00 TO 43+26

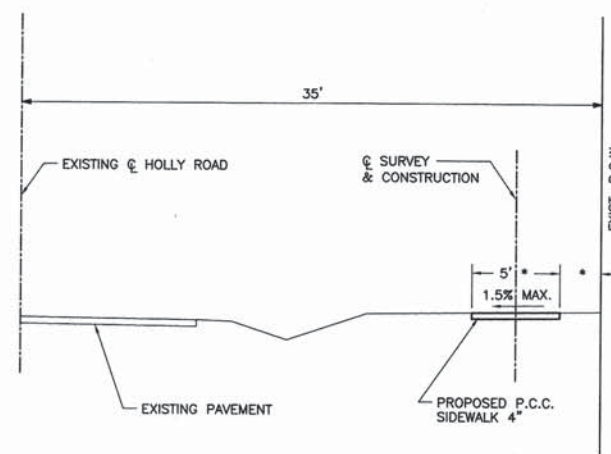

PROPOSED TYPICAL SECTION

STA. 72+84 TO 82+78.00
 * STA. 72+84 TO 73+31 = 1.0'
 STA. 73+31 TO 77+22 = 0.0'

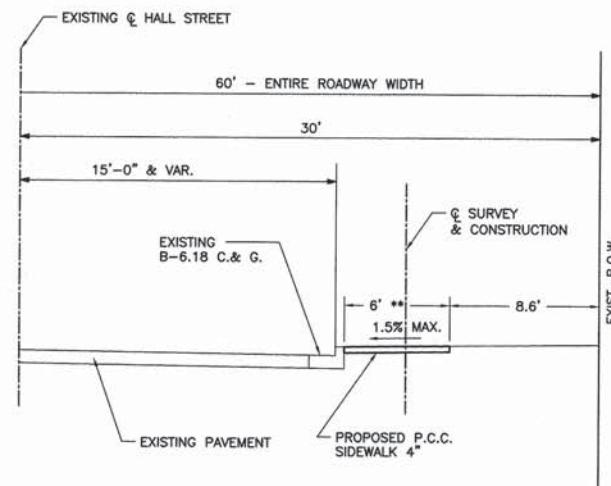

PROPOSED TYPICAL SECTION

STA. 47+30 TO 72+84

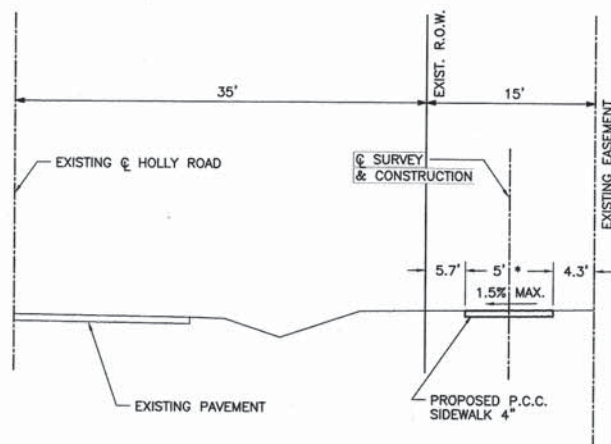

PROPOSED TYPICAL SECTION

STA. 77+22 TO 80+67

* DIMENSION PLUS ONE FOOT EACH SIDE OF PROPOSED SIDEWALK DENOTES PAY LIMITS FOR EARTH EXCAVATION
 ** DIMENSION PLUS ONE FOOT SOUTH SIDE OF PROPOSED SIDEWALK DENOTES PAY LIMITS FOR EARTH EXCAVATION

SUMMARY OF QUANTITIES			
CODE NO.	ITEM	UNIT	QUANTITY
X2500900	SEEDING, CLASS 1 (SPECIAL)	ACRE	0.80
X6023500	INLETS, TYPE A, WITH SALVAGED FRAME AND GRATE	EACH	1
X6024242	INLETS, SPECIAL, NO. 1	EACH	1
X6024244	INLETS, SPECIAL, NO. 2	EACH	1
X6024246	INLETS, SPECIAL, NO. 3	EACH	1
X7010216	TRAFFIC CONTROL AND PROTECTION, (SPECIAL)	L. SUM	1
XX000717	STORM SEWER CONNECTION, SPECIAL	EACH	1
Z0051400	REMOVING AND RESETTING POSTS	EACH	6
20100210	TREE REMOVAL (OVER 15 UNITS DIAMETER)	UNIT	116
20200100	EARTH EXCAVATION	CU YD	300
20800150	TRENCH BACKFILL	CU YD	10.0
35101400	AGGREGATE BASE COURSE, TYPE B	TON	123.0
40200800	AGGREGATE SURFACE COURSE, TYPE B	TON	5.0
Δ 40800050	INCIDENTAL HOT-MIX ASPHALT SURFACING	TON	3.0
42000100	PORTLAND CEMENT CONCRETE PAVEMENT 6"	SQ YD	253.0
42300200	PORTLAND CEMENT CONCRETE DRIVEWAY PAVEMENT, 6 INCH	SQ YD	525.0
42400100	PORTLAND CEMENT CONCRETE SIDEWALK 4 INCH	SQ FT	18385.0
42400800	DETECTABLE WARNINGS	SQ FT	202.0
44000100	PAVEMENT REMOVAL	SQ YD	273.0
44000200	DRIVEWAY PAVEMENT REMOVAL	SQ YD	525.0
44000500	COMBINATION CURB AND GUTTER REMOVAL	FOOT	291.0
44000600	SIDEWALK REMOVAL	SQ FT	875.0
55080070	STORM SEWERS, CLASS B, TYPE 1 15"	FOOT	5.0
Δ 56109210	WATER VALVES TO BE ADJUSTED	EACH	5
60100915	PIPE DRAINS 6"	FOOT	8.0
60255500	MANHOLES TO BE ADJUSTED	EACH	7
60260400	INLETS TO BE ADJUSTED WITH NEW TYPE 1 FRAME, CLOSED LID	EACH	3
60603800	COMBINATION CONCRETE CURB AND GUTTER, TYPE B-6.12	FOOT	106.0
60604400	COMBINATION CONCRETE CURB AND GUTTER, TYPE B-6.18	FOOT	276.0
67100100	MOBILIZATION	L. SUM	1
70100450	TRAFFIC CONTROL AND PROTECTION, STANDARD 701201	L. SUM	1
70102620	TRAFFIC CONTROL AND PROTECTION, STANDARD 701501	L. SUM	1
70102640	TRAFFIC CONTROL AND PROTECTION, STANDARD 701801	L. SUM	1
Δ 84400105	RELOCATE EXISTING LIGHTING UNIT	EACH	1

Δ SPECIALTY ITEMS

EXCAVATION AND EMBANKMENT		
ITEM		CU.YD.
EXCAVATION		
SIDEWALK EXCAVATION		290
DRIVEWAY EXCAVATION		10
	TOTAL	300
EMBANKMENT		
SIDEWALK		25
	TOTAL	25

GENERAL NOTES

1. THE CROSS SLOPE OF ALL SIDEWALKS SHALL NOT EXCEED 1.5%. SEE IDOT STANDARD DRAWINGS FOR MORE DETAIL.
2. THE LONGITUDINAL SLOPE OF ALL SIDEWALKS SHALL NOT EXCEED 8.0%. SEE IDOT STANDARD DRAWINGS FOR MORE DETAIL.
3. SIDE CURBS SHALL BE LOCATED AT AREAS ALONG THE PROPOSED SIDEWALK RAMPS ACCORDING TO THE STANDARD DRAWINGS LISTED ON SHEET 1. SIDE CURBS SHALL BE INCIDENTAL TO ITEM "PORTLAND CEMENT CONCRETE SIDEWALK 4 INCH" AND SURFACE AREAS ARE INCLUDED IN THE QUANTITIES SHOWN.
4. THE FINISHED SURFACE OF THE PROPOSED P.C.C. SIDEWALK 4" SHALL FOLLOW EXISTING GROUND AND / OR BACK OF CURB PROFILES THROUGHOUT PROPOSED CORRIDOR UNLESS OTHERWISE NOTED ON THE PLANS.
5. ALL SAND BACKFILL USED UNDER THE PROPOSED P.C.C. SIDEWALK 4" SHALL BE ENTIRELY AT THE CONTRACTOR'S EXPENSE.

CHARLESTON ENGINEERING, INC.
 CONSULTING ENGINEERS
 105 NORTH KITCHELL
 P.O. BOX 387
 OLNEY, ILLINOIS 62450
 (618) 352-0736
 ILLINOIS DEPARTMENT OF PROFESSIONAL REGULATION REGISTRATION #184.003913

SUMMARY OF QUANTITIES /
 TYPICAL SECTIONS
 SECTION 12-00081-00-SW
 CITY OF OLNEY

ROUTE	SECTION	CITY	TOTAL SHEETS	SHEET NO.
SAFE ROUTES TO SCHOOL	12-00081-00-SW	OLNEY	21	3
CONTRACT NO. 95733		ILLINOIS	PROJECT SRTS-4009(2B1)	

DRAINAGE STRUCTURES					
NO.	DIST.	STA.	ITEM	GRATE	INV.
1	3' RT.	34+15	INLETS, SPECIAL, NO. 1	487.73	486.41
2	3' LT.	34+18	OUTFALL	-	486.33
3	16' RT.	55+80	INLETS, TYPE A, WITH SALVAGED FRAME AND GRATE	505.00	501.90
4	16' RT.	55+83	STORM SEWER CONNECTION, SPECIAL	-	501.85
5	8' RT.	55+81	INLETS TO BE ADJUSTED WITH NEW TYPE 1 FRAME, CLOSED LID	505.10	502.64
6	1' RT.	58+38	INLETS TO BE ADJUSTED WITH NEW TYPE 1 FRAME, CLOSED LID	506.95	503.25
7	15' RT.	58+44	INLETS, SPECIAL, NO. 2	506.59	503.54
8	1' RT.	58+77	INLETS TO BE ADJUSTED WITH NEW TYPE 1 FRAME, CLOSED LID	507.67	503.66
9	15' RT.	58+72	INLETS, SPECIAL, NO. 3	507.04	503.72

NOTE: DRAINAGE STRUCTURE (D.S.)#3-USE SALVAGED TY-23 F&G FROM D.S.#5

STORM SEWERS - CLASS B		
LOCATION	TY-1,15"	TR.B'FILL
3 TO 4	5.0	5.0

PIPE DRAINS 6"		
LOCATION	TY-1,6"	TR.B'FILL
1 TO 2	8.0	5.0

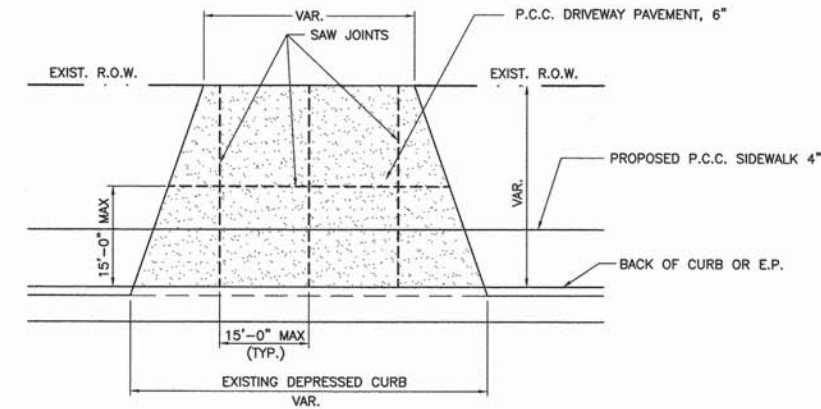

PRIVATE ENTRANCE DETAILS

LOCATED AT ALL PRIVATE ENTRANCES

NOTES

- PRIVATE ENTRANCES SHALL HAVE SAW JOINTS AT 15' SPACING MAX. MEASURED ALONG THE BACK OF CURB AND 15' SPACING MAX. MEASURED ALONG LENGTH OF ENTRANCES
- PREFORMED EXPANSION JOINT FILLER SHALL BE USED AS SHOWN ON STANDARD BLR 10-6. COST TO BE INCLUDED IN ITEM "P.C.C. DRIVEWAY PAVEMENT 6 INCH."
- THE COST OF ALL SAW JOINTS SHALL BE INCLUDED IN ITEM "P.C.C. DRIVEWAY PAVEMENT, 6 INCH."

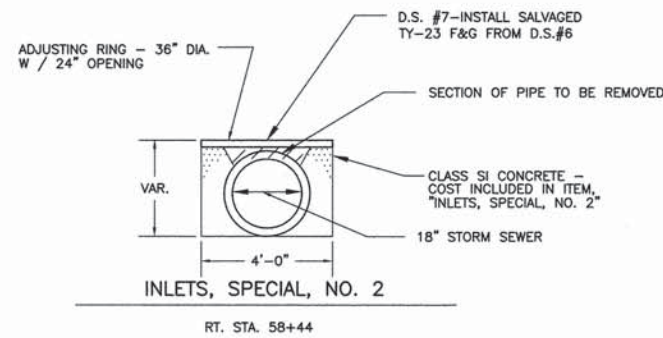

RT. STA. 58+44

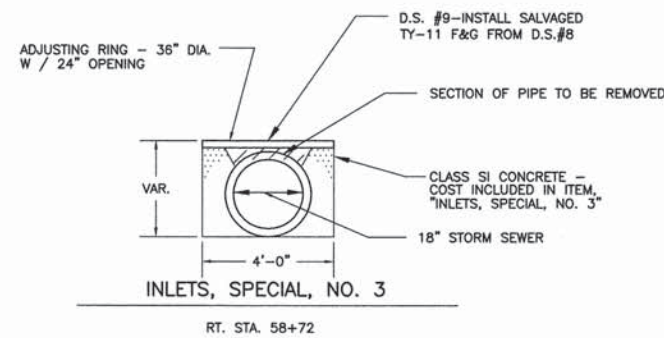

RT. STA. 58+72

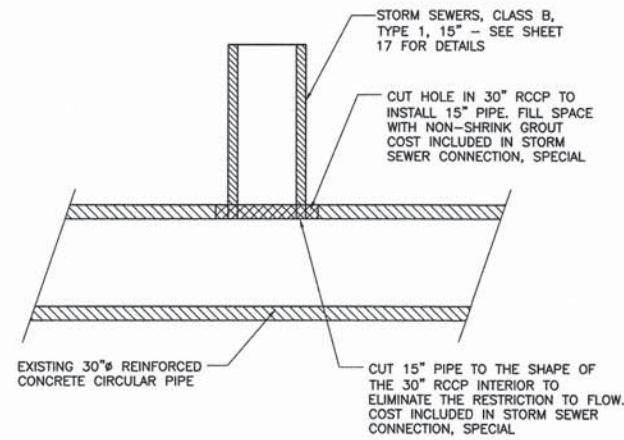

STORM SEWER CONNECTION, SPECIAL DETAIL

RT. STA. 55+83

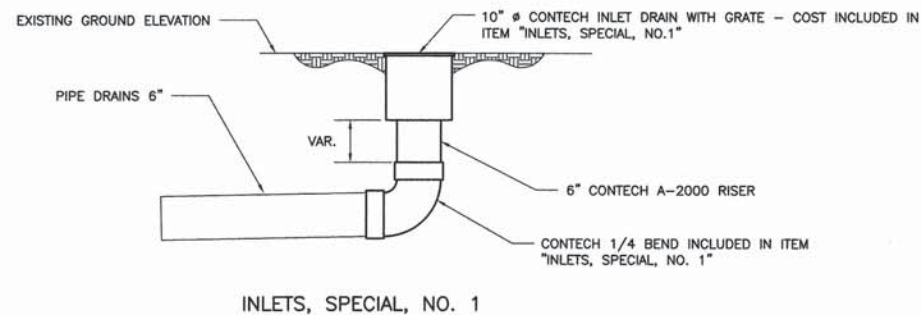

INLETS, SPECIAL, NO. 1

STA. 34+15

NOTE: RISER PIPE LENGTHS AND 1/4 BEND COST INCLUDED IN ITEMS "INLETS, SPECIAL, NO. 1"

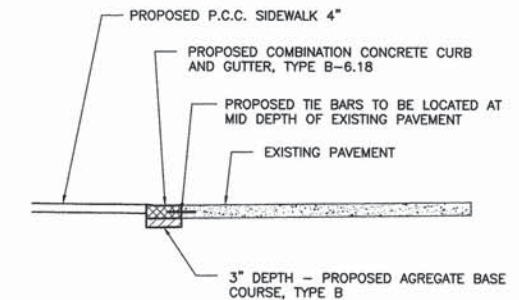

SECTION A-A

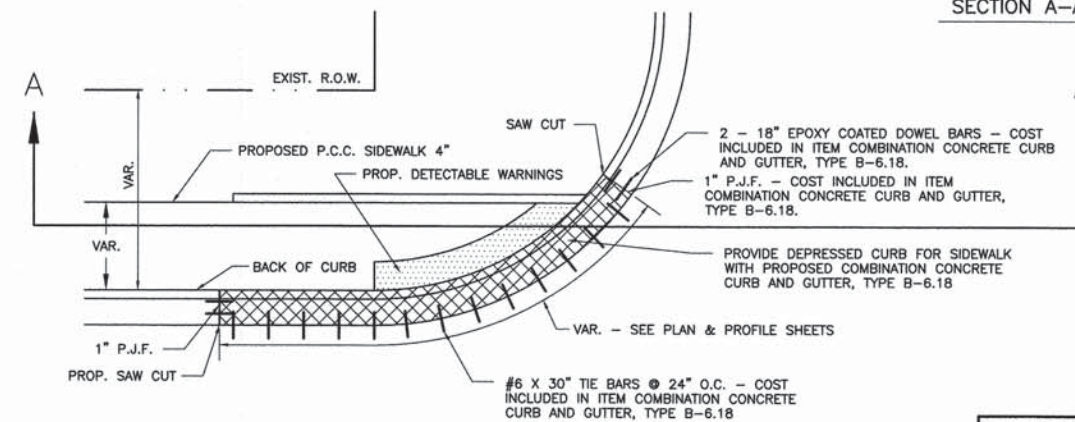

PLAN VIEW

TYPICAL CURB RAMP DETAILS

- THE PROPOSED CURB AND GUTTER SHALL BE TIED TO THE EXISTING P.C.C. PAVEMENT USING #6 X 30" EPOXY COATED REBARS EXTENDING 15" INTO THE PROPOSED CURB AND GUTTER. THE BARS SHALL BE DRILLED AND EPOXY GROUTED INTO THE EXISTING PAVEMENT, 24" O.C.
- THE PROPOSED CURB AND GUTTER SHALL BE TIED TO THE EXISTING CURB AND GUTTER WITH 2 - 18" EPOXY COATED DOWEL BARS EXTENDING 9" INTO THE PROPOSED CURB AND GUTTER AT EACH END AS SHOWN IN STANDARD 606001, DETAIL A.

LOCATED AT ALL LOCATIONS WHERE PROPOSED P.C.C. CURB AND GUTTER ABUTS EXISTING P.C.C. PAVEMENT AND / OR EXISTING CONCRETE CURB AND GUTTER

CHARLESTON ENGINEERING, INC.
 CONSULTING ENGINEERS
 105 NORTH KITCHELL
 P.O. BOX 397
 OLNEY, ILLINOIS 62450
 (618) 352-0736
 ILLINOIS DEPARTMENT OF PROFESSIONAL REGULATION REGISTRATION #164.003513

MISCELLANEOUS DETAILS

SECTION 12-00081-00-SW
CITY OF OLNEY

ROUTE	SECTION	CITY	TOTAL SHEETS	SHEET NO.
SAFE ROUTES TO SCHOOL	12-00081-00-SW	OLNEY	21	4
CONTRACT NO. 95733		ILLINOIS	PROJECT SRTS-4009(281)	

EAST RICHLAND COMMUNITY UNIT SCHOOL DISTRICT #1,
EAST RICHLAND MIDDLE SCHOOL PROPERTY

SCALES:
1" = 20' HOR
1" = 5' VER

FIBER OPTIC LINE
CLEARWAVE COMMUNICATIONS
HARRISBURG, ILLINOIS
618-294-8000

HATCH LEGEND

	DRIVEWAY PAVEMENT REMOVAL
	SIDEWALK REMOVAL
	DETECTABLE WARNINGS

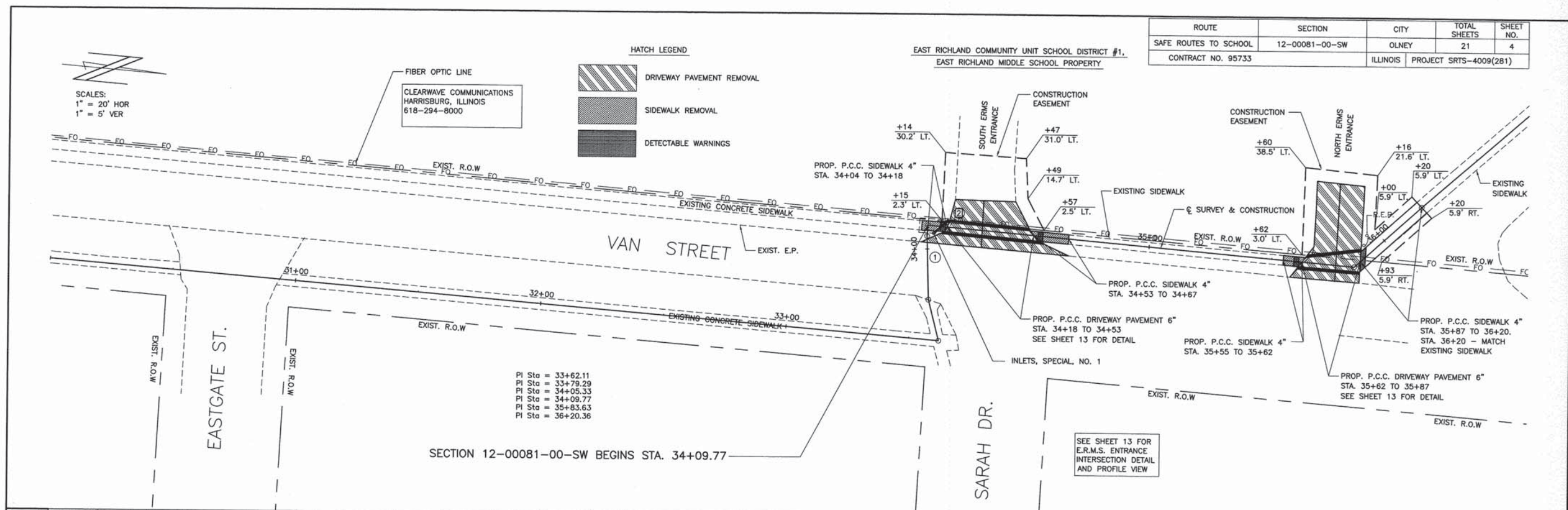

PI Sta = 33+62.11
PI Sta = 33+79.29
PI Sta = 34+05.33
PI Sta = 34+09.77
PI Sta = 35+83.63
PI Sta = 36+20.36

SECTION 12-00081-00-SW BEGINS STA. 34+09.77

45	DRIVEWAY PAVEMENT REMOVAL	SQ YD	PORTLAND CEMENT CONCRETE DRIVEWAY PAVEMENT 6"	SQ YD	45								
	STA. 34+18 TO 34+53 (ERMS SOUTH ENTRANCE)	77.0	STA. 34+18 TO 34+53 (ERMS SOUTH ENTRANCE)	77.0									
	STA. 35+62 TO 35+87 (ERMS NORTH ENTRANCE)	93.0	STA. 35+62 TO 35+87 (ERMS NORTH ENTRANCE)	93.0									
	TOTAL 170.0 SQ YD		TOTAL 170.0 SQ YD										
40					40								
35	SIDEWALK REMOVAL	SQ FT	PORTLAND CEMENT CONCRETE SIDEWALK 4 INCH	SQ FT	35								
	STA. 34+04 TO 34+18	40	STA. 34+04 TO 34+18	40									
	STA. 34+53 TO 34+67	55	STA. 34+53 TO 34+67	55									
	STA. 35+55 TO 35+63	35	STA. 35+55 TO 35+63	34									
	TOTAL 130 SQ FT		STA. 35+87 TO 36+20	196									
			TOTAL 325 SQ FT										
30					30								
25	REMOVING AND RESETTING POSTS	EACH	SEEDING, CLASS 1 (SPECIAL)	ACRE	25								
	LT. STA. 35+93	1	STA. 30+09 TO 36+20	0.02									
20	AGGREGATE BASE COURSE, TYPE B	TON	DETECTABLE WARNINGS	SQ FT	20								
	STA. 34+32 (ERMS SOUTH ENTRANCE)	15	STA. 34+18	8.0									
	STA. 35+76 (ERMS NORTH ENTRANCE)	16	STA. 34+56	8.0									
	TOTAL 31 TON		STA. 35+60	8.0									
			STA. 35+88	18.0									
			TOTAL 42.0 SQ FT										
15					15								
10					10								
5					5								
0					0								
	30+00	30+50	31+00	31+50	32+00	32+50	33+00	33+50	34+00	34+50	35+00	35+50	36+00

ROUTE	SECTION	CITY	TOTAL SHEETS	SHEET NO.
SAFE ROUTES TO SCHOOL	12-00081-00-SW	OLNEY	21	5
CONTRACT NO. 95733		ILLINOIS	PROJECT SRTS-4009(281)	

SCALES:
1" = 20' HOR
1" = 5' VER

E.R.M.S. SCHOOL
BUS DRIVE

CIRCULAR
D = 95'23.09"
Dc = 40'11.34"
Dc = 41'03.58"
T = 156.62
R = 142.55
L = 237.32
C = 210.85
E = 69.23
M = 46.60

APPROX. LOCATION
PI Sta = 36+20.36
PI Sta = 36+88.76
PI Sta = 38+45.39
PI Sta = 39+26.08
PI Sta = 40+11.26
PI Sta = 41+74.31

HATCH LEGEND
[Hatched Box] DRIVEWAY PAVEMENT REMOVAL

KENNETH H. & CANDICE HARRISON

P.C.C. DRIVEWAY PAVEMENT, 6 INCH
STA. 41+74 TO 42+00

SEE NEXT SHEET FOR
SIDEWALK QUANTITIES

CONSTRUCTION
EASEMENT

☉ SURVEY & CONSTRUCTION

SEE SHEET 14 FOR
SIDEWALK DETAIL

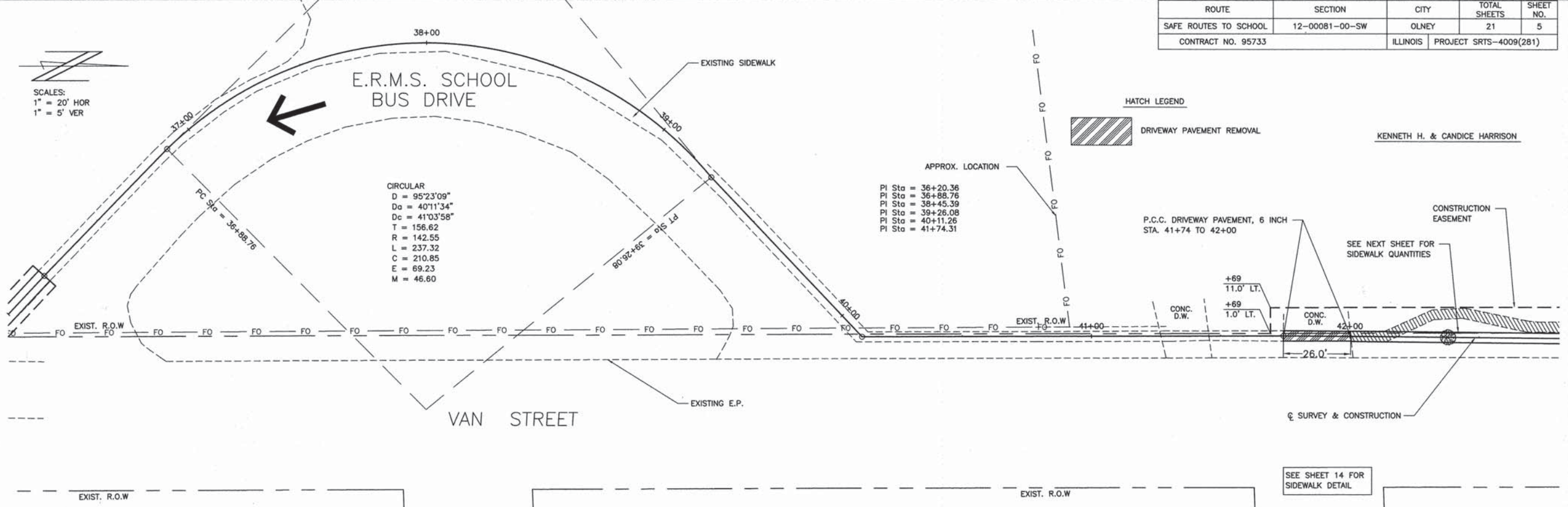

45	DRIVEWAY PAVEMENT REMOVAL	SQ YD	PORTLAND CEMENT CONCRETE DRIVEWAY PAVEMENT 6"	SQ YD	45								
	STA. 41+74 TO 42+00	12.0	STA. 41+74 TO 42+00	12.0									
40					40								
35					35								
30					30								
25					25								
20					20								
15					15								
10					10								
5					5								
0					0								
	36+00	36+50	37+00	37+50	38+00	38+50	39+00	39+50	40+00	40+50	41+00	41+50	42+00

ROUTE	SECTION	CITY	TOTAL SHEETS	SHEET NO.
SAFE ROUTES TO SCHOOL	12-00081-00-SW	OLNEY	21	8
CONTRACT NO. 95733		ILLINOIS	PROJECT SRTS-4009(281)	

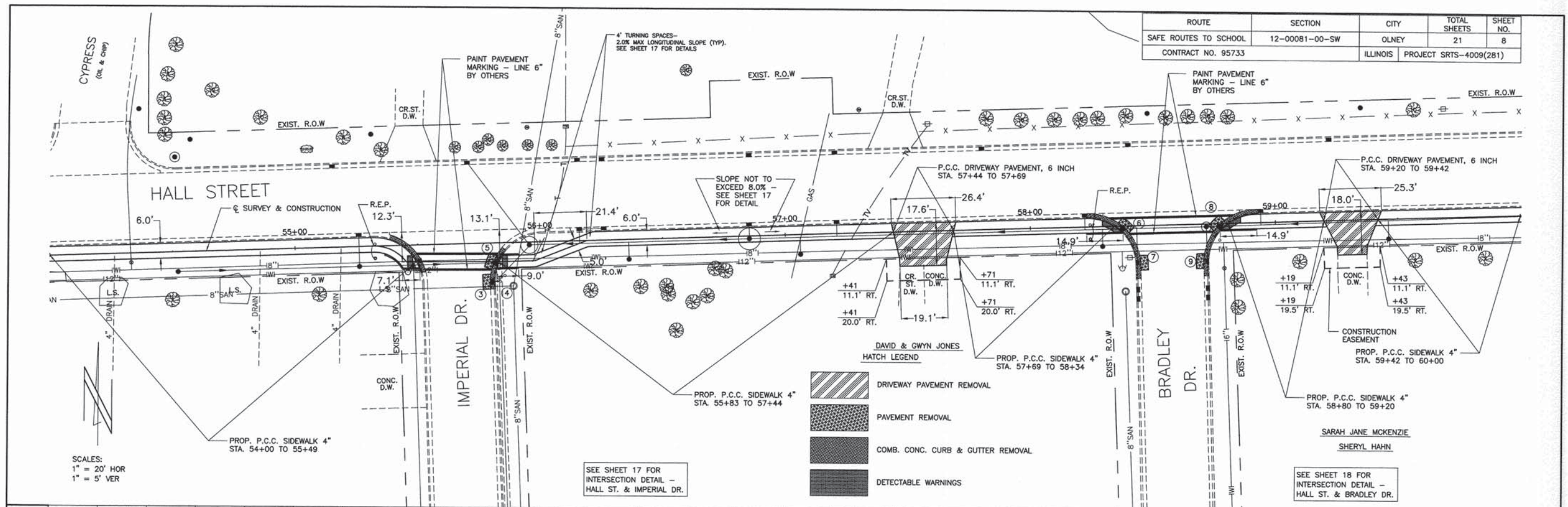

SCALES:
 1" = 20' HOR
 1" = 5' VER

SEE SHEET 17 FOR
 INTERSECTION DETAIL -
 HALL ST. & IMPERIAL DR.

DAVID & GWYN JONES
 HATCH LEGEND

	DRIVEWAY PAVEMENT REMOVAL
	PAVEMENT REMOVAL
	COMB. CONC. CURB & GUTTER REMOVAL
	DETECTABLE WARNINGS

SEE SHEET 18 FOR
 INTERSECTION DETAIL -
 HALL ST. & BRADLEY DR.

45	DRIVEWAY PAVEMENT REMOVAL	SQ YD	PORTLAND CEMENT CONCRETE DRIVEWAY PAVEMENT, 6 INCH	SQ YD	SEEDING, CLASS 1 (SPECIAL)	ACRE	45						
	STA. 57+44 TO 57+69 STA. 59+20 TO 59+42	44.0 35.0 TOTAL 79.0 SQ YD	STA. 57+44 TO 57+69 STA. 59+20 TO 59+42	44.0 35.0 TOTAL 79.0 SQ YD	STA. 54+00 TO 60+00	0.10							
40					AGGREGATE BASE COURSE, TYPE B	TON	40						
					STA. 55+48 STA. 55+81 STA. 58+33 STA. 58+83	2.0 4.0 6.0 6.0 TOTAL 18.0 TON							
35	COMBINATION CURB AND GUTTER REMOVAL	FOOT	COMBINATION CONCRETE CURB AND GUTTER, TYPE B-6.18	FOOT			35						
	STA. 55+48 STA. 55+81 STA. 58+33 STA. 58+83	20.0 18.0 40.0 40.0 TOTAL 118.0 FOOT	STA. 55+48 STA. 55+81 STA. 58+33 STA. 58+83	20.0 18.0 40.0 40.0 TOTAL 118.0 FOOT									
30					RELOCATE EXISTING LIGHTING UNIT	EACH	30						
					RT. STA. 55+49	1							
25	WATER VALVES TO BE ADJUSTED	EACH	PORTLAND CEMENT CONCRETE SIDEWALK 4 INCH	SQ FT	PORTLAND CEMENT CONCRETE PAVEMENT 6"	SQ YD	25						
	STA. 54+33 STA. 55+48 STA. 55+51	1 1 1 TOTAL 3 EACH	STA. 54+00 TO 55+49 STA. 55+83 TO 57+44 STA. 57+69 TO 58+34 STA. 58+80 TO 59+20 STA. 59+42 TO 60+00	918.0 900.0 394.0 232.0 348.0 TOTAL 2790.0 SQ FT	STA. 55+80 STA. 55+81 STA. 58+38 STA. 58+43 STA. 58+72 STA. 58+77	3.0 2.0 2.0 2.0 2.0 2.0 TOTAL 13.0 SQ YD							
20							20						
15	MANHOLES TO BE ADJUSTED	EACH	DETECTABLE WARNINGS	SQ FT	PAVEMENT REMOVAL	SQ YD	15						
	STA. 56+85	1	STA. 55+48 STA. 55+84 STA. 58+33 STA. 58+83	10.0 10.0 16.0 16.0 TOTAL 52.0 SQ FT	STA. 55+80 STA. 55+81 STA. 58+38 STA. 58+43 STA. 58+72 STA. 58+77	3.0 2.0 2.0 2.0 2.0 2.0 TOTAL 13.0 SQ YD							
10	REMOVING AND RESETTNG POSTS	EACH					10						
	LT. STA. 55+32 LT. STA. 58+25	1 1 TOTAL 2 EACH											
5							5						
0							0						
	54+00	54+50	55+00	55+50	56+00	56+50	57+00	57+50	58+00	58+50	59+00	59+50	60+00

ROUTE	SECTION	CITY	TOTAL SHEETS	SHEET NO.
SAFE ROUTES TO SCHOOL	12-00081-00-SW	OLNEY	21	10
CONTRACT NO. 95733		ILLINOIS	PROJECT SRTS-4009(281)	

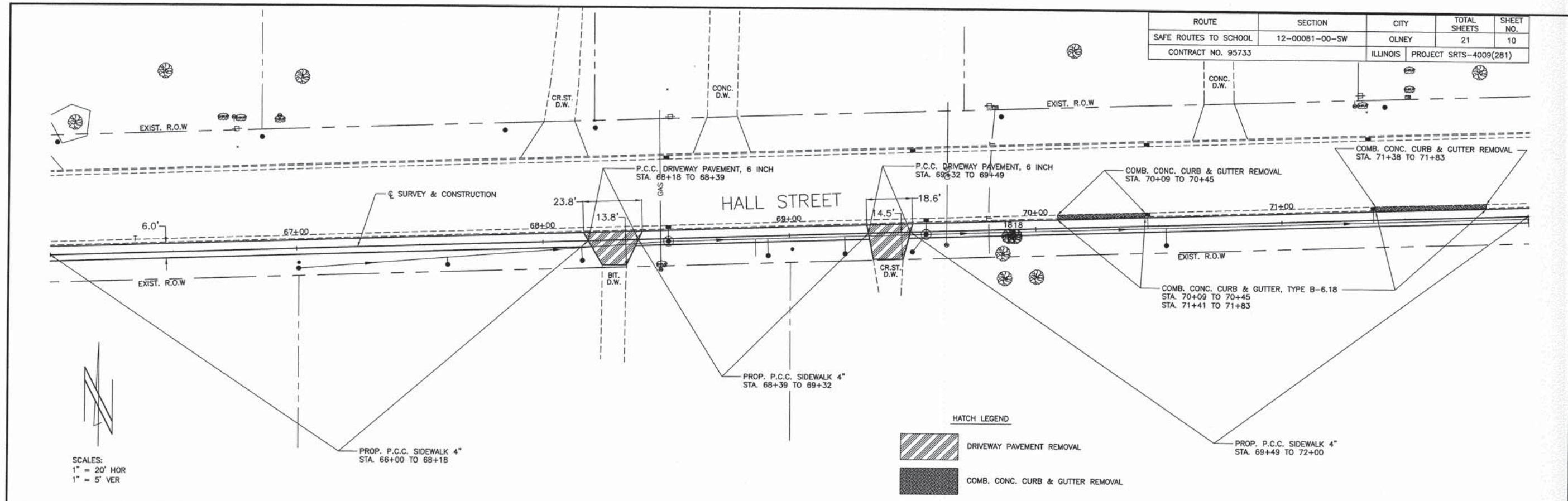

45	TREE REMOVAL (OVER 15 UNITS DIAMETER)	UNIT	PORTLAND CEMENT CONCRETE DRIVEWAY PAVEMENT, 6 INCH	SQ YD	SEEDING, CLASS 1 (SPECIAL)	ACRE	45						
	STA. 69+89 STA. 69+91	20 24 TOTAL 44 UNITS	STA. 68+18 TO 68+39 STA. 69+32 TO 69+49	26.0 25.0 TOTAL 51.0 SQ YD	STA. 66+00 TO 72+00	0.12							
40					AGGREGATE BASE COURSE, TYPE B	TON	40						
					STA. 70+09 TO 70+45 STA. 71+38 TO 71+83	2.0 3.0 TOTAL 5.0 TON							
35	DRIVEWAY PAVEMENT REMOVAL	SQ YD	PORTLAND CEMENT CONCRETE SIDEWALK 4 INCH	SQ FT			35						
	STA. 68+18 TO 68+39 STA. 69+32 TO 69+49	26.0 25.0 TOTAL 51.0 SQ YD	STA. 66+00 TO 68+18 STA. 68+39 TO 69+32 STA. 69+49 TO 72+00	1295.0 554.0 1486.0 TOTAL 3335.0 SQ FT									
30							30						
25	COMBINATION CURB AND GUTTER REMOVAL	FOOT	COMBINATION CONCRETE CURB AND GUTTER, TYPE B-6.18	FOOT			25						
	STA. 70+09 TO 70+45 STA. 71+41 TO 71+83	36.0 45.0 TOTAL 81.0 FOOT	STA. 70+09 TO 70+45 STA. 71+38 TO 71+83	36.0 45.0 TOTAL 81.0 FOOT									
20							20						
15	MANHOLES TO BE ADJUSTED	EACH					15						
	STA. 68+51 STA. 69+56	1 1 TOTAL 2 EACH											
10							10						
5							5						
0							0						
	66+00	66+50	67+00	67+50	68+00	68+50	69+00	69+50	70+00	70+50	71+00	71+50	72+00

ROUTE	SECTION	CITY	TOTAL SHEETS	SHEET NO.
SAFE ROUTES TO SCHOOL	12-00081-00-SW	OLNEY	21	11
CONTRACT NO. 95733		ILLINOIS	PROJECT SRTS-4009(281)	

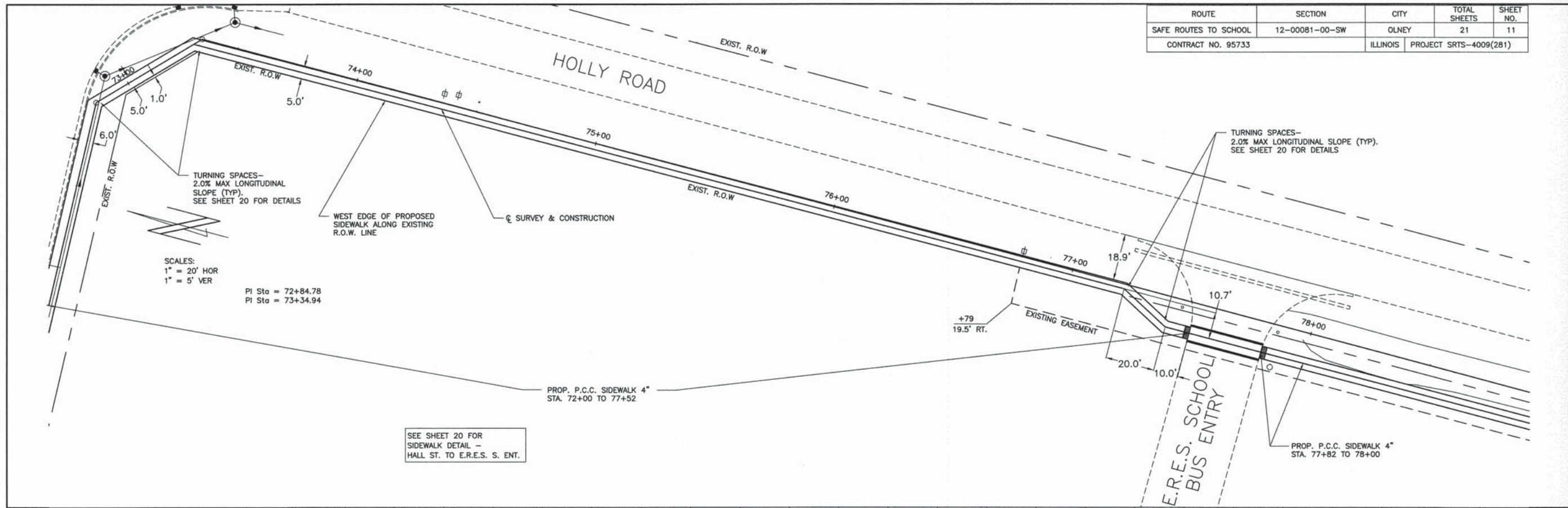

45	PORTLAND CEMENT CONCRETE SIDEWALK 4 INCH	SQ FT	45
	STA. 72+00 TO 77+52	2850.0	
	STA. 77+82 TO 78+00	90.0	
	TOTAL	2940.0 SQ FT	
40			40
35	SEEDING, CLASS 1 (SPECIAL)	ACRE	35
	STA. 72+00 TO 78+00	0.12	
30			30
25			25
20			20
15			15
10			10
5			5
0			0
	72+00	72+50	73+00
		73+50	74+00
			74+50
			75+00
			75+50
			76+00
			76+50
			77+00
			77+50
			78+00

ROUTE	SECTION	CITY	TOTAL SHEETS	SHEET NO.
SAFE ROUTES TO SCHOOL	12-00081-00-SW	OLNEY	21	12
CONTRACT NO. 95733		ILLINOIS	PROJECT SRTS-4009(281)	

SCALES:
1" = 20' HOR
1" = 5' VER

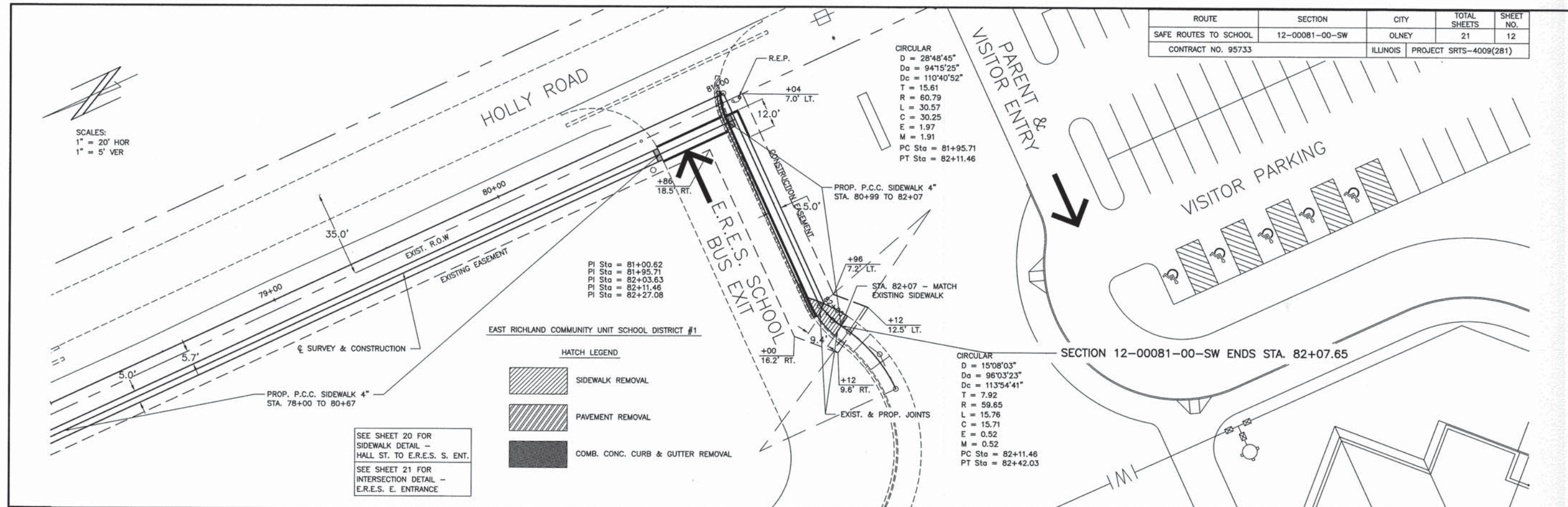

SEE SHEET 20 FOR
SIDEWALK DETAIL -
HALL ST. TO E.R.E.S. S. ENT.
SEE SHEET 21 FOR
INTERSECTION DETAIL -
E.R.E.S. E. ENTRANCE

HATCH LEGEND

	SIDEWALK REMOVAL
	PAVEMENT REMOVAL
	COMB. CONC. CURB & GUTTER REMOVAL

45	COMBINATION CURB AND GUTTER REMOVAL	FOOT	COMBINATION CONCRETE CURB AND GUTTER, TYPE B-6.12	FOOT	SEEDING, CLASS 1 (SPECIAL)	ACRE	45						
	STA. 81+85 TO 81+98	15.0	STA. 81+85 TO 81+98	106.0	STA. 78+00 TO 82+07	0.20							
40	SIDEWALK REMOVAL	SQ FT	PORTLAND CEMENT CONCRETE SIDEWALK 4 INCH	SQ FT	INCIDENTAL HOT-MIX ASPHALT SURFACING	TON	40						
	STA. 81+94 TO 82+07	105.0	STA. 78+00 TO 80+87 STA. 80+99 TO 82+07	1340.0 535.0 TOTAL 1875.0 SQ FT	STA. 81+00 TO 82+00	3.0							
35	REMOVING AND RESETTING POSTS	EACH					35						
	LT. STA. 81+05	1											
30	PAVEMENT REMOVAL	SQ YD	DETECTABLE WARNINGS	SQ FT			30						
	STA. 81+00 TO 82+00	20.0	STA. 80+63 STA. 81+01	10.0 13.0 TOTAL 23.0 SQ FT									
25	AGGREGATE BASE COURSE, TYPE B	TON					25						
	STA. 81+00 TO 82+00	13.0											
20							20						
15							15						
10							10						
5							5						
0							0						
	78+00	78+50	79+00	79+50	80+00	80+50	81+00	81+50	82+00	82+50	83+00	83+50	84+00

ERMS NORTH ENTRANCE

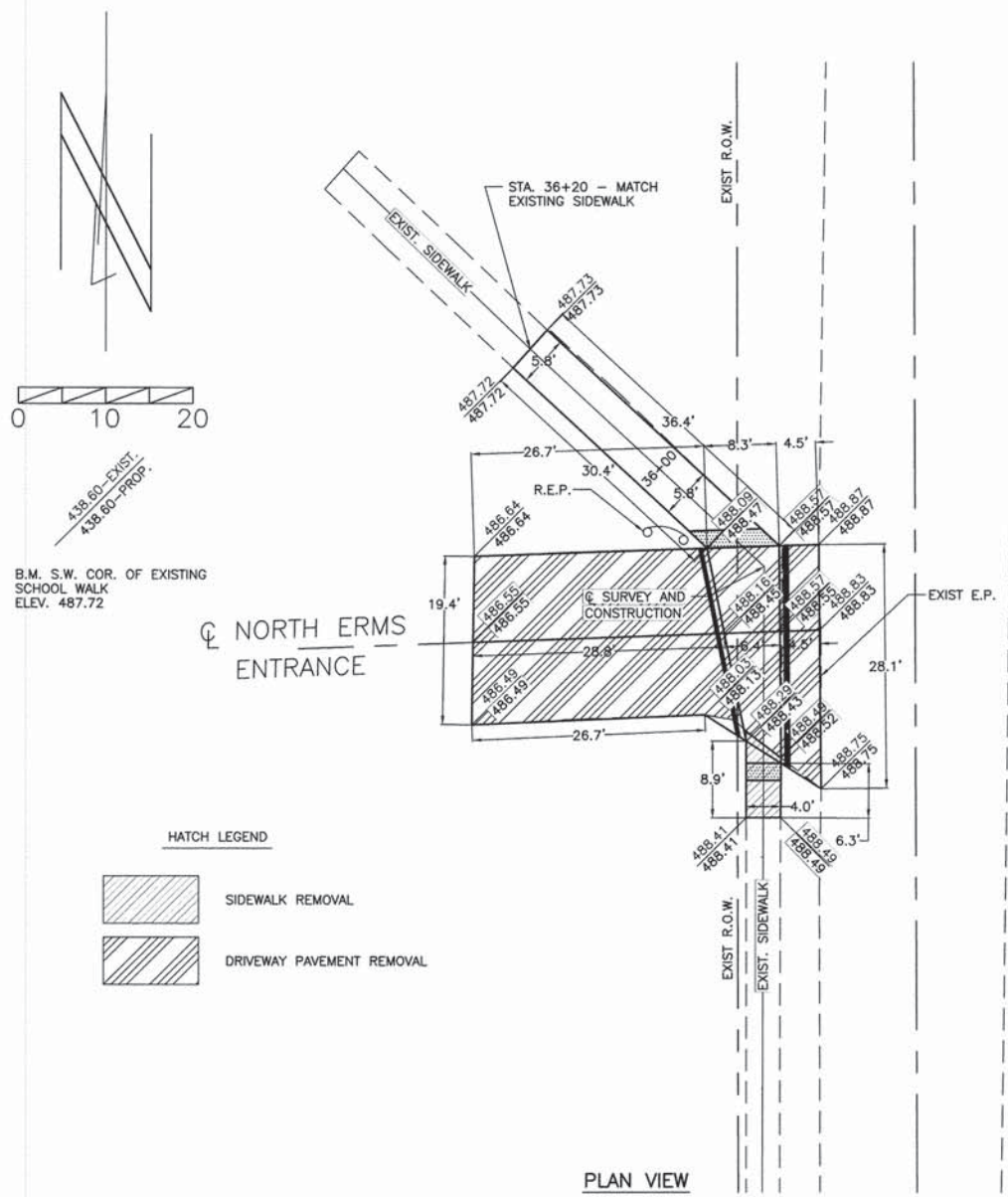

CONSTRUCTION NOTES

1. AT NORTH ERMS ENTRANCE, SAW 28.1 L.F. OF EXISTING PAVEMENT AT VAN STREET, AND 19.4 L.F. OF EXISTING PAVEMENT AT WEST END OF ENTRANCE, FULL DEPTH TO ESTABLISH A VERTICAL CONSTRUCTION JOINT, AND REMOVE EXISTING PAVEMENT.
2. AT SOUTH ERMS ENTRANCE, SAW 60.1 L.F. OF EXISTING PAVEMENT AT VAN STREET, AND 23.3' OF EXISTING PAVEMENT AT WEST END OF ENTRANCE, FULL DEPTH TO ESTABLISH A VERTICAL CONSTRUCTION JOINT, AND REMOVE EXISTING PAVEMENT.
3. CONSTRUCT PORTLAND CEMENT CONCRETE DRIVEWAY PAVEMENT 6" ON 3" AGGREGATE BASE COURSE, TYPE B FROM FULL DEPTH JOINT AT VAN STREET TO FULL DEPTH JOINT AT WEST END OF ENTRANCES.
4. THE CROSS-SLOPE OF SIDEWALK SHALL NOT EXCEED 1.5%
5. THE P.C.C. DRIVEWAY PAVEMENT 6" SHALL BE TIED TO THE EXISTING PAVEMENT AT BOTH JOINTS USING #6 X 30" EPOXY COATED REBARS EXTENDING 12" INTO THE NEW PAVEMENT. THE BARS SHALL BE DRILLED AND EPOXY GROUTED INTO THE EXISTING PAVEMENT, 24" O.C.
6. ALL PCC PAVEMENT TRANSVERSE CONSTRUCTION JOINTS TO BE TIED WITH #6 X 30" EPOXY COATED BARS AT 24" CTS.
7. SAWED CONTRACTION JOINT SPACING SHALL BE AT 12.5 FT. MAX. DOWEL BARS WILL NOT BE REQUIRED AT SAWED CONTRACTION JOINTS.
8. CONTRACTOR TO RE-SEED ALL DISTURBED AREAS WITHIN CITY OF OLNEY R.O.W.
9. ALL SAW JOINTS SHALL BE SEALED WITH HOT POURED JOINT SEALER. SEE SPECIAL PROVISIONS.
10. THE FOLLOWING ITEMS SHALL CONFORM TO, OR BE CONSTRUCTED ACCORDING TO THE STANDARDS SHOWN.

ITEM	STANDARD
P.C.C. SIDEWALK	424001-07 424026-01
TRAFFIC CONTROL	701006-05 701301-04 701501-06 701801-05 701901-03

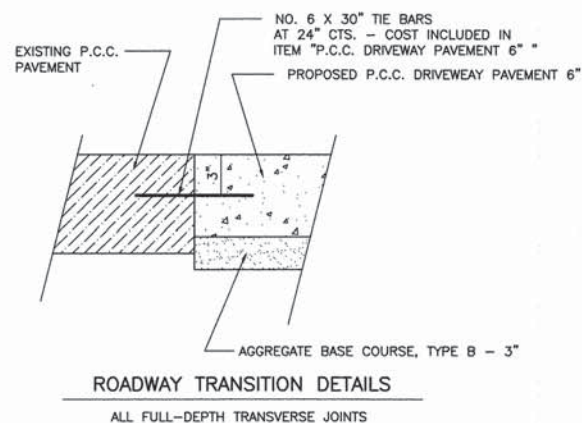

ERMS SOUTH ENTRANCE

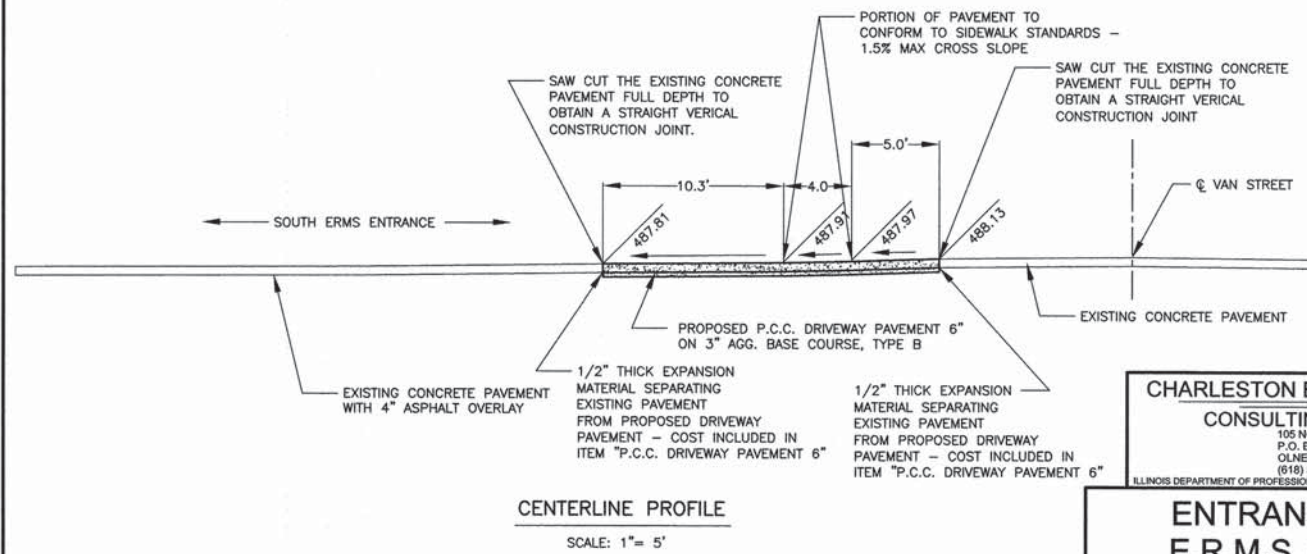
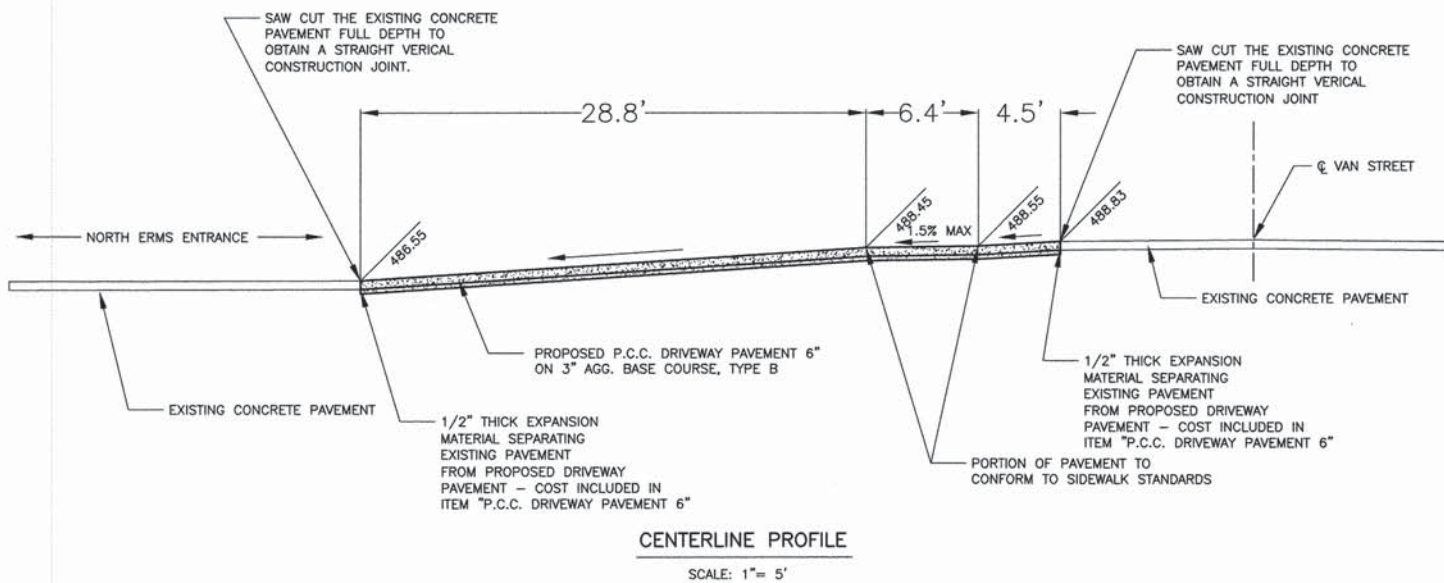
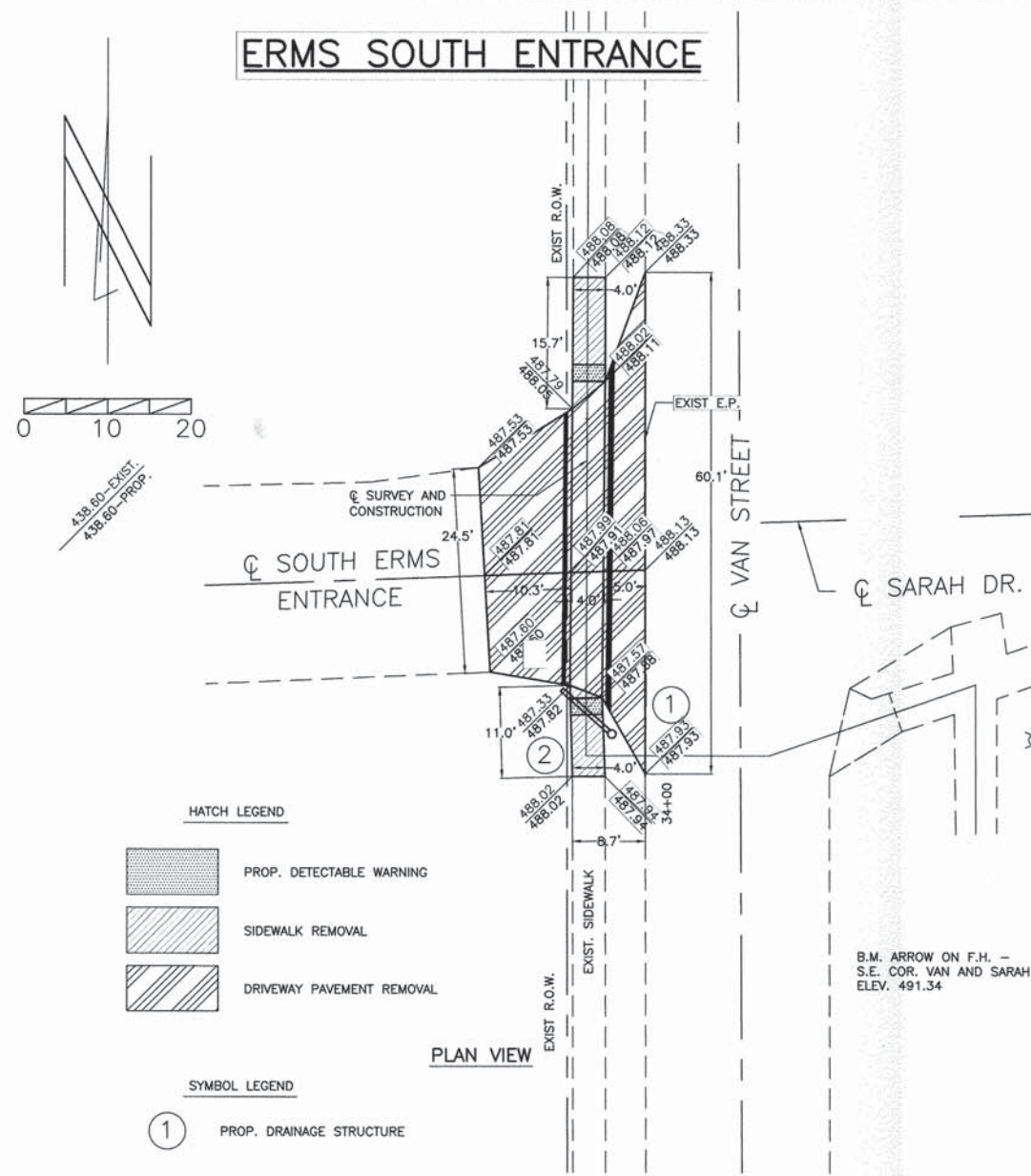

CHARLESTON ENGINEERING, INC.
CONSULTING ENGINEERS
105 NORTH KITCHELL
P.O. BOX 397
OLNEY, ILLINOIS 62450
(618) 362-0736
ILLINOIS DEPARTMENT OF PROFESSIONAL REGULATION REGISTRATION #184-003513

ENTRANCE DETAIL -
E.R.M.S. ENTRANCES
SECTION 12-00081-00-SW
CITY OF OLNEY

ROUTE	SECTION	CITY	TOTAL SHEETS	SHEET NO.
SAFE ROUTES TO SCHOOL	12-00081-00-SW	OLNEY	21	15
CONTRACT NO. 95733		ILLINOIS	PROJECT SRTS-4009(281)	

CONSTRUCTION NOTES

1. SAW 87 L.F. OF EXISTING PAVEMENT, AT EXISTING EDGE OF PAVEMENT AT VAN STREET LOCATION, FULL DEPTH TO ESTABLISH A VERTICAL CONSTRUCTION JOINT, AND REMOVE EXISTING PAVEMENT.
2. SAW 35 L.F. OF EXISTING PAVEMENT, AT EXISTING EDGE OF PAVEMENT ALONG JONATHAN STREET LOCATION, FULL DEPTH TO ESTABLISH A VERTICAL CONSTRUCTION JOINT, AND REMOVE EXISTING PAVEMENT.
3. CONSTRUCT PORTLAND CEMENT CONCRETE PAVEMENT 6" ON 3" AGGREGATE BASE COURSE, TYPE B FROM FULL DEPTH JOINT AT JONATHAN DRIVE TO FULL DEPTH JOINT AT VAN STREET.
4. THE CROSS-SLOPE OF SIDEWALK SHALL NOT EXCEED 1.5%.
5. THE P.C.C. PAVEMENT 6" SHALL BE TIED TO THE EXISTING PAVEMENT AT BOTH JOINTS USING #6 X 30" EPOXY COATED REBARS EXTENDING 12" INTO THE NEW PAVEMENT. THE BARS SHALL BE DRILLED AND EPOXY GROUTED INTO THE EXISTING PAVEMENT, 24" O.C.
6. ALL PCC PAVEMENT CONSTRUCTION JOINTS BOTH LONGITUDINAL AND TRANSVERSE TO BE TIED WITH #6 X 30" EPOXY COATED BARS AT 24" CTS. WITH KEYWAY.
7. SAWED CONTRACTION JOINT SPACING SHALL BE AT 12.5 FT MAX. DOWEL BARS WILL NOT BE REQUIRED AT SAWED CONTRACTION JOINTS.
8. CONTRACTOR TO RE-SEED ALL DISTURBED AREAS WITHIN CITY OF OLNEY R.O.W.
9. ALL SAW JOINTS SHALL BE SEALED WITH HOT POURED JOINT SEALER. SEE SPECIAL PROVISIONS.
10. THE FOLLOWING ITEMS SHALL CONFORM TO, OR BE CONSTRUCTED ACCORDING TO THE STANDARDS SHOWN.

ITEM	STANDARD
P.C.C. SIDEWALK	424001-07
P.C.C. PAVEMENT	BLR 14-10
TRAFFIC CONTROL	701006-05
	701201-04
	701301-04
	701501-06
	701801-05
	701901-03

B.M. I.T. STA. 43+53
EXISTING CENTERLINE OF JONATHAN DR. AT WEST PROP. JOINT
ELEV. 490.57

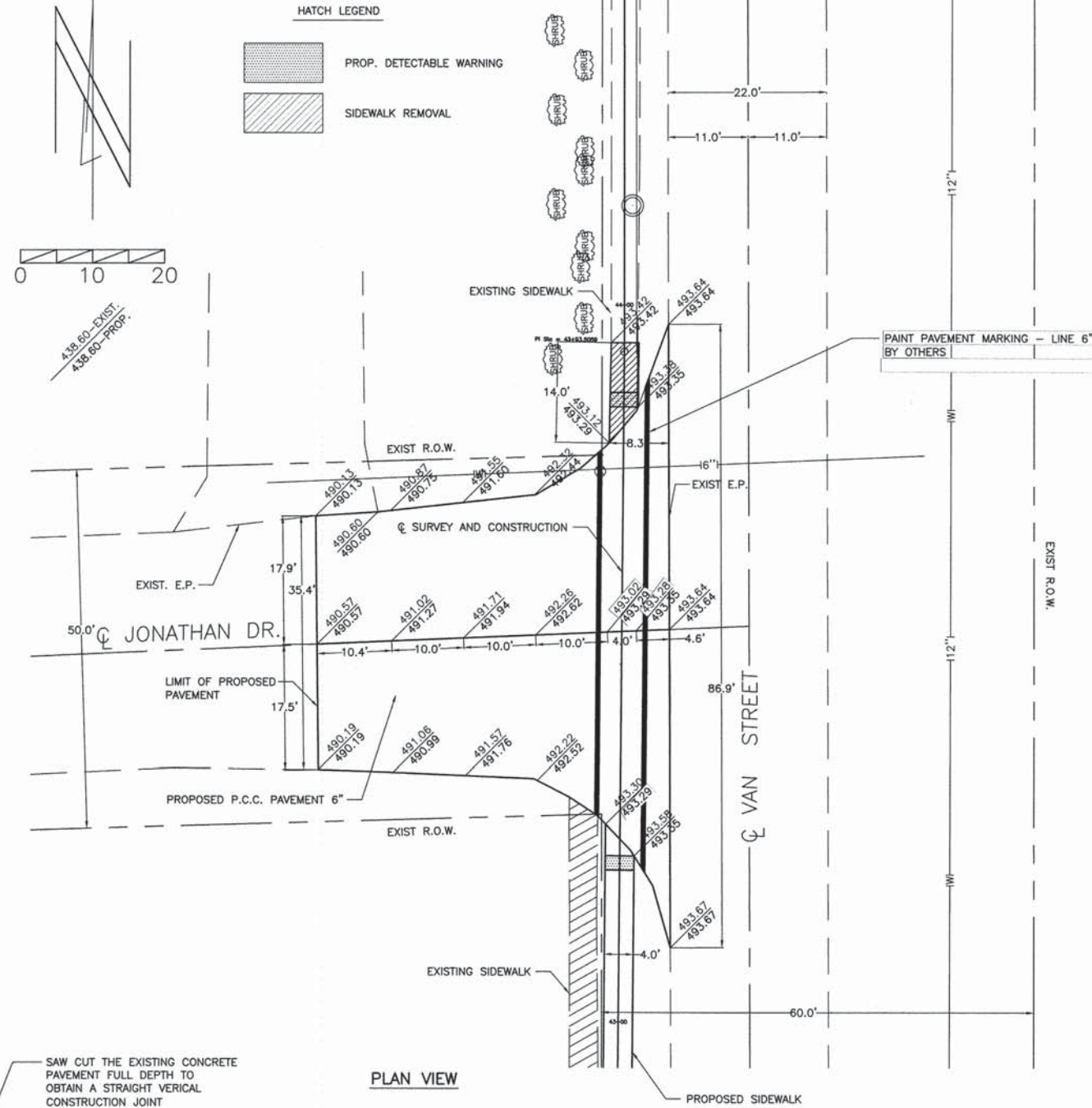

PLAN VIEW

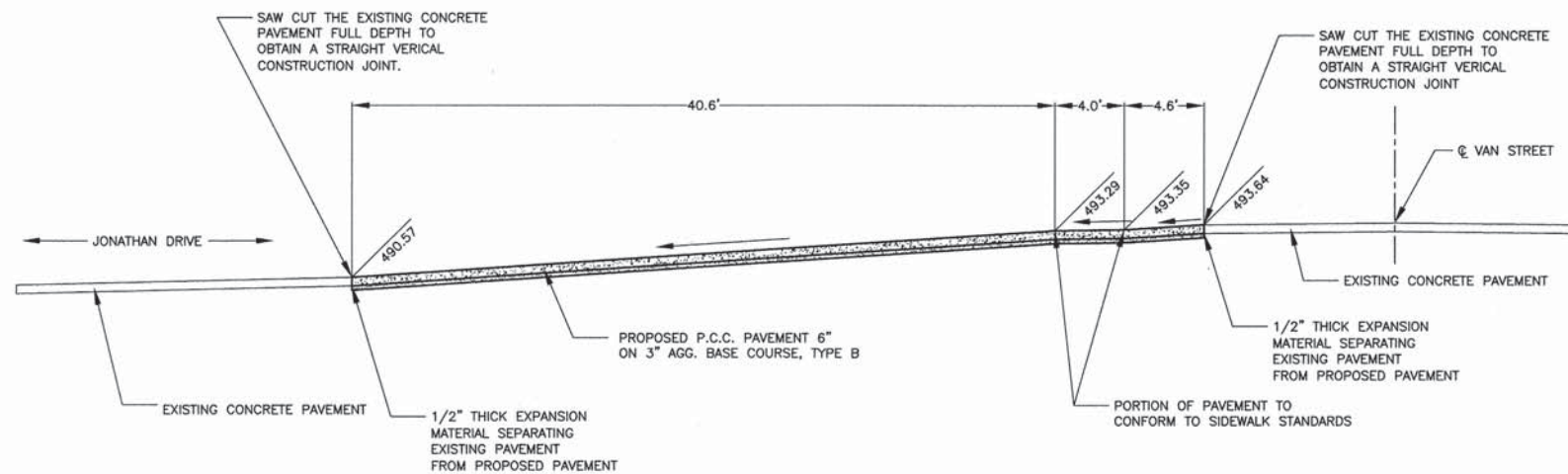

CENTERLINE PROFILE

SCALE: 1" = 5'

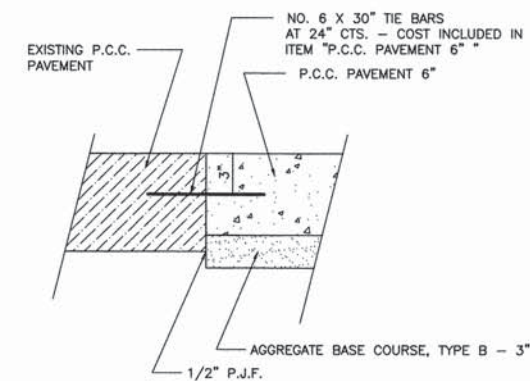

ROADWAY TRANSITION DETAILS

BOTH FULL-DEPTH TRANSVERSE JOINTS

CHARLESTON ENGINEERING, INC.
CONSULTING ENGINEERS
105 NORTH KITCHELL
P.O. BOX 397
OLNEY, ILLINOIS 62450
(618) 352-0739
ILLINOIS DEPARTMENT OF PROFESSIONAL REGULATION REGISTRATION #184.003513

INTERSECTION DETAIL 2
VAN ST. AND JONATHAN DR.

SECTION 12-00081-00-SW
CITY OF OLNEY

TV

ROUTE	SECTION	CITY	TOTAL SHEETS	SHEET NO.
SAFE ROUTES TO SCHOOL	12-00081-00-SW	OLNEY	21	16
CONTRACT NO. 95733		ILLINOIS	PROJECT SRTS-4009(281)	

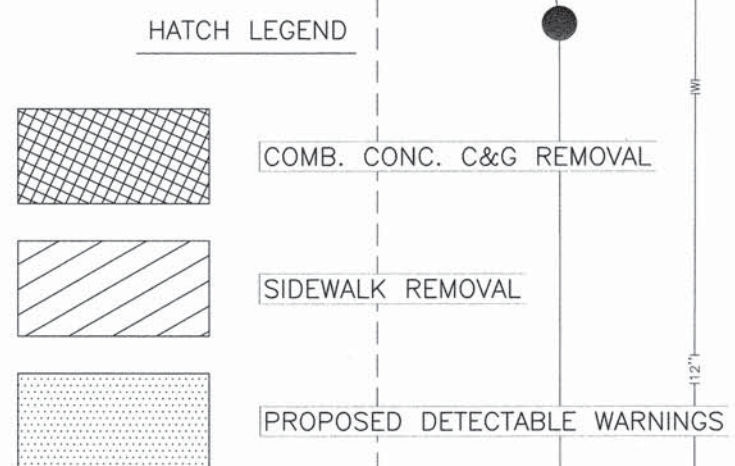
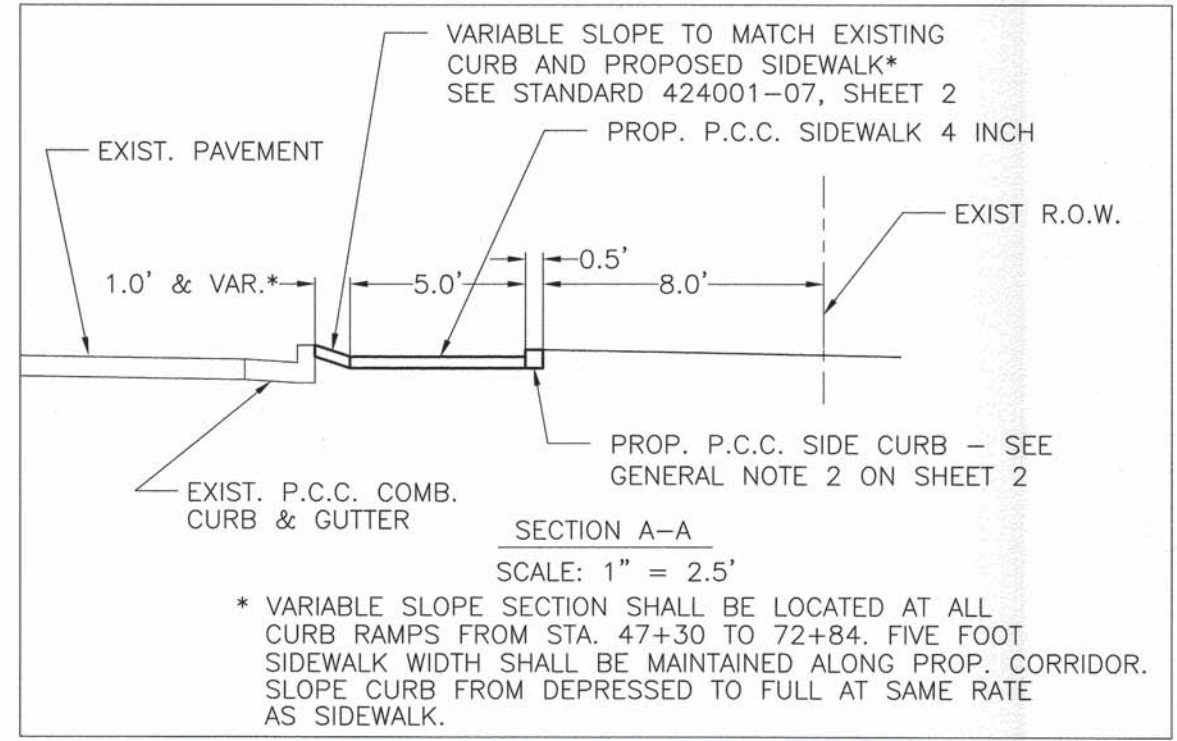
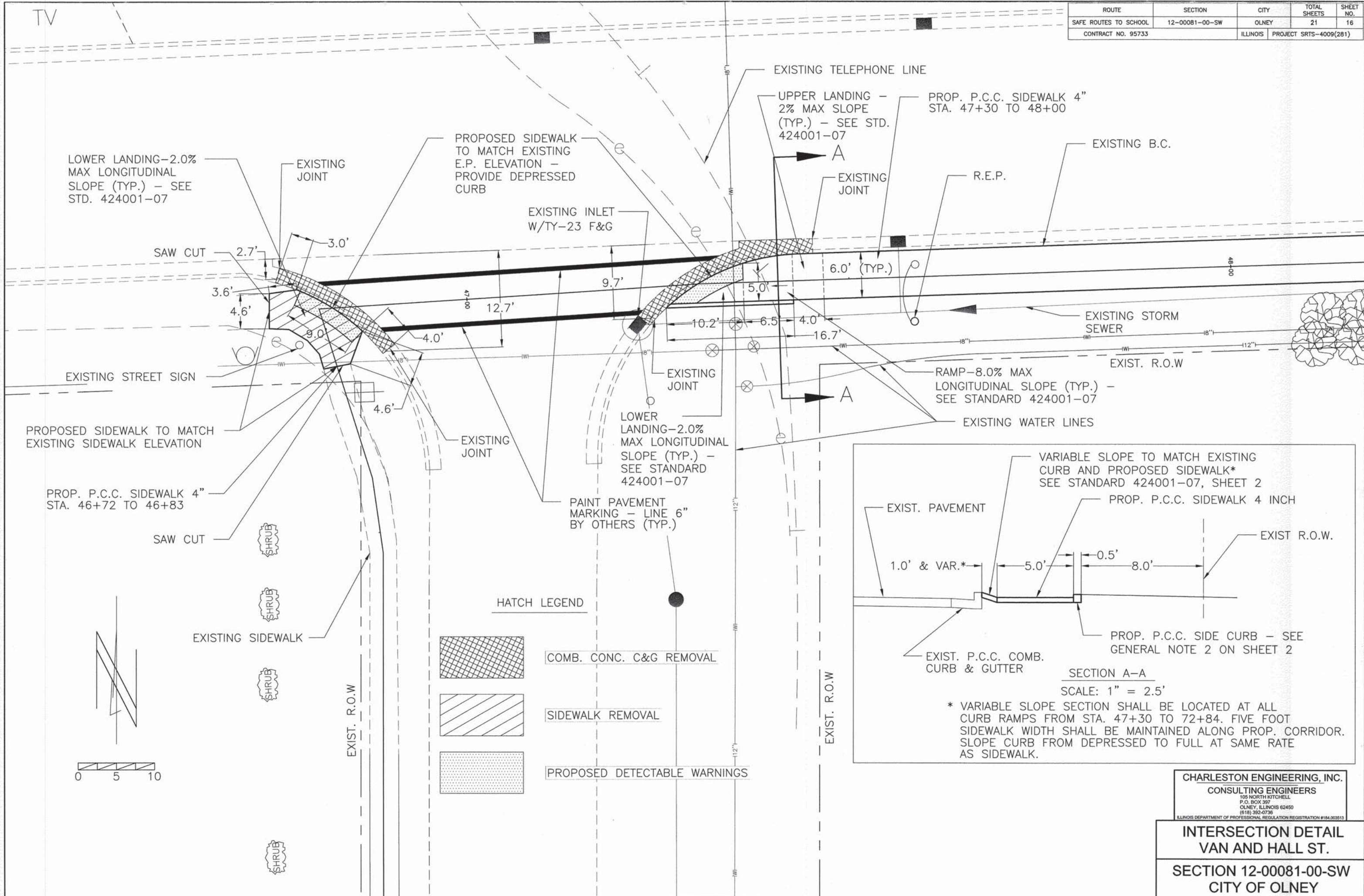



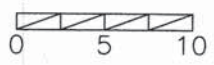
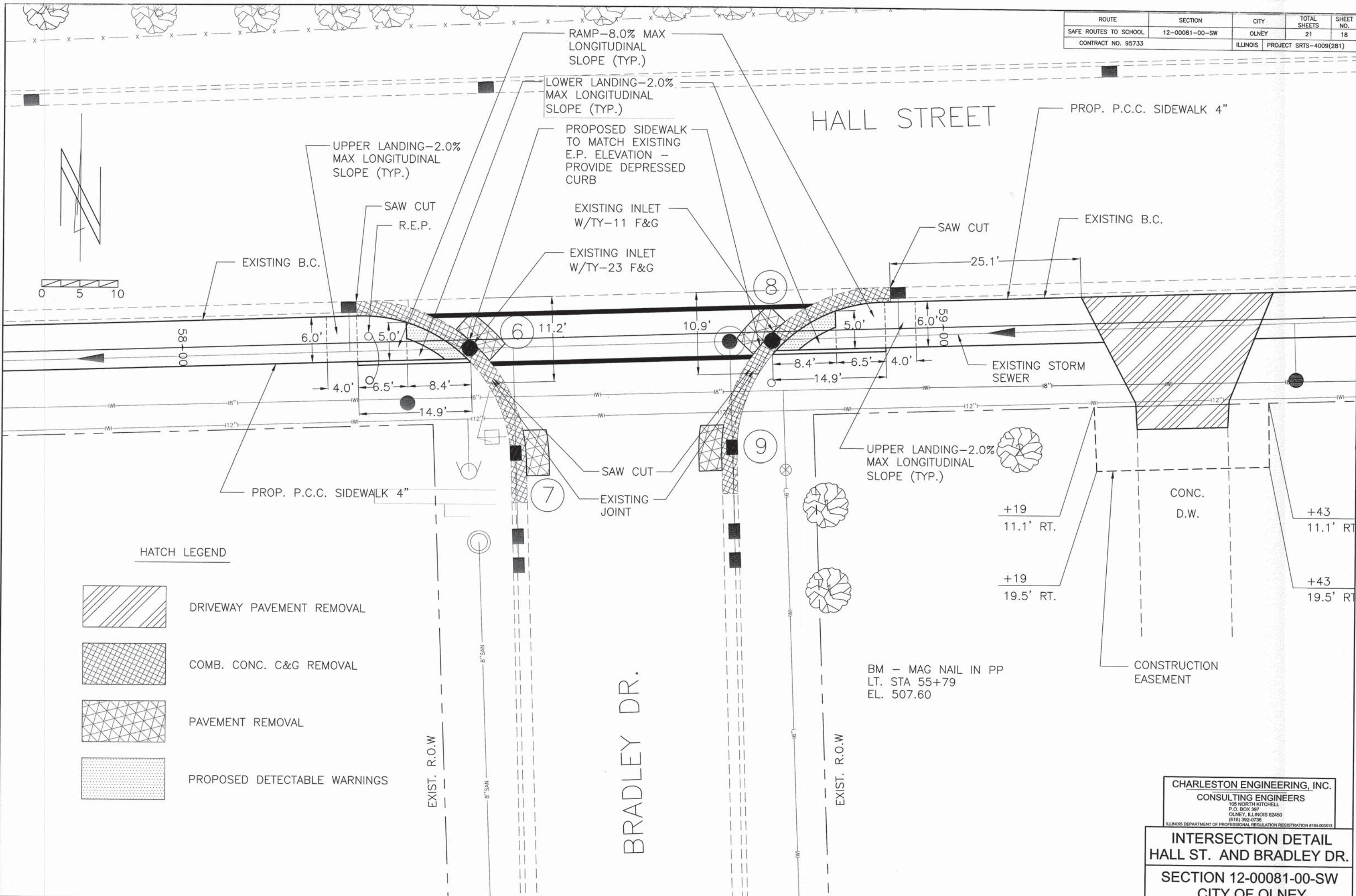

CHARLESTON ENGINEERING, INC.
 CONSULTING ENGINEERS
 105 NORTH KITCHELL
 P.O. BOX 397
 OLNEY, ILLINOIS 62450
 (618) 382-0736
ILLINOIS DEPARTMENT OF PROFESSIONAL REGULATION REGISTRATION #184.003513

**INTERSECTION DETAIL
 VAN AND HALL ST.
 SECTION 12-00081-00-SW
 CITY OF OLNEY**

ROUTE	SECTION	CITY	TOTAL SHEETS	SHEET NO.
SAFE ROUTES TO SCHOOL	12-00081-00-SW	OLNEY	21	18
CONTRACT NO. 95733		ILLINOIS	PROJECT SRTS-4009(281)	



HATCH LEGEND

-  DRIVEWAY PAVEMENT REMOVAL
-  COMB. CONC. C&G REMOVAL
-  PAVEMENT REMOVAL
-  PROPOSED DETECTABLE WARNINGS

CHARLESTON ENGINEERING, INC.
CONSULTING ENGINEERS
165 NORTH KITCHELL
P.O. BOX 397
OLNEY, ILLINOIS 62450
(618) 352-0736
ILLINOIS DEPARTMENT OF PROFESSIONAL REGULATION REGISTRATION #184.002513

INTERSECTION DETAIL
HALL ST. AND BRADLEY DR.
SECTION 12-00081-00-SW
CITY OF OLNEY

ROUTE	SECTION	CITY	TOTAL SHEETS	SHEET NO.
SAFE ROUTES TO SCHOOL	12-00081-00-SW	OLNEY	21	20
CONTRACT NO. 95733		ILLINOIS	PROJECT SRTS-4009(281)	

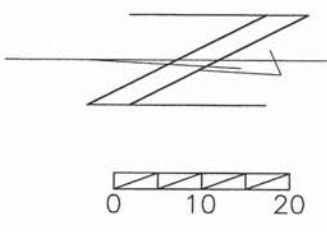
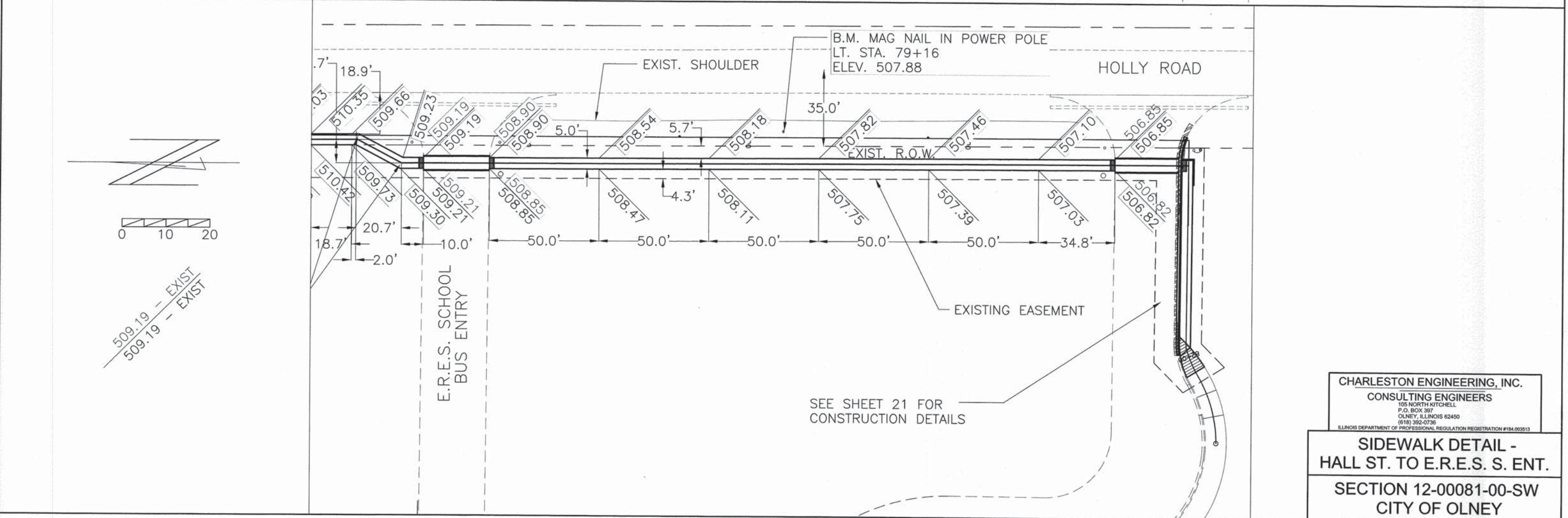
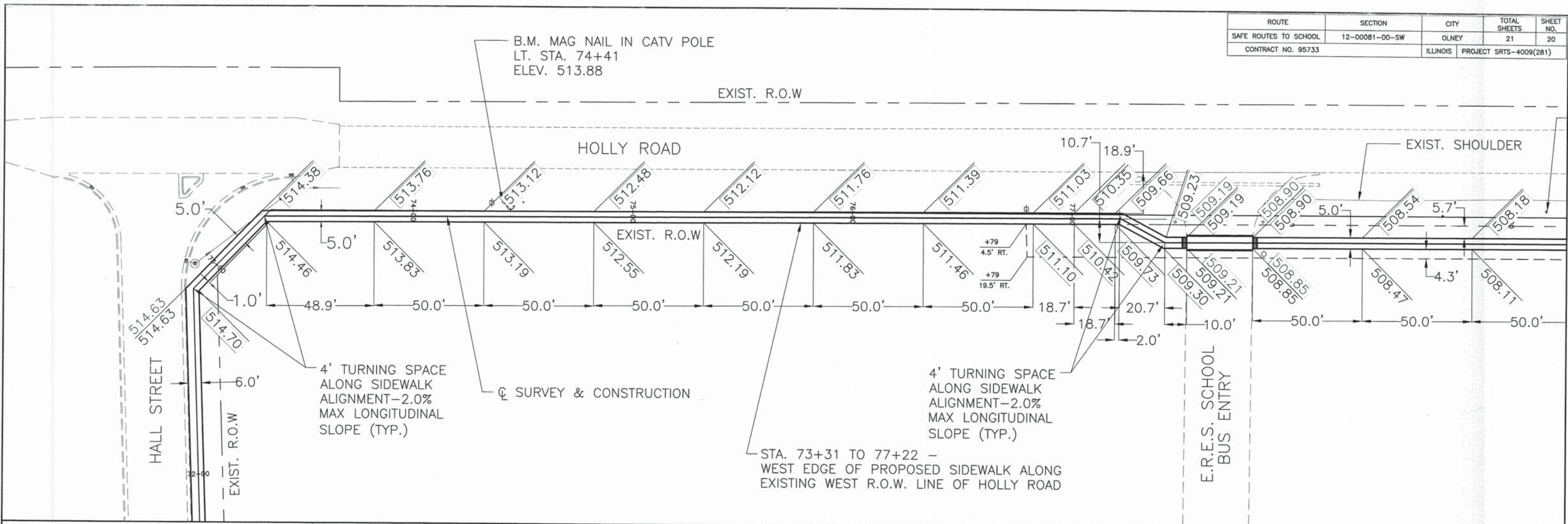

509.19 - EXIST
509.19 - EXIST

CHARLESTON ENGINEERING, INC.
CONSULTING ENGINEERS
105 NORTH KITCHELL
P.O. BOX 387
OLNEY, ILLINOIS 62450
(618) 392-0739
ILLINOIS DEPARTMENT OF PROFESSIONAL REGULATION REGISTRATION #184.003513

**SIDEWALK DETAIL -
HALL ST. TO E.R.E.S. S. ENT.**
**SECTION 12-00081-00-SW
CITY OF OLNEY**

ROUTE	SECTION	CITY	TOTAL SHEETS	SHEET NO.
SAFE ROUTES TO SCHOOL	12-00081-00-SW	OLNEY	21	21
CONTRACT NO. 95733		ILLINOIS	PROJECT SRTS-4009(281)	

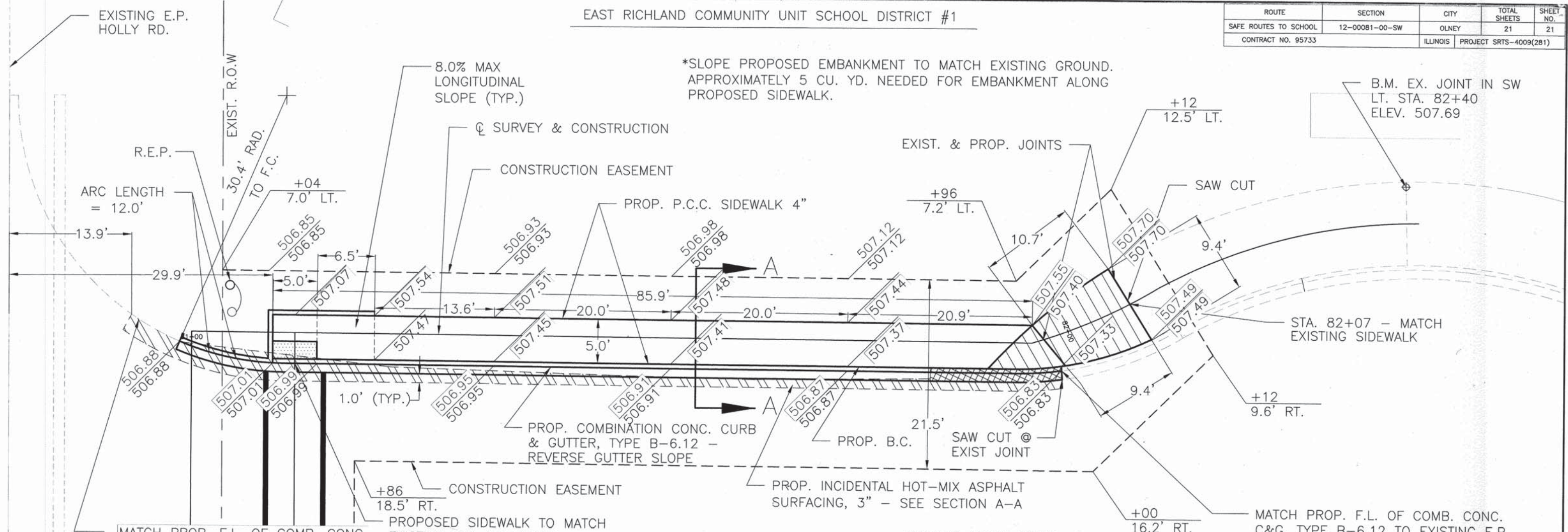

E.R.E.S. SCHOOL
BUS EXIT

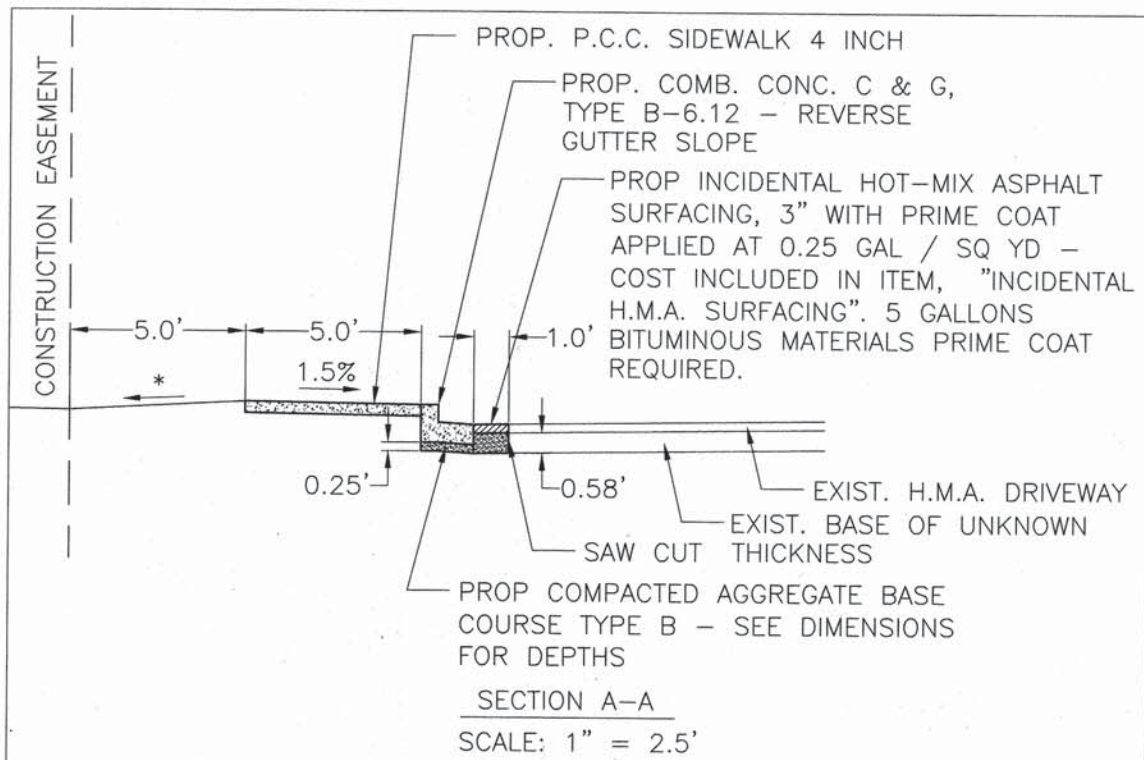
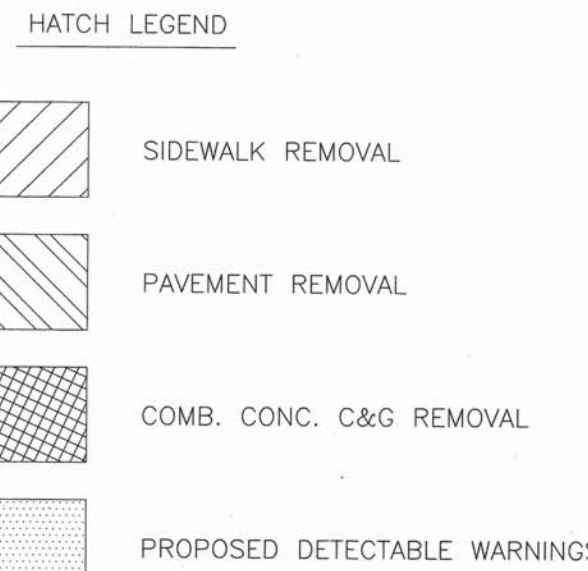

0 5 10

CHARLESTON ENGINEERING, INC.
CONSULTING ENGINEERS
105 NORTH KITCHELL
P.O. BOX 397
OLNEY, ILLINOIS 62450
(618) 382-0738
ILLINOIS DEPARTMENT OF PROFESSIONAL REGULATION REGISTRATION #184.003513

**ENTRANCE DETAIL -
E.R.E.S. EAST ENTRANCE**

**SECTION 12-00081-00-SW
CITY OF OLNEY**