

03-06-2020 LETTING ITEM 008

STATE OF ILLINOIS
DEPARTMENT OF TRANSPORTATION

F.A.U. RTE.	SECTION	COUNTY	TOTAL SHEETS	SHEET NO.
2332	19-00007-00-RS	KANE	17	1
FED. ROAD DIST. NO 1		CONTRACT NO. 61G17		

FOR INDEX OF SHEETS, SEE SHEET NO. 2
FOR LIST OF HIGHWAY STANDARDS SEE SHEET NO. 2

TRAFFIC DATA

ADT: BOLCUM ROAD 2018 TRAFFIC 5,450 VPD

ROADWAY	SPEED POSTED	DESIGN SPEED
BOLCUM ROAD	50 MPH	50 MPH

DESIGN DESIGNATION

FAU 2332 (BOLCUM ROAD) - MINOR ARTERIAL

PLANS FOR PROPOSED FEDERAL AID HIGHWAY

FAU 2332 (BOLCUM ROAD)
FROM BURLINGTON ROAD (FAU 2301) TO FAIRWAY DRIVE AT VILLAGE LIMITS
RESURFACING

SECTION NO: 19-00007-00-RS
PROJECT NO: DWFE(883)
VILLAGE OF CAMPTON HILLS
KANE COUNTY
C-91-055-20

PROJECT LOCATION MAP
N.T.S.



LOCATION OF SECTION INDICATED THUS: -

J.U.L.I.E.
JOINT
UTILITY
LOCATION
INFORMATION FOR
EXCAVATION
CALL 811



Know what's below.
Call before you dig.



FULL SIZE PLANS HAVE BEEN PREPARED USING STANDARD ENGINEERING SCALES. REDUCED SIZED PLANS WILL NOT CONFORM TO STANDARD SCALES. IN MAKING MEASUREMENTS ON REDUCED PLANS, THE ABOVE SCALES MAY BE USED.

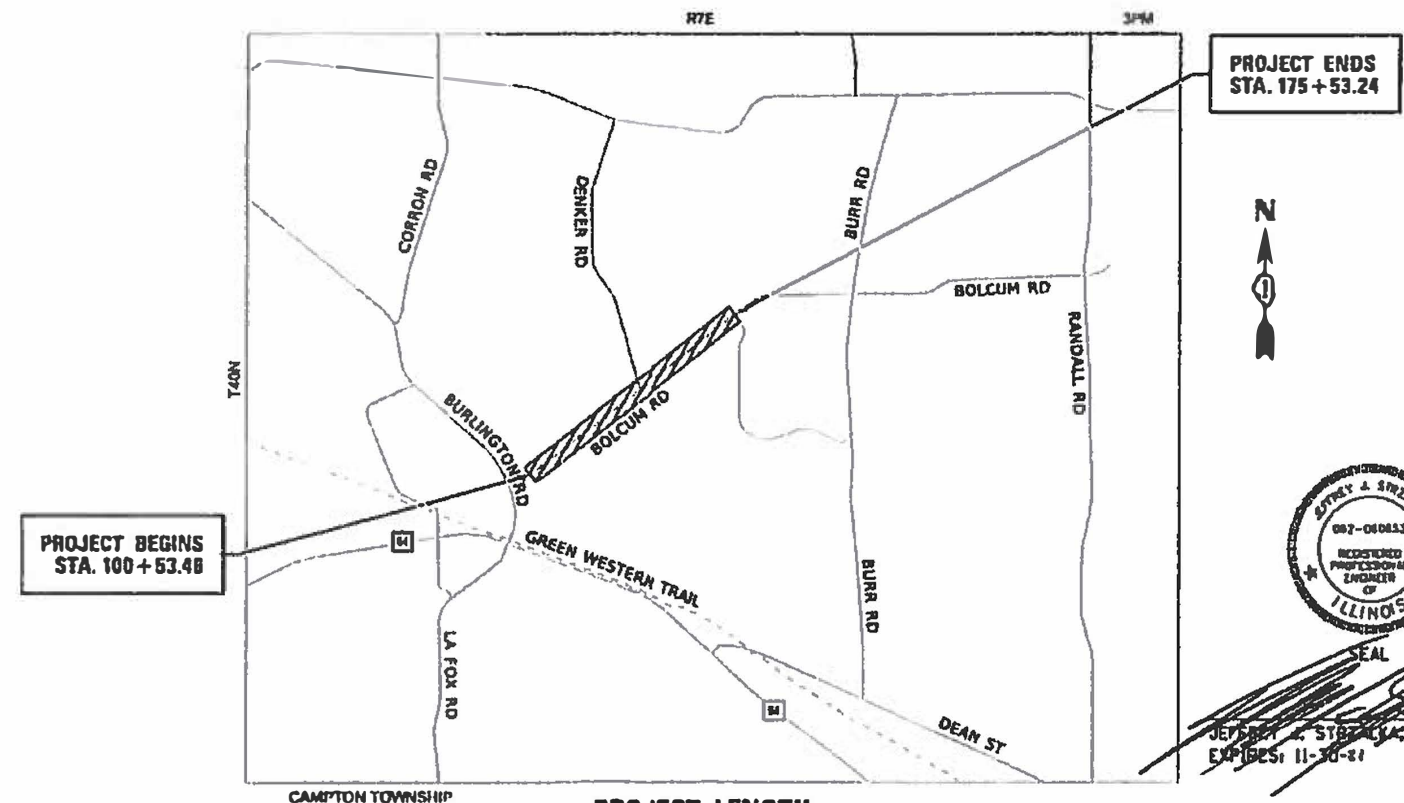

JEFFREY A. STRZALKA, P.E.
EXPIRES: 11-30-21

FEDERAL AID PROGRAM ENGINEER: CARMEN E. RAMOS, P.E. SCHAUMBURG, IL (847) 705-4021

PROJECT ENGINEER: J. STRZALKA
PROJECT MANAGER: S. MARQUARDT
CONTRACT NO. 61G17

PROJECT LENGTH
NET AND GROSS LENGTH OF PROJECT = 7,499.8 FT. = 1.42 MILES



HRGreen
420 NORTH FRONT STREET, SUITE 100 | McHENRY, ILLINOIS 60050
Phone: 815.385.1778 | Toll Free: 800.728.7805 | Fax: 815.385.1781 | HRGreen.com
ILLINOIS PROFESSIONAL DESIGN FIRM #184-001322

STATE OF ILLINOIS
DEPARTMENT OF TRANSPORTATION

APPROVED *[Signature]* OCT 21 2019
VILLAGE OF CAMPTON HILLS

PASSED *[Signature]* NOV 12 2019
DISTRICT ONE ENGINEER OF LOCAL ROADS AND STREETS

RELEASING FOR BID
BASED ON LIMITED REVIEW *[Signature]* NOVEMBER 12 2019
REGIONAL ENGINEER

PRINTED BY THE AUTHORITY
OF THE STATE OF ILLINOIS

INDEX OF SHEETS

1	COVER SHEET
2	INDEX OF SHEETS, STATE STANDARDS, DISTRICT ONE DETAILS & GENERAL NOTES
3 - 5	SUMMARY OF QUANTITIES
6	TYPICAL SECTIONS
7 - 9	RESURFACING PLANS
10 - 16	IDOT DISTRICT 1 DETAILS
17	CONSTRUCTION DETAILS

DISTRICT ONE DETAILS

STANDARD NO.	LIST OF DESCRIPTION
BD-22	PAVEMENT PATCHING FOR HMA SURFACED PAVEMENT
BD-24	CURB OR CURB AND GUTTER REMOVAL AND REPLACEMENT
BD-32	BUTT JOINT AND HMA TAPER DETAILS
TC-10	TRAFFIC CONTROL AND PROTECTION FOR SIDE ROADS, INTERSECTIONS AND DRIVEWAYS
TC-13	DISTRICT ONE TYPICAL PAVEMENT MARKINGS
TC-16	SHORT TERM PAVEMENT MARKING LETTERS AND SYMBOLS
TC-22	ARTERIAL ROAD INFORMATION SIGN

STATE STANDARDS

STANDARD NO.	LIST OF DESCRIPTION
000001-07	STANDARD SYMBOLS, ABBREVIATIONS AND PATTERNS
442201-03	CLASS C AND D PATCHES
482011-03	HMA SHOULDER STRIPS/SHOULDERS WITH RESURFACING OR WIDENING & RESURFACING PROJECTS
606001-07	CONCRETE CURB TYPE BAND COMBINATION CONCRETE CURB AND GUTTER
701006-05	OFF-RD OPERATIONS, 2L, 2W, 15' TO 24" FROM PAVEMENT EDGE
701201-05	LANE CLOSURE, 2L, 2W, DAY ONLY, FOR SPEEDS ≥ 45 MPH
701301-04	LANE CLOSURE, 2L, 2W, SHORT TIME OPERATIONS
701306-04	LANE CLOSURE, 2L, 2W, SLOW MOVING OPERATIONS DAY ONLY, FOR SPEEDS ≥ 45 MPH
701311-03	LANE CLOSURE, 2L, 2W, MOVING OPERATIONS-DAY ONLY
701336-07	LANE CLOSURE, 2L, 2W, WORK AREAS IN SERIES, FOR SPEEDS ≥ 45 MPH
701501-06	URBAN LANE CLOSURE, 2L, 2W, UNDIVIDED
701701-10	URBAN LANE CLOSURE, MULTILANE INTERSECTION
701901-08	TRAFFIC CONTROL DEVICES
BLR 24-2	MAILBOX TURNOUT FOR LOCAL ROADS

GENERAL NOTES

- ALL REFERENCES TO "STANDARD SPECIFICATIONS" IN THESE GENERAL NOTES SHALL BE INTERPRETED TO MEAN "STANDARD SPECIFICATIONS FOR ROAD AND BRIDGE CONSTRUCTION" ADOPTED BY THE ILLINOIS DEPARTMENT OF TRANSPORTATION, APRIL 1, 2016. ALL WORK TO BE COMPLETED IN ACCORDANCE WITH THE STANDARD SPECIFICATIONS.
- ALL REFERENCES TO "ENGINEER" SHALL BE INTERPRETED TO MEAN THE RESIDENT ENGINEER.
- IT IS THE CONTRACTOR'S RESPONSIBILITY TO ASCERTAIN EXISTING FIELD CONDITIONS PRIOR TO BIDDING ON THE PROJECT.
- BEFORE STARTING ANY EXCAVATION, THE CONTRACTOR SHALL CALL "JULIE" (JOINT UTILITY LOCATION INFORMATION FOR EXCAVATION) AT (800) 892-0123 FOR FIELD LOCATIONS OF BURIED UTILITIES (48 HOURS NOTIFICATION IS REQUIRED).
- SAW CUTTING OF PAVEMENTS, CURB, ETC. SHALL BE TO FULL DEPTH AND SHALL RESULT IN A CLEAN STRAIGHT EDGE ON THE PORTION REMAINING.
- THE CONTRACTOR SHALL BE RESPONSIBLE FOR SWEEPING AND CLEANING STREETS OF ANY DEBRIS AND MATERIAL THAT HAS ACCUMULATED AS A RESULT OF THE CONSTRUCTION ACTIVITY. A MECHANICAL SWEEPER, MECHANICALLY DRIVEN AIR AND HANDWORK WITH SHOVEL AND BROOM SHALL BE UTILIZED TO PROVIDE A CLEAN STREET FOR THE MOTORING PUBLIC. WITHIN 24 HOURS OF PLACING TACK COAT AND THE LAYING OF HMA, THE CONTRACTOR SHALL SWEEP THE PAVEMENT AND REMOVE STANDING WATER, EARTH, WEEDS, LEAVES, DIRT, CONSTRUCTION DEBRIS, AND ALL LOOSE MATERIAL.
- EXISTING AGGREGATE DRIVEWAYS WILL RECEIVE A TWENTY-FOUR INCH (24") WIDE ASPHALT APRON MATCHING THE PROPOSED SURFACE COURSE RESURFACING LIFT THICKNESS. THE DRIVEWAY APRON WILL BE CONSTRUCTED IN CONJUNCTION WITH MAINLINE PAVING.
- EXISTING ASPHALT DRIVEWAYS WILL RECEIVE A FORTY-EIGHT (48") WIDE ASPHALT APRON MATCHING THE PROPOSED RESURFACING LIFT THICKNESS. THE DRIVEWAY APRON WILL BE CONSTRUCTED IN CONJUNCTION WITH THE MAINLINE PAVING. THE EXISTING DRIVEWAY APRON WILL BE SAWCUT AND MILLED FOR A SATISFACTORY TRANSITION BETWEEN THE ROADWAY PAVEMENT AND THE DRIVEWAY PAVEMENT REMAINING AT EXISTING GRADE. WHEN THE TRANSITION IS FORTY-EIGHT INCHES (48") OR LESS FROM THE EDGE OF PAVEMENT, THE REMOVAL WILL BE CONSTRUCTED IN CONJUNCTION WITH MAINLINE MILLING OPERATIONS. HOT-MIX ASPHALT DRIVEWAY APRONS EXCEEDING FORTY-EIGHT INCHES (48") FROM THE EDGE OF PAVEMENT TO THE SAW CUT WILL BE MEASURED FOR PAYMENT IN ACCORDANCE WITH THE CONSTRUCTION DETAILS.
- THE CONTRACTOR SHALL MAINTAIN ACCESS TO PRIVATE ENTRANCES ALONG THE LIMITS OF CONSTRUCTION, UNLESS OTHERWISE NOTED.

- THE CONTRACTOR SHALL BE RESPONSIBLE FOR POSTING "FRESH OIL" SIGNS (48"x48" MINIMUM) AS NEEDED FOR THE PROJECT. THE CONTRACTOR SHALL INSTALL AND MAINTAIN TEMPORARY SIGNS IN THE PARKWAY TWENTY-FOUR (24) HOURS PRIOR TO STARTING WORK ON EACH STREET. THE SIGNS SHALL READ "FRESH OIL, TRAVEL AT YOUR OWN RISK." THE CONTRACTOR SHALL REMOVE THE SIGNS AND REINSTALL THEM AS NEEDED.
- IN ACCORDANCE WITH THE IDOT DROP OFF POLICY AT INSTANCES IN WHICH THERE IS A GREATER THAN 1.5 INCH HEIGHT DIFFERENCE IN VERTICAL MILLED FACE, OR WHEN THERE IS A GREATER THAN 2.5 INCH LIFT DIFFERENCE, UNEVEN LANE SIGNS (W8-11(0)) WILL BE REQUIRED.

UTILITIES

- THE CONTRACTOR SHALL BE RESPONSIBLE FOR CONTACTING THE OWNERS OF ALL UTILITIES PRIOR TO CONSTRUCTION TO DETERMINE THE LOCATION OF ALL UTILITY EQUIPMENT. THE CONTRACTOR SHALL COOPERATE WITH ALL UTILITY OWNERS IN ACCORDANCE WITH THE STANDARD SPECIFICATIONS IF UTILITY RELOCATION, ADJUSTMENT, OR PROTECTION IS NECESSARY.
- THE LOCATION OF EXISTING DRAINAGE STRUCTURES, STORM SEWERS, WATER MAINS, SANITARY SEWERS, AND ANY OTHER PUBLIC OR PRIVATE UTILITIES AS SHOWN ON THE PLANS IS APPROXIMATE AND THEIR EXACT LOCATION IS TO BE DETERMINED IN THE FIELD BY THE CONTRACTOR.
- THE CONTRACTOR SHALL BE RESPONSIBLE FOR THE PROTECTION OF ALL UNDERGROUND AND SURFACE UTILITIES EVEN THOUGH THEY MIGHT NOT BE SHOWN ON THE PLANS. ANY UTILITY PROPERTY DAMAGED DURING CONSTRUCTION SHALL BE REPAIRED OR REPLACED TO THE SATISFACTION OF THE OWNER.
- ALL UTILITY COMPANIES AND THE VILLAGE OF CAMPTON HILLS SHALL BE NOTIFIED AT LEAST 3 DAYS PRIOR TO THE START OF CONSTRUCTION.
- THE CONTRACTOR SHALL USE ALL NECESSARY PRECAUTIONS AND PROTECTION MEASURES REQUIRED TO MAINTAIN EXISTING UTILITIES, SEWERS, AND APPURTENANCES THAT MUST BE KEPT IN OPERATION.
- ANY LOOSE MATERIAL DEPOSITED IN THE FLOWLINE OF DRAINAGE STRUCTURES, WHICH OBSTRUCTS THE NATURAL FLOW OF WATER SHALL BE REMOVED AT THE CLOSE OF EACH WORKING DAY. PRIOR TO ACCEPTANCE OF THE IMPROVEMENT, ALL DRAINAGE STRUCTURES SHALL BE FREE OF DIRT AND DEBRIS.
- THE INDISCRIMINATE USE OF FIRE HYDRANTS OR EXISTING STREAMS, CREEKS, WETLANDS OR PONDS IS STRICTLY PROHIBITED. THE CONTRACTOR SHALL PROVIDE A WATER TRUCK AND DRIVER AS REQUIRED TO OBTAIN AND TRANSPORT THIS WATER. THE CONTRACTOR SHALL BE RESPONSIBLE FOR OBTAINING THIS WATER FROM AN APPROVED SOURCE. IF THIS WATER IS FROM A SOURCE OTHER THAN HIS YARD, WRITTEN APPROVAL FROM THE AGENCY HAVING JURISDICTION FOR THE SOURCE OF THE WATER MUST BE RECEIVED BY THE ENGINEER PRIOR TO USE OF THE WATER.

SIGNING AND STRIPING

- SIGNS SHALL NOT BE MOVED OR COVERED UNTIL PROGRESS OF WORK NECESSITATES IT.
- IN ACCORDANCE WITH ARTICLE 107.25, THE CONTRACTOR WILL BE REQUIRED TO TEMPORARILY RESET ALL SUCH SIGNS THAT INTERFERE WITH HIS CONSTRUCTION OPERATIONS. ALL SUCH SIGNS MUST BE MAINTAINED STRAIGHT AND CLEAN FOR THE DURATION OF THE TEMPORARY SETTING AND MUST BE RE-ERECTED AT A TEMPORARY LOCATION IN A WORKMANLIKE MANNER AND BE VISIBLE TO THE TRAFFIC FOR WHICH IT IS INTENDED.
- GRINDING OF PAVEMENT MARKINGS ON NEWLY CONSTRUCTED HOT-MIX ASPHALT PAVEMENT WILL NOT BE PERMITTED.

HRG PROJECT NO.: 16154
 HRG PROJ. CONTACT:
 FILE: 16154-001-001.dwg
 PEN: TABLE: 16154.tbl



USER NAME = jstrzal	DESIGNED - JJS	REVISED - XX/XX/XXXX
	DRAWN - DMS	REVISED - XX/XX/XXXX
PLOT SCALE =	CHECKED -	REVISED - XX/XX/XXXX
PLOT DATE = 11/13/2019	DATE -	REVISED - XX/XX/XXXX

**STATE OF ILLINOIS
 DEPARTMENT OF TRANSPORTATION**

INDEX OF SHEETS, STATE STANDARDS, DISTRICT DETAILS & GENERAL NOTES		F.A.U. RTE.	SECTION NO.	COUNTY	TOTAL SHEETS	SHEET NO.
		2332	19-00007-00-R5	KANE	17	2
SCALE: N.T.S.		SHEET 1 OF 1 SHEETS		STA.	TO STA.	
		FED. ROAD DIST. NO.		ILLINOIS FED. AID PROJECT		CONTRACT NO. 61G17

CODE NO.	ITEM	UNIT	TOTAL QUANTITY	CONSTRUCTION CODE
				STU 75% FED/25% LOCAL 0005
40600290	BITUMINOUS MATERIALS (TACK COAT)	POUND	18,750	18,750
40600400	MIXTURE FOR CRACKS, JOINTS, AND FLANGEWAYS	TON	42	42
40600982	HOT-MIX ASPHALT SURFACE REMOVAL - BUTT JOINT	SQ YD	250	250
40603080	HOT-MIX ASPHALT BINDER COURSE, 1L-19.0, N50	TON	3,520	3,520
40604060	HOT-MIX ASPHALT SURFACE COURSE, MIX "D", 1L-9.5, N50	TON	2,395	2,395
* 40800050	INCIDENTAL HOT-MIX ASPHALT SURFACING	TON	30	30
44000163	HOT-MIX ASPHALT SURFACE REMOVAL, 3 1/2"	SQ YD	27,778	27,778
44201725	CLASS D PATCHES, TYPE I, 7 INCH	SQ YD	350	350
44201729	CLASS D PATCHES, TYPE II, 7 INCH	SQ YD	350	350
44201733	CLASS D PATCHES, TYPE III, 7 INCH	SQ YD	350	350
44201735	CLASS D PATCHES, TYPE IV, 7 INCH	SQ YD	350	350
48101200	AGGREGATE SHOULDERS, TYPE B	TON	570	570
67100100	MOBILIZATION	L SUM	1	1
70100450	TRAFFIC CONTROL AND PROTECTION, STANDARD 701201	L SUM	1	1
70100460	TRAFFIC CONTROL AND PROTECTION, STANDARD 701306	L SUM	1	1
70100600	TRAFFIC CONTROL AND PROTECTION, STANDARD 701336	L SUM	1	1

* SPECIAL PROVISION
+ SPECIALTY ITEM

HRG PROJECT NO: 18534
 FILE NAME: 18534.dwg
 PLOT DRIVER: L:pdf, l:hpcltcf9
 PEN TABLE: plot00a.tbl



HRGreen.com
 Illinois Professional Design Firm
 #194-001322

USER NAME = jstrzel	DESIGNED - JJS	REVISED -
PLDT SCALE =	DRAWN - DMS	REVISED -
PLDT DATE = 11/13/2019	CHECKED -	REVISED -
	DATE -	REVISED -

STATE OF ILLINOIS
DEPARTMENT OF TRANSPORTATION

BOLCUM ROAD SUMMARY OF QUANTITIES		
SCALE: N.T.S.	SHEET 1 OF 3 SHEETS STA.	TO STA.

F.A.J. RTE.	SECTION NO.	COUNTY	TOTAL SHEETS	SHEET NO.
2332	19-00007-00-RS	KANE	17	3
FED. ROAD DIST. NO. [ILLINOIS] FED. AID PROJECT				
CONTRACT NO. 61G17				

CODE NO.	ITEM	UNIT	TOTAL QUANTITY	CONSTRUCTION CODE	
				75% FED/25% LOCAL 0005	STU
70102620	TRAFFIC CONTROL AND PROTECTION, STANDARD 701501	L SUM	1	1	
70102635	TRAFFIC CONTROL AND PROTECTION, STANDARD 701701	L SUM	1	1	
70300100	SHORT TERM PAVEMENT MARKING	FOOT	5,980.0	5,980.0	
70300150	SHORT TERM PAVEMENT MARKING REMOVAL	SQ FT	3,290	3,290	
* 70300520	PAVEMENT MARKING TAPE, TYPE III 4"	FOOT	1,140.0	1,140.0	
* 70300540	PAVEMENT MARKING TAPE, TYPE III 6"	FOOT	25.0	25.0	
* 70300560	PAVEMENT MARKING TAPE, TYPE III 12"	FOOT	95.0	95.0	
+ 78000100	THERMOPLASTIC PAVEMENT MARKING - LETTERS AND SYMBOLS	SQ FT	110.0	110.0	
+ 78000200	THERMOPLASTIC PAVEMENT MARKING - LINE 4"	FOOT	29,080.0	29,080.0	
+ 78000400	THERMOPLASTIC PAVEMENT MARKING - LINE 6"	FOOT	640.0	640.0	
+ 78000600	THERMOPLASTIC PAVEMENT MARKING - LINE 12"	FOOT	250.0	250.0	
+ 78000650	THERMOPLASTIC PAVEMENT MARKING - LINE 24"	FOOT	200.0	200.0	
* X0326806	WASHOUT BASIN	L SUM	1	1	
* X4400196	HOT-MIX ASPHALT SURFACE REMOVAL, SPECIAL	SQ YD	70	70	
* Z0004562	COMBINATION CONCRETE CURB AND GUTTER REMOVAL AND REPLACEMENT	FOOT	500.0	500.0	
* Z0013798	CONSTRUCTION LAYOUT	L SUM	1	1	

* SPECIAL PROVISION

+ SPECIALTY ITEM

HRG PROJECT NO. 191594
 FILE NAME: 191594-0001.dgn
 PLOT DRIVER: L:\soft\dwgplotf9
 PEN TABLE: plottbl.tbl



USER NAME = jstzeal	DESIGNED - JJS	REVISED -
	DRAWN - DMS	REVISED -
PLOT SCALE =	CHECKED -	REVISED -
PLOT DATE = 11/13/2019	DATE -	REVISED -

STATE OF ILLINOIS
DEPARTMENT OF TRANSPORTATION

BOLCUM ROAD
SUMMARY OF QUANTITIES

SCALE: N.T.S. SHEET 2 OF 3 SHEETS STA. TO STA.

F.A.U. RTE.	SECTION NO.	COUNTY	TOTAL SHEETS	SHEET NO.
2332	19-00007-00-RS	KANE	17	4
FED. ROAD DIST. NO.			ILLINOIS FED. AID PROJECT	
			CONTRACT NO. 61G17	

CODE NO.	ITEM	UNIT	TOTAL QUANTITY	CONSTRUCTION CODE
				STU 75% FED/25% LOCAL 0005
* Z0030850	TEMPORARY INFORMATION SIGNING	SQ FT	130	130
* Z0033700	LONGITUDINAL JOINT SEALANT	FOOT	9,630	9,630

* SPECIAL PROVISION

+ SPECIALTY ITEM

HRG PROJECT NO.: 18594
 HRG PROJ. CONTACT:
 FILE NAME: 18594-drt-000.dgn
 PLOT DATE: 11/13/2019
 PEN TABLE: plot000.tbl



USER NAME = jstrzel	DESIGNED - JJS	REVISED -
	DRAWN - DMS	REVISED -
PLDT SCALE =	CHECKED -	REVISED -
PLDT DATE = 11/13/2019	DATE -	REVISED -

STATE OF ILLINOIS
 DEPARTMENT OF TRANSPORTATION

BOLCUM ROAD
 SUMMARY OF QUANTITIES

SCALE: N.T.S. SHEET 3 OF 3 SHEETS STA. TO STA.

F.A.J. RTE.	SECTION NO.	COUNTY	TOTAL SHEETS	SHEET NO.
2332	19-00007-00-R5	KANE	17	5
FED. ROAD DIST. NO.			ILLINOIS FED. AID PROJECT	
			CONTRACT NO. 61G17	

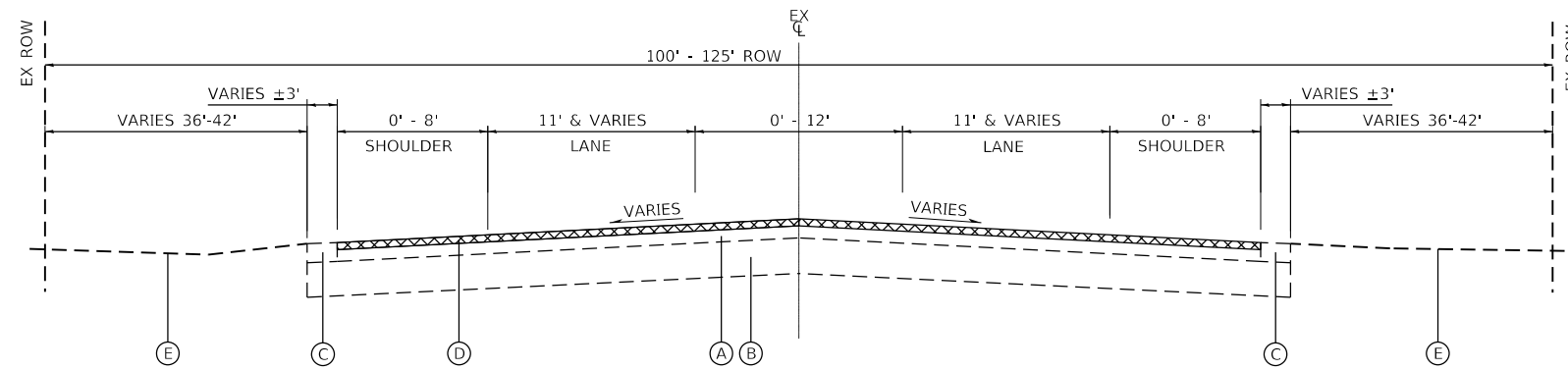

EXISTING TYPICAL SECTION
 BOLCUM ROAD
 STA. 100+53.46 TO STA. 175+53.24

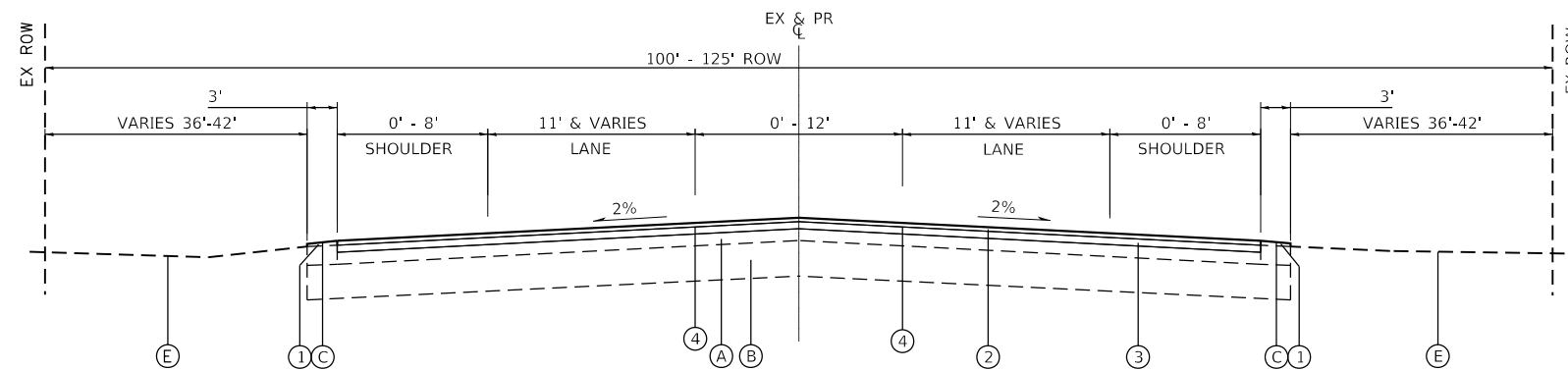

PROPOSED TYPICAL SECTION
 BOLCUM ROAD
 STA. 100+53.46 TO STA. 175+53.24

EXISTING LEGEND

- (A) EXISTING HOT-MIX ASPHALT PAVEMENT; ±10"-16"
- (B) EXISTING AGGREGATE BASE COURSE; ±8"
- (C) EXISTING AGGREGATE SHOULDER
- (D) HOT-MIX ASPHALT SURFACE REMOVAL, 3 1/2"
- (E) EXISTING GROUND

PROPOSED LEGEND

- (1) AGGREGATE SHOULDERS, TYPE B (9% MAX SLOPE) (CM-6 CRUSHED RECYCLED ASPHALT)
- (2) HOT-MIX ASPHALT SURFACE COURSE, MIX "D", IL-9.5, N50; 1 1/2"
- (3) HOT-MIX ASPHALT BINDER COURSE, IL-19.0, N50; 2 1/4"
- (4) LONGITUDINAL JOINT SEALANT (PLACED UNDER THE SURFACE LIFT)

HOT-MIX ASPHALT MIXTURE REQUIREMENTS	
MIXTURE TYPE	AIR VOIDS @ Ndes
PAVEMENT RESURFACING	
HMA SURFACE COURSE, MIX "D", IL-9.5, N50; 1 1/2"	3.5% @ 50 GYR.
HMA BINDER COURSE, IL-19.0, N50; 2 1/4"	3.5% @ 50 GYR.
INCIDENTAL HMA SURFACING (DRIVEWAYS)	
HMA SURFACE COURSE, MIX "D", N50 (IL-9.5mm); 2"	3.5% @ 50 GYR.
PATCHING	
CLASS D PATCHES, (HMA BINDER, IL-19mm); 7"	4.0% @ 70 GYR.

THE UNIT WEIGHT TO CALCULATE ALL HMA SURFACE MIXTURE QUANTITIES IS 112 LBS/SQ YD/IN

THE "AC TYPE" FOR POLYMERIZED HMA MIXES SHALL BE "SBS/SBR PG 76-22" AND FOR NON-POLYMERIZED HMA THE "AC TYPE" SHALL BE "PG 64-22" UNLESS MODIFIED BY DISTRICT ONE SPECIAL PROVISIONS.

FOR USE OF RECYCLED MATERIALS SEE SPECIAL PROVISIONS.

PATCHING LOCATIONS TO BE DETERMINED BY THE ENGINEER AFTER MILLING OPERATIONS.

HRG PROJECT NO. #16194
 HRG PROJ. CONTACT:
 FILE NAME: 16194-571-1-10-16.dgn
 PEN TABLE: 16194.tbl



USER NAME = jstrzal	DESIGNED - JJS	REVISED - XX/XX/XXXX
	DRAWN - DMS	REVISED - XX/XX/XXXX
PLOT SCALE =	CHECKED -	REVISED - XX/XX/XXXX
PLOT DATE = 11/13/2019	DATE -	REVISED - XX/XX/XXXX

**STATE OF ILLINOIS
 DEPARTMENT OF TRANSPORTATION**

**BOLCUM ROAD
 TYPICAL SECTIONS**

SCALE: N.T.S. SHEET 1 OF 1 SHEETS STA. TO STA.

F.A.U. RTE.	SECTION NO.	COUNTY	TOTAL SHEETS	SHEET NO.
2332	19-00007-00-R5	KANE	17	6
CONTRACT NO. 61G17				
FED. ROAD DIST. NO. ILLINOIS FED. AID PROJECT				

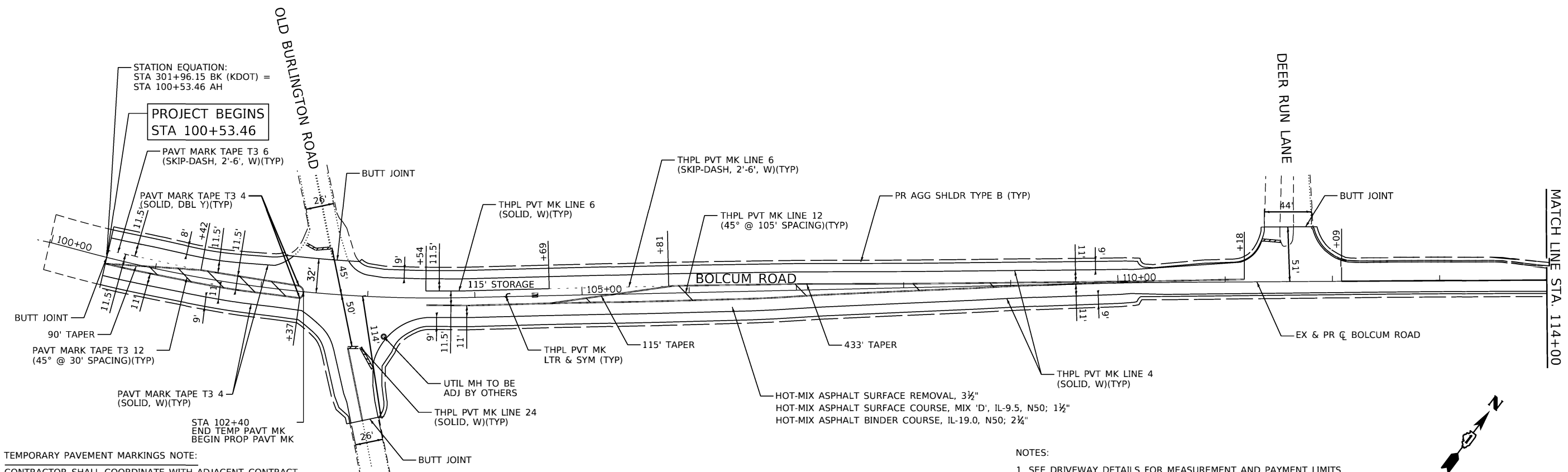

TEMPORARY PAVEMENT MARKINGS NOTE:
 CONTRACTOR SHALL COORDINATE WITH ADJACENT CONTRACT BY KDOT. ADJACENT CONTRACT WILL BE RESPONSIBLE FOR THE REMOVAL OF TEMPORARY PAVEMENT MARKING TAPE AND THE FINAL INSTALLATION OF PROPOSED PAVEMENT MARKINGS BETWEEN STA 100+53.46 AND STA 102+40.

NOTES:
 1. SEE DRIVEWAY DETAILS FOR MEASUREMENT AND PAYMENT LIMITS.
 2. SEE BUTT JOINT AND HMA TAPER DETAILS FOR BUTT JOINT LENGTHS

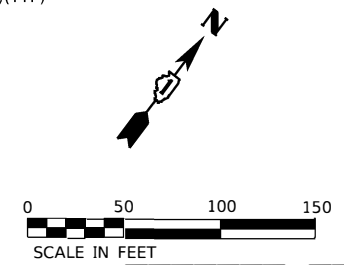
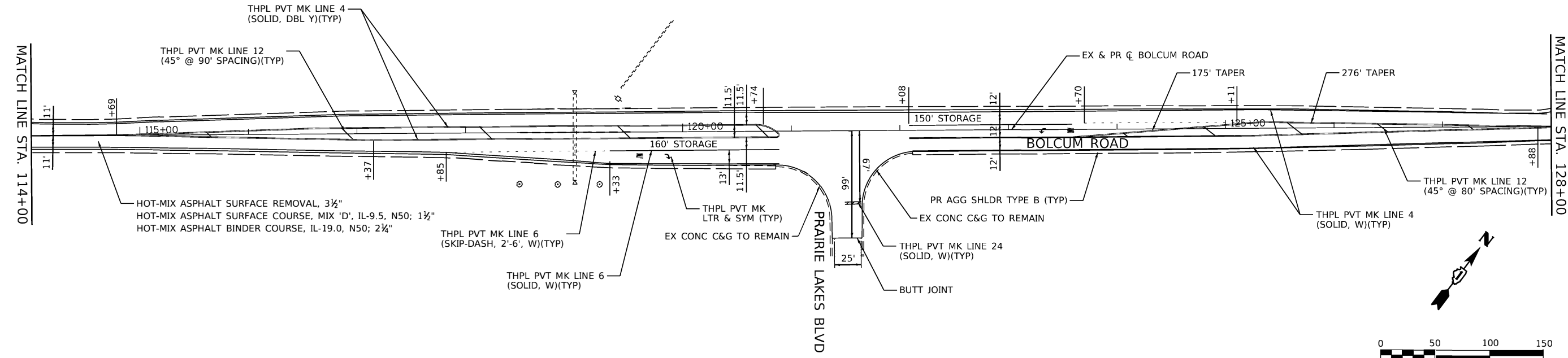
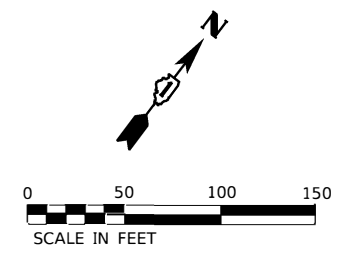

HRG PROJECT NO. 181694
 HRG PROJ. CONTACT:
 FILE NO. 181694-001-001-001-001-001-001
 PEN TABLE: 181694.tbl



 HRGreen.com
 Illinois Professional Design Firm
 #184-001322

USER NAME = jstrzal	DESIGNED - JJS	REVISED - XX/XX/XXXX
	DRAWN - DMS	REVISED - XX/XX/XXXX
PLOT SCALE =	CHECKED -	REVISED - XX/XX/XXXX
PLOT DATE = 11/13/2019	DATE -	REVISED - XX/XX/XXXX

**STATE OF ILLINOIS
 DEPARTMENT OF TRANSPORTATION**

BOLCUM ROAD RESURFACING PLAN		
SCALE: 1"=50'	SHEET 1 OF 3 SHEETS	STA. 100+53.46 TO STA. 128+00.00

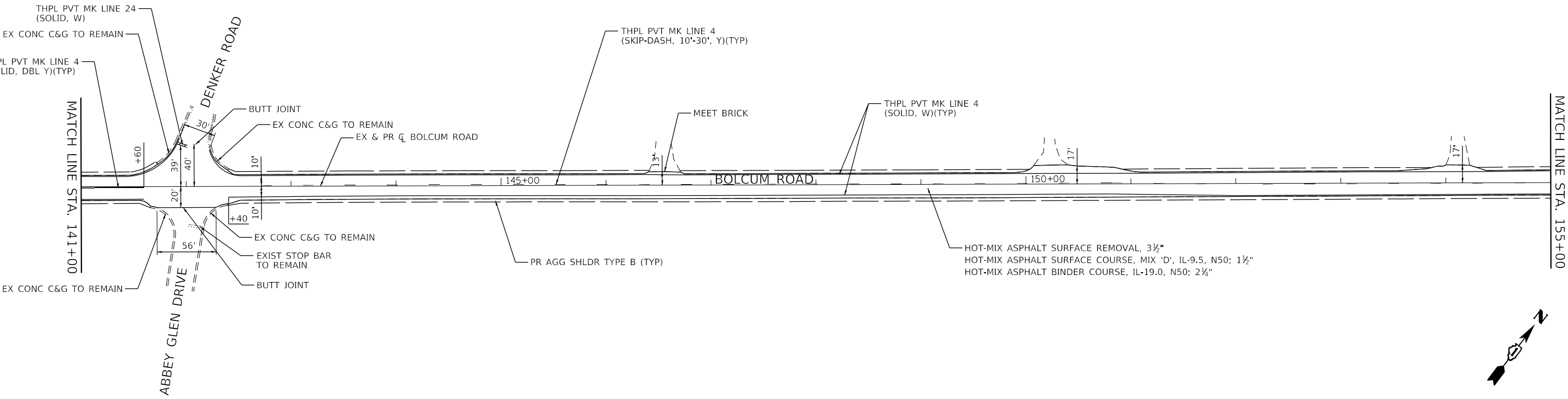
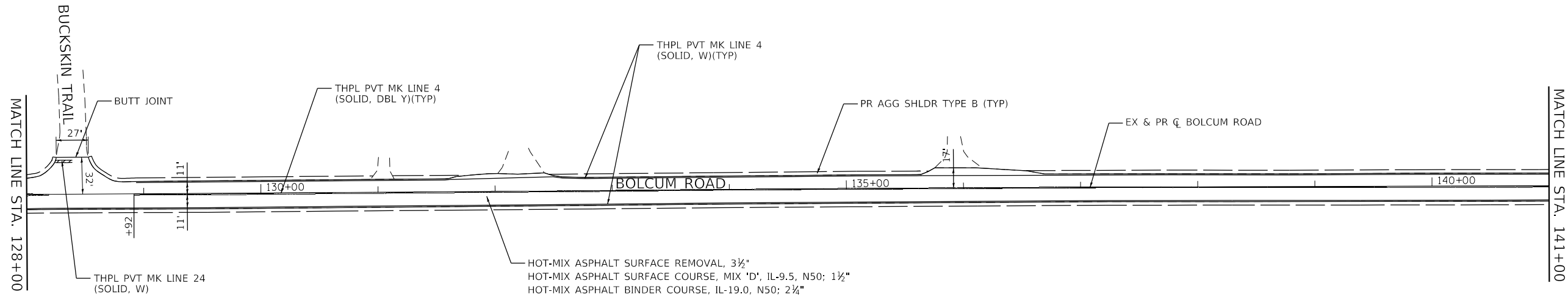
F.A.U. RTE. 2332	SECTION NO. 19-00007-00-R5	COUNTY KANE	TOTAL SHEETS 17	SHEET NO. 7
FED. ROAD DIST. NO. ILLINOIS FED. AID PROJECT			CONTRACT NO. 61G17	



- NOTES:
 1. SEE DRIVEWAY DETAILS FOR MEASUREMENT AND PAYMENT LIMITS.
 2. SEE BUTT JOINT AND HMA TAPER DETAILS FOR BUTT JOINT LENGTHS

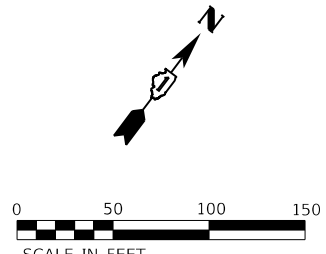
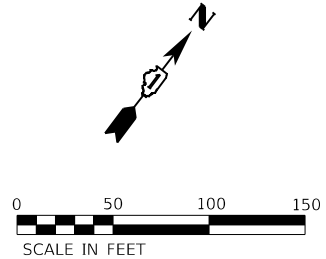

HRG PROJECT NO.: 191694
 HRG PROJ. CONTACT:
 FILE NAME: 191694-171-plan-02.dgn
 PEN TABLE: 191694.tbl



USER NAME = jstrzal	DESIGNED - JJS	REVISED - XX/XX/XXXX
	DRAWN - DMS	REVISED - XX/XX/XXXX
PLOT SCALE =	CHECKED -	REVISED - XX/XX/XXXX
PLOT DATE = 11/13/2019	DATE -	REVISED - XX/XX/XXXX

**STATE OF ILLINOIS
DEPARTMENT OF TRANSPORTATION**

**BOLCUM ROAD
RESURFACING PLAN**

SCALE: 1"=50' SHEET 2 OF 3 SHEETS STA. 128+00.00 TO STA. 155+00.00

F.A.U. RTE.	SECTION NO.	COUNTY	TOTAL SHEETS	SHEET NO.
2332	19-00007-00-R5	KANE	17	8
CONTRACT NO. 61G17				
FED. ROAD DIST. NO. ILLINOIS FED. AID PROJECT				

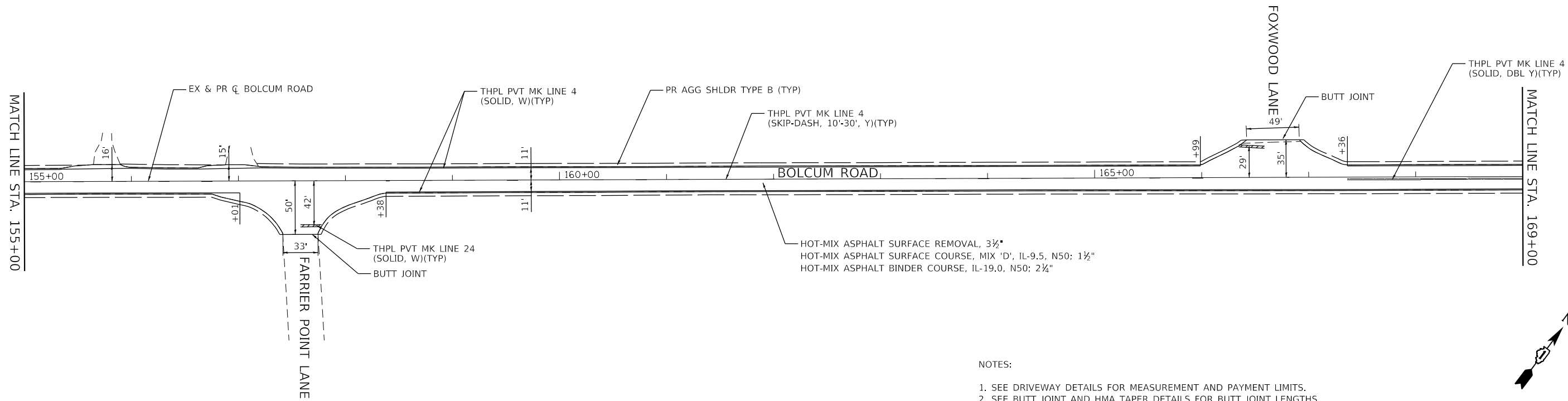

NOTES:

1. SEE DRIVEWAY DETAILS FOR MEASUREMENT AND PAYMENT LIMITS.
2. SEE BUTT JOINT AND HMA TAPER DETAILS FOR BUTT JOINT LENGTHS

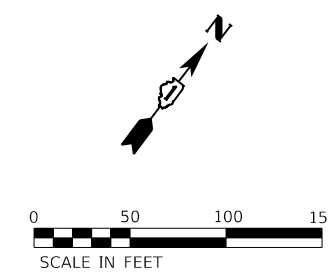
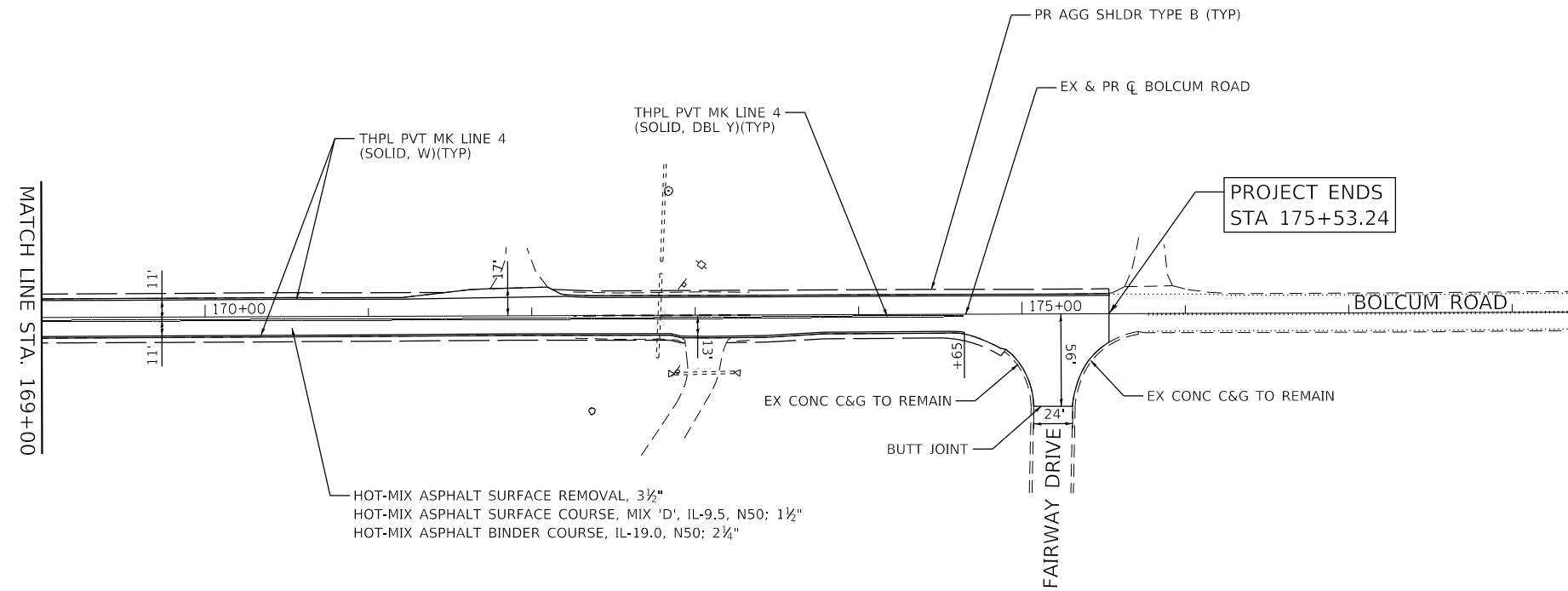

HRG PROJECT NO.: #16194
 HRG PROJ. CONTACT:
 FILE NAME: #0594-S17-plan-01.dgn
 PEN TABLE: penTable.tbl



USER NAME = jstrzol	DESIGNED - JJS	REVISED - XX/XX/XXXX
	DRAWN - DMS	REVISED - XX/XX/XXXX
PLOT SCALE =	CHECKED -	REVISED - XX/XX/XXXX
PLOT DATE = 11/13/2019	DATE -	REVISED - XX/XX/XXXX

**STATE OF ILLINOIS
DEPARTMENT OF TRANSPORTATION**

**BOLCUM ROAD
RESURFACING PLAN**

SCALE: 1"=50' SHEET 3 OF 3 SHEETS STA. 155+00.00 TO STA. 175+53.24

F.A.U. RTE.	SECTION NO.	COUNTY	TOTAL SHEETS	SHEET NO.
2332	19-00007-00-R5	KANE	17	9
CONTRACT NO. 61G17				
FED. ROAD DIST. NO. ILLINOIS FED. AID PROJECT				

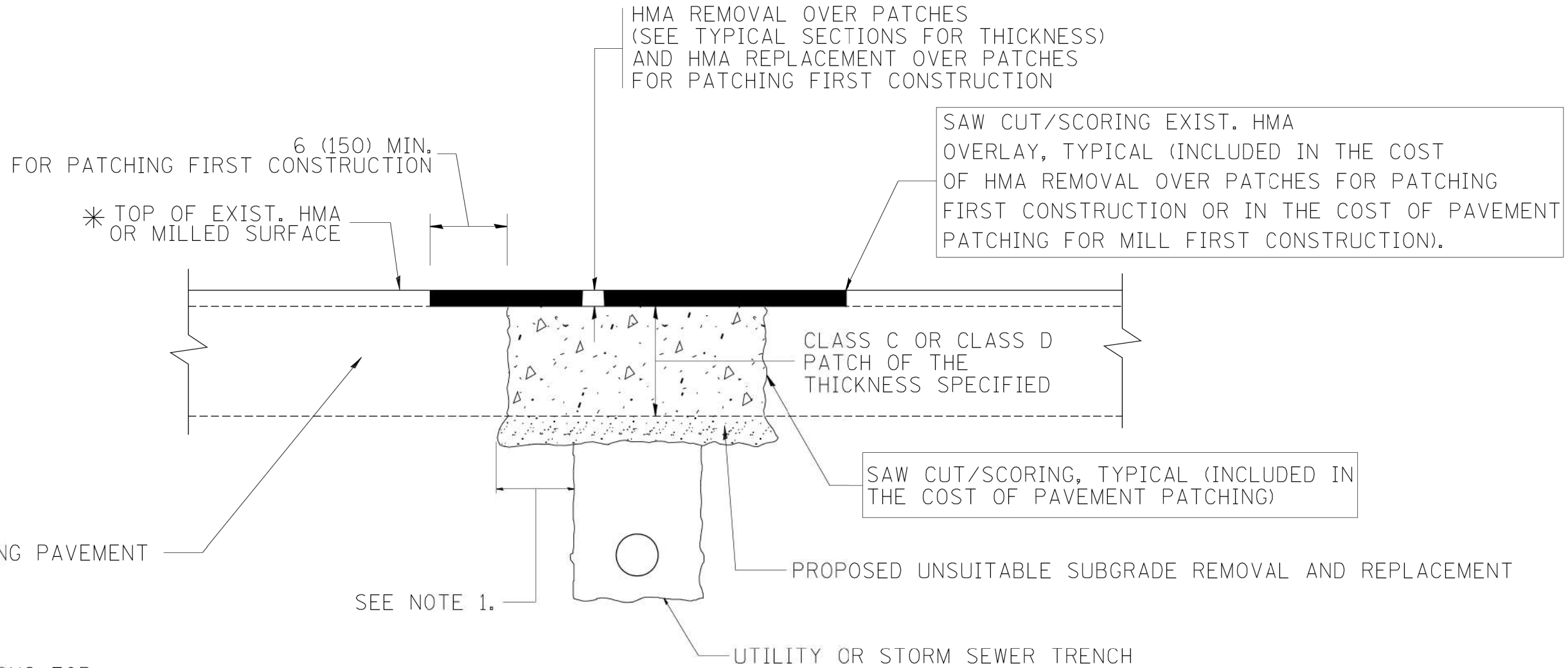

* SEE TYPICAL SECTIONS FOR THICKNESS AND MATERIALS

NOTES:

1. THE WIDTH OF THE FULL DEPTH PATCH OVER A TRENCH SHALL BE 12 (300) WIDER ON EACH SIDE OF THE TRENCH.
2. FOR METHOD OF MEASUREMENT AND BASIS OF PAYMENT, SEE RECURRING SPECIAL PROVISION "PATCHING WITH HOT-MIX ASPHALT OVERLAY REMOVAL".

SEQUENCE OF CONSTRUCTION (PATCHING FIRST)

1. REMOVE THE EXISTING HMA MATERIAL OVER THE AREA TO BE PATCHED.
2. REMOVE AND REPLACE WITH CLASS C OR D PATCH.
3. REPLACE HMA MATERIAL OVER THE AREA TO BE PATCHED.

SEQUENCE OF CONSTRUCTION (MILLING FIRST)

1. MILL HMA FIRST IF THERE IS AT LEAST 4 1/2 INCHES OR MORE OF HMA MATERIAL ON TOP OF THE EXISTING PAVEMENT OR IF THE PAVEMENT IS FULL DEPTH HMA. A MINIMUM OF 2 INCHES OF HMA MATERIAL SHALL BE IN PLACE AFTER MILLING.
2. REMOVE AND REPLACE WITH FULL DEPTH CLASS D PATCHES TO TOP OF MILLED SURFACE.

ALL DIMENSIONS ARE IN INCHES (MILLIMETERS) UNLESS OTHERWISE SHOWN.

COMPANY NAME: \$COMPANY.NAMES
 PROJECT CONTACT: \$PROJECT.CONTACT#
 DATE PLOTTED: 11/13/2019 2:45:24 PM
 FILE NAME: 181594-sh1-ds1-BD22.dgn
 PLOT DRIVER: IL_dwf.dwg
 PEN TABLE: plotlabel.tbl

FILE NAME =	USER NAME = bauerdl	DESIGNED - R. SHAH	REVISED - A. ABBAS 04-27-98
c:\projects\diststd22x34\bd22.dgn		DRAWN -	REVISED - R. BORO 01-01-07
		CHECKED -	REVISED - R. BORO 09-04-07
		DATE - 10-25-94	REVISED - K. ENG 10-27-08

**STATE OF ILLINOIS
 DEPARTMENT OF TRANSPORTATION**

**PAVEMENT PATCHING FOR
 HMA SURFACED PAVEMENT**

SCALE: NONE SHEET NO. 1 OF 1 SHEETS STA. TO STA.

F.A.U. RTE.	SECTION	COUNTY	TOTAL SHEETS	SHEET NO.
2332	19-00007-00-R5	KANE	17	10
BD400-04 (BD-22)			CONTRACT NO.	
FED. ROAD DIST. NO. 1 ILLINOIS FED. AID PROJECT				

VARIABLE - TO MEET EXISTING DIMENSIONS AND FIELD CONDITIONS (SEE NOTE ②)

PROP. CONC. CURB OR CURB AND GUTTER REPLACEMENT IN ACCORDANCE WITH STATE STANDARD 606001. (SEE NOTE ②)

SAW CUT FULL DEPTH - INCLUDED IN THE COST OF SIDEWALK, DRIVEWAY OR MEDIAN SURFACE REMOVAL PAY ITEM.

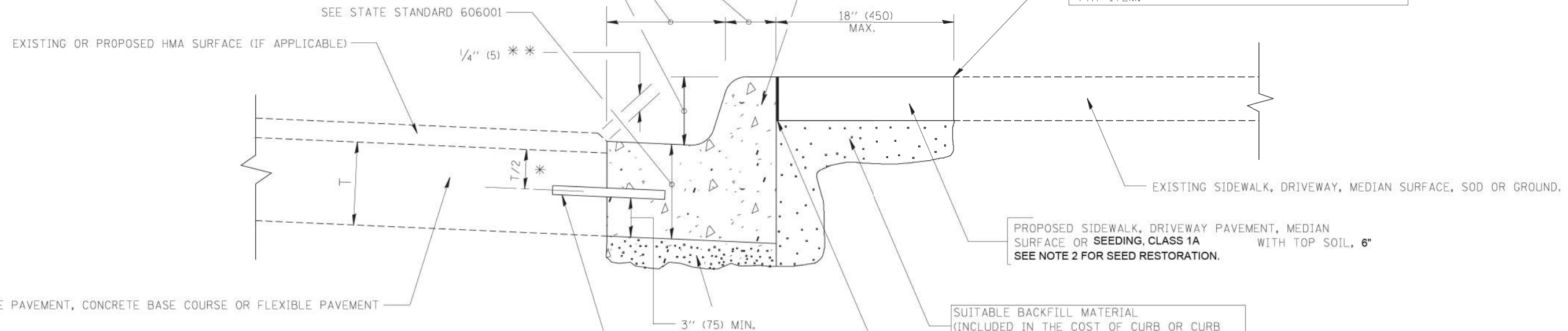

EXISTING CONCRETE PAVEMENT, CONCRETE BASE COURSE OR FLEXIBLE PAVEMENT

* 3" (75) MINIMUM FROM TOP AND BOTTOM OF THE CONCRETE PAVEMENT OR BASE COURSE.

** IF THE FINAL SURFACE OF THE PAVEMENT IS CONCRETE, THE GUTTER IS TO BE FLUSH WITH THE PAVEMENT.

NOTE: ① SIDEWALK, DRIVEWAY PAVEMENT OR MEDIAN SURFACE SHALL BE SIMILAR TO THE MATERIAL BEING REMOVED AND WILL BE PAID FOR SEPARATELY.

② RESTORATION BEHIND THE BACK OF CURB WILL NOT BE PAID FOR SEPARATELY, BUT INCLUDED IN THE COST OF COMBINATION CONCRETE CURB AND GUTTER OF THE TYPE SPECIFIED.

③ CURB OR CURB AND GUTTER REPLACEMENT SHALL MATCH THE SHAPE OF THE EXISTING CURB OR CURB AND GUTTER UNLESS OTHERWISE SPECIFIED.

④ FOR CURB OR CURB AND GUTTER REMOVAL AND REPLACEMENT ADJACENT TO FLEXIBLE PAVEMENT DELETE EPOXY COATED TIE BARS.

⑤ LONGITUDINAL BARS, IF ENCOUNTERED IN THE EXISTING CURB OR CURB AND GUTTER, ARE NOT TO BE REPLACED. CUTTING AND REMOVING LONGITUDINAL BARS SHALL BE INCLUDED IN THE COST OF CURB OR CURB AND GUTTER REMOVAL AND REPLACEMENT.

⑥ THE COST OF HMA SURFACE REMOVAL IN THE EXISTING GUTTER FLAG SHALL BE INCLUDED IN THE COST OF THE CURB AND GUTTER REMOVAL AND REPLACEMENT.

⑦ THE REMOVAL AND REPLACEMENT OF THE EXISTING CURB OR CURB AND GUTTER SHALL BE DONE IN ACCORDANCE WITH THE APPLICABLE PORTIONS OF SECTION 440 AND 606 OF THE STANDARD SPECIFICATIONS.

⑧ THE LOCATIONS OF REMOVAL AND REPLACEMENT OF EXISTING CURB OR CURB AND GUTTER SHALL BE DETERMINED BY THE RESIDENT ENGINEER AT THE TIME OF CONSTRUCTION.

PROPOSED SIDEWALK, DRIVEWAY PAVEMENT, MEDIAN SURFACE OR SEEDING, CLASS 1A WITH TOP SOIL, 6" SEE NOTE 2 FOR SEED RESTORATION.

SUITABLE BACKFILL MATERIAL (INCLUDED IN THE COST OF CURB OR CURB AND GUTTER REMOVAL AND REPLACEMENT)

PROPOSED 3/4" (20) PREFORMED EXPANSION JOINT AT CONCRETE SIDEWALKS, DRIVEWAYS, AND MEDIANS. (INCLUDED IN THE COST OF CURB OR CURB AND GUTTER REMOVAL AND REPLACEMENT.)

UNSUITABLE SUB-BASE MATERIAL TO BE REMOVED, IF DIRECTED BY THE ENGINEER, SHALL BE REPLACED WITH EITHER SUB-BASE GRANULAR MATERIAL, TYPE B OR ADDITIONAL THICKNESS OF CONCRETE.

REMOVAL AND REPLACEMENT 4" (100) OR LESS IS INCLUDED IN THE COST OF CURB OR CURB AND GUTTER REMOVAL AND REPLACEMENT.

REMOVAL AND REPLACEMENT IN EXCESS OF 4" (100) WILL BE PAID FOR IN ACCORDANCE WITH ARTICLE 109.04 OF THE STANDARD SPECIFICATIONS.

PROPOSED #6 (20) EPOXY COATED TIE BARS 24" (600) LONG AT 24" (600) CENTERS WILL NOT BE PAID FOR SEPARATELY. DELETE EPOXY COATED TIE BARS IF EXISTING TIE BARS ARE USABLE AS DETERMINED BY THE ENGINEER. (SEE NOTE ③).

BASIS OF PAYMENT:

THIS WORK WILL BE PAID FOR AT THE CONTRACT UNIT PRICE PER FOOT (METER) FOR "CURB REMOVAL AND REPLACEMENT" OR "COMBINATION CONCRETE CURB AND GUTTER REMOVAL AND REPLACEMENT".

CURB OR CURB AND GUTTER REMOVAL AND REPLACEMENT

ALL DIMENSIONS ARE IN INCHES (MILLIMETERS) UNLESS OTHERWISE SHOWN.

COMPANY NAME: 181594-011-001-B024.dgn
 PROJECT CONTACT: 11/13/2019 2:45:17 PM
 DATE PLOTTED: 181594-011-001-B024.dgn
 FILE NAME: IL.pdf
 PLOT DRIVER: plot.tbl

FILE NAME =	USER NAME = d3rvakosgn	DESIGNED - A. HOUSEH	REVISED - R. SHAH 10-03-96
cs:\p\work\p\dot\drivakosgn\d0106315\bc24.dgn		DRAWN -	REVISED - A. ABBAS 03-21-97
	PLOT SCALE = 50.000 ' / IN.	CHECKED -	REVISED - M. GOMEZ 01-22-01
	PLOT DATE = 12/15/2009	DATE - 03-11-94	REVISED - R. BORO 12-15-09

**STATE OF ILLINOIS
 DEPARTMENT OF TRANSPORTATION**

**CURB OR CURB AND GUTTER
 REMOVAL AND REPLACEMENT**

SCALE: NONE SHEET NO. 1 OF 1 SHEETS STA. TO STA.

F.A.U. RTE.	SECTION	COUNTY	TOTAL SHEETS	SHEET NO.
2332	19-00007-00-R5	KANE	17	11
BD600-06 (BD-24)			CONTRACT NO.	
FED. ROAD DIST. NO. 1 ILLINOIS FED. AID PROJECT				

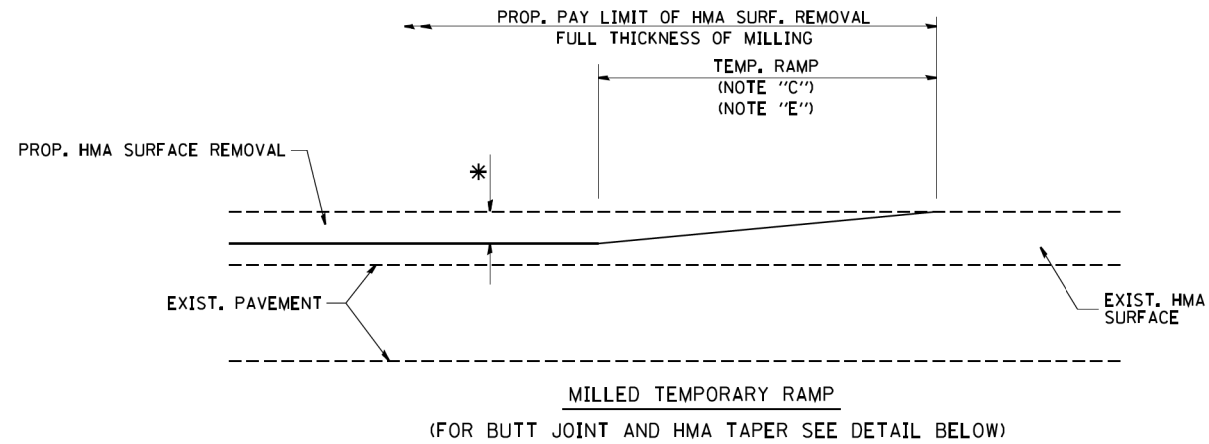

OPTION 1

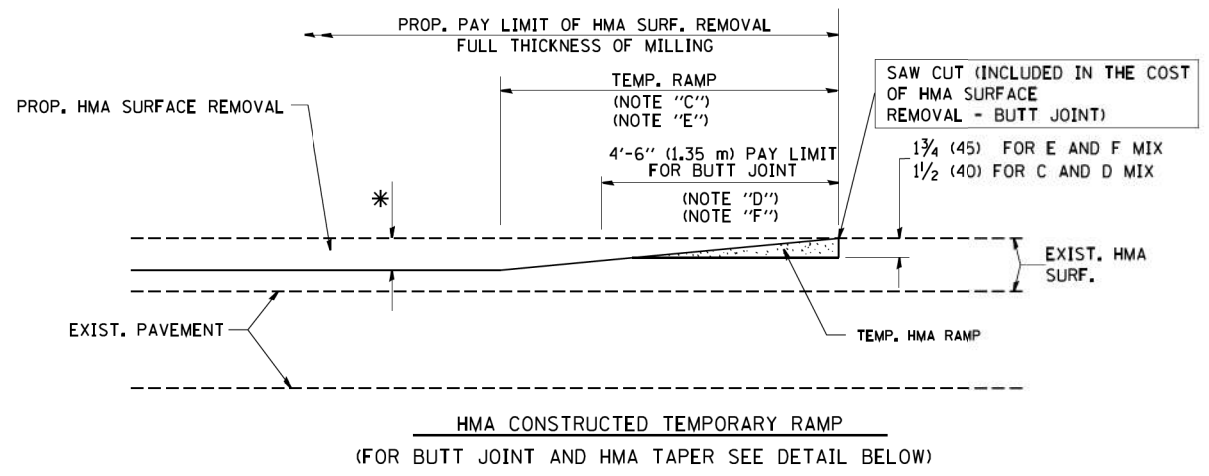

OPTION 2
TYPICAL TEMPORARY RAMP

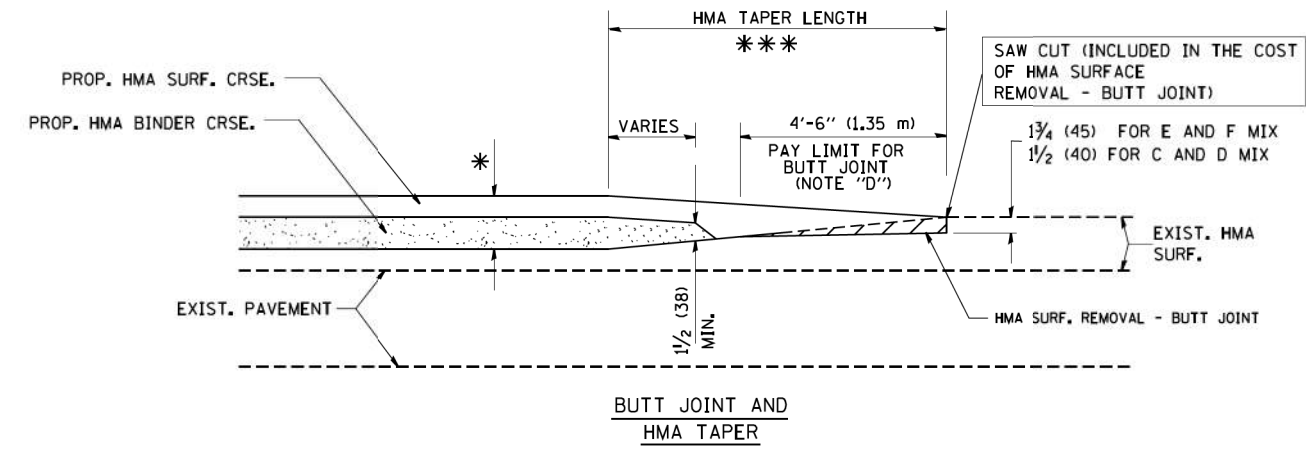

TYPICAL BUTT JOINT AND HMA TAPER FOR MILLING AND RESURFACING

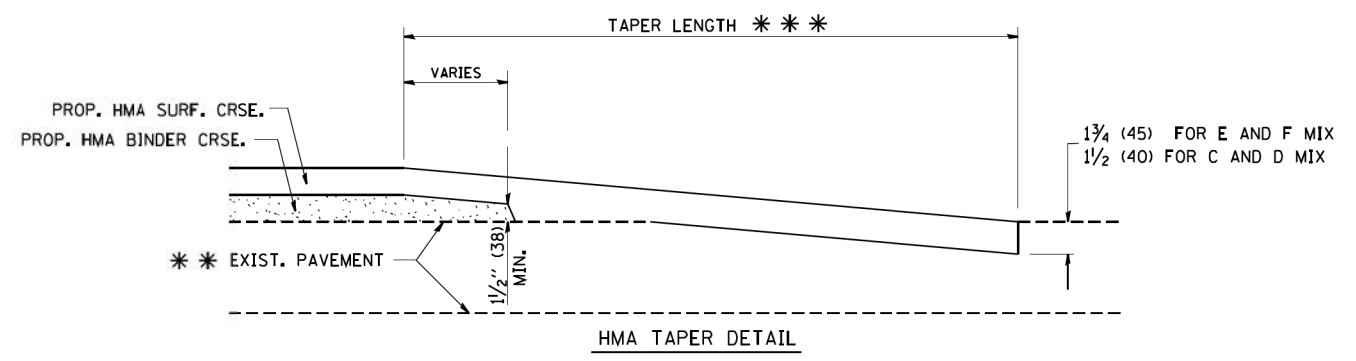
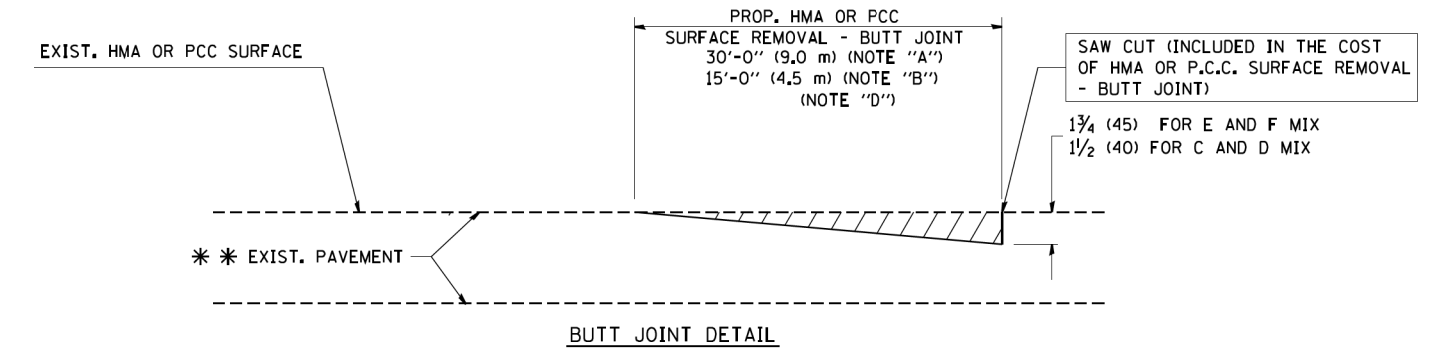

TYPICAL BUTT JOINT AND HMA TAPER FOR RESURFACING ONLY

*** PC CONCRETE, HMA OR HMA RESURFACED PAVEMENT.

NOTES

- A: MAINLINE ROADWAYS AND MAJOR SIDE ROADS.
 - B: MINOR SIDE ROADS.
 - C: THE TEMP. RAMP SHALL BE CONSTRUCTED IMMEDIATELY UPON REMOVAL OF THE EXISTING HMA SURFACE.
 - D: THE BUTT JOINT SHALL BE CONSTRUCTED IMMEDIATELY PRIOR TO PLACING THE PROPOSED HMA COURSES.
 - E: TAPER THE TEMP. RAMP AT A RATE OF 3'-0" (900 mm) PER 1 INCH (25 mm) OF MILLING THICKNESS.
 - F: INSTALLATION AND REMOVAL OF THE 4'-6" (1.35 m) TEMP. RAMP IS INCLUDED IN COST OF HMA SURFACE REMOVAL - BUTT JOINT
 - G: SEE ARTICLE 406.08 AND 406.14 OF THE STANDARD SPECIFICATIONS FOR "HMA AND/OR PCC SURFACE REMOVAL, BUTT JOINT".
- * SEE TYPICAL SECTIONS FOR MILLING THICKNESS.
- *** 20'-0" (6.1 m) PER 1 (25) RESURFACING (NOTE "A")
10'-0" (3.0 m) PER 1 (25) RESURFACING (NOTE "B")

BASIS OF PAYMENT:

THE BUTT JOINT WILL BE PAID FOR AT THE CONTRACT UNIT PRICE PER SQUARE YARD (SQUARE METER) FOR "HOT-MIX ASPHALT SURFACE REMOVAL - BUTT JOINT" OR FOR "PORTLAND CEMENT CONCRETE SURFACE REMOVAL - BUTT JOINT".

ALL DIMENSIONS ARE IN INCHES (MILLIMETERS) UNLESS OTHERWISE SHOWN.

COMPANY NAME: * COMPANY NAME *
PROJECT CONTACT: * PROJECT CONTACT *
DATE PLOTTED: 11/13/2019 2:45:51 PM
FILE NAME: 181594-sh1-ds1-BD32.dgn
PLOT DRIVER: ILDwf.plt
PEN TABLE: plottable.tbl

FILE NAME =	USER NAME = gegl1enobt	DESIGNED - M. DE YONG	REVISED - R. SHAH 10-25-94
W:\diststa\22x34\bd32.dgn		DRAWN -	REVISED - A. ABBAS 03-21-97
	PLOT SCALE = 50.0000' / IN.	CHECKED -	REVISED - M. GOMEZ 04-06-01
	PLOT DATE = 1/4/2008	DATE - 06-13-90	REVISED - R. BORO 01-01-07

**STATE OF ILLINOIS
DEPARTMENT OF TRANSPORTATION**

**BUTT JOINT AND
HMA TAPER DETAILS**

SCALE: NONE SHEET NO. 1 OF 1 SHEETS STA. TO STA.

F.A.U. RTE.	SECTION	COUNTY	TOTAL SHEETS	SHEET NO.
2332	19-00007-00-R5	KANE	17	12
BD400-05 BD32		CONTRACT NO. 61G17		
FED. ROAD DIST. NO. 1 ILLINOIS FED. AID PROJECT				

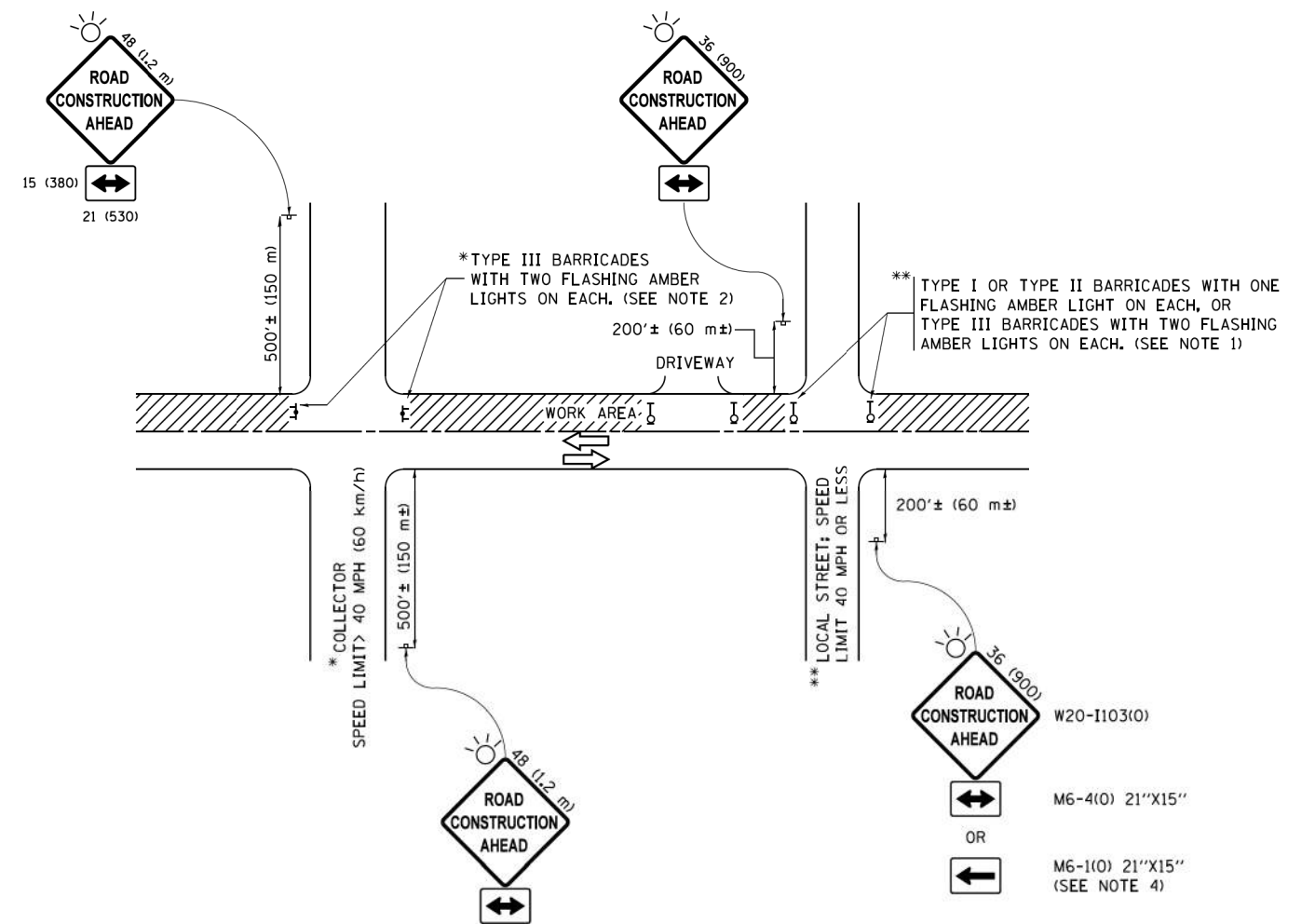

NOTES:

1. SIDE ROAD WITH A SPEED LIMIT OF 40 MPH (60 km/h) OR LESS AS SHOWN ON THE DRAWING AND AS DIRECTED BY THE ENGINEER:
 - a) ONE "ROAD CONSTRUCTION AHEAD" SIGN 36 x 36 (900x900) WITH A FLASHER MOUNTED ON IT APPROXIMATELY 200' (60 m) IN ADVANCE OF THE MAIN ROUTE.
 - b) THE CLOSED PORTION OF THE MAIN ROUTE SHALL BE PROTECTED BY BLOCKING WITH TYPE I, TYPE II OR TYPE III BARRICADES, 1/3 OF THE CROSS SECTION OF THE CLOSED PORTION.
2. SIDE ROAD WITH A SPEED LIMIT GREATER THAN 40 MPH (60 km/h) AS SHOWN ON THE DRAWING AND AS DIRECTED BY THE ENGINEER:
 - a) ONE "ROAD CONSTRUCTION AHEAD" SIGN 48 x 48 (1.2 m x 1.2 m) WITH A FLASHER MOUNTED ON IT APPROXIMATELY 500' (150 m) IN ADVANCE OF THE MAIN ROUTE.
 - b) THE CLOSED PORTION OF THE MAIN ROUTE SHALL BE PROTECTED BY BLOCKING WITH TYPE III BARRICADES, 1/2 OF THE CROSS SECTION OF THE CLOSED PORTION.
3. CONES MAY BE SUBSTITUTED FOR BARRICADES OR DRUMS AT HALF THE SPACING DURING DAY OPERATIONS. CONES SHALL BE A MINIMUM OF 28 (710) IN HEIGHT.
4. WHEN THE SIDE ROAD LIES BETWEEN THE BEGINNING OF THE MAINLINE SIGNING AND THE WORK ZONE, A SINGLE HEADED ARROW (M6-1) SHALL BE USED IN LIEU OF THE DOUBLE HEADED ARROW (M6-4).
5. WHEN WORK IS BEING PERFORMED ON A SIDE ROAD OR DRIVEWAY, FOLLOW THE APPLICABLE STANDARD(S). THE DIRECTIONAL ARROW (M6-1 OR M6-4) SHALL BE COVERED OR REMOVED WHEN NO LONGER CONSISTENT WITH THE TRAFFIC CONTROL SET-UP.
6. ADVANCE WARNING SIGNS ARE TO BE OMITTED ON DRIVEWAYS UNLESS OTHERWISE SPECIFIED IN THE PLANS OR BY THE ENGINEER.
7. THE TRAFFIC CONTROL AND PROTECTION FOR SIDE ROADS, INTERSECTIONS, AND DRIVEWAYS SHALL BE INCLUDED IN THE COST OF SPECIFIED TRAFFIC CONTROL STANDARDS OR ITEMS.

All dimensions are in inches (millimeters) unless otherwise shown.

COMPANY NAME: #COMPANY NAME#
 PROJECT CONTACT: #PROJECT CONTACT#
 DATE PLOTTED: 11/13/2019 2:46:03 PM
 FILE NAME: 181594-sh1-det-TC10.dgn
 PLOT DRIVER: ILpdf.plt
 PEN TABLE: plotlabel.tbl

FILE NAME =	USER NAME = foatemj	DESIGNED - L.H.A.	REVISED - A. HOUSEH 10-15-96
pwt\IL084EBID\INTEG\illinois.gov\FWIDOT\Documents\IDOT Offices\District 1\Projects\Dist1\181594\CADD\sets\CADsheets\tc10.dgn		DRAWN	REVISED - T. RAMMACHER 01-06-00
Default	PLOT SCALE = 50,000' / in.	CHECKED -	REVISED - A. SCHUETZE 07-01-13
	PLOT DATE = 9/15/2016	DATE - 06-89	REVISED - A. SCHUETZE 09-15-16

**STATE OF ILLINOIS
 DEPARTMENT OF TRANSPORTATION**

**TRAFFIC CONTROL AND PROTECTION FOR
 SIDE ROADS, INTERSECTIONS, AND DRIVEWAYS**

SCALE: NONE SHEET 1 OF 1 SHEETS STA. TO STA.

F.A.U. RTE.	SECTION	COUNTY	TOTAL SHEETS	SHEET NO.
2332	19-00007-00-R5	KANE	17	13
TC-10			CONTRACT NO. 61G17	
ILLINOIS FED. AID PROJECT				

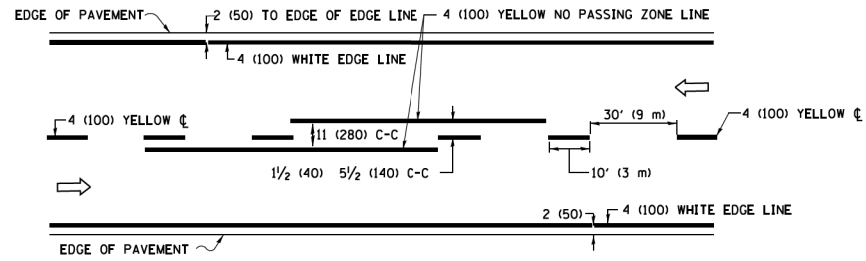

2-LANE ROADWAY

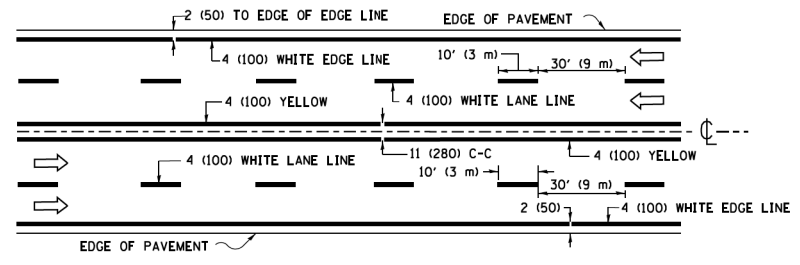

MULTI-LANE UNDIVIDED

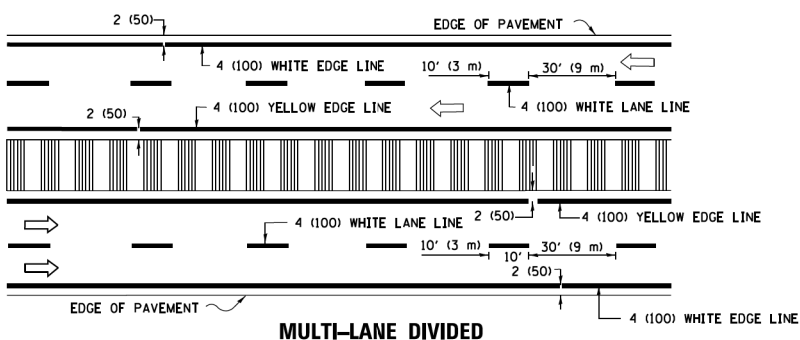

MULTI-LANE DIVIDED WITH MEDIAN

TYPICAL LANE AND EDGE LINE MARKING

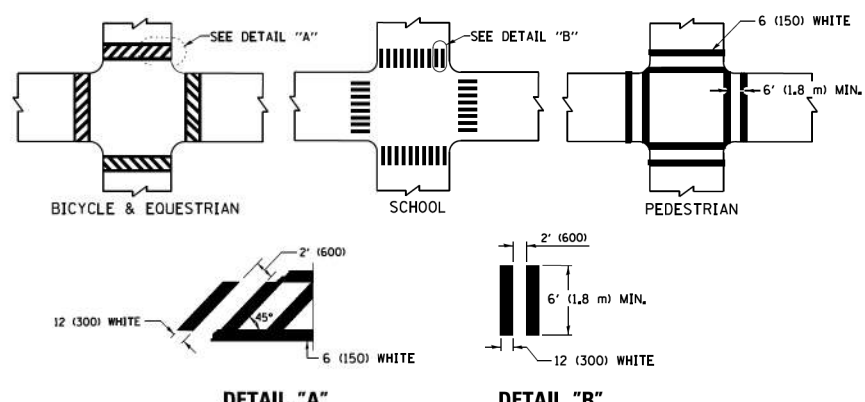

TYPICAL CROSSWALK MARKING

* MARKINGS SHALL BE INSTALLED PARALLEL TO THE CENTERLINE OF THE ROAD WHICH IT CROSSES

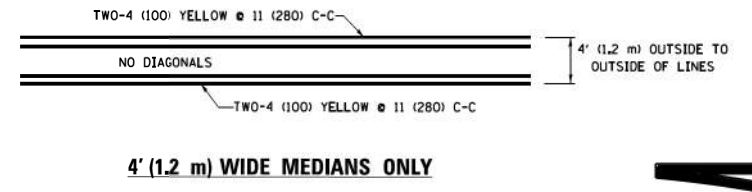

4' (1.2 m) WIDE MEDIANS ONLY

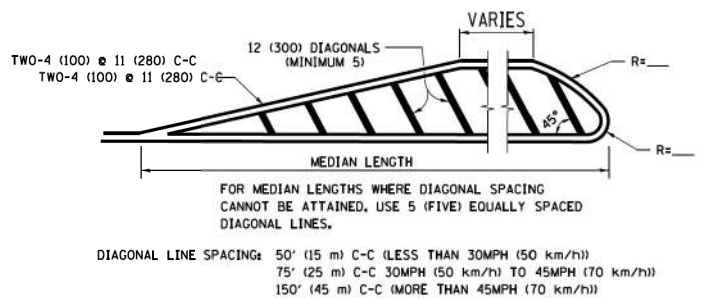

MEDIANS OVER 4' (1.2 m) WIDE

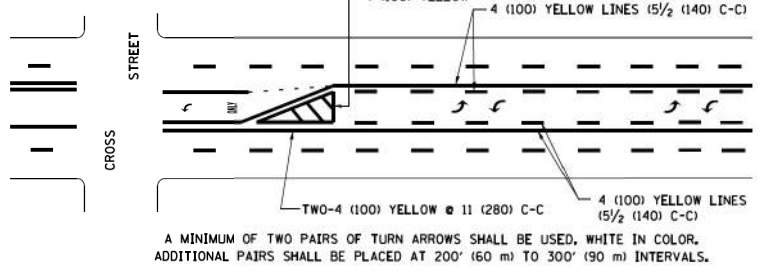

**MEDIAN WITH TWO-WAY LEFT TURN LANE
TYPICAL PAINTED MEDIAN MARKING**

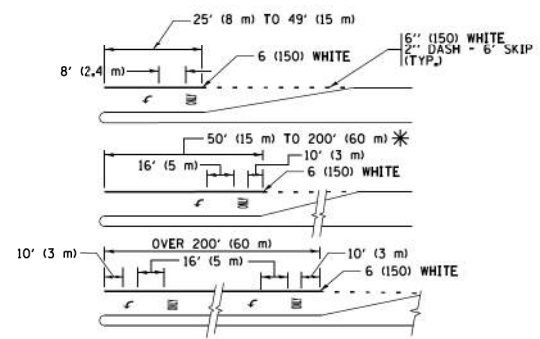

**TYPICAL LEFT (OR RIGHT) TURN LANE
TYPICAL TURN LANE MARKING**

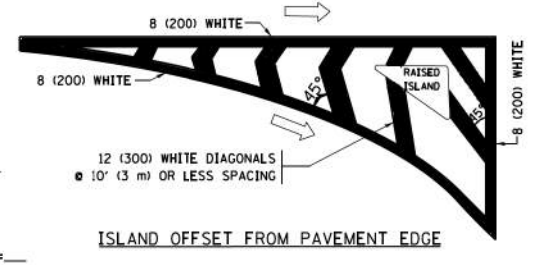

ISLAND OFFSET FROM PAVEMENT EDGE

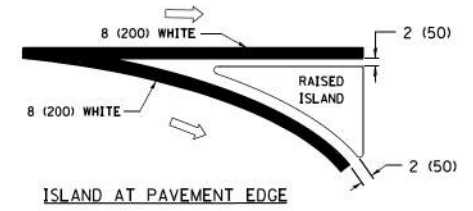

**ISLAND AT PAVEMENT EDGE
TYPICAL ISLAND MARKING**

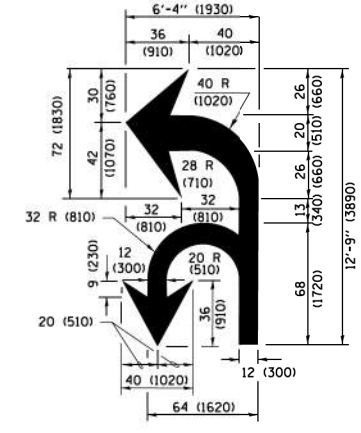

COMBINATION LEFT AND U-TURN

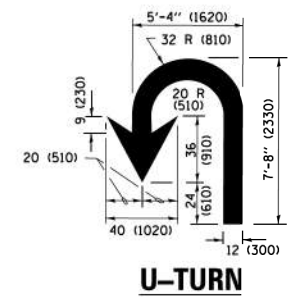

U-TURN

D(FT)	SPEED LIMIT
345	30
425	35
500	40
580	45
665	50
750	55

LANE REDUCTION TRANSITION
* LANE REDUCTION ARROWS REQUIRED AT SPEEDS OF 45 MPH OR GREATER OR WHEN SPECIFIED IN PLANS.

TYPE OF MARKING	WIDTH OF LINE	PATTERN	COLOR	SPACING /REMARKS
CENTERLINE ON 2 LANE PAVEMENT	4 (100)	SKIP-DASH	YELLOW	10' (3 m) LINE WITH 30' (9 m) SPACE
CENTERLINE ON MULTI-LANE UNDIVIDED PAVEMENT	2 @ 4 (100)	SOLID	YELLOW	11 (280) C-C
NO PASSING ZONE LINES FOR ONE DIRECTION FOR BOTH DIRECTIONS	4 (100) 2 @ 4 (100)	SOLID SOLID	YELLOW YELLOW	5 1/2 (140) C-C FROM SKIP-DASH CENTERLINE 11 (280) C-C OMIT SKIP-DASH CENTERLINE BETWEEN
LANE LINES	4 (100) 5 (125) ON FREEWAYS	SKIP-DASH SKIP-DASH	WHITE WHITE	10' (3 m) LINE WITH 30' (9 m) SPACE
DOTTED LINES (EXTENSIONS OF CENTER, LANE OR TURN LANE MARKINGS)	SAME AS LINE BEING EXTENDED	SKIP-DASH	SAME AS LINE BEING EXTENDED	2' (600) LINE WITH 6' (1.8 m) SPACE
EDGE LINES	4 (100)	SOLID	YELLOW-LEFT WHITE-RIGHT	OUTLINE MEDIANS IN YELLOW
TURN LANE MARKINGS	6 (150) LINE; FULL SIZE LETTERS & SYMBOLS (8' (2.4m))	SOLID	WHITE	SEE TYPICAL TURN LANE MARKING DETAIL
TWO WAY LEFT TURN MARKING	2 @ 4 (100) EACH DIRECTION 8' (2.4m) LEFT ARROW	SKIP-DASH AND SOLID IN PAIRS	YELLOW WHITE	10' (3 m) LINE WITH 30' (9 m) SPACE FOR SKIP-DASH; 5 1/2 (140) C-C BETWEEN SOLID LINE AND SKIP-DASH LINE SEE TYPICAL TWO-WAY LEFT TURN MARKING DETAIL
CROSSWALK LINES (PEDESTRIAN) A. DIAGONALS (BIKE & EQUESTRIAN) B. LONGITUDINAL BARS (SCHOOL)	2 @ 6 (150) 12 (300) @ 45° 12 (300) @ 90°	SOLID SOLID SOLID	WHITE WHITE WHITE	NOT LESS THAN 6' (1.8 m) APART 2' (600) APART 2' (600) APART SEE TYPICAL CROSSWALK MARKING DETAILS.
STOP LINES	24 (600)	SOLID	WHITE	PLACE 4' (1.2 m) IN ADVANCE OF AND PARALLEL TO CROSSWALK, IF PRESENT, OTHERWISE, PLACE AT DESIRED STOPPING POINT, PARALLEL TO CROSSROAD CENTERLINE, WHERE POSSIBLE
PAINTED MEDIANS	2 @ 4 (100) WITH 12 (300) DIAGONALS @ 45° NO DIAGONALS USED FOR 4' (1.2 m) WIDE MEDIANS	SOLID	YELLOW; TWO WAY TRAFFIC WHITE; ONE WAY TRAFFIC	11 (280) C-C FOR THE DOUBLE LINE SEE TYPICAL PAINTED MEDIAN MARKING.
CORE MARKING AND CHANNELIZING LINES	8 (200) WITH 12 (300) DIAGONALS @ 45°	SOLID	WHITE	DIAGONALS: 15' (4.5 m) C-C (LESS THAN 30MPH (50 km/h)) 20' (6 m) C-C (30 MPH (50 km/h) TO 45MPH (70 km/h)) 30' (9 m) C-C (OVER 45MPH (70 km/h))
RAILROAD CROSSING	24 (600) TRANSVERSE LINES; "RR" IS 6' (1.8 m) LETTERS; 16 (400) LINE FOR "X"	SOLID	WHITE	SEE STATE STANDARD 780001 AREA OF "RR" IS 6' (1.8 m) "X" IS 54.0 SQ. FT. (5.0 m ²) EACH
SHOULDER DIAGONALS (REQUIRED FOR SHOULDERS ≥ 8')	12 (300) @ 45°	SOLID	WHITE - RIGHT YELLOW - LEFT	50' (15 m) C-C (LESS THAN 30MPH (50 km/h)) 75' (25 m) C-C (30 MPH (50 km/h) TO 45MPH (70 km/h)) 150' (45 m) C-C (OVER 45MPH (70 km/h))
U TURN ARROW	SEE DETAIL	SOLID	WHITE	16.3 SF
2 ARROW COMBINATION LEFT AND U TURN	SEE DETAIL	SOLID	WHITE	30.4 SF

FOR FURTHER DETAILS ON PAVEMENT MARKING REFER TO STANDARD SPECIFICATIONS FOR ROAD AND BRIDGE CONSTRUCTION AND STATE STANDARD 780001.

All dimensions are in inches (millimeters) unless otherwise shown.

COMPANY NAME: PROJECT CONTACT: PROJECT AREA: DATE PLOTTED: FILE NAME: PLOT DRIVER: PEN TABLE:

FILE NAME	USER NAME	DESIGNED	REVISED
pwt\11084EBID\INTEG\11084EBID\DWG\11084EBID\11084EBID.dwg	footemj	EVERS	C. JUCIUS 09-09-09
		CHECKED	C. JUCIUS 07-01-13
		DATE	C. JUCIUS 12-21-15
		REVISED	C. JUCIUS 04-12-16

**STATE OF ILLINOIS
DEPARTMENT OF TRANSPORTATION**

DISTRICT ONE TYPICAL PAVEMENT MARKINGS		SECTION	COUNTY	TOTAL SHEETS	SHEET NO.
SCALE: NONE	SHEET 1 OF 1 SHEETS	2332	KANE	17	14
		TC-13			CONTRACT NO. 61G17

F.A.U. RTE.	SECTION	COUNTY	TOTAL SHEETS	SHEET NO.
2332	19-00007-00-R5	KANE	17	14

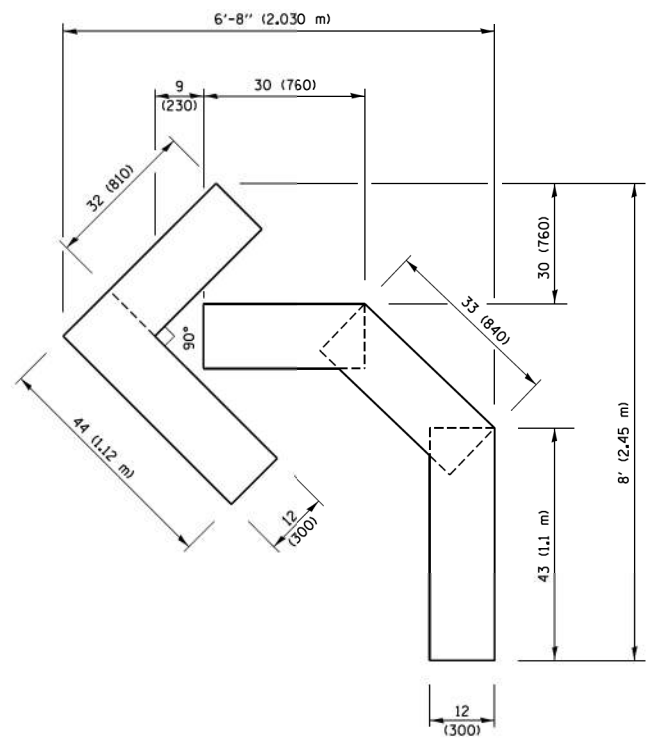

QUANTITY
 4 (100) LINE = 45.5 ft. (13.9 m)
 15.2 sq. ft. (1.41 sq. m)

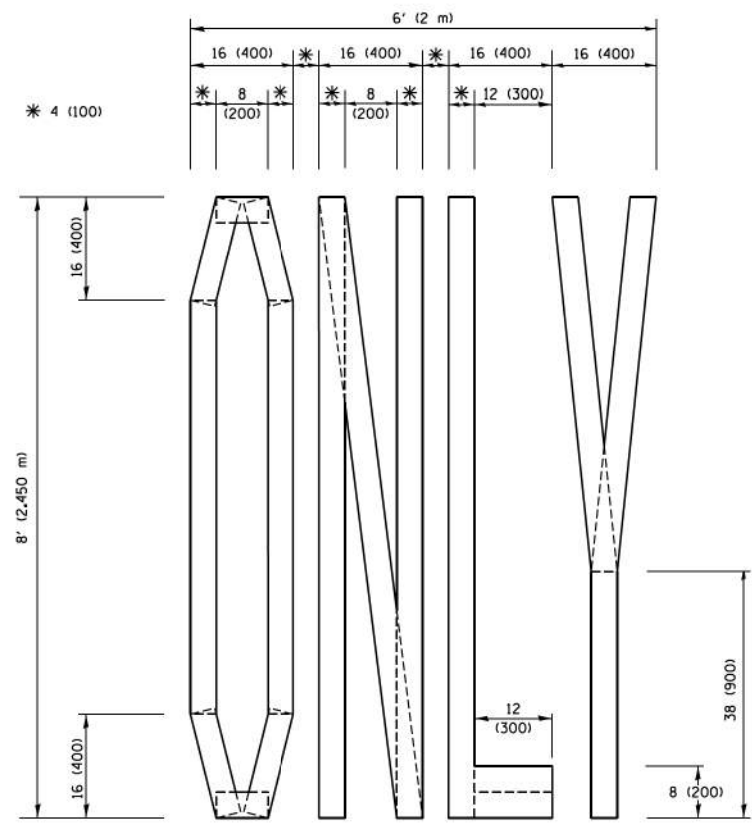

QUANTITY
 4 (100) LINE = 64.1 ft. (19.5 m)
 21.4 sq. ft. (1.99 sq. m)

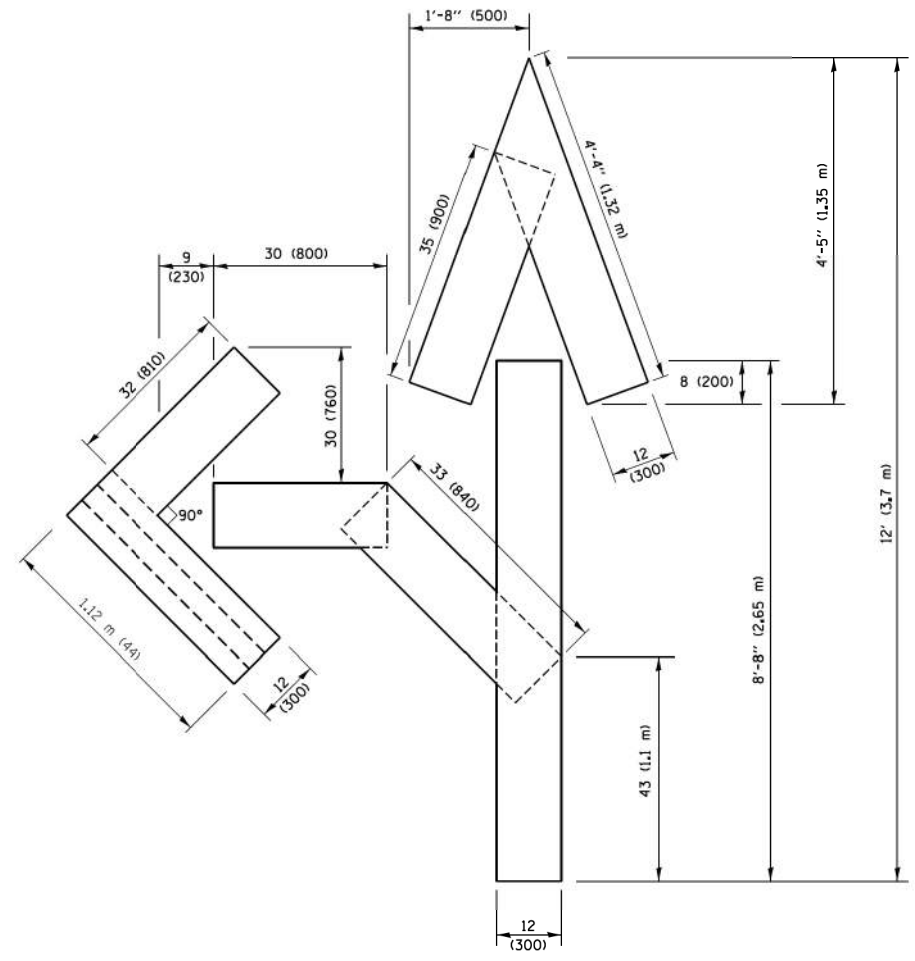

QUANTITY
 4 (100) LINE = 82.5 ft. (25.1 m)
 27.5 sq. ft. (2.53 sq. m)

NOTE:
 ALL QUANTITIES OF PLACEMENT ARE REPRESENTED IN LINEAR FEET OF 4" LINES TO MATCH THE 4" TEMPORARY TAPE PAY ITEM AND REPRESENTS THE TOTAL QUANTITY OF 4" TAPE REQUIRED.

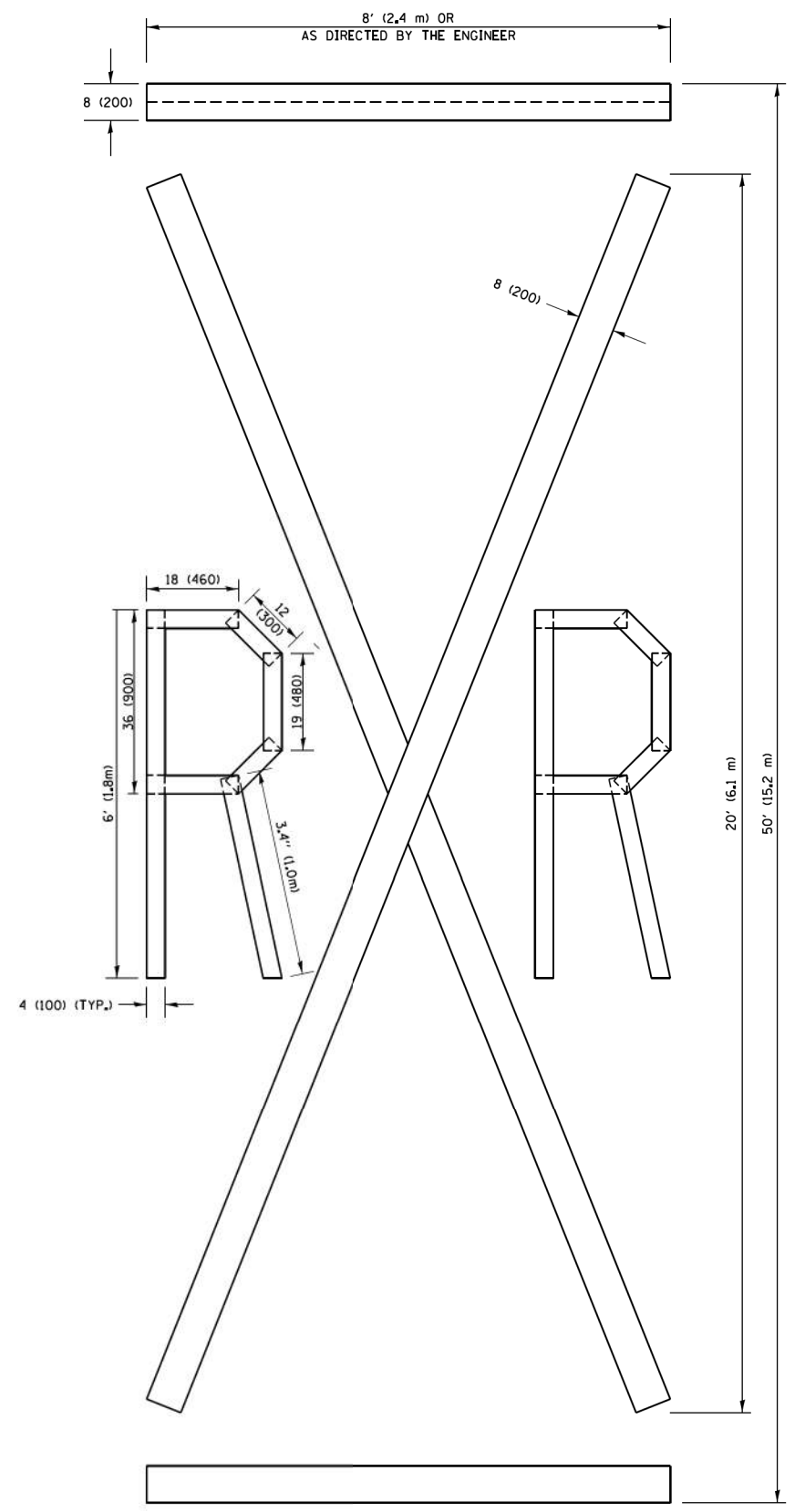

QUANTITY
 4 (100) LINE = 225.9 ft. (68.9 m)
 75.3 sq. ft. (6.99 sq. m)

All dimensions are in inches (millimeters) unless otherwise shown.

COMPANY NAME: 181594-sh1-det-TC16.dgn
 PROJECT CONTACT: 11/13/2019 2:46:31 PM
 DATE PLOTTED: 181594-sh1-det-TC16.dgn
 FILE NAME: IL:\pdf\pwworksp\181594-sh1-det-TC16.dgn
 PLOT DRIVER: plotttbl.tbl
 PEN TABLE:

FILE NAME =	USER NAME = footemj	DESIGNED -	REVISED -T. RAMMACHER 03-02-98
pw\1\181594\181594\INTEG\11nois.gov\PWIDOT\Documents\DOT Offices\District 1\Projects\Dist 1\CADData\CADsheets\tc16.dgn		DRAWN	REVISED -E. GOMEZ 08-28-00
		CHECKED -	REVISED -E. GOMEZ 08-28-00
PLOT SCALE = 50,0000 / 1		DATE - 09-18-94	REVISED -A. SCHUETZE 09-15-16

**STATE OF ILLINOIS
 DEPARTMENT OF TRANSPORTATION**

SHORT TERM PAVEMENT MARKING LETTERS AND SYMBOLS			
SCALE: NONE	SHEET NO. 1 OF 1 SHEETS	STA.	TO STA.

F.A.U. RTE.	SECTION	COUNTY	TOTAL SHEETS	SHEET NO.
2332	19-00007-00-R5	KANE	17	15
TC-16		CONTRACT NO. 61G17		
FED. ROAD DIST. NO. 1 ILLINOIS FED. AID PROJECT				

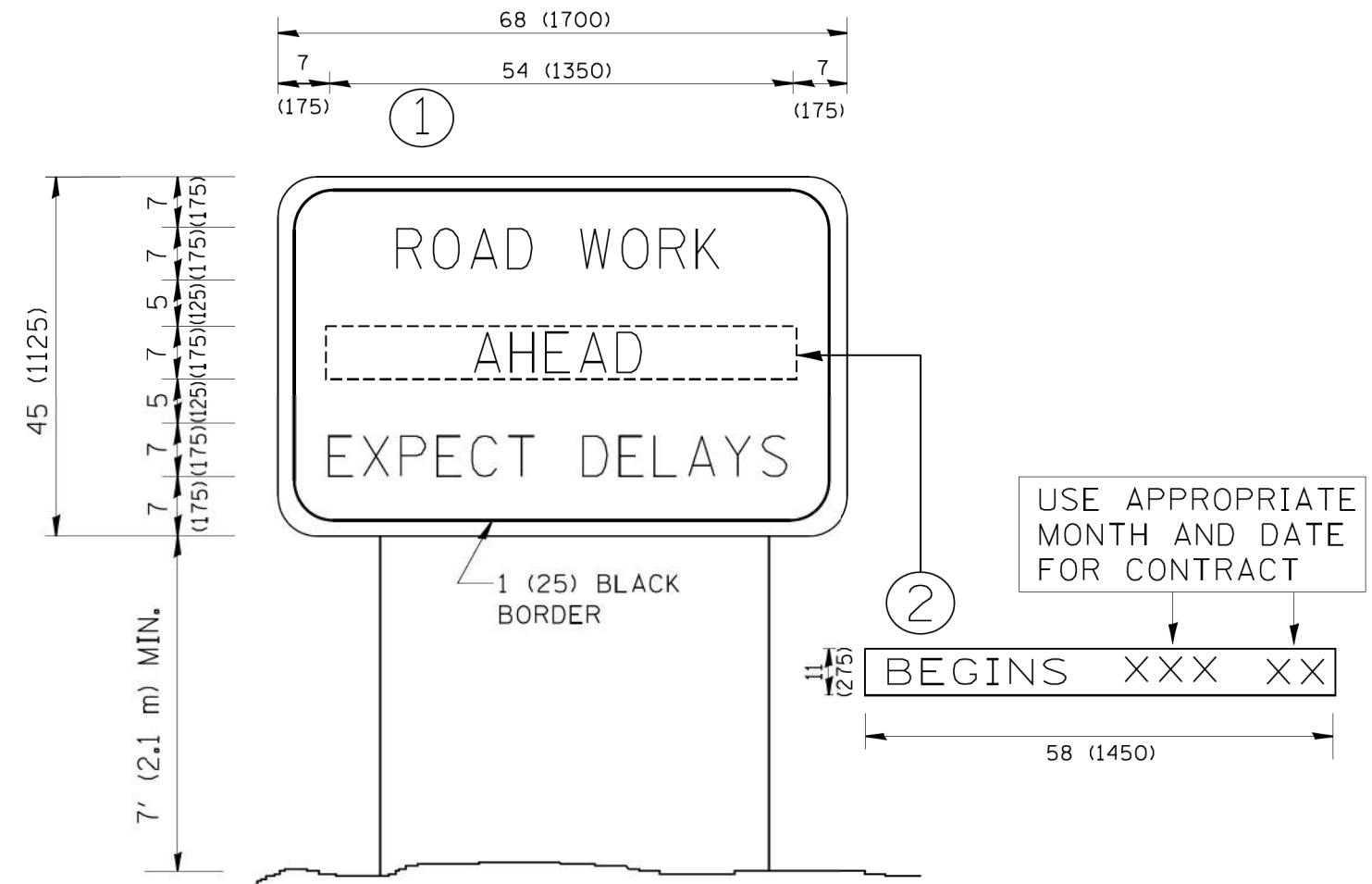

NOTES:

1. USE BLACK LETTERING ON ORANGE BACKGROUND.
2. ERECT SIGNS IN ADVANCE OF THE LOCATION FOR THE "ROAD CONSTRUCTION AHEAD" SIGN AT LOCATIONS AS DIRECTED BY THE ENGINEER.
3. ERECT SIGN ① WITH INSTALLED PANEL ② ONE WEEK PRIOR TO THE START OF CONSTRUCTION.
4. REMOVE PANEL ② SOON AFTER THE START OF CONSTRUCTION.
5. SEE SPECIAL PROVISION FOR "TEMPORARY INFORMATION SIGNING" FOR ADDITIONAL INFORMATION.
6. ONE SIGN ASSEMBLY EQUALS 25.70 SQ. FT. (2.3 SQ. M.)
7. SHALL BE PAID FOR AS TEMPORARY INFORMATION SIGNING.

ALL DIMENSIONS ARE IN INCHES (MILLIMETERS) UNLESS OTHERWISE SHOWN.

COMPANY NAME: #COMPANY NAME#
 PROJECT CONTACT: #PROJECT CONTACT#
 DATE PLOTTED: 11/13/2019 2:46:56 PM
 FILE NAME: 181594-sh1-det-TC22.dgn
 PLOT DRIVER: ILpdf.plt
 PEN TABLE: plotlabel.tbl

FILE NAME =	USER NAME = gegl1enobt	DESIGNED -	REVISED - R, MIRS 09-15-97
W:\diststd\22x34\tc22.dgn		DRAWN -	REVISED - R, MIRS 12-11-97
	PLOT SCALE = 50.000 ' / IN.	CHECKED -	REVISED - T. RAMMACHER 02-02-99
	PLOT DATE = 1/4/2008	DATE -	REVISED - C. JUCIUS 01-31-07

**STATE OF ILLINOIS
 DEPARTMENT OF TRANSPORTATION**

**ARTERIAL ROAD
 INFORMATION SIGN**

SCALE: NONE SHEET NO. 1 OF 1 SHEETS STA. TO STA.

F.A.U. RTE.	SECTION	COUNTY	TOTAL SHEETS	SHEET NO.
2332	19-00007-00-R5	KANE	17	16
TC-22		CONTRACT NO.	61G17	
FED. ROAD DIST. NO. 1 ILLINOIS FED. AID PROJECT				

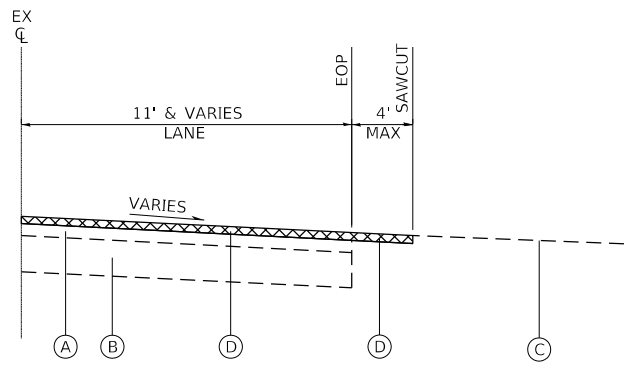

EXISTING / REMOVAL DETAIL

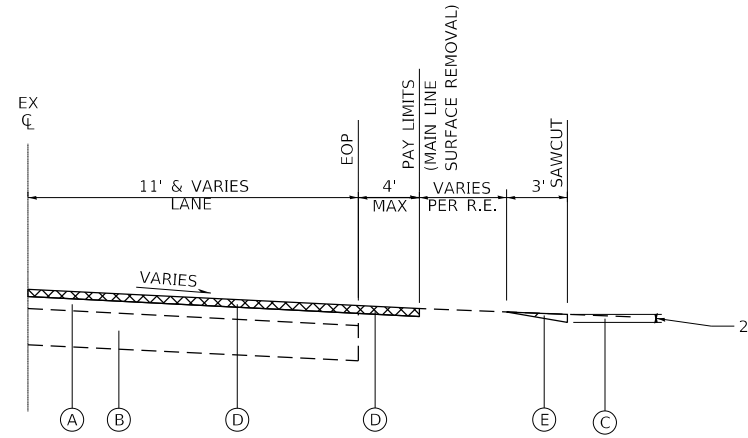

EXISTING / REMOVAL DETAIL

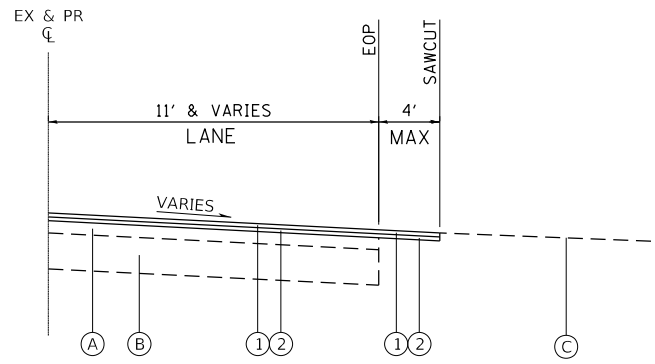

PROPOSED / RESURFACING DETAIL

CASE I

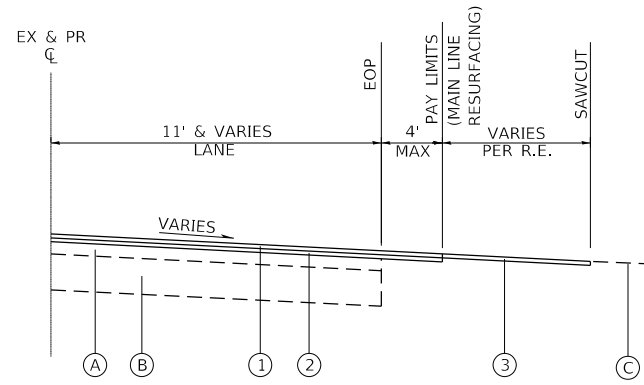

PROPOSED / RESURFACING DETAIL

CASE II

DRIVEWAY RESURFACING DETAILS

EXISTING LEGEND

- (A) EXISTING HOT-MIX ASPHALT PAVEMENT; ±10"-16"
- (B) EXISTING AGGREGATE BASE COURSE; ±8"
- (C) EXISTING DRIVEWAY PAVEMENT
- (D) HOT-MIX ASPHALT SURFACE REMOVAL (PER SQ YD)
- (E) HOT-MIX ASPHALT SURFACE REMOVAL, SPECIAL (PER SQ YD)

PROPOSED LEGEND

- (1) PROPOSED RESURFACING; HMA SURFACE COURSE, MIX 'D', IL-9.5, N50
- (2) PROPOSED RESURFACING; HMA BINDER COURSE, IL-19.0, N50
- (3) INCIDENTAL HOT-MIX ASPHALT SURFACING (PER TON)

HRG PROJECT NO.: #16194
 HRG PROJ. CONTACT:
 FILE NAME: #0594-SY1-def-CP-01.dgn
 PEN TABLE: p101tbl01.tbl



USER NAME = jstrzal	DESIGNED - JJS	REVISED - XX/XX/XXXX
	DRAWN - DMS	REVISED - XX/XX/XXXX
PLOT SCALE =	CHECKED -	REVISED - XX/XX/XXXX
PLOT DATE = 11/13/2019	DATE -	REVISED - XX/XX/XXXX

**STATE OF ILLINOIS
DEPARTMENT OF TRANSPORTATION**

BOLCUM ROAD CONSTRUCTION DETAILS			
SCALE: N.T.S.	SHEET 1	OF 1 SHEETS	STA. TO STA.

F.A.U. RTE.	SECTION NO.	COUNTY	TOTAL SHEETS	SHEET NO.
2332	19-00007-00-R5	KANE	17	17
FED. ROAD DIST. NO. ILLINOIS FED. AID PROJECT			CONTRACT NO. 61G17	