

STATE OF ILLINOIS
DEPARTMENT OF TRANSPORTATION

FAP RTE	SECTION	COUNTY	TOTAL SHEETS	SHEET NO.
317	D5 CM PATCH 2020-1	MCLEAN	7	1
		ILLINOIS	CONTRACT NO. 70E32	

PROPOSED HIGHWAY PLANS

ROUTE: FAP 317 / (US 24)
SECTION: D5 CM PATCH 2020-1
PATCHING
COUNTY: MCLEAN

FOR INDEX OF SHEETS, SEE SHEET NO. 2
FOR SUMMARY OF QUANTITIES, SEE SHEET NO. 3

CURRENT TRAFFIC DATA

LEG "A" US 24 FROM I-55 TO OLD ROUTE 66
LEG "B" US 24 FROM OLD ROUTE 66 TO THIRD AVE.
LEG "C" US 24 FROM THIRD AVE. TO THE LIVINGSTON CO. LINE

	LEG "A"	LEG "B"	LEG "C"
2019 ADT	7500	6250	4950
P.U. & P.C.	80.6	77.6	73.7
SUP%	9.7	8.0	7.1
MLP%	9.7	14.4	19.2

C-95-017-20

WEST OF I-55 TO THE LIVINGSTON COUNTY LINE

DESIGN DESIGNATION
O.P.A.

TOWNSHIP
CHENOA, YATES

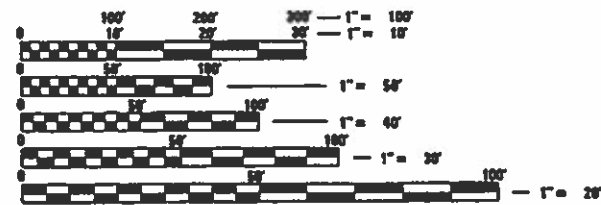

FULL SIZE PLANS HAVE BEEN PREPARED USING STANDARD ENGINEERING SCALES. REDUCED SIZED PLANS WILL NOT CONFORM TO STANDARD SCALES. IN MAKING MEASUREMENTS ON REDUCED PLANS, THE ABOVE SCALES MAY BE USED.

J.U.L.L.E.
JOINT UTILITY LOCATION INFORMATION FOR EXCAVATORS
1-800-892-0123
OR 811

PROJECT ENGINEER: JASON W. STULTS
SQUAD LEADER: GREG EAGLIN
PROJECT DESIGNER: MATTHEW W. MURPHY
PHONE NUMBER: 217-465-4181
CONTRACT NO. 70E32

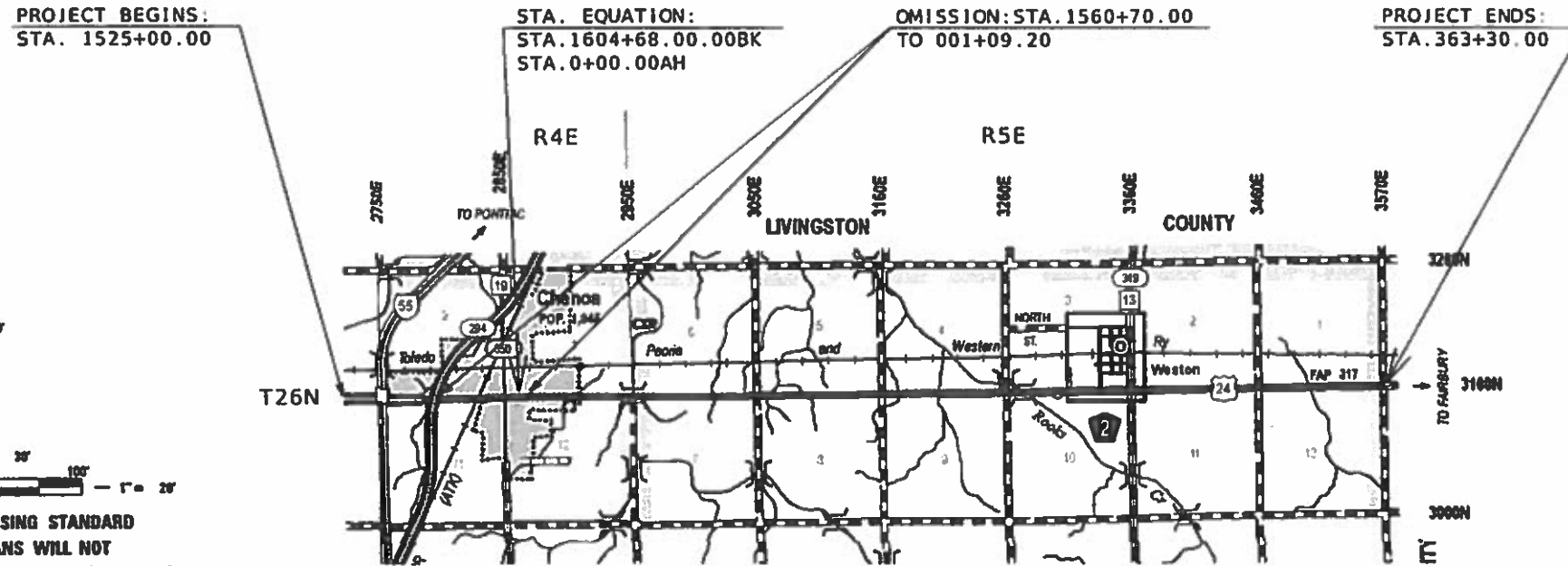

STA. EQUATION:
STA. 1604+68.00.00BK
STA. 0+00.00AH

OMISSION: STA. 1560+70.00
TO 001+09.20

PROJECT BEGINS:
STA. 1525+00.00

PROJECT ENDS:
STA. 363+30.00

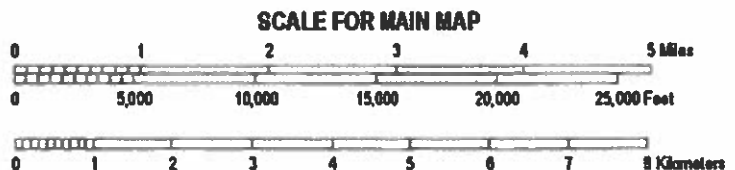

GROSS LENGTH = 44,290.00 FT. = 8.38 MILE
NET LENGTH = 39,790.8 FT. = 7.54 MILE

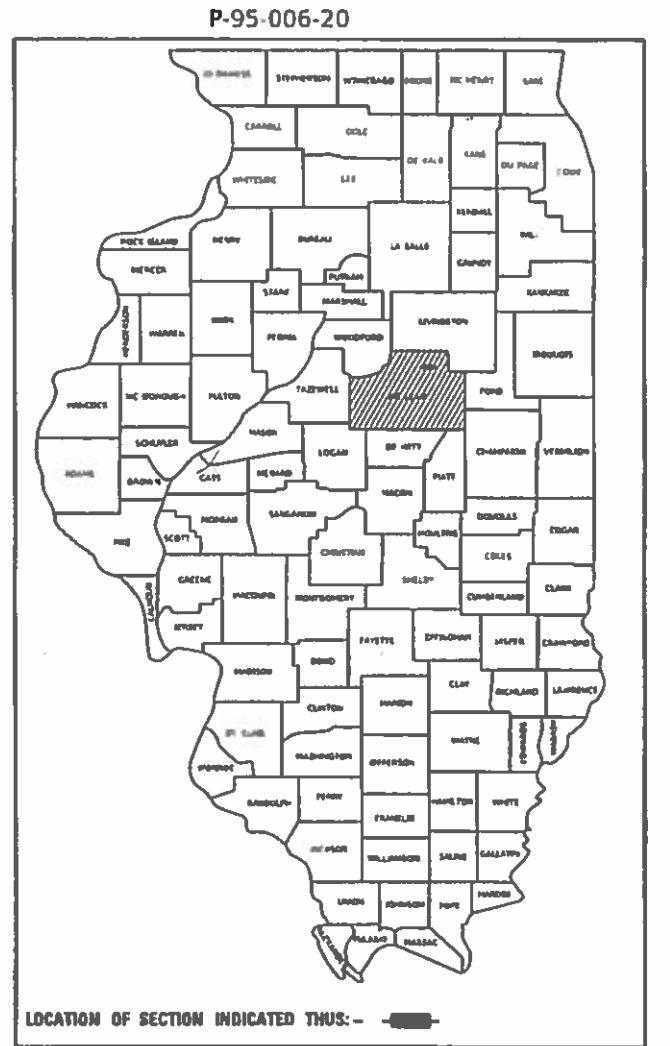

STATE OF ILLINOIS
DEPARTMENT OF TRANSPORTATION

SUBMITTED *December 11, 2019*

Jason W. Stults REGIONAL ENGINEER

Matthew W. Murphy ENGINEER OF DESIGN AND ENVIRONMENT

Jason W. Stults DIRECTOR OF HIGHWAYS PROJECT IMPLEMENTATION

PRINTED BY THE AUTHORITY
OF THE STATE OF ILLINOIS

INDEX OF SHEETS

SHEET NO.	DESCRIPTION
1	COVER SHEET
2	INDEX OF SHEETS, HIGHWAY STANDARDS, & GENERAL NOTES
3	SUMMARY OF QUANTITIES
4 - 6	EXISTING TYPICAL CROSS SECTIONS
7	SCHEDULES

LIST OF HIGHWAY STANDARDS

STANDARD NO.	DESCRIPTION
000001-07	STANDARD SYMBOLS, ABBREVIATIONS, AND PATTERNS
001006	DECIMAL OF AN INCH AND OF A FOOT
442201-03	CLASS C AND D PATCHES
701201-05	LANE CLOSURE , 2L, 2W DAY ONLY FOR SPEEDS \geq 45 MPH
701301-04	LANE CLOSURE, 2L, 2W, SHORT TIME OPERATIONS
701501-06	URBAN LANE CLOSURE, 2L, 2W, UNDIVIDED
701601-09	URBAN LANE CLOSURE, MULTILANE, 1W OR 2W WITH NONTRAVERSABLE MEDIAN
701901-08	TRAFFIC CONTROL DEVICES

GENERAL NOTES

G.N.-100A
ELECTRONIC FILES AND/OR ELECTRONIC SURVEY INFORMATION INCLUDING CADD FILES WILL NOT BE AVAILABLE TO THE CONTRACTOR.

G.N. -406H
MIXTURE REQUIREMENTS
THE FOLLOWING MIXTURE REQUIREMENTS ARE APPLICABLE FOR THIS PROJECT:

GN 406H Mixture Requirements Contract: 70E32

Location	U.S. 24	U.S. 24
Mixture Use	Class D Patching (Bottom Lift)	Class D Patching (Top 2")
AC/PG	PG 64-22	PG 64-22
Design Air Voids	4.0% @ Ndes=70	4.0% @ Ndes=70
Mix Comp(Gradation)	IL 19.0	IL 9.5
Friction Aggregate	N.A.	Mix D
Mixture Weight	112	112
Quality Management Program	QC/QA	QC/QA
Sublot Size	N.A.	N.A.

G.N.- 442B - PATCHING SCHEDULES
THE PATCHING SCHEDULES INCLUDED IN THE PLANS REPRESENT THE BEST INFORMATION AVAILABLE AT THE TIME OF COMPLETION OF THE PLANS FOR LETTING. VARIATIONS IN LOCATION AND SIZES OF THE FULL-DEPTH AND PARTIAL-DEPTH PATCHES MAY OCCUR.

COMMITMENTS: THERE ARE NO COMMITMENTS FOR THIS CONTRACT.

**STATE OF ILLINOIS
DEPARTMENT OF TRANSPORTATION**

**INDEX OF SHEETS, LIST OF HIGHWAY STANDARDS
& GENERAL NOTES**

USER NAME = MurphyMW	DESIGNED -	REVISED -
	DRAWN -	REVISED -
PLOT SCALE = 40.0000 ' / in.	CHECKED -	REVISED -
PLOT DATE = 12/11/2019	DATE -	REVISED -

SCALE: SHEET OF SHEETS STA. TO STA.

F.A.P. RTE.	SECTION	COUNTY	TOTAL SHEETS	SHEET NO.
317	D5 CM PATCH 2020-1	MCLEAN	7	2
CONTRACT NO. 70E32				
ILLINOIS FED. AID PROJECT				

SUMMARY OF QUANTITIES

LOCATION OF WORK: FAP 317 (U.S. 24)

RURAL

O.P.A

STA. 1525+00.00 TO STA. 363+30.00

MCLEAN COUNTY

100% STATE

CONSTRUCTION TYPE CODE: 0006

CODE NO.	ITEM	UNIT	TOTAL QUANTITY
44201777	CLASS D PATCHES, TYPE II, 11 INCH	SQ YD	160.0
44201815	CLASS D PATCHES, TYPE II, 14 INCH	SQ YD	1000.0
44201819	CLASS D PATCHES, TYPE III, 14 INCH	SQ YD	80.0
44201821	CLASS D PATCHES, TYPE IV, 14 INCH	SQ YD	120.0
67100100	MOBILIZATION	L SUM	1.0
X7010216	TRAFFIC CONTROL AND PROTECTION, (SPECIAL)	L SUM	1.0

MODEL: I:\MODEL\MHFE
 FILE: MHFE.dwg
 Path: \\hmc\com\ada\illinois\pwr\DOT\Documents\DOT_Offices\Illiniet\3\Projects\0570E32\CADDData\CAD\Sheet\0570E32-ctb-S.O.dgn

USER NAME = MurphyMW PLOT SCALE = 40.0000 ' / in. PLOT DATE = 12/11/2019	DESIGNED - DRAWN - CHECKED - DATE -	REVISED - REVISED - REVISED - REVISED -	STATE OF ILLINOIS DEPARTMENT OF TRANSPORTATION	SUMMARY OF QUANTITIES	<table border="1" style="width: 100%; border-collapse: collapse;"> <tr> <td style="font-size: 8px;">F.A.P. RTE.</td> <td style="font-size: 8px;">SECTION</td> <td style="font-size: 8px;">COUNTY</td> <td style="font-size: 8px;">TOTAL SHEETS</td> <td style="font-size: 8px;">SHEET NO.</td> </tr> <tr> <td style="text-align: center;">317</td> <td style="text-align: center;">D5 CM PATCH 2020-1</td> <td style="text-align: center;">MCLEAN</td> <td style="text-align: center;">7</td> <td style="text-align: center;">3</td> </tr> <tr> <td colspan="5" style="text-align: center; font-size: 8px;">CONTRACT NO. 70E32</td> </tr> </table>	F.A.P. RTE.	SECTION	COUNTY	TOTAL SHEETS	SHEET NO.	317	D5 CM PATCH 2020-1	MCLEAN	7	3	CONTRACT NO. 70E32				
F.A.P. RTE.	SECTION	COUNTY	TOTAL SHEETS	SHEET NO.																
317	D5 CM PATCH 2020-1	MCLEAN	7	3																
CONTRACT NO. 70E32																				
			SCALE:	SHEET OF SHEETS	STA. TO STA.	ILLINOIS FED. AID PROJECT														

EXISTING TYPICAL CROSS SECTION ①

STA. 1525+00.00 TO STA. 1526+09.45 ①

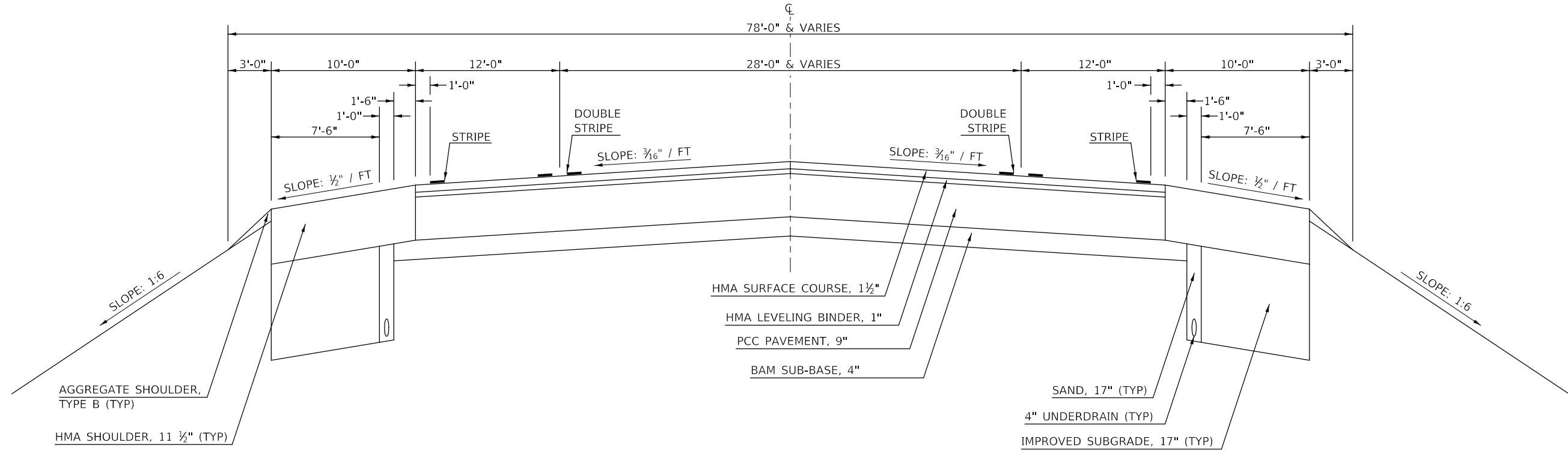

EXISTING TYPICAL CROSS SECTION ②

① STA. 1526+09.45 TO STA. 1557+55.78 ②

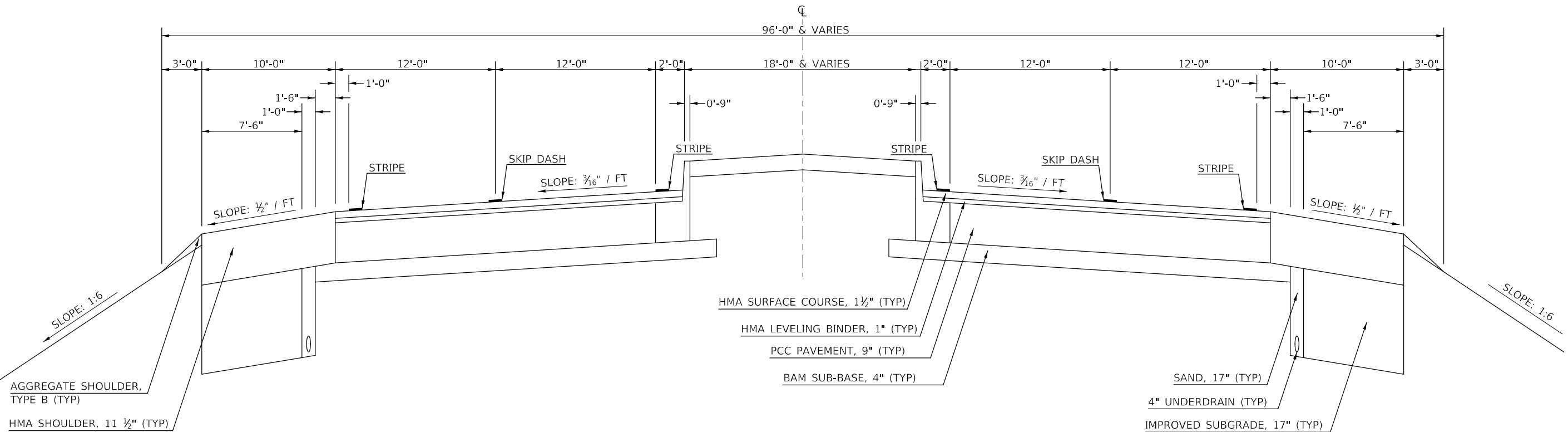

MODEL: \\MODEL\MAR\F...
 FILE: \\MAR\F...

USER NAME = MurphyMW	DESIGNED -	REVISED -
PLOT SCALE = 40.0000' / in.	DRAWN -	REVISED -
PLOT DATE = 12/11/2019	CHECKED -	REVISED -
	DATE -	REVISED -

STATE OF ILLINOIS
DEPARTMENT OF TRANSPORTATION

EXISTING TYPICAL CROSS SECTION
F.A.P. 317 (U.S. 24)

SCALE: NONE SHEET 1 OF 3 SHEETS STA. TO STA.

F.A.P. RTE.	SECTION	COUNTY	TOTAL SHEETS	SHEET NO.
317	D5 CM PATCH 2020-1	MCLEAN	7	4
ILLINOIS FED. AID PROJECT			CONTRACT NO. 70E32	

EXISTING TYPICAL CROSS SECTION ③
 ② STA. 1557+55.78 TO STA. 1560+57.61 ③

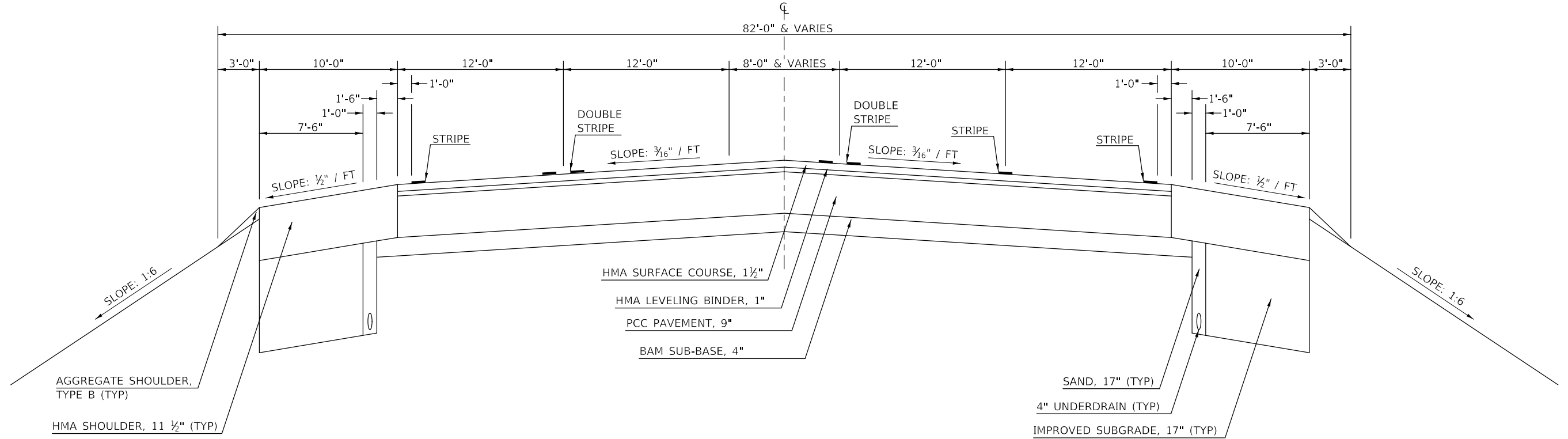

EXISTING TYPICAL CROSS SECTION ④
 ③ STA. 1560+57.61 TO STA. 1560+70.00

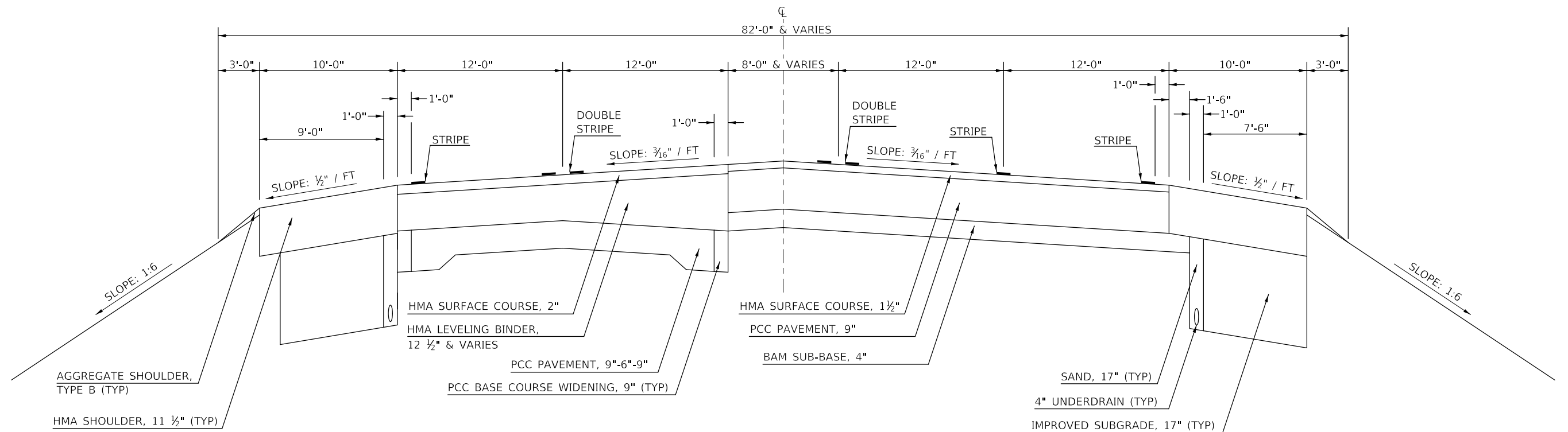

MODEL: \\MODEL\MAR\F...
 FILE: \\MAR\F...

USER NAME = MurphyMW	DESIGNED -	REVISED -
	DRAWN -	REVISED -
PLOT SCALE = 40.0000' / in.	CHECKED -	REVISED -
PLOT DATE = 12/11/2019	DATE -	REVISED -

**STATE OF ILLINOIS
DEPARTMENT OF TRANSPORTATION**

**EXISTING TYPICAL CROSS SECTION
F.A.P. 317 (U.S. 24)**

SCALE: NONE SHEET 2 OF SHEETS STA. TO STA.

F.A.P. RTE. 317	SECTION D5 CM PATCH 2020-1	COUNTY MCLEAN	TOTAL SHEETS 7	SHEET NO. 5
CONTRACT NO. 70E32			ILLINOIS FED. AID PROJECT	

EXISTING TYPICAL CROSS SECTION ⑤

STA. 01+09.20 TO STA. 23+80.00 ⑤

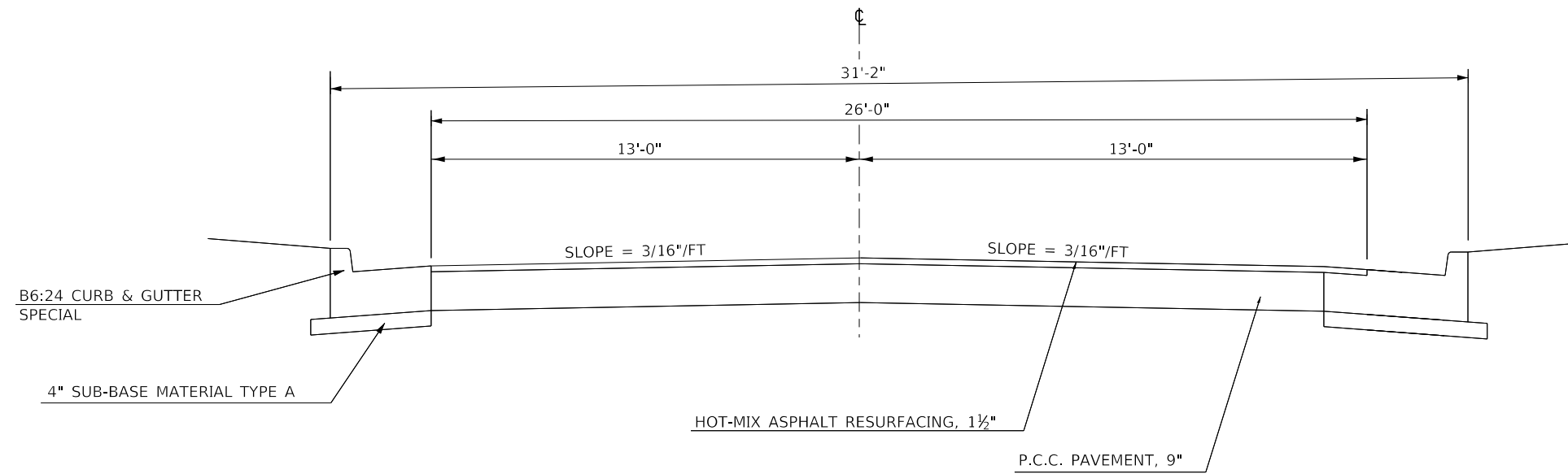

STRUCTURE OMISSION
STA. 43+40.38 TO 44+45.63
STA. 209+06.75 TO 210+64.25

EXISTING TYPICAL CROSS SECTION ⑥

⑤ STA. 23+80.00 TO STA. 363+30.00

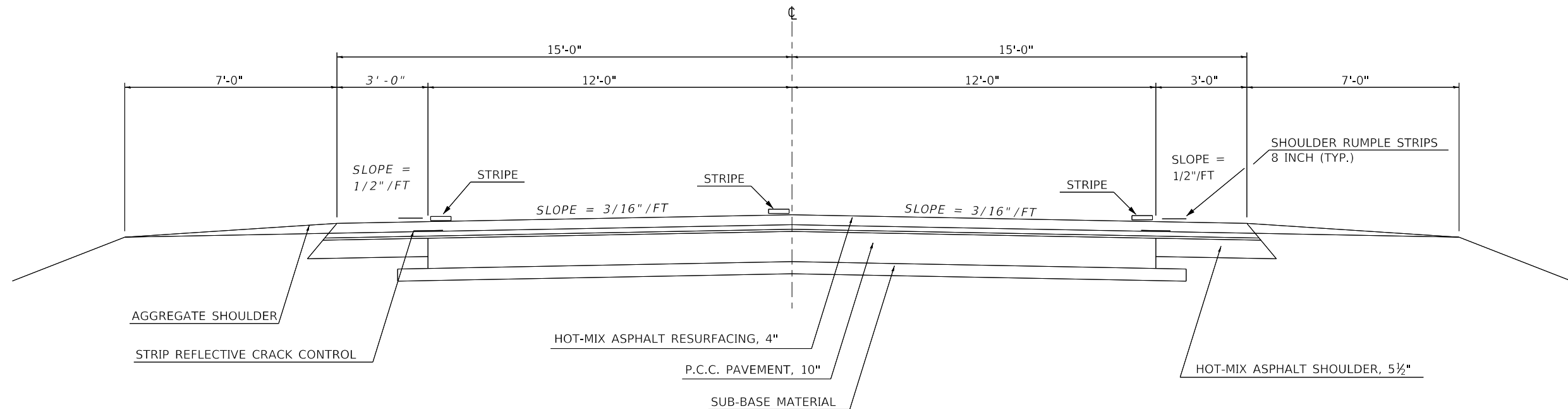

MODEL: \\MODEL\MAT\... FILE: \\MAT\... \Projects\0570E32\CADDData\CAD\Sheet\0570E32-shc-Typical.dgn

USER NAME = MurphyMW	DESIGNED -	REVISED -
	DRAWN -	REVISED -
PLOT SCALE = 40.0000 ' / in.	CHECKED -	REVISED -
PLOT DATE = 12/11/2019	DATE -	REVISED -

STATE OF ILLINOIS
DEPARTMENT OF TRANSPORTATION

EXISTING TYPICAL CROSS SECTION
F.A.P. 317 (U.S. 24)

SCALE: NONE SHEET 2 OF SHEETS STA. TO STA.

F.A.P. RTE.	SECTION	COUNTY	TOTAL SHEETS	SHEET NO.
317	D5 CM PATCH 2020-1	MCLEAN	7	6
CONTRACT NO. 70E32				
ILLINOIS FED. AID PROJECT				

