

089

03-06-2020 LETTING ITEM 089

STATE OF ILLINOIS
DEPARTMENT OF TRANSPORTATION

**PROPOSED
HIGHWAY PLANS**

FAP 789 (IL 143)
SECTION (125,125-1)RS-5
PROJECT NHPP-V9Q0(562)
RESURFACING - SMART IMPROVEMENTS
MADISON COUNTY

F.A.P.	SECTION	COUNTY	TOTAL SHEETS	SHEET NO.
789	(125,125-1)RS-5	MADISON	10	1
		ILLINOIS	CONTRACT NO. 76N07	

FOR INDEX OF SHEETS, SEE SHEET NO. 2

BRIDGE OMISSIONS		
STRUCTURE NO.	LOCATION	DECK LENGTH
060-0191	0.90 M.S. - 0.93 M.S.	172.20 FT.
060-0192	0.90 M.S. - 0.93 M.S.	176.20 FT.

	OASIS DR.	DRDA LN.
ADT (CONSTRUCTION YR.):	10300	8400
MUP%	1.3	1.8
SLP%	5.1	4.8
20 YR. FSAI'S:	1.92	1.92



C-98-047-20

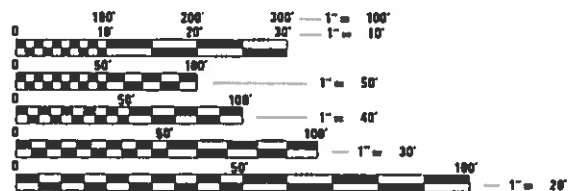
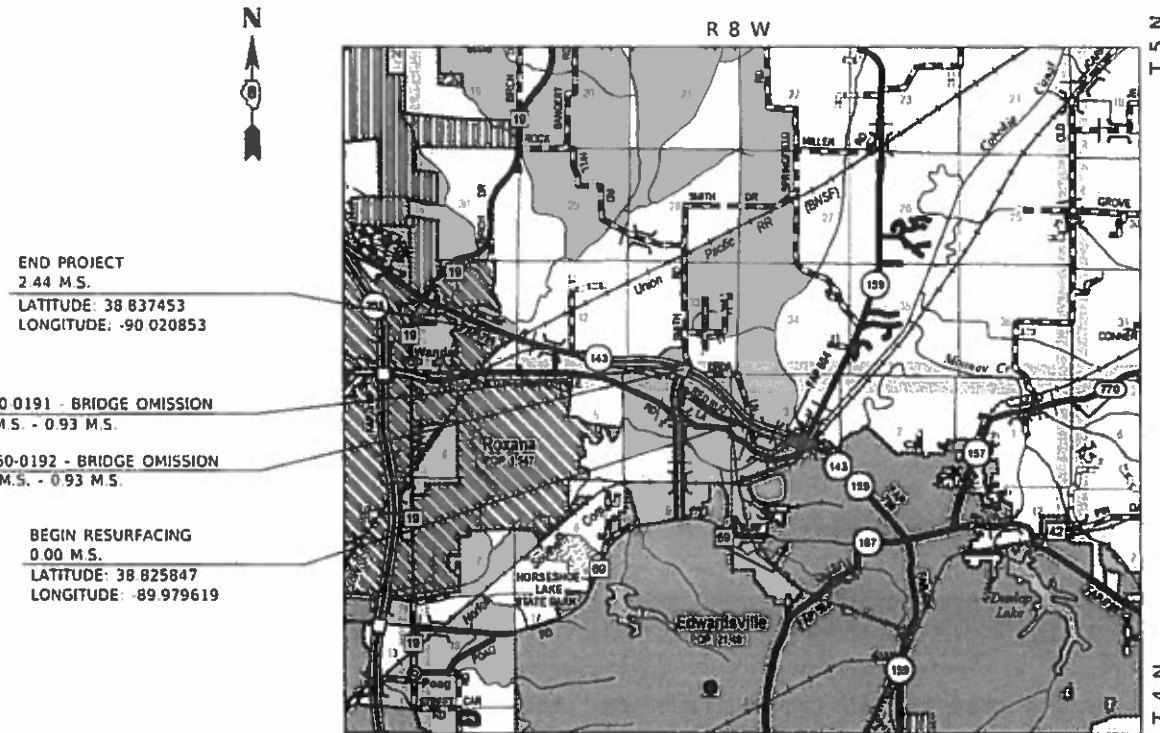

FULL SIZE PLANS HAVE BEEN PREPARED USING STANDARD ENGINEERING SCALES. REDUCED SIZED PLANS WILL NOT CONFORM TO STANDARD SCALES. IN MAKING MEASUREMENTS ON REDUCED PLANS, THE ABOVE SCALES MAY BE USED.

J.U.L.I.E.
JOINT UTILITY LOCATION INFORMATION FOR EXCAVATION
1-800-892-0123
OR 811

PROJECT ENGINEER: TIM PADGETT (618)346-3325
PROJECT MANAGER: DIANA MURRAY (618)346-3207

CONTRACT NO. 76N07

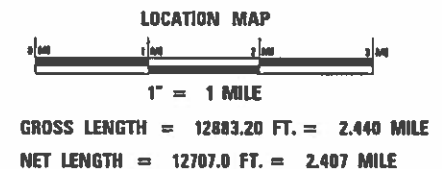

STATE OF ILLINOIS
DEPARTMENT OF TRANSPORTATION

SUBMITTED Dec 3 2019
Keith Roberts
REGIONAL ENGINEER

Jan 31 2020
Scott A. Etk
ENGINEER OF DESIGN AND ENVIRONMENT

Jan 31 2020
James J. ...
DIRECTOR OF HIGHWAYS PROJECT IMPLEMENTATION

PRINTED BY THE AUTHORITY
OF THE STATE OF ILLINOIS

PAVEMENT MARKING SCHEDULE

MILE STATION TO MILE STATION	LENGTH	SHORT TERM PAVEMENT MARKING			TEMPORARY & THERMOPLASTIC PAVEMENT MARKING								RAISED REFLECTIVE PAVEMENT MARKER REMOVAL	RAISED REFLECTIVE PAVEMENT MARKER (AMBER)	RAISED REFLECTIVE PAVEMENT MARKER (CRYSTAL)	TEMPORARY PAVEMENT MARKING REMOVAL	
		4" SKIP-DASH WHITE	4" SKIP-DASH YELLOW	SHORT TERM PAVEMENT MARKING REMOVAL	4" SOLID WHITE	4" SOLID YELLOW	4" SKIP-DASH WHITE	4" SKIP-DASH WHITE (ABBREVIATED)	4" SKIP-DASH YELLOW	NO PASSING ZONE		12" SOLID YELLOW					LETTERS AND SYMBOLS
		FOOT	FOOT	SQ FT	FOOT	FOOT	FOOT		FOOT	DIR	FOOT	FOOT					SQ FT
EASTBOUND																	
0.000 - 0.015	80	24	3	80		20								1		34	
0.015 - 0.138	650	148	20	650	650	170								8	8	490	
0.138 - 0.152	74	24	3			20								1	1	7	
0.152 - 0.158	32	24	3	32		10										14	
0.158 - 0.198	212	52	7	424	212	60								3	3	232	
0.198 - 0.245	249	72	10	249	249	70	70							3	3	213	
0.245 - 0.757	2704	612	83	2704	2704	680								34	34	2030	
0.757 - 0.90	756	172	23	756	756	190								9	9	568	
0.93 - 1.16	1215	292	40	1215	1215	310								15	15	914	
1.16 - 1.52	1901	440	60	1901	1901	480								24	24	1428	
1.52 - 1.54	106	28	3			30								1	1	10	
1.54 - 1.83	1532	344	47	1532	1532	390								19	19	1152	
1.83 - 1.93	528		17	528					EB-2	1056	192			14	14	592	
1.93 - 2.07	740		24	740										9	9	247	
2.10 - 2.44	1796		57	1796										22	22	599	
WESTBOUND																	
0.000 - 0.015	79	24	3	79		20								1	1	34	
0.015 - 0.037	116	48	7	116	116	30	30							1	1	98	
0.037 - 0.085	253	72	10	507	253	70								3	3	277	
0.085 - 0.139	285	72	10	570	285	80								4	4	312	
0.139 - 0.145	32	24	3	32		10										14	
0.145 - 0.153	42	24	3			20								1	1	7	
0.153 - 0.156	16	24	3	16	16											11	
0.156 - 0.90	3928	880	120	3928	3928	990								49	49	2949	
0.93 - 1.25	1690	388	53	1690	1690	430								21	21	1270	
1.25 - 1.53	1478	340	47	1478	1478	370								18	18	1109	
1.53 - 1.54	53	24	3			20								1	1	7	
1.54 - 1.74	1056	244	33	1056	1056	270								13	13	794	
1.74 - 1.83	475	120	17	475	475									6	6	317	
1.83 - 1.93	528		17	528					WB-2	1056						528	
1.93 - 1.94	53		4					20	EB	53						25	
1.94 - 2.02	422		14	422				110	EB	422						319	
2.02 - 2.12	528		17	528				140								223	
2.12 - 2.14	106		4					30								10	
2.14 - 2.18	211		7	211				60								91	
2.18 - 2.37	1003		34	1003					WB	1003						669	
2.37 - 2.40	158		7	158					BOTH	317						159	
2.40 - 2.41	53		4	53					BOTH	106						53	
2.41 - 2.44	158		7	158					BOTH	317						159	
RAMPS																	
EB ENTRANCE @ 0.75	1161				1407	915										774	
WB EXIT @ 0.94	504				1008									6	6	336	
EB EXIT @ 1.16	757				1225	289								9	9	505	
WB ENTRANCE @ 1.25	1185				1499	871										790	
LEFT TURN ARROWS																	
@ 0.094 - WB												15.6				16	
@ 0.130 - WB												15.6				16	
@ 0.168 - EB												15.6				16	
@ 0.189 - EB												15.6				16	
SUBTOTAL		4516	1240	830	30756	20592	4740	100	360		4330	192	62.4	298	46	252	20432
TOTAL			5756	830			60878					192	62.4	298	298		20432

MODEL: \\MODEL\MARIS
FILE: \\MARIS_Plan\Illinois\gov\PIWDOT\Documents\DOT_Offices\Illinois\Projects\076607\CADD\DATA\CAD\Inches\076607-Plan\Schedule.dgn

USER NAME = murrayda	DESIGNED - _____	REVISED - _____
	DRAWN - _____	REVISED - _____
PLOT SCALE = 2.0000' / in.	CHECKED - _____	REVISED - _____
PLOT DATE = 12/5/2019	DATE - _____	REVISED - _____

STATE OF ILLINOIS
DEPARTMENT OF TRANSPORTATION

SCHEDULE OF QUANTITIES			
SCALE: _____	SHEET 2	OF 3	SHEETS
STA. _____	TO STA. _____		

F.A.P. R.T.E.	SECTION	COUNTY	TOTAL SHEETS	SHEET NO.
789	(125,125-1) RS-5	MADISON	10	7
CONTRACT NO. 76N07				
ILLINOIS FED. AID PROJECT				

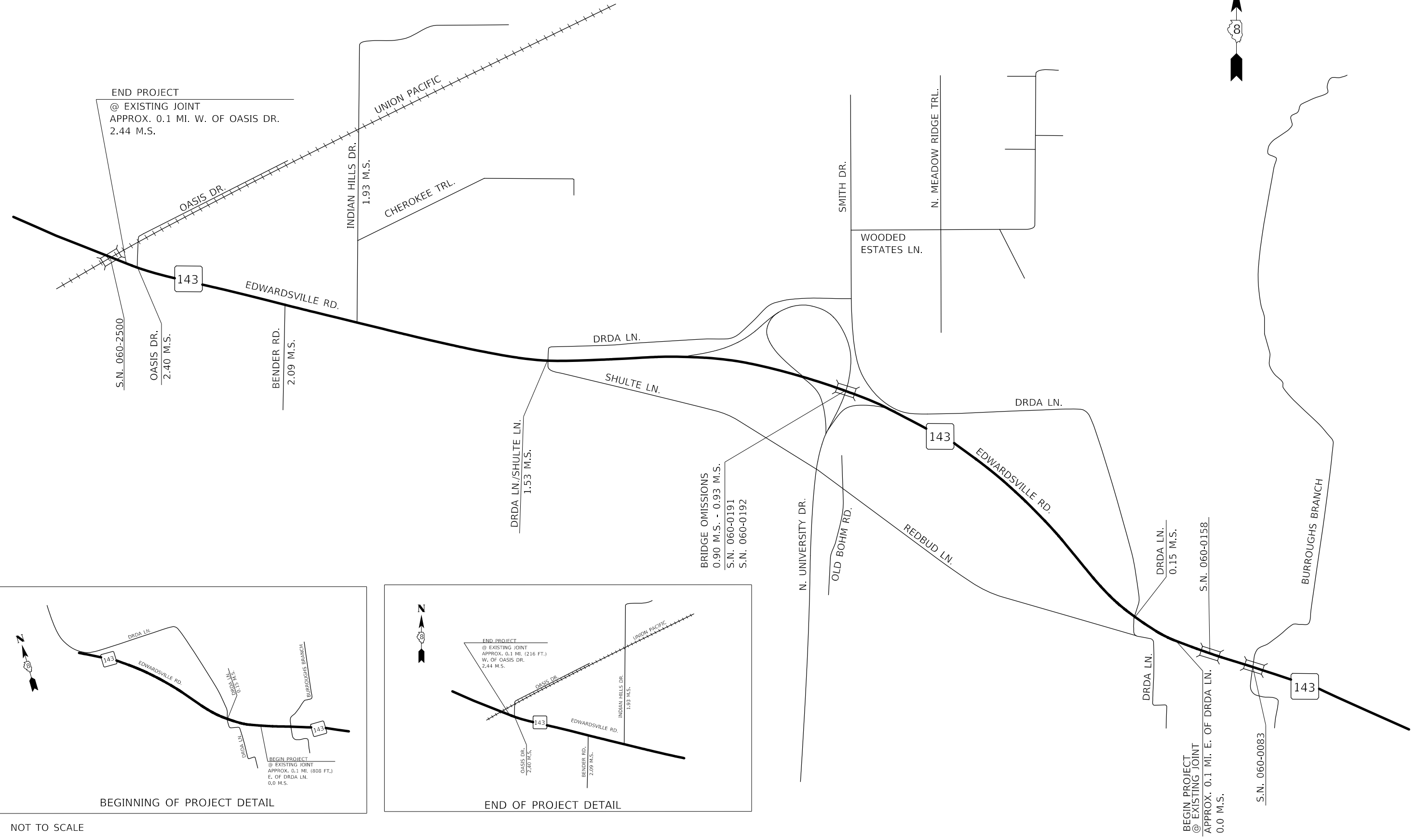

BRIDGE OMISSIONS
 0.90 M.S. - 0.93 M.S.
 S.N. 060-0191
 S.N. 060-0192

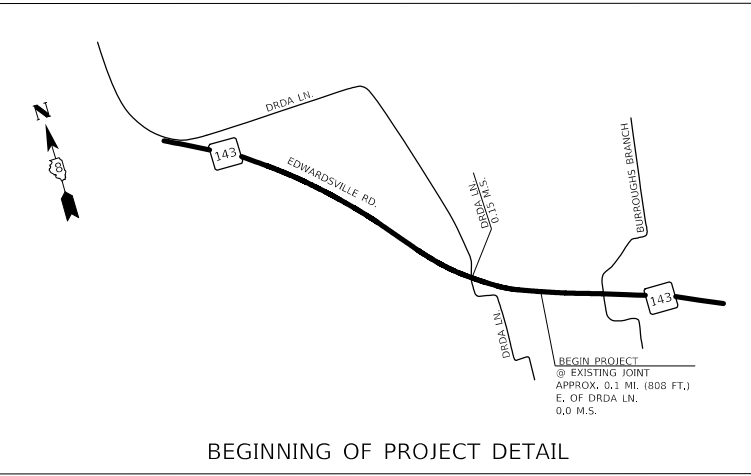

BEGINNING OF PROJECT DETAIL

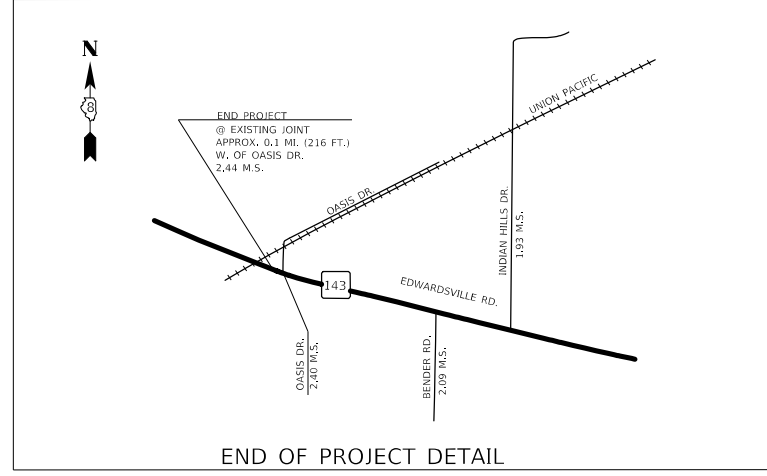

END OF PROJECT DETAIL

NOT TO SCALE

MODEL: \\MODELNAME
 FILE NAME: P:\p1\murrayda\illinois.gov\PHOTO\Documents\DOT_Offices\Dir\et 8\Projects\0676N07\CADD\DATA\CAD\pieces\0676N07-shc-plan.dgn

USER NAME = murrayda	DESIGNED - _____	REVISED - _____
DRAWN - _____	REVISIONS - _____	
PLOT SCALE = 2,000' / in.	CHECKED - _____	REVISED - _____
PLOT DATE = 11/19/2019	DATE - _____	REVISED - _____

**STATE OF ILLINOIS
 DEPARTMENT OF TRANSPORTATION**

LOCATION MAP

SCALE: _____ SHEET 1 OF 1 SHEETS STA. _____ TO STA. _____

F.A.P. RTE. 789	SECTION (125,125-1)RS-5	COUNTY MADISON	TOTAL SHEETS 10	SHEET NO. 9
CONTRACT NO. 76N07				
ILLINOIS FED. AID PROJECT				

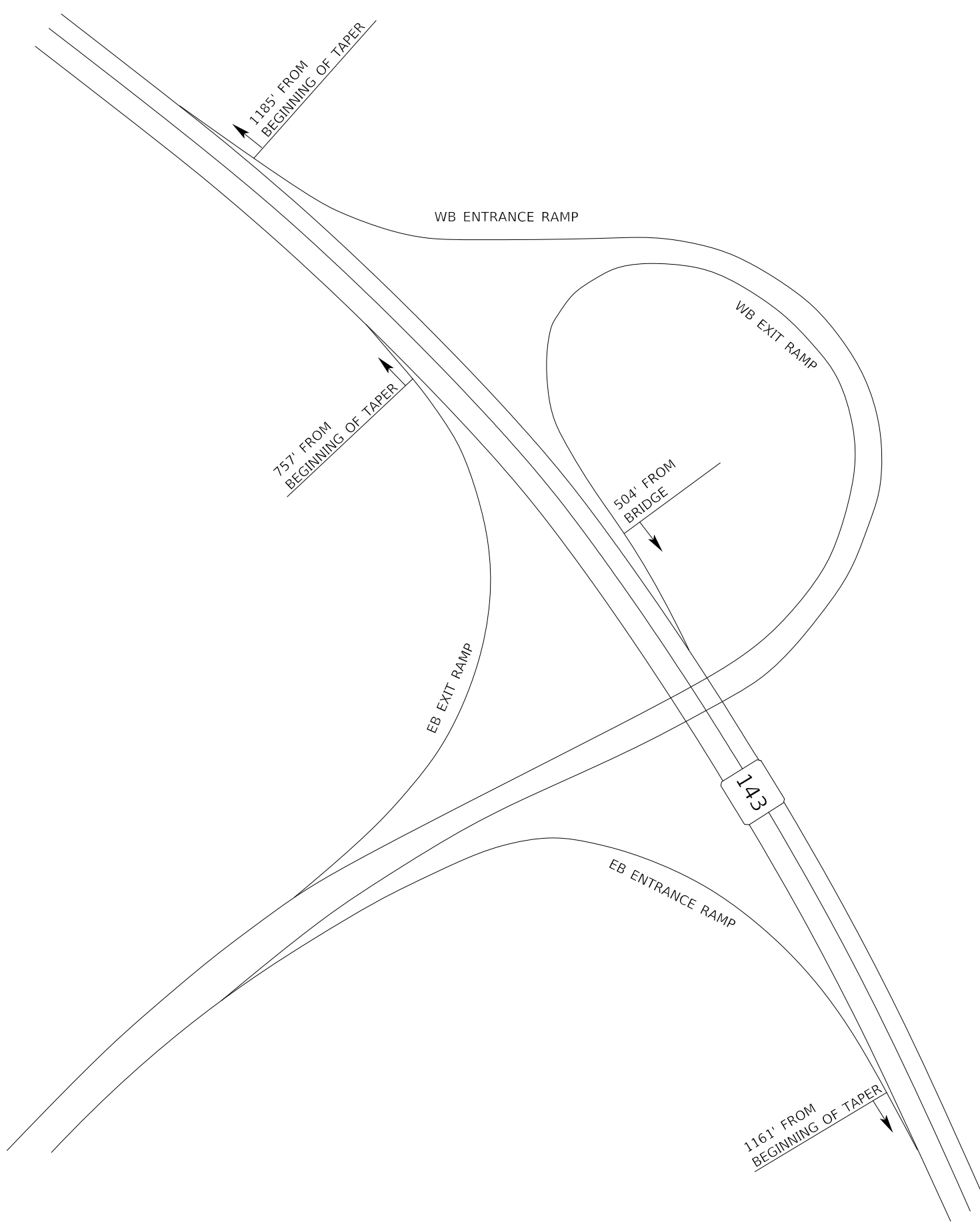

NOT TO SCALE

MODEL: s:\MODEL\MRFs
 FILE: MRFs_Plan\Illinois\mrf\76N07\CADD\Drawings\DOT_Offices\Drawings\DOT_76N07\76N07-1161-1161.dgn

USER NAME = murrayda	DESIGNED - _____	REVISED - _____
	DRAWN - _____	REVISED - _____
PLOT SCALE = 2,000' / in.	CHECKED - _____	REVISED - _____
PLOT DATE = 12/2/2019	DATE - _____	REVISED - _____

**STATE OF ILLINOIS
DEPARTMENT OF TRANSPORTATION**

RAMP DETAILS

SCALE: _____ SHEET 1 OF 1 SHEETS STA. _____ TO STA. _____

F.A.P. RTE.	SECTION	COUNTY	TOTAL SHEETS	SHEET NO.
789	(125,125-1)RS-5	MADISON	10	10
CONTRACT NO. 76N07			ILLINOIS FED. AID PROJECT	