

STATE OF ILLINOIS
DEPARTMENT OF TRANSPORTATION

FAI RTE	SECTION	COUNTY	TOTAL SHEETS	SHEET NO.
64	82-7PP-1	ST. CLAIR	15	1
		ILLINOIS	CONTRACT NO. 76M92	

FOR INDEX OF SHEETS, SEE SHEET NO. 2

PROPOSED HIGHWAY PLANS

FAI 64 ROUTE I-64
SECTION 82-7PP-1

PATCHING
ST. CLAIR COUNTY

C-98-029-20

D-98-015-20

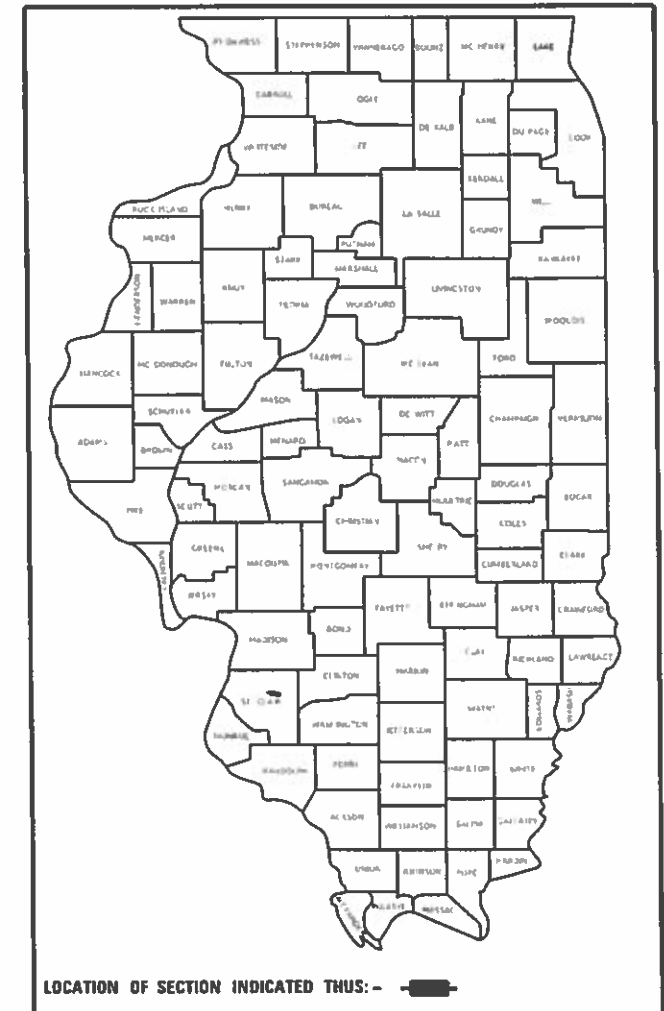

TRAFFIC DATA

2017 ADT = 59,200 (ACTUAL)
2020 ADT = 59,700 (ESTIMATED)
2028 ADT = 70,000 (ESTIMATED)
SU = 2.0% MU = 13.9%

FUNCTIONAL CLASSIFICATION

INTERSTATE

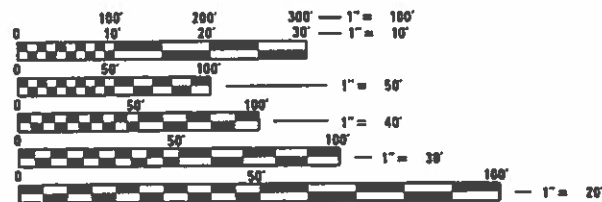

FULL SIZE PLANS HAVE BEEN PREPARED USING STANDARD ENGINEERING SCALES. REDUCED SIZED PLANS WILL NOT CONFORM TO STANDARD SCALES. IN MAKING MEASUREMENTS ON REDUCED PLANS, THE ABOVE SCALES MAY BE USED.

J.U.L.I.E.
JOINT UTILITY LOCATION INFORMATION FOR EXCAVATORS
1-800-892-0123
OR 811

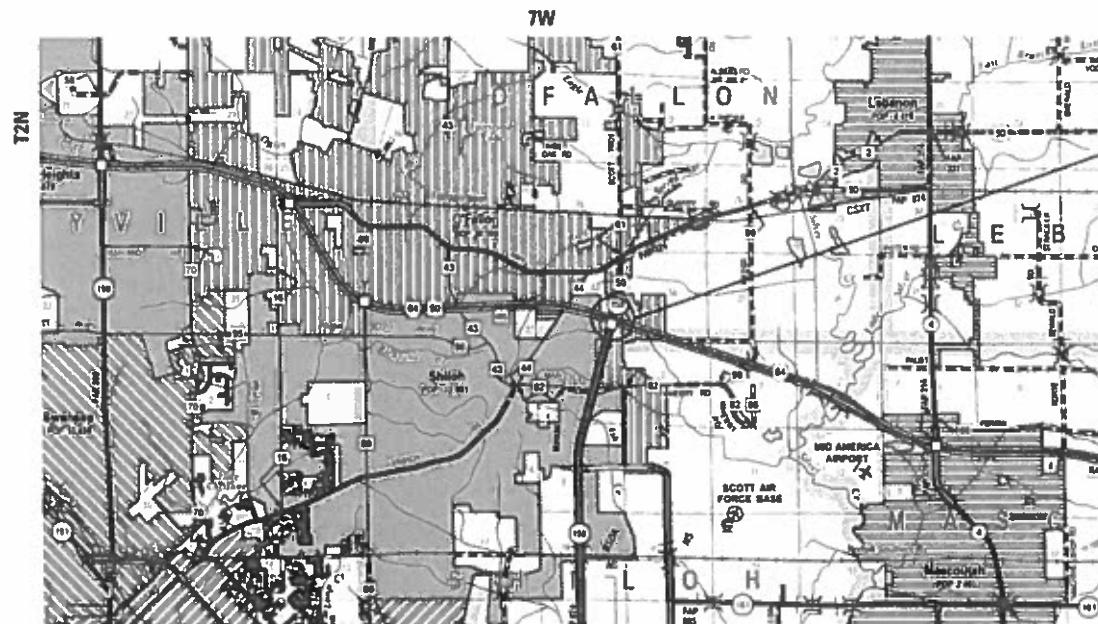

LOCATION MAP
(NOT TO SCALE)

PROJECT LOCATION
LATITUDE: 38.57288
LONGITUDE: -89.87614

PROJECT ENGINEER HERVE GELIN (618) 346-3179
PROJECT MANAGER HERVE GELIN (618) 346-3179

CONTRACT NO. 76M92

GROSS LENGTH = 640 FT. = 0.121 MILE
NET LENGTH = 640 FT. = 0.121 MILE

STATE OF ILLINOIS
DEPARTMENT OF TRANSPORTATION.

SUBMITTED Dec 6, 2019
Kaith Roberts
REGIONAL ENGINEER

Jan 31, 2020
E.A. Elk
ENGINEER OF DESIGN AND ENVIRONMENT

Jan 31, 2020
Jan 13
DIRECTOR OF HIGHWAYS PROJECT IMPLEMENTATION

PRINTED BY THE AUTHORITY
OF THE STATE OF ILLINOIS

INDEX OF SHEETS

1. COVER SHEET
2. GENERAL NOTES, INDEX OF SHEETS, STANDARDS, COMMITMENTS
- 3.-4. SUMMARY OF QUANTITIES
5. TYPICAL SECTIONS
6. SCHEDULE OF QUANTITIES
7. PLAN SHEET
8. STAGING SHEET
- 9.-12. DETOUR SHEETS
13. PAVEMENT MARKING SHEET
14. DETAILS
15. TRAFFIC CONTROL AND PROTECTION (SPECIAL) DETAIL

COMMITMENTS

NONE

HIGHWAY STANDARDS

- | | |
|-----------|--|
| 000001-07 | STANDARD SYMBOLS, ABBREVIATIONS AND PATTERNS |
| 001001-02 | AREAS OF REINFORCEMENT BARS |
| 001006 | DECIMAL OF AN INCH AND OF A FOOT |
| 442001-04 | CLASS A PATCHES |
| 701101-05 | OFF-ROAD OPERATIONS, MULTILANE, 15' (4.5 M) TO 24" (600 MM) FROM PAVEMENT EDGE |
| 701106-02 | OFF-ROAD OPERATIONS, MULTILANE, MORE THAN 15' (4.5 M) AWAY |
| 701400-09 | APPROACH TO LANE CLOSURE, FREEWAY/EXPRESSWAY |
| 701401-12 | LANE CLOSURE, FREEWAY/EXPRESSWAY |
| 701406-12 | LANE CLOSURE, FREEWAY/EXPRESSWAY, DAY OPERATIONS ONLY |
| 701411-09 | LANE CLOSURE, MULTILANE, AT EXIT OR ENTRANCE RAMP FOR SPEEDS ≥ 45 MPH |
| 701426-09 | LANE CLOSURE, MULTILANE, INTERMITTENT OR MOVING OPER., FOR SPEEDS ≥ 45 MPH |
| 701446-10 | TWO LANE CLOSURE FREEWAY/EXPRESSWAY |
| 701451-05 | RAMP CLOSURE FREEWAY/EXPRESSWAY |
| 701901-08 | TRAFFIC CONTROL DEVICES |

GENERAL NOTES

1. THE CONTRACTOR SHALL VERIFY ALL DIMENSIONS AND CONDITIONS IN THE FIELD PRIOR TO CONSTRUCTION AND ORDERING OF MATERIALS.
2. THE LOCATIONS OF THE REPAIR AREAS AS SHOWN IN THE PLANS ARE APPROXIMATE LOCATIONS. THE EXACT LOCATIONS SHALL BE DETERMINED BY THE ENGINEER.
3. ILLINOIS STATE LAW REQUIRES A 48-HOUR NOTICE TO BE GIVEN TO UTILITIES BEFORE DIGGING. FIELD MARKING OF FACILITIES MAY BE OBTAINED BY CONTACTING J.U.L.I.E. (1-800-892-0123 OR 811) OR FOR NON-MEMBERS THE UTILITY COMPANY DIRECTLY.
4. THE RESIDENT ENGINEER SHALL VERIFY THE EXISTENCE OF HIGHWAY LIGHTING AND/OR I.T.S. UTILITIES WITHIN THE PROJECT LIMITS. IF HIGHWAY LIGHTING AND/OR I.T.S. EXISTS WITHIN THE PROJECT LIMITS, AND IF THESE ITEMS REQUIRE LOCATING, THE CONTRACTOR SHALL BE DIRECTED TO DO SO ACCORDING TO SECTION 803 OF THE STANDARD SPECIFICATIONS.
5. THE PIPE UNDERDRAINS SHALL BE CONNECTED TO THE CROSSROAD CULVERTS AS SHOWN ON THE PLANS. PRIOR TO THE START OF THIS WORK, THE METHOD AND CONSTRUCTION OF THIS WORK SHALL BE APPROVED BY THE ENGINEER. ALL WORK TO MAKE THIS CONNECTION SHALL BE INCLUDED IN THE PAY ITEM PIPE UNDERDRAINS 4 INCH.
6. THE COST OF REMOVING THE EXISTING RAISED PAVEMENT MARKERS SHALL BE INCLUDED IN THE PAY ITEM CLASS A PATCHES TYPE IV, 14 INCH.
7. ALL TEMPORARY PAVEMENT MARKINGS WILL BE PLACED IN SUCH A MANNER SO AS NOT TO INTERFERE WITH THE PLACEMENT OF PERMANENT PAVEMENT MARKINGS.
8. ONLY NON-CHLORIDE CONCRETE ACCELERATOR WILL BE ACCEPTED ON THIS PROJECT. IF USED, THE ACCELERATOR SHALL MEET THE APPROVAL OF THE ENGINEER PRIOR TO POURING THE CONCRETE.

REV. - MS

MODEL: D:\default
 FILE: M:\MISC_Plan\planroom.dwg
 I:\Illinois.gov\PWIDOT\Documents\DOT_Offices\Districts\District\B\Project\0876493\CADD\03\CADD\03\0876493-01-01-01.dwg

USER NAME = dintelmanjn	DESIGNED -	REVISED -
	DRAWN -	REVISED -
PLOT SCALE = 100.0000' / in.	CHECKED -	REVISED -
PLOT DATE = 12/18/2019	DATE -	REVISED -

**STATE OF ILLINOIS
DEPARTMENT OF TRANSPORTATION**

**INDEX OF SHEETS, STANDARDS,
GENERAL NOTES, & COMMITMENTS**

SCALE: SHEET 1 OF 1 SHEETS STA. TO STA.

F.A.I. RTE.	SECTION	COUNTY	TOTAL SHEETS	SHEET NO.
64	82-7PP-1	ST. CLAIR	15	2
			CONTRACT NO. 76M92	
ILLINOIS FED. AID PROJECT				

CLASS A PAVEMENT PATCH										
LOCATION	EB/WB	AGG. BASE COURSE TYPE-A 12"	GEOTECHNICAL REINFORCEMENT	EXPANSION JOINT (SPECIAL)	CLASS A PATCHES, TYPE IV, 14"	DOWEL BARS 1 1/2"	TIE BARS 3/4"	SAW CUTS	PATCHING REINFORCEMENT	PROFILE DIAMOND GRINDING CONCRETE PAVEMENT
		(SQYD)	(SQYD)	(FOOT)	(SQYD)	(EACH)	(EACH)	(FOOT)	(SQYD)	(SQYD)
STA. 911+25.94 TO STA. 915+25.94	EB	1832	1832	81	1762	73	200	1477	1762	1762
STA. 911+25.94 TO STA. 915+25.94	WB	1850	1850	81	1733	75	200	1536	1733	1733
TOTAL		3682	3682	162	3495	148	400	3013	3495	3495

PIPE UNDERDRAIN SYSTEM SCHEDULE					
LOCATION		PIPE UNDERDRAIN 4"	PIPE UNDERDRAIN 4" (SPECIAL)	CONCRETE HEADWALL FOR PIPE DRAINS	SHOULDER REMOVAL AND REPLACEMENT 8"
STATION	TO STATION	FOOT	FOOT	EACH	FOOT
MAINLINE EB					
911+25.94	TO 916+62.94	537	30	2	547
MAINLINE WB					
910+23.94	TO 916+34.94	611	30	2	621
TOTAL :		1148	60	4	1168

LOCATION	PAINT PAVEMENT MARKING				RAISED REFLECTIVE PAVEMENT MARKERS	SHORT TERM PAVEMENT MARKING	SHORT TERM PAVEMENT MARKING REMOVAL	TEMPORARY PAVEMENT MARKING				TEMPORARY PAVEMENT MARKING REMOVAL			
	6"		8"					6"		8"					
	SOLID WHITE EDGE LINE	SKIP-DASH WHITE CENTERLINE	ABBREV. WHITE SKIP-DASH	SOLID WHITE				SOLID WHITE EDGE LINE	SKIP-DASH WHITE CENTERLINE	ABBREV. WHITE SKIP-DASH	SOLID WHITE				
STA.	TO	STA.	FOOT	FOOT	FOOT	FOOT	EACH	FOOT	SQ FT	FOOT	FOOT	FOOT	FOOT	SQ FT	
EB 64															
911+25.94	TO	913+25.94	400	100	100		10	80	27	400	100	100		167	
WB 64															
911+25.94	TO	913+25.94	400	100	100	75	10	80	27	400	100	100	75	217	
SUB-TOTAL			800	200	200	75	20	160	53	800	200	200	75	383	
TOTAL			1000		275		20	160	53	1000		275		383	

TEMP. CONCRETE BARRIER				
LOCATION			TEMP. CONC. BARRIER	IMPACT ATTENUATORS, TEMPORARY (NON-REDIRECTIVE), TEST LEVEL 3
STA.	TO	STA.	(FOOT)	(EACH)
STAGE 1 (EB)				
911+25.94	TO	915+25.94	688	1
STAGE 2 (WB)				
911+25.94	TO	915+25.94	688	1
TOTAL			1376	2

MODEL: Default
 FILE: \\nrcs-pix\pub\room\dat\illinois.gov\PWIDOT\Documents\DOT_Offices\Dir\ctc @ Projects\0776M92\CADD\ba\CAD\ba\sheet\0776M92-2hc-2ba-5.dgn

USER NAME = dintelmanjn	DESIGNED -	REVISED -
	DRAWN -	REVISED -
PLOT SCALE = 100.0000' / in.	CHECKED -	REVISED -
PLOT DATE = 12/18/2019	DATE -	REVISED -

STATE OF ILLINOIS
DEPARTMENT OF TRANSPORTATION



SCHEDULES

SCALE: SHEET 1 OF 1 SHEETS STA. TO STA.

F.A.I. RTE.	SECTION	COUNTY	TOTAL SHEETS	SHEET NO.
64	82-7PP-1	ST. CLAIR	15	6
CONTRACT NO. 76M92				
ILLINOIS FED. AID PROJECT				

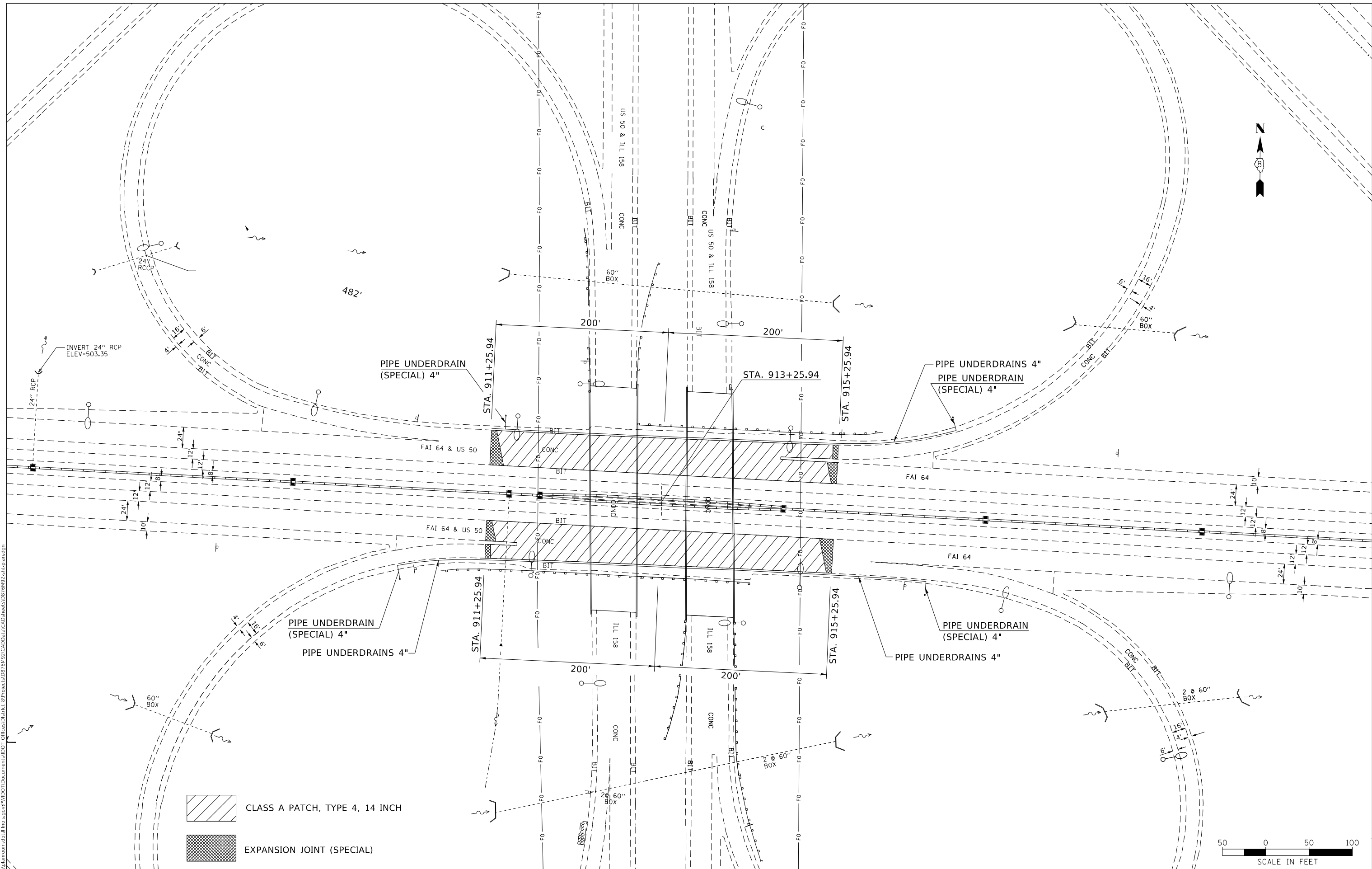
MODEL: Default
 FILE: \\nrcs-pub\pubroom.dca\illinois.gov\PIWDOT\Documents\DOT_Offices\District 8\Projects\ID76M92\CADD\Drawings\CD\Drawings\ID76M92-2hc-2bns.dgn

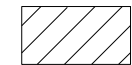

-  CLASS A PATCH, TYPE 4, 14 INCH
-  EXPANSION JOINT (SPECIAL)

USER NAME = dintelmanjn	DESIGNED -	REVISED -
	DRAWN -	REVISED -
PLOT SCALE = 100.0000' / in.	CHECKED -	REVISED -
PLOT DATE = 12/18/2019	DATE -	REVISED -

**STATE OF ILLINOIS
 DEPARTMENT OF TRANSPORTATION**

PLAN SHEET			
SCALE:	SHEET 1	OF 1	SHEETS
	STA.		TO STA.

F.A.I. RTE.	SECTION	COUNTY	TOTAL SHEETS	SHEET NO.
64	82-7PP-1	ST. CLAIR	15	7
ILLINOIS FED. AID PROJECT			CONTRACT NO. 76M92	

STAGING GENERAL NOTES:

THE CONTRACTOR WILL BE ALLOWED TO SAW CUT THE PAVEMENT FOR EACH STAGE UP TO THREE CALENDAR DAYS PRIOR TO THE START OF STAGE CONSTRUCTION.

THE STAGE CONSTRUCTION SHALL BE ACCOMPLISHED ON TWO SEPARATE WEEKENDS APPROVED BY THE ENGINEER.

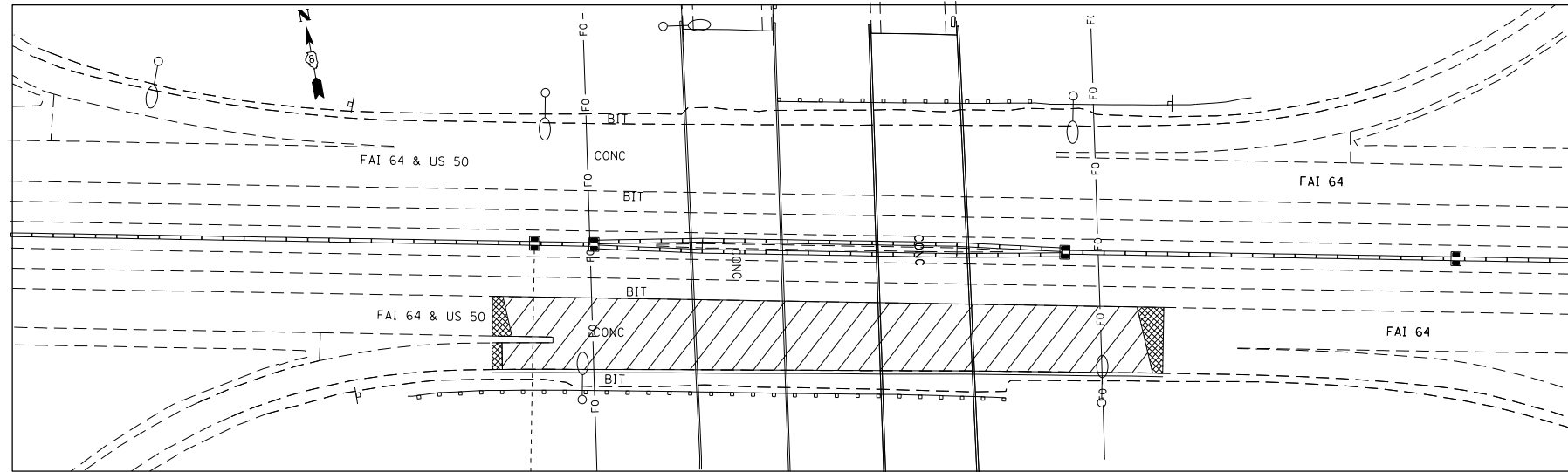

STAGE 1 CONSTRUCTION

STAGE 1 GENERAL NOTES:

THE CONTRACTOR SHALL MAINTAIN TWO 11 FOOT EASTBOUND TRAFFIC LANES.

THE CONTRACTOR SHALL PROVIDE STAGE I DETOUR SIGNING ACCORDING TO THE DETAILS IN THE PLANS AND PROVISIONS.

CHANGEABLE MESSAGE BOARDS SHALL BE USED TWO WEEKS PRIOR TO THE START OF AND DURING STAGE I CONSTRUCTION.

THE CONTRACTOR SHALL COMPLETE ALL WORK ASSOCIATED WITH STAGE 1 CONSTRUCTION, EXCEPT ITEMS RELATED TO DRAINAGE AND PAVEMENT MARKING, DURING ONE WEEKEND PERIOD (BETWEEN 7:00 PM FRIDAY AND 6:00 AM MONDAY).

RAMP FROM EAST BOUND I-64 TO NORTH BOUND IL 158 TO REMAN OPEN PER HIGHWAY STANDARD 701411.

PENALTY DURING PEAK HOUR SPECIAL PROVISION SHALL APPLY.

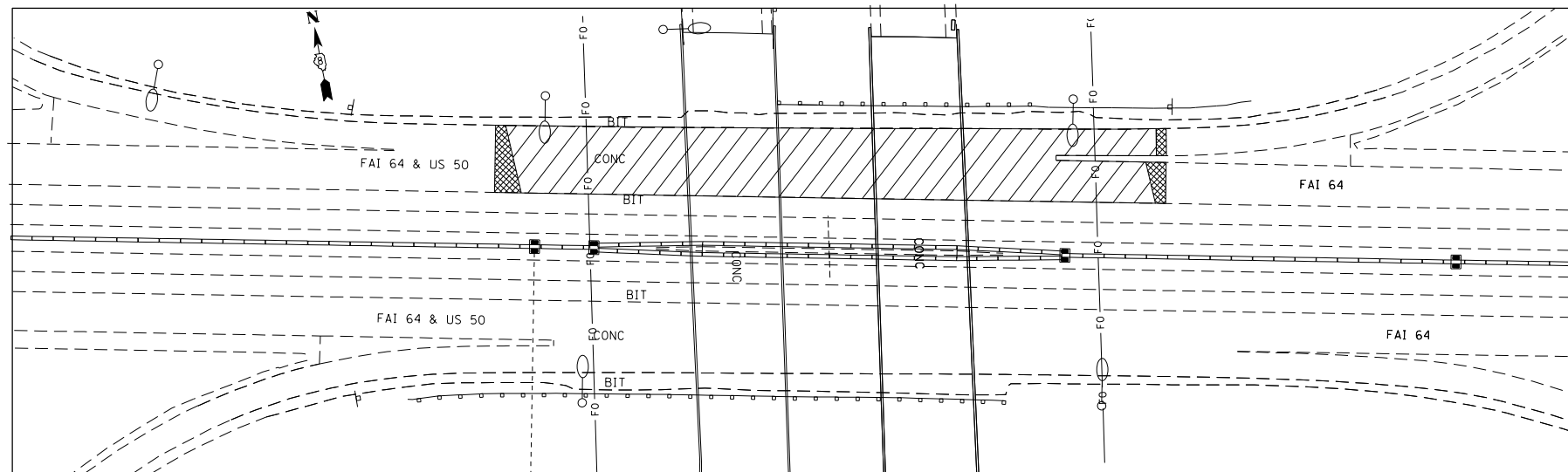

STAGE 2 CONSTRUCTION

STAGE 2 GENERAL NOTES:

THE CONTRACTOR SHALL MAINTAIN TWO 11 FOOT WESTBOUND TRAFFIC LANES.

THE CONTRACTOR SHALL PROVIDE STAGE II DETOUR SIGNING ACCORDING TO THE DETAILS IN THE PLANS AND PROVISIONS

CHANGEABLE MESSAGE BOARDS SHALL BE USED TWO WEEKS PRIOR TO THE START OF AND DURING STAGE II CONSTRUCTION.

THE CONTRACTOR SHALL COMPLETE ALL WORK ASSOCIATED WITH STAGE 2 CONSTRUCTION, EXCEPT ITEMS RELATED TO DRAINAGE AND PAVEMENT MARKING, DURING ONE WEEKEND PERIOD (BETWEEN 7:00 PM FRIDAY AND 5:00 AM MONDAY).

RAMP FROM WEST BOUND I-64 TO SOUTH BOUND IL 158 TO REMAN OPEN PER HIGHWAY STANDARD 701411.

PENALTY DURING PEAK HOUR SPECIAL PROVISION SHALL APPLY.

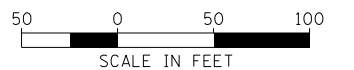

MODEL: Default
FILE: \\nashville.pw.gov\pub\lancorn.dta\illinois.gov\PWIDOT\Documents\DOT_Offices\District 8\Projects\0776M92\CADD\Drawings\0776M92-2-18-2019.dgn

USER NAME = dintelmanjn	DESIGNED -	REVISED -
	DRAWN -	REVISED -
PLOT SCALE = 100.0000' / in.	CHECKED -	REVISED -
PLOT DATE = 12/18/2019	DATE -	REVISED -

**STATE OF ILLINOIS
DEPARTMENT OF TRANSPORTATION**

STAGE CONSTRUCTION SHEET

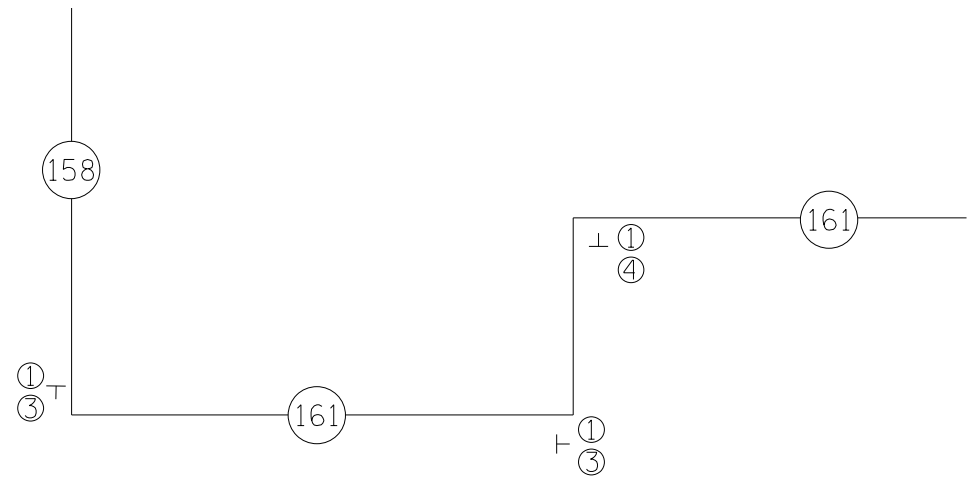
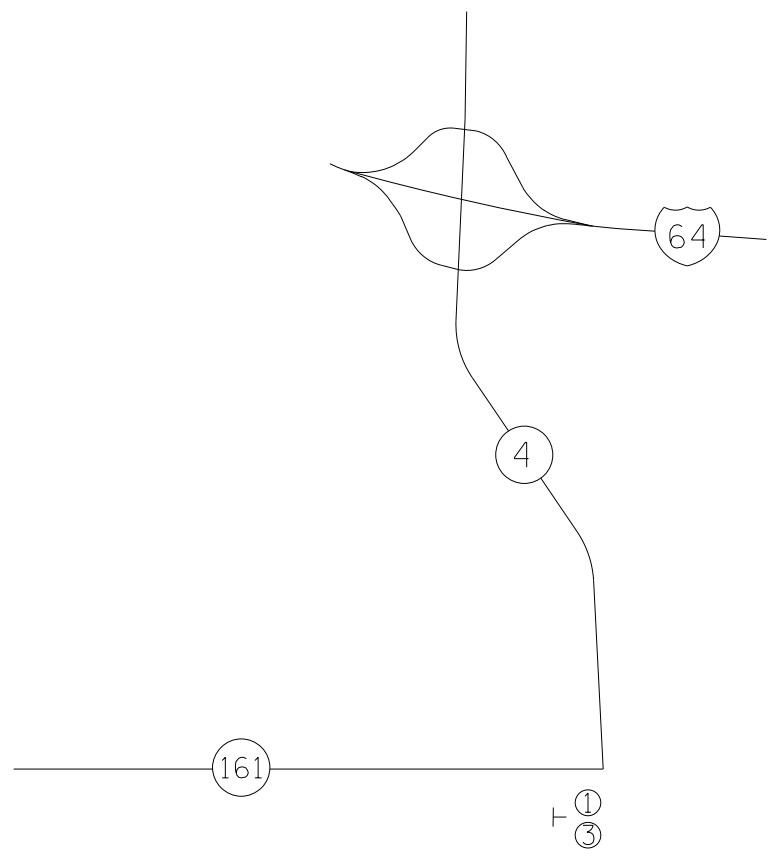
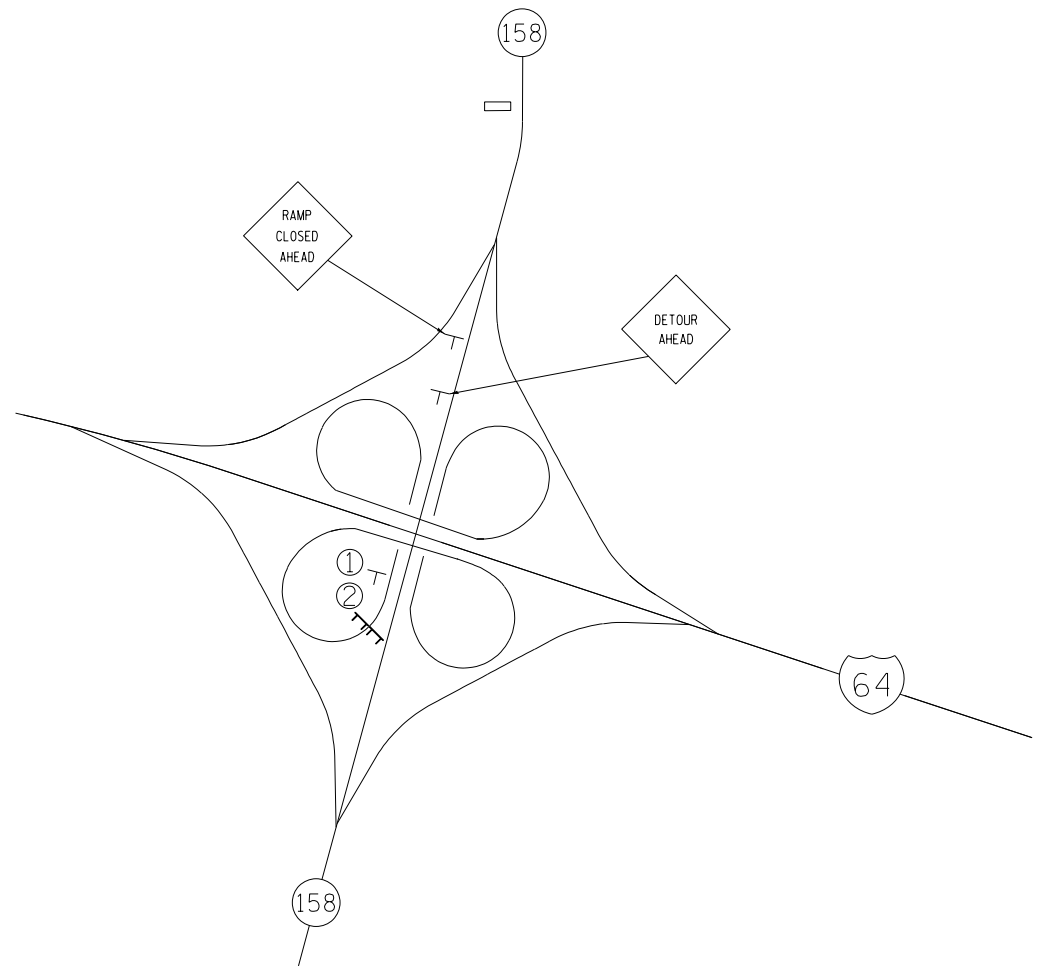
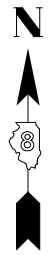

SCALE: SHEET 1 OF 1 SHEETS STA. TO STA.

F.A.I. RTE.	SECTION	COUNTY	TOTAL SHEETS	SHEET NO.
64	82-7PP-1	ST. CLAIR	15	8
				CONTRACT NO. 76M92
ILLINOIS FED. AID PROJECT				



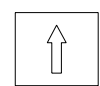
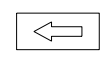
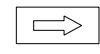

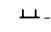
STAGE I SIGNING

- ①  5 EACH
- ②  1 EACH
- ③  3 EACH
- ④  1 EACH

 - TYPE 3 BARRICADES
 - MESSAGE BOARD

SIGNS TO BE PROVIDED BY IDOT

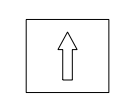
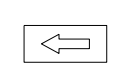
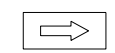
-  5 EACH
-  5 EACH
-  5 EACH
-  1
-  3 EACH
-  1 EACH

DRAWING NOT TO SCALE

MODEL: Default
 FILE: \\nrcs-pix\pub\room\dat\illinois\gov\PIVIDOT\Documents\IDOT_Offices\IDOT\B\Projects\IDOT\76M92\CADD\ba\CAD\sheet\IDOT\76M92-2hc-2ba-4.dgn

USER NAME = dintelmanjn	DESIGNED -	REVISED -
	DRAWN -	REVISED -
PLOT SCALE = 100.0000' / in.	CHECKED -	REVISED -
PLOT DATE = 12/18/2019	DATE -	REVISED -

**STATE OF ILLINOIS
 DEPARTMENT OF TRANSPORTATION**

STAGE 1 DETOUR

SCALE: SHEET 2 OF 2 SHEETS STA. TO STA.

F.A.I. RTE.	SECTION	COUNTY	TOTAL SHEETS	SHEET NO.
64	82-7PP-1	ST. CLAIR	15	10
CONTRACT NO. 76M92				
ILLINOIS FED. AID PROJECT				

MODEL: Default
 FILE: \\mhc-pw\pub\baronm.dwg
 PROJECT: \\mhc-pw\pub\baronm.dwg
 PLOT DATE: 12/18/2019

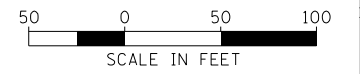
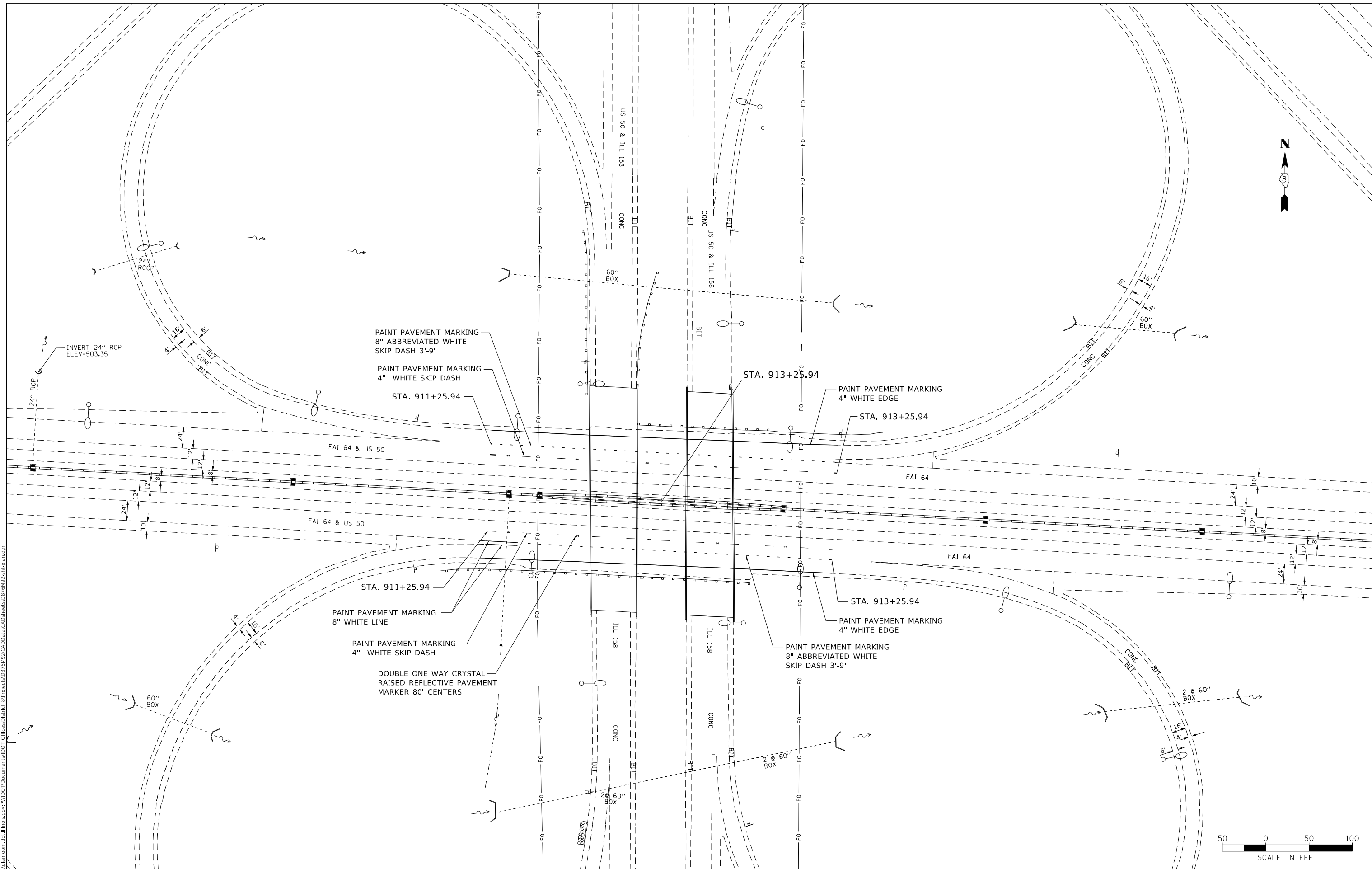

USER NAME = dintelmanjn	DESIGNED -	REVISED -
	DRAWN -	REVISED -
PLOT SCALE = 100.0000' / in.	CHECKED -	REVISED -
PLOT DATE = 12/18/2019	DATE -	REVISED -

**STATE OF ILLINOIS
 DEPARTMENT OF TRANSPORTATION**

PAVEMENT MARKING

SCALE: SHEET 1 OF 1 SHEETS STA. TO STA.

F.A.I. RTE.	SECTION	COUNTY	TOTAL SHEETS	SHEET NO.
64	82-7PP-1	ST. CLAIR	15	13
CONTRACT NO. 76M92				
ILLINOIS FED. AID PROJECT				

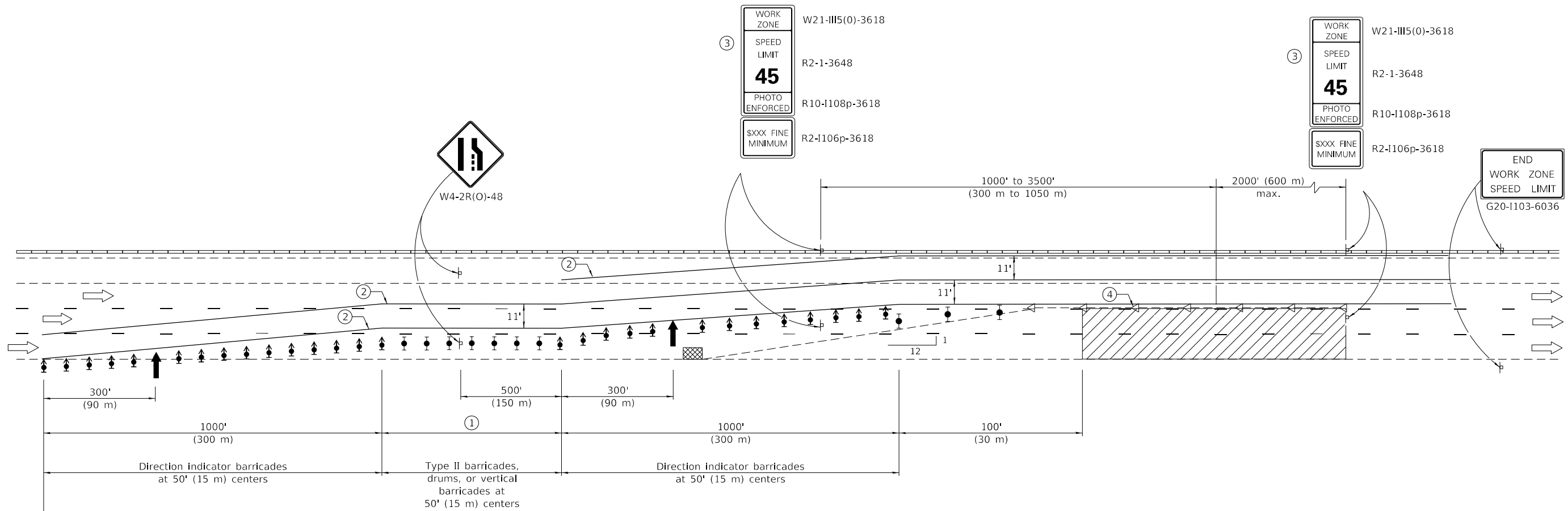

See Standard 701400 for approach
Start of lane closure taper

SYMBOLS

- Arrow board
- Work area
- Worker
- Sign
- Direction indicator barricade with steady burn monodirectional light
- Type II barricade, drum, or vertical barricade with steady burn monodirectional light
- Temporary concrete barrier
- Monodirectional guardrail/barrier wall reflector
- Impact attenuator

① The length of the tangent section shall be:

Duration of Closure	Length of Tangent Section
< 14 Days	1000' (300 m)
≥ 14 Days	2000' (600 m)

② ReflectORIZED temporary pavement marking tape shall be placed throughout the tapers and for 300' (90 m) along-side the work area when the closure time is greater than fourteen days. The edge line shall be white for right lane closures and yellow for left lane closures.

③ Work zone speed limits signs shall be moved as necessary to maintain the required spacing between the signs and the workers in each separate work activity. Work Zone Speed Limit 55 Photo Enforced sign shall be omitted when the work area dictates that placement of the sign array within 500' (150 m) of the End Work Zone Speed Limit sign.

④ Guardrail/barrier wall reflectors at 25' (7.6 m). Markers on right shall be crystal and markers on left shall be amber. See Standards 704001 and 782006.

GENERAL NOTES

This Standard is used where at any time any vehicle, equipment, workers or their activities will encroach on two lanes of a freeway/expressway.

This Standard must always be used in combination with Standard 701400.

This Standard also applies when work is being performed in the left lanes. Under these conditions, the set up would be a mirror image to what is shown.

Check barricades shall be placed in the middle of the closed lanes at 1000' (300 m) centers.

All dimensions are in inches (millimeters) unless otherwise shown.

MODEL: Default
FILE: \\nrc\p\planningroom\dat\illinois.gov\PIWDOT\Documents\DOT_Offices\Illin\ct\B\Projects\076M92\CADD\00a\CAD\Sheets\076M92-2bc-2a1a.dgn

USER NAME = dintelmanjn	DESIGNED -	REVISED -
	DRAWN -	REVISED -
PLOT SCALE = 100.0000' / in.	CHECKED -	REVISED -
PLOT DATE = 12/18/2019	DATE -	REVISED -

**STATE OF ILLINOIS
DEPARTMENT OF TRANSPORTATION**

TRAFFIC CONTROL AND PROTECTION (SPECIAL)

SCALE: SHEET 1 OF 1 SHEETS STA. TO STA.

F.A.I. RTE.	SECTION	COUNTY	TOTAL SHEETS	SHEET NO.
64	82-7PP-1	ST. CLAIR	15	15
CONTRACT NO. 76M92				
ILLINOIS FED. AID PROJECT				