

STATE OF ILLINOIS
DEPARTMENT OF TRANSPORTATION

FAU RTE.	SECTION	COUNTY	SHEETS	NO.
9110	31-15PP-1	MADISON	7	1
		ILLINOIS	CONTRACT NO. 76N31	

PROPOSED HIGHWAY PLANS

FAU ROUTE 9110 (VADALABENE DR)
SECTION 31-15PP-1

PATCHING - CM
MADISON COUNTY

C-98-073-20

FOR INDEX OF SHEETS, SEE SHEET NO. 2

TRAFFIC DATA - IL 159 TO CAMROSE GREEN
2016 ADT = 13900 (ACTUAL)
2020 ADT = 14800 (ESTIMATED)
2040 ADT = 19900 (ESTIMATED)
SU = 1.7% MU = 0.3%

TRAFFIC DATA - CAMROSE GREEN TO IL 162
2016 ADT = 3350 (ACTUAL)
2020 ADT = 3600 (ESTIMATED)
2040 ADT = 4800 (ESTIMATED)
SU = 1.3% MU = 0.5%

PROJECT ENDS: IL 159
38.731456
-89.956635
MI. STA. 0.96

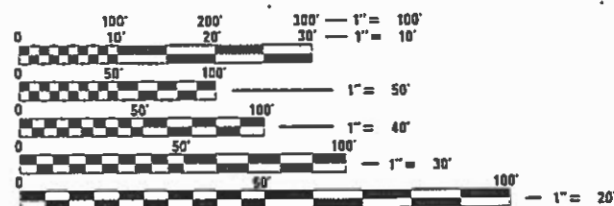
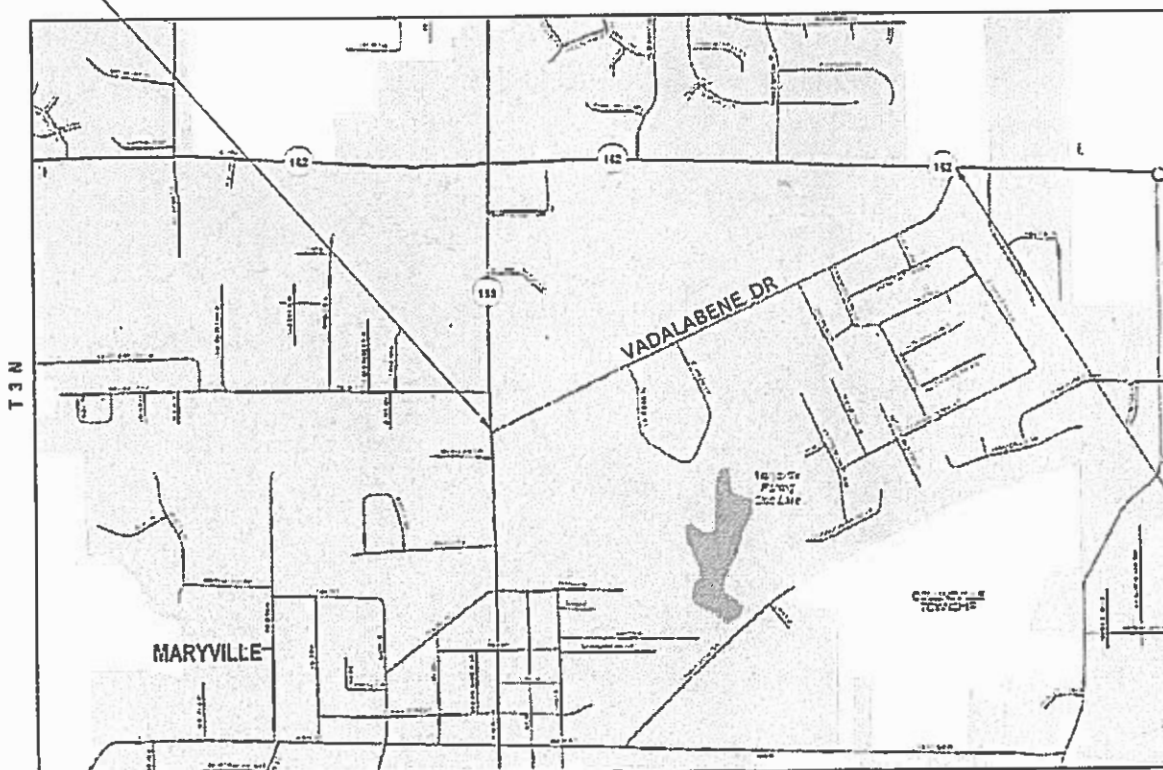

FULL SIZE PLANS HAVE BEEN PREPARED USING STANDARD ENGINEERING SCALES. REDUCED SIZED PLANS WILL NOT CONFORM TO STANDARD SCALES. IN MAKING MEASUREMENTS ON REDUCED PLANS, THE ABOVE SCALES MAY BE USED.

J.U.L.I.E.
JOINT UTILITY LOCATION INFORMATION FOR EXCAVATORS
1-800-892-0123
OR 811

PROJECT ENGINEER TIM PADGETT 618-346-3225
PROJECT MANAGER MARCEL LARE 618-346-3208

CONTRACT NO. 76N31



PROJECT BEGINS: IL 162
38.738012
-89.911619
MI. STA. 0.00

STATE OF ILLINOIS
DEPARTMENT OF TRANSPORTATION

SUBMITTED Jan 9 20
Keith Roberts REGIONAL ENGINEER

Jan 31 20
[Signature] ENGINEER OF DESIGN AND ENVIRONMENT

Jan 31 20
[Signature] 13
DIRECTOR OF HIGHWAYS PROJECT IMPLEMENTATION

PRINTED BY THE AUTHORITY
OF THE STATE OF ILLINOIS

SCALE
0 0.175 0.35 0.7 Miles

GROSS LENGTH = 5068.8 FT. = 0.96 MILE
NET LENGTH = 5068.8 FT. = 0.96 MILE

INDEX OF SHEETS

1. COVER SHEET
2. INDEX OF SHEETS, HIGHWAY STANDARDS, MIXTURE REQUIREMENTS, GENERAL NOTES, AND COMMITMENTS
3. SUMMARY OF QUANTITIES
4. TYPICAL SECTION AND PATCH DETAIL
5. SCHEDULES OF QUANTITIES
6. EXISTING DETECTOR LOOP DETAIL
7. LOCATION MAP

STANDARDS

- 000001-07 STANDARD SYMBOLS, ABBREVIATIONS AND PATTERNS
- 001006 DECIMAL OF AN INCH AND OF THE FOOT
- 442201-03 CLASS C & D PATCHES
- 701501-06 URBAN LANE CLOSURE, 2L, 2W, UNDIVIDED
- 701901-08 TRAFFIC CONTROL DEVICES

MIXTURE REQUIREMENTS

ROUTE	FAU 9110
SECTION	31-15PP-1
COUNTY	MADISON
CONTRACT	76N31

DESCRIPTION	PATCHING – VADALABENE DR FROM IL 162 TO IL 159
--------------------	---

ADT (CONSTRUCTION YR):	13900
MU%	0.3
SU%	1.7
20 YR. ESAL'S:	0.60

MIXTURE USE	PARTIAL DEPTH PATCHING	FULL DEPTH PATCHING	
		BINDER	SURFACE
AC/PG	PG 64-22	PG 64-22	PG 64-22
RAP % (MAX)	SEE SPECIAL PROVISION	SEE SPECIAL PROVISION	SEE SPECIAL PROVISION
DESIGN AIR VOIDS	4.0% @ Ndes = 70	4.0% @ Ndes = 70	4.0% @ Ndes = 70
MIX COMPOSITION (GRADATION MIXTURE)	IL 9.5	IL 19.0	IL 9.5
FRICTION AGG	MIXTURE "D"	MIXTURE "B"	MIXTURE "D"
QUALITY MGMT PROGRAM	QC /QA	QC /QA	QC /QA

GENERAL NOTES

1. ILLINOIS STATE LAW REQUIRES A 48-HOUR NOTICE TO BE GIVEN TO ALL UTILITIES WITHIN THE PROJECT AREA BEFORE DIGGING. FIELD MARKING OF FACILITIES MAY BE OBTAINED BY CONTACTING J.U.L.I.E. (1-800-892-0123 OR 811) FOR NON-MEMBERS, THE UTILITY COMPANY DIRECTLY.
2. THE CONTRACTOR AND THE ENGINEER SHALL BE AWARE THAT NO SURVEY WAS PERFORMED FOR THIS PROJECT. THE STATIONING, TOPOGRAPHY, AND QUANTITIES SHOWN IN THE PLANS WERE CREATED USING MICROFILM AND FIELD MEASUREMENTS. ALL SHALL BE ASSUMED TO BE APPROXIMATE. THE CONTRACTOR SHALL VERIFY DIMENSIONS AND CONDITIONS IN THE FIELD PRIOR TO CONSTRUCTION AND ORDERING OF MATERIALS.
3. THE DEPARTMENT STRONGLY ENCOURAGES THE PRIME CONTRACTOR AND THEIR APPROVED SUB-CONTRACTORS TO HIRE MINORITY, WOMEN AND DISADVANTAGED INDIVIDUALS FROM ITS FEDERALLY FUNDED HIGHWAY CONSTRUCTION CAREERS TRAINING PROGRAM (HCCTP) TO HELP MEET WORKFORCE AND TRAINEE GOALS. THIS PROGRAM IS TRAINING MINORITIES, WOMEN AND DISADVANTAGED INDIVIDUALS IN HIGHWAY CONSTRUCTION-RELATED SKILLS, E.G., MATH FOR THE TRADES, JOB READINESS, TECHNICAL SKILLS COURSEWORK (CARPENTRY, CONCRETE FLATWORK, BLUEPRINT READING, SITE PLANS, SITE WORK, TOOLS USE, ETC.) AND OSHA 10 HOUR CERTIFICATION, TO PREPARE THEM FOR A CAREER IN THE HIGHWAY CONSTRUCTION TRADES. GRADUATES ARE WELL-TRAINED AND READY TO BECOME PRODUCTIVE ENTRY-LEVEL CONSTRUCTION WORKERS. CONTACT THE DISTRICT 8 EEO OFFICE AT 618-346-3360 AND/OR THE HCCTP COORDINATOR AT 618-874-6528 TO LEARN MORE ABOUT THE PROGRAM AND FOR ASSISTANCE IN MEETING WORKFORCE AND TRAINEE GOALS.
4. NO OVERNIGHT LANE CLOSURES WILL BE PERMITTED.
5. THE CONTRACTOR SHALL EXERCISE CAUTION TO NOT DAMAGE DETECTOR LOOPS OR LEAD-IN WIRES. ANY DAMAGE SHALL BE REPAIRED AT THE CONTRACTOR'S EXPENSE. NO ADDITIONAL COMPENSATION WILL BE ALLOWED.
6. 200 FEET OF PAINT PAVEMENT MARKING - LINE 4" HAS BEEN PROVIDED FOR PAVEMENT MARKINGS AFFECTED DURING THE PATCHING.

COMMITMENTS

NONE

MODEL: I:\MODEL\MRFS
 FILE: MRFS_Plan\p15m100m.dwg
 I:\Projects\076N31\CADDData\CAD\Drawings\076N31-15-15-2020.dwg

USER NAME = laremd	DESIGNED -	REVISED -
	DRAWN -	REVISED -
PLOT SCALE = 100,0000 ' / in.	CHECKED -	REVISED -
PLOT DATE = 1/9/2020	DATE -	REVISED -

**STATE OF ILLINOIS
DEPARTMENT OF TRANSPORTATION**

**INDEX OF SHEETS, HIGHWAY STANDARDS, MIXTURE REQUIREMENTS,
GENERAL NOTES AND COMMITMENTS**

SCALE: SHEET 1 OF 1 SHEETS STA. TO STA.

F.A.U RTE.	SECTION	COUNTY	TOTAL SHEETS	SHEET NO.
9110	31-15PP-1	MADISON	7	2
			CONTRACT NO. 76N31	
		ILLINOIS FED. AID PROJECT		

MODEL: \\MODEL\NAME
 FILE: NAME.Plot\Illinois\gov\PWIDOT\Documents\DOT_Offices\District 8\Projects\076N31\CADD\DATA\CAD\Sheet\076N31-1st-500.dgn

CODE NO.	ITEM	UNIT	TOTAL QUANTITY	100% STATE	CONSTR. CODE
					ROADWAY 0006 URBAN
44201821	CLASS D PATCHES, TYPE IV, 14 INCH	SQ YD	92		92
67100100	MOBILIZATION	L SUM	1		1
70102620	TRAFFIC CONTROL AND PROTECTION, STANDARD 701501	L SUM	1		1
* 78001110	PAINT PAVEMENT MARKING - LINE 4"	FOOT	200		200
X4406225	PARTIAL DEPTH REMOVAL, TYPE II, 2.5"	SQ YD	64.4		64.4
X4421000	PARTIAL DEPTH PATCHING	TON	9.2		9.2

* SPECIALTY ITEM

USER NAME = laremd	DESIGNED -	REVISED -
	DRAWN -	REVISED -
PLOT SCALE = 100.0000' / in.	CHECKED -	REVISED -
PLOT DATE = 1/9/2020	DATE -	REVISED -

**STATE OF ILLINOIS
 DEPARTMENT OF TRANSPORTATION**

SUMMARY OF QUANTITIES

SCALE: SHEET 1 OF 1 SHEETS STA. TO STA.

F.A.U RTE.	SECTION	COUNTY	TOTAL SHEETS	SHEET NO.
9110	31-15PP-1	MADISON	7	3
			CONTRACT NO. 76N31	
		ILLINOIS	FED. AID PROJECT	

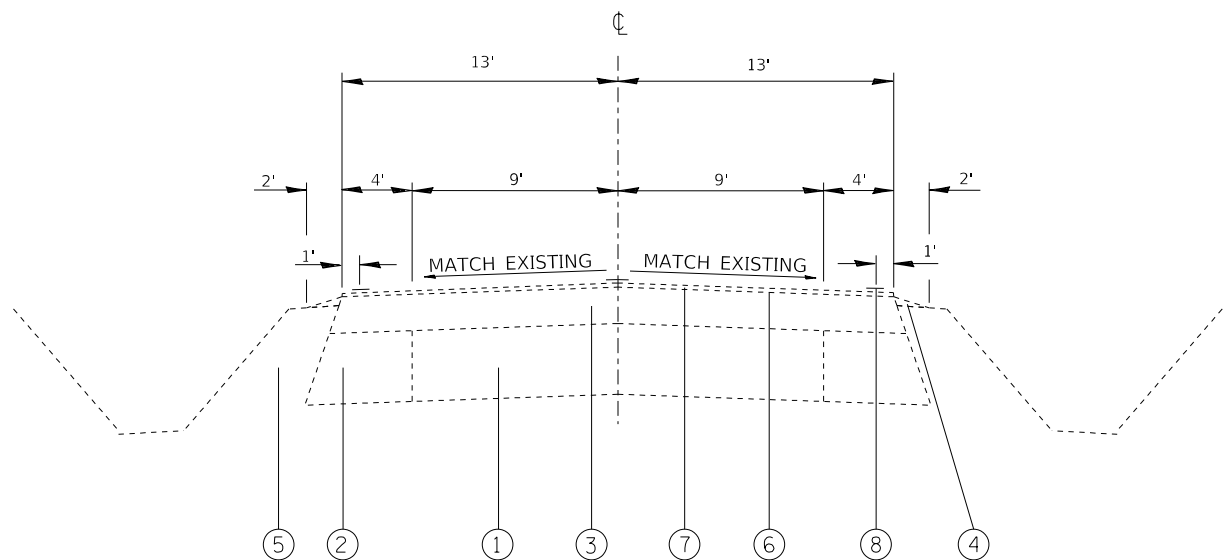

EXISTING TYPICAL SECTION
 MI. STA. 0.00 TO MI. STA. 0.96

LEGEND

- ① EXISTING PCC PAVEMENT, 9"
- ② EXISTING HOT-MIX ASPHALT BASE COURSE WIDENING, 9"
- ③ EXISTING HOT-MIX ASPHALT RESURFACING, 4 1/4"
- ④ EXISTING AGGREGATE WEDGE SHOULDER, TYPE B
- ⑤ EXISTING EARTH SHOULDER
- ⑥ EXISTING BITUMINOUS MATERIALS (PRIME COAT)
- ⑦ EXISTING MICRO-SURFACING, SINGLE PASS, TYPE II
- ⑧ EXISTING THERMOPLASTIC PAVEMENT MARKING - LINE 4"

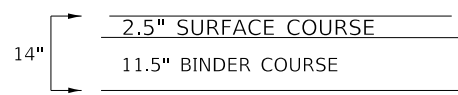

FULL-DEPTH PATCH DETAIL
 NOT TO SCALE

MODEL: \\MODELNAME
 FILE NAME: \\path\name.dwg
 PROJECT: \\path\projectname\DOT_Offices\District_8\Projects\076N31\CADData\CAD\Sheet\076N31-shc1.tpd.dwg

USER NAME = laremd	DESIGNED -	REVISED -
	DRAWN -	REVISED -
PLOT SCALE = 100.0000 ' / in.	CHECKED -	REVISED -
PLOT DATE = 1/9/2020	DATE -	REVISED -

STATE OF ILLINOIS
DEPARTMENT OF TRANSPORTATION

TYPICAL SECTIONS AND PATCH DETAIL

SCALE: SHEET 1 OF 1 SHEETS STA. TO STA.

F.A.U. RTE.	SECTION	COUNTY	TOTAL SHEETS	SHEET NO.
9110	31-15PP-1	MADISON	7	4
CONTRACT NO. 76N31				
		ILLINOIS FED. AID PROJECT		

FULL DEPTH PATCHING SCHEDULE, 14"					
MILE STATION	LOCATION	LENGTH	WIDTH	AREA	CLASS D PATCHES TYPE IV
	EB/WB	FEET	FEET	SQ YD	SQ YD
VADALABENE DR					
0.12	EB	120	6	80	80
SUBTOTAL					80
ANTICIPATED FAILURES (15%)					12
TOTAL					92

PARTIAL DEPTH PATCHING SCHEDULE, 2.5"						
MILE STATION	LOCATION	LENGTH	WIDTH	AREA	PARTIAL DEPTH PATCHING	PARTIAL DEPTH REMOVAL TYPE II
	EB/WB	FEET	FEET	SQ YD	TON	SQ YD
VADALABENE DR						
0.4	EB	6	12	8	1.1	8
0.6	EB	6	12	8	1.1	8
0.7	WB	6	12	8	1.1	8
0.7	WB	6	12	8	1.1	8
0.8	WB	6	12	8	1.1	8
0.8	WB	6	12	8	1.1	8
0.9	WB	6	12	8	1.1	8
SUBTOTAL					8	56
ANTICIPATED FAILURES (15%)					1.2	8.4
TOTAL					9.2	64.4

MODEL: \\MODEL\NAME FILES
FILE: NAME: P:\pub\mcomada\data\illinois.gov\PWIDOT\Documents\DOT_Offices\District 8\Projects\076831\CADD\at\atCAD\patches\076831-14-in-schedule.dgn

USER NAME = laremd	DESIGNED -	REVISED -
	DRAWN -	REVISED -
PLOT SCALE = 100,0000' / in.	CHECKED -	REVISED -
PLOT DATE = 1/9/2020	DATE -	REVISED -

**STATE OF ILLINOIS
DEPARTMENT OF TRANSPORTATION**

SCHEDULES OF QUANTITIES

SCALE: SHEET 1 OF 1 SHEETS STA. TO STA.

F.A.U RTE.	SECTION	COUNTY	TOTAL SHEETS	SHEET NO.
9110	31-15PP-1	MADISON	7	5
CONTRACT NO. 76N31				
ILLINOIS FED. AID PROJECT				

FAP ROUTE	SECTION	COUNTY	TOTAL SHEETS	SHEET NO.
600	127-3R-3	MADISON	377	240
STA.	TO STA.	EXISTING CONDITIONS:		

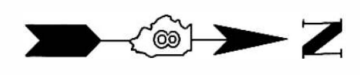
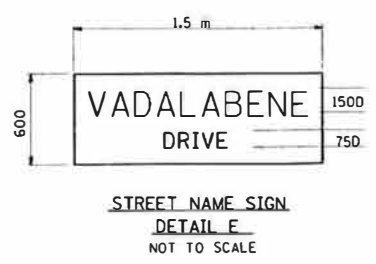
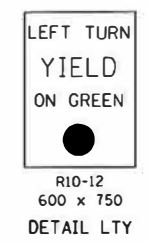
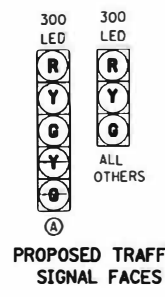

PLAN

PROJECT NO.	127-3R-3
DATE	12/03/2003
DESIGNED BY	larem
DRAWN BY	larem
CHECKED BY	
DATE	

12/03/2003
C:\projects\127-3R-3\127-3R-3-127-3R-3-127-3R-3.dwg
L:\12-3R-3-127-3R-3-127-3R-3.dwg

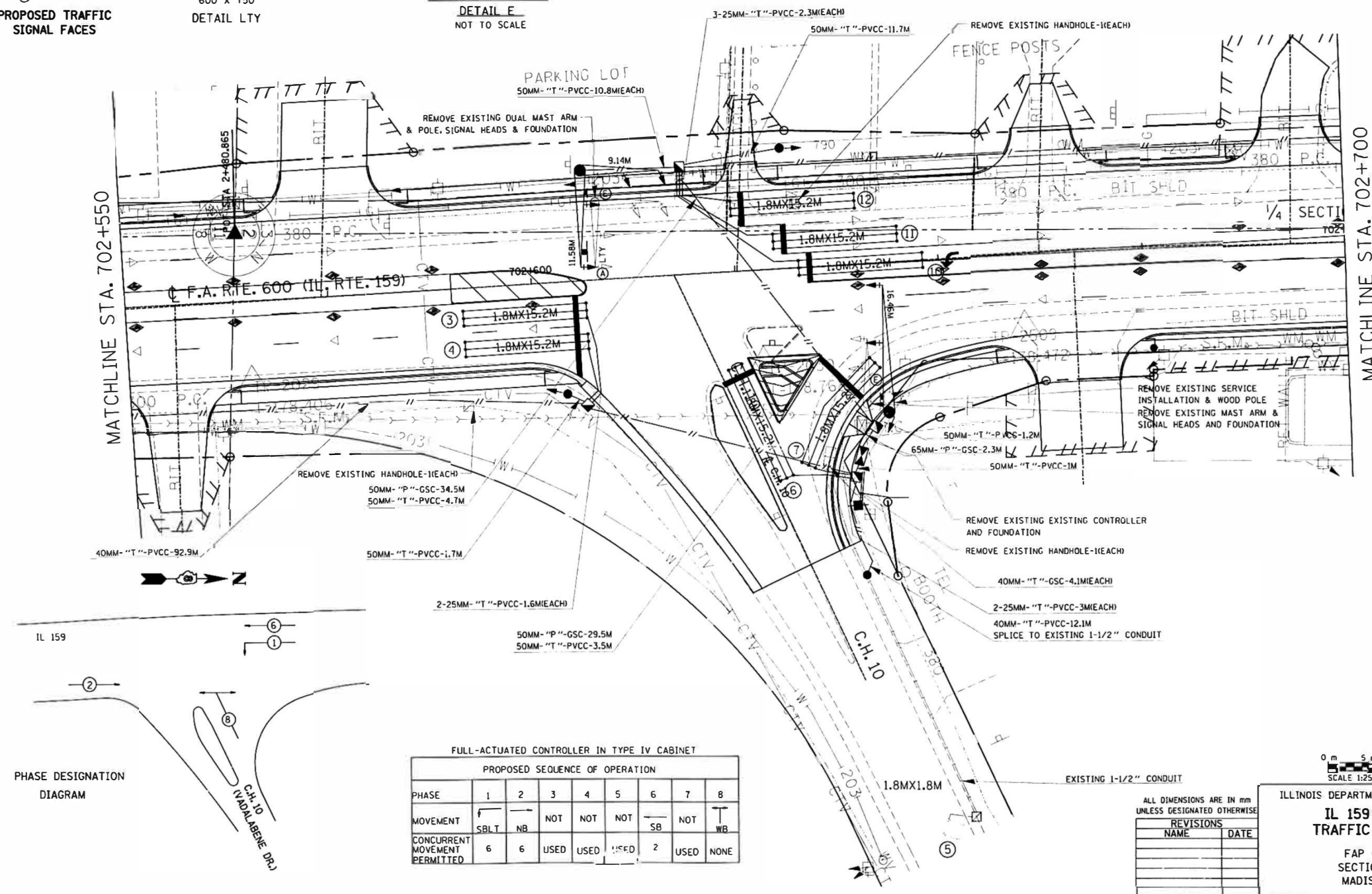

PHASE DESIGNATION DIAGRAM

FULL-ACTUATED CONTROLLER IN TYPE IV CABINET

PHASE	PROPOSED SEQUENCE OF OPERATION							
	1	2	3	4	5	6	7	8
MOVEMENT	SBLT	NB	NOT	NOT	NOT	SB	NOT	WB
CONCURRENT MOVEMENT PERMITTED	6	6	USED	USED	USED	2	USED	NONE

ALL DIMENSIONS ARE IN MM UNLESS DESIGNATED OTHERWISE

REVISIONS	
NAME	DATE

ILLINOIS DEPARTMENT OF TRANSPORTATION
IL 159 AND C.H. 10 TRAFFIC SIGNAL PLAN
FAP 600 ROUTE
SECTION 127-3R-3
MADISON COUNTY
DRAWN BY: 1 OF 2

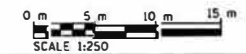

12-29-03 Revised sheet

PLOT DATE: Wednesday December 03, 2003 @ 10:47:12 AM

MODEL: #MODEL NAMES
FILE NAME: P:\updatem\mtda\illind\gov\pww\dot\Documents\DOT - Off\ca\District B\Projects\127-3R-3\CADDData\CAD\sheet\127-3R-3-127-3R-3-127-3R-3.dwg

USER NAME = larem	DESIGNED -	REVISED -
	DRAWN -	REVISED -
PLOT SCALE = 100.0000 / in.	CHECKED -	REVISED -
PLOT DATE = 10/11/2019	DATE -	REVISED -

**STATE OF ILLINOIS
DEPARTMENT OF TRANSPORTATION**

**EXISTING DETECTOR LOOP DETAIL
(FOR INFORMATION ONLY)**

SCALE: SHEET 1 OF 1 SHEETS STA. TO STA.

F A U RTE.	SECTION	COUNTY	TOTAL SHEETS	SHEET NO.
9110	31-15PP-1	MADISON	7	6
CONTRACT NO. 76N31				
ILLINOIS FED. AID PROJECT				

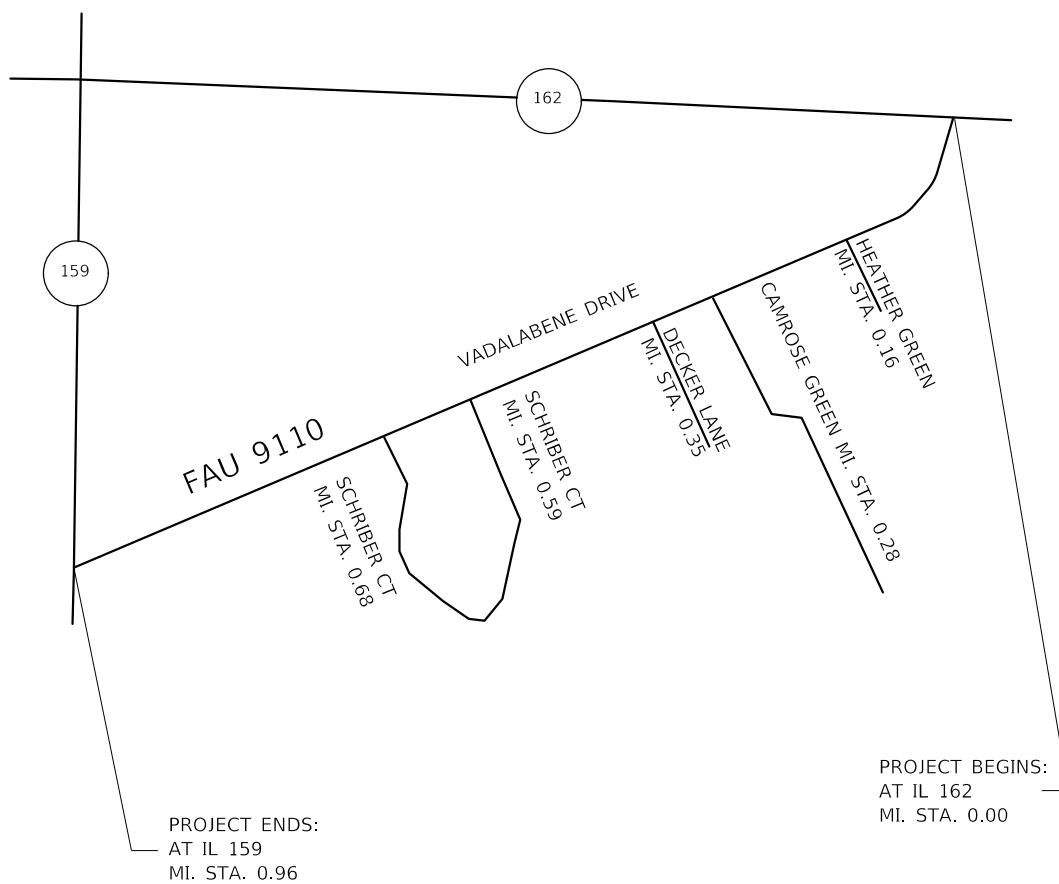

MODEL: S:\MODEL\MAME
 FILE: MAME.dwg
 PLOT DATE: 1/9/2020

USER NAME = laremd	DESIGNED -	REVISED -
	DRAWN -	REVISED -
PLOT SCALE = 100,0000 ' / in.	CHECKED -	REVISED -
PLOT DATE = 1/9/2020	DATE -	REVISED -

**STATE OF ILLINOIS
 DEPARTMENT OF TRANSPORTATION**

LOCATION MAP

SCALE: SHEET 1 OF 1 SHEETS STA. TO STA.

F.A.U. RTE.	SECTION	COUNTY	TOTAL SHEETS	SHEET NO.
9110	31-15PP-1	MADISON	7	7
CONTRACT NO. 76N31				
ILLINOIS		FED. AID PROJECT		