

SB LAGRANGE RD.

SB LAGRANGE RD
TO EB IL 171
& I-294 RAMP

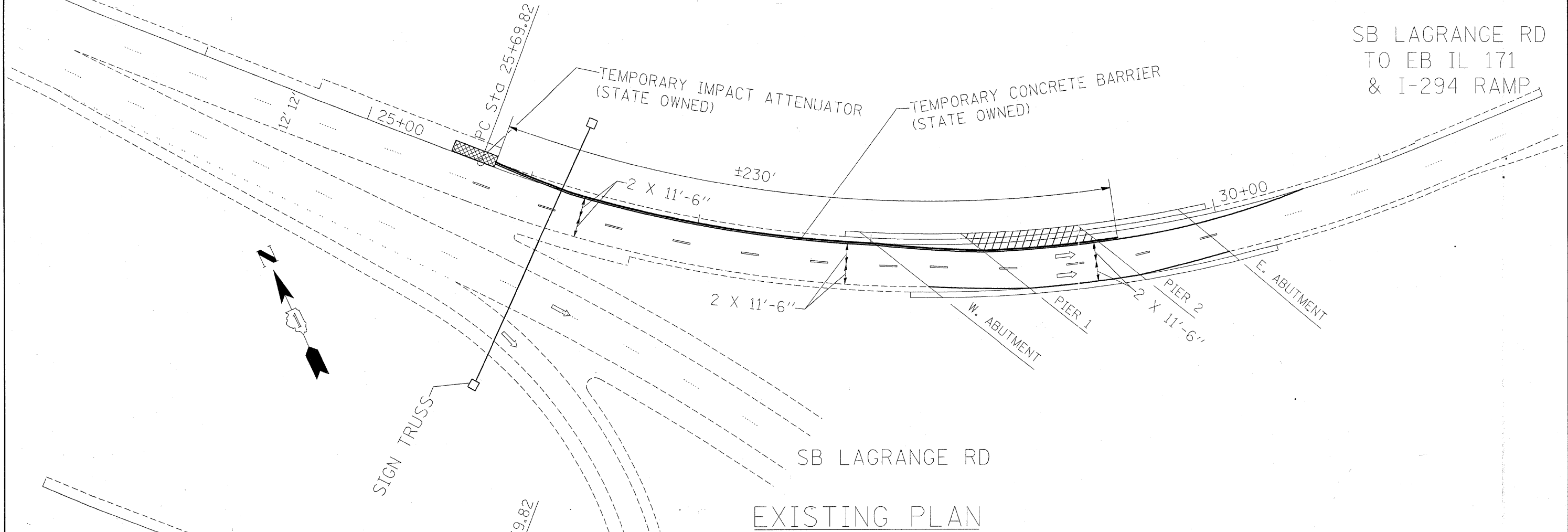

SB LAGRANGE RD

EXISTING PLAN

SB LAGRANGE RD
TO WB IL 171 RAMP

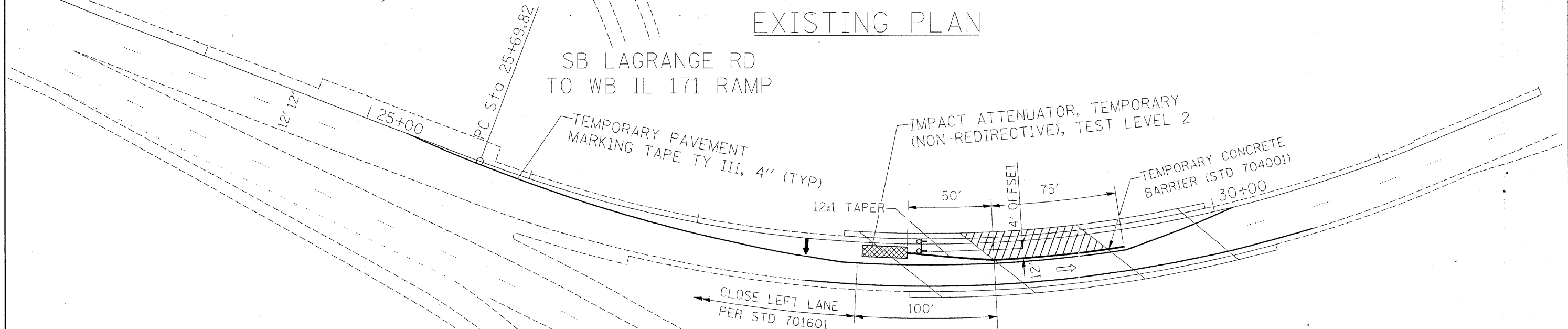

PROPOSED PLAN

COVER CONFLICTING PAVEMENT MARKING WITH BLACK TYPE III TAPE. TEMPORARY PAVEMENT MARKING TAPE, TYPE III AND ITS REMOVAL AND ALL TRAFFIC CONTROL ITEMS SHOWN ON THIS SHEET ARE INCLUDED IN THE COST OF "TRAFFIC CONTROL AND PROTECTION (SPECIAL)"

- ↑ Arrow board
- ⊠ Type III barricade with flashing lights

FILE NAME = e:\projects\dl03708\design_00.dgn	USER NAME = ansaris	DESIGNED -	REVISED -
		DRAWN -	REVISED -
		CHECKED -	REVISED -
		DATE -	REVISED -

**STATE OF ILLINOIS
DEPARTMENT OF TRANSPORTATION**

TRAFFIC STAGING PLAN				
SCALE:	SHEET NO.	OF SHEETS	STA.	TO STA.

F.A.P. RTE.	SECTION	COUNTY	TOTAL SHEETS	SHEET NO.
330	BR-H6-I-2	COOK	14	4
CONTRACT NO. 60D53				
FED. ROAD DIST. NO. 1 ILLINOIS FED. AID PROJECT				