

**EXISTING EQUIPMENT TO BE REMOVED LEGEND**

- ◁ EXISTING SIGNAL TO BE REMOVED
- "E" EXISTING SERVICE INSTALLATION TO BE REMOVED
- EXISTING SIGNAL POST AND FOUNDATION TO BE REMOVED
- EXISTING STEEL MAST ARM POLE AND FOUNDATION TO BE REMOVED
- ⊠ "E" EXISTING CONTROLLER AND FOUNDATION TO BE REMOVED
- ◻ "E" EXISTING HANDHOLE TO BE REMOVED
- ◻ "E" EXISTING DOUBLE HANDHOLE TO BE REMOVED
- ◻ "E" EXISTING HEAVY DUTY HANDHOLE TO BE REMOVED
- ⊗ EMERGENCY VEHICLE LIGHT DETECTOR TO BE REMOVED
- CONFIRMATION BEACON TO BE REMOVED

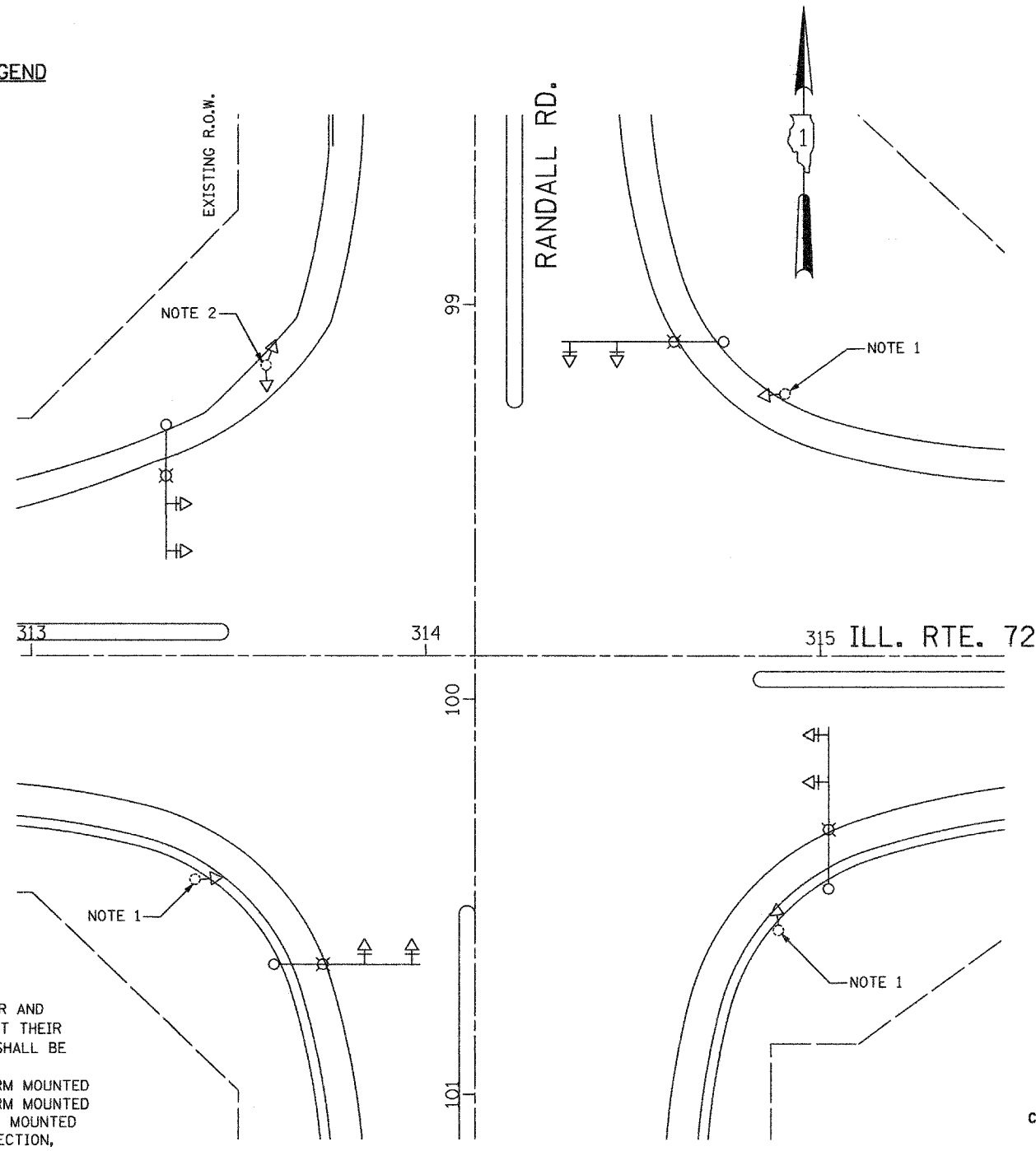

**TRAFFIC SIGNAL REMOVAL PLAN**

1" = 20'

THE FOLLOWING ITEMS SHALL BE REMOVED BY THE CONTRACTOR AND SHALL BE DISPOSED OF BY THEM OUTSIDE THE RIGH-OF-WAY AT THEIR EXPENSE. THE SALVAGE VALUE OF THE REMOVED EQUIPMENT SHALL BE REFLECTED IN THE CONTRACT BID PRICE.

- 2 EACH SIGNAL HEAD, 1-FACE 3-SECTION, MAST ARM MOUNTED
- 6 EACH SIGNAL HEAD, 1-FACE 5-SECTION, MAST ARM MOUNTED
- 3 EACH SIGNAL HEAD, 1-FACE 5-SECTION, BRACKET MOUNTED
- 1 EACH SIGNAL HEAD, 2-FACE 1-3 SECTION, 1-5 SECTION, BRACKET MOUNTED
- 8 EACH TRAFFIC SIGNAL BACKPLATE
- 4 EACH STEEL MAST ARM ASSEMBLY AND POLE, 34 FT, 36 FT & 40 FT.

NOTE 1: REMOVE EXISTING 1-5 SECTION, BRACKET MOUNTED LED SIGNAL HEAD AND INSTALL NEW 1-3 SECTION, BRACKET MOUNTED LED SIGNAL HEAD WITH LEFT TURN ARROWS WHERE NOTED ON PLANS AND AS DIRECTED BY THE ENGINEER.

NOTE 2: REMOVE EXISTING 2-FACE, 1-3 SECTION (FOR SB DIRECTION) AND 1-5 SECTION (FOR NB DIRECTION) SIGNAL HEAD AND INSTALL NEW 2-FACE, 1-3 SECTION (FOR NB DIRECTION WITH LEFT TURN ARROWS) AND 1-5 SECTION (FOR SB DIRECTION) SIGNAL HEAD AS SHOWN IN THE PLANS AND AS DIRECTED BY THE ENGINEER. THE CABLE CONNECTIONS SHALL BE MODIFIED IN THE CONTROLLER AS REQUIRED.

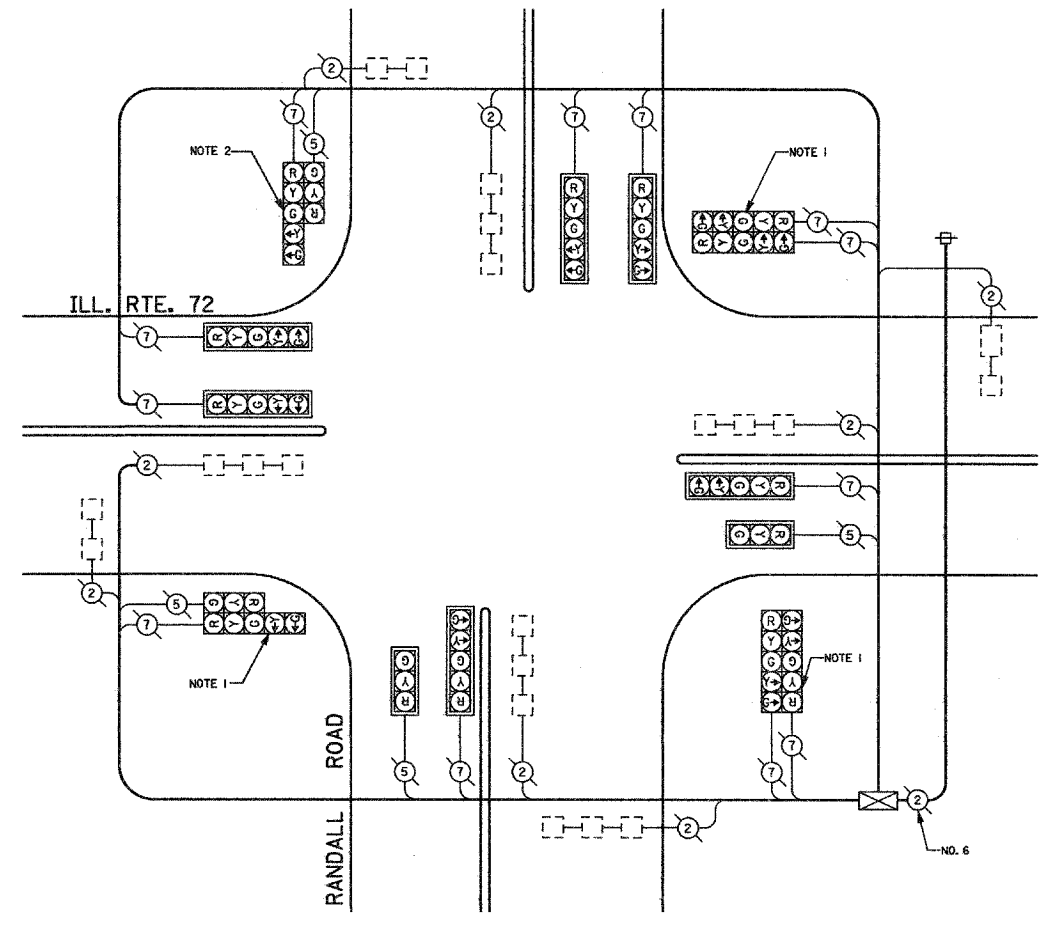

**EXISTING CABLE PLAN**

**CABLE PLAN LEGEND**

- | EXISTING | PROPOSED |   |
|----------|----------|---|
| ⊖        | ⊖        | 8" (200mm) TRAFFIC SIGNAL SECTION   |
| ⊖        | ⊖        | 12" (300mm) TRAFFIC SIGNAL SECTION  |
| ⊠        | ⊠        | CONTROLLER CABINET  |
| ⊕        | ⊕        | SERVICE INSTALLATION  |
| ⊖        | ⊖        | TELEPHONE INSTALLATION  |
| ⊖        | ⊖        | VEHICLE DETECTOR, INDUCTION LOOP  |
| ②        | ②        | DENOTES NUMBER OF CONDUCTORS, ALL CABLE NO. 14 EXCEPT AS INDICATED. ALL LOOP DETECTOR CABLE TO BE SHIELDED. |
| ①        | ①        | GROUND CABLE IN CONDUIT NO. 6 SOLID COPPER (GREEN)  |
| ②④       | ②④       | FIBER OPTIC CABLE IN CONDUIT NO. 62.5/125 2-MM12F & SM12F   |
| ⊖        | ⊖        | SIGNAL FACE WITH BACKPLATE. *P* INDICATES PROGRAMMED HEAD.  |

**CONTROLLER SEQUENCE**

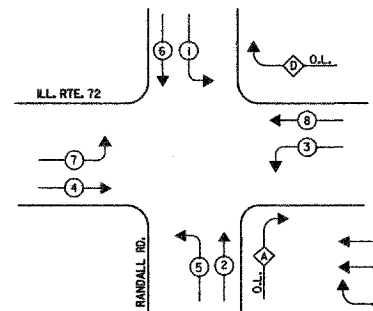

OVERLAP LETTER PERMISSIVE PHASE PROTECTED PHASE  
 A = 2 + 3  
 D = 8 + 1

**LEGEND**

- ⊖ DUAL ENTRY PHASE
- ⊖ SINGLE ENTRY PHASE
- ⊖ OVERLAP
- ⊖ PEDESTRIAN PHASE
- \* NUMBER REFERS TO ASSOCIATED PHASE

**EXISTING PHASE DESIGNATION DIAGRAM**

FILE NAME =	USER NAME = RDP	DESIGNED - PKG/RDP	REVISED -
J:\PROJECTS\Projects 2007\ILL_RTE.72_RandallRD\07_Randall_road_ill.72_CD.exdgn		DRAWN - MAA/RDP	REVISED -
	PLOT SCALE = 20.0000' / IN.	CHECKED - PKG	REVISED -
	PLOT DATE = 12/16/2007	DATE - 12-06-2007	REVISED -

**STATE OF ILLINOIS  
DEPARTMENT OF TRANSPORTATION**

EXISTING CABLE PLAN, EXISTING PHASE DESIGNATION DIAGRAM  
 TRAFFIC SIGNAL REMOVAL PLAN  
 ILLINOIS ROUTE 72 AT RANDALL ROAD

SCALE: NONE SHEET NO. OF SHEETS STA. TO STA.

F.A. RTE. 341	SECTION 2007-059 L	COUNTY KANE	TOTAL SHEETS 21	SHEET NO. 07
FED. ROAD DIST. NO. 1 ILLINOIS FED. AID PROJECT				CONTRACT NO. 60D98