

F.A.S. RTE.	SECTION	COUNTY	TOTAL SHEETS	SHEET NO.
2320	113X-N	WILL	133	1

133
+3
136

STATE OF ILLINOIS
DEPARTMENT OF TRANSPORTATION
DIVISION OF HIGHWAYS

**PROPOSED
HIGHWAY PLANS**

F.A.S. 2320: ILL 113 (MAIN STREET)
AT
ILL 129 (WASHINGTON STREET) AND ILL 53 (FRONT STREET)
SECTION 113X-N
INTERSECTION RECONSTRUCTION /TRAFFIC SIGNAL INSTALLATION AND
RAILROAD CROSSING IMPROVEMENT
WILL COUNTY
C-91-117-05

FOR INDEX OF SHEETS, SEE SHEET NO.

THE IMPROVEMENT IS LOCATED IN THE
VILLAGE OF BRAIDWOOD IN WILL COUNTY

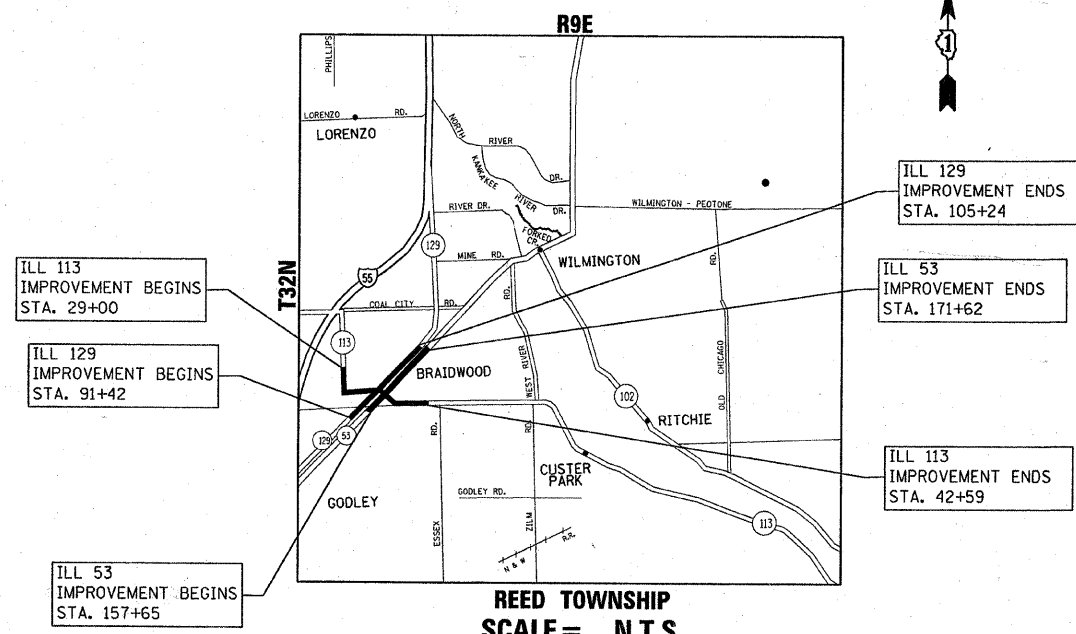
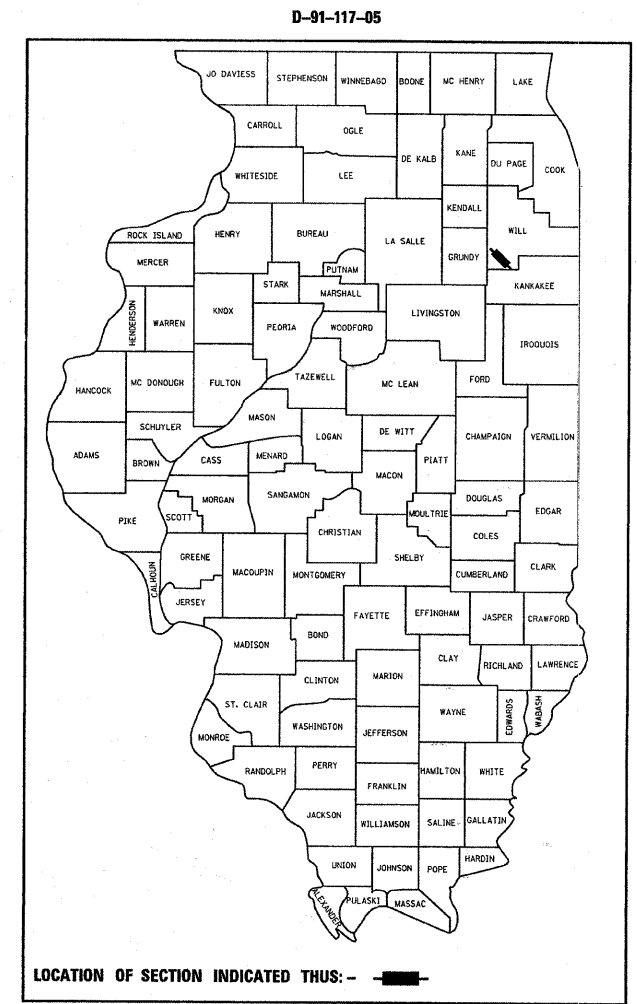

GROSS AND NET LENGTH OF IMPROVEMENT: IL RTE 113 = 1359 LF = 0.257 MILE
GROSS AND NET LENGTH OF IMPROVEMENT: IL RTE 129 = 1232 LF = 0.233 MILE
GROSS AND NET LENGTH OF IMPROVEMENT: IL RTE 53 = 1247 LF = 0.237 MILE
GROSS AND NET LENGTH OF IMPROVEMENT: MITCHELL ST. = 222.50 LF = 0.04 MILE

2002 ADT = ILL. 113 (EAST LEG), 10,400
2002 ADT = ILL. 113 (WEST LEG), 7,511
2002 ADT = ILL. 129, 4,630
2002 ADT = ILL. 53, 7,575
2002 ADT = MITCHELL STREET, 1,795

SPEED LIMIT: 25-30 MPH ILL. 113
SPEED LIMIT: 45 MPH ILL. 129
SPEED LIMIT: 30 MPH ILL. 53
SPEED LIMIT: 20 MPH MICHELL STREET

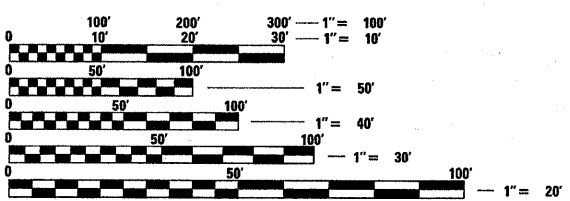

FULL SIZE PLANS HAVE BEEN PREPARED USING STANDARD ENGINEERING SCALES. REDUCED SIZED PLANS WILL NOT CONFORM TO STANDARD SCALES. IN MAKING MEASUREMENTS ON REDUCED PLANS, THE ABOVE SCALES MAY BE USED.

J.U.L.I.E.
JOINT UTILITY LOCATION INFORMATION FOR EXCAVATION
1-800-892-0123

CONTRACT NO. 62910

DISTRICT ONE - DESIGN - PLAN PREPARATION ENGINEER:
KEN ENG / ROBERT BORO (847) 705-4178

STATE OF ILLINOIS
DEPARTMENT OF TRANSPORTATION
DIVISION OF HIGHWAYS

SUBMITTED August 30, 2007

Diane O'Keefe
DEPUTY DIRECTOR OF HIGHWAYS, REGION ENGINEER

October 12, 2007
Eric E. Harrell
ENGINEER OF DESIGN AND ENVIRONMENT

October 12, 2007
Milton R. Sees, P.E.
DIRECTOR OF HIGHWAYS, CHIEF ENGINEER

PRINTED BY THE AUTHORITY
OF THE STATE OF ILLINOIS

Rev. 11-5-07