

F.A.S. RTE.	SECTION	COUNTY	TOTAL SHEETS	SHEET NO.
2320	113X-N	WILL	133	28
STA.		TO STA.		
FED. ROAD DIST. NO.		ILLINOIS FED. AID PROJECT		

IL. RTE. 113

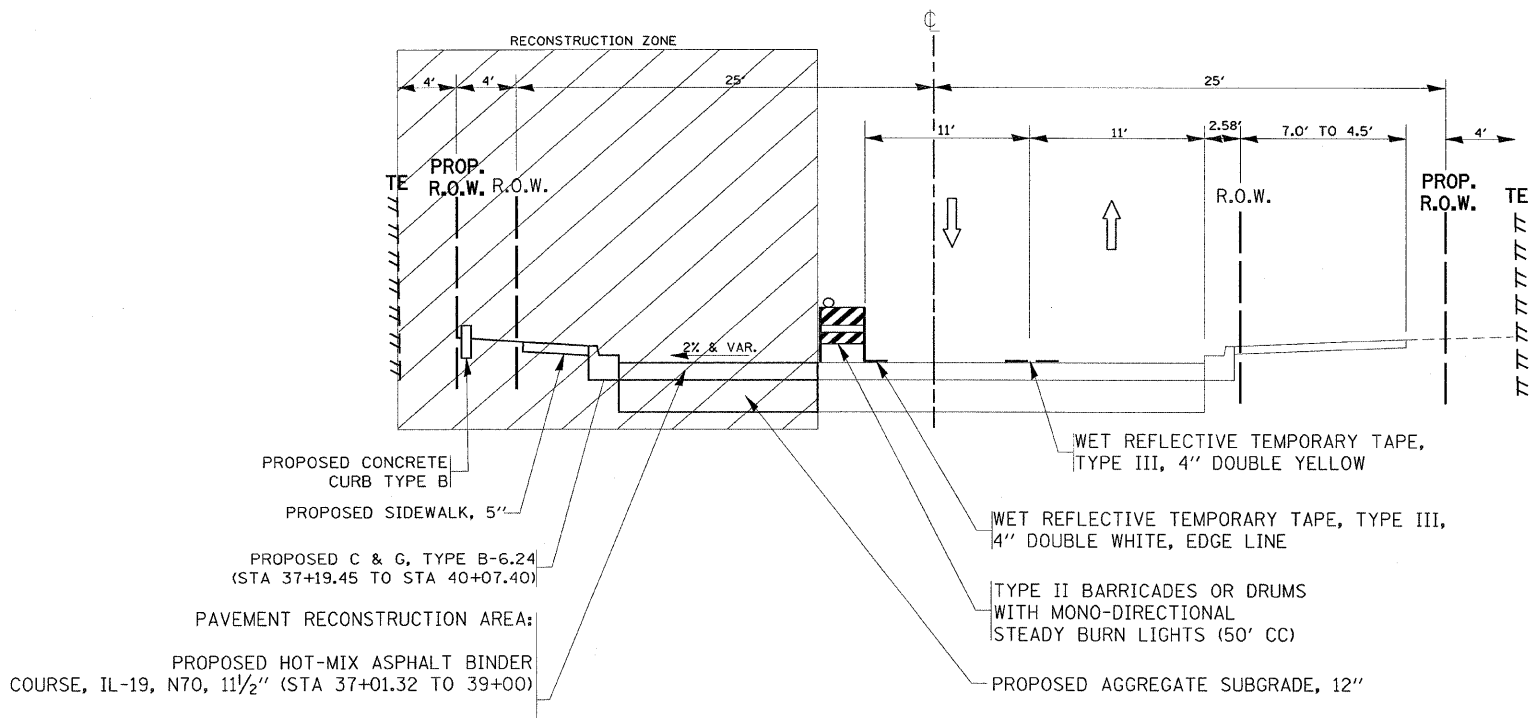

PROPOSED STAGE Ib WORK
 IL 113
 37+01.32 TO STA 39+00 (RECONSTRUCTION)
 AND
 STA 39+00 TO STA 42+59.30 (RESURFACING AND WIDENING)

IL. RTE. 113

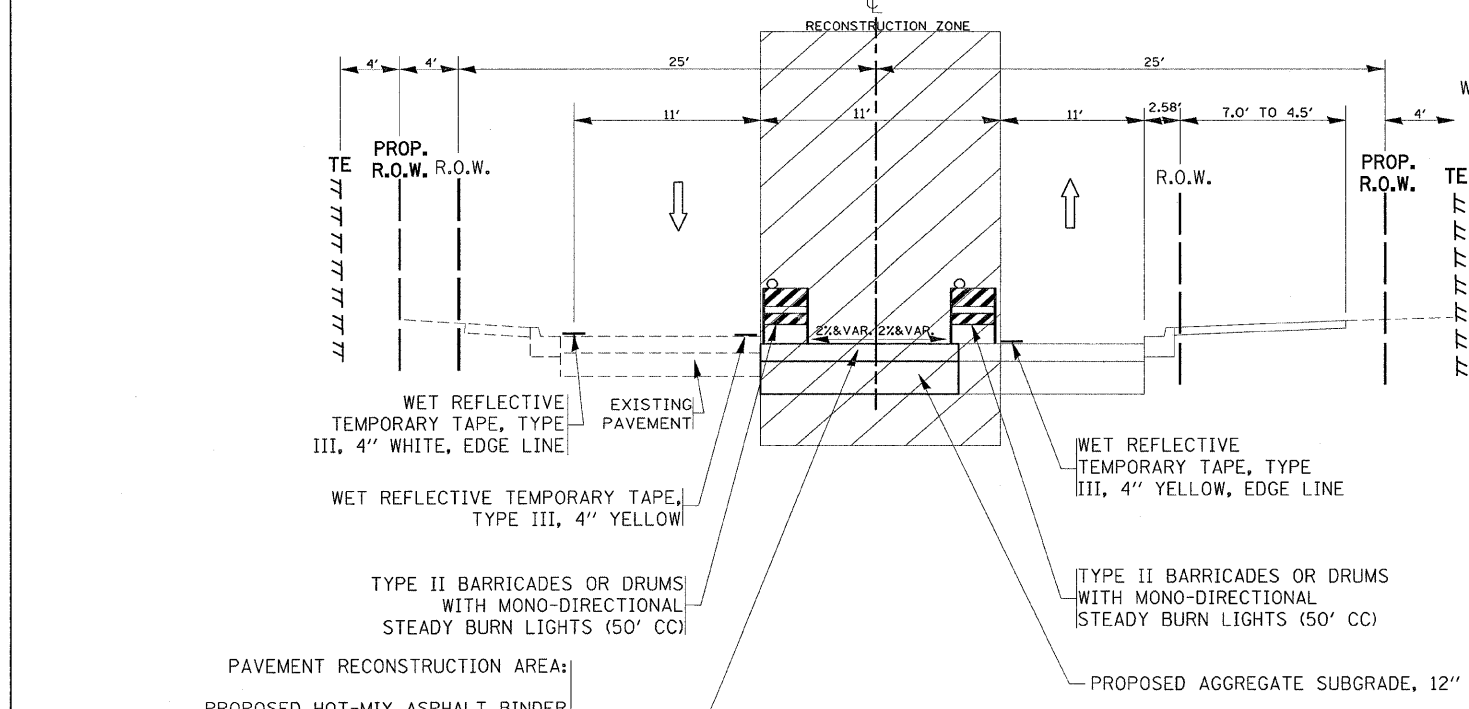

PROPOSED STAGE Ia WORK
 IL 113
 37+01.32 TO STA 39+00 (RECONSTRUCTION)
 AND
 STA 39+00 TO STA 42+59.30 (RESURFACING AND WIDENING)

PAVEMENT RECONSTRUCTION AREA:

PROPOSED HOT-MIX ASPHALT BINDER COURSE, IL-19, N70, 1 1/2" (STA 37+01.32 TO 39+00)

PAVEMENT WIDENING AREA:

PROPOSED HOT-MIX ASPHALT BASE COURSE WIDENING, IL-19, 10 3/4" (STA 39+00 TO STA 42+59.30)

REVISIONS	
NAME	DATE

ILLINOIS DEPARTMENT OF TRANSPORTATION
 ILLINOIS 113 AT
 ILLINOIS 129 AND ILLINOIS 53
 EXISTING AND PROPOSED
 TYPICAL SECTION
 STAGE I (a & b)

SCALE: VERT. _____
 HORIZ. _____
 DATE _____

DRAWN BY _____
 CHECKED BY _____

PLOT DATE = 5/28/2007
 PLOT NAME = I:\Projects\1131169\stage2.ctb
 PLOT SCALE = 1/4" = 1'-0"
 USER NAME = hmdanah