

F.A.S. RTE.	SECTION	COUNTY	TOTAL SHEETS	SHEET NO.
2320	113X-N	WILL	133	45
STA.		TO STA.		
FED. ROAD DIST. NO.	ILLINOIS	FED. AID PROJECT		

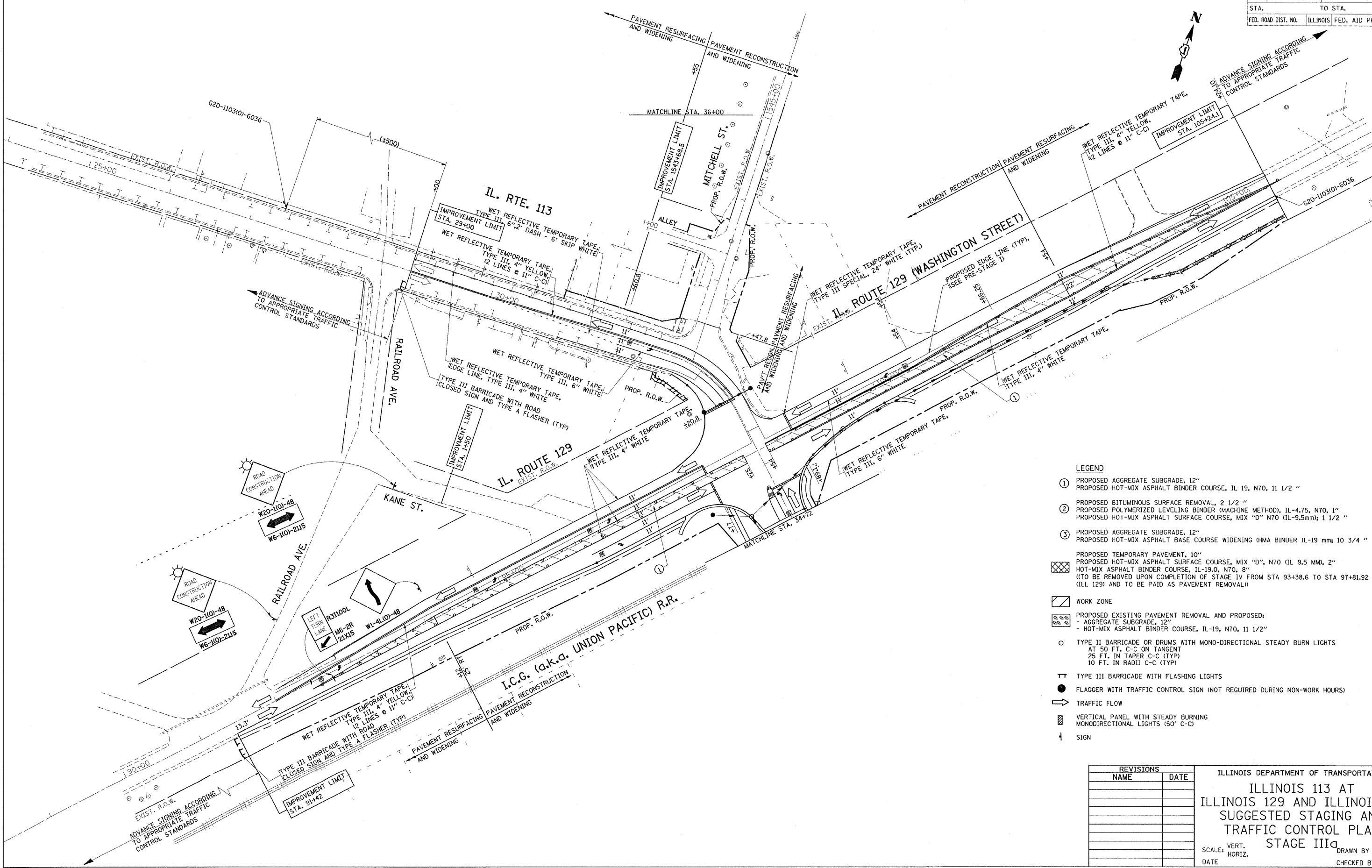

- LEGEND**
- ① PROPOSED AGGREGATE SUBGRADE, 12"  
PROPOSED HOT-MIX ASPHALT BINDER COURSE, IL-19, N70, 11 1/2 "
  - ② PROPOSED BITUMINOUS SURFACE REMOVAL, 2 1/2 "  
PROPOSED POLYMERIZED LEVELING BINDER (MACHINE METHOD), IL-4.75, N70, 1"  
PROPOSED HOT-MIX ASPHALT SURFACE COURSE, MIX "D" N70 (IL-9.5mm); 1 1/2 "
  - ③ PROPOSED AGGREGATE SUBGRADE, 12"  
PROPOSED HOT-MIX ASPHALT BASE COURSE WIDENING (HMA BINDER IL-19 mm; 10 3/4 "
  - PROPOSED TEMPORARY PAVEMENT, 10"  
PROPOSED HOT-MIX ASPHALT SURFACE COURSE, MIX "D", N70 (IL 9.5 MM), 2"  
HOT-MIX ASPHALT BINDER COURSE, IL-19.0, N70, 8"  
(TO BE REMOVED UPON COMPLETION OF STAGE IV FROM STA 93+38.6 TO STA 97+81.92 (ILL 129) AND TO BE PAID AS PAVEMENT REMOVAL)
  - WORK ZONE
  - PROPOSED EXISTING PAVEMENT REMOVAL AND PROPOSED:  
- AGGREGATE SUBGRADE, 12"  
- HOT-MIX ASPHALT BINDER COURSE, IL-19, N70, 11 1/2"
  - TYPE II BARRICADE OR DRUMS WITH MONO-DIRECTIONAL STEADY BURN LIGHTS  
AT 50 FT. C-C ON TANGENT  
25 FT. IN TAPER C-C (TYP)  
10 FT. IN RADII C-C (TYP)
  - TT TYPE III BARRICADE WITH FLASHING LIGHTS
  - FLAGGER WITH TRAFFIC CONTROL SIGN (NOT REQUIRED DURING NON-WORK HOURS)
  - ➔ TRAFFIC FLOW
  - VERTICAL PANEL WITH STEADY BURNING MONODIRECTIONAL LIGHTS (50' C-C)
  - ↑ SIGN

REVISIONS	
NAME	DATE

ILLINOIS DEPARTMENT OF TRANSPORTATION  
 ILLINOIS 113 AT  
 ILLINOIS 129 AND ILLINOIS 53  
 SUGGESTED STAGING AND  
 TRAFFIC CONTROL PLAN  
 STAGE IIIa  
 SCALE: VERT. \_\_\_\_\_ DRAWN BY \_\_\_\_\_  
 DATE \_\_\_\_\_ HORIZ. \_\_\_\_\_ CHECKED BY \_\_\_\_\_

PLOT DATE = 6/29/2007  
 FILE NAME = C:\113113X-N\113113X-N.dgn  
 PLOT SCALE = 50,000 / IN.  
 USER NAME = hamdanah