

F.A.S. RTE.	SECTION	COUNTY	TOTAL SHEETS	SHEET NO.
2320	113X-N	WILL	133	77
STA.		TO STA.		
FED. ROAD DIST. NO. 1		ILLINOIS FED. AID PROJECT		

TIME: 4:36:23 PM

DATE: 7/18/2007

FILENAME: S:\06\051-900\0519\071\Micros\Sheets\RT113-06.dgn

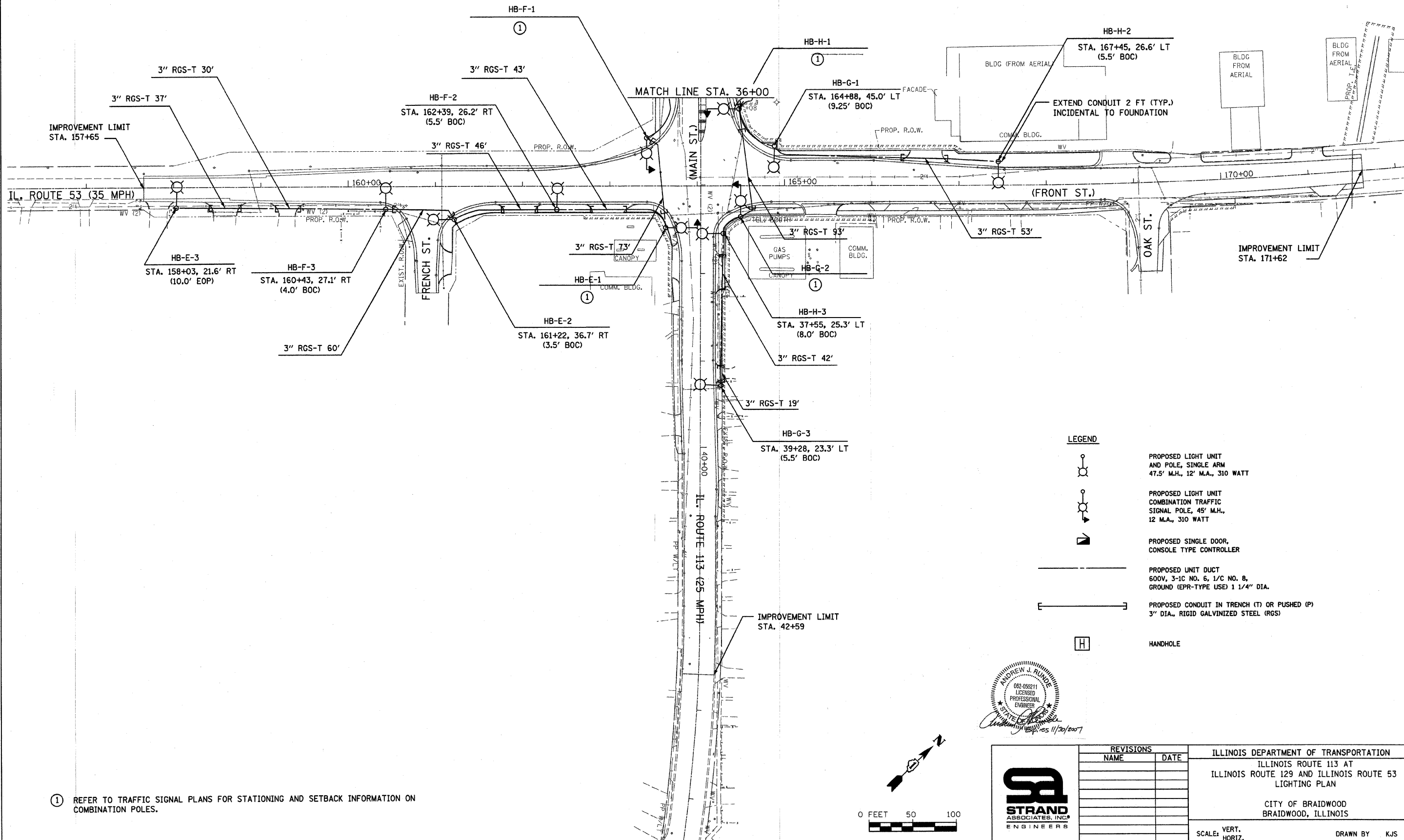

LEGEND

- PROPOSED LIGHT UNIT AND POLE, SINGLE ARM
47.5' M.H., 12' M.A., 310 WATT
- PROPOSED LIGHT UNIT COMBINATION TRAFFIC SIGNAL POLE, 45' M.H., 12' M.A., 310 WATT
- PROPOSED SINGLE DOOR, CONSOLE TYPE CONTROLLER
- PROPOSED UNIT DUCT
600V, 3-1C NO. 6, 1/C NO. 8,
GROUND (EPR-TYPE USE) 1 1/4" DIA.
- PROPOSED CONDUIT IN TRENCH (T) OR PUSHED (P)
3" DIA., RIGID GALVANIZED STEEL (RGS)
- HANDHOLE

① REFER TO TRAFFIC SIGNAL PLANS FOR STATIONING AND SETBACK INFORMATION ON COMBINATION POLES.

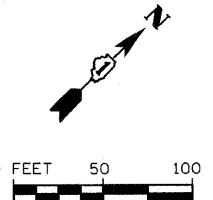
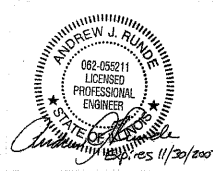

<p>STRAND ASSOCIATES, INC. ENGINEERS</p>	REVISIONS NAME DATE		ILLINOIS DEPARTMENT OF TRANSPORTATION ILLINOIS ROUTE 113 AT ILLINOIS ROUTE 129 AND ILLINOIS ROUTE 53 LIGHTING PLAN CITY OF BRAIDWOOD BRAIDWOOD, ILLINOIS	
	SCALE: VERT. HORIZ. DATE 7/18/2007	DRAWN BY KJS CHECKED BY AJR		