

STATE OF ILLINOIS
DEPARTMENT OF PUBLIC WORKS AND BUILDINGS
DIVISION OF HIGHWAYS
PLANS FOR PROPOSED
STATE BOND ISSUE HIGHWAY

SET 2 OF 4 SETS

SHEET 23 OF 43

FOR INFORMATION ONLY

INDEX OF SHEETS

- 1 TITLE SHEET
- 2 TYPICAL SECTIONS, SUMMARY OF QUANTITIES, GENERAL NOTES & SCHEDULE OF QUANTITIES
- 3 PLAN & PROFILE
- 4 GENERAL PLAN & ELEVATION
- 5 APPROACH DETAILS
- 6 SUPER STRUCTURE
- 7 TYPE W STEEL RAILING
- 8 ABUTMENTS
- 9 CROSS SECTIONS (TEMPORARY RUNAROUND)

- STD. 2115-3 PAVEMENT FABRIC
- STD. 2230-3 STEEL PLATE BEAM GUARD RAIL
- STD. 2231-3 TYPICAL APPLICATION OF STEEL PLATE BEAM GUARD RAIL
- STD. 2298-1 APPLICATION OF TRAFFIC CONTROL DEVICES
- STD. 2299-1 DESIGN OF TRAFFIC CONTROL DEVICES
- STD. 2300 FLAGMAN TRAFFIC CONTROL SIGN
- STD. 2303-1 APPLICATION OF TRAFFIC CONTROL DEVICES
- STD. 2310-1 APPLICATION OF TRAFFIC CONTROL DEVICES
- STD. 2239-3 BITUMINOUS SHOULDER

ABOVE STANDARDS ARE INCLUDED AFTER SHEET 32 OF SET 4

SCALES	PLAN	1 INCH	30 FT.
	PROFILE, HOR.	1 INCH	50 FT.
	PROFILE, VERT.	1 INCH	10 FT.
	CROSS-SECTIONS	1 INCH	8 FT.

SBI ROUTE 3
SEC 11BR
WHITESIDE COUNTY

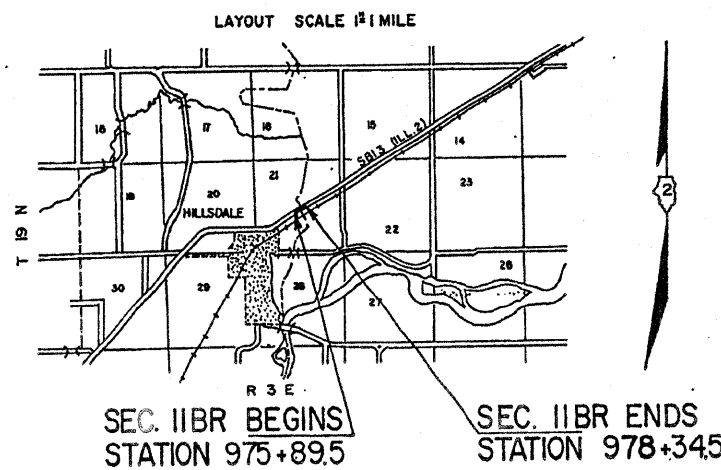

GROSS LENGTH OF SECTION 245.0 FT.=.046 MILES
 NET LENGTH OF SECTION 245.0 FT.=.046 MILES

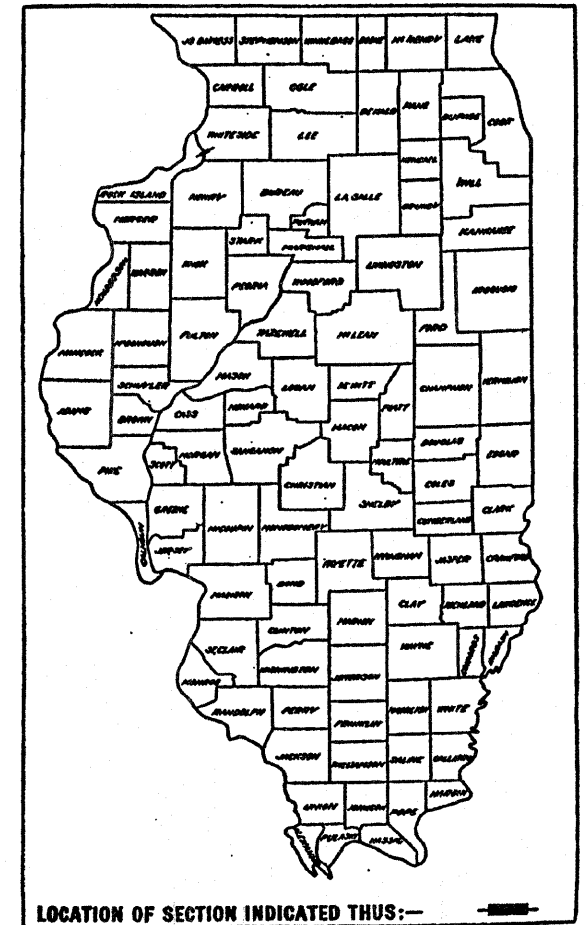

SECTION 11 BR INCLUDES THE REMOVAL OF THE EXISTING SUPERSTRUCTURE AND PORTIONS OF THE SUBSTRUCTURE AND REPLACEMENT WITH A PRECAST PRESTRESSED DECK BEAM BRIDGE OVER MEREDOSIA SLOUGH. ALSO INCLUDED IS CONSTRUCTION OF A TEMPORARY BRIDGE AND RUNAROUND AND ALL OTHER WORK THAT IS NECESSARY TO COMPLETE THE SECTION.

STATE OF ILLINOIS DEPARTMENT OF PUBLIC WORKS AND BUILDINGS DIVISION OF HIGHWAYS	
SUBMITTED	March 30, 1970
EXAMINED	<i>[Signature]</i> 16, 1970
PASSED	<i>[Signature]</i> 16, 1970
APPROVED	<i>[Signature]</i> 16, 1970
APPROVED	<i>[Signature]</i> 16, 1970
APPROVED	<i>[Signature]</i> 16, 1970
DIRECTOR	