

F.A.P. RTE.	SECTION	COUNTY	TOTAL SHEETS	SHEET NO.
326	*	LIVINGSTON	354	40
STA. 845+00 TO STA. 860+00				
FED. ROAD DIST. NO. ILLINOIS FED. AID PROJECT				
*(123,123)RS-3,(124)RS-5,(123)BR-3				

**LEGEND**

- X - TREE REMOVAL
- [Hatched Box] - PAVEMENT REMOVAL & CLASS D PATCH
- [Wavy Line] - SPECIAL DITCH
- [Dashed Line] - STANDARD DITCH
- [Cross-hatched Box] - RIPRAP
- [Diamond] - TEMP. DITCH CHECK

SEC. 27, T28N, R7E, 3RD P.M.  
R.J. LANNON, TRUSTEE

R.J. LANNON, TRUSTEE  
SEC. 28, T28N, R7E, 3RD P.M.

BM#75 CHISLED SQUARE IN PAVEMENT  
NEAR PAVEMENT STAMP 852  
11.3' RT. STA. 851+90.3 ELEV. 662.68

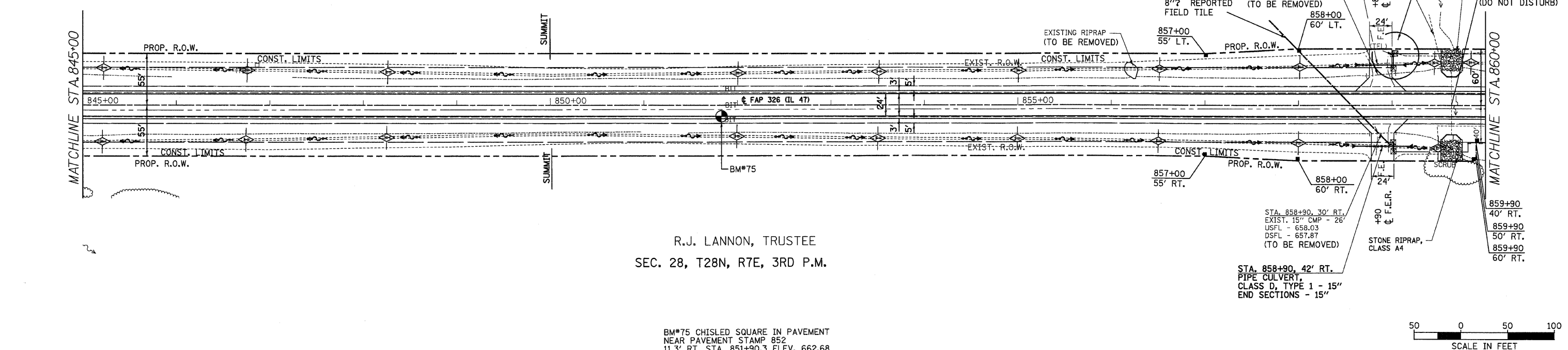
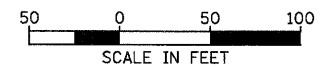

PLAN

REVIEWED	DATE
PLOTTED	
CHECKED	
BY	
NO.	

PROFILE

REVIEWED	DATE
PLOTTED	
CHECKED	
BY	
NO.	

