

| F.A.P. RTE. | SECTION | COUNTY | TOTAL SHEETS | SHEET NO. |
|---|---------|------------|--------------|-----------|
| 326 | | LIVINGSTON | 354 | 42 |
| STA. 875+00 TO STA. 890+00 | | | | |
| FED. ROAD DIST. NO. ILLINOIS FED. AID PROJECT | | | | |
| •(123,123)RS-3,(124)RS-5,(123)BR-3 | | | | |

LEGEND

- X - TREE REMOVAL
- ▨ - PAVEMENT REMOVAL & CLASS D PATCH
- - SPECIAL DITCH
- - - - STANDARD DITCH
- - RIPRAP
- ◇ - TEMP. DITCH CHECK

THE CHILDREN OF WILLIAM GEORGE STEVENSON, DECEASED

SEC. 34, T28N, R7E, 3RD P.M.



LT. STA. 890+00±
PROPOSED STONE RIPRAP,
CLASS A4
PROTECT EXISTING
EARTH SPILLWAY

EVELYN FOX
SHAUFLER

MARY A.
HALEY,
TRUSTEE

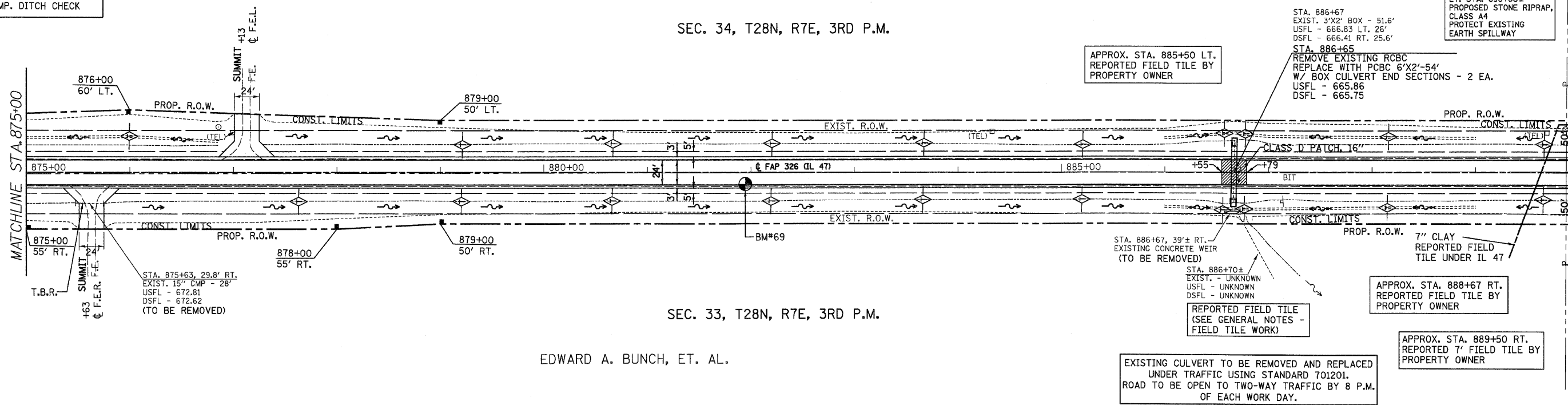

SEC. 33, T28N, R7E, 3RD P.M.

EDWARD A. BUNCH, ET. AL.

BM#69 CHISLED SQUARE IN PAVEMENT
NEAR PAVEMENT STAMP 882
12.1' RT. STA. 881+97 ELEV. 672.12

EXISTING CULVERT TO BE REMOVED AND REPLACED
UNDER TRAFFIC USING STANDARD 701201.
ROAD TO BE OPEN TO TWO-WAY TRAFFIC BY 8 P.M.
OF EACH WORK DAY.

APPROX. STA. 889+50 RT.
REPORTED 7' FIELD TILE BY
PROPERTY OWNER

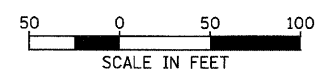

PLAN

| | |
|-------------|--|
| DATE | |
| BY | |
| REVISIONS | |
| NO. | |
| DESCRIPTION | |

PROFILE

| | |
|-------------|--|
| DATE | |
| BY | |
| REVISIONS | |
| NO. | |
| DESCRIPTION | |

