

F.A.P. RTE.	SECTION	COUNTY	TOTAL SHEETS	SHEET NO.
326		LIVINGSTON	354	47
STA. 950+00 TO STA. 965+00				
FED. ROAD DIST. NO. ILLINOIS FED. AID PROJECT				
*(123)XRS-3,(124)RS-5,(123)BR-3				

RAY L. LINDLEY, ET UX



LEGEND

- X - TREE REMOVAL
- [Hatched Box] - PAVEMENT REMOVAL & CLASS D PATCH
- [Dashed Line] - SPECIAL DITCH
- [Wavy Line] - STANDARD DITCH
- [Cross-hatched Box] - RIPRAP
- [Diamond] - TEMP. DITCH CHECK

SEC. 3, T27N, R7E, 3RD P.M.

SEC. 4, T27N, R7E, 3RD P.M.

RICHARD P. NICKRENT, ET UX

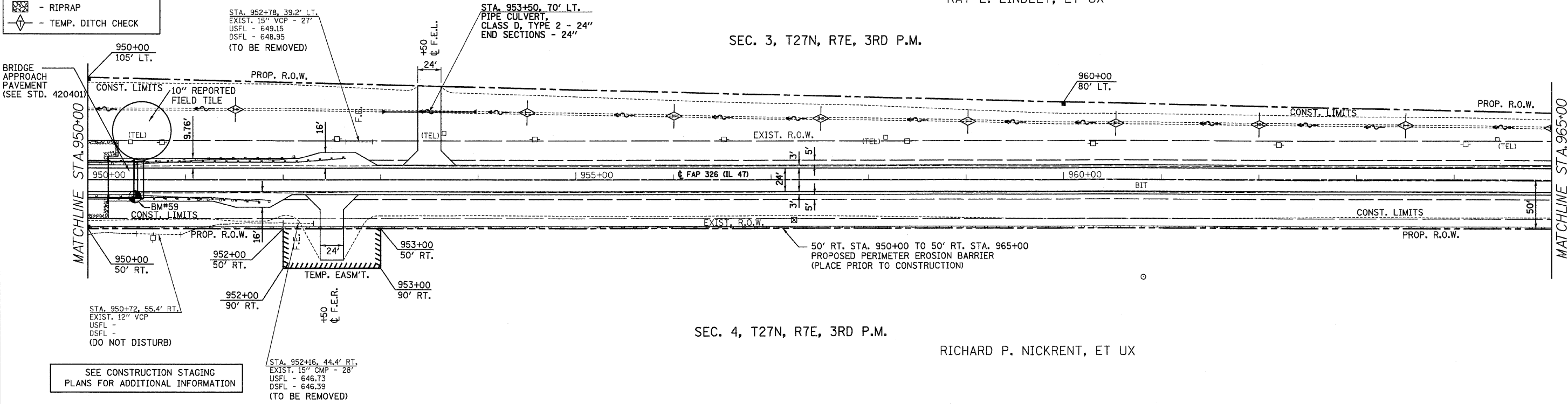

BM#59 CHISELED SQUARE ON SOUTHWEST CORNER BRG. HUB GUARD 16.6' RT. STA. 950+48.1 ELEV. 655.02

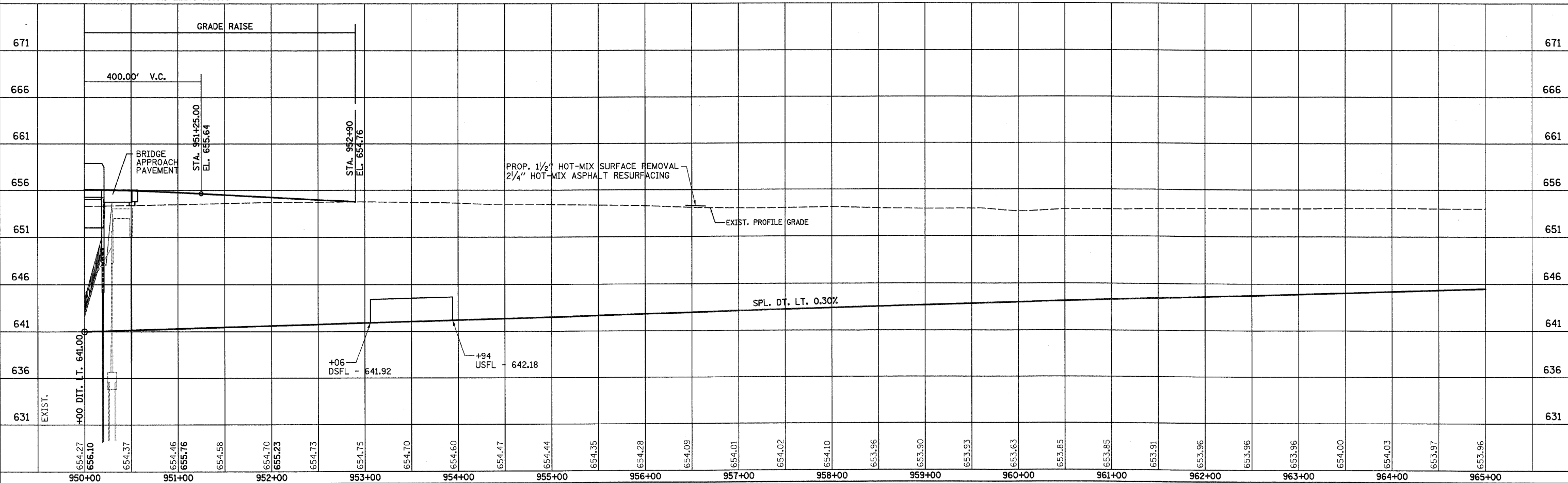
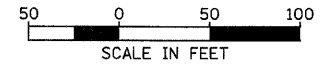

IL 47 STA. 950+00 TO STA. 965+00

PLAN

DATE

BY

REVIEWED

CHECKED

NO. _____

PROFILE

DATE

BY

REVIEWED

CHECKED

NO. _____