

F.A.P. RTE.	SECTION	COUNTY	TOTAL SHEETS	SHEET NO.
326		LIVINGSTON	354	49
STA. 980+00		TO STA. 995+00		
FED. ROAD DIST. NO.		ILLINOIS FED. AID PROJECT		
		•(123,123XRS-3,(124)RS-5,(123)BR-3		

LEGEND

- X - TREE REMOVAL
- [Hatched Box] - PAVEMENT REMOVAL & CLASS D PATCH
- [Dashed Line] - SPECIAL DITCH
- [Wavy Line] - STANDARD DITCH
- [Cross-hatched Box] - RIPRAP
- [Diamond] - TEMP. DITCH CHECK

CHERYL RORK, ET AL

LUELLA M. STEPHENS, ET AL

LUELLA M. STEPHENS, ET AL

REPORTED FIELD TILE (SEE GENERAL NOTES - FIELD TILE WORK)

STA. 983+40
EXIST. 12'x7.4' BOX - 59.6'
USFL - 642.48 LT. 30'
DSFL - 642.43 RT. 29.6'

SEC. 10, T27N, R7E, 3RD P.M.

STA. 994+57
EXIST. 15" CMP -
USFL -
DSFL - 645.89

DATE	
BY	
REVISION	
NO.	

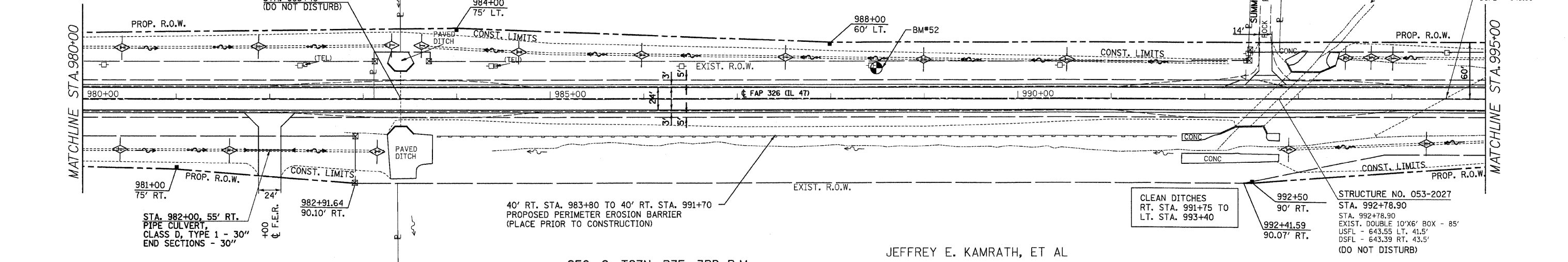

STA. 982+00, 55' RT.
PIPE CULVERT
CLASS D, TYPE 1 - 30"
END SECTIONS - 30"

40' RT. STA. 983+80 TO 40' RT. STA. 991+70
PROPOSED PERIMETER EROSION BARRIER
(PLACE PRIOR TO CONSTRUCTION)

CLEAN DITCHES
RT. STA. 991+75 TO
LT. STA. 993+40

STRUCTURE NO. 053-2027
STA. 992+78.90
EXIST. DOUBLE 10'x6' BOX - 85'
USFL - 643.55 LT. 41.5'
DSFL - 643.39 RT. 43.5'
(DO NOT DISTURB)

EXISTING FIELD ENTRANCE
REPORTED IN THIS AREA
FROM LAND ACQUISITION PROCESS

REMOVE EXCESS WIDTH OF EXISTING
PAVED SHOULDER, MAINTAINING A MAX.
3' WIDTH.
LT. STA. 991+30 TO LT. STA. 994+00
RT. STA. 991+30 TO RT. STA. 993+80

RECONSTRUCT EXISTING BERM
STA. 993+00 TO STA. 1012+00.
SEE CROSS SECTIONS SHEETS

BM#52 NAIL IN POWER POLE
35.5' LT. STA. 988+44 ELEV. 649.46

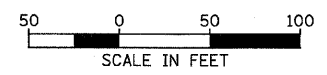

DATE	
BY	
REVISION	
NO.	

