

F.A.P. RTE.	SECTION	COUNTY	TOTAL SHEETS	SHEET NO.
326	*	LIVINGSTON	354	54
STA. 1055+00 TO STA. 1070+00				
FED. ROAD DIST. NO. ILLINOIS FED. AID PROJECT				
*(123)XRS-3,(124)RS-5,(123)BR-3				



**LEGEND**

- X - TREE REMOVAL
- ▨ - PAVEMENT REMOVAL & CLASS D PATCH
- - - - - SPECIAL DITCH
- ~ ~ ~ ~ ~ STANDARD DITCH
- ▤ - RIPRAP
- ◇ - TEMP. DITCH CHECK

ESTATE OF STUART W. MILLER

SEC. 15, T27N, R7E, 3RD P.M.

BETTY LOU KIBORT, TRUSTEE

MARY A. HALEY, TRUSTEE

SEC. 16, T27N, R7E, 3RD P.M.

RALPH HARMS

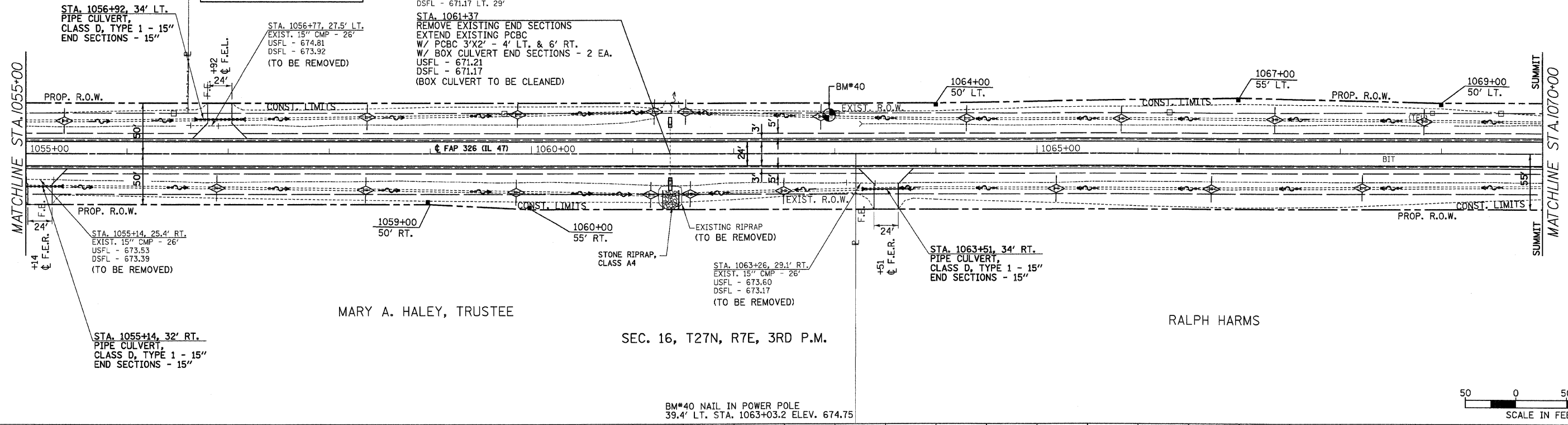

BM\*40 NAIL IN POWER POLE  
39.4' LT. STA. 1063+03.2 ELEV. 674.75

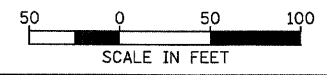

**PLAN**

DATE	
BY	
REVIEWED	
PLOTTED	
CHECKED	
DATE	
NO.	

**PROFILE**

DATE	
BY	
REVIEWED	
PLOTTED	
CHECKED	
DATE	
NO.	

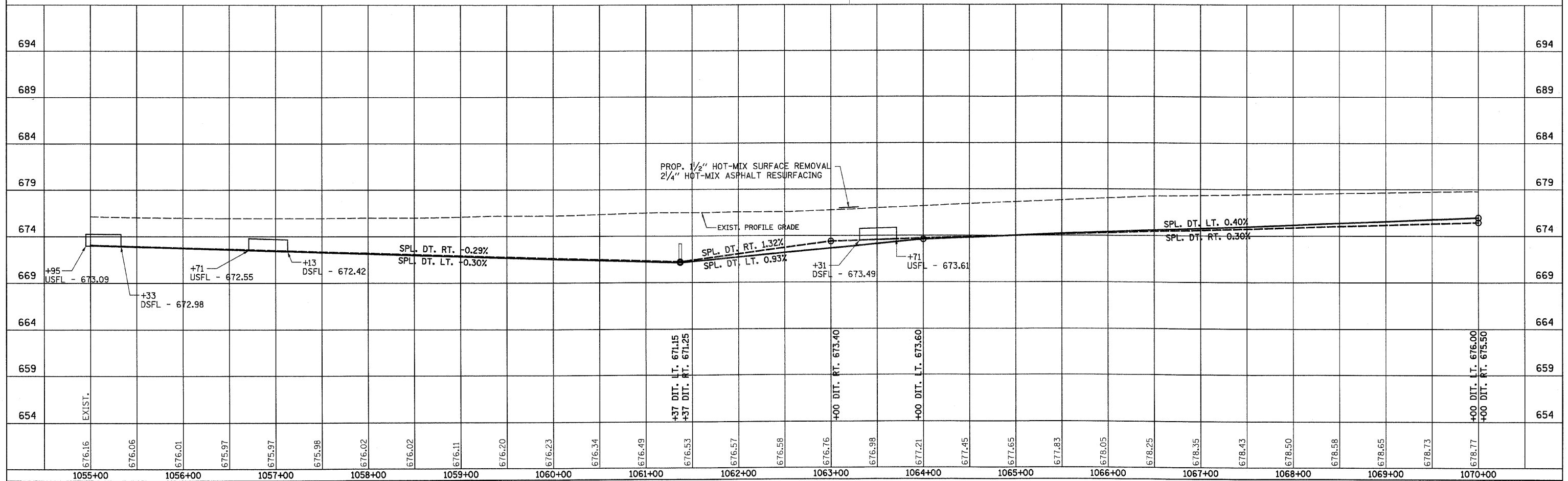

IL 47 STA. 1055+00 TO STA. 1070+00