

F.A.P. RTE.	SECTION	COUNTY	TOTAL SHEETS	SHEET NO.
326	*	LIVINGSTON	354	58

STA. 1115+00 TO STA. 1130+00

FED. ROAD DIST. NO. ILLINOIS FED. AID PROJECT
*(123)XRS-3,(124)RS-5,(123)BR-3

LEGEND

- X - TREE REMOVAL
- ▨ - PAVEMENT REMOVAL & CLASS D PATCH
- - SPECIAL DITCH
- - - - STANDARD DITCH
- ▨ - RIPRAP
- ◇ - TEMP. DITCH CHECK



SEC. 22, T27N, R7E, 3RD P.M.
MARY A. HALEY, TRUSTEE

SEC. 27
T27N, R7E, 3RD P.M.
ALINE L. SCHROEDER, TRUSTEE

SEC. 21, T27N, R7E, 3RD P.M.
A. JOHN KILGUS, ET UX

SEC. 28
T27N, R7E, 3RD P.M.
ALICE MARIE MEYER, TRUSTEE

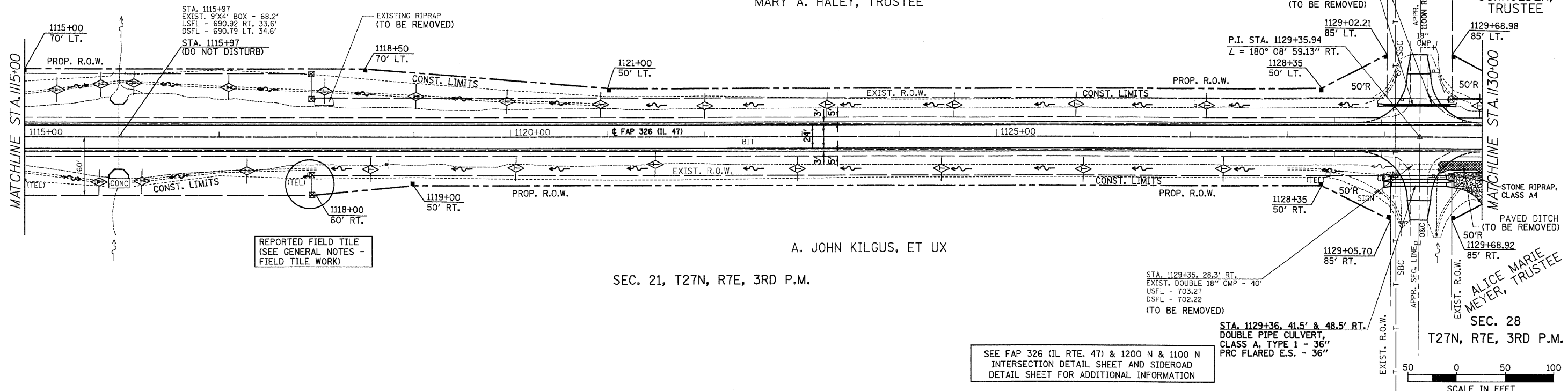

SEE FAP 326 (IL RTE. 47) & 1200 N & 1100 N INTERSECTION DETAIL SHEET AND SIDEROAD DETAIL SHEET FOR ADDITIONAL INFORMATION

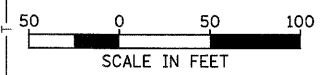

PLAN

DATE	
BY	
REVIEWED	
PLOTTED	
CHECKED	
NO. OF WAY CHECKED	
ROAD FILE NAME	

PROFILE

DATE	
BY	
REVIEWED	
PLOTTED	
CHECKED	
NO. OF WAY CHECKED	
STRUCTURE NOTATIONS DRWG	

