

F.A.P. RTE.	SECTION	COUNTY	TOTAL SHEETS	SHEET NO.
326		LIVINGSTON	354	76
STA. 1264+00		TO STA. 1270+00		
FED. ROAD DIST. NO.		ILLINOIS	FED. AID PROJECT	
•(123,123)RS-3,(124)RS-5,(123)BR-3				

LEGEND

- X - TREE REMOVAL
- [Hatched Box] - PAVEMENT REMOVAL & CLASS D PATCH
- [Dashed Line] - SPECIAL DITCH
- [Wavy Line] - STANDARD DITCH
- [Stippled Box] - RIPRAP
- [Diamond] - TEMP. DITCH CHECK

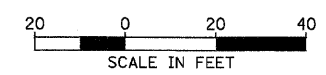
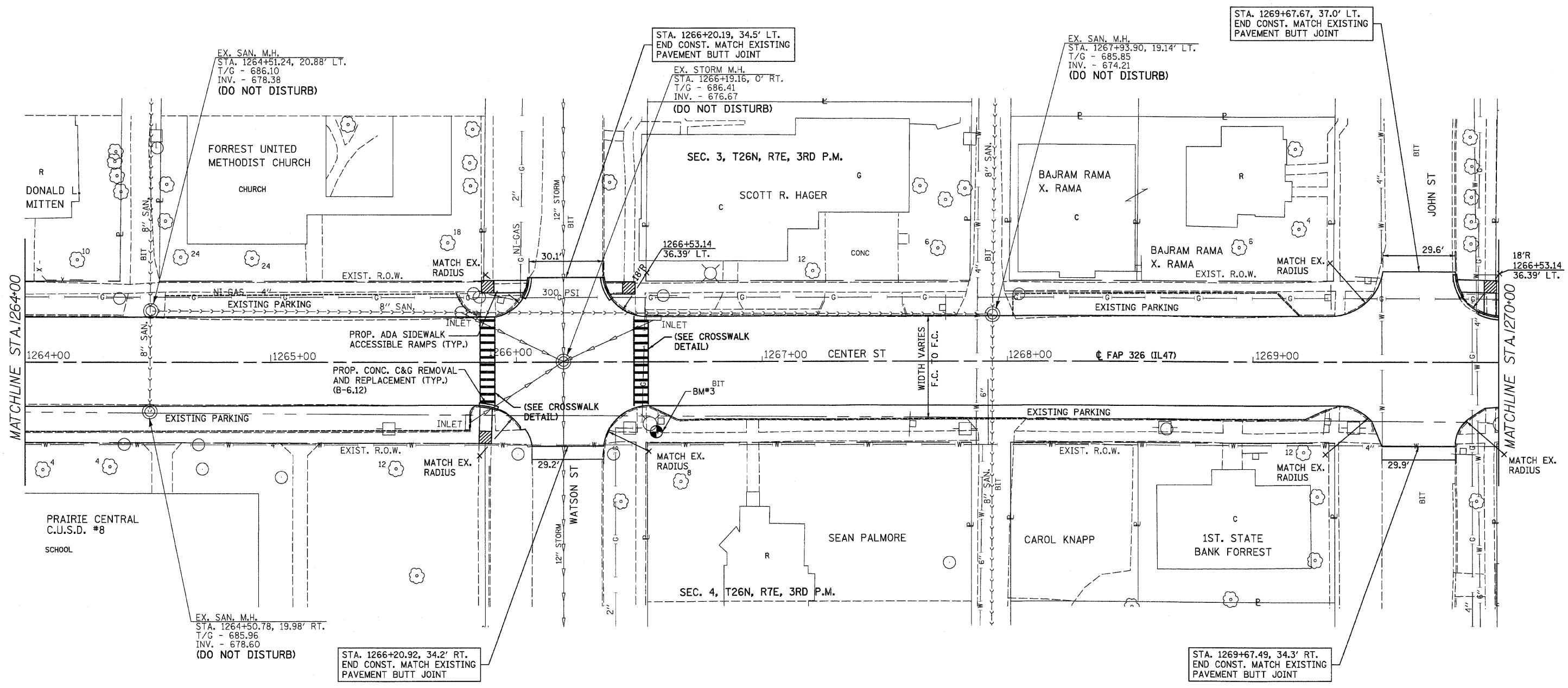

REVISIONS	
NAME	DATE

ILLINOIS DEPARTMENT OF TRANSPORTATION

IL 47
 STA. 1264+00 TO STA. 1270+00

SCALE: VERT. _____
 HORIZ. _____
 DATE _____

DRAWN BY _____
 CHECKED BY _____

BM#3 CHISLED "X" ON NORTHEAST BOLT, FIRE HYDRANT 24.6' RT. STA. 1266+57.5 ELEV. 687.80

K:\110127\geopak\PlanSheet20.dgn