

F.A.P. RTE.	SECTION	COUNTY	TOTAL SHEETS	SHEET NO.
326		LIVINGSTON	354	90
STA. TO STA.		FED. ROAD DIST. NO. ILLINOIS FED. AID PROJECT		
		*123,123XRS-3,(124)RS-5,(123)BR-3		

EXIST. CURVE EXCL-5
 PI STA. = 1241+73.46
 $\Delta = 1^\circ 07' 50''$ (LT)
 $D = 0^\circ 07' 53''$
 $R = 43,56872'$
 $T = 429.83$
 $L = 859.64'$
 $E = 2.12'$
 $e = N.C.$
 P.C. STA. = 1237+43.62
 P.T. STA. = 1246+03.26

PLACE VERTICAL PANELS, TYPE A LIGHTS, BARRICADES, DRUMS AND SIGNS AS SHOWN IN THIS DETAIL AND AS DIRECTED BY THE ENGINEER. COST OF THESE ITEMS TO BE INCLUDED IN THE CONTRACT UNIT PRICE EACH FOR TRAFFIC CONTROL AND PROTECTION (SPECIAL).

CONFLICTING EXISTING PAVEMENT MARKINGS WILL BE REMOVED AND PAID FOR AS PAVEMENT MARKING REMOVAL.

POSTED 40 MPH
 CONST. SPEED LIMIT 30 MPH

MAINTAIN EXISTING CULVERT FOR DRAINAGE UNTIL NEW CULVERT HAS BEEN CONSTRUCTED. REMOVE EXISTING PCBC END SECTIONS AND EXTEND EXISTING CULVERT WITH 3'X2' PCBC - 8 L.F. LT AND 8 L.F. RT.. (SUPPORTS TEMP. WIDENING FOR STAGING)

TEMPORARY CONCRETE BARRIER (VERTICAL PANELS, TYPE A LIGHT AND TYPE C BIDIRECTIONAL REFLECTOR SEE STANDARD 701321 FOR PLACEMENT)

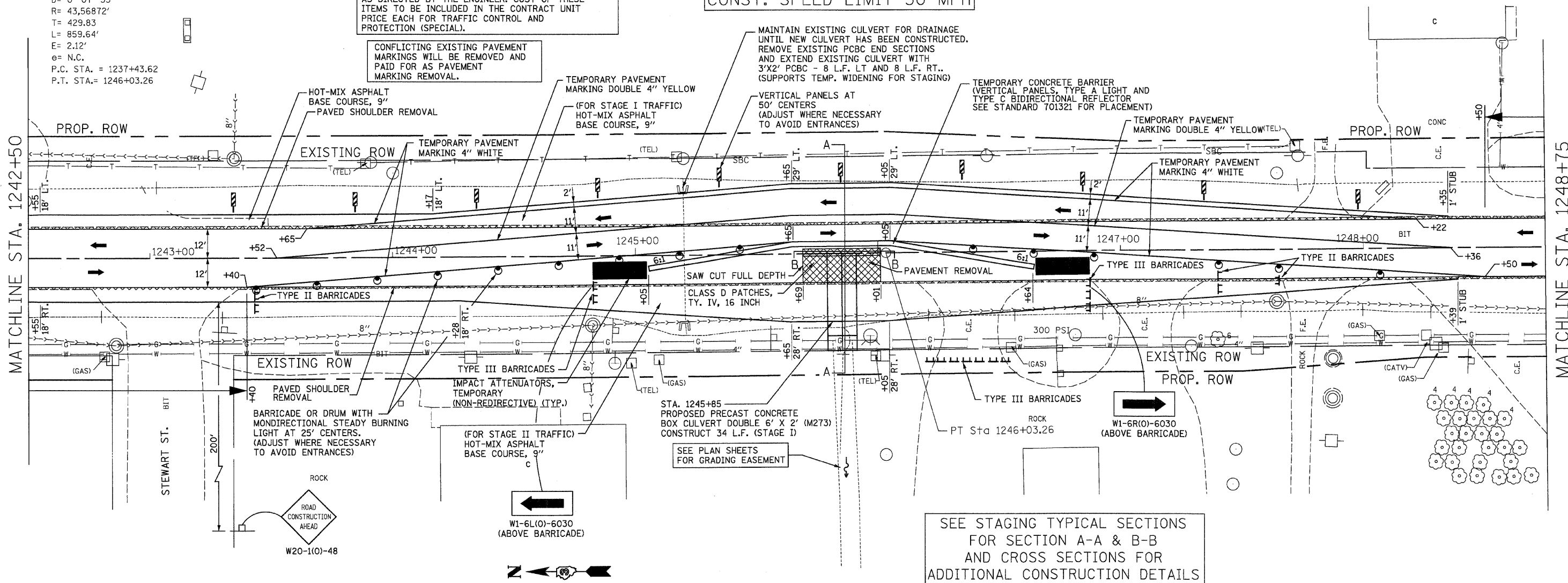

STAGE I SEQUENCE OF OPERATIONS

1. REMOVE THE EXISTING 1.5' WIDE PAVED SHOULDER ON BOTH SIDES OF THE EXISTING PAVEMENT AS SHOWN IN THESE DETAILS.
2. EXTEND THE EXISTING 3'X2' RCBC (STA. 1245+20).
3. CONSTRUCT HOT-MIX ASPHALT BASE COURSE, 9" LT. OF THE EXISTING PAVEMENT.
4. INSTALL ATTENUATORS, CONCRETE BARRIERS, DRUMS, VERTICAL PANELS, STRIPING AND ALL OTHER ITEMS PER THESE DETAILS. MAINTAIN TWO-WAY TRAFFIC.
5. INSTALL THE TEMPORARY SOIL RETENTION SYSTEM (SEE SPECIAL PROVISION). REMOVE THE STAGE I PORTION OF THE EXISTING PAVEMENT AND CULVERT AS SHOWN IN THESE DETAILS.
6. CONSTRUCT THE STAGE I PORTION OF THE PRECAST CONCRETE BOX CULVERT, GRANULAR EMBANKMENT, CLASS D PATCH AND HOT-MIX ASPHALT BASE COURSE, 9" RT. OF THE EXISTING PAVEMENT AS SHOWN IN THESE DETAILS.
7. CONSTRUCT DOWNSTREAM CHANNEL (SEE PLAN SHEETS FOR GRADING INFORMATION).

NOTE: IF OPERATIONS EXCEED 4 DAYS SIGNS SHALL BE POST MOUNTED.

SEE STAGING TYPICAL SECTIONS FOR SECTION A-A & B-B AND CROSS SECTIONS FOR ADDITIONAL CONSTRUCTION DETAILS

REVISIONS	
NAME	DATE

ILLINOIS DEPARTMENT OF TRANSPORTATION
 TRAFFIC CONTROL AND PROTECTION (SPECIAL)
 STATION 1245+85
 STAGE I CONSTRUCTION PLANS
 SCALE: VERT. DATE
 HORIZ. DATE
 DRAWN BY
 CHECKED BY