

F.A.P. RTE. 326	SECTION •	COUNTY LIVINGSTON	TOTAL SHEETS 354	SHEET NO. 175
STA.		TO STA.		
FED. ROAD DIST. NO.		ILLINOIS FED. AID PROJECT		
•123,123XIRS-3,424IRS-5,123IBR-3				

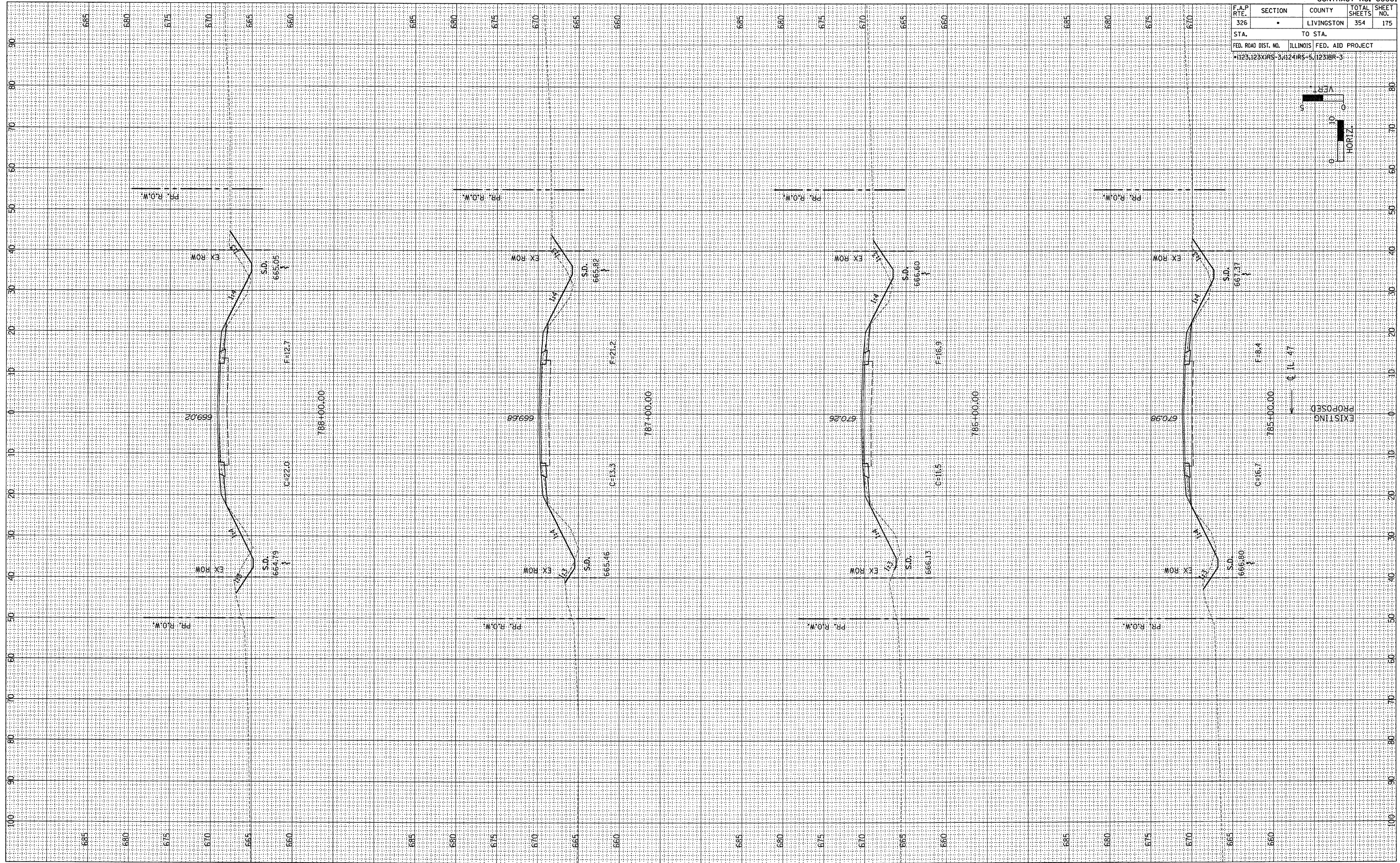
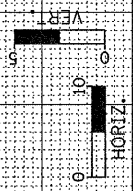

FINAL SURVEY	DATE	BY
REVISED		
PLOTTED		
TEMPLATE		
AREAS		
CHECKED		

ORIGINAL SURVEY	DATE	BY
REVISED		
PLOTTED		
TEMPLATE		
AREAS		
CHECKED		