

F.A.P. RTE.	SECTION	COUNTY	TOTAL SHEETS	SHEET NO.
326	*	LIVINGSTON	354	183
STA.		TO STA.		
FED. ROAD DIST. NO.	ILLINOIS	FED. AID PROJECT		
*123123XRS-3;124RS-5;1231BR-3				

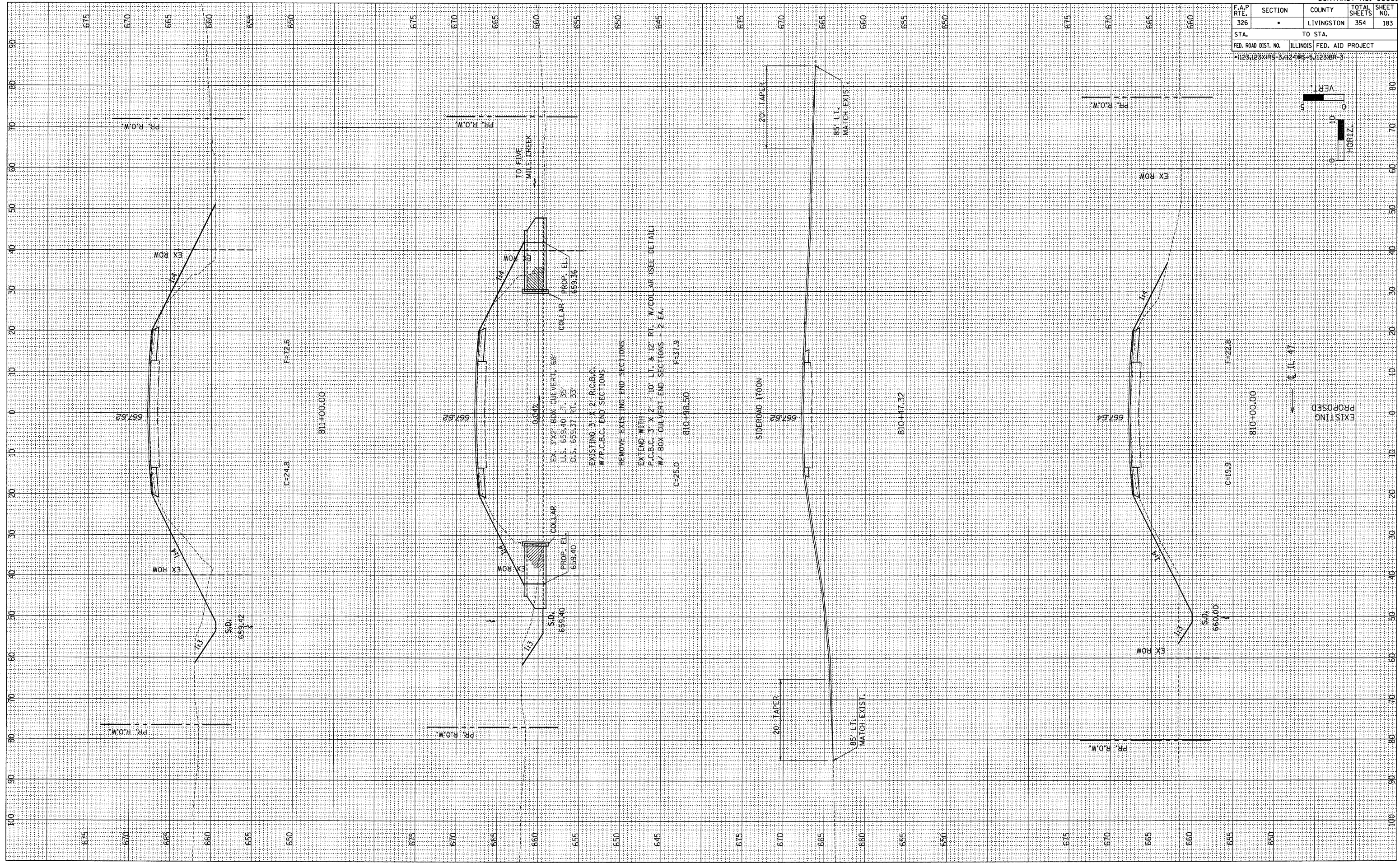
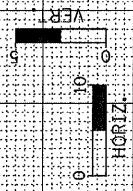

FINAL SURVEY	BY	DATE
NO.		
REVIEWED		
NOTE BOOK		
AREAS CHECKED		

ORIGINAL SURVEY	BY	DATE
NO.		
REVIEWED		
NOTE BOOK		
AREAS CHECKED		