

F.A.P. RTE. 326	SECTION •	COUNTY LIVINGSTON	TOTAL SHEETS 354	SHEET NO. 187
STA.		TO STA.		
FED. ROAD DIST. NO.		ILLINOIS FED. AID PROJECT		
•1123,123XIRS-3,1124IRS-5,1123IBR-3				

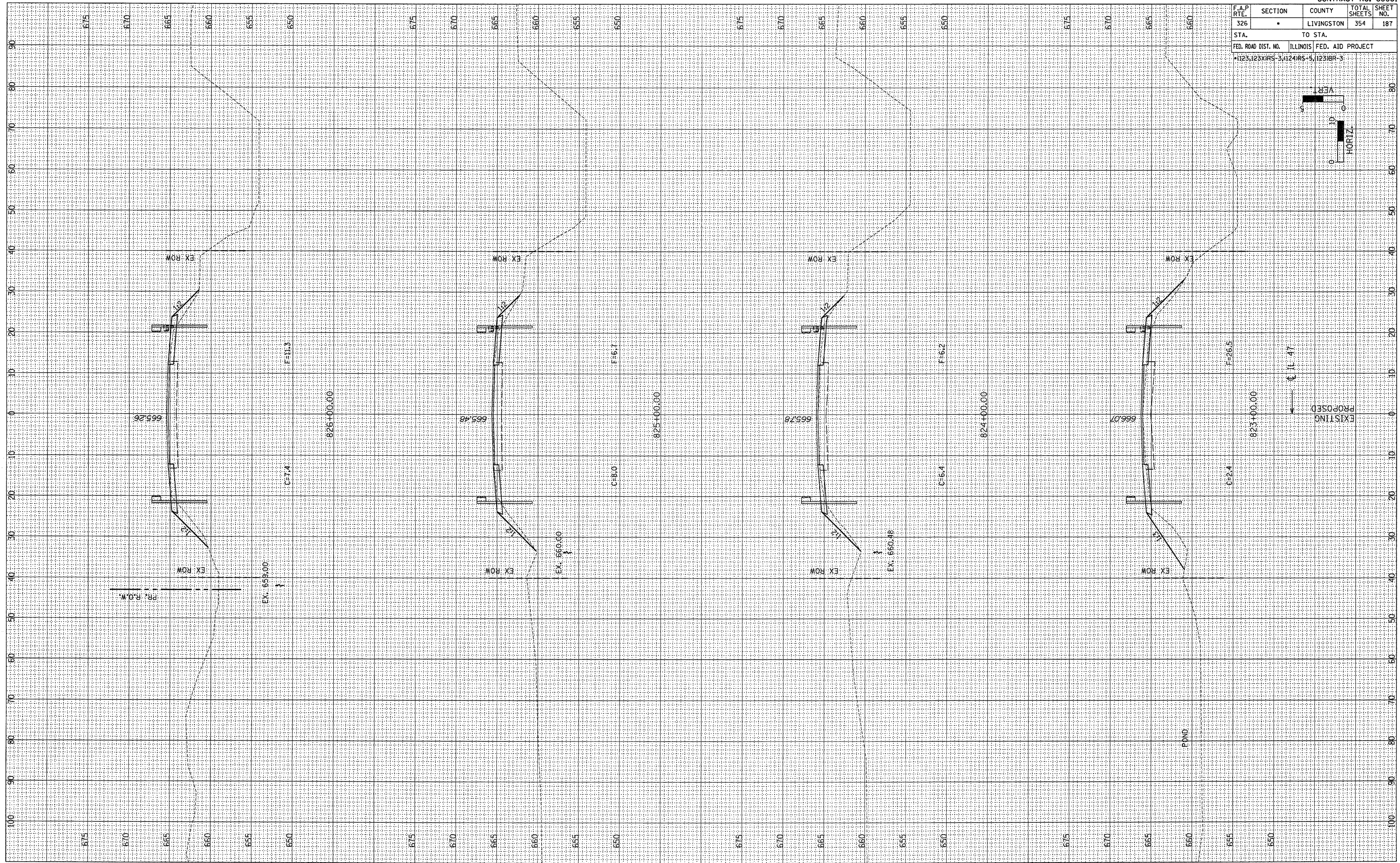
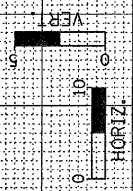

FINAL SURVEY	BY	DATE
QUANDED PLOTTED		
NOTE BOOK		
AREAS CHECKED		
NO.		

ORIGINAL SURVEY	BY	DATE
QUANDED PLOTTED		
NOTE BOOK		
AREAS CHECKED		
NO.		